

Location: D-29 4th Fl. MEWS RM.

Site: DHS-EML

RWP#

EMC #002

Survey #

037

Survey Type:

D-29 F.S.S.

1 pg. of 4

Smear (CPM/100 cm²)

circle one

Release of Equipment / Materials

Class 1 FSS State/Smear results

No.	α	β	No.	α	β
1	0	82	26		
2	0	72	27		
3	2	85	28		
4	0	50	29		
5	1	76	30		
6	0	66	31		
7	0	65	32		
8	1	72	33		
9	0	64	34		
10	1	76	35		
11	0	65	36		
12	1	67	37		
13	0	68	38		
14	2	60	39		
15	1	48	40		
16	0	52	41		
17	0	67	42		
18	1	65	43		
19	2	61	44		
20	0	59	45		
21			46		
22			47		
23			48		
24			49		
25			50		

Items

Average (cpm) Max (cpm)

- 1) D-29-F-1 0, 260
- 2) D-29-F-2 0, 263
- 3) D-29-F-3 1, 286
- 4) D-29-F-4 3, 264
- 5) D-29-C-5 2, 269
- 6) D-29-C-6 0, 265
- 7) D-29-C-7 6, 323
- 8) D-29-C-8 1, 263
- 9) D-29-C-9 2, 311
- 10) D-29-W-10 3, 403
- 11) D-29-W-11 4, 373
- 12) D-29-W-12 4, 388
- 13) D-29-W-13 2, 381
- 14) D-29-W-14 1, 267
- 15) D-29-W-15 2, 340
- 16) D-29-W-16 0, 240
- 17) D-29-W-17 3, 376
- 18) D-29-F/B-18 6, 287
- 19) D-29-B/B-19 1, 225
- 20) _____
- 21) _____
- 22) _____
- 23) _____
- 24) _____

Items

Average (cpm) Max (cpm)

- 25) _____
- 26) _____
- 27) _____
- 28) _____
- 29) _____
- 30) _____
- 31) _____
- 32) _____
- 33) _____
- 34) _____
- 35) _____
- 36) _____
- 37) _____
- 38) _____
- 39) _____
- 40) _____
- 41) _____
- 42) _____
- 43) _____
- 44) _____
- 45) _____
- 46) _____
- 47) _____
- 48) _____

Comments	Surveyed By:	Date:	Instrument	Serial #	α Eff.	β Eff.	α Bkg.	β Bkg.	γ Bkg.	Cal. Due	Key	
	K. ANDREWS	3/24/08	2360 w/ 43-68	193667/ PR 120548	.058	.183	0	133	N/A	11/11/08		
	K. ANDREWS	3/24/08	2929 w/ 43-10-1	129566 w/ PR 132720	.333	.204	0.5	70.1	N/A	01/05/09	■	A/S Location
											_	Boundary
											○	Smear
											□	Dose Rate _____ /hr
	Reviewed By:	Date:									*	Direct Reading CPM/direct frisk
	Nicholas M. Berliner	12/28/11	Original survey misplaced								△	Grab Sample

Scan Information Sheet

SU/Room: D-29 men's bathroomClass: 1Tech Init.: GB/KA

- Note:
1. On map: draw dimensions and characters
 2. Record scan data for different surfaces
 3. Mark all areas > Action Level (include sample ID)
 4. Record avg and max observed cpm

Directs (cpm) w/43-68

(18) 6/287
 (19) 1/225
 ↳ on ceiling
 (20)
 (1) 4/338
 (2) 2/384
 (23) 6/493
 (24) 6/382
 w/43-93
 background
 above
 drop ceiling
 1/219

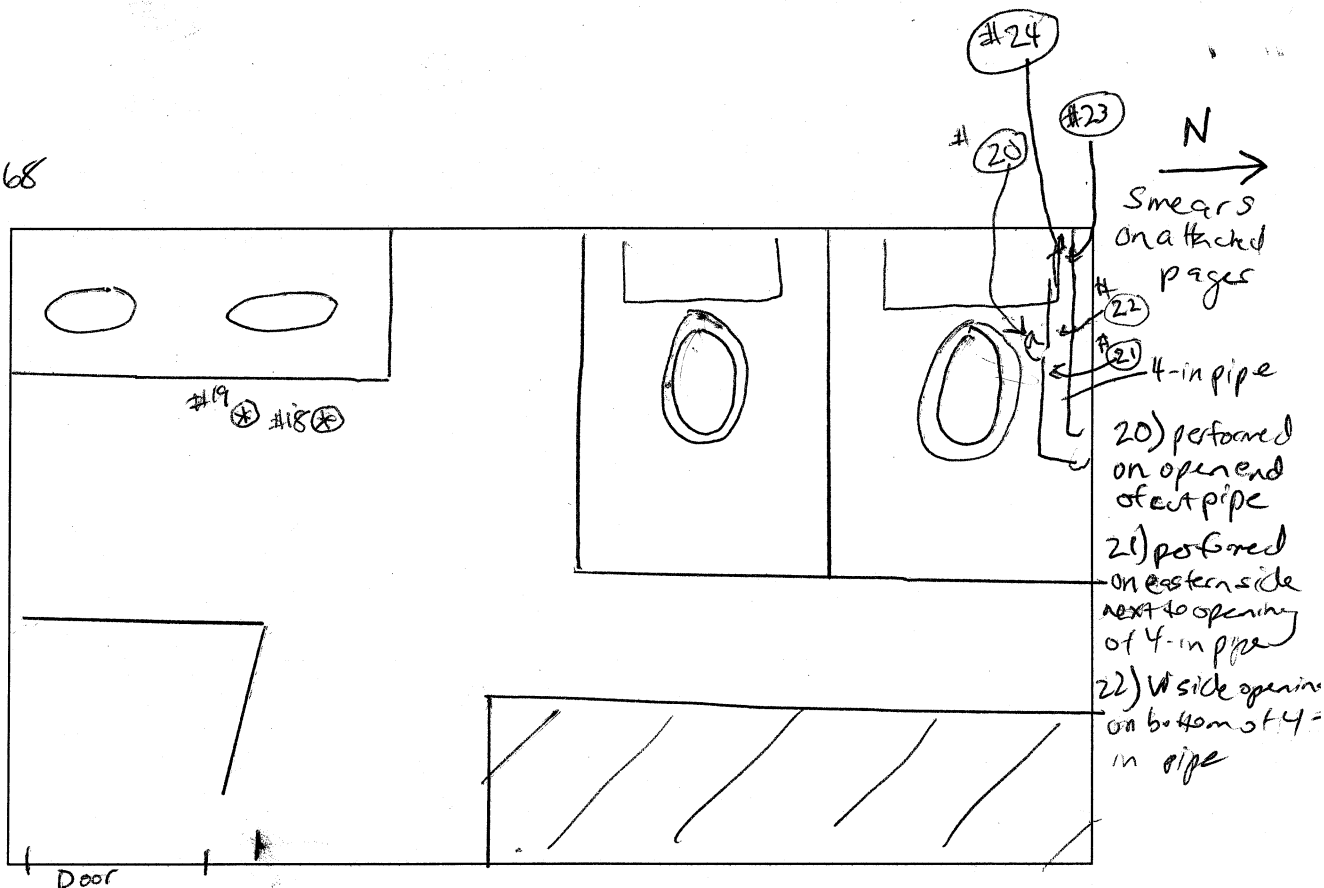

Notes: ^{of ceiling tiles} 100% scan of topsides performed w/2360/43-68 #193667/PRI20548

100% scan of ^{floors} walls + ceiling performed w/2360/43-37 #184938/PRI78371

Floors: Average: 500cpm, Max: 1000cpm beta - alpha range - 0-36 cpm

Walls + Ceiling: Average 800cpm, Max 1200cpm beta - alpha range - 10-40cpm

GB 3/24/08 Ceiling tiles scanned Average: 700cpm, Max 1000cpm

Tech Signature: 3/24/08

Date: 3/24/08

Room D-29

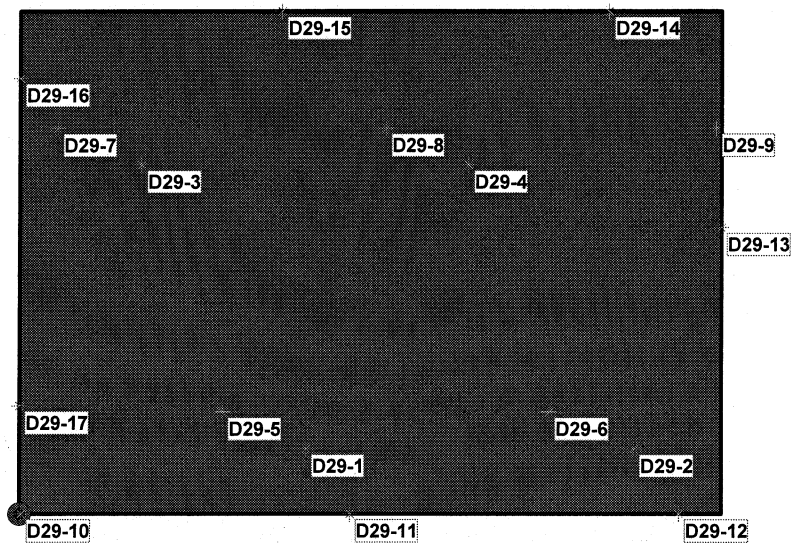

Class 1 Floors, Walls, and Ceiling

4 of 4

Area: Room D-29

X Coord	Y Coord	Z Coord	Label	Value	Type	Historical	Surface	LX	LY
6.2421	1.4174	0.0000	D29-1		Systematic		Floor	6.2421	1.4174
13.4147	1.4174	0.0000	D29-2		Systematic		Floor	13.4147	1.4174
2.6559	7.6290	0.0000	D29-3		Systematic		Floor	2.6559	7.6290
9.8284	7.6290	0.0000	D29-4		Systematic		Floor	9.8284	7.6290
4.4191	2.2248	8.0000	D29-5		Systematic		Ceiling	4.4191	2.2248
11.5916	2.2248	8.0000	D29-6		Systematic		Ceiling	11.5916	2.2248
0.8328	8.4364	8.0000	D29-7		Systematic		Ceiling	0.8328	8.4364
8.0053	8.4364	8.0000	D29-8		Systematic		Ceiling	8.0053	8.4364
15.1779	8.4364	8.0000	D29-9		Systematic		Ceiling	15.1779	8.4364
0.0352	0.0000	2.7990	D29-10		Systematic		Wall 4	15.2648	2.7990
7.2077	0.0000	2.7990	D29-11		Systematic		Wall 4	8.0923	2.7990
14.3802	0.0000	2.7990	D29-12		Systematic		Wall 4	0.9198	2.7990
15.3000	6.2528	2.7990	D29-13		Systematic		Wall 3	4.7472	2.7990
12.8747	11.0000	2.7990	D29-14		Systematic		Wall 2	12.8747	2.7990
5.7021	11.0000	2.7990	D29-15		Systematic		Wall 2	5.7021	2.7990
0.0000	9.5296	2.7990	D29-16		Systematic		Wall 1	9.5296	2.7990
0.0000	2.3571	2.7990	D29-17		Systematic		Wall 1	2.3571	2.7990