



Department of Energy
Washington, D.C. 20585

JUL 6 1979

Honorable Joseph Hendrie
Chairman
Nuclear Regulatory Commission
Washington, D.C. 20555

Dear Mr. Chairman:

Public Law 95-604, the Uranium Mill Tailings Radiation Control Act of 1978, requires the Secretary of Energy to designate processing sites at or near the locations listed in Section 102 of the Law.

As part of the process of designating these sites, the Department of Energy, in consultation with the Nuclear Regulatory Commission, is to identify the site boundaries of each of the designated processing sites. Enclosed is a set of descriptions of the 22 proposed processing sites, including site maps and the site boundary descriptions for your review. I would appreciate your comments concerning these proposed site designations. Dr. William E. Mott, Director, Environmental Control Technology Division, has been designated as my point of contact for this project.

Sincerely,

James G. Liverman
Ruth C. Cluser
Assistant Secretary for Environment

Enclosure

cc: S. Lichtman, EPA

90028066

~~90023102~~

8001160

209

~~219~~

Enclosure 1

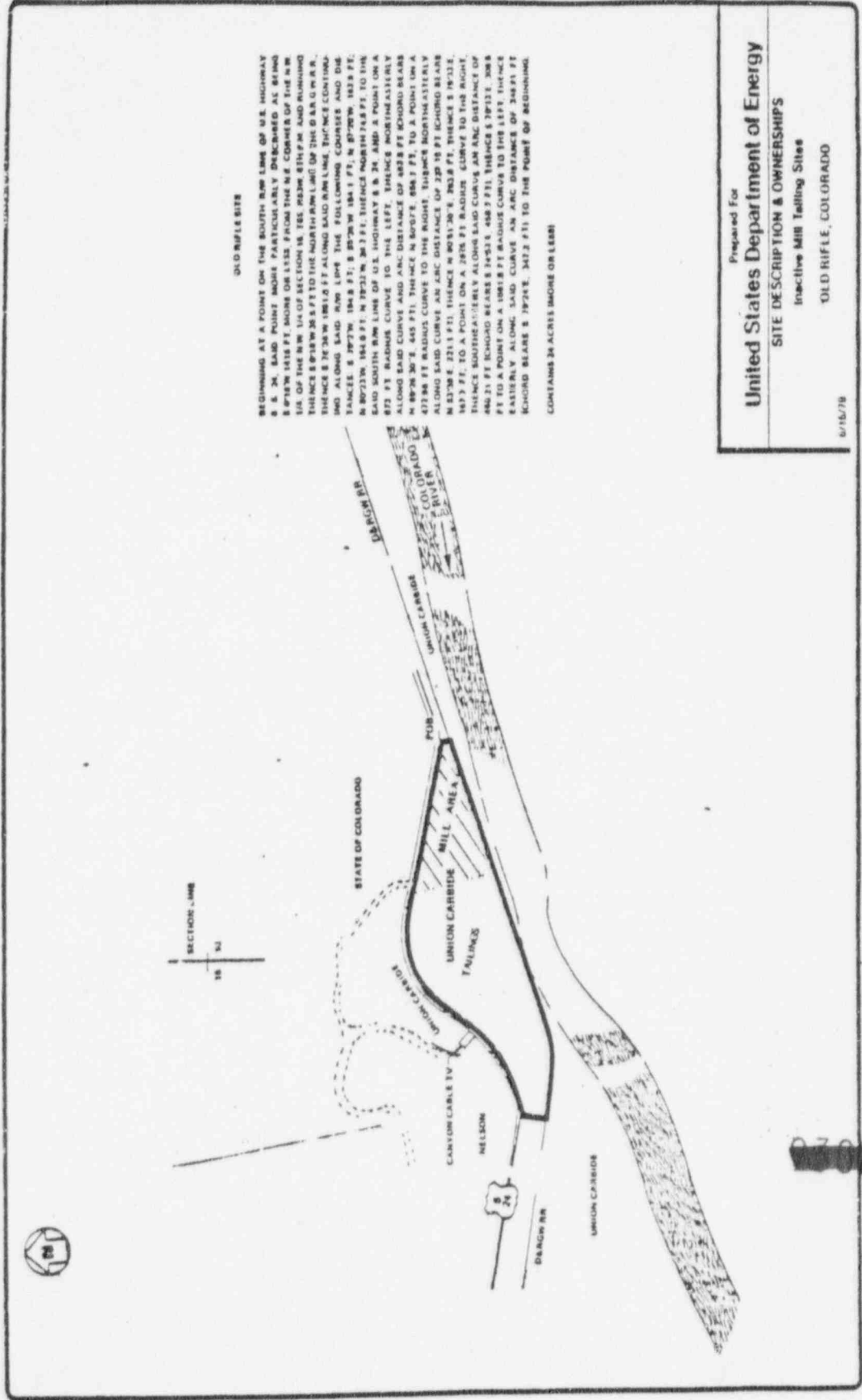

Prepared for
United States Department of Energy
SITE DESCRIPTION & OWNERSHIPS
Inactive MIB Telling Sites
OLD RIFLE, COLORADO

6/16/78

90028067

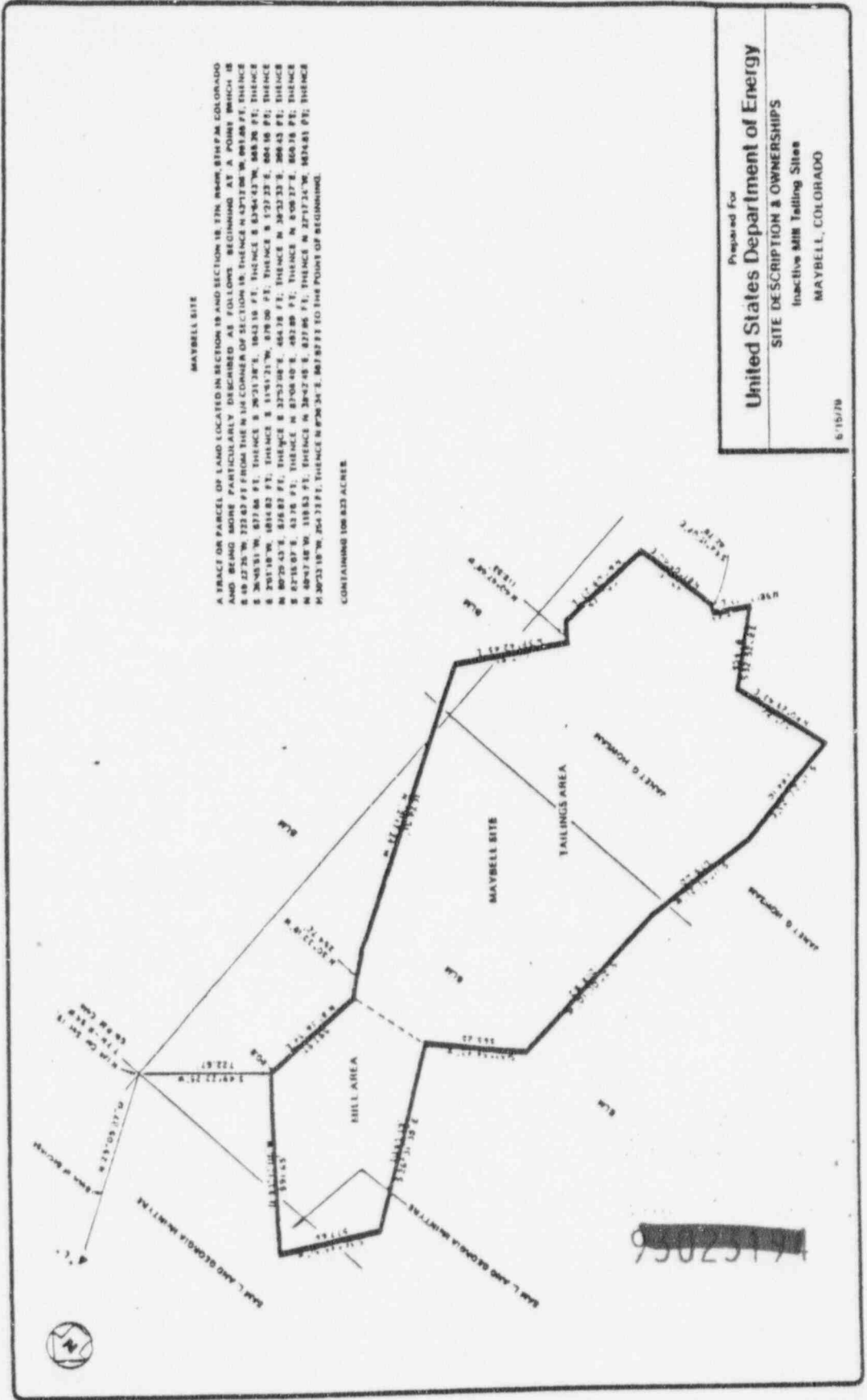

United States Department of Energy
Prepared For
SITE DESCRIPTION & OWNERSHIPS
Inactive Mill Tailing Sites
GUNNISON, COLORADO

46 / 45 39

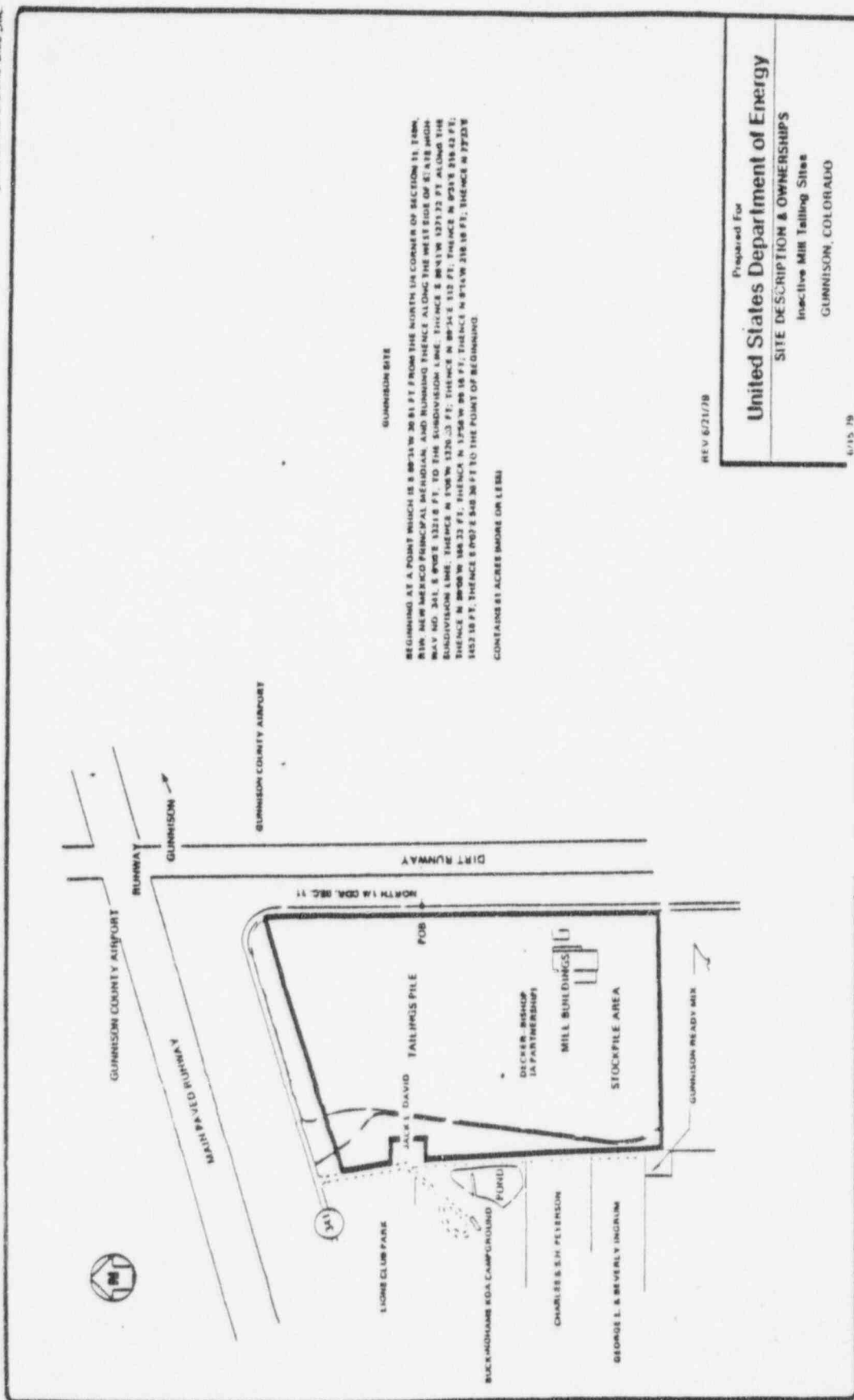

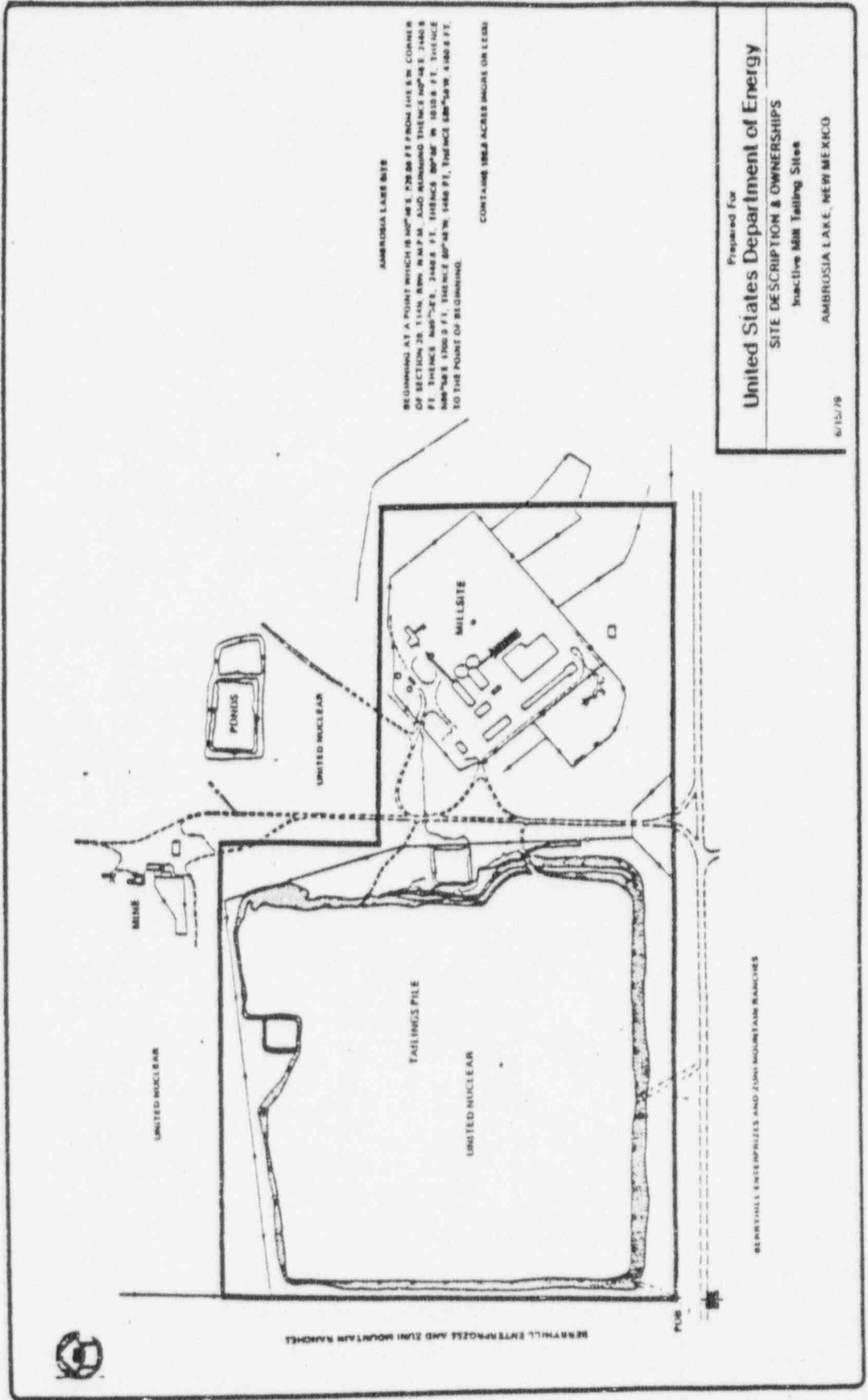

AMBROSIA LAKE MILL

BEGINNING AT A POINT WHICH IS 100' W. E. 720' S. 75' FROM THE S.W. CORNER OF SECTION 28, T14N, R10W, N.M.P.M. ALSO ALONGING THE LINE 100' W. E. 720' S. 75' TO THE POINT OF BEGINNING.

CONTAINS 188.6 ACRES MORE OR LESS

Prepared For
United States Department of Energy

SITE DESCRIPTION & OWNERSHIPS

Inactive Mill Tailings Site

AMBROSIA LAKE, NEW MEXICO

6/15/79

BEAUFORT ENTERPRISES AND ZUNI MOUNTAIN RANCHES

90028070

75023196

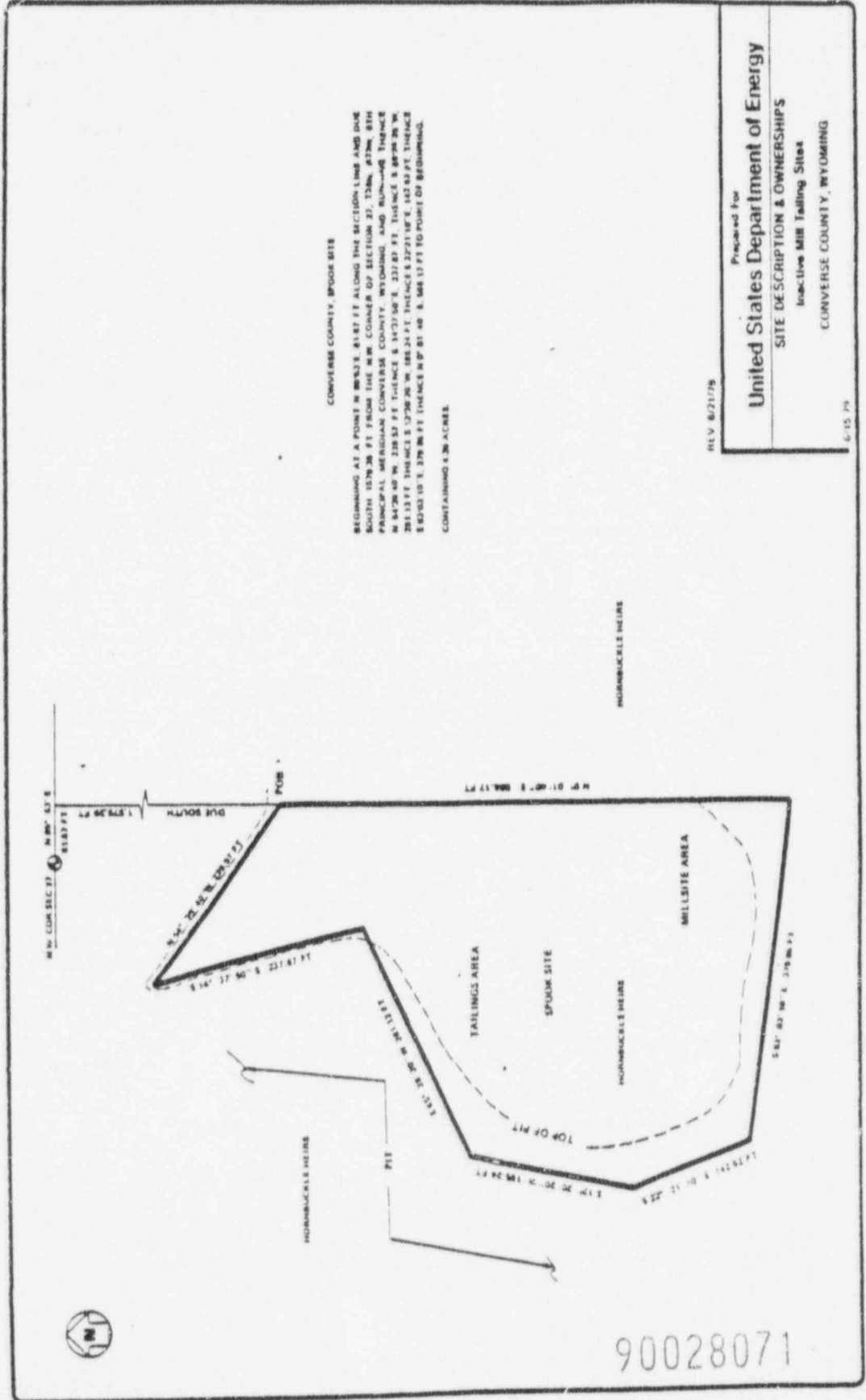

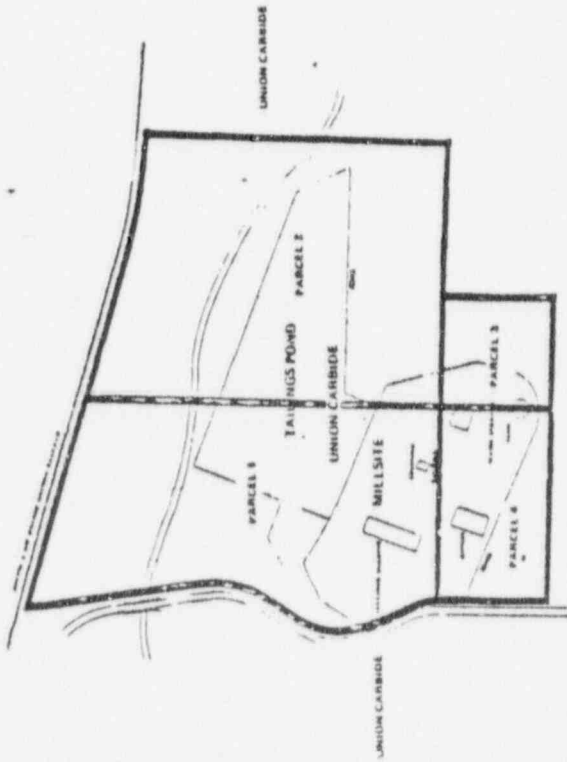

GREEN RIVER RITE
PARCELS 1 THROUGH 6

PARCEL 1

THAT PORTION OF LAND LOCATED IN THE SW 1/4 OF THE SE 1/4 SECTION 18, T21S, R12E, SALT LAKE MERIDIAN, LYING ADJACENT TO AND EAST OF A COUNTY ROAD FROM SLOAN TO THE GREEN RIVER MISSILE SITE, AND SOUTH OF THE D & W RAILROAD R/W

PARCEL 2

THAT PORTION OF LAND LOCATED IN THE WEST 1/2 OF THE SE 1/4 OF THE SE 1/4 OF SECTION 15, T21S, R12E, SALT LAKE MERIDIAN LYING SOUTH OF AND ADJACENT TO THE D & W RAILROAD R/W

PARCEL 3

THAT PORTION OF LAND LOCATED IN THE WEST 1/2 OF THE NORTH 1/2 OF THE NORTH 1/2 OF THE NE 1/4 OF SECTION 22, T21S, R12E, SALT LAKE MERIDIAN

PARCEL 4

THAT PORTION OF LAND LOCATED IN THE NORTH 1/2 OF THE NORTH 1/2 OF THE NE 1/4 OF THE NE 1/4 OF SECTION 22, T21S, R12E, SALT LAKE MERIDIAN, LYING EAST OF AND ADJACENT TO A COUNTY ROAD FROM SLOAN TO THE GREEN RIVER MISSILE SITE.
CONTAINS 20 ACRES MINUS, OR LESS

Prepared for
United States Department of Energy
SITE DESCRIPTION & OWNERSHIPS
Inactive Mill Telling Sites
GREEN RIVER, UTAH

90028072

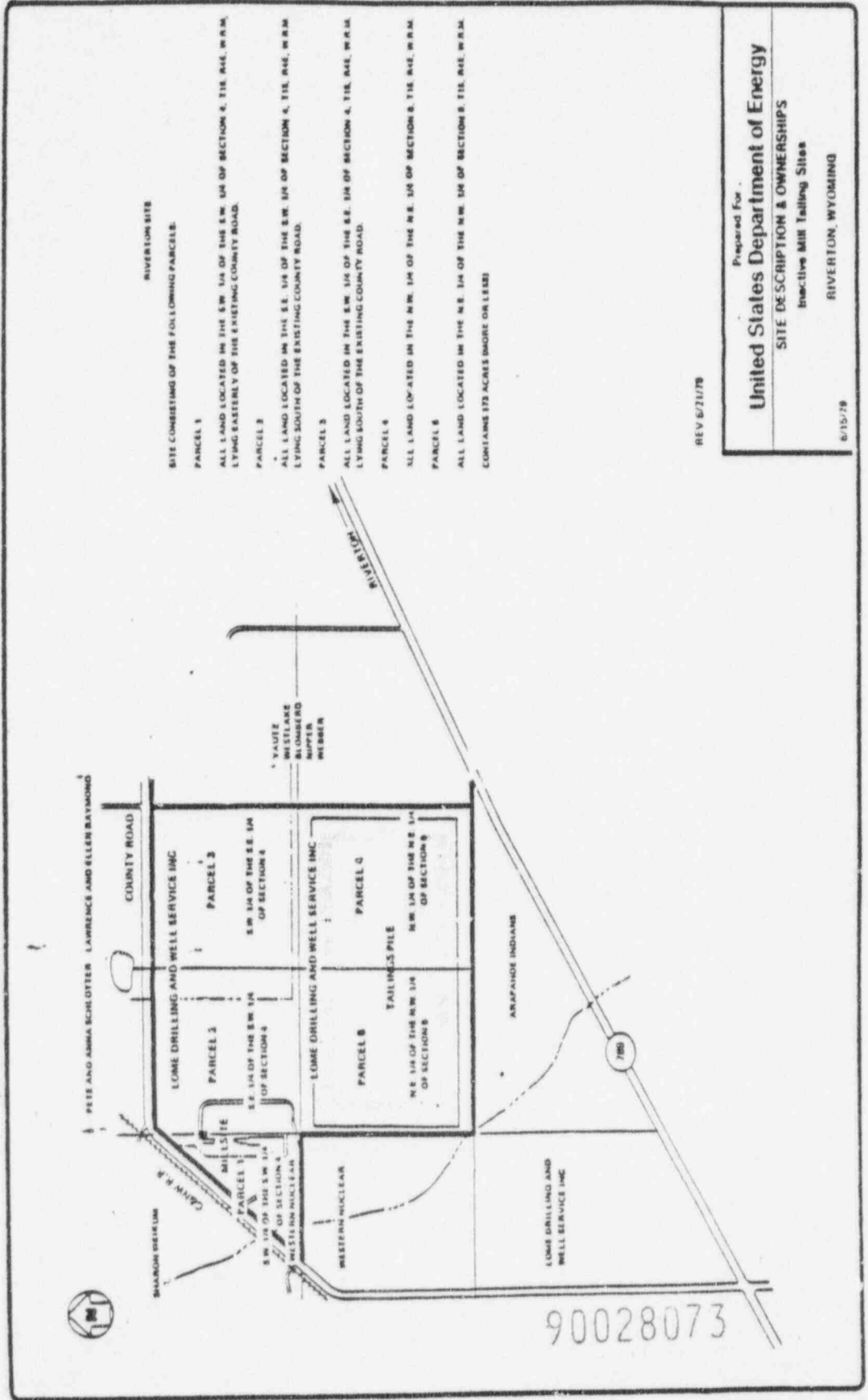

RIVERBEND SITE

SITE CONSISTING OF THE FOLLOWING PARCELS:

PARCEL 1

ALL LAND LOCATED IN THE SW 1/4 OF THE SW 1/4 OF SECTION 4, T1S, R4E, W4M, LYING EASTERLY OF THE EXISTING COUNTY ROAD.

PARCEL 2

ALL LAND LOCATED IN THE SE 1/4 OF THE SW 1/4 OF SECTION 4, T1S, R4E, W4M, LYING SOUTH OF THE EXISTING COUNTY ROAD.

PARCEL 3

ALL LAND LOCATED IN THE SW 1/4 OF THE SE 1/4 OF SECTION 4, T1S, R4E, W4M, LYING SOUTH OF THE EXISTING COUNTY ROAD.

PARCEL 4

ALL LAND LOCATED IN THE NW 1/4 OF THE SE 1/4 OF SECTION 8, T1S, R4E, W4M.

PARCEL 5

ALL LAND LOCATED IN THE NE 1/4 OF THE NW 1/4 OF SECTION 8, T1S, R4E, W4M, CONTAINS 173 ACRES MORE OR LESS.

Prepared For:
United States Department of Energy

SITE DESCRIPTION & OWNERSHIPS

Inactive Mill Tailings Sites

RIVERTON, WYOMING

REV 5/21/78

5/15/78

95023199

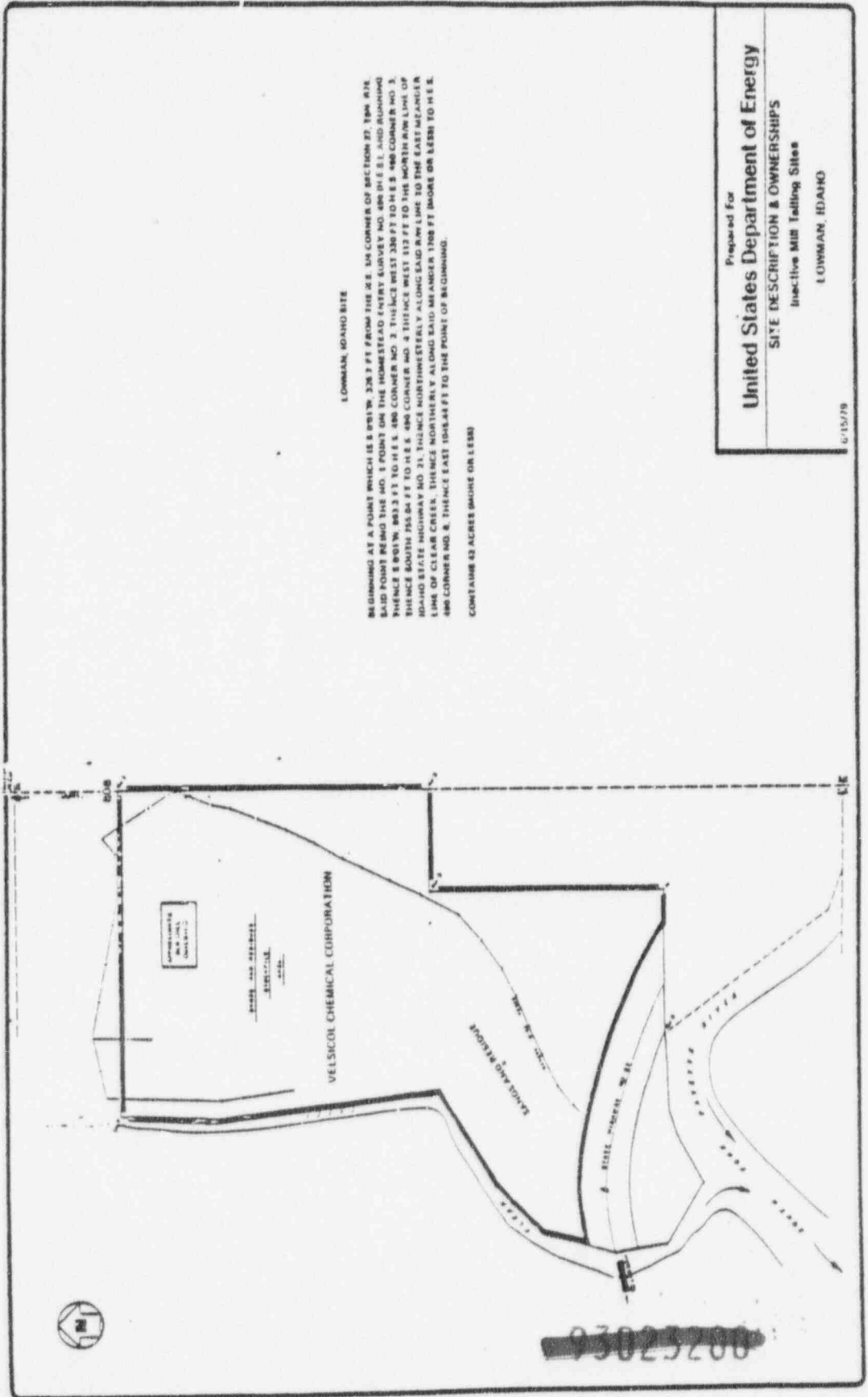

Prepared For
United States Department of Energy
 SITE DESCRIPTION & OWNERSHIP
 Inactive Mill Tailing Sites
 LOWMAN, IDAHO

6/15/78

93023200

90028074

PARCEL "A"

BEGINNING AT A MONUMENT AT THE INTERSECTION OF THE NORTH LINE OF GEORGE STREET AND THE WEST LINE OF STRABANE AVENUE IN THE BOROUGH OF CAMDENBURG, PENNSYLVANIA, THENCE ALONG THE NORTH LINE OF GEORGE STREET S 71°15'W, 882.87 FT. THENCE N 5°05'E, 240.22 FT. TO A MONUMENT AT THE SOUTH R/W LINE OF THE WASHINGTON-CAMDENBURG STREET RAILWAY, THENCE ALONG SAID R/W LINE N 82°34'E, 281.80 FT. TO THE WEST LINE OF WARD STREET, THENCE ALONG THE WEST LINE OF WARD STREET S 47°18'E, 222.82 FT. S 30°55'E, 358.88 FT. S 18°22'E, 111.22 FT. TO THE WEST LINE OF STRABANE AVENUE, THENCE ALONG THE WEST LINE OF STRABANE AVENUE S 8°00'W, 120.86 FT. TO THE POINT OF BEGINNING.

CONTAINS 18.9 ACRES (MORE OR LESS)

PARCEL "B"

BEGINNING AT A POINT AT THE INTERSECTION OF THE EAST LINE OF WARD STREET AND THE WEST LINE OF STRABANE AVENUE IN THE BOROUGH OF CAMDENBURG, WASHINGTON COUNTY, PENNSYLVANIA, THENCE ALONG THE EAST LINE OF WARD STREET N 84°18'W, 80.06 FT. THENCE ALONG THE EAST LINE OF WARD STREET N 84°18'W, 80.06 FT. TO A MONUMENT ON THE SOUTH R/W LINE OF THE WASHINGTON-CAMDENBURG STREET RAILWAY, THENCE ALONG SAID R/W LINE S 21°58'E, 28.82 FT. THENCE S 21°58'E, 346.14 FT. THENCE S 87°25'E, 88.18 FT. THENCE S 87°25'E, 314.78 FT. TO THE WEST LINE OF STRABANE AVENUE, THENCE ALONG STRABANE AVENUE S 30°55'W, 184.30 FT. S 30°55'W, 184.30 FT. S 21°00'W, 100.33 FT. TO THE POINT OF BEGINNING.

CONTAINS 4.3 ACRES (MORE OR LESS)

PARCEL "C"

BEGINNING AT A POINT WHICH IS THE INTERSECTION OF THE EAST LINE OF STRABANE AVENUE AND THE NORTH R/W LINE OF CONRAIL, THENCE ALONG THE EAST LINE OF STRABANE AVENUE N 50°18'E, 66.86 FT. N 21°00'W, 81.40 FT. N 30°55'E, 133.33 FT. N 20°12'E, 111.22 FT. TO CHARLES CREEK, THENCE S 77°22'E, 81.13 FT. THENCE S 77°22'E, 189.31 FT. THENCE S 108°17'E, 187.79 FT. THENCE S 108°17'E, 127.22 FT. TO A POINT ON THE NORTH R/W LINE OF CONRAIL, THENCE ALONG SAID R/W LINE S 108°17'E, 428.09 FT. TO THE POINT OF BEGINNING.

CONTAINS 3.1 ACRES (MORE OR LESS)

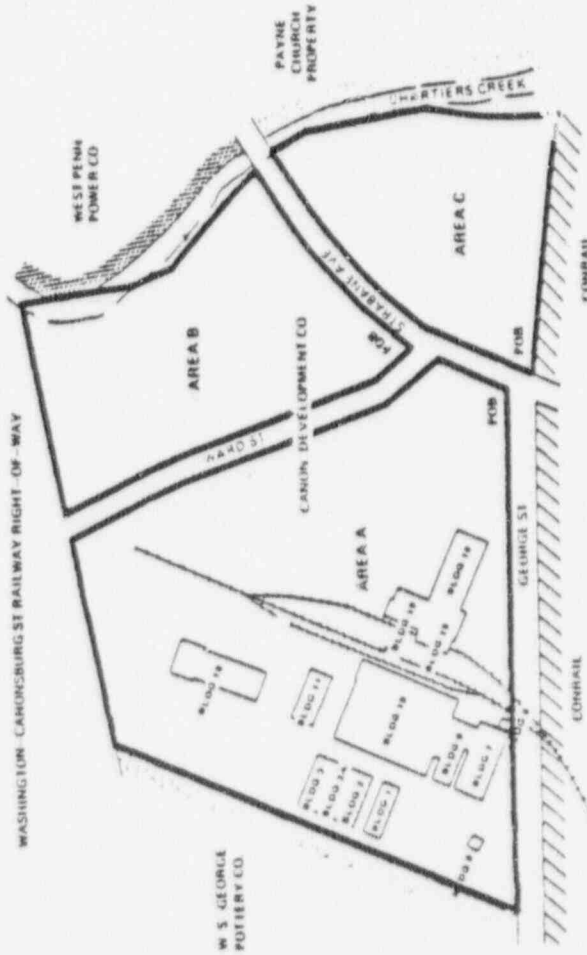

Prepared For
United States Department of Energy
 SITE DESCRIPTION & OWNERSHIPS
 Inactive Mill Tailing Sites
 CAMDENBURG, PENNSYLVANIA

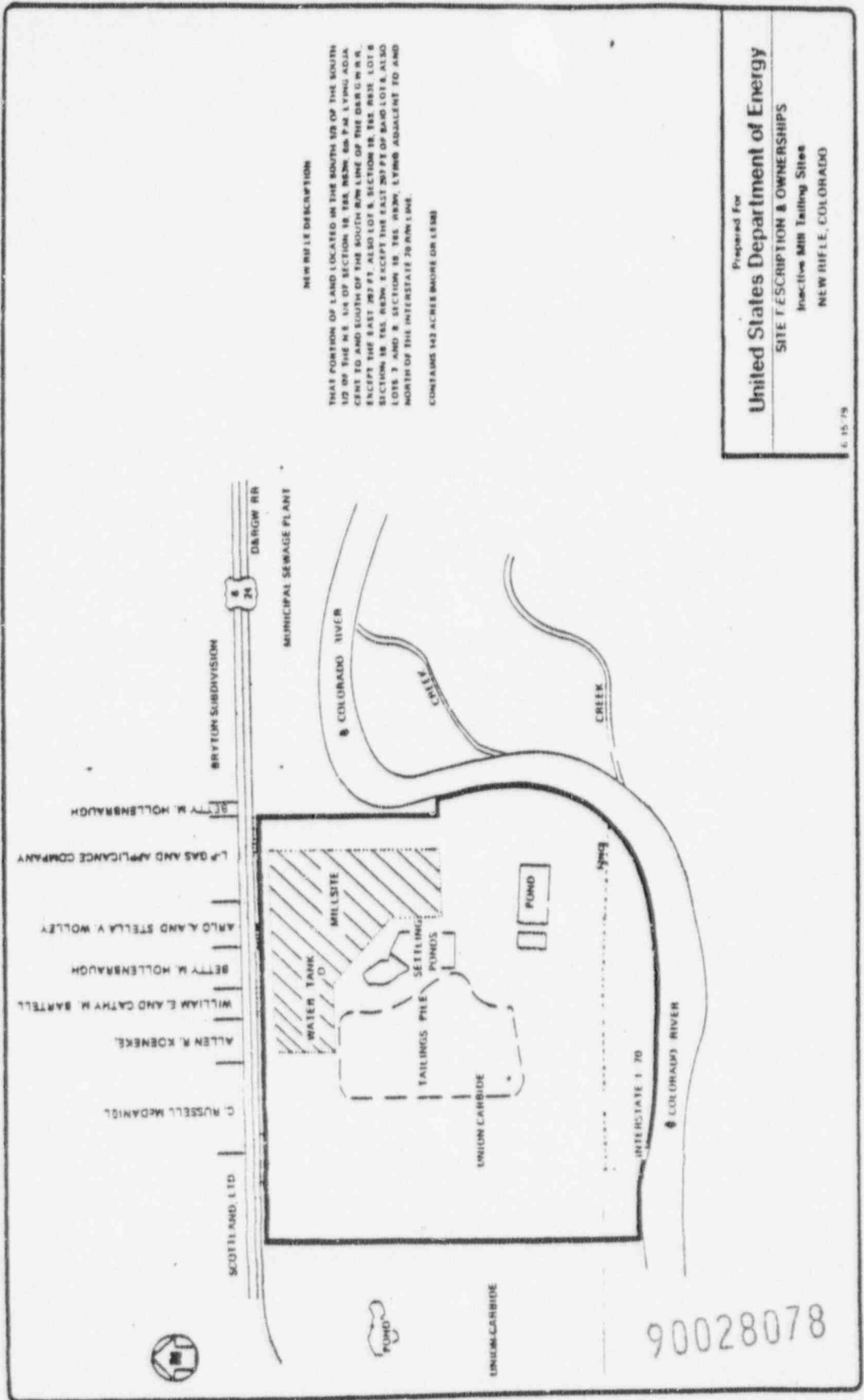

NEW RIVER DESCRIPTION

THAT PORTION OF LAND LOCATED ON THE SOUTH 1/4 OF THE SOUTH 1/4 OF THE N.E. 1/4 OF SECTION 18, T4S, R24E, S4M, LYING ADJACENT TO AND SOUTH OF THE SOUTH RIVER LINE OF THE BAR W & R, EXCEPT THE EAST 1/2 PT. ALSO LOT 8, SECTION 18, T4S, R24E, LOT 8, SECTION 18, T4S, R24E, EXCEPT THE EAST 1/2 PT. OF BAR LOT 8, ALSO LOTS 7 AND 8, SECTION 18, T4S, R24E, LYING ADJACENT TO AND NORTH OF THE INTERSTATE 70 R/W LINE.

CONTAINS 142 ACRES MORE OR LESS

Prepared For
United States Department of Energy
SITE DESCRIPTION & OWNERSHIPS
 Inactive Mill Tailings Sites
 NEW HIFLE, COLORADO

6.15.78

90028078

93023204



NATURITA SITE

PARCEL "A"

BEGINNING AT THE NO. 3 CORNER OF THE KENTUCKY PLACER MINING CLAIM NO. 2534, SAID POINT BEING N 27° 48' E, 250.24 FT MORE OR LESS FROM THE S.W. CORNER OF SECTION 14, T4N, R10W, N.M.P.M. SAID POINT ALSO BEING APPROXIMATELY ON THE EASTERLY RUN LINE OF COLORADO STATE HIGHWAY NO. 141, AND RUNNING THENCE NORTHERLY ALONG SAID COLORADO STATE HIGHWAY NO. 141 RUN LINE 822 FT MORE OR LESS, THENCE N 87° 05' 52" E, 827.3 FT MORE OR LESS TO THE WESTERLY BANK OF THE SAN MIGUEL RIVER, THENCE CONTINUING ALONG SAID WESTERLY BANK THE FOLLOWING COURSES AND DISTANCES: S 86° 19' 18" E, 260.51 FT; S 47° 24' E, 844.3 FT; S 40° 45' 40" E, 500 FT; S 34° 36' 18" E, 796 FT, THENCE LEAVING SAID BANK OF THE SAN MIGUEL RIVER S 64° 04' W, 150 FT MORE OR LESS TO THE SAID EASTERLY RUN LINE OF COLORADO STATE HIGHWAY NO. 141, THENCE NORTHERLY, ALONG SAID RUN LINE 1280 FT MORE OR LESS TO THE POINT OF BEGINNING.

CONTAINING 37 ACRES MORE OR LESS

PARCEL "B"

BEGINNING AT A POINT WHICH IS S 47° 24' E, 844.3 FT MORE OR LESS FROM THE CORNER NO. 1 OF THE KENTUCKY PLACER MINING CLAIM NO. 2534, SAID POINT BEING ON THE WESTERLY RUN LINE OF COLORADO STATE HIGHWAY NO. 141, SAID CORNER NO. 1 OF THE KENTUCKY PLACER MINING CLAIM NO. 2534 BEING N 84° 22' 28" E, 1848 FT MORE OR LESS FROM THE S.W. CORNER OF SECTION 14, T4N, R10W, N.M.P.M. AND RUNNING THENCE N 47° 24' E, 425 FT MORE OR LESS TO THE WESTERLY RUN LINE OF COLORADO STATE HIGHWAY NO. 141, THENCE SOUTHERLY ALONG SAID HIGHWAY RUN LINE 1000 FT MORE OR LESS TO THE POINT OF BEGINNING.

CONTAINING 19 ACRES MORE OR LESS

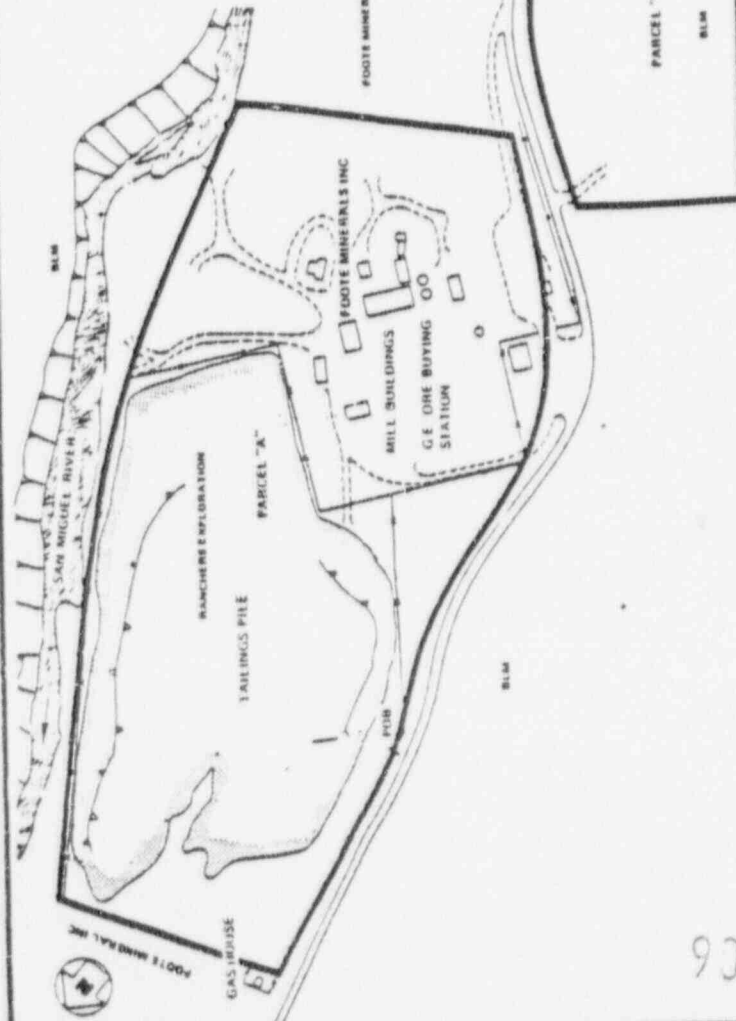

United States Department of Energy
SITE DESCRIPTION & OWNERSHIP
Inactive MIB Tailing Sites
NATURITA, COLORADO

90028080

93023206

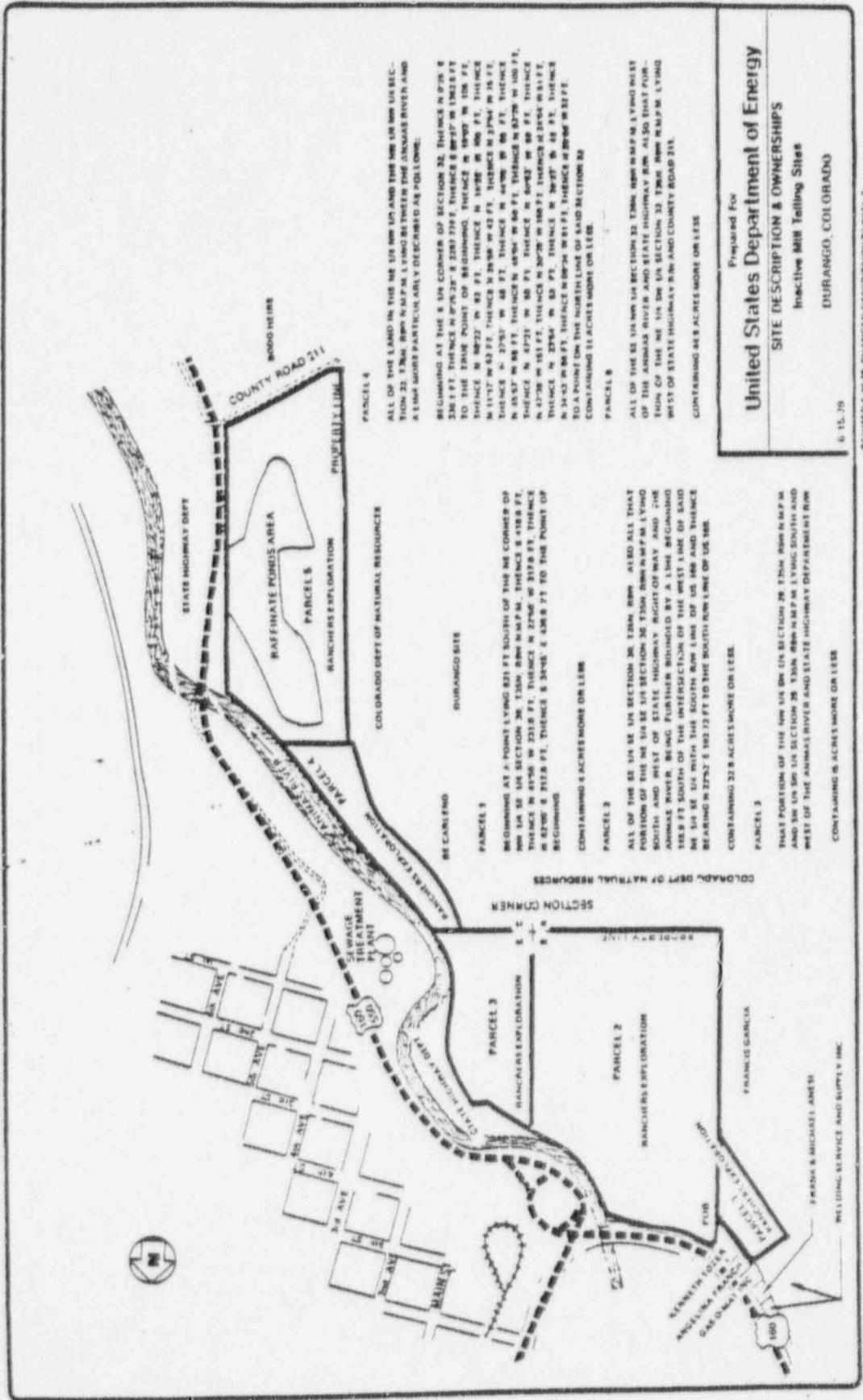

90028082

02022200

United States Department of Energy

SITE DESCRIPTION & OWNERSHIPS

Inactive Mill Tailings Sites

DURANGO, COLORADO

6-11-79

REVISED 6-20-78 CHANGED DESCRIPTION PARCEL 5

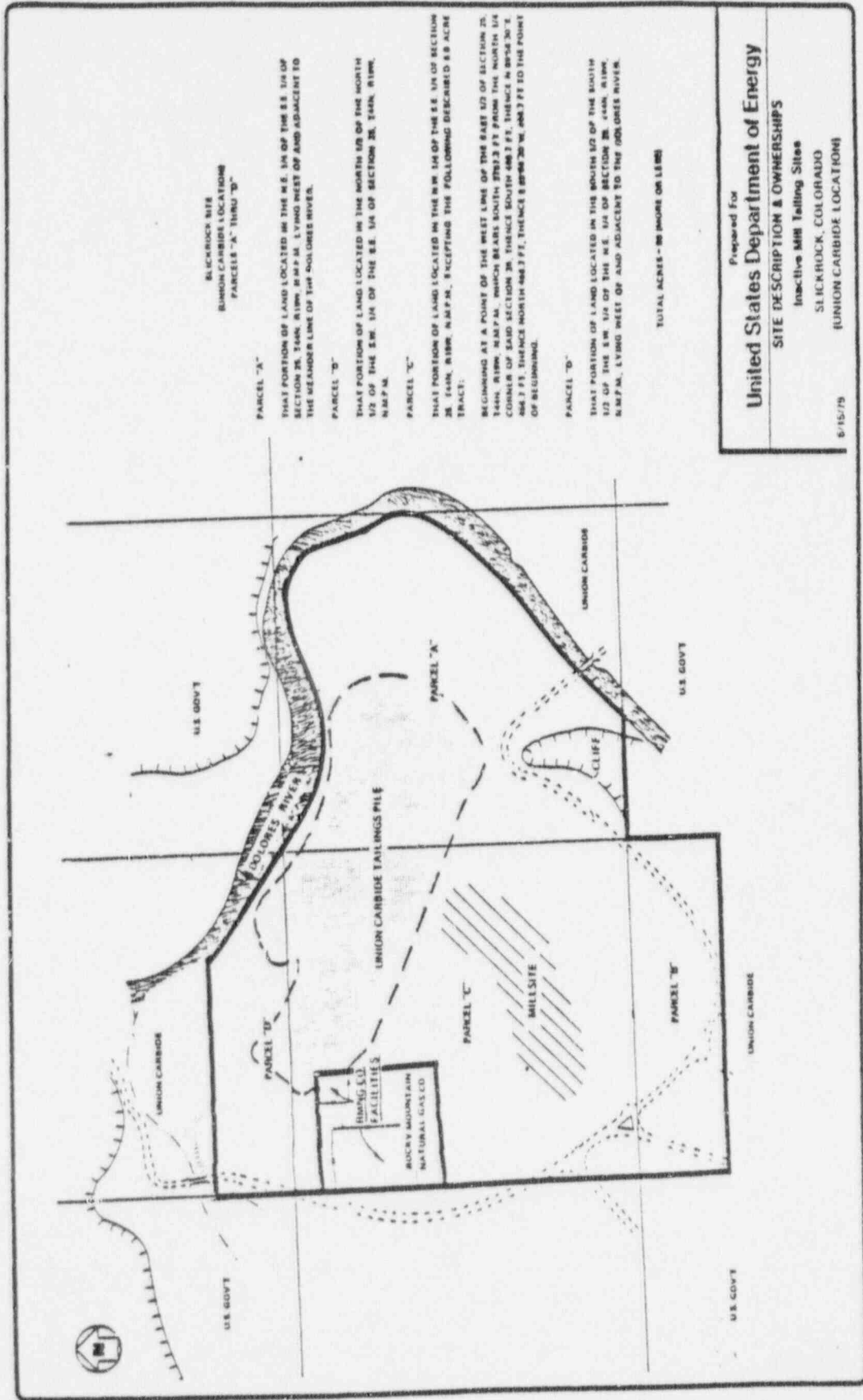

Slickrock Site
Union Carbide Locations
Parcels "A" thru "D"

PARCEL "A"

THAT PORTION OF LAND LOCATED IN THE N.E. 1/4 OF THE S.E. 1/4 OF SECTION 25, T44N, R18W, N.M.P.M. LYING WEST OF AND ADJACENT TO THE MEANDER LINE OF THE DOLORES RIVER.

PARCEL "B"

THAT PORTION OF LAND LOCATED IN THE NORTH 1/2 OF THE NORTH 1/2 OF THE S.W. 1/4 OF THE S.E. 1/4 OF SECTION 25, T44N, R18W, N.M.P.M.

PARCEL "C"

THAT PORTION OF LAND LOCATED IN THE N.W. 1/4 OF THE S.E. 1/4 OF SECTION 25, T44N, R18W, N.M.P.M., EXCEPTING THE FOLLOWING DESCRIBED 6.9 ACRE TRACT:

BEGINNING AT A POINT OF THE WEST LINE OF THE EAST 1/2 OF SECTION 25, T44N, R18W, N.M.P.M., WHICH BEARS SOUTH 279.3 FT FROM THE NORTH 1/4 CORNER OF SAID SECTION 25, THENCE SOUTH 488.3 FT, THENCE N 89°54'30" E 488.3 FT, THENCE NORTH 488.3 FT, THENCE S 89°54'30" W, 488.3 FT TO THE POINT OF BEGINNING.

PARCEL "D"

THAT PORTION OF LAND LOCATED IN THE NORTH 1/2 OF THE NORTH 1/2 OF THE S.W. 1/4 OF THE S.E. 1/4 OF SECTION 25, T44N, R18W, N.M.P.M., LYING WEST OF AND ADJACENT TO THE DOLORES RIVER.

TOTAL ACRES - 86.0000 OR LESS

Prepared For
United States Department of Energy

SITE DESCRIPTION & OWNERSHIPS

Inactive MM Tailings Sites

Slickrock, Colorado

Union Carbide Location

5/15/79

90028083

93023207

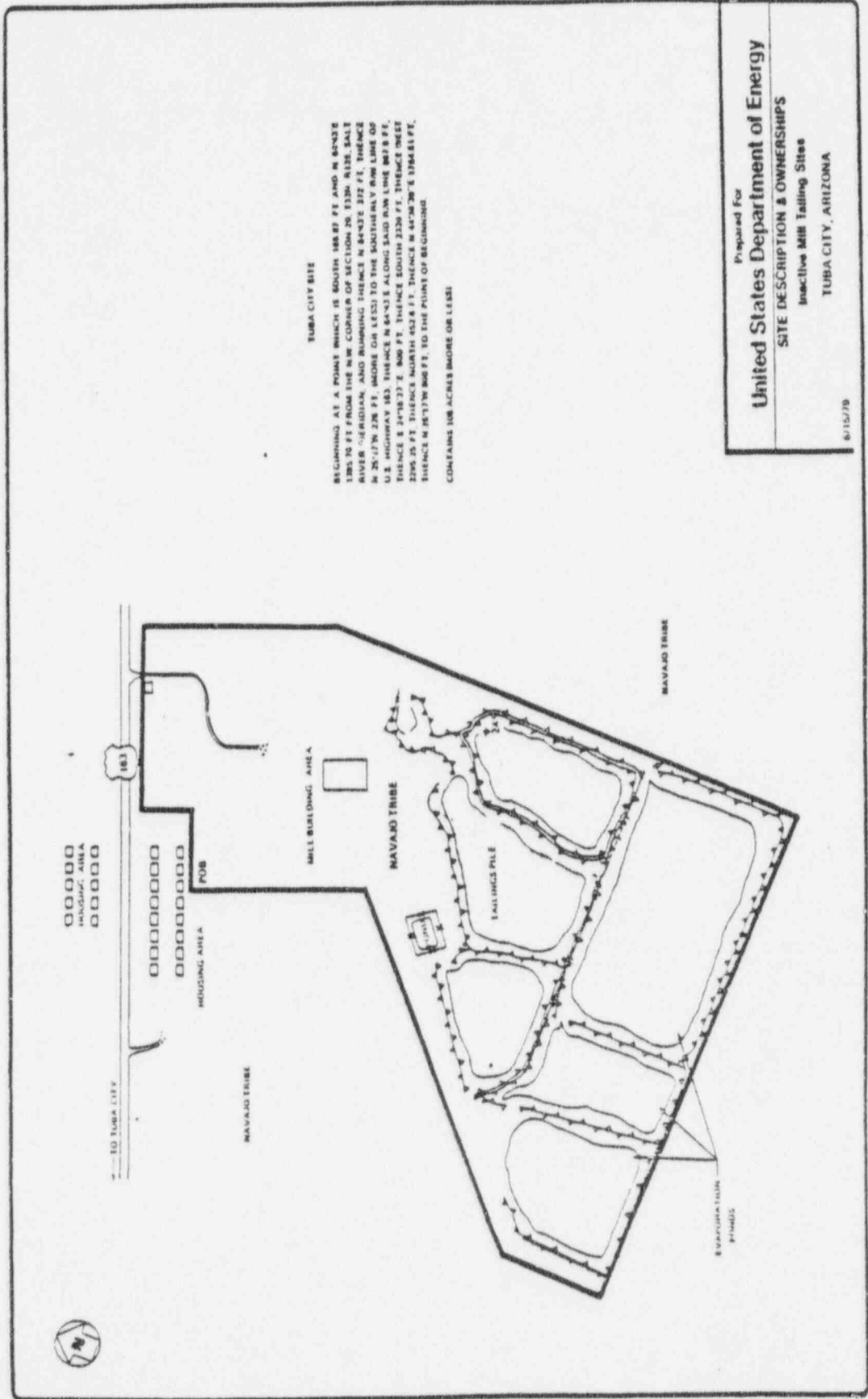

90028084 75023210

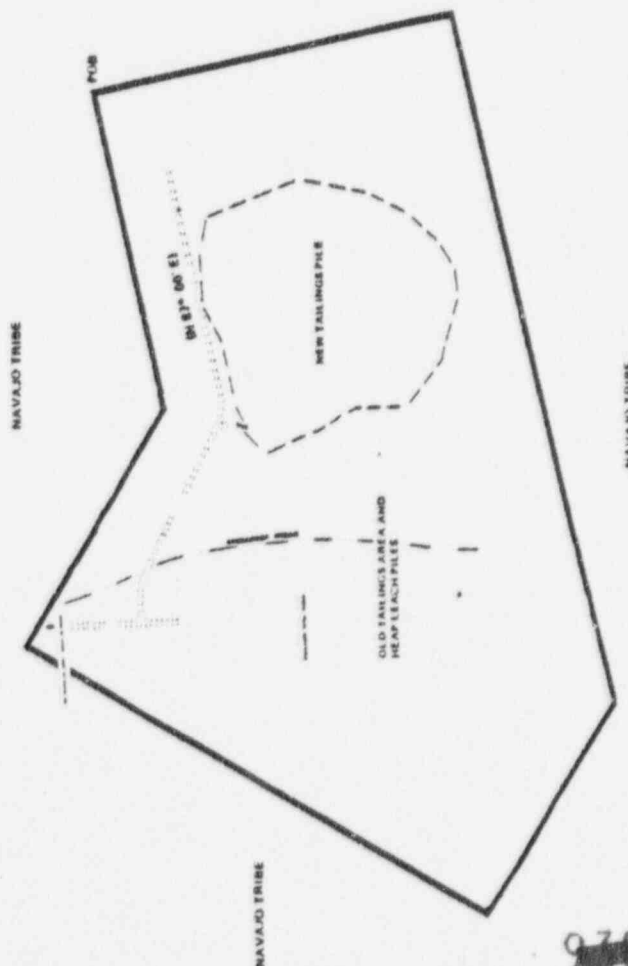

HAIRY ABBOTT & SON

BEGINNING AT A POINT WHICH IS N 50°E, 1625 FT FROM AN ARIZONA STATE
 PUBLIC LAND SURVEY CORNER TO THE CENTER OF THE "NEW TANKS"
 TRACT, AS N 216°00' E - 287'300 AND RUNNING THENCE S 73°E, 1308 FT,
 THENCE S 87°W, 2841'84 FT; THENCE N 50°E, 884'81 FT; THENCE N 40°E, 1650 FT;
 THENCE S 80°E, 1741 FT; THENCE N 50°E, 1160 FT TO THE POINT OF BEGINNING.
 CONTAINS 501 ACRES MORE OR LESS.

NOTE:

"CENTER OF EALINGS FILE LOCATED BY ARIZONA DEPARTMENT OF HIGHWAYS FROM CONTRAILED AERIAL PHOTOGRAPHY SAID POINT LIVING BEING 1430 FT (40M) OR LESS FROM THE CORNER RIGID CONTROL MONUMENT.

REV 6 29/79

Prepared for

United States Department of Energy

SITE DESCRIPTION & OWNERSHIPS

Inactive Mail Telling Sites

MONUMENT VALLEY, ARIZONA

617 51 9

~~93023211~~

90028085



REV 6/21/79

Prepared For
United States Department of Energy
SITE DESCRIPTION & OWNERSHIP
 Inactive Mill Tailing Site
 MEXICAN HAT, UTAH

6-15-79

90028086

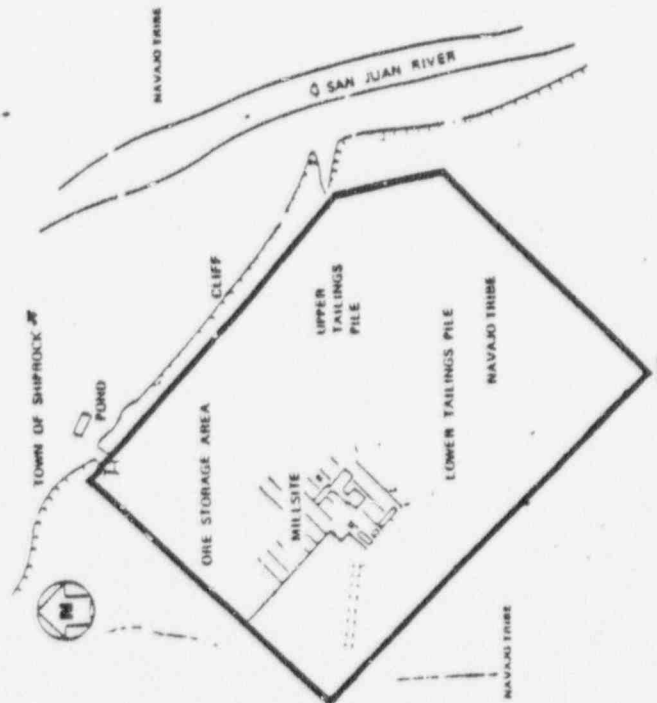

SHIPROCK SITE

BEGINNING AT A POINT WHICH LIES 141°32'20" N, 120°33' FT FROM THE
S.E. CORNER OF SECTION 34, T8N R10W, N.M.P.M. AND RUNNING THENCE
S44°00' W, 2925 FT, THENCE S44°00' E, 108,331 FT, THENCE S87°00' W,
2319.3 FT, THENCE S74°43' E, 116 FT, THENCE S41°00' W, 1879 FT TO THE
POINT OF BEGINNING.

CONTAINING 143.8 ACRES (MORE OR LESS)

Prepared For

United States Department of Energy

SITE DESCRIPTION & OWNERSHIP'S

Inactive Mill Tailings Sites

SHIPROCK, NEW MEXICO

6/15/79

90028087

751023213

[illegible]

CC-BY-NC-ND 4.0 International license.

REV 0/22/79

Prepared For

United States Department of Energy

SITE DESCRIPTION & OWNERSHIPS

Inertive Mill Yelling Sites

SALT LAKE CITY, UTAH

6/15/79



UNITED STATES
NUCLEAR REGULATORY COMMISSION
WASHINGTON, D.C. 20555

OFFICE OF THE
CHAIRMAN

Director, Office of Nuclear Material
Safety and Safeguards

DELEGATION OF AUTHORITY

In addition to the authority delegated in the Delegation of Authority dated June 16, 1975 signed by Marcus A. Rowden, then Chairman of the Commission, and subject to the conditions therein, you are hereby delegated authority to:

18. pursuant to Title I of the Uranium Mill Tailings Radiation Control Act of 1978, provide advice, consultation, and concurrence as required in all aspects of Department of Energy actions implementing Title I to prevent or minimize hazards associated with designated inactive mill tailings sites.

The June 16, 1976 Delegation of Authority is amended by inserting this additional authority as paragraph 18.

Joseph M. Hendrie
Chairman

Enclosure 2

90028089

~~75023215~~

93023215