

RADIATION PROTECTION CONSULTANTS, LTD.

Serving Radiology, Nuclear Medicine, Therapy and Industrial Facilities Since 1968
710 EAST OGDEN AVENUE, SUITE 106
NAPERVILLE, ILLINOIS 60540
PHONE: (312) 369-6488

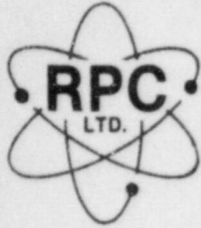

September 9, 1983

William J. Adam, PhD.
Licensing Section
U.S. Nuclear Regulatory Commission
799 Roosevelt Road
Glen Ellyn, Illinois 60137

REFERENCE NUMBER: CONTROL NO. 75512

Dear Dr. Adam:

In reference to our recent conversation regarding MacNeal Memorial Hospital, I am submitting the following information:

1. The supply and exhaust air flow rate for each imaging room and the hot lab is as follows:
 - a. Gamma Camera Room #1 - exhaust rate - 845 CFM
supply rate - 770 CFM
 - b. Room #2 - exhaust rate - 845 CFM
supply rate - 770 CFM
 - c. Room #3 - exhaust rate -1645 CFM
supply rate -1570 CFM
 - d. Hot Lab - exhaust rate -1140 CFM
supply rate -1070 CFM

The exhaust duct work from these rooms and from the fume hood located in the hot lab exhaust directly to the outside. There is no recirculation of air. Be advised that the air flow rates will be checked on a semi-annual basis, using a calibrated air flow volumeter to verify readings.

U.S. Nuclear Regulatory Commission
Dr. William J. Adam
September 9, 1983
- Page 2 -

2. Please see the attached diagram, which contains more detailed information regarding the new Nuclear Medicine facility.
3. As per our discussion, please delete the statement in the original amendment application stating we would submit a close-out survey to you upon completion. The copy of the close-out survey information will be kept on file for review by your agency during routine inspection. Information relating to the close-out survey, such as individuals performing the survey, instrumentation used, as well as the results, will be included in that record.

Should you have any other questions or if I can be of any additional assistance to you, please contact me at your convenience.

Very truly yours,
FOR MACNEAL MEMORIAL HOSPITAL

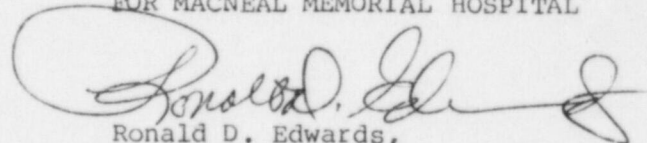
Ronald D. Edwards,
Health Physicist

RDE:pam
enclosure

xc: MacNeal Memorial Hospital

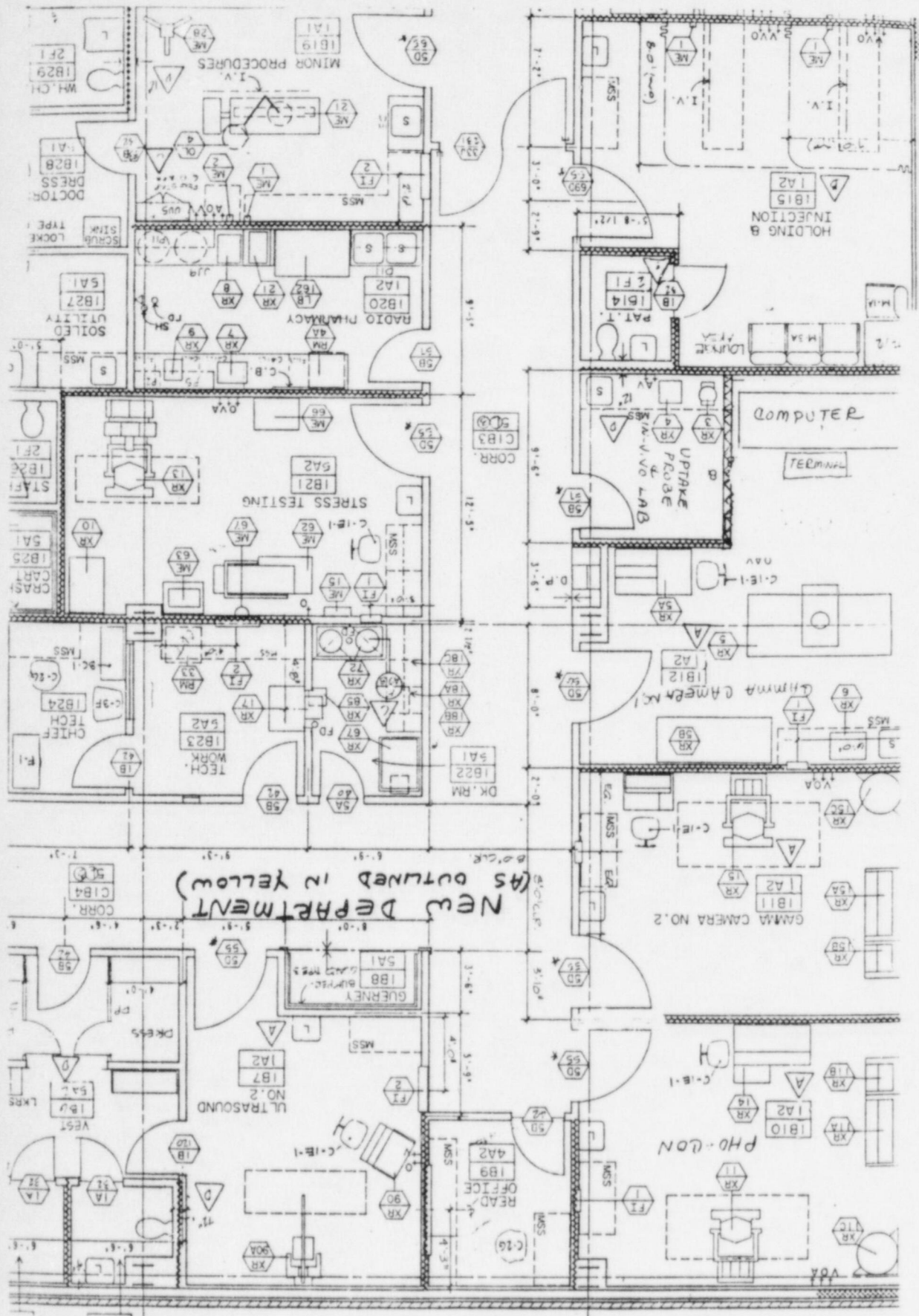

NEW DEPARTMENT
(As outlined in yellow)

NEW DEPT.
HALL 101