

Westinghouse
Electric Corporation

Lamp Divisions

One Westinghouse Plaza
Bloomfield New Jersey 07003

March 20, 1981

Mr. J. A. Jones
U. S. Nuclear Regulatory Commission
Materials Licensing Branch
Division of Fuel Cycle and Material Safety
Washington, D. C. 20555

Dear Mr. Jones:

The following is our final report of the decontamination efforts taken in our Building 7 basement and will also serve to update our report of November 12, 1980.

As stated in NRC's report of December 22, 1980, two closeout inspections were conducted by your King of Prussia office on November 21 and December 2, 1980. While some disagreement arose as to sample results taken during these inspections, Westinghouse believed and verified their sample results were correct and reproducible.

In a telephone conversation with your office on January 12, 1981, Westinghouse agreed to accept NRC's assumption that further excavation would achieve the 35 pico-curie per gram level that NRC had established.

On January 13-14, 1981 our decontamination contractor, Radiac Research Corporation, removed another 6" to 8" of soil throughout Excavation #1. Material removed was placed in 21 fifty-five gallon DOT approved metal drums for burial at an NRC approved disposal site.

The drain line identified in NRC's report of December 22 was removed and its floor drain plugged with concrete.

A second abandoned drain line (not previously identified) was also cleaned and plugged with concrete.

A 10" poured concrete sump in the excavation was back-filled with 6" of clean sand and capped with 4" of concrete. Westinghouse felt that this would be in keeping with the treatment afforded the sump bottom previously identified in our report of November 12, 1980.

Sampling Plan -

Surface samples were taken at 8 locations identified by letters on Attachment #1. Samples were obtained by breaking shale rock and subsurface soil with a pick. Samples were then dried, lightly crushed and screened to remove debris.

Samples were analyzed by the x-ray fluorescence method using a Phillips Model 1410 x-ray instrument.

COPIES SENT TO OFFICE OF
INSPECTION AND ENFORCEMENT

Sample results were as follows:

<u>Location</u>	<u>Pico-curies/GM</u>
A	0
B	0
C	54
D	75
E	54
F	116
G	0
H	0
	<hr/>
MEAN	37 ± 13.6 pico-curies/GM

A request for a post decontamination survey was made to your King of Prussia office on January 20, 1981 and a representative inspected the site on January 29, 1981. Samples were taken by your representative and their results apparently agreed with those reported by Westinghouse.

On February 3, 1981 your office reported by telephone that NRC had accepted as satisfactory the decontamination of the Building 7 basement and agreed that Westinghouse could begin restoration of its facility.

Since obtaining the release for restoration, we have accomplished the following:

1. All excavations were filled with clean sand fill and covered with 4" - 6" of concrete to the original floor level. These filled areas will be covered with new floor tile.
2. All basement surfaces were thoroughly cleaned by vacuuming, damp wiping and/or wet mopping to remove dust, etc. which accumulated during the decontamination effort.
3. A radiation survey of the area using a Ludlum Model 12S micro-R-meter indicates radiation levels to be less than .1 mr/hr throughout the area. (See Attachment #2)

Closing Remarks -

1. To date, 110 fifty-five gallon barrels of scrap material and soil have been removed from the basement facility. Each barrel contained an estimated 60 micro-curie of natural uranium.
2. To date, Westinghouse has expended approximately \$45,700 in its efforts to comply with NRC's guidelines.
3. We believe the Building 7 basement area now meets the conditions of NRC's "Guidelines For Decontamination of Facilities and Equipment Prior to Release For Unrestricted Use" and poses no adverse radiation hazard to its employees or members of the general public.

4. Westinghouse believes it has fulfilled its obligation for decontaminating its facility to a level suitable for unrestricted use and requests a copy of a statement or report of NRC findings and results indicating that they have found the decontamination of the basement area satisfactory.

Very truly yours,



G. W. Goodrow
Division Administrator
Accident Prevention

/bg

MAIN DRAINS

Letters A Thru **0528**
Sample Locations

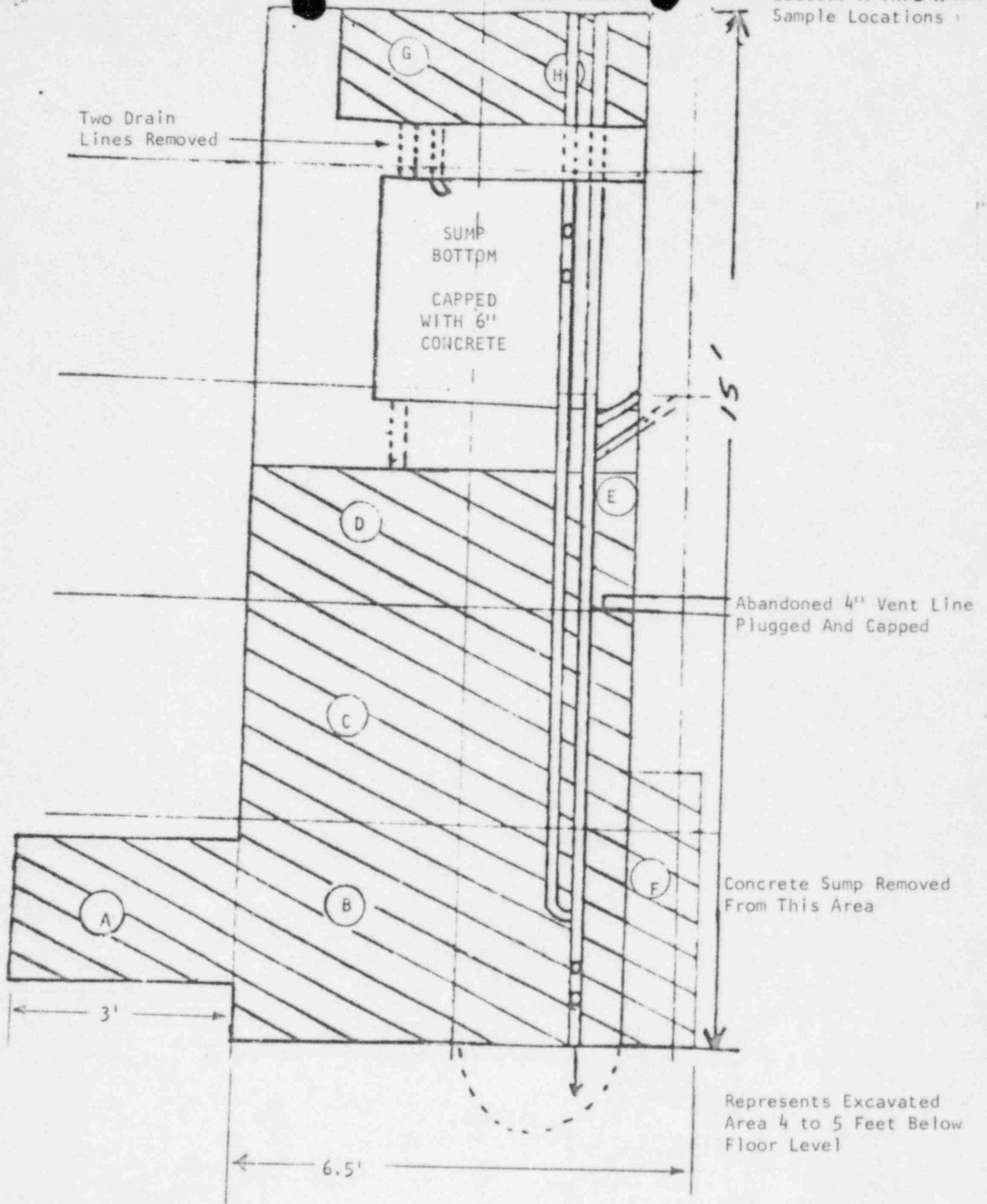

C-SK-92980KP

SUB

N

SYM.

(L)
(F)
(G)
(H)

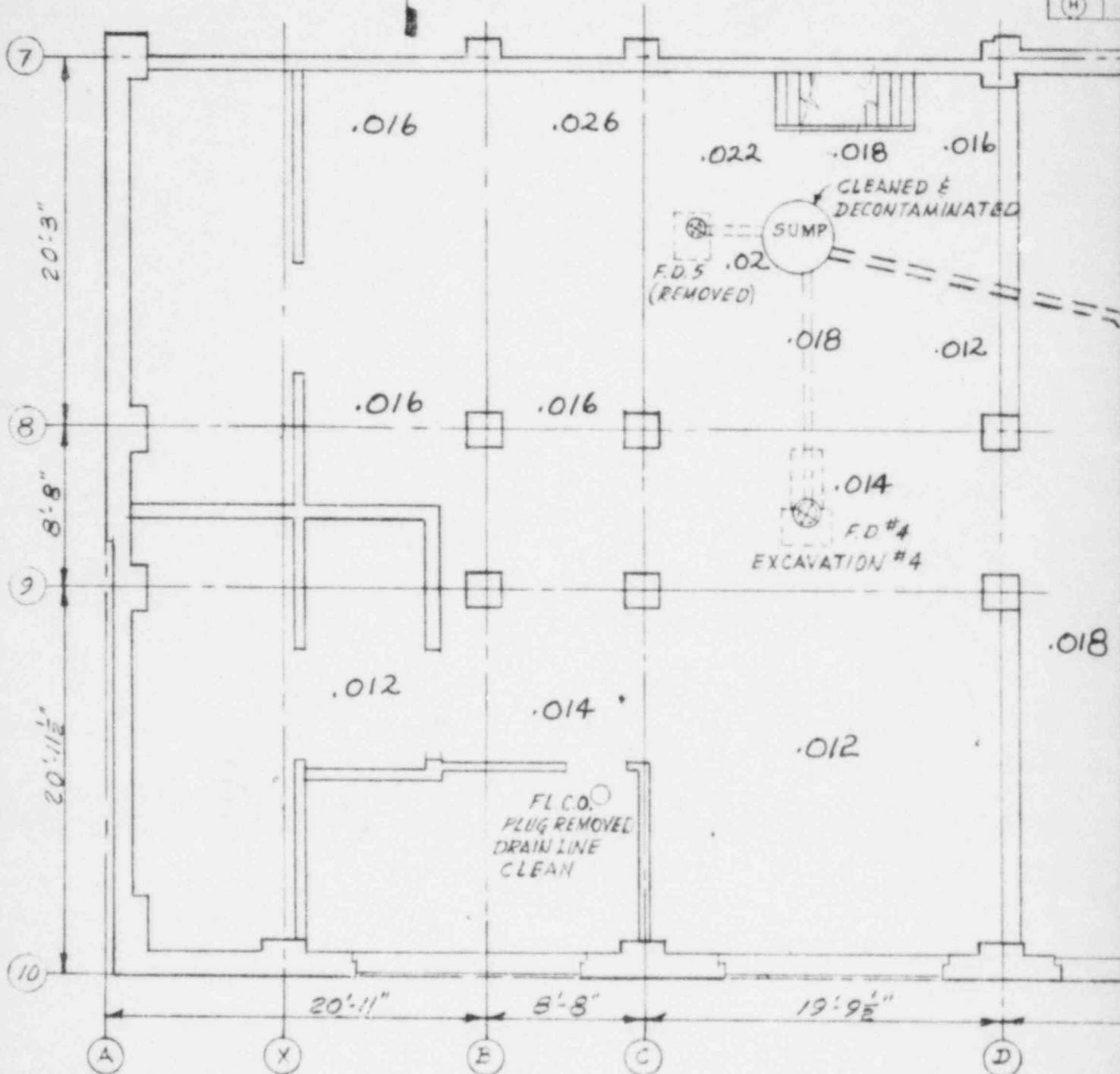

⊗ ORIGINAL FLOOR DRAINS F.D. #1, 2 & 3 REMOVED DURING 1ST DECONTAMINATION
F.D. #4 & 5 " " 2ND " "

— OUTLINES EXCAVATION AFTER 1ST DECONTAMINATION EFFORT
--- OUTLINES EXTENT OF EXCAVATION AFTER 2ND DECONTAMINATION EFFORT
PDS LOCATION OF AREAS IDENTIFIED DURING NRC POST DECONTAMINATION SURVEY

UNLESS OTHERWISE SPECIFIED:

- (1) PLACE DEC. ± .05 FINISH 125/
(2) PLACE DEC. ± .02 BREAK SHARP EDGES
(3) PLACE DEC. ± .005 .02 MAX. RADIUS
ANGLES ± 0°30' ALL THOS. CLASS 2

PATTERN

MAT

DRAWN K. PFEIFFER

DAT

CHECKED

DAT

APPROVED

DAT

SCA

SUB-ASSEMBLY REQ. SUB-ASSEMBLY REQ.

810408D689-01

N. NO.	ALTERED BY	DATE	SYM.	N. NO.	ALTERED BY	DATE	ITEM NO.	NO. REQ.	DESCRIPTION
			(A)						
			(B)						
			(C)						
			(D)						

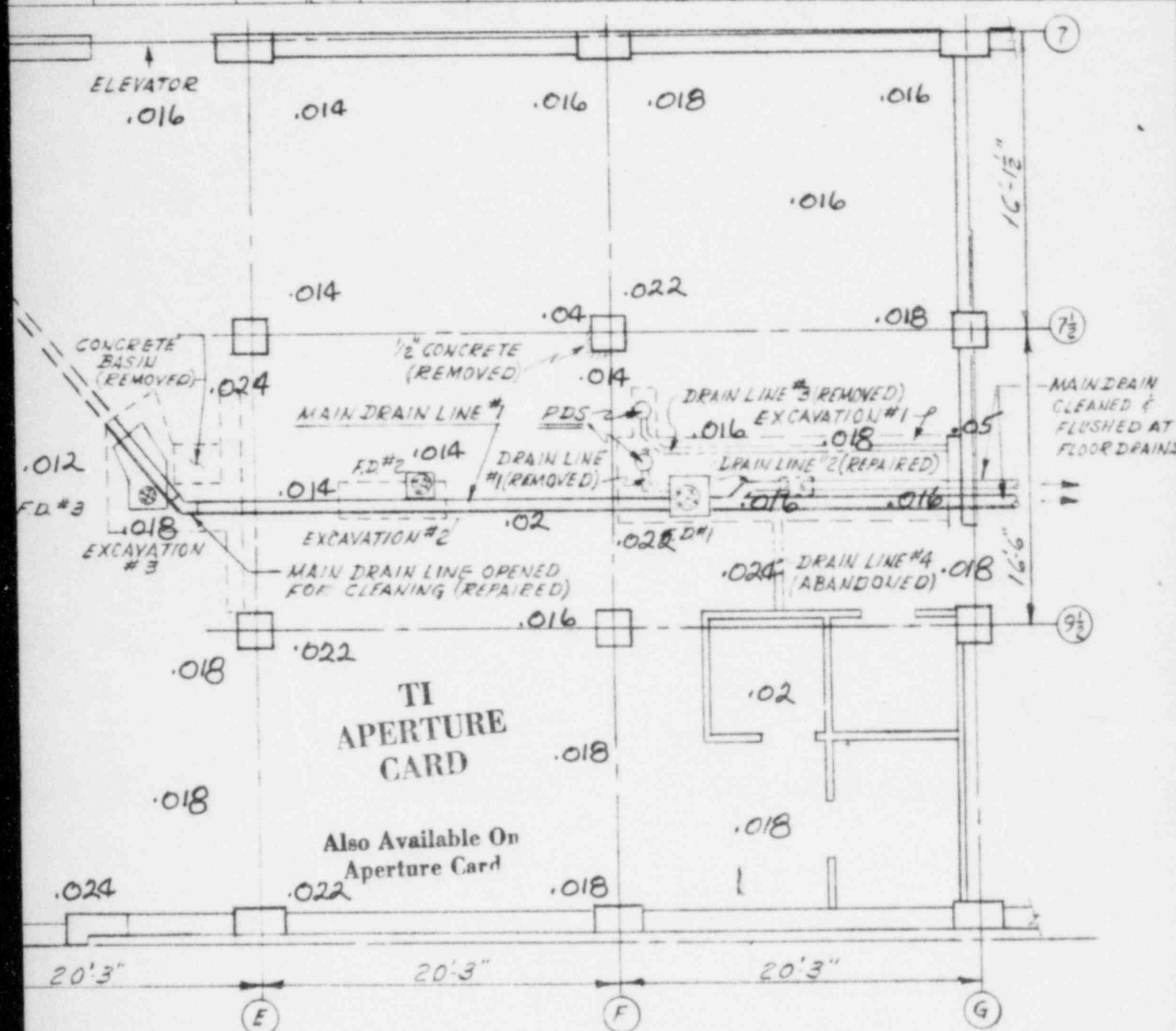

AREA SURVEY 3/17/81
 FIGURES IN RED = MR/HR AT FLOOR SURFACE.
 AFTER FINAL CLEANING
 BACKGROUND = .016 MR/HR.

SHEET	ITEM
OF	

SERIAL NO.	DESCRIPTION OF MATERIAL	MACHINE	PARTIAL FLOOR PLAN BLDG. N° 7
9-27-80	 PROPRIETARY INFORMATION OF Westinghouse Electric Corporation LAMP DIVISION EQUIPMENT ENGINEERING BLOOMFIELD, NEW JERSEY	PART	BASEMENT
			C-SK-92980-KP