

Monsanto

CORPORATE RESEARCH AND DEVELOPMENT STAFF

Monsanto Company
700 Chesterfield Village Parkway
St. Louis, Missouri 63198
Phone: (314) 694-1000

November 7, 1985

Ms. B. J. Holt
Materials Licensing Section
U.S. Nuclear Regulatory Commission
Region III, Building 4
799 Roosevelt Road
Glen Ellyn, IL 60317

Dear Ms. Holt:

Enclosed are the complete results of our exit survey of the Creve Coeur site. Please note: "This Is Additional Information, Not a New Amendment Request."

This closeout survey is for all laboratories at the Creve Coeur site where radioactive materials were used or stored. Specifically, labs U403-U420 and labs T413, T414, T415 and T417 were surveyed. A total of 274 swipes were done in these 22 laboratories. Diagrams of the laboratories are enclosed with the locations of the swipes indicated. Twenty-one of the swipes showed greater than 100 dpm/100 cm². After wiping these vials with ethanol to reduce static, only four vials showed greater than 100 dpm/100 cm². The areas corresponding to these swipes were decontaminated to less than 100 dpm/100 cm². Also, all laboratories were monitored using a Geiger counter. No readings above background were seen.

Surveys done in March, 1985, were conducted by Ned Siegel, David McPherson, Keith O'Connell, John Minnerly, Geoff Tombaugh and Charles Rodi. Swipes were counted in a Beckman LS9800 scintillation counter calibrated March 4, 1985. Monitoring by Geiger counter was done using an Eberline E-120 (calibrated January 11, 1985). The survey done in September, 1985, was conducted by Ron Frazier and Charles Rodi in laboratories T413, T415 and T417. Swipes were counted in a Beckman LS9800 scintillation counter calibrated September 6, 1985. Monitoring by Geiger counter was done using an Eberline E-120 calibrated July 9, 1985.

RECEIVED BY LFMB

Date 11/18/85

LOG Nov 9 III

CONTROL NO.

80184

80115

RECEIVED

NOV 12 1985

REGION III

8602200052 851217

REQ3 LIC30

24-19531-01

FEE EXEMPT

NOV 12 1985

PDR

As indicated on the diagrams, sinks and air hoods were included in the swipe tests. Specifically, swipes were done on areas immediately surrounding drains and vents. No indication of contamination was seen in any instance. Since no radioactive materials were ever disposed of down drains or vented through hoods (in keeping with Monsanto policy) we are confident that background levels seen for the sink and air hood swipes are indicative that no contamination exists in areas of the drains and ductwork that are inaccessible to our monitoring.

In summary, all Creve Coeur facilities have now been vacated, surveyed, and where necessary, decontaminated. We now request that these facilities be released for unrestricted use.

If there are any questions regarding the closeout survey, please contact me. Thank you.

Sincerely

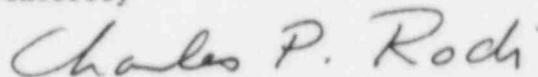
A handwritten signature in cursive script that reads "Charles P. Rodi".

Charles P. Rodi, Ph.D.
Senior Research Biologist
Radiation Safety Officer
Biological Sciences

Enclosure

B110704

2 " hot spot

Close out survey

JC Minnerly Supervisor U4

<u>No.</u>	<u>Location</u>	<u>No.</u>	<u>Location</u>
1	Gel Area - U420	21	Ogden sink
2	U420 door	22	Ogden/Hansen bench
3	Minnerly bench	23	U416 door
4	Minnerly sink	24	Wiegand bench
5	Moore bench	25	Wiegand bench
6	Davies bench	26	Davy bench
7	Davies load	27	Davy sink
8	U418 door	28	Harding sink bench
9	Hironaka sink	29	U416 door
10	Hironaka bench	30	Rodi bench
11	Shah sink	31	Gel dryer area
12	Shah/Rochester bench	32	Tom Saugh bench
13	U418 door	33	Manning sink
14	Cold room sink	34	Manning bench
15	Egg. fuge area	35	U414 door
16	Cold room door - inside	36	McWilliams bench
17	Cold room door - outside	37	Funkes-Shippy bench
18	Hippenmeyer sink	38	U414 door
19	Hippenmeyer bench	39	Levine sink
20	^{U418} U416 door	40	Seetharam bench

Note - "door" refers door handle

March

U414
 U416
 U418
 U420

40 Swipes

Gel Area
~280 cpm

U420	1 X				2
	3	4	5		8
	6			Hand 7	
U418	9	10			13
	11		12		
	14	15		16	29
U416	18	19			23
	20	22			
	25	24			27
U414	26	28			
	30	31			35
	32	34			
U414	36	37			38
	39	40			

USER: 2 ID:JCMINN

PRESET TIME: 1.00

SAMPLE REPEAT: 1 CYCLE REPEAT: 1 SCR:N RS232:N

H#: 1 AQC:N QCF:N

CHANNEL 1-LL: 0 UL: 400 2SIGMA: 2.00 BKG SUB: 0.00 BKG 2SIG: 0.00 LSR:

CHANNEL 2-LL: 0 UL: 670 2SIGMA: 2.00 BKG SUB: 0.00 BKG 2SIG: 0.00 LSR:

CHANNEL 3-LL: 0 UL: 1000 2SIGMA: 2.00 BKG SUB: 0.00 BKG 2SIG: 0.00 LSR:

DATA CALC: CPM, UNKNOWN REPLICATES: 1 NORM FACTOR:Q 1.00000

HALF LIFE(DAYS):N

SAM	CPM1	CPM2	CPM3	TIME	AVG H#
1	28.00	171.00	290.00	1.00	125.0
2	13.00	26.00	40.00	1.00	86.0
3	13.00	26.00	38.00	1.00	109.0
4	15.00	25.00	37.00	1.00	96.0
5	7.00	21.00	36.00	1.00	135.0
6	8.00	28.00	39.00	1.00	144.0
7	20.00	32.00	39.00	1.00	132.0
8	10.00	24.00	44.00	1.00	86.0
9	16.00	31.00	45.00	1.00	117.0
10	16.00	34.00	49.00	1.00	103.0
11	20.00	34.00	48.00	1.00	116.0
12	15.00	34.00	42.00	1.00	140.0
13	16.00	34.00	66.00	1.00	91.0
14	12.00	27.00	40.00	1.00	90.0
15	15.00	32.00	47.00	1.00	103.0
16	18.00	63.00	134.00	1.00	89.0
17	22.00	52.00	71.00	1.00	86.0
18	22.00	39.00	57.00	1.00	127.0
19	21.00	36.00	58.00	1.00	107.0
20	20.00	35.00	55.00	1.00	87.0
21	14.00	29.00	37.00	1.00	102.0
22	41.00	58.00	73.00	1.00	112.0
23	14.00	34.00	76.00	1.00	96.0
24	9.00	17.00	32.00	1.00	101.0
25	12.00	22.00	36.00	1.00	150.0
26	9.00	19.00	29.00	1.00	101.0
27	16.00	23.00	30.00	1.00	122.0
28	8.00	28.00	37.00	1.00	124.0
29	16.00	37.00	57.00	1.00	87.0
30	14.00	30.00	44.00	1.00	93.0
31	10.00	24.00	39.00	1.00	103.0
32	12.00	21.00	30.00	1.00	105.0
33	14.00	28.00	47.00	1.00	97.0
34	12.00	29.00	42.00	1.00	104.0
35	16.00	29.00	46.00	1.00	84.0
36	13.00	31.00	46.00	1.00	125.0
37	8.00	22.00	41.00	1.00	109.0
38	12.00	27.00	39.00	1.00	82.0
39	15.00	30.00	43.00	1.00	114.0
40	11.00	17.00	24.00	1.00	119.0

ERF

R: 2 ID:JCMIN 4 PRESET TIME: 1.00
SAMPLE REPEAT: 1 CYCLE REPEAT: 1 SCR:N RS232:N
H#: 1 AQC:N QCF:N

CHANNEL 1-LL: 0 UL: 400 2SIGMA: 0.50 BKG SUB: 0.00 BKG 2SIG: 0.00 LSR:
CHANNEL 2-LL: 0 UL: 670 2SIGMA: 0.50 BKG SUB: 0.00 BKG 2SIG: 0.00 LSR:
CHANNEL 3-LL: 0 UL: 1000 2SIGMA: 0.50 BKG SUB: 0.00 BKG 2SIG: 0.00 LSR:
DATA CALC: CPM, UNKNOWN REPLICATES: 1 NORM FACTOR: 0 1.00000
HALF LIFE(DAYS):N

2nd swipe test

SAM	CPM1	CPM2	CPM3	TIME	AVG H#
1	21.00	34.00	52.00	1.00	75.0
2	16.00	31.00	49.00	1.00	74.0
3	14.00	24.00	34.00	1.00	74.0
4	19.00	37.00	56.00	1.00	71.0
5					

} area #1
- area #16

ERF

100

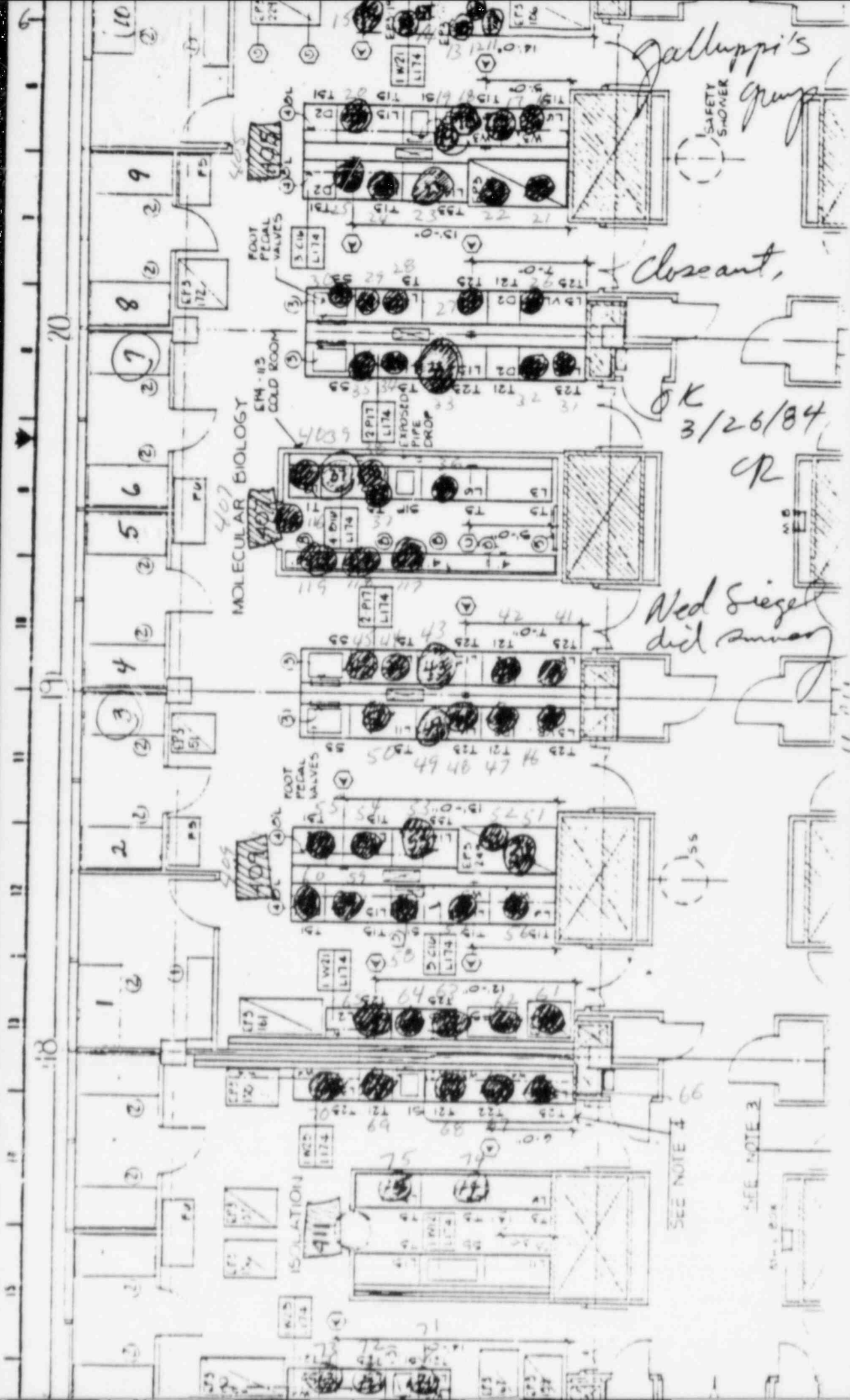

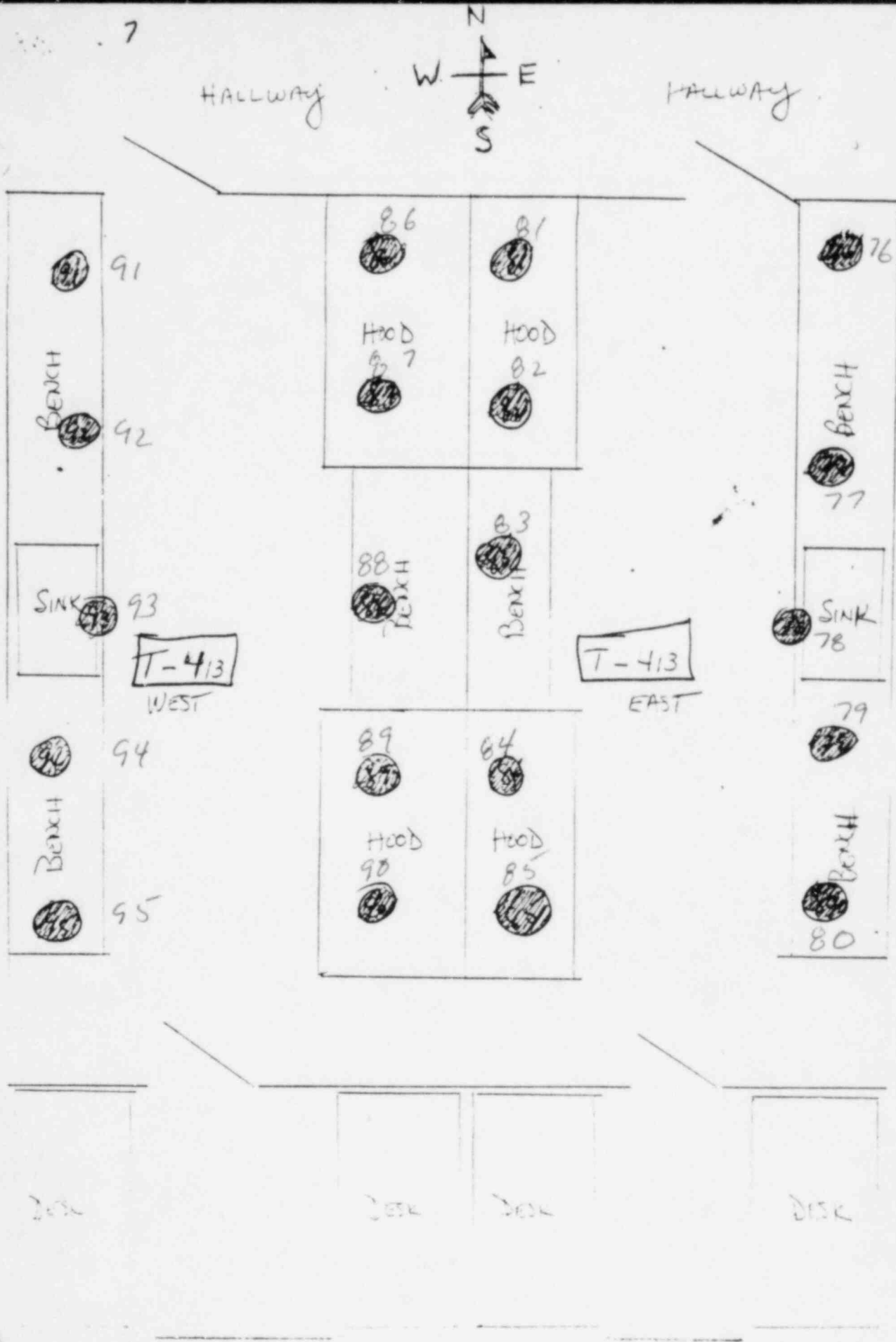

T-BUILDING 4TH FLOOR
 CONTROL NO. 80115

SEE NOTE 2

SEE NOTE 3

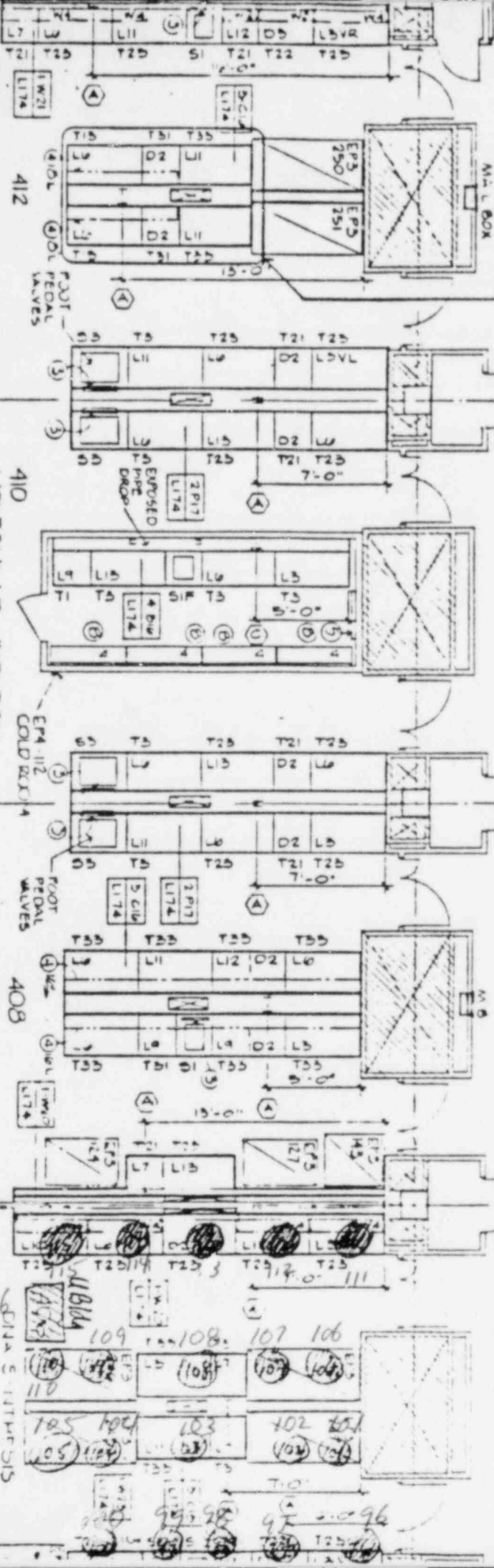

MOLECULAR BIOLOGY

406 DNA S. ITHFEDIS

SEE NOTE 1

9.

R-021

USER: 2 ID:WIFES

PRESET TIME: 10.00

TUE 12 MAR 1985 13:50

SAMPLE REPEAT: 1 CYCLE REPEAT: 1 SCR: N R8232:N

CHANNEL 1-LL: 0 UL: 400 SSICHA: 0.00 EKG SUB: 0.00 EKG SSIG: 0.00 LSR:

CHANNEL 2-LL: 0 UL: 670 SSICHA: 0.00 EKG SUB: 0.00 EKG SSIG: 0.00 LSR:

CHANNEL 3-LL: 670 UL: 1000 SSICHA: 0.00 EKG SUB: 0.00 EKG SSIG: 0.00 LSR:

DATA CALC: CFM, UNKNOWN REPLICATES: 1 NORM FACTOR: 01.00000

ALF LIFE (DAYS): N

SAM	CFM1	CFM2	CFM3	TIME
1	11.00	23.10	13.40	10.00
2	30.00	40.00	11.60	10.00
3	10.00	31.00	11.70	10.00
4	11.00	30.00	10.00	10.00
5	10.00	30.00	11.00	10.00
6	10.00	30.00	10.00	10.00
7	40.70	50.00	11.10	10.00
8	10.00	30.00	10.70	10.00
9	11.10	30.00	10.00	10.00
10	10.40	30.00	10.00	10.00
11	11.10	30.00	11.00	10.00
12	14.70	30.00	10.00	10.00
13	10.70	30.00	10.00	10.00
14	40.00	30.00	10.00	10.00
15	10.70	30.00	10.00	10.00
16	10.00	30.00	10.00	10.00
17	10.00	30.00	10.00	10.00
18	10.00	30.00	10.00	10.00
19	10.00	30.00	10.00	10.00
20	10.00	30.00	10.00	10.00
21	10.00	30.00	10.00	10.00
22	10.00	30.00	10.00	10.00
23	10.00	30.00	10.00	10.00
24	10.00	30.00	10.00	10.00
25	10.00	30.00	10.00	10.00
26	10.00	30.00	10.00	10.00
27	10.00	30.00	10.00	10.00
28	10.00	30.00	10.00	10.00
29	10.00	30.00	10.00	10.00
30	10.00	30.00	10.00	10.00
31	10.00	30.00	10.00	10.00
32	10.00	30.00	10.00	10.00
33	10.00	30.00	10.00	10.00
34	10.00	30.00	10.00	10.00
35	10.00	30.00	10.00	10.00
36	10.00	30.00	10.00	10.00
37	10.00	30.00	10.00	10.00
38	10.00	30.00	10.00	10.00
39	10.00	30.00	10.00	10.00
40	10.00	30.00	10.00	10.00
41	10.00	30.00	10.00	10.00
42	10.00	30.00	10.00	10.00
43	10.00	30.00	10.00	10.00
44	10.00	30.00	10.00	10.00
45	10.00	30.00	10.00	10.00
46	10.00	30.00	10.00	10.00
47	10.00	30.00	10.00	10.00
48	10.00	30.00	10.00	10.00
49	10.00	30.00	10.00	10.00
50	10.00	30.00	10.00	10.00
51	10.00	30.00	10.00	10.00
52	10.00	30.00	10.00	10.00
53	10.00	30.00	10.00	10.00
54	10.00	30.00	10.00	10.00
55	10.00	30.00	10.00	10.00
56	10.00	30.00	10.00	10.00
57	10.00	30.00	10.00	10.00
58	10.00	30.00	10.00	10.00
59	10.00	30.00	10.00	10.00
60	10.00	30.00	10.00	10.00
61	10.00	30.00	10.00	10.00
62	10.00	30.00	10.00	10.00
63	10.00	30.00	10.00	10.00
64	10.00	30.00	10.00	10.00
65	10.00	30.00	10.00	10.00
66	10.00	30.00	10.00	10.00
67	10.00	30.00	10.00	10.00
68	10.00	30.00	10.00	10.00
69	10.00	30.00	10.00	10.00
70	10.00	30.00	10.00	10.00
71	10.00	30.00	10.00	10.00
72	10.00	30.00	10.00	10.00
73	10.00	30.00	10.00	10.00
74	10.00	30.00	10.00	10.00
75	10.00	30.00	10.00	10.00
76	10.00	30.00	10.00	10.00
77	10.00	30.00	10.00	10.00
78	10.00	30.00	10.00	10.00
79	10.00	30.00	10.00	10.00
80	10.00	30.00	10.00	10.00
81	10.00	30.00	10.00	10.00
82	10.00	30.00	10.00	10.00
83	10.00	30.00	10.00	10.00
84	10.00	30.00	10.00	10.00
85	10.00	30.00	10.00	10.00
86	10.00	30.00	10.00	10.00
87	10.00	30.00	10.00	10.00
88	10.00	30.00	10.00	10.00
89	10.00	30.00	10.00	10.00
90	10.00	30.00	10.00	10.00
91	10.00	30.00	10.00	10.00
92	10.00	30.00	10.00	10.00
93	10.00	30.00	10.00	10.00
94	10.00	30.00	10.00	10.00
95	10.00	30.00	10.00	10.00
96	10.00	30.00	10.00	10.00
97	10.00	30.00	10.00	10.00
98	10.00	30.00	10.00	10.00
99	10.00	30.00	10.00	10.00
100	10.00	30.00	10.00	10.00

re-counted

— 11, 24, 39
 — 11, 24, 37
 — 13, 27, 40
 — 11, 25, 40
 — 12, 26, 40
 — 12, 26, 40

SAM CFM1 CFM2 CFM3 TIME

SAM	CFM1	CFM2	CFM3	TIME
51	12.70	26.40	11.40	10.00
52	13.40	25.10	11.40	10.00
53	20.50	38.40	19.00	10.00
54	16.10	35.00	11.90	10.00
55	22.00	38.00	26.00	10.00
56	14.00	31.50	18.40	10.00
57	11.00	26.10	13.00	10.00
58	12.00	29.10	12.40	10.00
59	61.60	73.60	12.90	10.00
60	9.00	23.70	12.00	10.00
61	10.00	22.60	13.50	10.00
62	10.70	21.70	10.00	10.00
63	13.40	25.40	12.00	10.00
64	15.40	30.00	16.60	10.00
65	11.00	24.60	12.00	10.00
66	71.10	31.50	12.00	10.00
67	30.50	42.00	12.00	10.00
68	13.40	24.40	10.00	10.00
69	12.90	22.70	15.00	10.00
70	10.00	26.00	11.00	10.00
71	11.10	22.30	13.50	10.00
72	21.00	33.00	14.00	10.00
73	37.70	49.00	12.40	10.00
74	12.00	24.10	14.10	10.00
75	11.00	21.00	15.10	10.00
76	11.00	23.00	10.00	10.00
77	11.00	23.70	10.00	10.00
78	10.00	24.00	11.00	10.00
79	13.70	26.00	11.00	10.00
80	12.00	26.00	11.00	10.00
81	9.00	23.10	11.00	10.00
82	14.00	24.00	10.00	10.00
83	11.00	25.00	11.10	10.00
84	10.10	22.10	12.10	10.00
85	11.10	21.40		

E

		12	23.00	16.46		
3	191	1	11.00	16.61	10.00	222.46
		2	23.00	16.64		
		3	40.00	9.99		
3	191	1	10.00	17.61	10.00	232.66
		2	26.00	12.60		
		3	38.00	10.22		
3	191	1	12.00	17.61	10.00	242.66
		2	26.00	12.19		
		3	41.00	9.88		
3	191	1	12.00	17.61	10.00	252.76
		2	24.00	12.91		
		3	38.10	10.25		
3	191	1	12.00	16.11	10.00	262.66
		2	27.00	12.04		
		3	41.00	9.81		
3	191	1	14.00	16.90	10.00	272.96
		2	28.00	11.95		
		3	41.00	9.88		
3	191	1	12.00	17.82	10.00	283.06
		2	27.10	12.15		
		3	41.00	9.88		
3	191	1	13.10	17.47	10.00	293.16
		2	27.00	12.10		
		3	40.00	10.00		
3	191	1	12.10	18.18	10.00	303.26
		2	26.00	12.08		
		3	40.10	9.99		

SAM AVG CFM(RNG) 1: 12.70(11.62) 2: 26.65(9.94) 3: 40.23(5.29)

4	192	1	10.00	19.41	10.00	312.47
		2	24.00	12.76		
		3	37.00	10.40		
4	192	1	10.00	19.16	10.00	323.57
		2	27.00	12.17		
		3	40.10	9.99		
4	192	1	13.00	17.24	10.00	333.66
		2	26.00	12.88		
		3	41.00	9.84		
4	192	1	12.00	17.61	10.00	343.76
		2	26.00	12.86		
		3	40.70	9.91		

PAGE: 3

SAM FCS CH CFM SEC% TIME EL TIME

EPR

4	192	1	12.00	17.82	10.00	353.87
		2	26.00	12.10		
		3	41.00	9.88		
4	192	1	12.00	17.82	10.00	363.97
		2	26.00	12.10		
		3	41.00	9.88		
4	192	1	12.00	17.82	10.00	374.07
		2	26.00	12.10		
		3	41.00	9.88		
4	192	1	12.00	17.82	10.00	384.17
		2	26.00	12.10		
		3	41.00	9.88		
4	192	1	12.00	17.82	10.00	394.27
		2	26.00	12.10		
		3	41.00	9.88		
4	192	1	12.00	17.82	10.00	404.37
		2	26.00	12.10		
		3	41.00	9.88		

13

9

5	193	1	12.00	17.41	10.00	464.70
5	193	1	12.00	17.41	10.00	464.80
5	193	1	11.00	18.41	10.00	444.69
5	193	1	12.00	17.41	10.00	464.99
5	193	1	12.00	17.41	10.00	465.09
5	193	1	11.00	18.41	10.00	475.19
5	193	1	12.00	17.41	10.00	465.29
5	193	1	12.00	17.41	10.00	495.39
5	193	1	11.00	18.49	10.00	505.49

SAM AVG CPM (RMG) 1: 12.43 (9.41) 2: 25.86 (12.92) 3: 39.66 (6.71)

6	194	1	11.00	18.96	10.00	515.69
6	194	1	10.00	19.40	10.00	525.75

30

PAGE: 4

SAM	POS	CH	CPM	SSIG%	TIME	EL TIME
6	194	1	12.00	18.26	10.00	535.83
6	194	1	11.00	18.49	10.00	545.90
6	194	1	11.00	18.49	10.00	555.97
6	194	1	11.00	18.49	10.00	565.03

EPR

7	195	1	11.10	10.90	10.00	688.52
		0	10.90	10.70		
		0	10.90	10.91		
7	195	1	10.40	10.87	10.00	686.59
		0	10.90	10.10		
		0	10.40	10.80		
7	195	1	11.00	10.41	10.00	646.66
		0	10.40	10.70		
		0	10.40	10.64		
7	195	1	10.00	10.05	10.00	656.72
		0	10.00	10.10		
		0	10.00	10.06		
7	195	1	10.00	10.40	10.00	666.78
		0	10.40	10.06		
		0	10.00	10.04		
7	195	1	11.00	10.00	10.00	676.84
		0	10.40	10.70		
		0	10.00	10.01		
7	195	1	10.00	10.05	10.00	666.91
		0	10.00	10.00		
		0	10.00	10.00		
7	195	1	10.00	10.71	10.00	696.97
		0	10.40	10.07		
		0	10.00	10.14		
7	195	1	10.10	10.90	10.00	707.03
		0	10.00	10.40		
		0	10.00	10.47		

SAM AVG CPM (RNG) 1: 10.73 (95.60) 2: 85.46 (53.18) 3: 39.34 (34.98)

PAGE: 9

SAM	POS	CH	CPM	SEICM	TIME	LL TIME
6	196	1	10.50	10.00	10.00	717.21
		0	10.40	10.00		
		0	10.40	10.00		
6	196	1	10.10	10.47	10.00	727.00
		0	10.00	10.04		
		0	10.40	10.71		
6	196	1	10.70	10.00	10.00	737.06
		0	10.10	10.00		
		0	10.00	10.00		
6	196	1	10.00	10.00	10.00	747.42
		0	10.00	10.40		
		0	10.00	10.00		
6	196	1	10.00	10.00	10.00	757.48
		0	10.40	10.00		
		0	10.40	10.00		
6	196	1	10.00	10.00	10.00	767.54
		0	10.40	10.00		
		0	10.00	10.00		
6	196	1	10.00	10.00	10.00	777.60
		0	10.00	10.00		
		0	10.00	10.00		
6	196	1	10.00	10.00	10.00	787.67
		0	10.00	10.00		
		0	10.00	10.00		

END

(116) Cold room door

(120) Background

Sample pos (180) = re-count of (25) which had been artifactually "hot"

"	"	(190)	"	"	(26)	"	"	"	"
"	"	(191)	"	"	(27)	"	"	"	"
"	"	(192)	"	"	(28)	"	"	"	"
"	"	(193)	"	"	(29)	"	"	"	"
"	"	(194)	"	"	(30)	"	"	"	"
"	"	(195)	"	"	(45)	"	"	"	"
"	"	(196)	"	"	(96)	"	"	"	"

probably static.

80184
CONTROL NO. 80115

Closeout: OK 3/26/85 R
Frakey's Group; Rec'd 3/26/85

Keith O'Connell, Supervisor

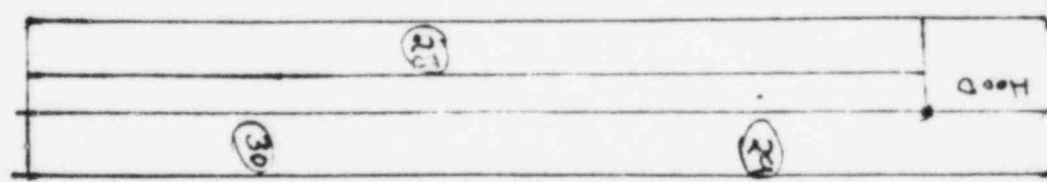
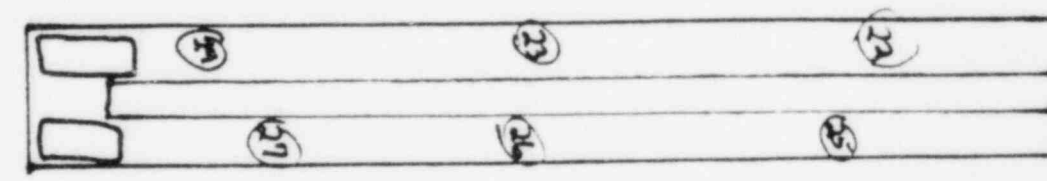
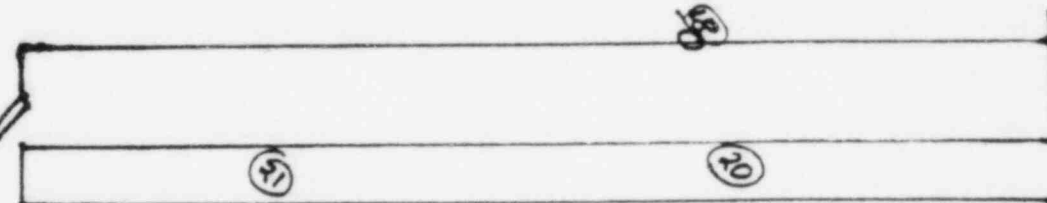
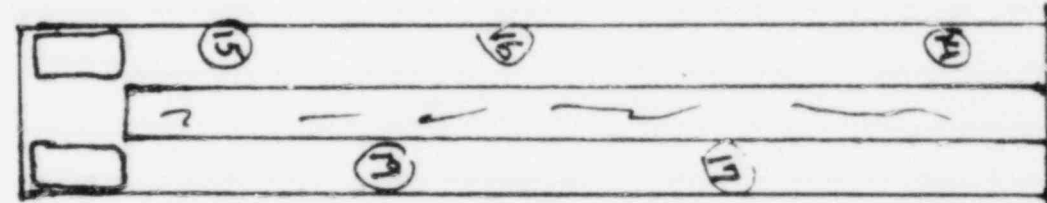
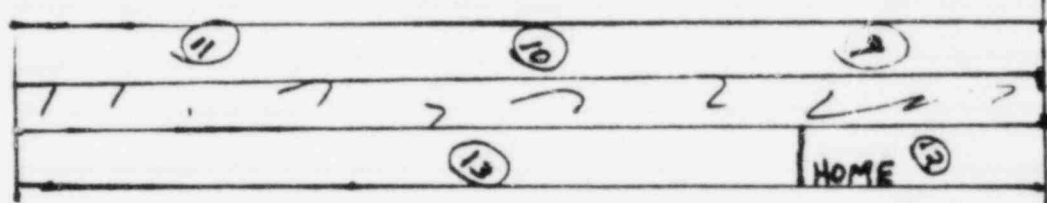

u415
u415
u417
u417
u417
u419

CYCLE: 2

1	33.00	36.00	69.00	1.00
2	43.00	34.00	77.00	1.00
3	64.00	43.00	107.00	1.00
4	117.00	25.00	142.00	1.00
5	56.00	28.00	84.00	1.00
6	70.00	33.00	103.00	1.00
7	46.00	45.00	91.00	1.00
8	63.00	25.00	88.00	1.00
9	41.00	38.00	79.00	1.00
10	43.00	35.00	77.00	1.00
11	36.00	31.00	67.00	1.00
12	25.00	28.00	53.00	1.00
13	41.00	41.00	81.00	1.00
14	36.00	32.00	67.00	1.00
15	19.00	31.00	50.00	1.00

PAGE: 2

SAM	CPM1	CPM2	CPM3	TIME	ERR
16	44.00	44.00	87.00	1.00	
17	43.00	38.00	81.00	1.00	
18	65.00	56.00	121.00	1.00	
19	23.00	29.00	52.00	1.00	
20	28.00	29.00	57.00	1.00	
21	20.00	31.00	51.00	1.00	
22	33.00	35.00	68.00	1.00	
23	28.00	42.00	70.00	1.00	
24	27.00	44.00	71.00	1.00	
25	22.00	27.00	59.00	1.00	
26	33.00	33.00	65.00	1.00	
27	25.00	121.00	145.00	1.00	
28	30.00	42.00	71.00	1.00	
29	26.00	43.00	69.00	1.00	
30	24.00	20.00	44.00	1.00	

decontaminated to 67cpm

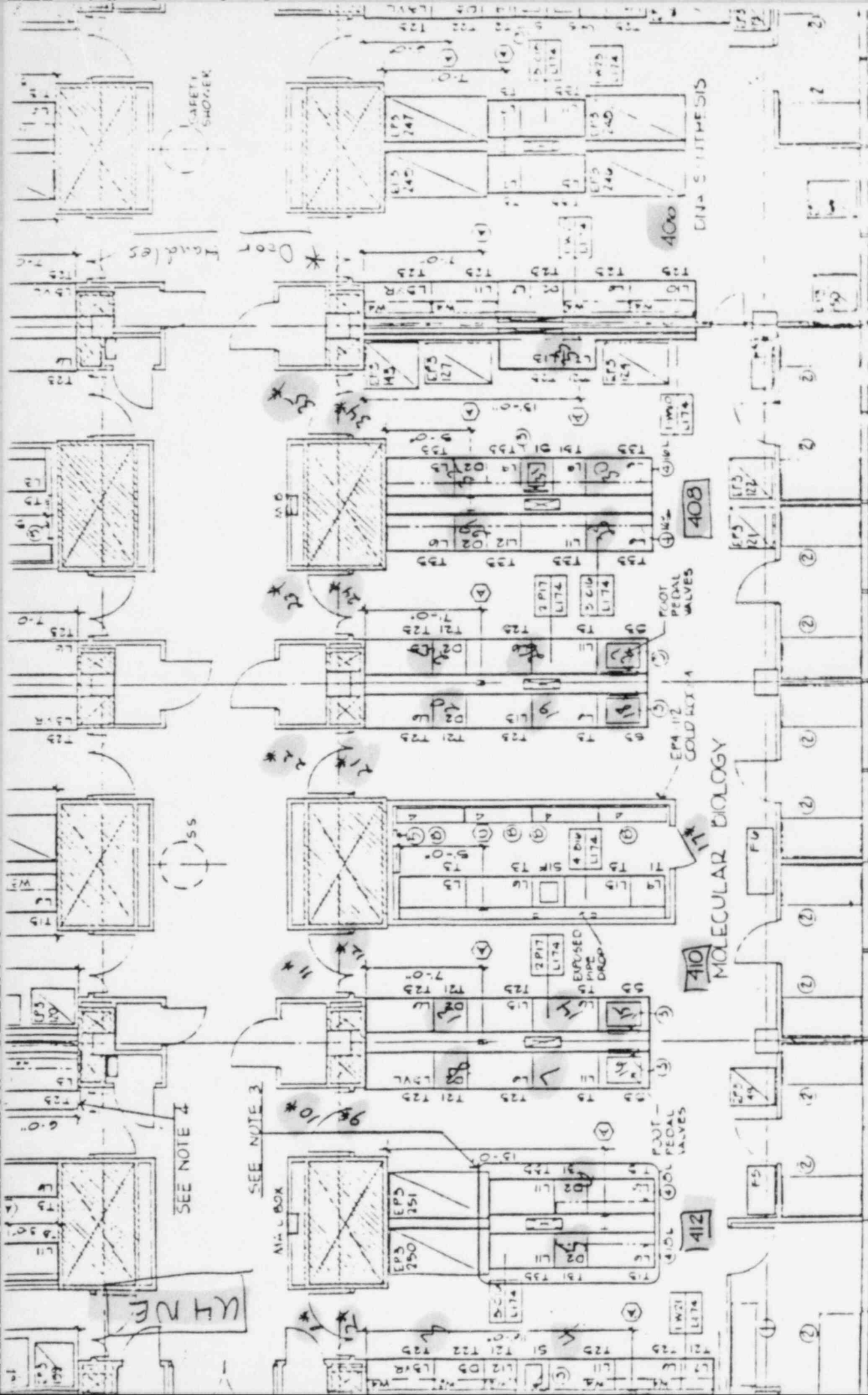

YEAST CULTURE

TISSUE CULTURE

This diagram
mirror images
the actual Lab.

* Door Handles

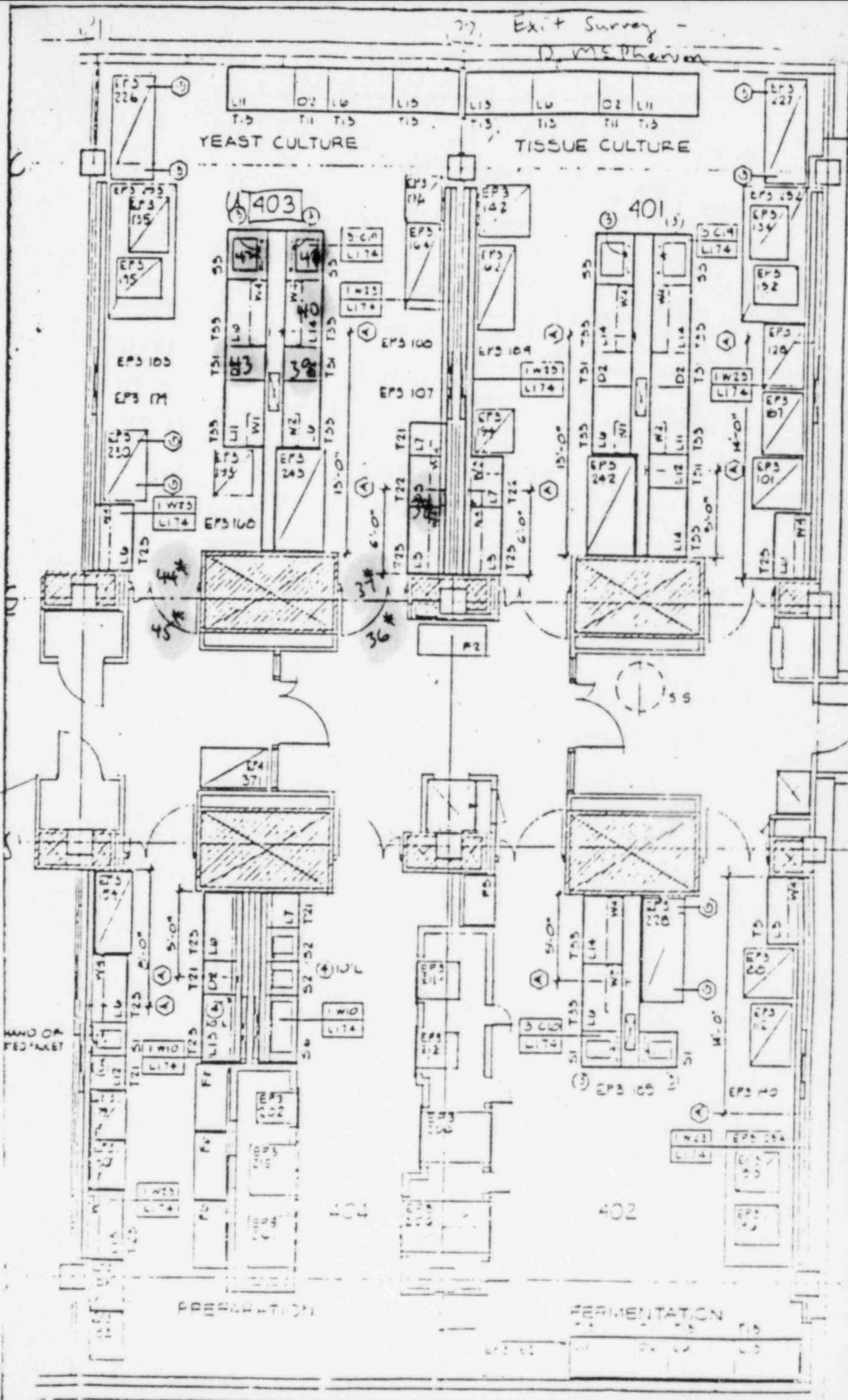

T414

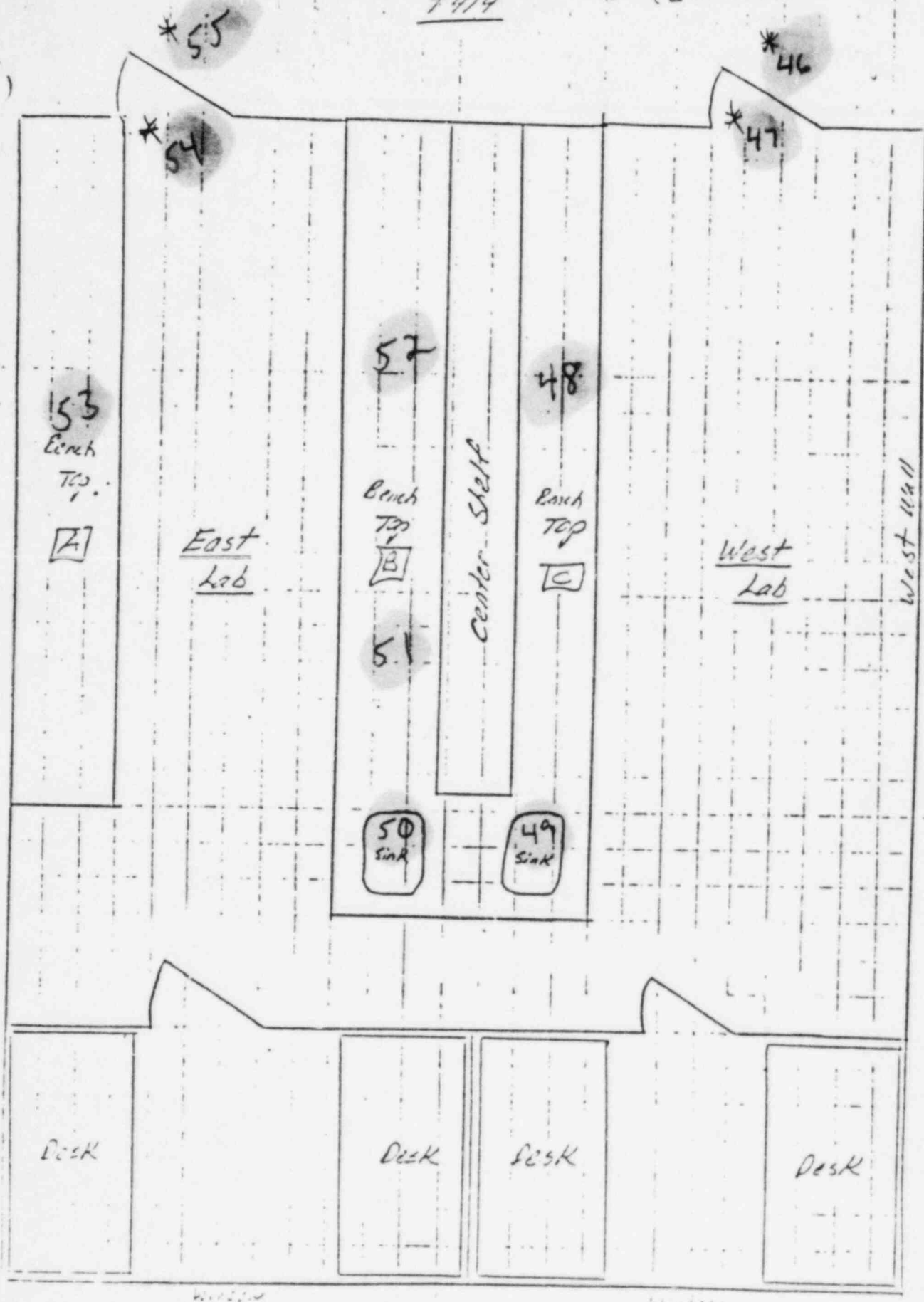

80184
CONTROL NO. 80115

* Door Handles

Exit Survey Swipe Test

D. McPherson 21

USER: 8 ID:MB PRESET TIME: 1.00
 SAMPLE REPEAT: 0 CYCLE REPEAT: 1 CORR: R2232:N
 AM: 0 ACC:N OCF:N PCN:N 2 PHASE MONITOR:N
 CHANNEL 1-LL: 0 UL: 400 SIGMA: 2.00 BKG SUB: 0.00 BKG SIG: 0.00 LSR: 0
 CHANNEL 2-LL: 0 UL: 670 SIGMA: 2.00 BKG SUB: 0.00 BKG SIG: 0.00 LSR: 0
 CHANNEL 3-LL: 0 UL: 1000 SIGMA: 2.00 BKG SUB: 0.00 BKG SIG: 0.00 LSR: 0
 DATA CALC: CPM, UNKNOWN REPLICATES: 1 NORM FACTOR: 0 1.00000
 HALF LIFE(DAYS): N

SAM	CPM1	CPM2	CPM3	TIME	ERR
1	35.00	47.00	53.00	1.00	
2	7.00	24.00	30.00	1.00	
3	10.00	19.00	24.00	1.00	
4	8.00	17.00	20.00	1.00	
5	10.00	17.00	21.00	1.00	
6	10.00	11.00	11.00	1.00	
7	17.00	26.00	41.00	1.00	
8	14.00	24.00	31.00	1.00	
9	13.00	14.00	21.00	1.00	
10	10.00	14.00	14.00	1.00	
11	10.00	11.00	10.00	1.00	
12	10.00	11.00	10.00	1.00	
13	10.00	11.00	10.00	1.00	
14	10.00	11.00	10.00	1.00	
15	10.00	11.00	10.00	1.00	
16	10.00	11.00	10.00	1.00	
17	10.00	11.00	10.00	1.00	
18	10.00	11.00	10.00	1.00	
19	10.00	11.00	10.00	1.00	
20	10.00	11.00	10.00	1.00	
21	10.00	11.00	10.00	1.00	
22	10.00	11.00	10.00	1.00	
23	10.00	11.00	10.00	1.00	
24	10.00	11.00	10.00	1.00	
25	10.00	11.00	10.00	1.00	
26	10.00	11.00	10.00	1.00	
27	10.00	11.00	10.00	1.00	
28	10.00	11.00	10.00	1.00	
29	10.00	11.00	10.00	1.00	
30	10.00	11.00	10.00	1.00	
31	10.00	11.00	10.00	1.00	
32	10.00	11.00	10.00	1.00	
33	10.00	11.00	10.00	1.00	
34	10.00	11.00	10.00	1.00	
35	10.00	11.00	10.00	1.00	
36	10.00	11.00	10.00	1.00	
37	10.00	11.00	10.00	1.00	
38	10.00	11.00	10.00	1.00	
39	10.00	11.00	10.00	1.00	
40	10.00	11.00	10.00	1.00	
41	10.00	11.00	10.00	1.00	
42	10.00	11.00	10.00	1.00	
43	10.00	11.00	10.00	1.00	
44	10.00	11.00	10.00	1.00	
45	10.00	11.00	10.00	1.00	
46	10.00	11.00	10.00	1.00	
47	10.00	11.00	10.00	1.00	
48	10.00	11.00	10.00	1.00	
49	10.00	11.00	10.00	1.00	
50	10.00	11.00	10.00	1.00	
51	10.00	11.00	10.00	1.00	
52	10.00	11.00	10.00	1.00	
53	10.00	11.00	10.00	1.00	
54	10.00	11.00	10.00	1.00	
55	10.00	11.00	10.00	1.00	
56	10.00	11.00	10.00	1.00	
57	10.00	11.00	10.00	1.00	
58	10.00	11.00	10.00	1.00	
59	10.00	11.00	10.00	1.00	
60	10.00	11.00	10.00	1.00	
61	10.00	11.00	10.00	1.00	
62	10.00	11.00	10.00	1.00	
63	10.00	11.00	10.00	1.00	
64	10.00	11.00	10.00	1.00	
65	10.00	11.00	10.00	1.00	
66	10.00	11.00	10.00	1.00	
67	10.00	11.00	10.00	1.00	
68	10.00	11.00	10.00	1.00	
69	10.00	11.00	10.00	1.00	
70	10.00	11.00	10.00	1.00	
71	10.00	11.00	10.00	1.00	
72	10.00	11.00	10.00	1.00	
73	10.00	11.00	10.00	1.00	
74	10.00	11.00	10.00	1.00	
75	10.00	11.00	10.00	1.00	
76	10.00	11.00	10.00	1.00	
77	10.00	11.00	10.00	1.00	
78	10.00	11.00	10.00	1.00	
79	10.00	11.00	10.00	1.00	
80	10.00	11.00	10.00	1.00	
81	10.00	11.00	10.00	1.00	
82	10.00	11.00	10.00	1.00	
83	10.00	11.00	10.00	1.00	
84	10.00	11.00	10.00	1.00	
85	10.00	11.00	10.00	1.00	
86	10.00	11.00	10.00	1.00	
87	10.00	11.00	10.00	1.00	
88	10.00	11.00	10.00	1.00	
89	10.00	11.00	10.00	1.00	
90	10.00	11.00	10.00	1.00	
91	10.00	11.00	10.00	1.00	
92	10.00	11.00	10.00	1.00	
93	10.00	11.00	10.00	1.00	
94	10.00	11.00	10.00	1.00	
95	10.00	11.00	10.00	1.00	
96	10.00	11.00	10.00	1.00	
97	10.00	11.00	10.00	1.00	
98	10.00	11.00	10.00	1.00	
99	10.00	11.00	10.00	1.00	
100	10.00	11.00	10.00	1.00	

SAM	CPM1	CPM2	CPM3	TIME
1	2.00	11.00	14.00	1.00
2	20.00	10.00	20.00	1.00
3	131.00	10.00	243.00	1.00
4	14.00	10.00	30.00	1.00
5	20.00	10.00	44.00	1.00
6	8.00	10.00	19.00	1.00

Recount.

22

USER: 8 ID:MB PRESET TIME: 1.00
 SAMPLE REPEAT: 0 CYCLE REPEAT: 1 SCR:N RS232:N
 H#: 0 AOC:N OCF:N RCN:N 2 PHASE MONITOR:N
 CHANNEL 1-LL: 0 UL: 400 SSIGMA: 0.00 BKG SUB: 0.00 BKG SSIG: 0.00 LSP: 0
 CHANNEL 2-LL: 0 UL: 670 SSIGMA: 0.00 BKG SUB: 0.00 BKG SSIG: 0.00 LSP: 0
 CHANNEL 3-LL: 0 UL: 1000 SSIGMA: 0.00 BKG SUB: 0.00 BKG SSIG: 0.00 LSP: 0
 DATA CALC: CPM UNKNOWN REPLICATES: 1 NORM FACTOR: 0 1.00000
 HALF LIFE (DAYS): N

SAM	CPM1	CPM2	CPM3	TIME	ERR
1	45.00	54.00	55.00	1.00	
2	24.00	40.00	50.00	1.00	
3	10.00	10.00	10.00	1.00	
4	14.00	10.00	10.00	1.00	
5	35.00	10.00	10.00	1.00	
6	7.00	10.00	10.00	1.00	
7	11.00	10.00	10.00	1.00	
8	7.00	10.00	10.00	1.00	
9	9.00	10.00	10.00	1.00	
10	50.00	10.00	10.00	1.00	
11	17.00	10.00	10.00	1.00	
12	9.00	10.00	10.00	1.00	
13	8.00	10.00	10.00	1.00	
14	14.00	10.00	10.00	1.00	
15	16.00	10.00	10.00	1.00	
16	11.00	10.00	10.00	1.00	
17	19.00	10.00	10.00	1.00	
18	7.00	10.00	10.00	1.00	
19	21.00	10.00	10.00	1.00	
20	10.00	10.00	10.00	1.00	
21	71.00	10.00	10.00	1.00	
22	3.00	10.00	10.00	1.00	
23	15.00	10.00	10.00	1.00	
24	4.00	10.00	10.00	1.00	
25	11.00	10.00	10.00	1.00	
26	10.00	10.00	10.00	1.00	
27	13.00	10.00	10.00	1.00	
28	7.00	10.00	10.00	1.00	
29	17.00	10.00	10.00	1.00	
30	14.00	10.00	10.00	1.00	
31	13.00	10.00	10.00	1.00	
32	13.00	10.00	10.00	1.00	
33	13.00	10.00	10.00	1.00	
34	13.00	10.00	10.00	1.00	
35	13.00	10.00	10.00	1.00	
36	13.00	10.00	10.00	1.00	
37	13.00	10.00	10.00	1.00	
38	13.00	10.00	10.00	1.00	
39	13.00	10.00	10.00	1.00	
40	13.00	10.00	10.00	1.00	
41	13.00	10.00	10.00	1.00	
42	13.00	10.00	10.00	1.00	
43	13.00	10.00	10.00	1.00	
44	13.00	10.00	10.00	1.00	
45	13.00	10.00	10.00	1.00	
46	13.00	10.00	10.00	1.00	
47	13.00	10.00	10.00	1.00	
48	13.00	10.00	10.00	1.00	
49	13.00	10.00	10.00	1.00	
50	13.00	10.00	10.00	1.00	
51	13.00	10.00	10.00	1.00	
52	13.00	10.00	10.00	1.00	
53	13.00	10.00	10.00	1.00	
54	13.00	10.00	10.00	1.00	
55	13.00	10.00	10.00	1.00	
56	13.00	10.00	10.00	1.00	
57	13.00	10.00	10.00	1.00	
58	13.00	10.00	10.00	1.00	
59	13.00	10.00	10.00	1.00	
60	13.00	10.00	10.00	1.00	
61	13.00	10.00	10.00	1.00	
62	13.00	10.00	10.00	1.00	
63	13.00	10.00	10.00	1.00	
64	13.00	10.00	10.00	1.00	
65	13.00	10.00	10.00	1.00	
66	13.00	10.00	10.00	1.00	
67	13.00	10.00	10.00	1.00	
68	13.00	10.00	10.00	1.00	
69	13.00	10.00	10.00	1.00	
70	13.00	10.00	10.00	1.00	
71	13.00	10.00	10.00	1.00	
72	13.00	10.00	10.00	1.00	
73	13.00	10.00	10.00	1.00	
74	13.00	10.00	10.00	1.00	
75	13.00	10.00	10.00	1.00	
76	13.00	10.00	10.00	1.00	
77	13.00	10.00	10.00	1.00	
78	13.00	10.00	10.00	1.00	
79	13.00	10.00	10.00	1.00	
80	13.00	10.00	10.00	1.00	
81	13.00	10.00	10.00	1.00	
82	13.00	10.00	10.00	1.00	
83	13.00	10.00	10.00	1.00	
84	13.00	10.00	10.00	1.00	
85	13.00	10.00	10.00	1.00	
86	13.00	10.00	10.00	1.00	
87	13.00	10.00	10.00	1.00	
88	13.00	10.00	10.00	1.00	
89	13.00	10.00	10.00	1.00	
90	13.00	10.00	10.00	1.00	
91	13.00	10.00	10.00	1.00	
92	13.00	10.00	10.00	1.00	
93	13.00	10.00	10.00	1.00	
94	13.00	10.00	10.00	1.00	
95	13.00	10.00	10.00	1.00	
96	13.00	10.00	10.00	1.00	
97	13.00	10.00	10.00	1.00	
98	13.00	10.00	10.00	1.00	
99	13.00	10.00	10.00	1.00	
100	13.00	10.00	10.00	1.00	

SAM	CPM1	CPM2	CPM3	TIME	ERR
1	13.00	14.00	15.00	1.00	
2	14.00	15.00	16.00	1.00	
3	15.00	16.00	17.00	1.00	
4	16.00	17.00	18.00	1.00	
5	17.00	18.00	19.00	1.00	
6	18.00	19.00	20.00	1.00	
7	19.00	20.00	21.00	1.00	
8	20.00	21.00	22.00	1.00	
9	21.00	22.00	23.00	1.00	
10	22.00	23.00	24.00	1.00	
11	23.00	24.00	25.00	1.00	
12	24.00	25.00	26.00	1.00	
13	25.00	26.00	27.00	1.00	
14	26.00	27.00	28.00	1.00	
15	27.00	28.00	29.00	1.00	
16	28.00	29.00	30.00	1.00	
17	29.00	30.00	31.00	1.00	
18	30.00	31.00	32.00	1.00	
19	31.00	32.00	33.00	1.00	
20	32.00	33.00	34.00	1.00	
21	33.00	34.00	35.00	1.00	
22	34.00	35.00	36.00	1.00	
23	35.00	36.00	37.00	1.00	
24	36.00	37.00	38.00	1.00	
25	37.00	38.00	39.00	1.00	
26	38.00	39.00	40.00	1.00	
27	39.00	40.00	41.00	1.00	
28	40.00	41.00	42.00	1.00	
29	41.00	42.00	43.00	1.00	
30	42.00	43.00	44.00	1.00	
31	43.00	44.00	45.00	1.00	
32	44.00	45.00	46.00	1.00	
33	45.00	46.00	47.00	1.00	
34	46.00	47.00	48.00	1.00	
35	47.00	48.00	49.00	1.00	
36	48.00	49.00	50.00	1.00	
37	49.00	50.00	51.00	1.00	
38	50.00	51.00	52.00	1.00	
39	51.00	52.00	53.00	1.00	
40	52.00	53.00	54.00	1.00	
41	53.00	54.00	55.00	1.00	
42	54.00	55.00	56.00	1.00	
43	55.00	56.00	57.00	1.00	
44	56.00	57.00	58.00	1.00	
45	57.00	58.00	59.00	1.00	
46	58.00	59.00	60.00	1.00	
47	59.00	60.00	61.00	1.00	
48	60.00	61.00	62.00	1.00	
49	61.00	62.00	63.00	1.00	
50	62.00	63.00	64.00	1.00	
51	63.00	64.00	65.00	1.00	
52	64.00	65.00	66.00	1.00	
53	65.00	66.00	67.00	1.00	
54	66.00	67.00	68.00	1.00	
55	67.00	68.00	69.00	1.00	
56	68.00	69.00	70.00	1.00	
57	69.00	70.00	71.00	1.00	
58	70.00	71.00	72.00	1.00	
59	71.00	72.00	73.00	1.00	
60	72.00	73.00	74.00	1.00	
61	73.00	74.00	75.00	1.00	
62	74.00	75.00	76.00	1.00	
63	75.00	76.00	77.00	1.00	
64	76.00	77.00	78.00	1.00	
65	77.00	78.00	79.00	1.00	
66	78.00	79.00	80.00	1.00	
67	79.00	80.00	81.00	1.00	
68	80.00	81.00	82.00	1.00	
69	81.00	82.00	83.00	1.00	
70	82.00	83.00	84.00	1.00	
71	83.00	84.00	85.00	1.00	
72	84.00	85.00	86.00	1.00	
73	85.00	86.00	87.00	1.00	
74	86.00	87.00	88.00	1.00	
75	87.00	88.00	89.00	1.00	
76	88.00	89.00	90.00	1.00	
77	89.00	90.00	91.00	1.00	
78	90.00	91.00	92.00	1.00	
79	91.00	92.00	93.00	1.00	
80	92.00	93.00	94.00	1.00	
81	93.00	94.00	95.00	1.00	
82	94.00	95.00	96.00	1.00	
83	95.00	96.00	97.00	1.00	
84	96.00	97.00	98.00	1.00	
85	97.00	98.00	99.00	1.00	
86	98.00	99.00	100.00	1.00	
87	99.00	100.00		1.00	
88	100.00			1.00	
89				1.00	
90				1.00	
91				1.00	
92				1.00	
93				1.00	
94				1.00	
95				1.00	
96				1.00	
97				1.00	
98				1.00	
99				1.00	
100				1.00	

Recount.

3

USED 3 TIME
 SAMPLE REPEAT.
 HET 9 AOC:N OCT
 CHANNEL 1-LL:
 CHANNEL 2-LL:
 CHANNEL 3-LL:
 DATA CALC: CPM
 HALF LIFE (T_{1/2}):

SA1 CPM1

4
 5
 11
 24

51.00
 51.00
 51.00
 51.00

47
 75.00
 60
 55

1.00
 1.00
 1.00
 1.00

80184

CONTROL NO. ~~80115~~

LAB T413

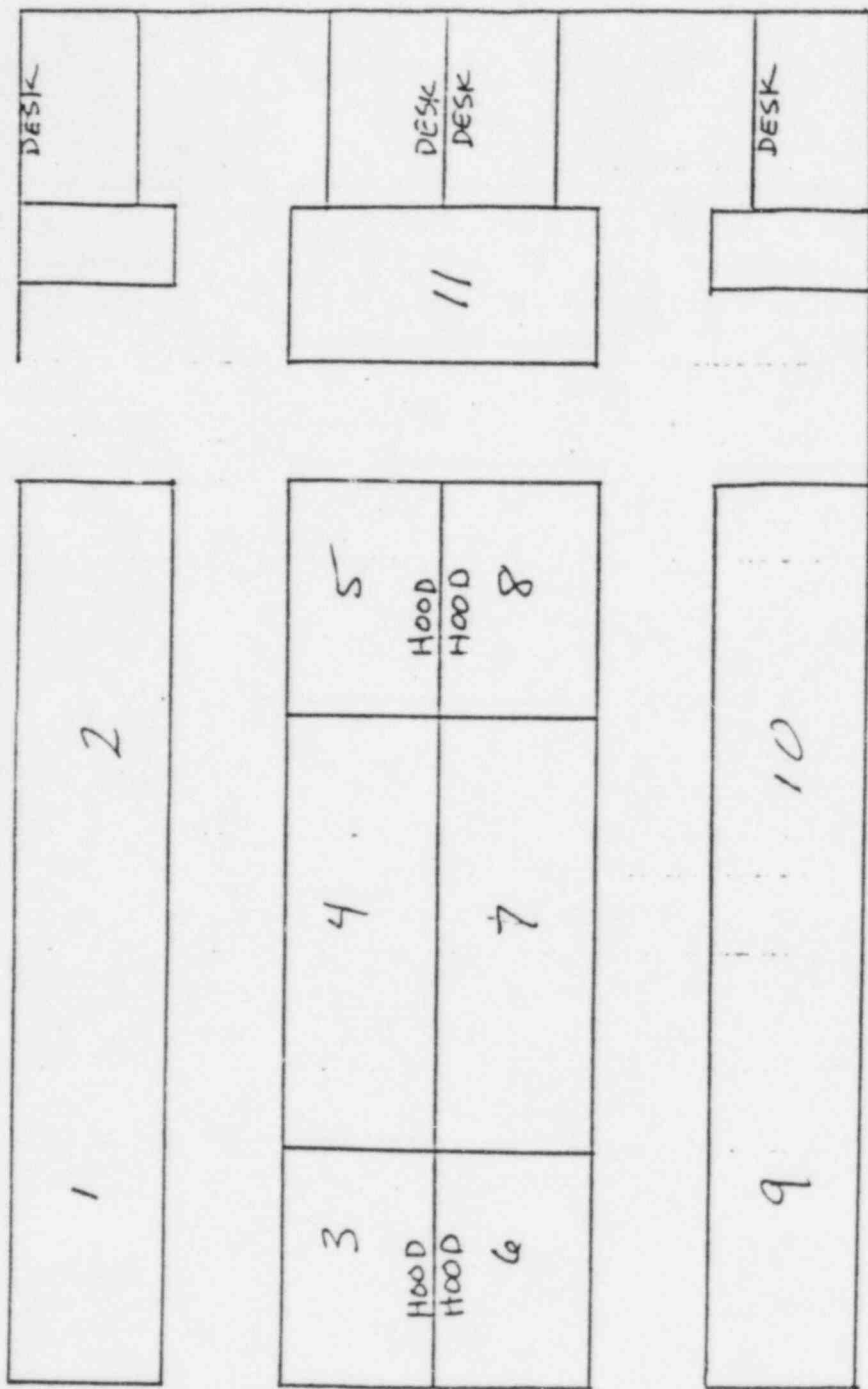

LAB T 415

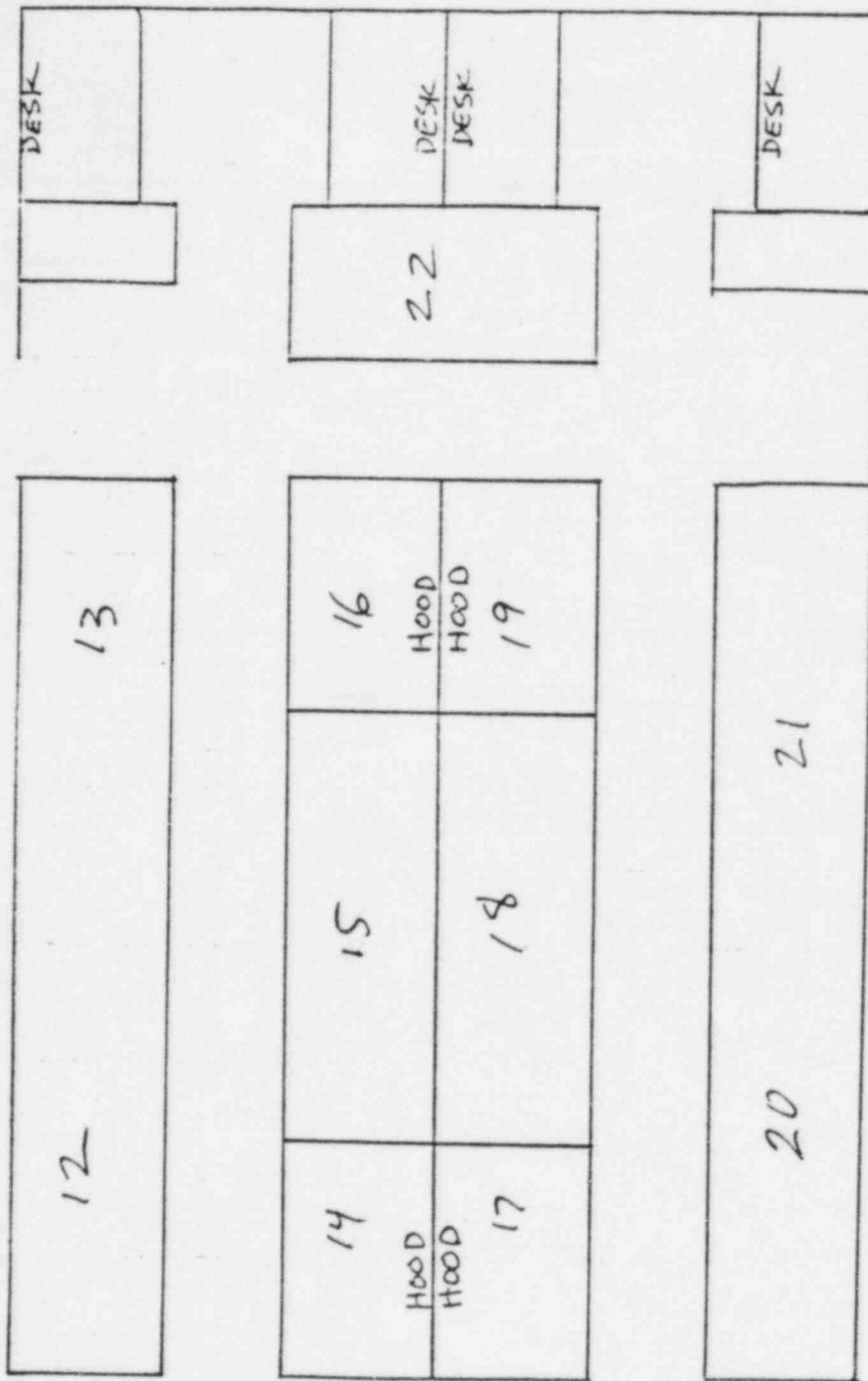

80184
CONTROL NO. 80115

LAB T417

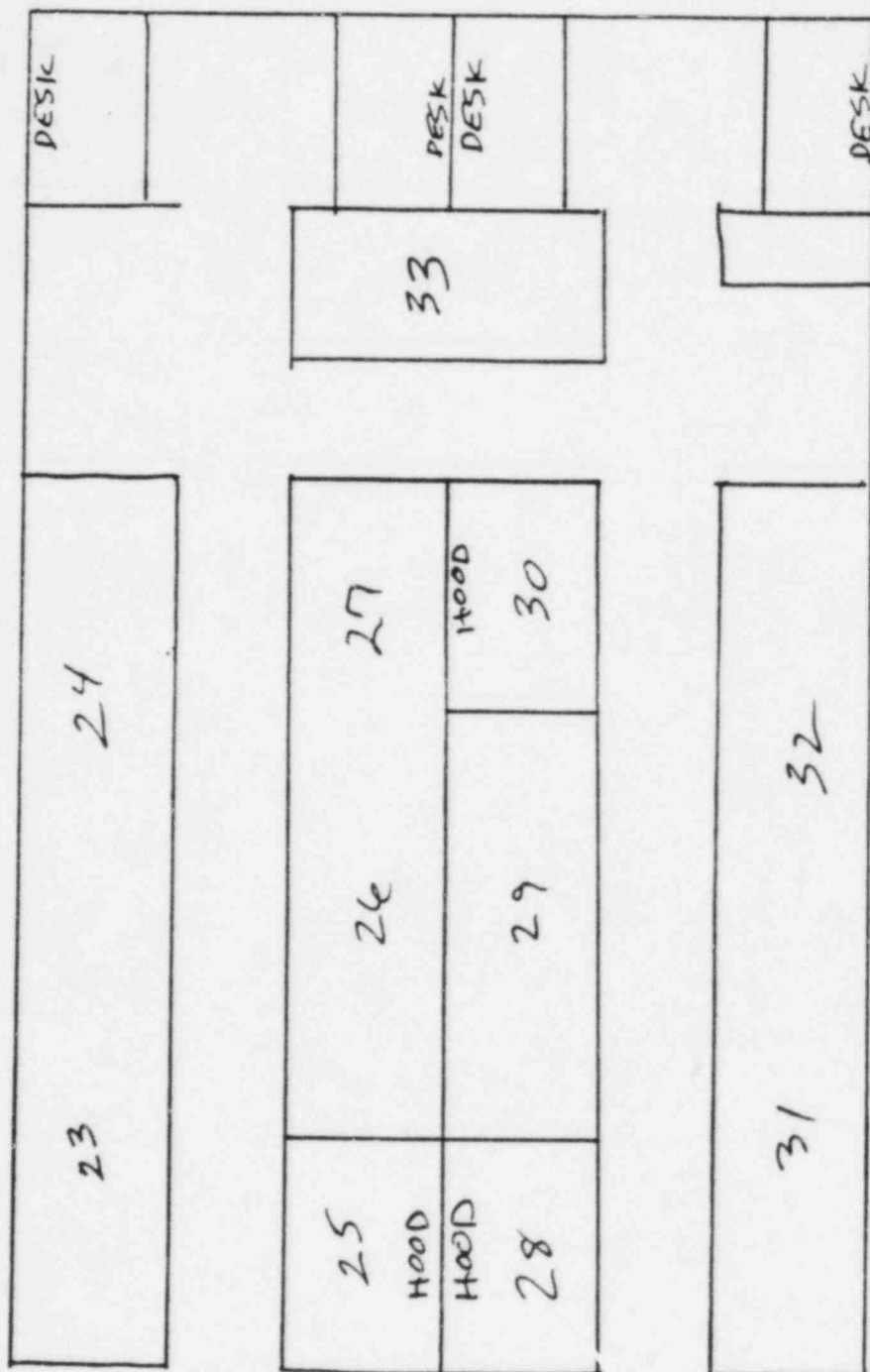

#34 = Blank

USER: 6 ID:RODI PRESET TIME: 1.00 TUE 17 SEP 1985 13:23
 SAMPLE REPEAT: 1 CYCLE REPEAT: 1 SCR:N RS232:N
 H#: 0 AOC:N OCF:N RCM:N 2 PHASE MONITOR:N
 CHANNEL 1-LL: 0 UL: 450 2SIGMA: 2.00 BKG SUB: 0.00 BKG 2SIG: 0.00 LSR: 0
 CHANNEL 2-LL: 450 UL: 1000 2SIGMA: 2.00 BKG SUB: 0.00 BKG 2SIG: 0.00 LSR: 0
 CHANNEL 3-LL: 0 UL: 1000 2SIGMA: 2.00 BKG SUB: 0.00 BKG 2SIG: 0.00 LSR: 0
 DATA CALC: CPM, UNKNOWN REPLICATES: 1 NORM FACTOR: 0 1.00000
 HALF LIFE(DAYS):N

SAM	POS	CH	CPM	2SIG%	TIME	EL TIME	ERR
1	90	1	24.00	40.82	1.00	1.00	
		2	18.00	47.14			
		3	42.00	30.86			
2	91	1	14.00	53.45	1.00	2.23	
		2	26.00	39.82			
		3	40.00	31.62			
3	92	1	30.00	36.51	1.00	3.37	
		2	11.00	60.30			
		3	41.00	31.23			
4	93	1	18.00	47.14	1.00	4.51	
		2	19.00	45.88			
		3	37.00	32.88			
5	94	1	23.00	41.70	1.00	5.64	
		2	14.00	53.45			
		3	37.00	32.88			
6	95	1	63.00	29.00	1.00	6.79	
		2	21.00	43.64			
		3	34.00	31.00			
7	96	1	34.00	34.60	1.00	7.92	
		2	15.00	51.64			
		3	49.00	28.57			
8	97	1	27.00	38.49	1.00	9.05	
		2	20.00	46.64			
		3	49.00	28.57			
9	98	1	16.00	45.88	1.00	10.20	
		2	17.00	48.51			
		3	35.00	33.01			
10	99	1	29.00	37.14	1.00	11.34	
		2	20.00	44.72			
		3	49.00	28.57			
11	100	1	29.00	37.14	1.00	12.47	
		2	17.00	48.51			
		3	46.00	29.49			
12	101	1	36.00	33.33	1.00	13.61	
		2	16.00	45.88			
		3	50.00	27.74			
13	102	1	27.00	38.49	1.00	14.74	
		2	20.00	44.72			
		3	47.00	29.17			
14	103	1	16.00	45.88	1.00	15.88	
		2	17.00	48.51			
		3	35.00	33.01			
15	104	1	20.00	44.72	1.00	17.02	
		2	16.00	45.88			
		3	46.00	29.49			
16	105	1	17.00	48.51	1.00	18.15	
		2	16.00	45.88			
		3	35.00	33.01			
17	106	1	17.00	48.51	1.00	19.29	
		2	16.00	45.88			
		3	35.00	33.01			
18	107	1	17.00	48.51	1.00	20.42	
		2	16.00	45.88			
		3	35.00	33.01			
19	108	1	17.00	48.51	1.00	21.56	
		2	16.00	45.88			
		3	35.00	33.01			
20	109	1	17.00	48.51	1.00	22.69	
		2	16.00	45.88			
		3	35.00	33.01			
21	110	1	17.00	48.51	1.00	23.83	
		2	16.00	45.88			
		3	35.00	33.01			
22	111	1	17.00	48.51	1.00	24.97	
		2	16.00	45.88			
		3	35.00	33.01			
23	112	1	17.00	48.51	1.00	26.10	
		2	16.00	45.88			
		3	35.00	33.01			
24	113	1	17.00	48.51	1.00	27.24	
		2	16.00	45.88			
		3	35.00	33.01			
25	114	1	17.00	48.51	1.00	28.38	
		2	16.00	45.88			
		3	35.00	33.01			
26	115	1	17.00	48.51	1.00	29.51	
		2	16.00	45.88			
		3	35.00	33.01			
27	116	1	17.00	48.51	1.00	30.65	
		2	16.00	45.88			
		3	35.00	33.01			
28	117	1	17.00	48.51	1.00	31.79	
		2	16.00	45.88			
		3	35.00	33.01			
29	118	1	17.00	48.51	1.00	32.92	
		2	16.00	45.88			
		3	35.00	33.01			
30	119	1	17.00	48.51	1.00	34.06	
		2	16.00	45.88			
		3	35.00	33.01			
31	120	1	17.00	48.51	1.00	35.20	
		2	16.00	45.88			
		3	35.00	33.01			
32	121	1	17.00	48.51	1.00	36.33	
		2	16.00	45.88			
		3	35.00	33.01			
33	122	1	17.00	48.51	1.00	37.47	
		2	16.00	45.88			
		3	35.00	33.01			
34	123	1	17.00	48.51	1.00	38.61	
		2	16.00	45.88			
		3	35.00	33.01			
35	124	1	17.00	48.51	1.00	39.74	
		2	16.00	45.88			
		3	35.00	33.01			
36	125	1	17.00	48.51	1.00	40.88	
		2	16.00	45.88			
		3	35.00	33.01			
37	126	1	17.00	48.51	1.00	42.02	
		2	16.00	45.88			
		3	35.00	33.01			
38	127	1	17.00	48.51	1.00	43.15	
		2	16.00	45.88			
		3	35.00	33.01			
39	128	1	17.00	48.51	1.00	44.29	
		2	16.00	45.88			
		3	35.00	33.01			
40	129	1	17.00	48.51	1.00	45.43	
		2	16.00	45.88			
		3	35.00	33.01			
41	130	1	17.00	48.51	1.00	46.56	
		2	16.00	45.88			
		3	35.00	33.01			
42	131	1	17.00	48.51	1.00	47.70	
		2	16.00	45.88			
		3	35.00	33.01			
43	132	1	17.00	48.51	1.00	48.84	
		2	16.00	45.88			
		3	35.00	33.01			
44	133	1	17.00	48.51	1.00	49.97	
		2	16.00	45.88			
		3	35.00	33.01			
45	134	1	17.00	48.51	1.00	51.11	
		2	16.00	45.88			
		3	35.00	33.01			
46	135	1	17.00	48.51	1.00	52.25	
		2	16.00	45.88			
		3	35.00	33.01			
47	136	1	17.00	48.51	1.00	53.38	
		2	16.00	45.88			
		3	35.00	33.01			
48	137	1	17.00	48.51	1.00	54.52	
		2	16.00	45.88			
		3	35.00	33.01			
49	138	1	17.00	48.51	1.00	55.66	
		2	16.00	45.88			
		3	35.00	33.01			
50	139	1	17.00	48.51	1.00	56.79	
		2	16.00	45.88			
		3	35.00	33.01			
51	140	1	17.00	48.51	1.00	57.93	
		2	16.00	45.88			
		3	35.00	33.01			
52	141	1	17.00	48.51	1.00	59.07	
		2	16.00	45.88			
		3	35.00	33.01			
53	142	1	17.00	48.51	1.00	60.20	
		2	16.00	45.88			
		3	35.00	33.01			
54	143	1	17.00	48.51	1.00	61.34	
		2	16.00	45.88			
		3	35.00	33.01			
55	144	1	17.00	48.51	1.00	62.48	
		2	16.00	45.88			
		3	35.00	33.01			
56	145	1	17.00	48.51	1.00	63.61	
		2	16.00	45.88			
		3	35.00	33.01			
57	146	1	17.00	48.51	1.00	64.75	
		2	16.00	45.88			
		3	35.00	33.01			
58	147	1	17.00	48.51	1.00	65.89	
		2	16.00	45.88			
		3	35.00	33.01			
59	148	1	17.00	48.51	1.00	67.02	
		2	16.00	45.88			
		3	35.00	33.01			
60	149	1	17.00	48.51	1.0		

28

SAM	POS	CH	CPM	2SIG%	TIME	EL TIME	ERR
18	107	1	21.00	43.64	1.00	20.43	
		2	15.00	51.64			
		3	36.00	33.33			
19	108	1	32.00	35.36	1.00	21.59	
		2	19.00	45.88			
		3	50.00	28.28			
20	109	1	36.00	33.33	1.00	22.73	
		2	15.00	51.64			
		3	51.00	28.31			
21	110	1	3146.00	3.57	1.00	23.99	—
		2	19.00	45.88			
		3	3165.00	3.56			
22	111	1	31.00	35.92	1.00	25.13	
		2	13.00	55.47			
		3	44.00	30.15			
23	112	1	26.00	39.22	1.00	26.26	
		2	18.00	47.14			
		3	44.00	30.15			
24	113	1	19.00	45.88	1.00	27.41	
		2	18.00	47.14			
		3	37.00	32.88			
25	114	1	26.00	39.22	1.00	28.54	
		2	17.00	48.51			
		3	43.00	30.50			
26	115	1	19.00	45.88	1.00	29.67	
		2	15.00	51.64			
		3	34.00	34.38			
27	116	1	22.00	42.64	1.00	30.83	
		2	17.00	48.51			
		3	39.00	32.88			
28	117	1	42.00	30.86	1.00	31.94	
		2	20.00	44.72			
		3	62.00	25.40			
29	118	1	28.00	37.80	1.00	33.08	
		2	15.00	51.64			
		3	43.00	30.50			
30	119	1	27.00	38.49	1.00	34.22	
		2	20.00	44.72			
		3	47.00	29.17			
31	120	1	26.00	37.80	1.00	35.35	
		2	23.00	41.70			
		3	51.00	28.31			
32	121	1	19.00	45.88	1.00	36.49	
		2	20.00	44.72			
		3	39.00	32.88			
33	122	1	30.00	36.51	1.00	37.63	
		2	18.00	47.14			
		3	48.00	28.87			
34	123	1	24.00	40.62	1.00	38.76	
		2	20.00	44.72			
		3	33.00	37.74			

29
H#: 0 AQC:N QCF:N RCM:N

CHANNEL 1-LL: 0 UL: 400 2SIGMA: 2.00 BKG SUB: 0.00 BKG 2SIG: 0.00

CHANNEL 2-LL: 400 UL: 1000 2SIGMA: 2.00 BKG SUB: 0.00 BKG 2SIG: 0.00

CHANNEL 3-LL: 0 UL: 1000 2SIGMA: 2.00 BKG SUB: 0.00 BKG 2SIG: 0.00

DATA CALC: CPM, UNKNOWN REPLICATES: 1 NORM FACTOR: 1.00000

HALF LIFE(DAYS):N

SAM	CPM1	CPM2	CPM3	TIME
-----	------	------	------	------

1	7.00	33.00	40.00	1.00
---	------	-------	-------	------

*re-count after
decontamination
(sample 21)*

80189
CONTROL NO. 80115