

**KERR-MCGEE CORPORATION**

KERR-MCGEE CENTER • OKLAHOMA CITY, OKLAHOMA 73125

ENVIRONMENT AND HEALTH MANAGEMENT DIVISION

November 12, 1985

CERTIFIED MAIL  
RETURN RECEIPT REQUESTED

Mr. William A. Nixon  
Uranium Process Licensing Section  
Uranium Fuel Licensing Branch  
Division of Fuel Cycle & Material Safety  
Office of Nuclear Material Safety and Safeguards  
United States Nuclear Regulatory Commission  
Washington, D.C. 20555

Re: License STA-583  
Docket 40-2061

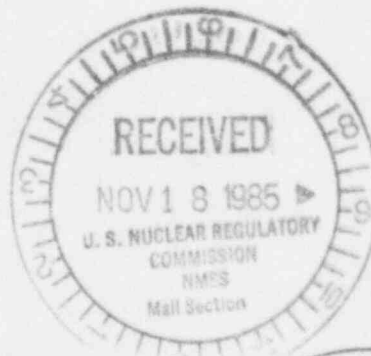

Dear Mr. Nixon:

The additional information you requested concerning our license amendment request to construct a haul road between the factory and disposal areas of the West Chicago facility is provided below.

Building Rubble Contamination Levels

The building rubble to be used for the road base is estimated to have average surface contamination levels of 500 dpm/100 cm<sup>2</sup> direct alpha and less than 50 dpm/100 cm<sup>2</sup> removable alpha. These averages are based upon the results of the detailed pre-demolition surveys of the buildings and post-demolition follow-up "spot" checks of the rubble.

We noted in our road construction amendment request that the rubble, on an average basis, meets unrestricted release limits; however all the material would not meet the criteria. It is not cost effective to survey and release the majority of the rubble, especially since it can be used productively on-site. As stated in our amendment request, the building rubble used for the road construction will be removed from the Intermediate Site and placed into the Disposal Cell following completion of the Factory Site decontamination work. If the building rubble that is already on-site were not used, off-site material would have to be obtained and brought on-site for this road construction.

On-site vehicles which will use the new road and vehicles which now use the existing driveway will not be surveyed prior to movement across the Intermediate Site area.

8512090524 851112  
PDR ADOCK 04002061  
C PDR

**FEE EXEMPT**

26060

Mr. William A. Nixon  
November 12, 1985  
Page Two

Intermediate Site License

The July 25, 1979 renewal application for License STA-583 updated the property description for our licensed facility in West Chicago by including the then recently purchased two parcels of land that comprise the Intermediate Site. We have considered the Intermediate Site to be a licensed part of the West Chicago facility since that time. A letter dated May 16, 1980 was received from your office indicating that our application met the requirements of timely renewal and our license would remain in effect. Copies of Kerr-McGee's license renewal application and NRC's timely renewal letter are attached.

We appreciate your timely consideration of this information and issuance of the license amendment so that construction of the haul road can begin as soon as possible.

Sincerely,

A handwritten signature in cursive script that reads "J.C. Stauter".

J.C. Stauter, Director  
Nuclear Licensing & Regulation

SCM/br

**KERR-McGEE**

July 20, 1979



Mr. William T. Crow  
Fuel Processing & Fabrication Branch  
Division of Fuel Cycle & Material Safety  
U.S. Nuclear Regulatory Commission  
Washington, D.C. 20555

Re: Docket No. 40-2061

Dear Mr. Crow:

This letter, the enclosed form NRC-2 and other attachments is an application for renewal of License No. STA-583 for the Kerr-McGee Chemical Corporation.

The drawing No. C11049.1 attached, updates previous drawings by showing two parcels of land recently purchased by Kerr-McGee. These are identified as No.'s 1515 and 1516 on the drawing. The attachment marked Exhibit "A" is the legal description of this property.

The application is brief at this time. As you know, a detailed decommissioning plan will be submitted to the Commission within a few weeks.

Also attached is our remittance for \$70 for your license renewal application fee.

Please contact me if you need additional information.

Very truly yours,

*W. J. Shelley*  
W. J. Shelley, Director  
Regulation & Control

WJS:jh

Attachments

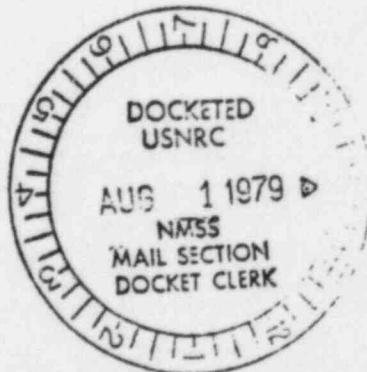

7908220184

7908220184

12527

U.S. NUCLEAR REGULATORY COMMISSION  
APPLICATION FOR SOURCE MATERIAL LICENSE

Pursuant to the regulations in Title 10, Code of Federal Regulations, Chapter 1, Part 40, application is hereby made for a license to receive, possess, use, transfer, deliver or import into the United States, source material for the activity or activities described.

1. (Check one) <input type="checkbox"/> (a) New license <input type="checkbox"/> (b) Amendment to License No. _____ <input checked="" type="checkbox"/> (c) Renewal of License No. <u>STA 583</u> <input type="checkbox"/> (d) Previous License No. _____		2. NAME OF APPLICANT <u>Kerr-McGee Chemical Corporation</u>	
		3. PRINCIPAL BUSINESS ADDRESS <u>Kerr-McGee Center</u> <u>Oklahoma City, Oklahoma 73125</u>	
4. STATE THE ADDRESS(ES) AT WHICH SOURCE MATERIAL WILL BE POSSESSED OR USED <u>258 Ann St. West Chicago Illinois 60185</u>			
5. NAME OF PERSON TO BE CONTACTED CONCERNING THIS APPLICATION <u>Wm. J. Shelley</u>		6. TELEPHONE NO. OF INDIVIDUAL NAMED IN ITEM 5 <u>405-270-2631</u>	
7. DESCRIBE PURPOSE FOR WHICH SOURCE MATERIAL WILL BE USED <u>For storage and distribution only.</u>			
8. STATE THE TYPE OR TYPES, CHEMICAL FORM OR FORMS, AND QUANTITIES OF SOURCE MATERIAL YOU PROPOSE TO RECEIVE, POSSESS, USE, OR TRANSFER UNDER THE LICENSE			
(a) TYPE	(b) CHEMICAL FORM	(c) PHYSICAL FORM (Including % U or Th.)	(d) MAXIMUM AMOUNT AT ANY ONE TIME (kilograms)
NATURAL URANIUM			
URANIUM DEPLETED IN THE 235 ISOTOPE			
THORIUM ISOTOPE	Ores, compounds and wastes (natural Thorium)	solids & liquids	unlimited
(e) MAXIMUM TOTAL QUANTITY OF SOURCE MATERIAL YOU WILL HAVE ON HAND AT ANY TIME (kilograms) <u>Unlimited</u>			
9. DESCRIBE THE CHEMICAL, PHYSICAL, METALLURGICAL, OR NUCLEAR PROCESS, OR PROCESSES IN WHICH THE SOURCE MATERIAL WILL BE USED. INDICATE THE MAXIMUM AMOUNT OF SOURCE MATERIAL INVOLVED IN EACH PROCESS AT ANY ONE TIME, AND PROVIDING A THOROUGH EVALUATION OF THE POTENTIAL RADIATION HAZARDS ASSOCIATED WITH EACH STEP OF THOSE PROCESSES. <u>Processing terminated 12/31/73. Activities involve (1) packaging &amp; sale of material, (2) disposal of waste.</u>			
10. LIST THE NAMES AND ATTACH A RESUME OF THE TECHNICAL QUALIFICATIONS INCLUDING TRAINING AND EXPERIENCE OF APPLICANT'S SUPERVISORY PERSONNEL AND THE PERSON RESPONSIBLE FOR THE RADIATION SAFETY PROGRAM (OR OF APPLICANT IF AN INDIVIDUAL). <u>Supervisors have 8-30 years experience in thorium and rare earth manufacturing. A graduate engineer is in charge of the facility and its programs.</u>			
11. DESCRIBE THE EQUIPMENT AND FACILITIES WHICH WILL BE USED TO PROTECT HEALTH AND MINIMIZE DANGER TO LIFE OR PROPERTY AND RELATE THE USE OF THE EQUIPMENT AND FACILITIES TO THE OPERATIONS LISTED IN ITEM 9. INCLUDE (a) RADIATION DETECTION AND RELATED INSTRUMENTS (including film badges, dosimeters, counters, air sampling, and other survey equipment as appropriate. The description of radiation detection instruments should include the instrument characteristics such as type of radiation detected, window thickness, and the range(s) of each instrument). <u>A monthly film badge program is in effect.</u>			
(b) METHOD, FREQUENCY, AND STANDARDS USED IN CALIBRATING INSTRUMENTS LISTED IN (a) ABOVE, INCLUDING AIR SAMPLING EQUIPMENT (for film badges, specify method of calibrating and processing, or name supplier). <u>Film badges are supplied by R.S. Landauer Jr. &amp; Co.</u>			

7908220192

12527

VENTILATION EQUIPMENT WHICH WILL BE USED IN OPERATIONS WHICH PRODUCE DUST, FUMES, MISTS, OR GASES, INCLUDING PLAN VIEW SHOWING TYPE AND LOCATION OF HOOD AND FILTERS, MINIMUM VELOCITIES MAINTAINED AT HOOD OPENINGS AND PROCEDURES FOR TESTING SUCH EQUIPMENT.

The shipping warehouse small package station is a ventilated hood served by a Torit dust collector, model 124. Loading is 2800 c.f.m.

12. DESCRIBE PROPOSED PROCEDURES TO PROTECT HEALTH AND MINIMIZE DANGER TO LIFE AND PROPERTY AND RELATE THESE PROCEDURES TO THE OPERATIONS LISTED IN ITEM 9, INCLUDING: (1) SAFETY FEATURES AND PROCEDURES TO AVOID NONNUCLEAR ACCIDENTS, SUCH AS FIRE, EXPLOSION, ETC. IN SOURCE MATERIAL STORAGE AND PROCESSING AREAS.

Prior to equipment or building demolition or dismantlement or earth moving operation, an assessment of the radiation hazard is made. An airborne radiation survey is made during the initial operation. Corrective and/or protective measures are taken to minimize airborne exposures.

(2) EMERGENCY PROCEDURES IN THE EVENT OF ACCIDENTS WHICH MIGHT INVOLVE SOURCE MATERIAL.

Spill clean-up & decontamination measures are taken.

(3) DETAILED DESCRIPTION OF RADIATION SURVEY PROGRAM AND PROCEDURES.

Radiation surveys are conducted by Health Physics Associates, Ltd., Eberline Instrument Co. or Chemical Nuclear Systems, Inc. at our request.

13. WASTE PRODUCTS: If none will be generated, state "None" opposite (a), below. If waste products will be generated, check here ☐ and explain on a supplemental sheet:

(a) Quantity and type of radioactive waste that will be generated.

(b) Detailed procedures for waste disposal.

Decommissioning & Disposal Plan Pending

14. IF PRODUCTS FOR DISTRIBUTION TO THE GENERAL PUBLIC UNDER AN EXEMPTION CONTAINED IN 12 CFR 40 ARE TO BE MANUFACTURED, USE A SUPPLEMENTAL SHEET TO FURNISH A DETAILED DESCRIPTION OF THE PRODUCT, INCLUDING:

(a) PERCENT SOURCE MATERIAL IN THE PRODUCT AND ITS LOCATION IN THE PRODUCT.

(b) PHYSICAL DESCRIPTION OF THE PRODUCT INCLUDING CHARACTERISTICS, IF ANY, THAT WILL PREVENT INHALATION OR INGESTION OF SOURCE MATERIAL THAT MIGHT BE SEPARATED FROM THE PRODUCT.

(c) BETA AND BETA PLUS GAMMA RADIATION LEVELS (Specify instrument used, date of calibration and calibration technique used) AT THE SURFACE OF THE PRODUCT AND AT 12 INCHES.

(d) METHOD OF ASSURING THAT SOURCE MATERIAL CANNOT BE DISASSOCIATED FROM THE MANUFACTURED PRODUCT.

### CERTIFICATE

(This item must be completed by applicant)

The applicant, and any official executing this certificate on behalf of the applicant named in Item 2, certify that this application is prepared in conformity with Title 10, Code of Federal Regulations, Part 40, and that all information contained herein, including any supplements attached hereto, is true and correct to the best of our knowledge and belief.

BY: J. L. Rainey

(Signature)

Dated July 25, 1979

J. L. Rainey

(Print or type name)

President

(Title of certifying official authorized to act on behalf of the applicant)

WARNING: 18 U.S.C. Section 1001; Act of June 25, 1948; 62 Stat. 749; makes it a criminal offense to make a willfully false statement or representation to any department or agency of the United States as to any matter within its jurisdiction.



PARCEL 1: That part of the South East Quarter of Section 9, Township 39 North, Range 9, East of the Third Principal Meridian, described as follows: Beginning at the intersection of the North line of Lester Street with the East line of Factory Street produced South; thence West with and along said North line of Lester Street produced West, 50.0 Feet, more or less, to the intersection of said North line produced with the West line of Factory Street produced South; thence South with and along said West line of Factory Street produced, 50.0 Feet, more or less, to the intersection of said West line of Factory Street produced with the South line of Lester Street produced west; thence West with and along said South line of Lester Street produced, 246.10 Feet, more or less, to a point on the Easterly right of way line of the Elgin, Joliet and Eastern Railway Company; thence North Easterly with and along said Easterly Right of way line of the Elgin, Joliet and Eastern Railway Company, 194.0 Feet, more or less, to the South West Corner of the land conveyed to the Public Service Company of Northern Illinois by deed recorded October 21, 1952, as document 665510; thence East 100.0 Feet on a line parallel with the South Line of Lot 3 in the Lindsay Light and Chemical Company assessment plat; thence North Easterly, parallel with the Easterly right of way line of the Elgin, Joliet and Eastern Railway Company, 97.97 Feet to a point 12.0 Feet South, measured on a line parallel with the West line of Factory Street, of the South line of Lot 3 in the Lindsay Light and Chemical Company assessment plat; thence East, parallel with the South Line of said Lot 3, 185.05 Feet, more or less, to the East line of Factory Street; thence South with and along said East Line of Factory Street produced South, 239.2 Feet more or less, to the place of beginning, in DuPage County, Illinois.

PARCEL 2: That part of the South East Quarter of Section 9, Township 39 North, Range 9, East of the Third Principal Meridian, described as follows: Beginning at the intersection of the North Line of Lester Street with the West Line of East Street and running thence West with and along said North Line of Lester Street, 542.79 Feet, more or less, to the East Line of Factory Street produced South (being the East line of Parcel 1 Described above); thence North with and along said East Line of Factory Street produced and the East Line of Factory Street, 462.0 Feet, more or less, to the intersection of the East line of Factory Street with the South line of the alley in Block 2 in Viant's Addition to Turner (now West Chicago), a subdivision of part of the South East Quarter of the South East Quarter of Section 9, aforesaid according to the plat thereof recorded January 3, 1893, as Document 50836; thence East with and along the South line of said alley, 536.24 feet, more or less, to the intersection of said South line with the West line of East Street; thence South with and along said West line of East Street, 462.0 Feet, more or less, to the place of beginning, in DuPage County, Illinois.

Parcel No.	Description/Proposed Use
1	Office and commercial use
2	Office and commercial use
3	Office and commercial use
4	Office and commercial use
5	Office and commercial use
6	Office and commercial use
7	Office and commercial use
8	Office and commercial use
9	Office and commercial use
10	Office and commercial use
11	Office and commercial use
12	Office and commercial use
13	Office and commercial use
14	Office and commercial use
15	Office and commercial use
16	Office and commercial use
17	Office and commercial use
18	Office and commercial use
19	Office and commercial use
20	Office and commercial use
21	Office and commercial use

PARCEL NO.	DATE ACQUIRED	AREA (ACRES)	CUMULATIVE ACRES
1501	7/11/31	4.769	4.769
1501a	7/11/31	0.006	4.775
1502	6/30/41	0.203	4.978
1503	8/12/43	2.971	7.949
1505	9/4/51	0.252	8.201
1506	10/1/51	0.152	8.353
1507	1/2/52	12.674	21.027
1508	4/28/55	0.558	21.585

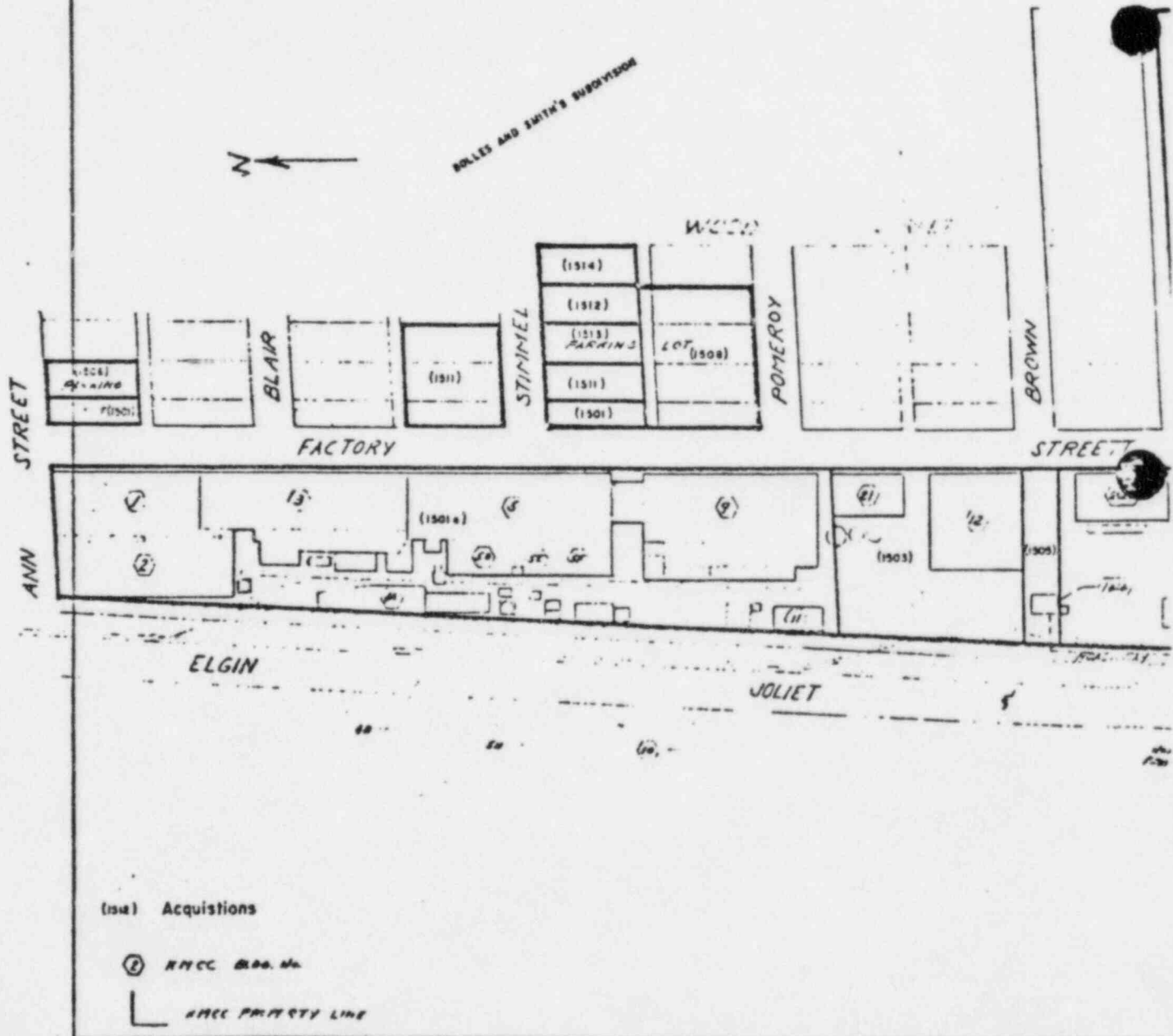

PARCEL NO.	DATE ACQUIRED	AREA (ACRES)	CUMULATIVE ACRES
1509	10/27/55	14.55	36.135
1510	11/14/56	0.057	36.192
1511	8/16/60	0.558	36.750
1512	9/30/60	0.152	36.902
1513	9/30/60	0.152	37.054
1514	11/21/60	0.152	37.206
1515	7/15/79	1.687	38.689
1516	7/15/79	6.682	45.371

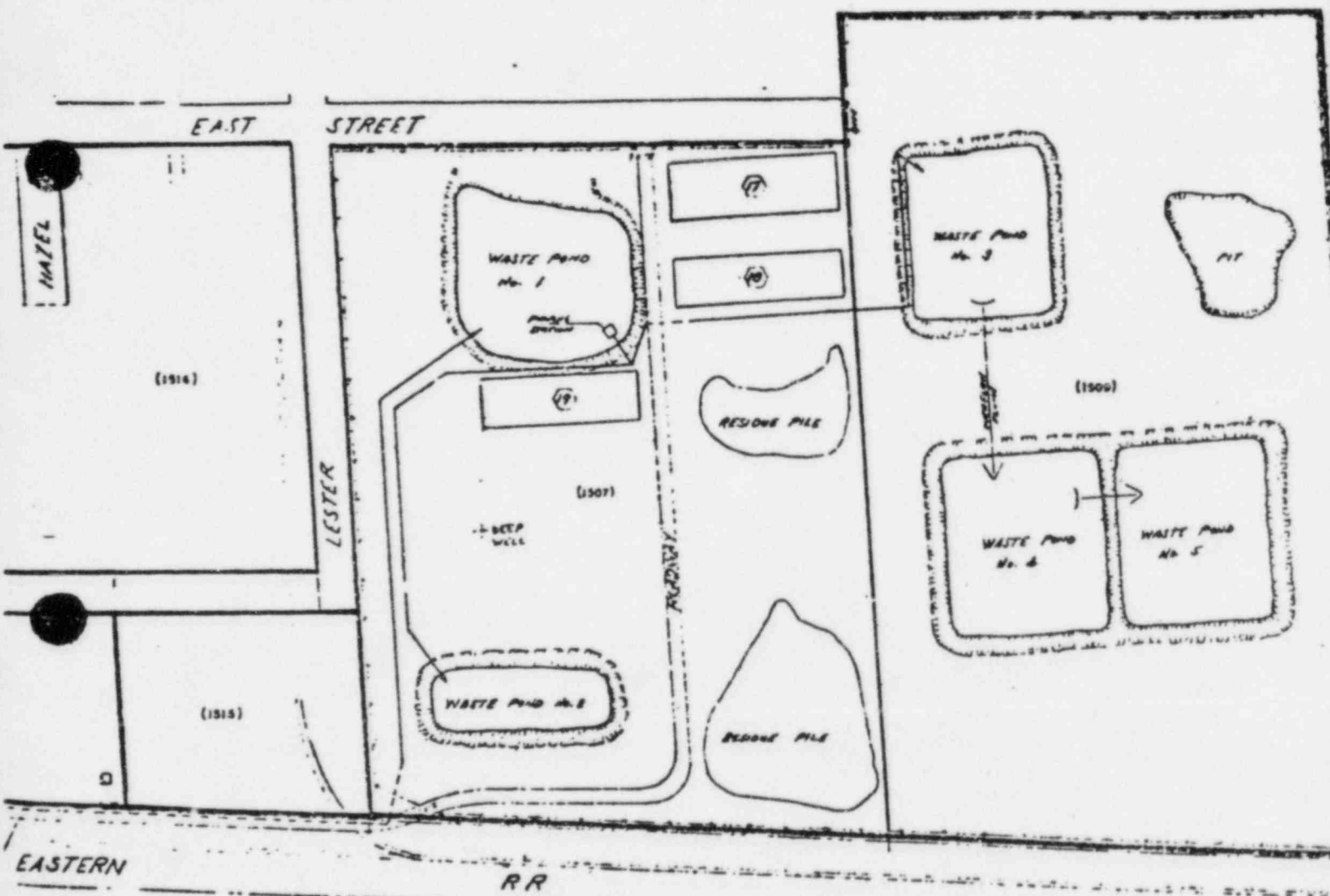

		DESCRIPTION		PROPERTY PLAN WEST CHICAGO PLANT		BRIDGES ENGINEERING DIVISION 1000 NORTH MICHIGAN AVE. CHICAGO, ILL. 60611 WEST CHICAGO, ILL. 60451	
DATE	REV. NO.	REVISION	DATE	REV. NO.	APP.	SCALE	NO.
5-6-72	1	ADD PANEL A, B, C, D, E, F, G, H, I, J, K, L, M, N, O, P, Q, R, S, T, U, V, W, X, Y, Z	5-6-72	1	APP.	1" = 10' FT	C11049-1





UNITED STATES  
NUCLEAR REGULATORY COMMISSION  
WASHINGTON, D. C. 20555

MAY 16 1980

Docket No. 40-2061  
License No. STA-583

Kerr-McGee Chemical Corporation  
ATTN: Mr. William J. Shelley, Director  
Regulation and Control  
Kerr-McGee Center  
Oklahoma City, Oklahoma 73125

Gentlemen:

Your application dated July 25, 1979, for renewal of License No. STA-583, Docket No. 40-2061, is considered to meet the timely renewal provisions of §40.43(b) of 10 CFR Part 40. Your license will remain in effect pending completion of our renewal review and action.

Sincerely,

A handwritten signature in dark ink, appearing to read "R. G. Page", is written above the typed name.

R. G. Page, Acting Chief  
Uranium Fuel Licensing Branch  
Division of Fuel Cycle and  
Material Safety

6006+20236

DOCKET NO. 40-2061  
CONTROL NO. 26060  
DATE OF DOC. 11/12/85  
DATE RCVD. 11/18/85  
FCUF ☒ PDR ☒  
FCAF ☐ LPDR ☒  
WM ☐ I&E REF. ☒  
WMUR ☐ SAFEGUARDS ☐  
PCTC ☐ OTHER ☐

DESCRIPTION:

Additional information  
you requested  
concerning their  
license amendment  
request  
11/21/85 INITIAL CEC