

Gibson Community Hospital

Daniel J. Marion, Executive Director

1120 N. Melvin Street • GIBSON CITY, ILLINOIS 60936 • Telephone (217) 784-4251

June 25, 1985

Dr. Bruce S. Mallett
Materials Licensing Section
U.S. Nuclear Regulatory Commission
799 Roosevelt Road
Glen Ellyn, Illinois 60137

Dear Dr. Mallett:

Enclosed please find the results of the "close-out survey" of the Gibson Community Hospital. Please note, our Cesium 137 source will be transferred to Nuclear Diagnostics, Inc., License Number 12-24416-01.

It is my understanding that all pertinent rules and regulations are now satisfied. If I am incorrect, please contact me immediately. Thank you for your cooperation regarding this matter.

Sincerely yours,

Daniel J. Marion
Executive Director

DJM:pb
Enclosure

cc: Charles G. Burchett

8512060133 850712
REG3 LIC30
12-16728-02 PDR

Feb-11 III
RECEIVED *tem*

JUN 27 1985

REGION III

78221
JUN 27 1985

ACUTE CARE HOSPITAL • SKILLED NURSING FACILITY

BOARD OF DIRECTORS

James A. Hager, President
John R. Noble, Vice-President
Grant Conibear, Secretary
George R. Walter, Treasurer
Daniel J. Marion, Executive Director

Walter Arends
Ernest E. Brown
George Elfers, M. D.
W. T. Francis
George Y. Harris
Anita McKeever

Elmo Meiners
Eugene A. Roth
William Stack
Meryl Sturm
Somchai Supawanich, M. D.



RADIATION PROTECTION CONSULTANTS, LTD.

Serving Radiology, Nuclear Medicine, Therapy and Industrial Facilities Since 1968
710 EAST OGDEN AVENUE, SUITE 106
NAPERVILLE, ILLINOIS 60540
PHONE: (312) 369-6488

CLOSEOUT SURVEY REPORT

Performed For: *Dibson Community Hospital*

Date Performed: *6-4-85*

Instruments Used: *Survey Meter + Searle Wall Counter Model 8725*

Data: * See attached diagram for area location in reference

Survey Location
Rm. No. *Area

Results - mR/hr		Wipes	
Background = .02 mR/hr		Results - CPM	
		Background = 25 cpm	
1	.01	1	0 cpm
2	.01	2	0 "
3	.01	3	1 "
4	.02	4	1 "
5	0	5	0 "
6	0	6	0 "
7	.01	7	1 "
8	.02	8	0 "
9	.01	9	0 "
10	.01	10	0 "
11	.01		

Results:

- ☒ Results show no evidence of contamination
☐ Results show evidence of contamination; see comments
☐ See comments

Comments:

Performed by:

Ronald D Edwards

Ronald D. Edwards,
Health Physicist

Gibson City Comm. Hosp.

12 1/2' outside wall

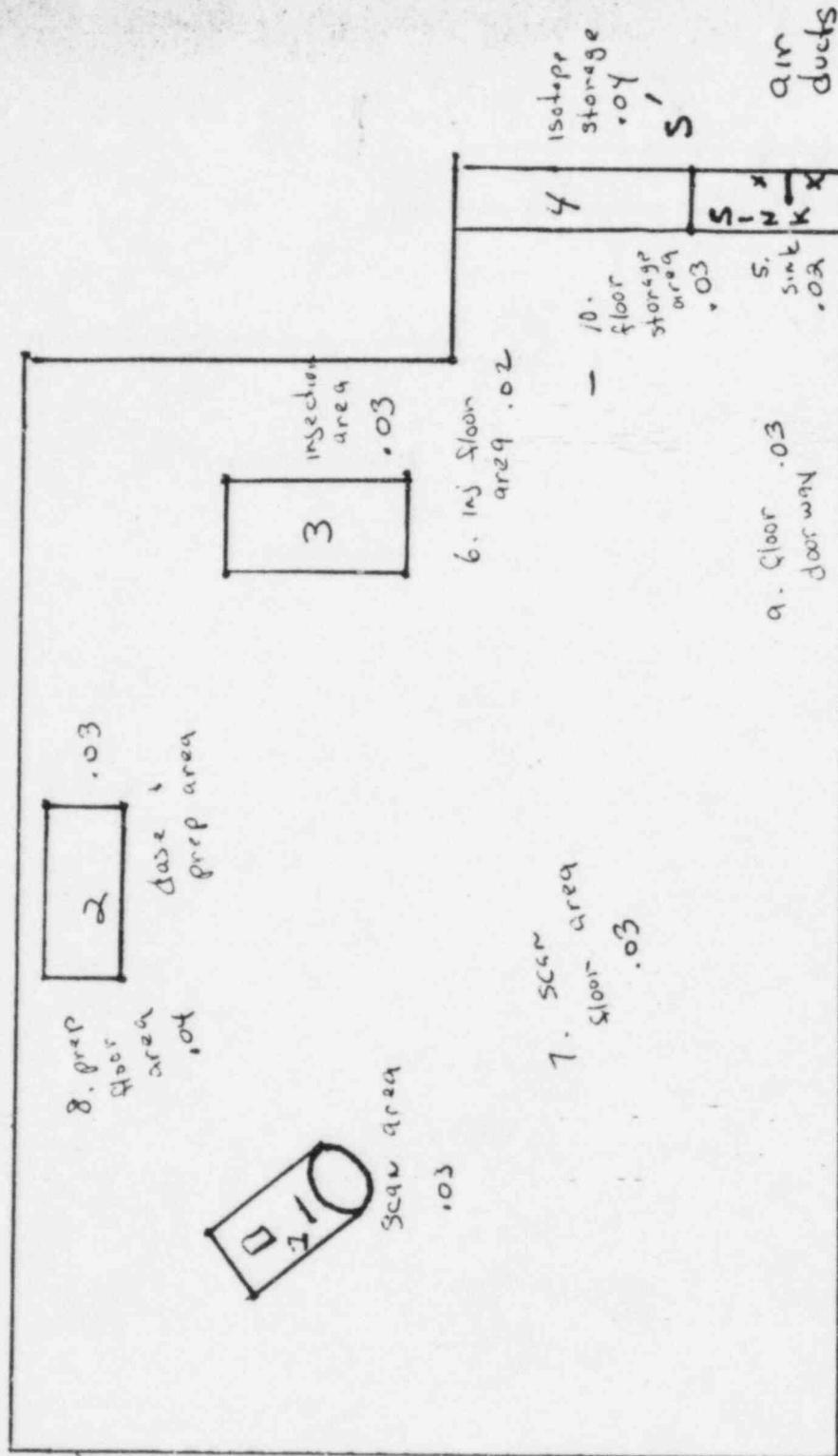

16 1/2'

ΣKG treadmill

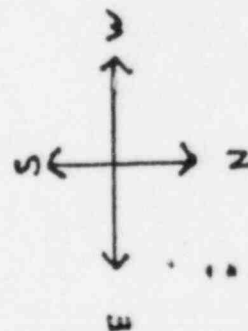

hallway

Readings # mr/hr