

MERCK SHARP & DOHME RESEARCH LABORATORIES

DIVISION OF MERCK & CO., INC.

P. O. BOX 2000, RAHWAY, NEW JERSEY 07065-0900

September 9, 1985

U. S. Nuclear Regulatory Commission
Region I
631 Park Avenue
King of Prussia, PA 19406

Gentlemen:

Re: License No. 29-00117-07

1. It is planned to relocate our Gamma Cell 1000 which contains no more than 3,264 Curies of Cs-137, from its present location in Building 80W, Room No. 132, to Room No. 135 in the same building for efficient utilization of existing space.
2. The attached sketch indicates the planned change.
3. The constant monitoring system and the external visible light warning system will be relocated at the time of the move.
4. The irradiator will be moved in toto by representatives from the Canadian AEC, from whom the device was purchased and initially installed.
5. After installation and prior to activation of the irradiation program, a radiation survey will be conducted to determine radiation levels around, above and below the irradiator with (a) the source in the irradiate position and (b) the source in the shielded position. Appropriate wipe testing will also be performed. Results will be forwarded to the U. S. Nuclear Regulatory Commission, Region I, King of Prussia, PA. 19406.
6. An amendment fee of \$40.00 is enclosed.

Very truly yours,

A. W. Wase
A. W. Wase, Ph.D.
MSDRL Health Physicist

/mk

Encl. Check
Sketch

U.S. N.R.C.
LIC FEE MGMT. BRANCH

85 SEP 20 10:54

RECEIVED

RECEIVED-REGION I
1985 SEP 11 PM 1:40

Sept - 12 I

Applicant	0614854/79672
Check No.	0614854/79672
Amount/Fee	\$40.00
Type of Fee	Amendment
Date Check Recd.	9/26/85
Received By	J. Wase / C. Wase

"OFFICIAL RECORD COPY"

ML10

104376

8512040311 851024
REG1 LIC30
29-00117-07 PDR

SEP 11 1985

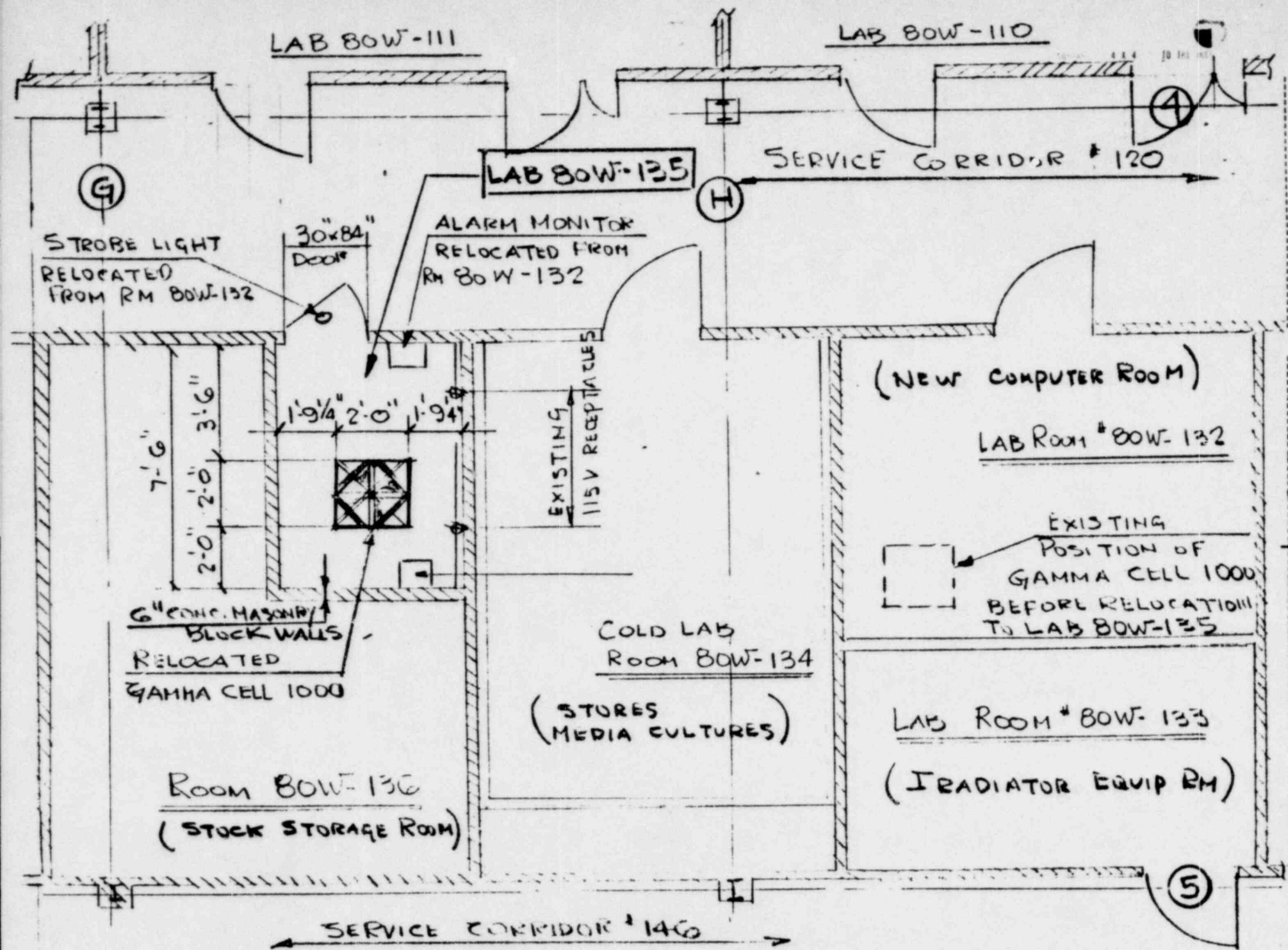

GAMMA CELL 1000 - RELOCATION