

APPLICATION FOR MATERIALS LICENSE - MEDICAL

INSTRUCTIONS - Complete Items 1 through 26 if this is an initial application or an application for renewal of a license. Use supplemental sheets where necessary. Item 26 must be completed on all applications and signed. Retain one copy. Submit original and one copy of entire application to: Director, Office of Nuclear Materials Safety and Safeguards, U.S. Nuclear Regulatory Commission, Washington, D.C. 20555. Upon approval of this application, the applicant will receive a Materials License. An NRC Materials License is issued in accordance with the general requirements contained in Title 10, Code of Federal Regulations, Part 30, and the Licensee is subject to Title 10, Code of Federal Regulations, Parts 19, 20 and 35 and the license fee provision of Title 10, Code of Federal Regulations, Part 170. The license fee category should be stated in Item 26 and the appropriate fee enclosed.

<p>1.a. NAME AND MAILING ADDRESS OF APPLICANT (institution, firm, clinic, physician, etc.) INCLUDE ZIP CODE</p> <p>The Tri County Diagnostic Center Pottstown Professional Mall Medical Drive Pottstown, Pennsylvania 19464</p> <p>TELEPHONE NO.: AREA CODE: _____</p>	<p>1.b. STREET ADDRESS(ES) AT WHICH RADIOACTIVE MATERIAL WILL BE USED (if different from 1.a.) INCLUDE ZIP CODE</p> <p>same</p>
<p>2. PERSON TO CONTACT REGARDING THIS APPLICATION</p> <p>Glenn H. Moran</p> <p>TELEPHONE NO.: AREA CODE (301) 654 - 0434</p>	<p>3. THIS IS AN APPLICATION FOR: (Check appropriate item)</p> <p>a. <input checked="" type="checkbox"/> NEW LICENSE</p> <p>b. <input type="checkbox"/> AMENDMENT TO LICENSE NO. _____</p> <p>c. <input type="checkbox"/> RENEWAL OF LICENSE NO. _____</p>
<p>4. INDIVIDUAL USERS (Name individuals who will use or directly supervise use of radioactive material. Complete Supplements A and B for each individual.)</p> <p>Clifford Turner, M.D.</p>	<p>5. RADIATION SAFETY OFFICER (RSO) (Name of person designated as radiation safety officer. If other than individual user, complete resume of training and experience as in Supplement A.)</p> <p>Clifford Turner, M.D.</p>

6.a. RADIOACTIVE MATERIAL FOR MEDICAL USE

RADIOACTIVE MATERIAL LISTED IN:	ITEMS DESIRED	MAXIMUM POSSESSION LIMITS	ADDITIONAL ITEMS:	MARK ITEMS DESIRED	MAXIMUM POSSESSION LIMITS
10 CFR 31.11 FOR IN VITRO STUDIES	"X"	(In millicuries)	IODINE-131 AS IODIDE FOR TREATMENT OF HYPERTHYROIDISM	"X"	(In millicuries)
10 CFR 35.100, SCHEDULE A, GROUP I		AS NEEDED	PHOSPHORUS-32 AS SOLUBLE PHOSPHATE FOR TREATMENT OF POLYCYTHEMIA VERA, LEUKEMIA AND BONE METASTASES		
10 CFR 35.100, SCHEDULE A, GROUP II		AS NEEDED	PHOSPHORUS-32 AS COLLOIDAL CHROMIC PHOSPHATE FOR INTRACAVITARY TREATMENT OF MALIGNANT EFFUSIONS.		
10 CFR 35.100, SCHEDULE A, GROUP III			GOLD-198 AS COLLOID FOR INTRACAVITARY TREATMENT OF MALIGNANT EFFUSIONS.		
10 CFR 35.100, SCHEDULE A, GROUP IV		AS NEEDED	IODINE-131 AS IODIDE FOR TREATMENT OF THYROID CARCINOMA		
10 CFR 35.100, SCHEDULE A, GROUP V		AS NEEDED	XENON-133 AS GAS OR GAS IN SALINE FOR BLOOD FLOW STUDIES AND PULMONARY FUNCTION STUDIES		
10 CFR 35.100, SCHEDULE A, GROUP VI					

6.b. RADIOACTIVE MATERIAL FOR USES NOT LISTED IN ITEM 6.a. (Sealed sources up to 3 mCi used for calibration and reference standards are authorized under Section 35.14(d), 10 CFR Part 35, and NEED NOT BE LISTED.)

ELEMENT AND MASS NUMBER	CHEMICAL AND/OR PHYSICAL FORM	MAXIMUM NUMBER OF MILLICURIES OF EACH FORM	DESCRIBE PURPOSE OF USE
Gadolinium - 153	Sealed Source (Gulf Nuclear Model No. GD-1)	2,000 mCi Total (1,000 per Source, one Source for Source exchange)	To be used in NOVO Diagnostic system dual photon bone densitometer for bone mineral analysis of humans.

"OFFICIAL RECORD COPY"

04191

8509190046 850828
REG1 LIC30
37-20893-01 PDR

INFORMATION REQUIRED FOR ITEMS 7 THROUGH 23

For Items 7. through 23, check the appropriate box(es) and submit a detailed description of all the requested information. Begin each item on a separate sheet. Identify the item number and the date of the application in the lower right corner of each page. If you indicate that an appendix to the medical licensing guide will be followed, do not submit the pages, but specify the revision number and date of the referenced guide: Regulatory Guide 10.8, Rev. 1 Date: October 1980

7. MEDICAL ISOTOPES COMMITTEE N/A		15. GENERAL RULES FOR THE SAFE USE OF RADIOACTIVE MATERIAL (Check One)	
<input type="checkbox"/>	Names and Specialties Attached; and	<input type="checkbox"/>	Appendix G Rules Followed; or
<input type="checkbox"/>	Duties as in Appendix B; or (Check One)	<input checked="" type="checkbox"/>	Equivalent Rules Attached
<input type="checkbox"/>	Equivalent Duties Attached	16. EMERGENCY PROCEDURES (Check One)	
8. TRAINING AND EXPERIENCE		<input type="checkbox"/>	Appendix H Procedures Followed; or
<input checked="" type="checkbox"/>	Supplements A & B Attached for Each Individual User; and	<input checked="" type="checkbox"/>	Equivalent Procedures Attached
<input type="checkbox"/>	Supplement A Attached for RSO.	17. AREA SURVEY PROCEDURES (Check One)	
9. INSTRUMENTATION (Check One)		<input type="checkbox"/>	Appendix I Procedures Followed; or
<input type="checkbox"/>	Appendix C Form Attached; or	<input checked="" type="checkbox"/>	Equivalent Procedures Attached See item 15: Para J & K
<input checked="" type="checkbox"/>	List by Name and Model Number	18. WASTE DISPOSAL (Check One)	
10. CALIBRATION OF INSTRUMENTS N/A		<input type="checkbox"/>	Appendix J Form Attached; or
<input type="checkbox"/>	Appendix D Procedures Followed for Survey Instruments; or (Check One)	<input checked="" type="checkbox"/>	Equivalent Information Attached
<input type="checkbox"/>	Equivalent Procedures Attached; and	19. THERAPEUTIC USE OF RADIOPHARMACEUTICALS (Check One) N/A	
<input type="checkbox"/>	Appendix D Procedures Followed for Dose Calibrator; or (Check One)	<input type="checkbox"/>	Appendix K Procedures Followed; or
<input type="checkbox"/>	Equivalent Procedures Attached	<input type="checkbox"/>	Equivalent Procedures Attached
11. FACILITIES AND EQUIPMENT		20. THERAPEUTIC USE OF SEALED SOURCES N/A	
<input checked="" type="checkbox"/>	Description and Diagram Attached	<input type="checkbox"/>	Detailed Information Attached; and
12. PERSONNEL TRAINING PROGRAM		<input type="checkbox"/>	Appendix L Procedures Followed; or (Check One)
<input checked="" type="checkbox"/>	Description of Training Attached	<input type="checkbox"/>	Equivalent Procedures Attached
13. PROCEDURES FOR ORDERING AND RECEIVING RADIOACTIVE MATERIAL		21. PROCEDURES AND PRECAUTIONS FOR USE OF RADIOACTIVE GASES (e.g., Xenon - 133) N/A	
<input checked="" type="checkbox"/>	Detailed Information Attached	<input type="checkbox"/>	Detailed Information Attached
14. PROCEDURES FOR SAFELY OPENING PACKAGES CONTAINING RADIOACTIVE MATERIALS (Check One)		22. PROCEDURES AND PRECAUTIONS FOR USE OF RADIOACTIVE MATERIAL IN ANIMALS N/A	
<input type="checkbox"/>	Appendix F Procedures Followed; or	<input type="checkbox"/>	Detailed Information Attached
<input type="checkbox"/>	Equivalent Procedures Attached	23. PROCEDURES AND PRECAUTIONS FOR USE OF RADIOACTIVE MATERIAL SPECIFIED IN ITEM 6.b N/A	
<input type="checkbox"/>		<input type="checkbox"/>	Detailed Information Attached

24. PERSONNEL MONITORING DEVICES

T.Y.P.E (Check appropriate box)		SUPPLIER	EXCHANGE FREQUENCY
a. WHOLE BODY	<input checked="" type="checkbox"/> FILM	R.S. Landauer, Inc., or equivalent	Monthly
	<input type="checkbox"/> TLD		
	<input type="checkbox"/> OTHER (Specify)		
b. FINGER	<input type="checkbox"/> FILM		
	<input type="checkbox"/> TLD		
	<input type="checkbox"/> OTHER (Specify)		
c. WRIST	<input type="checkbox"/> FILM		
	<input type="checkbox"/> TLD		
	<input type="checkbox"/> OTHER (Specify)		

d. OTHER (Specify)

Aug-14-85
 Applicant: J. Cardia, Inc.
 3735
 #580-7C
 App. 8/14/85
 Received by: J. H. H.

25. FOR PRIVATE PRACTICE APPLICANTS ONLY N/A

a. HOSPITAL AGREEING TO ACCEPT PATIENTS CONTAINING RADIOACTIVE MATERIAL

NAME OF HOSPITAL

MAILING ADDRESS

CITY

STATE

ZIP CODE

b. ATTACH A COPY OF THE AGREEMENT LETTER SIGNED BY THE HOSPITAL ADMINISTRATOR.

c. WHEN REQUESTING THERAPY PROCEDURES, ATTACH A COPY OF RADIATION SAFETY PRECAUTIONS TO BE TAKEN AND LIST AVAILABLE RADIATION DETECTION INSTRUMENTS.

26. CERTIFICATE

(This item must be completed by applicant)

The applicant and any official executing this certificate on behalf of the applicant named in Item 1a certify that this application is prepared in conformity with Title 10, Code of Federal Regulations, Parts 30 and 35, and that all information contained herein, including any supplements attached hereto, is true and correct to the best of our knowledge and belief.

a. LICENSE FEE REQUIRED
 (See Section 170.31, 10 CFR 170)

(1) LICENSE FEE CATEGORY: 7C

(2) LICENSE FEE ENCLOSED: \$ 580.00

b. APPLICANT OR CERTIFYING OFFICIAL (Signature)

Glenn H. Moran Jr.
 (1) NAME (Type of Print)
 Glenn H. Moran Jr., B.S. CNMT

(2) TITLE
 Director - Nuclear Medicine Services

c. DATE
 7/24/85

PRIVACY ACT STATEMENT

Pursuant to 5 U.S.C. 552a(e)(3), enacted into law by section 3 of the Privacy Act of 1974 (Public Law 93-579), the following statement is furnished to individuals who supply information to the Nuclear Regulatory Commission on NRC Form 313M. This information is maintained in a system of records designated as NRC-3 and described at 40 Federal Register 45334 (October 1, 1975).

1. **AUTHORITY** Sections 81 and 161(b) of the Atomic Energy Act of 1954, as amended (42 U.S.C. 2111 and 2201(b)).
2. **PRINCIPAL PURPOSE(S)** The information is evaluated by the NRC staff pursuant to the criteria set forth in 10 CFR Parts 30-36 to determine whether the application meets the requirements of the Atomic Energy Act of 1954, as amended, and the Commission's regulations, for the issuance of a radioactive material license or amendment thereof.
3. **ROUTINE USES** The information may be used: (a) to provide records to State health departments for their information and use; and (b) to provide information to Federal, State, and local health officials and other persons in the event of incident or exposure, for their information, investigation, and protection of the public health and safety. The information may also be disclosed to appropriate Federal, State, and local agencies in the event that the information indicates a violation or potential violation of law and in the course of an administrative or judicial proceeding. In addition, this information may be transferred to an appropriate Federal, State, or local agency to the extent relevant and necessary for a NRC decision or to an appropriate Federal agency to the extent relevant and necessary for that agency's decision about you. A copy of the license issued will routinely be placed in the NRC's Public Document Room, 1717 H Street, N.W., Washington, D.C.
4. **WHETHER DISCLOSURE IS MANDATORY OR VOLUNTARY AND EFFECT ON INDIVIDUAL OF NOT PROVIDING INFORMATION** Disclosure of the requested information is voluntary. If the requested information is not furnished, however, the application for radioactive material license, or amendment thereof, will not be processed.
5. **SYSTEM MANAGER(S) AND ADDRESS** Director, Division of Fuel Cycle and Material Safety, Office of Nuclear Material Safety and Safeguards, U.S. Nuclear Regulatory Commission, Washington, D.C. 20555.

TRAINING AND EXPERIENCE
AUTHORIZED USER OR RADIATION SAFETY OFFICER

1. NAME OF AUTHORIZED USER OR RADIATION SAFETY OFFICER Clifford J. Turner, M.D.	2. STATE OR TERRITORY IN WHICH LICENSED TO PRACTICE MEDICINE Pennsylvania
--	--

3. CERTIFICATION		
SPECIALTY BOARD A	CATEGORY B	MONTH AND YEAR CERTIFIED C
American Board of Radiology American Board of Nuclear Medicine		December 1971 April 1983

4. TRAINING RECEIVED IN BASIC RADIOISOTOPE HANDLING TECHNIQUES

FIELD OF TRAINING A	LOCATION AND DATE(S) OF TRAINING B	TYPE AND LENGTH OF TRAINING	
		LECTURE/ LABORATORY COURSES (Hours) C	SUPERVISED LABORATORY EXPERIENCE (Hours) D
a. RADIATION PHYSICS AND INSTRUMENTATION	See attached Curriculum Vitae		
b. RADIATION PROTECTION	Currently authorized user/RSO (NRC Lic. No. 0823376-01)		
c. MATHEMATICS PERTAINING TO THE USE AND MEASUREMENT OF RADIOACTIVITY			
d. RADIATION BIOLOGY			
e. RADIOPHARMACEUTICAL CHEMISTRY			

5. EXPERIENCE WITH RADIATION. (Actual use of Radioisotopes or Equivalent Experience)

ISOTOPE	MAXIMUM AMOUNT	WHERE EXPERIENCE WAS GAINED	DURATION OF EXPERIENCE	TYPE OF USE
		See attached Curriculum Vitae		

AGE AND DATE OF BIRTH:

Paterson, New Jersey 19 November 1940

COLLEGE:

Lehigh University, Bethlehem, Pennsylvania 1958-62, BA 1962

MEDICAL SCHOOL:

Hahnemann Medical College, Philadelphia, Pennsylvania 1962-66, MD 1966

INTERNSHIP:

Walter Reed General Hospital, Washington, D.C. 1966-67

RESIDENCY:

General Radiology, Walter Reed General Hospital 1967-70

EXPERIENCE:

- 1970-72 Chief, Department of Radiology
Valley Forge General Hospital
Phoenixville, Pennsylvania 19460
1,000-bed hospital, department had \$1,000,000 annual budget.
- 1972-74 Chief, Diagnostic Section, and Assistant Chief, Department of Radiology
Fitzsimons Army Medical Center
Denver, Colorado 80240 - Duties included direction of the Radiology
Residency Program. The program contained 12 residents at that time.
- 1974-81 Private practice of radiology in a group of 10 radiologists who
(June) staff Holy Cross Hospital, Silver Spring, Maryland, and two private
offices. I developed the ultrasound facility at the hospital in
1975. This included Echocardiography. I actively participated
in the design and selection of a new department with \$2,000,000
worth of new equipment in 1977-78.
- 1981- July Private practice with Community Radiology Associates, a 7-person
to present association of radiologists that staffs the Department of Radiology
at Montgomery General Hospital and three private offices.
I developed a Breast Diagnostic Center including dedicated breast
ultrasound at the office I direct.

BOARD CERTIFICATION:

American Board of Radiology 1971
American Board of Nuclear Medicine 1973

EXAMINATIONS:

Maryland, Pennsylvania, New Jersey, District of Columbia, Colorado,
Kansas (Diplomate, National Board of Medical Examiners).

PROFESSIONAL ASSOCIATIONS:

A.M.A., Montgomery County (Maryland) Medical Society, A.C.R., R.S.N.A.,
A.I.U.M., Society of Nuclear Medicine

MILITARY SERVICE:

Nine years active duty, resigned Regular Army Commission as Lt. Colonel, June 1974

FAMILY: Very happily married, two teenage children.

P. 6
Item 8
July 24, 1985

American Board of Nuclear Medicine, Inc.

a conjoint board of the American Boards of Internal Medicine, Pathology and Radiology,
and sponsored by the Society of Nuclear Medicine

June 8, 1973

Clifford J. Turner, M.D.
1556 South Ironston St.
Aurora, Colo. 80012

Dear Dr. Turner:

With great pleasure the Conjoint American Board of Nuclear Medicine informs you that you have passed its April 7, 1973 Certifying Examination in the broad field of Nuclear Medicine and now are recognized as a Certified Specialist with special competence in all aspects of the diagnostic, therapeutic, and medical research uses of radioactive materials.

A certificate indicating this recognition will be sent to you in the near future. Please indicate on the enclosed card the way in which you wish your name to be engrossed upon the certificate and return it as soon as possible to the ABNM office.

The Conjoint American Board of Nuclear Medicine congratulates you upon your achievement and this recognition.

Sincerely yours,

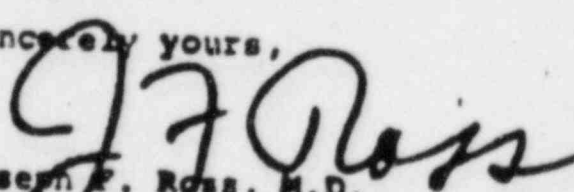
Joseph F. Ross, M.D.
Chairman

JFR:mr
Enclosure

Organized through the cooperation of the

American College of Radiology, the American Roentgen Ray Society,
the American Radium Society, the Radiological Society of North America
and the Section on Radiology of the American Medical Association

Hereby certifies that

Clifford James Turner, M.D.

Has pursued an accepted course of graduate study
and clinical work, has met certain standards and qualifications and
has passed the examinations conducted under the authority of

The American Board of Radiology

On this tenth day of December, 1971

Thereby demonstrating to the satisfaction of the Board
that he is qualified to practice the specialty of

Radiology



P. 8
Item 8
July 24, 1985

John F. Ruel

C. Allen Good



January 1984

ITEM 9: INSTRUMENTATION

Dual BMC - Lab 22a,
Dual Photon Bone Densitometer
with one (1) curie Gadolinium - 153
Source, in a Lead-Shielded
Sourceholder, installed below a
Patient Couch.

ITEM 11: FACILITIES AND EQUIPMENT

- The NOVO Diagnostic System's Dual Photon Bone Densitometer is a fixed unit installed in the office. The unit will not be relocated without prior permission of the NRC. The Gadolinium-153 source is to be installed in the densitometer device by the authorized manufacturer representative. The source will not be removed from the device by the licensee. Source exchange will be performed by an authorized representative of the manufacturer of the device.

Attached is a drawing indicating the location of the densitometer in the facilities. The unit shall be under the direct control of the licensee and shall not be used except by the licensed users. It shall be controlled from unauthorized use or tampering during off duty hours.

The Tri County Diagnostic Center
Pottstown Professional Mall
Medical Drive
Pottstown, Pennsylvania 19464

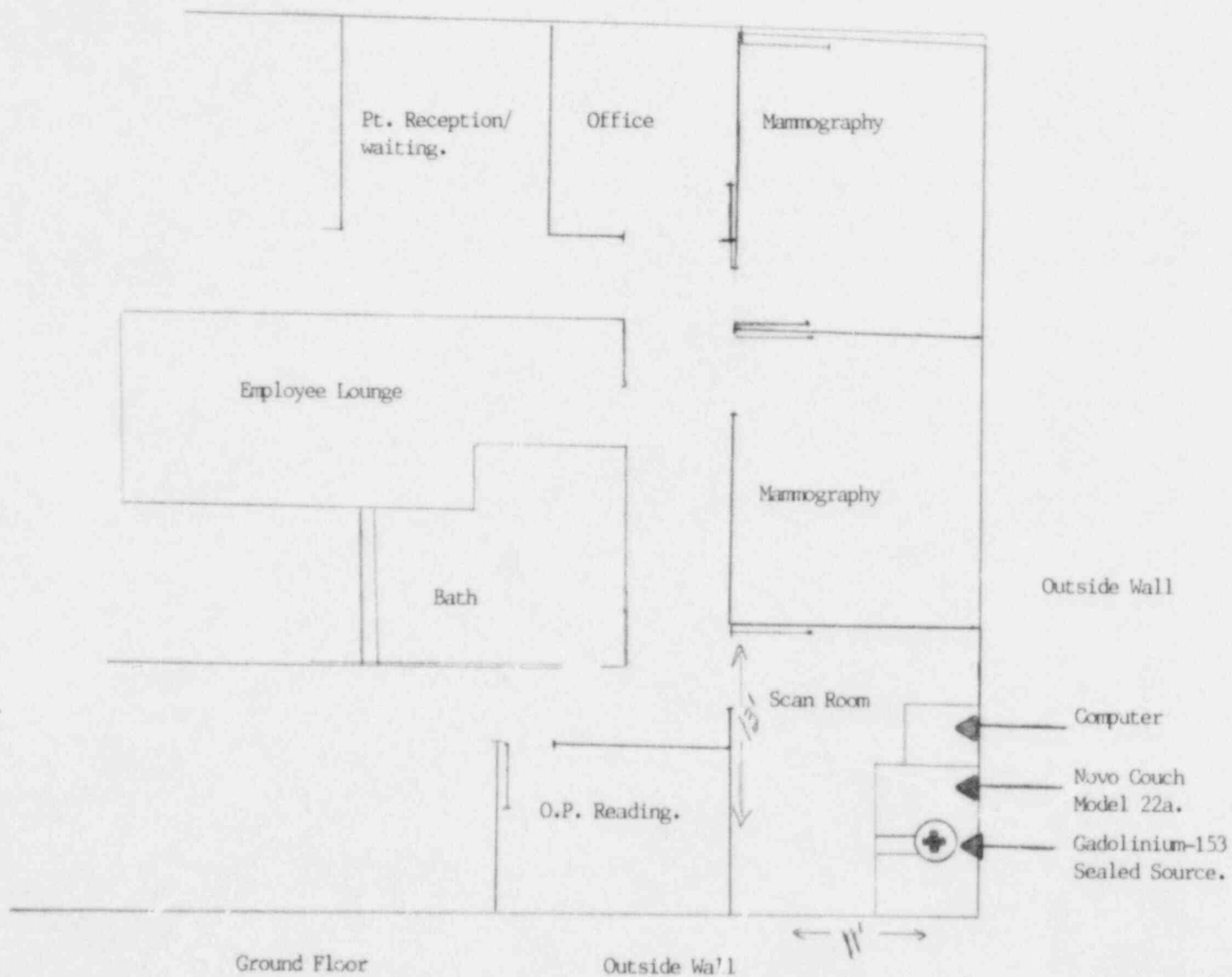

Scale: 1/8" = 1' - 0"

GM

P.11.
Item 11.
July 24, 1985

ITEM 12: PERSONNEL TRAINING PROGRAM

The personnel training program will be given to all personnel who work with or in the vicinity of radioactive materials. The training will be in the form of lectures and the duration of each session will depend on the extent of applicability to the employees involved. The training program will be of sufficient scope to ensure that all ancillary personnel, including technical, clerical, nursing, housekeeping, and security personnel receive proper instruction in the items A and B below, and that radiation workers (i.e., technologists) receive instruction in all items below.

- A. Areas where radioactive materials are used or stored.
- B. Potential hazards associated with radioactive material.
- C. Radiological safety procedures appropriate to their respective duties.
- D. Pertinent NRC regulations.
- E. Pertinent terms of the license.
- F. Their obligation to report unsafe conditions.
- G. Appropriate response to emergencies or unsafe conditions.
- H. Their right to be informed of their radiation exposure and bioassay results.
- I. Locations where the licensee has posted or made available notices, copies of pertinent licenses and license conditions (including applications and applicable correspondence), as required by 10 CFR Part 19.

Personnel will be properly instructed as follows:

- A. Before assuming duties with, or in the vicinity of radioactive materials.
- B. During annual refresher training.
- C. Whenever there is a significant change in duties, regulations, or terms of the license.

ITEM 13: ORDERING AND RECEIVING RADIOACTIVE MATERIAL

All orders for the radioactive source will be placed by the Director of Nuclear Medicine Services or his authorized agent after verification that the item is a licensed material and, that upon receipt, possession limits will not be exceeded.

Radioactive shipments will be delivered only during duty hours to the scan room of the suite and the technologist notified.

This area shall be secured to prevent unauthorized use.

Radioactive materials will not be delivered during off-duty hours.

ITEM 15: GENERAL RULES FOR THE SAFE USE OF RADIOACTIVE MATERIAL

- A. The device is to be operated by the user authorized by a license issued by the State of Maryland.
- B. The users and ancillary support personnel are not to modify, remove, or exchange the source or the device in a way that would hamper the effectiveness of its use, compromise the radioactive source containment, or unnecessarily expose personnel to radiation.
- C. Personnel shall not place their hand or body in the beam of radiation emitted by the device that shall cause it to be unnecessarily exposed.
- D. The device containing radioactive material shall be secured to prevent unauthorized use, tampering or removal except during actual usage.
- E. The device shall be visually inspected prior to each use to assure continued safe functioning. Any abnormal conditions should be reviewed with the manufacturer's representative or a health physics consultant.
- F. Persons operating or assisting in the procedures associated with this device shall wear a radiation dosimetry device of either film type or TLD type. These dosimeters will be changed and presented for analysis on a monthly frequency. These devices will be furnished and serviced by a company such as R.S. Landauer, Inc. or equivalent.
- G. Persons frequenting the room housing this device shall not smoke, eat or drink unless for the purposes of medical treatment.
- H. Radioactive material shall be used for diagnostic medical uses only.
- I. Records will be kept of the receipt and return of the radioactive materials, the use and leak testing of the source, and film badge/TLD results.
- J. The source shall be installed into the densitometer device by an authorized representative of the manufacturer. During the initial installation or source transfer, a radiation survey shall be conducted by the installer indicating the radiation levels in the "open" and "closed" modes. A copy of the survey shall be provided to the licensee and shall be available for inspection by the NRC.
- K. The source shall be leak tested at a six (6) month interval. Having a half-life of 242 days, the source will be replaced periodically. Leak testing will be performed by the manufacturer of the device, or a licensed representative of the licensee. The source shall not be removed or leak tested by the licensee.

ITEM 16: EMERGENCY PROCEDURES

A. If it appears the device is stuck in an "open" or exposed position or any malfunction potentially compromising the integrity of the source or device, the patient shall be immediately removed and no person shall be allowed to an area within 10 feet of the device. The user shall contact the manufacturer or his designated representative to identify the problem. The device shall not be used, or the area around the device occupied until the problem is rectified by the manufacturer representative. The area shall be posted to prevent unnecessary entry until the unit is returned to a safe condition.

B. In case of an emergency notify:

Radiation Safety Officer: Clifford Turner, M.D.

Office Phone: (301) 589-5476

Home Phone: (301) 299-2130

Alternate names designated by the RSO:

Director of Nuclear Medicine: Glenn Moran

Office Phone: (301) 654-0434

Home Phone: (301) 381-2928

President of Cardio, Inc: Richard Toren

Office Phone: (301) 654-0434

Home Phone: (301) 564-1130

ITEM 18: WASTE DISPOSAL

The source shall be removed and returned to the manufacturer's representative or to a licensed waste disposal facility for ultimate disposition. The source shall be properly packaged to include shielding, if necessary, and presented for disposal.

BETWEEN: William O. Miller, Chief
License Fee Management Branch
Office of Administration -

John E. Glenn, Chief
Nuclear Materials Section B
Division of Engineering and
Technical Programs

LICENSE FEE TRANSMITTAL

A. REGION I

1. APPLICATION ATTACHED

Applicant/Licensee: The Tri County Diagnostic Center

Application Dated: 7/24/85

Control No.: 04191

License No.: NEW

2. FEE ATTACHED

Amount: \$ 580.00

Check No.: 3735

3. COMMENTS

Signed Brenda Platchk

Date 8/6/85

B. LICENSE FEE MANAGEMENT BRANCH

1. Fee Category and Amount: #580-7c

2. Correct Fee Paid. Application may be processed for:

Amendment

Renewal

License ✓

Signed G Jackson

Date 8/20/85

"SECTION COPY"

CARDIO, INC.
5530 WISCONSIN AVENUE
CHEVY CHASE, MARYLAND 20815

DATE	INVOICE	AMOUNT
	<i>Palston</i>	

15-120
540

3735

July 31, 1985

PAY *five hundred eighty & 00/100* Dollars \$ *580.00*

U.S. Nuclear Regulatory Comm.

TO
THE ORDER
OF

DISTRICT OF COLUMBIA NATIONAL BANK
MAIN OFFICE, 1801 R STREET, N.W.
WASHINGTON, D.C. 20006

Richard B. In

⑆ 00003735⑆ ⑆05400⑆204⑆

265982 4⑈