

<b>NRC FORM 313M</b> (9-81) 10 CFR 35	<b>U.S. NUCLEAR REGULATORY COMMISSION</b> <b>APPLICATION FOR MATERIALS LICENSE – MEDICAL</b>	Approved by OMB 3150-0041 Expires 9-30-83
---	---	---

**INSTRUCTIONS** – Complete items 1 through 26 if this is an initial application or an application for renewal of a license. Use supplemental sheets where necessary. Item 26 must be completed on all applications and signed. Retain one copy. Submit original and one copy of entire application to: Director, Office of Nuclear Materials Safety and Safeguards, U.S. Nuclear Regulatory Commission, Washington, D.C. 20555. Upon approval of this application, the applicant will receive a Materials License. An NRC Materials License is issued in accordance with the general requirements contained in Title 10, Code of Federal Regulations, Part 30, and the Licensee is subject to Title 10, Code of Federal Regulations, Parts 19, 20 and 35 and the license fee provision of Title 10, Code of Federal Regulations, Part 170. The license fee category should be stated in Item 26 and the appropriate fee enclosed.

<b>1.a. NAME AND MAILING ADDRESS OF APPLICANT</b> (institution, firm, clinic, physician, etc.) INCLUDE ZIP CODE  Basha Radiology 1401 S. Washington Avenue Royal Oak, MI 48067  TELEPHONE NO. AREA CODE (313) 398-6070	<b>1.b. STREET ADDRESS(ES) AT WHICH RADIOACTIVE MATERIAL WILL BE USED</b> (if different from 1.a.) INCLUDE ZIP CODE  Amend to Add: Dearborn Diagnostics 2200 Monroe Dearborn, Mich 48124
<b>2. PERSON TO CONTACT REGARDING THIS APPLICATION</b>  Y.M. Basha, M.D.  TELEPHONE NO. AREA CODE (313) 398-6070	<b>3. THIS IS AN APPLICATION FOR:</b> (Check appropriate item) a. <input type="checkbox"/> NEW LICENSE b. <input checked="" type="checkbox"/> AMENDMENT TO LICENSE NO. <u>21-20416-01</u> c. <input type="checkbox"/> RENEWAL OF LICENSE NO. _____
<b>4. INDIVIDUAL USERS</b> (Name individuals who will use or directly supervise use of radioactive material. Complete Supplements A and B for each individual.)  Refer to License # 21-20416-01	<b>5. RADIATION SAFETY OFFICER (RSO)</b> (Name of person designated as radiation safety officer. If other than individual user, complete resume of training and experience as in Supplement A.)  Y.M. Basha, M.D.

**6.a. RADIOACTIVE MATERIAL FOR MEDICAL USE**

RADIOACTIVE MATERIAL LISTED IN	ITEMS DESIRED "X"	MAXIMUM POSSESSION LIMITS (In millicuries)	ADDITIONAL ITEMS	MARK ITEMS DESIRED "X"	MAXIMUM POSSESSION LIMITS (In millicuries)
10 CFR 31.11 FOR IN VITRO STUDIES			IODINE-131 AS IODIDE FOR TREATMENT OF HYPERTHYROIDISM		
10 CFR 35.100, SCHEDULE A, GROUP I	X	AS NEEDED	PHOSPHORUS-32 AS SOLUBLE PHOSPHATE FOR TREATMENT OF POLYCYTHEMIA VERA, LEUKEMIA AND BONE METASTASES		
10 CFR 35.100, SCHEDULE A, GROUP II	X	AS NEEDED	PHOSPHORUS-32 AS COLLOIDAL CHROMIC PHOSPHATE FOR INTRACAVITARY TREATMENT OF MALIGNANT EFFUSIONS.		
10 CFR 35.100, SCHEDULE A, GROUP III	X		GOLD-198 AS COLLOID FOR INTRACAVITARY TREATMENT OF MALIGNANT EFFUSIONS.		
10 CFR 35.100, SCHEDULE A, GROUP IV		AS NEEDED	IODINE-131 AS IODIDE FOR TREATMENT OF THYROID CARCINOMA		
10 CFR 35.100, SCHEDULE A, GROUP V		AS NEEDED	XENON-133 AS GAS OR GAS IN SALINE FOR BLOOD FLOW STUDIES AND PULMONARY FUNCTION STUDIES		
10 CFR 35.100, SCHEDULE A, GROUP VI					

**6.b. RADIOACTIVE MATERIAL FOR USES NOT LISTED IN ITEM 6.a.** (Sealed sources up to 3 mCi used for calibration and reference standards are authorized under Section 35.14(d), 10 CFR Part 35, and NEED NOT BE LISTED.)

ELEMENT AND MASS NUMBER	CHEMICAL AND/OR PHYSICAL FORM	MAXIMUM NUMBER OF MILLICURIES OF EACH FORM	DESCRIBE PURPOSE OF USE
<div style="position: relative;"> <div style="position: absolute; top: 10px; left: 10px; font-size: small;">           Applicant.....            Check No. <u>3216</u>            Amount/Fee Category <u>120-7C</u>            Type of Fee <u>Amendment</u>            Date Check Rec'd. <u>8/14/85</u>            Received By <u>C.A.P.</u> </div> <div style="position: absolute; top: 50%; left: 50%; transform: translate(-50%, -50%); font-size: 2em; opacity: 0.5;">             RECEIVED              AUG 7 1985              REGION III              AUG 7 1985           </div> </div>			

8509120262 850820  
 REG3 LIC30  
 21-20416-01 PDR

CONTROL NO. 7 9519

# INFORMATION REQUIRED FOR ITEMS 7 THROUGH 23

For Items 7 through 23, check the appropriate box(es) and submit a detailed description of all the requested information. Begin each item on a separate sheet. Identify the item number and the date of the application in the lower right corner of each page. If you indicate that an appendix to the medical licensing guide will be followed, do not submit the pages, but specify the revision number and date of the referenced guide: Regulatory Guide 10.8 Rev. \_\_\_\_\_ Date: \_\_\_\_\_

Items 10, 14-18 as per license application #21-20416-01

7. MEDICAL ISOTOPES COMMITTEE		15. GENERAL RULES FOR THE SAFE USE OF RADIOACTIVE MATERIAL (Check One)	
<input type="checkbox"/>	Names and Specialties Attached; and	<input type="checkbox"/>	Appendix G Rules Followed; or
<input type="checkbox"/>	Duties as in Appendix B; or _____ (Check One)	<input type="checkbox"/>	Equivalent Rules Attached
<input type="checkbox"/>	Equivalent Duties Attached	16. EMERGENCY PROCEDURES (Check One)	
8. TRAINING AND EXPERIENCE		<input type="checkbox"/>	Appendix H Procedures Followed; or
<input type="checkbox"/>	Supplements A & B Attached for Each Individual User, and	<input type="checkbox"/>	Equivalent Procedures Attached
<input type="checkbox"/>	Supplement A Attached for RSO.	17. AREA SURVEY PROCEDURES (Check One)	
9. INSTRUMENTATION (Check One)		<input type="checkbox"/>	Appendix I Procedures Followed; or
<input type="checkbox"/>	Appendix C Form Attached; or	<input type="checkbox"/>	Equivalent Procedures Attached
X	List by Name and Model Number	18. WASTE DISPOSAL (Check One)	
10. CALIBRATION OF INSTRUMENTS		<input type="checkbox"/>	Appendix J Form Attached; or
<input type="checkbox"/>	Appendix D Procedures Followed for Survey Instruments; or _____ (Check One)	<input type="checkbox"/>	Equivalent Information Attached
<input type="checkbox"/>	Equivalent Procedures Attached; and	19. THERAPEUTIC USE OF RADIOPHARMACEUTICALS (Check One)	
<input type="checkbox"/>	Appendix D Procedures Followed for Dose Calibrator; or _____ (Check One)	<input type="checkbox"/>	Appendix K Procedures Followed; or
<input type="checkbox"/>	Equivalent Procedures Attached	<input type="checkbox"/>	Equivalent Procedures Attached
11. FACILITIES AND EQUIPMENT		20. THERAPEUTIC USE OF SEALED SOURCES	
X	Description and Diagram Attached	<input type="checkbox"/>	Detailed Information Attached; and
12. PERSONNEL TRAINING PROGRAM		<input type="checkbox"/>	Appendix L Procedures Followed; or _____ (Check One)
<input type="checkbox"/>	Description of Training Attached	<input type="checkbox"/>	Equivalent Procedures Attached
13. PROCEDURES FOR ORDERING AND RECEIVING RADIOACTIVE MATERIAL		21. PROCEDURES AND PRECAUTIONS FOR USE OF RADIOACTIVE GASES (e.g., Xenon - 133)	
X	Detailed Information Attached	<input type="checkbox"/>	Detailed Information Attached
14. PROCEDURES FOR SAFELY OPENING PACKAGES CONTAINING RADIOACTIVE MATERIALS (Check One)		22. PROCEDURES AND PRECAUTIONS FOR USE OF RADIOACTIVE MATERIAL IN ANIMALS	
<input type="checkbox"/>	Appendix F Procedures Followed; or	<input type="checkbox"/>	Detailed Information Attached
<input type="checkbox"/>	Equivalent Procedures Attached	23. PROCEDURES AND PRECAUTIONS FOR USE OF RADIOACTIVE MATERIAL SPECIFIED IN ITEM 6.b	
<input type="checkbox"/>		<input type="checkbox"/>	Detailed Information Attached

## 24. PERSONNEL MONITORING DEVICES

TYPE <small>(Check appropriate box)</small>		SUPPLIER	EXCHANGE FREQUENCY
a. WHOLE BODY	<input checked="" type="checkbox"/> FILM	R.S. Landauer, Jr. & Sons, Inc.	Monthly
	<input type="checkbox"/> TLD		
	<input type="checkbox"/> OTHER <small>(Specify)</small>		
b. FINGER	<input type="checkbox"/> FILM		
	<input checked="" type="checkbox"/> TLD	R.S. Landauer, Jr. & Sons, Inc.	Monthly
	<input type="checkbox"/> OTHER <small>(Specify)</small>		
c. WRIST	<input type="checkbox"/> FILM		
	<input type="checkbox"/> TLD		
	<input type="checkbox"/> OTHER <small>(Specify)</small>		

d. OTHER (Specify)

## 25. FOR PRIVATE PRACTICE APPLICANTS ONLY

a. HOSPITAL AGREEING TO ACCEPT PATIENTS CONTAINING RADIOACTIVE MATERIAL			
NAME OF HOSPITAL		b. ATTACH A COPY OF THE AGREEMENT LETTER SIGNED BY THE HOSPITAL ADMINISTRATOR.	
MAILING ADDRESS		c. WHEN REQUESTING THERAPY PROCEDURES, ATTACH A COPY OF RADIATION SAFETY PRECAUTIONS TO BE TAKEN AND LIST AVAILABLE RADIATION DETECTION INSTRUMENTS.	
CITY	STATE	ZIP CODE	

## 26. CERTIFICATE

*(This item must be completed by applicant)*

The applicant and any official executing this certificate on behalf of the applicant named in Item 1a certify that this application is prepared in conformity with Title 10, Code of Federal Regulations, Parts 30 and 35, and that all information contained herein, including any supplements attached hereto, is true and correct to the best of our knowledge and belief.

a. LICENSE FEE REQUIRED <small>(See Section 170.31, 10 CFR 170)</small>		b. APPLICANT OR CERTIFYING OFFICIAL <small>(Signature)</small>	
(1) LICENSE FEE CATEGORY		(1) NAME <small>(Type or Print)</small>	
(2) LICENSE FEE ENCLOSED \$		(2) TITLE	
(3) DATE		(4) REGION	

CONTROL NO. 79519

## PRIVACY ACT STATEMENT

Pursuant to 5 U.S.C. 552a(e)(3), enacted into law by section 3 of the Privacy Act of 1974 (Public Law 93-579), the following statement is furnished to individuals who supply information to the Nuclear Regulatory Commission on NRC Form 313M. This information is maintained in a system of records designated as NRC-3 and described at 40 Federal Register 45334 (October 1, 1975).

1. **AUTHORITY** Sections 81 and 161(b) of the Atomic Energy Act of 1954, as amended (42 U.S.C. 2111 and 2201(b)).
2. **PRINCIPAL PURPOSE(S)** The information is evaluated by the NRC staff pursuant to the criteria set forth in 10 CFR Parts 30-36 to determine whether the application meets the requirements of the Atomic Energy Act of 1954, as amended, and the Commission's regulations, for the issuance of a radioactive material license or amendment thereof.
3. **ROUTINE USES** The information may be used: (a) to provide records to State health departments for their information and use, and (b) to provide information to Federal, State, and local health officials and other persons in the event of incident or exposure, for their information, investigation, and protection of the public health and safety. The information may also be disclosed to appropriate Federal, State, and local agencies in the event that the information indicates a violation or potential violation of law and in the course of an administrative or judicial proceeding. In addition, this information may be transferred to an appropriate Federal, State, or local agency to the extent relevant and necessary for a NRC decision or to an appropriate Federal agency to the extent relevant and necessary for that agency's decision about you. A copy of the license issued will routinely be placed in the NRC's Public Document Room, 1717 H Street, N.W., Washington, D.C.
4. **WHETHER DISCLOSURE IS MANDATORY OR VOLUNTARY AND EFFECT ON INDIVIDUAL OF NOT PROVIDING INFORMATION** Disclosure of the requested information is voluntary. If the requested information is not furnished, however, the application for radioactive material license, or amendment thereof, will not be processed.
5. **SYSTEM MANAGER(S) AND ADDRESS** Director, Division of Fuel Cycle and Material Safety, Office of Nuclear Material Safety and Safeguards, U.S. Nuclear Regulatory Commission, Washington, D.C. 20555.

U.S. NRC  
LIC. FEE MGMT. BRANCH

85 AUG 14 P 3:46

RECEIVED

NRC FORM 313M  
(9-81)

ITEM NINE  
License No. 21-20416-01

SURVEY METER

BICRON - SURVEYOR 2000

Range: 0 - 0.2 mR/hr  
0 - 2,000 mR/hr

VICTOREEN - FRISKER 495

Range: 0 - 500 mR/hr  
0 - 500,000 mR/hr

DOSE CALIBRATOR

CAPINTEC CRC-7

CAMERA

SIEMENS LFOV GAMMA CAMERA

ADAC COMPUTER

FACILITY DIAGRAM

ITEM #11

License # 21-20416-01

2200 Monroe  
Dearborn, Mich

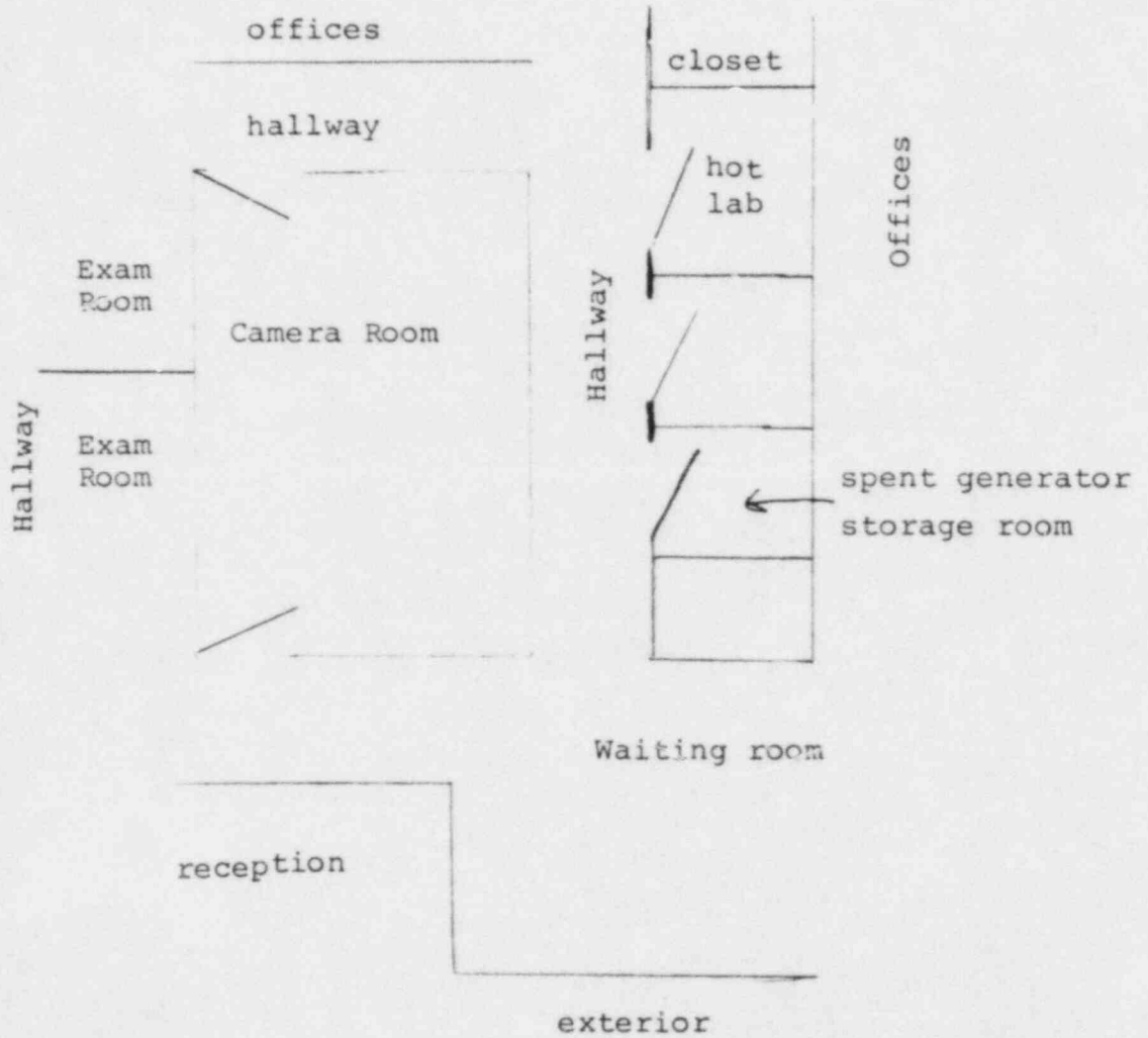

# FACILITY DIAGRAM

ITEM #11

License No. 21-20416-01

2200 Monroe

Dearborn, Michigan

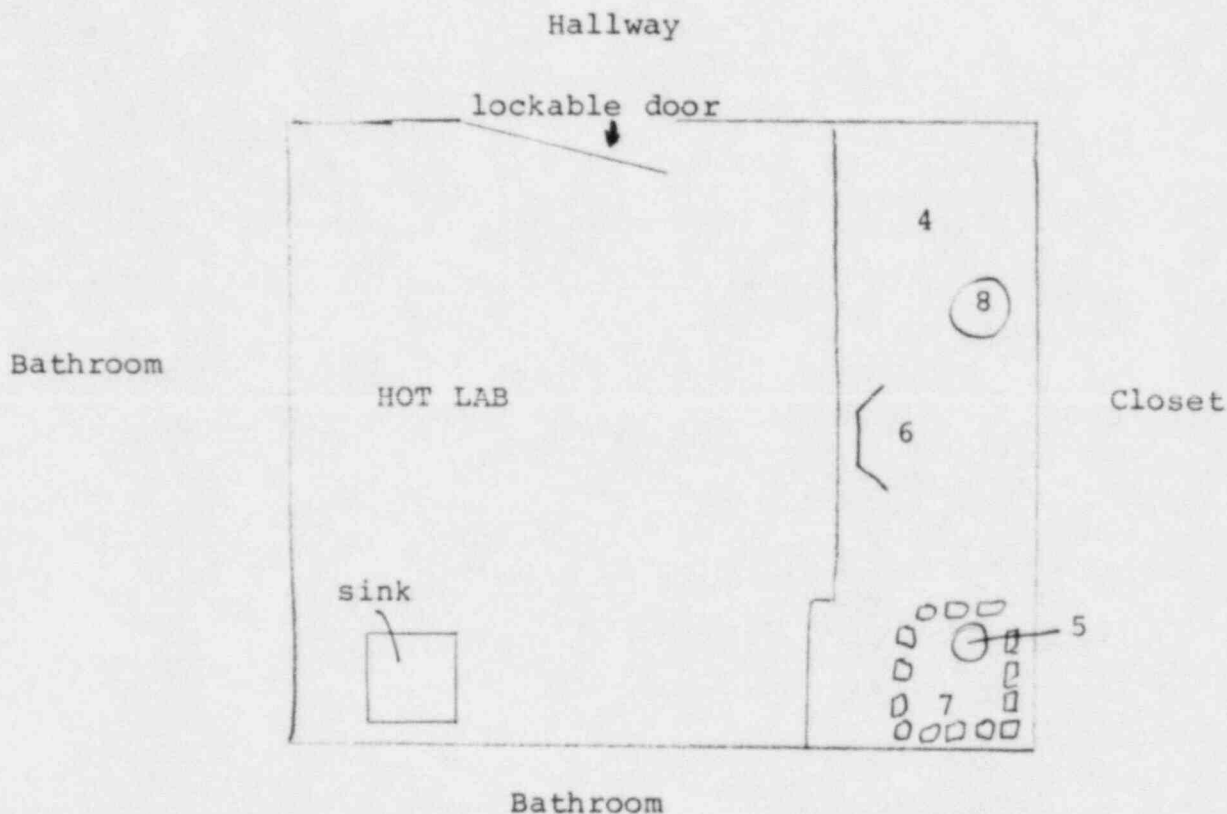

## KEY

- # 6 L-shield ( standard model with  $\frac{1}{2}$ " thick leaded glass Kit and dose preparation area.
- # 7 Lead bricks for Lead castle 8" x 4" x 2" (24 bricks)  
Waste Storage area and isotope storage area
- #5 Generator Shield (NEN Model) 9" x 11" x  $\frac{1}{2}$ "
- #4 Isotope Receipt Area
- #8 Dose Calibrator

CONTROL NO. 79519

## PROCEDURES FOR ORDERING AND RECEIVING RADIOACTIVE MATERIAL

2200 Monroe Dearborn, Michigan

1. The chief nuclear medicine technologist or his/her designee will place all orders for radioactive material and will ensure that the requested materials and quantities are authorized by the license, and that possession limits are not exceeded. The receipt area identified in the Item #11 diagram is designed such that radiation levels in unrestricted areas do not exceed the limits specified in 10 CFR 20.105.
2. During normal working hours, carriers will be instructed to deliver radioactive packages directly to nuclear medicine. If this is not practical, responsible personnel (indicated in the memorandum below) will sign for packages containing radioactive materials and immediately take them to this location. Alternatively, trained nuclear medicine personnel will sign for and transport packages to the appropriate department.
3. During off-duty hours, packages will not be delivered.

TO: Managerial Personnel of Dearborn Diagnostics

FROM: Nuclear Medicine Services

SUBJECT: Delivery of packages containing radioactive materials

If couriers or common carriers attempt delivery of packages containing radioactive materials, the supervisor on duty will be contacted. He/she will have the carrier escorted to nuclear medicine personnel who have been assigned this duty. Alternatively, hospital personnel will deliver the package to the receipt area. Under these conditions, people transporting the packages will receive special training for this purpose. Personnel not trained in the proper handling of radioactive materials are not to personally accept packages containing radioactive materials. The packages will be secured against unauthorized removal. When delivered packages are wet or appear to be damaged, the RSO is to be immediately contacted.\* The carrier should be requested to remain until it can be determined that neither he nor the delivery vehicle is contaminated.

\*Radiation Safety Officer:

**DEARBORN DIAGNOSTIC CLINIC, INC.**

2200 Monroe Blvd.  
Dearborn, Michigan 48124  
(313) 562-9128

August 6, 1985

Dear Sir:

This letter is to inform you that Dearborn Diagnostic Inc., has given formal notice of dismissal to Tri County Radiologists who are currently licensed to operate our nuclear medicine department. Full responsibility for this department will be assumed by Y. M. Basha, M.D., Diagnostics.

We are also requesting that an emergency temporary nuclear license be issued to Dr. Basha as soon as possible so our facility can continue service while the permanent license is being processed. The reason for this request is that upon notification of dismissal of Tri County Radiologists, a financial dispute arose which has given us concern that the continuity of care for our patients may be compromised unless an interim temporary license is issued to Dr. Basha. Many patients have been scheduled for nuclear studies in advance and any delay could conceivably present hazards to their health.

Thank you for your kind attention to this matter.

Sincerely,

*Peter K. Stratton M.D.*

Peter K. Stratton, M.D.  
President, D. D. C.

CONTROL NO. 7 9519