

46-6940



County Line Road, Boyertown, PA 19512 / Phone: (215) 367-2181

July 25, 1985



PDR  
return to  
39655

Dr. Donald Cool  
U.S. Nuclear Regulatory Commission  
Uranium Process Licensing Section  
Uranium Fuel Licensing Branch  
Division of Fuel Cycle & Materials Safety, NMSS  
Washington, DC 20555

Dear Don:

I have enclosed the maps prepared by Applied Health Physics, Inc. on July 12, 1985 of the Reading, Tulpehocken Street Plant. Our intention is to clean the areas which are greater than 20 micro R per hour before your team arrives in October.

As you can see, we have done a good job so far and expect no problems.

A few areas such as concrete pillars of the railroad siding are just a bit over 20 micro R and we believe this to be the aggregate used in the concrete rather than anything of ours. Your team may help us verify that as such; it is fixed in place.

I plan to send copies of old map surveys dealing with Reading, as well as this new one, to Jim Berger for the team to study before they arrive.

Sincerely,

*William C. Gannon*

William C. Gannon  
Assistant Radiation Safety Officer

WCG/djc  
1618B

enclosures



FEE EXEMPT

8508190343 850725  
PDR ADOCK 04006940  
C PDR

25611

DOCKET NO. 40-6940  
CONTROL NO. 25611  
DATE OF DOC. 7/25/85  
DATE RCVD. 8/5/85  
FOSE ☒ PDR ☒  
FOAR ☒ LEOR ☒  
WM ☒ I&E REF. ☒  
WARR ☒ SAFEGUARDS ☒  
POTC ☒ OTHER ☒

DESCRIPTION:  
maps prepared by  
AHP Inc. of the  
Resling Fuel petrochem  
Sheet Plant  
8/6/85  
cut



HEALTH PHYSICS inc.

2986 Industrial Blvd. Box 197 • Bethel Park, Pa. 15102 • Phone 412 • 563-2242

REPORT  
NUMRFR 85-6

FIELD SERVICE REPORT

DATE June 26 - July 12  
1985

KBI Division of Cabot Corporation

KBI's Tulpehocken St. Plant

Attn: Mr. William Gannon

P.O. Box 567

Reading, PA 19603

Bovertown, PA 19512

DESCRIPTION OF SERVICES

Outside Bay#5 - Fence Area

Several areas of this fence have been found to be contaminated in previous surveys (7 to 300 MicroR/hr.). Decontamination in these areas has begun. Approximately 300 ft.<sup>3</sup> of contaminate has been removed. The fence area is not complete.

Bay #2 - Mixing and Crushing Areas

The area between beams D23 and D24 has been surveyed and found to be contaminated. This area has been decontaminated and 67 barrels have been removed. The excavated areas were filled with 30 tons of shale.

Radiation Surveys:

A complete survey of the building and outside areas has been performed. Every 10 ft<sup>2</sup> was surveyed (an average of several readings in the 10 ft<sup>2</sup> area). Several areas could not be surveyed because of machinery and metal on the floor.

Radiation Surveys:

6-26 to 7-12 were done with Ludlem Model 19 Micro R Meter.

Map of: HAMBURG FABRICATING PLANT

Lebanon R.R. & Tulpehocken St.  
Reading, PA 19603

As drawn for: KBI (Division of Cabot Industries)

Drawn by: Joseph M. Franco (from existing plans)

Scale: 1" = 20'

Key: \_\_\_\_\_ = wall or bay limits  
- - - - - = continuation lines and match lines  
\_\_\_\_\_ = Property lines  
••••• = Fence

All radiation levels are existing levels and are shown  
at 10' intervals. The radiation levels are in units  
of MicroR/hr.

Survey Equipment:

Ludlum Micro R meter model 19

Calibrated 5-10-85

Calibration void after 8-10-85

Ser. # 23070

Ludlum Micro R meter model 19

Calibrated 5-10-85

Calibration void after 8-10-85

Ser. # 37379

*M. Franco*

*7-12-85*

*Michael P Kearney*

*7/12/85*



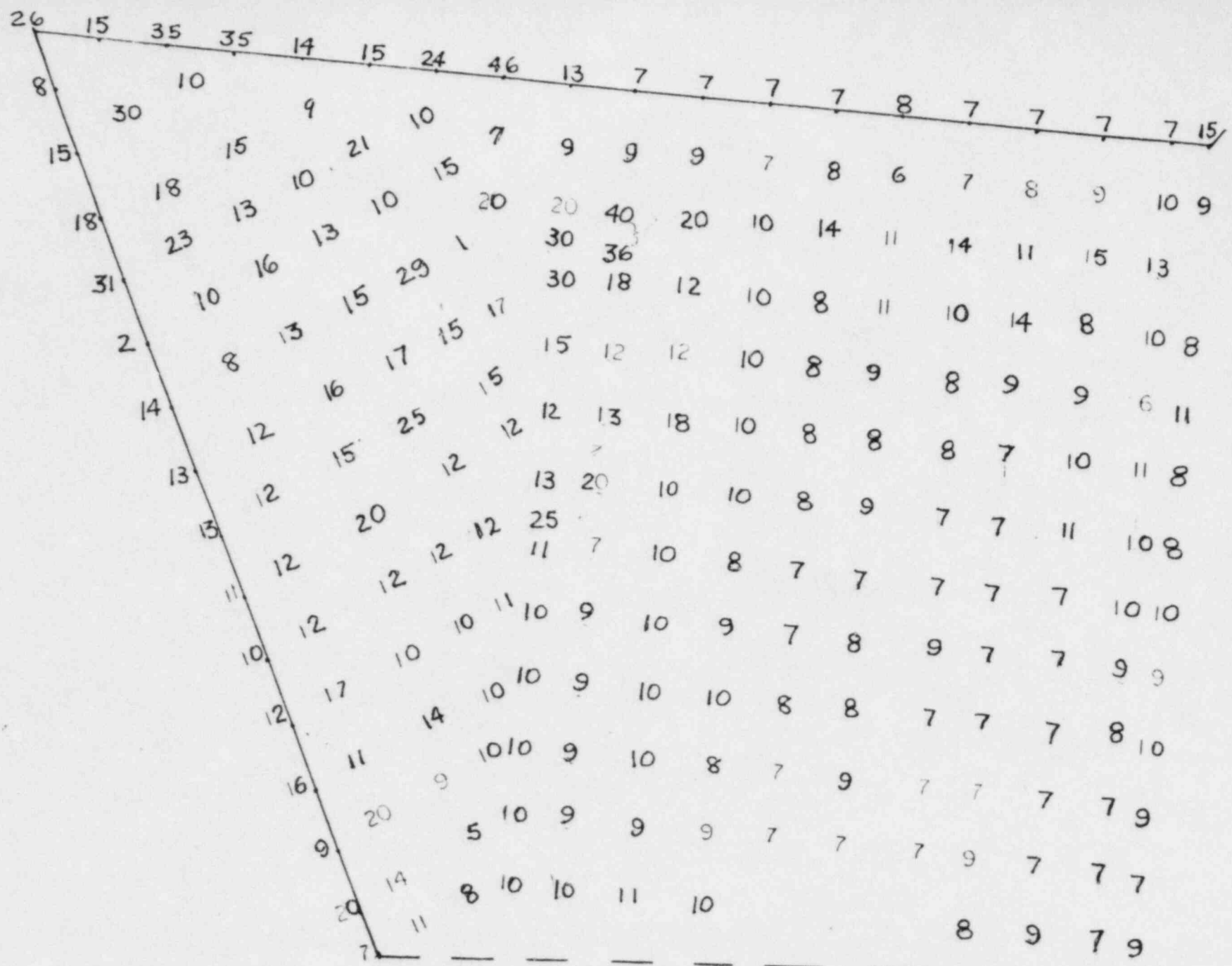

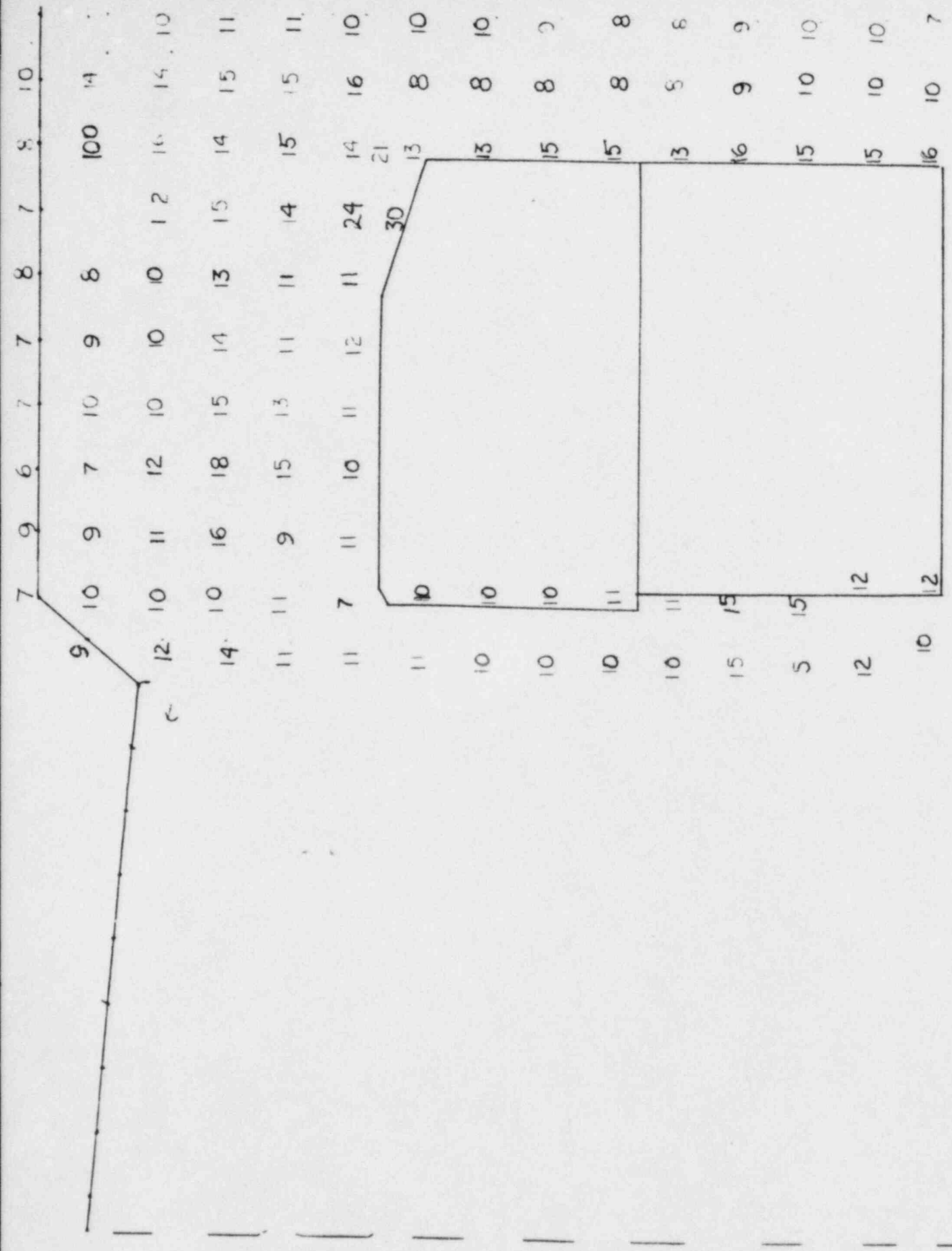



								5	9	9	9	10	7	8	15	11	7	9
								5	7	7	9	10	5	20	15	10	14	10
								7	7	7	7	12	10	24	15	14	11	11
								60	7	7	10	11	13	20	17	10	7	9
								7	9	9	14	22	15	13	10	11	11	
7	7	7	7	7	7	7	7	20										
								32	11									
								7	7	10	10	11	7	10				
								10	7	9	11	11	7	10	16	25	15	
								8	7	7	9	7	7	8	19	10	23	
								6	7	7	20	16	7	7	10	8	8	
5	5	5	10	7	5	5	6	5	4	6	5	4	6	3	6	5	5	
6				8	5	5	10	5	4	4	4	4	4	3	6	4	4	
6	3	5	4	4	4	7	5	5	6	4	7	5	4	4	4	4	3	
5	3	4	4	4	3	6	6	5	5	4	4	4	4	4	4	4	4	
5	3	4	3	5	6	4	4	4	4	5	5	5	5	5	4	4	4	
6	12	10	7	7	8	4	5	5	4	6	6	6	4	6	4	4	5	



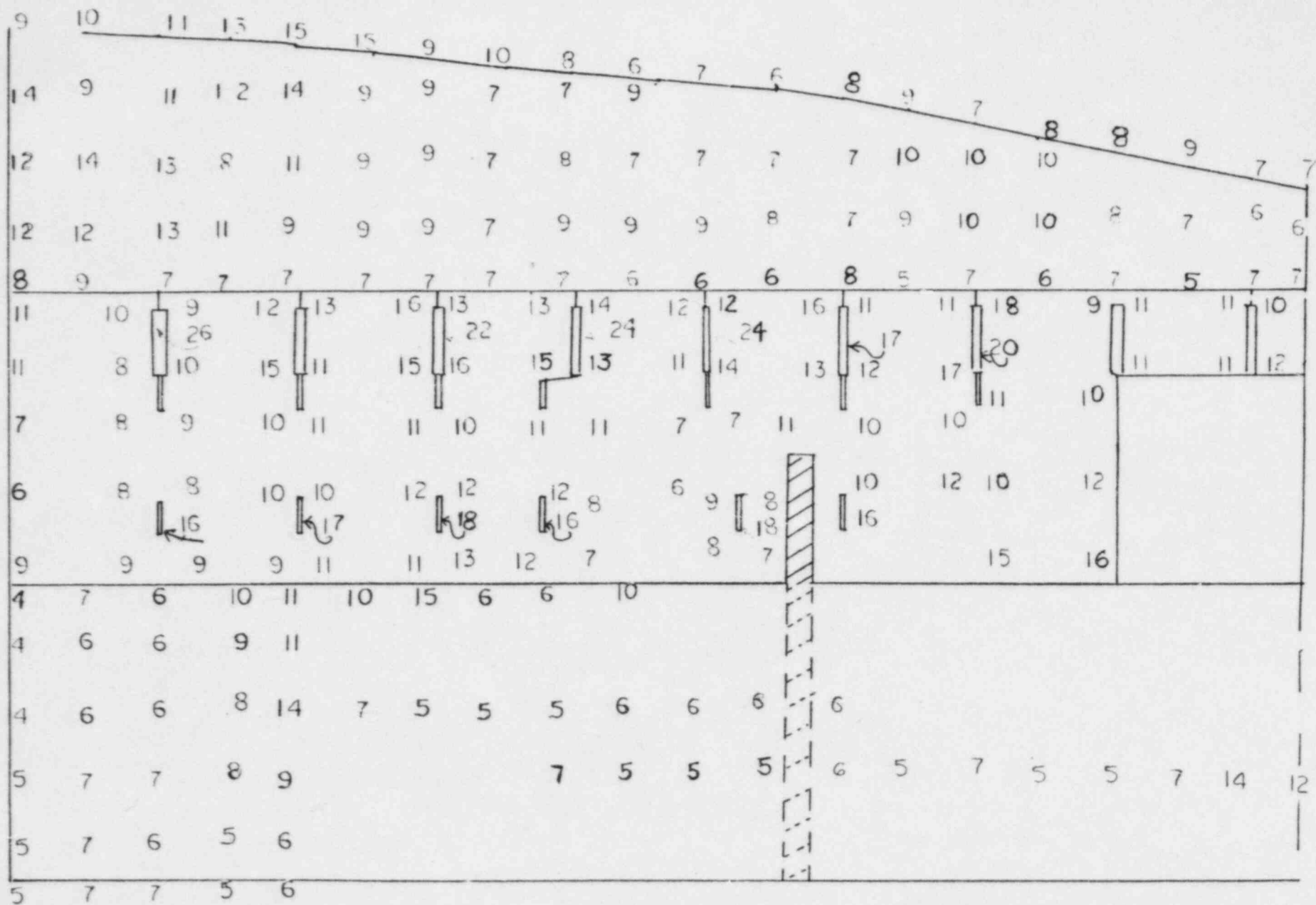



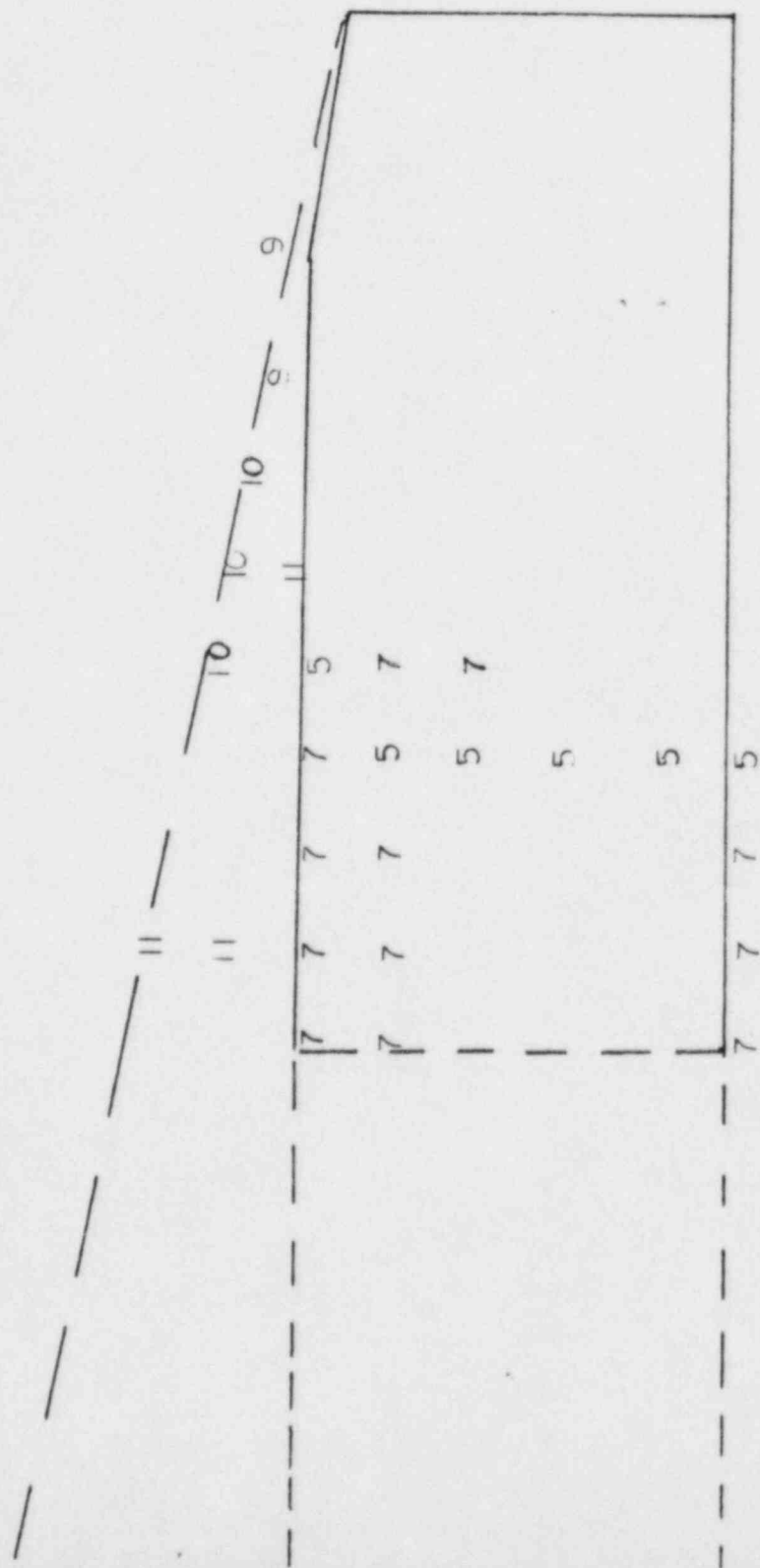

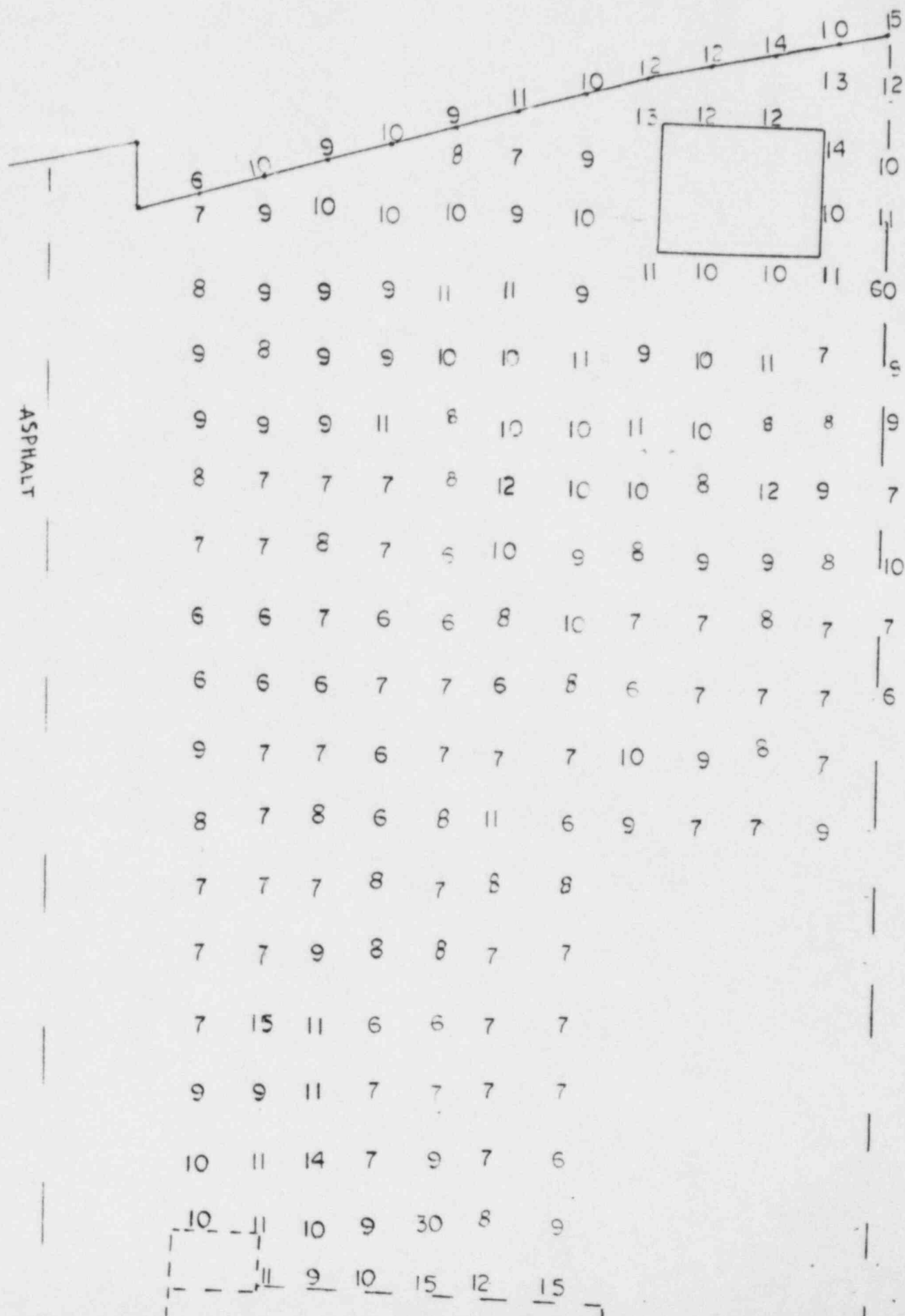

[illegible]

5	5	5	4	5	5	4	5	3	6	6	7	14		
5	6	4	7	4	6	4	3	4	6	4	11	8	10	12
5	5	4	7	4	4	5	5	5	4	3	5	6	8	7
5	6	5	5	4	6	5	7	5	5	4	4	4	4	5
6	4	5	5	5	5	5	4	4	6	5	4			
5	5	6	10	7	5	4	5	4	6	5	7	3	9	8
	5	6	10	7	5	4	5	4	6	5	7	3	9	8
	5	6	90	4	5	4	3	3					5	7
	5	7	6	5	4	3	5							6
	6	4	4	4	6	6	4	6	5	6	5	6	7	6
		4	11	6	7	6	12	10	10	10	3	3	4	3
	5							15	7	11	8	4	4	
	5	5								9	10	10	7	

15	7	7			6		5	8	1	9	4	4	5	7	6	5	4
13	10	8	11	13	6	3	7	6	3	6	5	6	4	4	6	6	6
13	8	5	5	4	5	6	5	4	3		4	3	4	3	4	4	4
5	5	6	4	5	5	7	5	4	4	4	4	5	4	3	8	5	9
4	4	6	6		5	7	4	4	3	3	4	7	4	5	3		11
5	5	5	5	12	5	7	5	5	5	4	3	5	5	3	7	3	7
5	5	5	5	12	5	7	5	5	5	4	3	5	5	3	7	3	7
6	6	4	4	4	7	4	5	3							5		
5	8	4	3	3	5	6	3	7						4	7	4	6
9	5	5	7	4	3	3	4	7						4	4	2	4
4	6	6	6	3	6	7	6	4			3			4	4	3	3
6	7	7	7	5	4	6	9	4			3			4	4	3	6
9	5	5	5	5	8	5	4	3	3	2	3	3	3	3	4	4	8



7	5	5	8	5		5	5	5	7	5	5	5	5	7	
8	12	5	8	5		10	8	5	8	5	6			5	
6		5	5	5		7	5	5	7	5	15	7	5	5	
7	5	7	6	5	7	7	5	5	5	5	5	5	5	7	
5	5	8	6	7	7	5	5	5	5	5	5	5	5	7	5
5	5	5		5		5		4	4	4	5	5	5	5	4
															5
4															5
6															5
4	5	6	5	5	4	5	5	5	7	8	8	9	6		
		5				5	6	6	6	9	9	9	6		
5	5	5					5	5	7	6	9	7	5		
5	7	8	5	8	7	10	5	5	5	6	6	5	5		

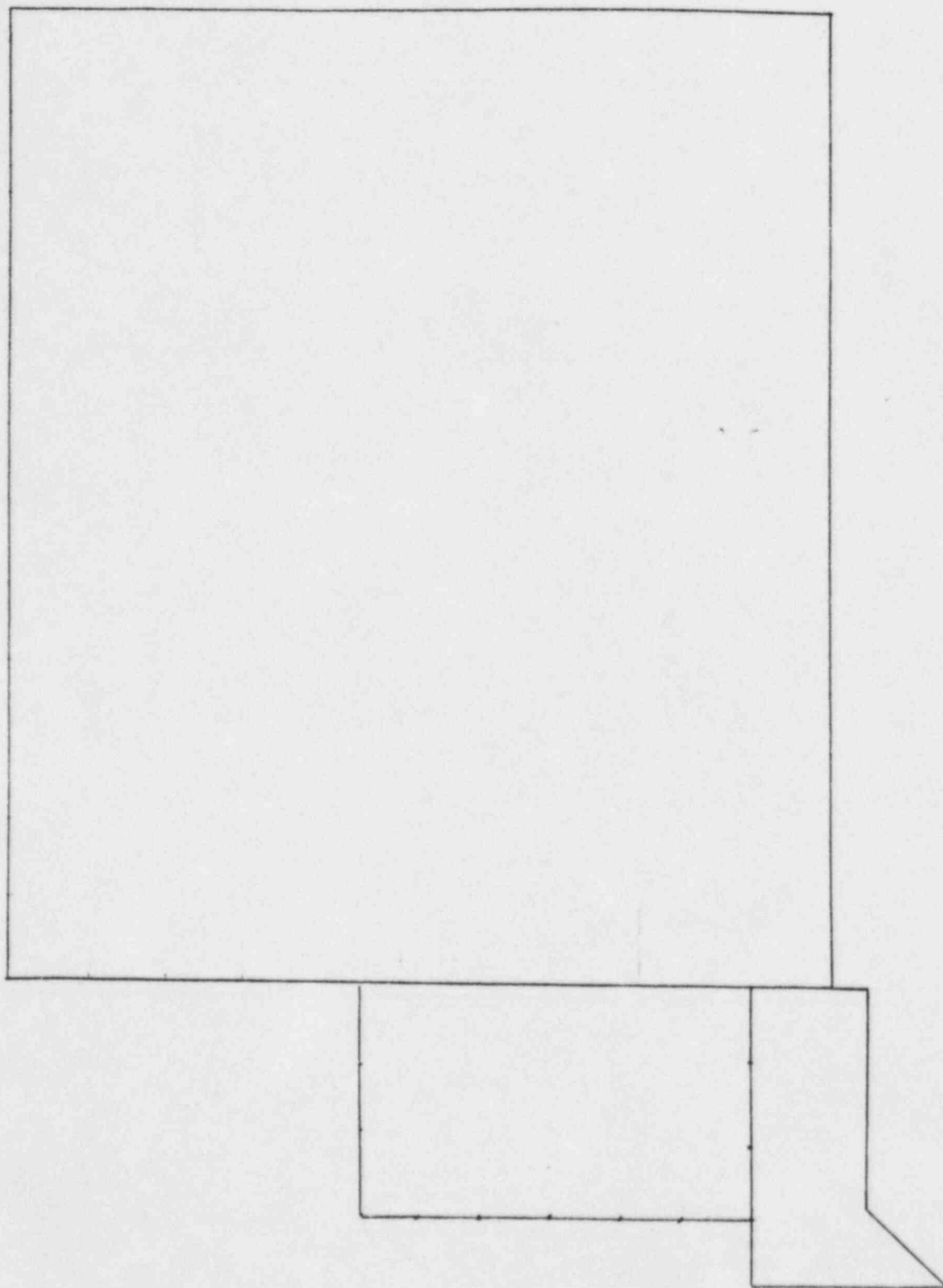

7	10	10	10	10	10	8	7	9	5	8
8	7	11	12	11	11	11	12	7	8	5
9	9	15	13	10	10	9	10	7	7	9
13	9	9	7	9	10	9	8	9	10	11
11	12	11	11	14	10	11	9	5	5	11
16	16	16	12	21						
15	12	12	12	15	7	9	9			
12	11	9	10	12	13	7	7	9	10	6
12	9	10	9	10	9	7	7	9	9	9
14	10	7	9	9	9	7	7	9	10	
12	9	8	8	9	8	5	9	11	6	5
12	16	12	16	12	8	5	7	5	5	5
12	14	12	14	12		5	6			
16	17	16	17	14		8	7		5	

16	12	12	12	15						
15	10	10	10	10	8	5		7		
15	10	8	8	15	5	5	7	7	7	13
14	9	8	9		5	6	7		7	
13	11	9	9	13	7	6	7	7		
		12	10	11	10	6	6	6	7	7
16	14	10	18	29	5	7	7	5	7	9
8	7	6	5							
5	7	6	7	5	6	7	7	5	5	7
5	7	8	7	5	5	7	6	7	7	7
7	7	9	7	5	5	7	7	7	7	6
6	5	5	7	7	5	7	5	7	7	7
5	7	7	7	7	5	6	8	7	6	7
5	7	6	6	7	5	5	8	9	5	7
5	7	6	6	7	5	5	7	7	7	6
5	5	5	6	7	7	7	7	6	6	7
5	5	5	5	5	4	5	6	5	5	5
7	7	6	5	5	5	5	5	5	6	7
7	7	6	7	5	5	5	7	6	7	5

