

P. Guinn
RSS



85 JUN 7 4 9:52

whittaker memorial hospital

1003 twenty-eighth street - newport news, virginia 23607
telephone (804) 380-8100

May 15, 1985

Mr. Paul Guinn
U.S. Nuclear Regulatory Commission
Region II
101 Marietta Street, N.W.
Suite 3100
Atlanta, Georgia 30303

RE: License No. 45-16973-01

Dear Mr. Guinn:

Enclosed are the results of a close-out survey for the Nuclear Medicine Suite at 28th and Orcutt Streets.

1. All radiation signs, symbols, and related documents have been removed from the scan suite.
2. Survey meter measurements were taken with a Picker 655-186 survey meter with an HP-190 probe. Background = 0.01 mR/hr.
3. All smear samples taken in the scan room and hot lab were found to be negative for spreadable contamination (results documented on enclosed diagram). Swipes were counted with a Beckman Scintillation Detector with an efficiency of 35%. Background = 15 cpm or 43 dpm.

Please advise us as soon as possible when this facility may be released for unrestricted use.

Sincerely,

WHITTAKER MEMORIAL HOSPITAL

Daniel C. Reina

Administrator

8508090752 850726
REG2 LIC30
45-16973-01 PDR

RECEIVED BY LFMD	
Date	6/26/85
Log	June - 24
By	J. Guinn
Orig. To	
Action Compl	6/28/85

EXEMPT

Continuation of
prev. report
(C.N. 50594)

A COMMUNITY HOSPITAL

RECEIVED
85 JUN 26 12:49
U.S. NRC
LIC. FEE MGMT. BRANCH

50629

Official Copy

CLOSE-OUT SURVEY
HOT LAB

<u>Wipe Locations</u>	<u>Survey Meter Radiation Levels</u>	<u>DPM Over Background</u>
1 Outside trash can	0.01 mR/hr	0
2 Inside trash can	0.01 mR/hr	0
3 Lead Bricks	0.01 mR/hr	0
4 Work Counter	0.01 mR/hr	0
5 Work Counter	0.01 mR/hr	0
6 Wall	0.01 mR/hr	0
7 Door Knob	0.01 mR/hr	0
8 Wall	0.01 mR/hr	0
9 Floor	0.01 mR/hr	0
10 Floor	0.01 mR/hr	0
11 Wall	0.01 mR/hr	0
12 Floor under work counter	0.01 mR/hr	0
13 Work Counter	0.01 mR/hr	0
14 Work Counter	0.01 mR/hr	0
101 Floor	0.01 mR/hr	0
102 Floor	0.01 mR/hr	0
103 Floor	0.01 mR/hr	0
104 Wall	0.01 mR/hr	0
105 Wall	0.01 mR/hr	0
106 Wall	0.01 mR/hr	0
107 Wall	0.01 mR/hr	6

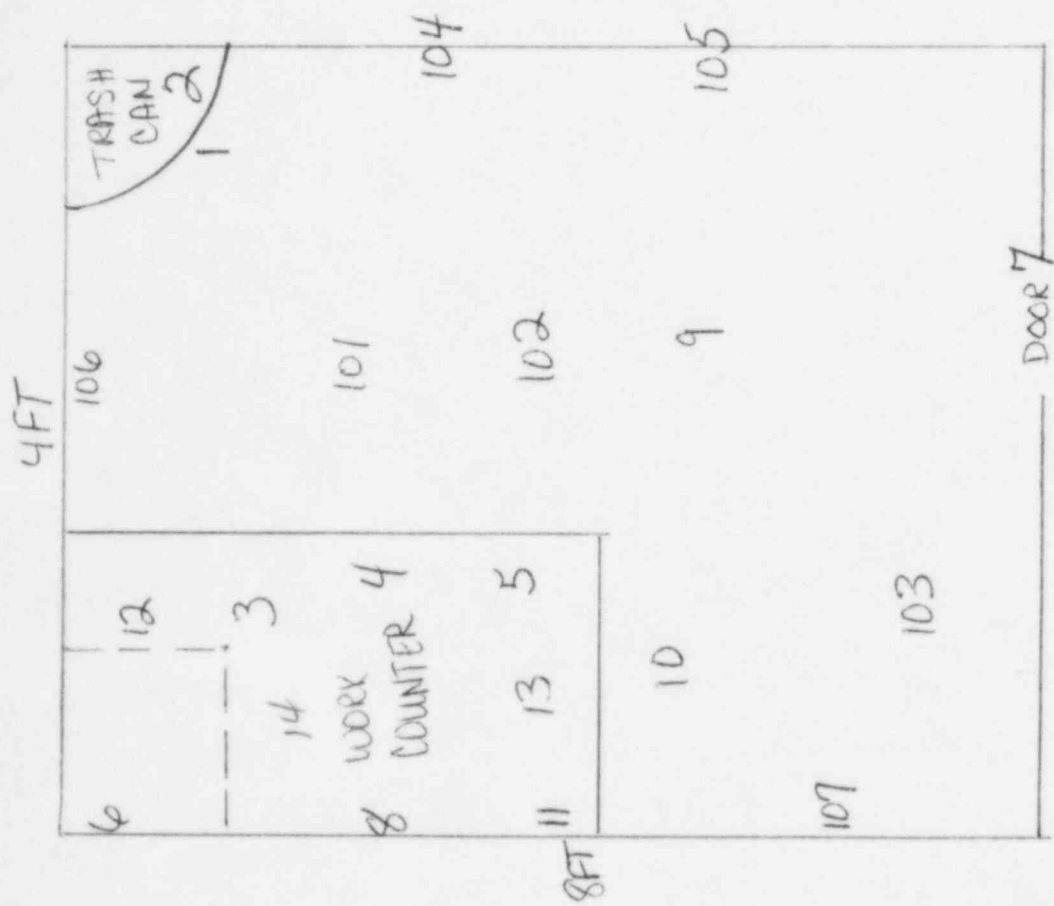

HOT LAB

CLOSE-OUT SURVEY
SCAN ROOM

<u>Wipe Locations</u>	<u>Survey Meter Radiation Levels</u>	<u>DPM Over Background</u>
1 Refrigerator	0.01 mR/hr	0
2 Table	0.01 mR/hr	0
4 Table	0.01 mR/hr	0
5 Scan room floor	0.01 mR/hr	0
6 Sink in kitchen	0.01 mR/hr	0
7 Bathroom door	0.01 mR/hr	0
8 Scan room door	0.01 mR/hr	0
9 Scan room floor	0.01 mR/hr	0
10 Scan room wall	0.01 mR/hr	0
11 Bathroom floor	0.01 mR/hr	0
12 Sink in bathroom	0.01 mR/hr	0
13 Toilet	0.01 mR/hr	0
14 Bathroom floor	0.01 mR/hr	0
15 Bathroom floor	0.01 mR/hr	0
16 Bathroom floor	0.01 mR/hr	0
17 Bathroom floor	0.01 mR/hr	0
18 Bathroom floor	0.01 mR/hr	8
19 Bathroom floor	0.01 mR/hr	0
20 Scan room floor	0.01 mR/hr	3
21 Scan room floor	0.01 mR/hr	0
22 Scan room floor	0.01 mR/hr	0
23 Scan room floor	0.01 mR/hr	0

Scan Room Results - Continued

<u>Wipe Locations</u>	<u>Survey Meter Radiation Levels</u>	<u>DPM Over Background</u>
24 Scan room floor	0.01 mR/hr	0
25 Scan room floor	0.01 mR/hr	0
26 Scan room floor	0.01 mR/hr	0
27 Scan room floor	0.01 mR/hr	0
28 Scan room floor	0.01 mR/hr	0
29 Scan room floor	0.01 mR/hr	14
30 Scan room floor	0.01 mR/hr	0
108 Scan room floor	0.01 mR/hr	11
109 Scan room floor	0.01 mR/hr	0
110 Scan room floor	0.01 mR/hr	0
111 Scan room floor	0.01 mR/hr	3
112 Scan room floor	0.01 mR/hr	0
113 Scan room floor	0.01 mR/hr	0
114 Scan room floor	0.01 mR/hr	0
115 Scan room floor	0.01 mR/hr	0
116 Scan room floor	0.01 mR/hr	0
117 Scan room floor	0.01 mR/hr	0
118 Scan room wall	0.01 mR/hr	0
119 Scan room wall	0.01 mR/hr	11
120 Scan room wall	0.01 mR/hr	0
121 Scan room wall	0.01 mR/hr	0
122 Scan room wall	0.01 mR/hr	0
123 Scan room wall	0.01 mR/hr	20
124 Scan room wall	0.01 mR/hr	0

NUCLEAR MEDICINE SCAN ROOM

KEY

- (W) - WALL
- (F) - FLOOR
- (D) - DOOR
- (T) - TABLE
- (R) - REFRIGERATOR

