



R&M ENGINEERING, INC.

ENGINEERS
GEOLOGISTS
SURVEYORS

6206 GLACIER HWY

P.O. BOX 1786

JUNEAU ALASKA 99802

PH. 907-780-6060

April 16, 1985

U.S. Nuclear Regulatory Commission
Region V
1450 Maria Lane, Suite 210
Walnut Creek, California 94596

Attn: Miss Beth A. Riedlinger
Health Physicist (Licensing)
Nuclear Materials Safety Section

Re: Application for Material License
Docket No. 030-22284
Control No. 18594

Ladies and Gentlemen:

This letter is in response to your letter of March 1, 1985, in which you listed several items of required additional information.

1. Item No. 1 is addressed in sketch "Sheet No. A".
2. We are having leak tests analyzed by National Leak Test Center, P.O. Box 486, Tonawanda, New York 14120. New York State DOL License No. 2323-3164
3. The gage is accompanied by the manufacturer's instruction booklet at all times. The usage procedures for compliance with NRC regulations are clearly annotated for reference.

At R & M, only three individuals are authorized to utilize the gage. These individuals have taken and passed the "Nuclear Gage Operators Radiation Safety Course" and are fully aware of security requirements. When the gage is not in active use, it is stored in a locked laboratory van or closet.

4. This is in effect.
5. The three individuals holding operators' licenses referenced in 3) above are the only persons authorized to service the device. These three individuals strictly adhere to that portion of the

8507170139 850508
REQ5 LIC30
50-23509-01 PDR

ANCHORAGE

FAIRBANKS

JUNEAU

SALT LAKE

18594

U.S. Nuclear Regulatory Commission
April 16, 1985
Page 2

training course which implores the user to not dismantle or attempt to dismantle the sources of radioactivity. Gages requiring more than perfunctory maintenance are shipped to the manufacturer.

Please process this material at your earliest convenience. If more information is required, we would appreciate prompt notification of the exact deficiency.

Sincerely,

R & M ENGINEERING, INC.

Joseph L. Connolly

Joseph L. Connolly, P.G., E.G.
Engineering Geologist

fej

Attachment

SUBJECT

Nuclear Gage

Location Sketch
Storage Area

PROJECT NO.

SHEET NO. A OF

R&M

R&M CONSULTANTS, INC.

ENGINEERS GEOLOGISTS PLANNERS SURVEYORS

CALC BY

DATE

CHKD BY

DATE

Laboratory Area

Mile G^{1/2}

OLD GLACIER HIGHWAY

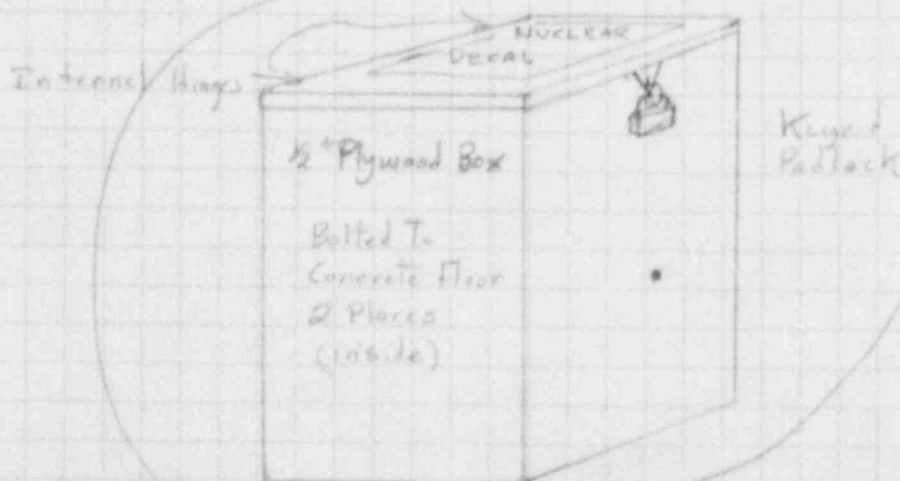
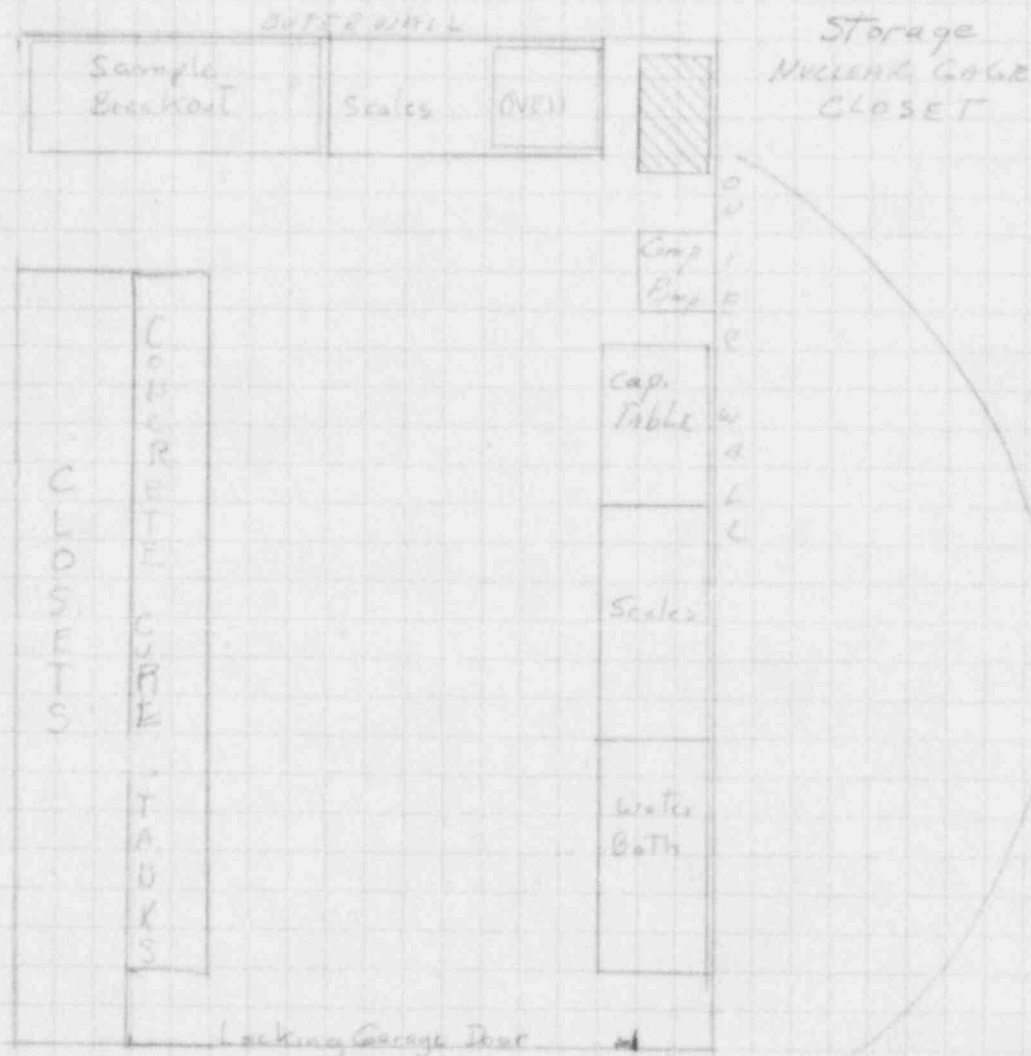

18594