



UNITED STATES
ATOMIC ENERGY COMMISSION
WASHINGTON, D.C. 20545

MAR 27 1968

DML:DPH
40-2061
STA-583, Amendment No. 2

American Potash & Chemical Company
Rare Earth Division
258 Ann Street
West Chicago, Illinois 60185

Attention: Mr. Gerald J. Sinke
Safety Engineer - R.S.O.

Gentlemen:

As requested in your application dated February 20, 1968, as supplemented March 13, 1968, AEC Source Material License No. STA-583 is hereby amended to add Item 10 as follows:

"10. Pursuant to Sections 20.106(b) and 20.302 of 10 CFR 20, the licensee is hereby authorized to treat source materials by incineration in accordance with the procedures described in applications dated February 20 and March 13, 1968. This condition does not authorize burial of source materials in excess of those quantities authorized pursuant to Section 20.304 of 10 CFR 20."

All other conditions of this license shall remain the same.

FOR THE ATOMIC ENERGY COMMISSION

DISTRIBUTION:
Document Room
State Health
Subject File
Compliance, Reg. III
N. Doulos, DML, w/3 cys. of ltr.
Br. Reading File
Div. Reading File

Don F. Harmon
Source & Special Nuclear Materials
Branch
Division of Materials Licensing

APR 4 1968

8407300320 XA

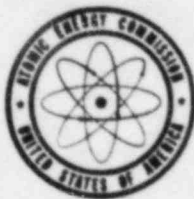

UNITED STATES
ATOMIC ENERGY COMMISSION
WASHINGTON, D.C. 20545

MAR 27 1968

DNL:DPH

40-2061

STA-583, Amendment No. 2

American Potash & Chemical Company
Rare Earth Division
258 Ann Street
West Chicago, Illinois 60185

Attention: Mr. Gerald J. Sinke
Safety Engineer - R.S.O.

Gentlemen:

As requested in your application dated February 20, 1968, as supplemented March 13, 1968, AEC Source Material License No. STA-583 is hereby amended to add Item 10 as follows:

"10. Pursuant to Sections 20.106(b) and 20.302 of 10 CFR 20, the licensee is hereby authorized to treat source materials by incineration in accordance with the procedures described in applications dated February 20 and March 13, 1968. This condition does not authorize burial of source materials in excess of those quantities authorized pursuant to Section 20.304 of 10 CFR 20."

All other conditions of this license shall remain the same.

FOR THE ATOMIC ENERGY COMMISSION

DISTRIBUTION:

Document Room

State Health

Subject File

Compliance, Reg. III

H. Doulos, DNL, w/3 cys. of ltr.

Br. Reading File

Div. Reading File

Don F. Harmon

Source & Special Nuclear Materials
Branch

Division of Materials Licensing

APR 4 1968

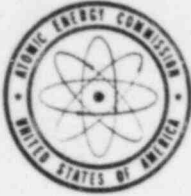

UNITED STATES
ATOMIC ENERGY COMMISSION
WASHINGTON, D.C. 20545

MAR 27 1968

DNL:DFH
40-2061
STA-583, Amendment No. 2

American Potash & Chemical Company
Rare Earth Division
258 Ann Street
West Chicago, Illinois 60135

Attention: Mr. Gerald J. Sinke
Safety Engineer - R.S.O.

Gentlemen:

As requested in your application dated February 20, 1968, as supplemented March 13, 1968, AEC Source Material License No. STA-583 is hereby amended to add Item 10 as follows:

- "10. Pursuant to Sections 20.106(b) and 20.302 of 10 CFR 20, the licensee is hereby authorized to treat source materials by incineration in accordance with the procedures described in applications dated February 20 and March 13, 1968. This condition does not authorize burial of source materials in excess of those quantities authorized pursuant to Section 20.304 of 10 CFR 20."

All other conditions of this license shall remain the same.

FOR THE ATOMIC ENERGY COMMISSION

DISTRIBUTION:
Document Room
State Health
Subject File
Compliance, Reg. III
N. Doulos, DNL, w/3 cys. of ltr.
Br. Reading File
Div. Reading File

Don F. Harmon
Source & Special Nuclear Materials
Branch
Division of Materials Licensing

APR 4 1968

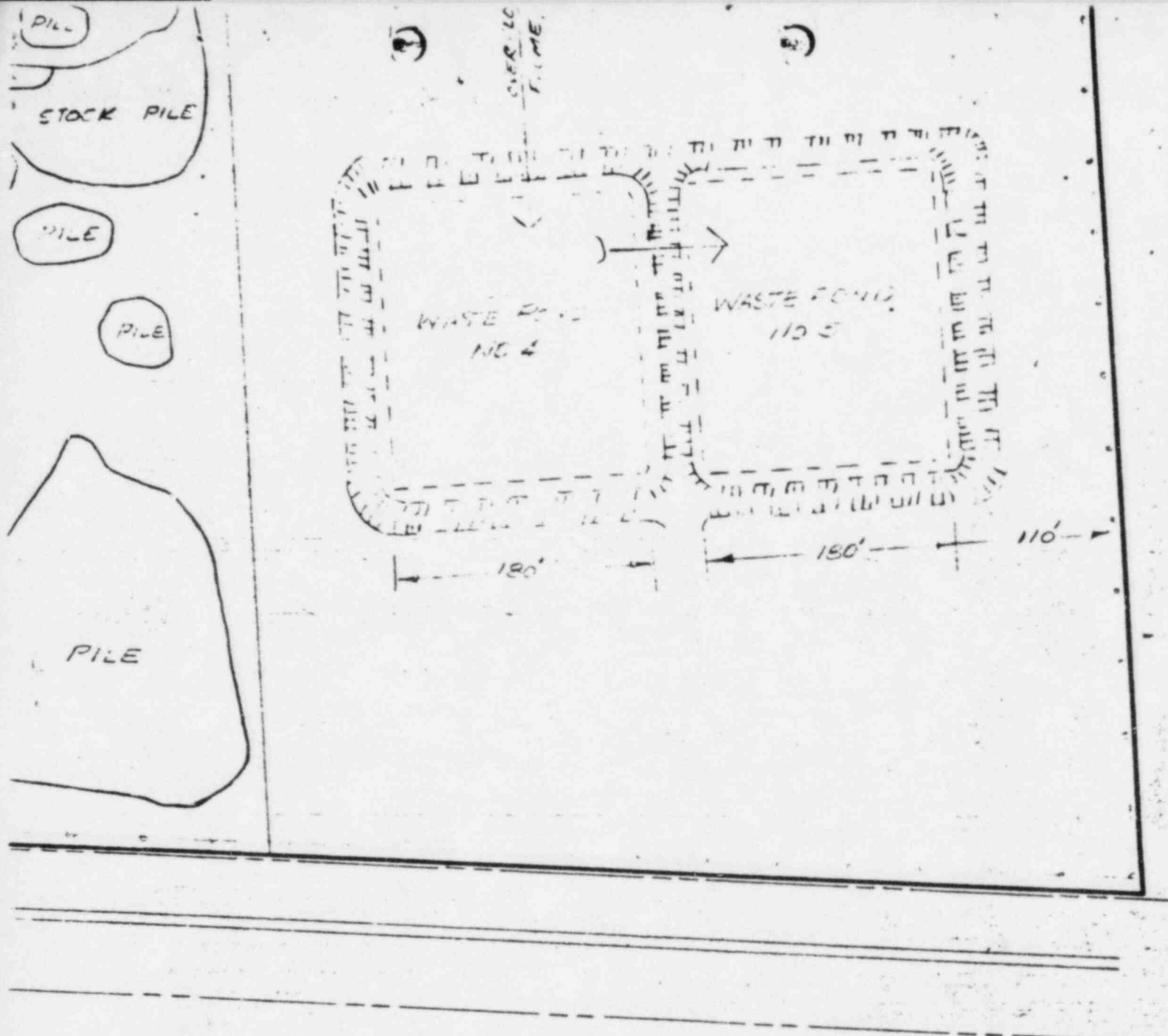

SCALE: 1" = 100'-0"

J.S.V. 4-21-64
REDRAWN FROM C11049 DATED 11-27-61

C-11083-4

EXHIBIT I

original copy too large to reproduce
should be available at local
Village Hall

ECONOMY
BUILDINGS
INC.

BROWN

20

17

18

15

COAL
STORAGE

16

ROADWAY

WOLFE AND EASTERN RAILROAD

PROPERTY PLAN

RARE EARTH PLANT
KERR MCGEE CHEMICAL CORP.
WEST CHICAGO, ILL.

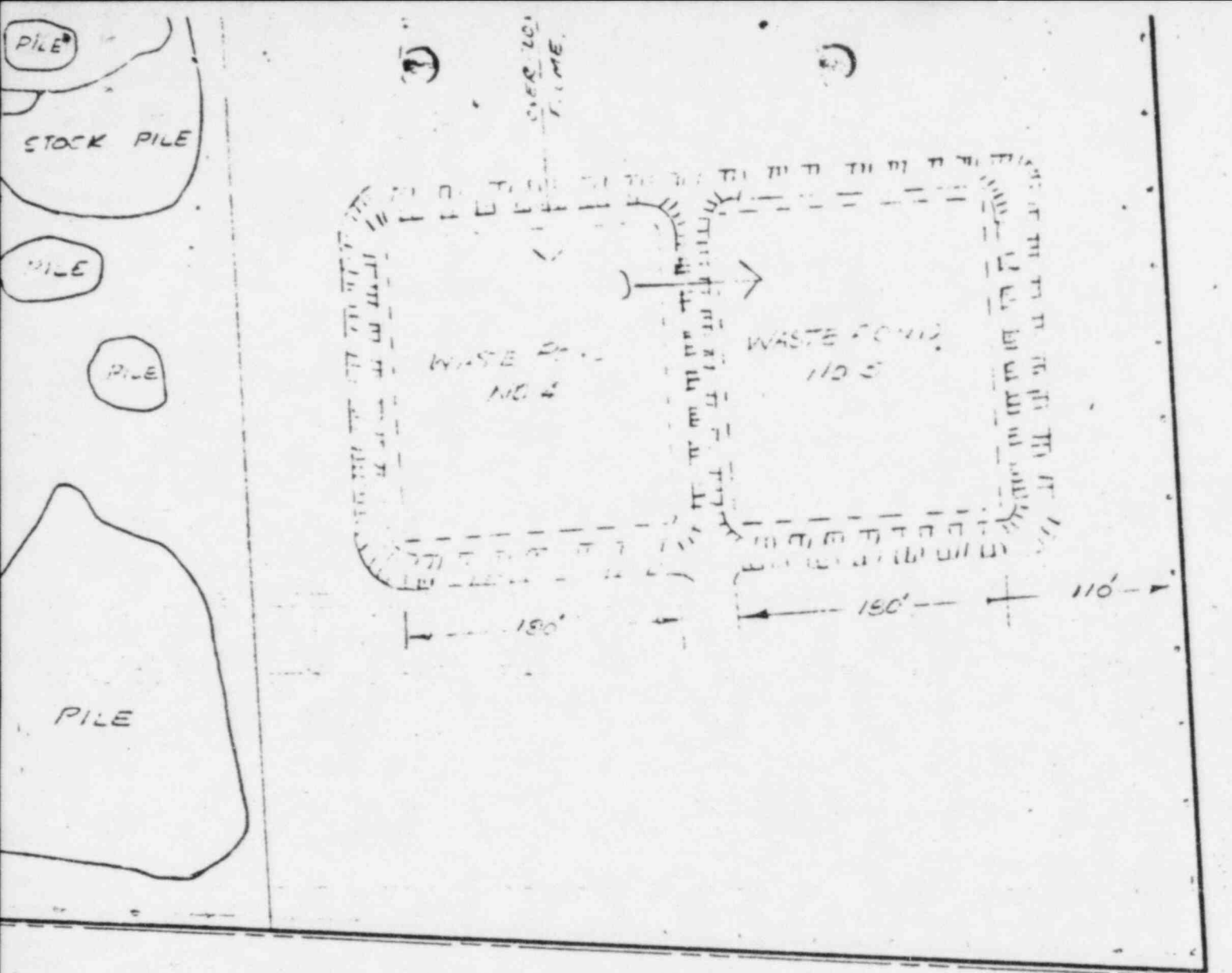

SCALE: 1" = 100'-0"

J.S.V. 4-21-64
 REDRAWN FROM C11049 DATED 11-27-61

C-11083-4

EXHIBIT I

Original Copy too large to reproduce
 should be available at local
 Village Hall

ECONOMY
BUILDINGS
INC.

BRONN

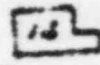
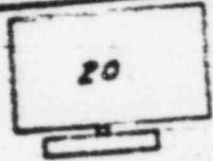

COAL
STORAGE



ROADWAY

JOINT AND EASTERN RAILROAD

PROPERTY PLAN
RARE EARTH PLANT
KERR MCGEE CHEMICAL CORP.
WEST CHICAGO, ILL.

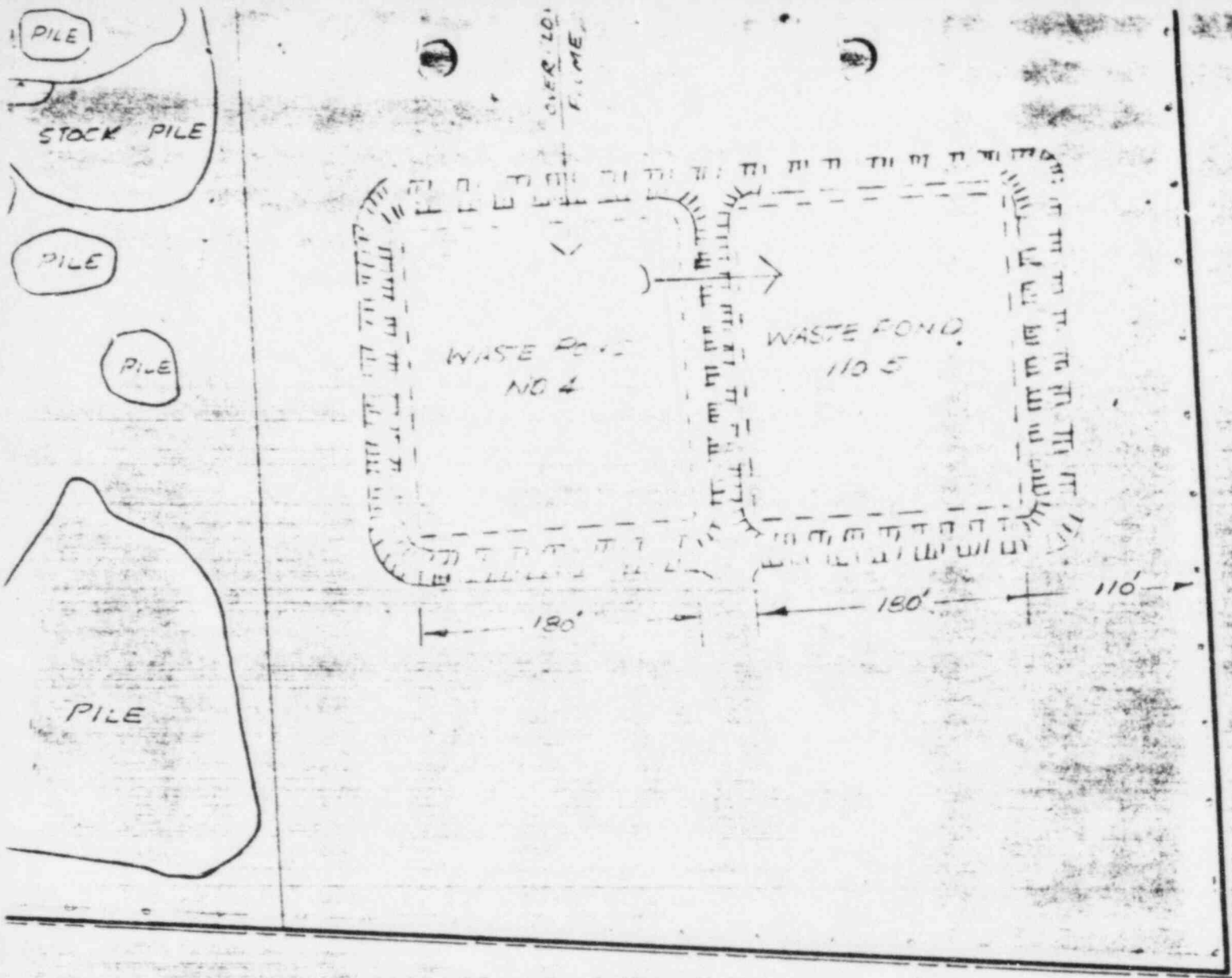

SCALE: 1" = 100'-0"

J.S.V. 4-21-64
 REDRAWN FROM C11049 DATED 11-27-61

C-11083-4

EXHIBIT I

original copy too large to reproduce
 should be available at
 Village Hall

ECONOMY
BUILDINGS
INC.

BROWN



COAL
STORAGE



ROADWAY

WOLFE AND EASTERN RAILROAD

PROPERTY PLAN

RARE EARTH PLANT
KERR MCGEE CHEMICAL CORP.
WEST CHICAGO, ILL.