



The Franklin Hospital

AND

SKILLED NURSING CARE UNIT

BENTON, ILLINOIS 62812

May 31, 1985

618-439-3161

J.R. Madera
Materials Licensing Section
U.S. Nuclear Regulatory Commission
Region III
799 Roosevelt Road
Glen Ellyn, IL 60137

Dear Mr. Madera:

Re: NRC materials license #12-04689-02

030-14234

A Ed 2/31/90

This is in response to your letter of March 29, 1985 requesting the results of the close-out radiation survey of our old nuclear medicine facilities.

In our license renewal application dated November 2, 1984, we indicated (Item 11, page 13) the department had been relocated. We had originally notified your agency of this relocation in a May 12, 1984 amendment application, which was approved as amendment #6 to our license.

If additional information is needed, please call Standard Nuclear Consultants, Ltd. directly at (312)344-5786, as they have been involved in preparing our license application. Thank you.

Sincerely,

[Signature]
George B. Murphy, M.D.

U.S. NRC
MATERIALS LICENSING
BRANCH

JUN 20 2:48 PM '85

8507230210 850619
REG3 LIC30
12-04689-02

PDR

FEE EXEMPT

*Continuation
of prev. request*

JUN 07 1985

REGION III

RECEIVED BY LFMS	
Date	<i>6/20/85</i>
Log	<i>June - 16 - III</i>
By	<i>[Signature]</i>
Orig. To	
Action Compl.	

CONTROL NO. 7 914 2

JUN 7 1985

CR01C - Unit Radiation Survey
OF Nuclear Medicine Imaging
in HOT LAB.

Date: September 1, 1984

	GM Survey (mr/hr)	Wipe Test (mr/ft ²)
#1 - ^{99m} Tc generator	20.05	20.05
2 - Radioactive Waste	20.05	20.05
3 - Decaying ^{99m} Tc generators	20.05	20.05
4 - Dose preparation free/dose Calibrator	20.05	20.05
5 - Shelves	20.05	20.05
6 - Shelves	20.05	20.05
7 - HOT LAB Floor	20.05	20.05
8 - HOT LAB Floor	20.05	20.05
9 - Imaging Room Shelves	20.05	20.05
10 - Imaging Room Shelves	20.05	20.05
11 - Imaging Room Shelves	20.05	20.05
12 - Nuclear Medicine Office Space	20.05	20.05
13 - Nuclear Medicine Office Space	20.05	20.05
14 - Nuclear Medicine Office Space	20.05	20.05
15 - Nuclear Medicine Office Space	20.05	20.05
16 thru 24 Nuclear Medicine Imaging Room & Patient Injection Areas	20.05	20.05

Background = 20.05 mr/hr

GM Meter - Victoreen 498

Operational Check = 1.0 mr/hr
(Side source on meter)

Survey performed by: Howard D. John RT.(R.R.T.)

CONTROL NO. 79142

outside

34"

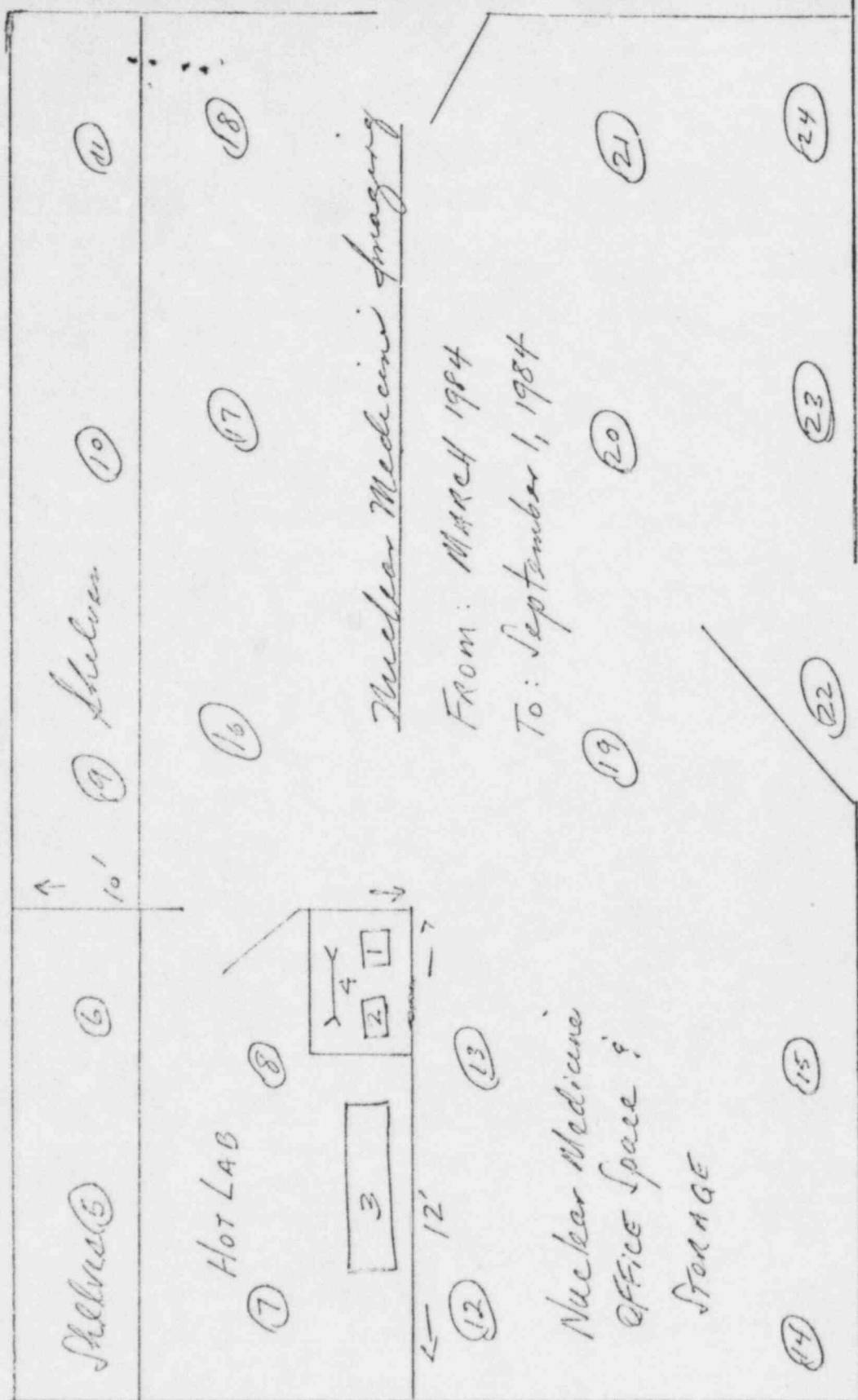

Hand-drawn
Floor Plan
Nuclear Medicine
Department



The Franklin Hospital

AND

SKILLED NURSING CARE UNIT

BENTON, ILLINOIS 62812

May 31, 1985

618-439-3161

J.R. Madera
Materials Licensing Section
U.S. Nuclear Regulatory Commission
Region III
799 Roosevelt Road
Carmel, IL 60137

Dear Mr. Madera:

030-14234

Re: NRC materials license #12-04689-02

A Ed 3/31/90

This is in response to your letter of March 29, 1985 requesting the results of the close-out radiation survey of our old nuclear medicine facilities.

In our license renewal application dated November 2, 1984, we indicated (Item 11, page 13) the department had been relocated. We had originally notified your agency of this relocation in a May 12, 1984 amendment application, which was approved as amendment #6 to our license.

If additional information is needed, please call Standard Nuclear Consultants, Ltd. directly at (312)344-5786, as they have been involved in preparing our license application. Thank you.

Sincerely,

[Signature]
George B. Murphy, M.D.

RECEIVED

JUN 07 1985

REGION III

CONTROL NO. 7 914 2

JUN

1985

LYOSC - unit radiation survey
OF Nuclear Medicine Imaging
in HOT LAB

Date: September 1, 1984

	GM Survey (mr/hr)	Wipe Test (mr/ft ²)
#1 - ^{99m} Tc generator	< 0.05	< 0.05
2 - Radioactive Waste	< 0.05	< 0.05
3 - Decaying ^{99m} Tc generators	< 0.05	< 0.05
4 - Dose preparation area/dose Calibrator	< 0.05	< 0.05
5 - Shelves	< 0.05	< 0.05
6 - Shelves	< 0.05	< 0.05
7 - HOT LAB Floor	< 0.05	< 0.05
8 - HOT LAB Floor	< 0.05	< 0.05
9 - Imaging Room Shelves	< 0.05	< 0.05
10 - Imaging Room Shelves	< 0.05	< 0.05
11 - Imaging Room Shelves	< 0.05	< 0.05
12 - Nuclear Medicine Office Space	< 0.05	< 0.05
13 - Nuclear Medicine Office Space	< 0.05	< 0.05
14 - Nuclear Medicine Office Space	< 0.05	< 0.05
15 - Nuclear Medicine Office Space	< 0.05	< 0.05
16 thru 24 Nuclear Medicine Imaging Room & Patient Injection Areas	< 0.05	< 0.05

Background = < 0.05 mr/hr

GM Meter - Victoreen 498

Operational Check = 1.0 mr/hr
(Side source on meter)

Survey performed by: Harold D. John RT.(R.R.T.)

CONTROL NO. 79142

outside

34'

↑ 10'

Shelves (5) (6) (9) Shelving (10) (11)

HOT LAB

(8)

(7)

3

4 1 2

12'

(12)

(13)

Nuclear Medicine
Office Space

STORAGE

(14)

(15)

(22)

(23)

(24)

(19)

(20)

(21)

(16)

(17)

(18)

Nuclear Medicine Imaging

From: MARCH 1984

To: September 1, 1984

Approved by
Nuclear Medicine
Imaging
Department

Hallway