

MATERIALS LICENSE
SUPPLEMENTARY SHEET

License Number

24-23418-01

Doc. or Reference Number

030-31239

Amendment No. 02

301797

St. Louis Metropolitan
Police Department
Crime Laboratory
1200 Clark Street
St. Louis, MO 63103

In accordance with NRC Form 314 "Certificate of Disposition" dated August 27, 1996 and letter dated October 7, 1996, License Number 24-23418-01 is hereby terminated.

TERMINATED

FOR THE U.S. NUCLEAR REGULATORY COMMISSION

Date

October 23, 1996

By

Colleen C. Casey

Nuclear Materials Licensing Branch, Region III

060055

COPY

2 ml
30
50

56

(FOR LFMS USE)
INFORMATION FROM LTS

BETWEEN:

License Fee Management Branch, ARM
and
Regional Licensing Sections

Program Code: 02410
Status Code: 0
Fee Category: 3P
Exp. Date: 20050930
Fee Comments:
Decom Fin Assur Req: N

LICENSE FEE TRANSMITTAL

A. REGION

1. APPLICATION ATTACHED

Applicant/Licensee: ST. LOUIS METROPOLITAN POLICE DEPT.
Received Date: 960903
Docket No: 3031239
Control No.: 301797
License No.: 24-23418-01
Action Type: Termination

2. FEE ATTACHED

Amount: 0
Check No.: 0

3. COMMENTS

Signed
Date

D. Hersey
9-4-96

B. LICENSE FEE MANAGEMENT BRANCH (Check when milestone 03 is entered /)

1. Fee Category and Amount: 3P

2. Correct Fee Paid. Application may be processed for:

Amendment
Renewal
License

3. OTHER

Signed
Date

AC 9/16/96

SEP 19 1996

Log	SEP 19 96
Remitter	
Check No.	
Amount	
Fee Category	3P
Type of Fee	EXEMPT
Date Check Made	
Date Completed	9/16/96
By:	AC

ESTIMATED BURDEN PER RESPONSE TO COMPLY WITH THIS INFORMATION COLLECTION REQUEST: 30 MINUTES. THIS MANDATORY SUBMITTAL IS USED BY NRC AS PART OF THE BASIS FOR ITS DETERMINATION THAT THE FACILITY HAS BEEN CLEARED OF RADIOACTIVE MATERIAL BEFORE THE FACILITY IS RELEASED FOR UNRESTRICTED USE. FORWARD COMMENTS REGARDING BURDEN ESTIMATE TO THE INFORMATION AND RECORDS MANAGEMENT BRANCH (MNRB 7714), U.S. NUCLEAR REGULATORY COMMISSION, WASHINGTON, DC 20555-0001, AND TO THE PAPERWORK REDUCTION PROJECT (3150-0028), OFFICE OF MANAGEMENT AND BUDGET, WASHINGTON, DC 20503.

CERTIFICATE OF DISPOSITION OF MATERIALS

INSTRUCTIONS: ALL ITEMS MUST BE COMPLETED -- PRINT OR TYPE
SEND THE COMPLETED CERTIFICATE TO THE NRC OFFICE SPECIFIED ON THE REVERSE

LICENSEE NAME AND ADDRESS

St. Louis Metropolitan Police Dept.
Crime Laboratory
1200 Clark
St. Louis, Mo. 63103

LICENSE NUMBER

24-23418-01

LICENSE EXPIRATION DATE

September 30, 2005

A. MATERIALS DATA (Check one and complete as necessary)

THE LICENSEE OR ANY INDIVIDUAL EXECUTING THIS CERTIFICATE ON BEHALF OF THE LICENSEE CERTIFIES THAT:
(Check and/or complete the appropriate item(s) below.)

- ☐ 1. NO MATERIALS HAVE EVER BEEN PROCURED OR POSSESSED BY THE LICENSEE UNDER THIS LICENSE.
- OR
- ☒ 2. ALL ACTIVITIES AUTHORIZED BY THE LICENSE HAVE CEASED AND ALL MATERIALS PROCURED AND/OR POSSESSED BY THE LICENSEE UNDER THE LICENSE NUMBER CITED ABOVE HAVE BEEN DISPOSED OF IN THE FOLLOWING MANNER. (If additional space is needed, use the reverse side or provide attachments.)

Describe specific material transfer actions and, if there were radioactive wastes generated in terminating this license, the disposal actions including the disposition of low-level radioactive waste, mixed waste, Greater-than-Class-C waste, and sealed sources, if applicable.

N/A

For transfers, specify the date of the transfer, the name of the licensed recipient, and the recipient's NRC license number or Agreement State name and license number.

N/A

If materials were disposed of directly by the licensee rather than transferred to another licensee, licensed disposal site or waste contractor, describe the specific disposal procedures (e.g., decay in storage). Only P-32 used in this Lab.

All has now been disposed of after decaying in storage
a minimum of twelve half-lives.

B. OTHER DATA

- ☒ 1. OUR LICENSE HAS NOT YET EXPIRED; PLEASE TERMINATE IT.
2. A RADIATION SURVEY WAS CONDUCTED BY THE LICENSEE TO CONFIRM THE ABSENCE OF LICENSED RADIOACTIVE MATERIALS AND TO DETERMINE WHETHER ANY CONTAMINATION REMAINS ON THE PREMISES COVERED BY THE LICENSE. (Check one)

☐ NO (Attach explanation)☒ YES, THE RESULTS (Check one)☒ ARE ATTACHED, or☐ WERE FORWARDED TO NRC ON (Date)**Termination
FEE EXEMPT**

TELEPHONE NUMBER

(Include Area Code)

314-444-5537

3. THE PERSON TO BE CONTACTED
REGARDING THE INFORMATION
PROVIDED ON THIS FORM

NAME

Joseph Stevens

4. MAIL ALL FUTURE CORRESPONDENCE REGARDING THIS LICENSE TO

Joseph Stevens
St. Louis Metropolitan Police Dept. Lab.
1200 Clark, St. Louis, Mo. 63103

RECEIVED**SEP 03 1996**

CERTIFYING OFFICIAL

I CERTIFY UNDER PENALTY OF PERJURY THAT THE FOREGOING IS TRUE AND CORRECT

PRINTED NAME AND TITLE

Chief of Police

SIGNATURE

Col. Ronald Henderson

REGION III

8-27-96

WARNING: FALSE STATEMENTS IN THIS CERTIFICATE MAY BE SUBJECT TO CIVIL AND/OR CRIMINAL PENALTIES. NRC REGULATIONS REQUIRE THAT SUBMISSIONS TO THE NRC BE COMPLETE AND ACCURATE IN ALL MATERIAL RESPECTS. 18 U.S.C. SECTION 1001 MAKES IT A CRIMINAL OFFENSE TO MAKE A WILLFULLY FALSE STATEMENT OR REPRESENTATION TO ANY DEPARTMENT OR AGENCY OF THE UNITED STATES AS TO ANY MATTER WITHIN ITS JURISDICTIONS.

FILE CERTIFICATES AS FOLLOWS:

IF YOU ARE A DISTRIBUTOR OF EXEMPT PRODUCTS, SEND TO:

DIVISION OF INDUSTRIAL AND MEDICAL NUCLEAR SAFETY
OFFICE OF NUCLEAR MATERIAL SAFETY AND SAFEGUARDS
U.S. NUCLEAR REGULATORY COMMISSION
WASHINGTON, DC 20555-0001

ALL OTHERS, IF YOU ARE LOCATED IN:

CONNECTICUT, DELAWARE, DISTRICT OF COLUMBIA, MAINE,
MARYLAND, MASSACHUSETTS, NEW HAMPSHIRE, NEW
JERSEY, NEW YORK, PENNSYLVANIA, RHODE ISLAND, OR
VERMONT, SEND APPLICATIONS TO:

LICENSING ASSISTANCE SECTION
NUCLEAR MATERIALS SAFETY BRANCH
U.S. NUCLEAR REGULATORY COMMISSION, REGION I
475 ALLENDALE ROAD
KING OF PRUSSIA, PA 19406-1415

ALABAMA, FLORIDA, GEORGIA, KENTUCKY, MISSISSIPPI,
NORTH CAROLINA, PUERTO RICO, SOUTH CAROLINA,
TENNESSEE, VIRGINIA, VIRGIN ISLANDS, OR WEST VIRGINIA,
SEND APPLICATIONS TO:

NUCLEAR MATERIALS SAFETY SECTION
U.S. NUCLEAR REGULATORY COMMISSION, REGION II
101 MARIETTA STREET NW, SUITE 2900
ATLANTA, GA 30323-0199

IF YOU ARE LOCATED IN:

ILLINOIS, INDIANA, IOWA, MICHIGAN, MINNESOTA, MISSOURI,
OHIO, OR WISCONSIN, SEND APPLICATIONS TO:

MATERIALS LICENSING SECTION
U.S. NUCLEAR REGULATORY COMMISSION, REGION III
801 WARRENVILLE ROAD
LISLE, IL 60532-4361 *ATTN: C. GILL*

ARKANSAS, COLORADO, IDAHO, KANSAS, LOUISIANA,
MONTANA, NEBRASKA, NEW MEXICO, NORTH DAKOTA,
OKLAHOMA, SOUTH DAKOTA, TEXAS, UTAH, OR WYOMING,
SEND APPLICATIONS TO:

MATERIAL RADIATION PROTECTION SECTION
U.S. NUCLEAR REGULATORY COMMISSION, REGION IV
811 RYAN PLAZA DRIVE, SUITE 400
ARLINGTON, TX 76011-8064

ALASKA, ARIZONA, CALIFORNIA, HAWAII, NEVADA, OREGON,
PACIFIC TRUST TERRITORIES, OR WASHINGTON, SEND
APPLICATIONS TO:

NUCLEAR MATERIALS SAFETY SECTION
U.S. NUCLEAR REGULATORY COMMISSION, REGION V
1450 MARIA LANE
WALNUT CREEK, CA 94596-5368

LABORATORY SURVEY REPORT

SURVEYOR: J. Stevens

TYPE INSTRUMENT: GM MODEL #: LUDLUM 3 SERIAL #: 67087

EFFICIENCY (IF APPLICABLE): 65 NORMAL BACKGROUND: 125 DPM: _____

RESULTS

COMPLETE DATE	SURVEY LOCATION	WIPE/SURVEY	DPM	COMMENTS	COMPLETE DATE	SURVEY LOCATION	WIPE/SURVEY	DPM	COMMENTS
8-23-96	1	W & S	Background						
11	2	W & S	11						
11	3	S	11						
11	4	S	11						
11	5	W	11						
11	6	W	11						
11	7	S	11						
11	8	S	11						
11	9	W	11						
11	10	W	11						
11	11	W	11						
11	12	W & S	11						
11	13	S	11						
11	14	S	11						
11	15	S	11						
11	16	S	11						
11	17	S	11						
11	18	S	11						
11	19	S	11						
11	20	W & S	11						
11	21	S	11						
11	22	S	11						
11	23	S	11						
11	24	S	11						
11	25	W & S	11						

W = Wipe

S = Survey

* See attached diagram

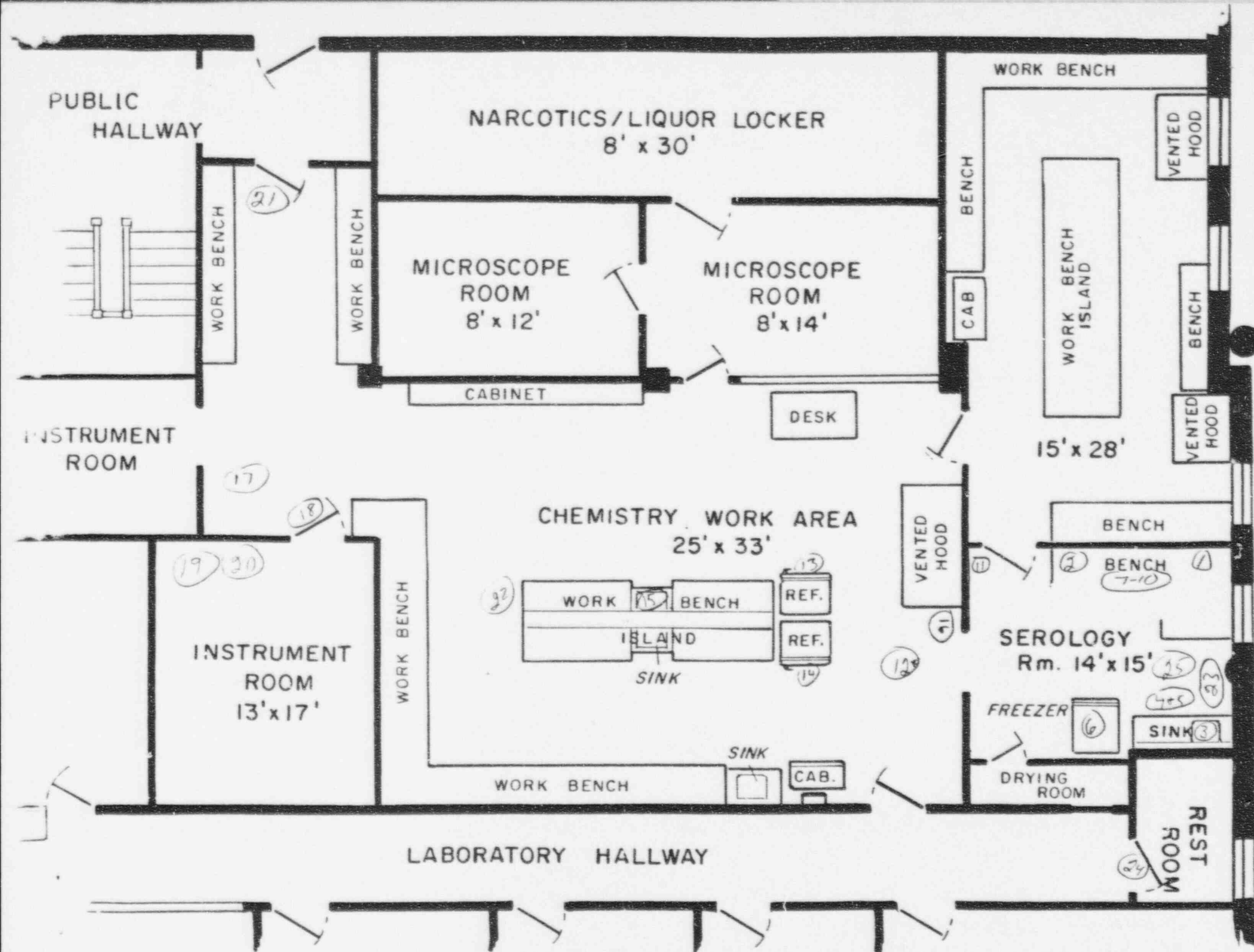

- 1) Bench top - under Paper G-M & wipe
- 2) Bare Bench top
- 3) ~~Sink & faucet~~ Sink & faucet
- 4) Freezer Handle Centrifuge control handles & latch
- 5) Inside centrifuge
- 6) Freezer Handle
- 7) Storage shielded storage cans (outer surface)
- 8) Plastic Boxes (pipet tips)
- 9) Incubation latch
- 10) Shaker lid handle
- 11) Phone
- 12) Main lab Floor
- 13) Refrig. ^{Freezer} door Handles
- 14) Refrig. / Freezer doors Handles
- 15) Sink Faucets
- 16) Shaker top & knob table & handle
- 17) Floor
- 18) Door Knob
- 19) Storage Box surface (outer)
- 20) " " (Floor)
- 21) Inside door knob (to hall & rest room)
- 22) Phone
- 23) Trash can
- 24) Rest room door knob
- 25) Floor

OCT 24 1996

Joseph Stevens
Radiation Safety Officer
St. Louis Metropolitan
Police Department
Crime Laboratory
1200 Clark Street
St. Louis, MO 63103

Dear Mr. Stevens:

Enclosed is Amendment No. 02 which terminates your NRC License Number 24-23418-01 in accordance with your request.

If you have any questions or require clarification on any of the information stated above, you may contact us at (630) 829-9887.

Sincerely,

Original Signed By
Colleen C. Casey
Nuclear Materials Licensing Branch

License No.: 24-23418-01
Docket No.: 030-31239

Enclosure: Amendment No. 02

DOCUMENT NAME: M:\03031239.TR6

To receive a copy of this document, indicate in the box: "C" = Copy without attachment/enclosure "E" = Copy with attachment/enclosure "N" = No copy

OFFICE	DNMS/RIII <i>CCCE</i>								
NAME	CCASEY:jaw								
DATE	10/23/96								

OFFICIAL RECORD COPY

301797



COL. RONALD HENDERSON, CHIEF OF POLICE

Service, Integrity, Leadership And Fair Treatment To All.

METROPOLITAN POLICE DEPARTMENT

CITY OF ST. LOUIS • 1200 CLARK AVENUE • ST. LOUIS, MISSOURI 63103

October 7, 1996

United States Nuclear Regulatory Commission
Region III
Attn: Colleen C. Casey
801 Warrenville Rd.
Lisle, Illinois 60532-4351

Ref: Control # 301797

Dear Mr. Casey:

Regarding your letter concerning our application dated 8-27-96 requesting termination of our by product materials license #24-23418-01, I am supplying the following additional information.

Items 1b and 2b:

No spills of radioactive material occurred under the license, therefore there were no radiation doses to the public.

Items 1c and 2c:

All radioactive solid and liquid wastes generated by our DNA profiling procedures were placed in shielded storage and allowed to decay for a minimum of six months prior to disposal through normal trash and sewer disposal routes. Consequently, no radioactive materials were released to unrestricted areas.

Item 3:

- a) The survey was conducted using a Ludlum Model 3 geiger counter fitted with a pancake type probe. This is the only type of survey instrument we have in our laboratory. Background level for the wipe test was determined by moistening a 15 centimeter diameter piece of filter paper with distilled water and placing it approximately 1 centimeter from the probe. Since the geiger counter only gives readings in cpms and mR/hr, the cpms were divided by the efficiency of the instrument to give 125 dpms. The direct dose rate reading was .03 mR/hr

RECEIVED

OCT 11 1996

REGION III

- b) Since none of the twenty five areas surveyed gave a reading in excess of the background level for either wipe test or direct dose rate results, I was under the impression that I could simply record "background" for each of the locations surveyed. Obviously I was in error with this assumption. In order to comply with 10 CFR Part 30 therefore, I am enclosing a revised version of the report listing the results obtained on this final survey.
- c) The action limits adhered to were 200 dpm above background level for wipe and .04 mR/hr above background for direct dose rate readings.
- d) The instrument was last calibrated on August 21, 1995.
- e) The figure is based on manufacturer stated specifications at time of purchase using a p-32 source. The instrument has been re-calibrated annually using a Cs-137 source.
- f) Each wipe test performed did cover 100 square centimeters.
- g) Our last use of P-32 was on March 14, 1996, approximately eleven and a half P-32 half lives prior to the survey in question.

Sincerely,

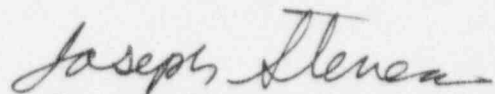

Joseph Stevens
St. Louis Metropolitan
Police Department
Laboratory Div.

JS/nfr1

LABORATORY SURVEY REPORT

SURVEYOR: J. Stevens

TYPE INSTRUMENT: GM MODEL #: LUDLUM 3 SERIAL #: 67087

EFFICIENCY (IF APPLICABLE): 65 NORMAL BACKGROUND mR/hr: .03 DPM: 125

RESULTS

COMPLETE DATE	SURVEY LOCATION	WIPE/ SURVEY	100mm ² DPM	mR/hr	COMPLETE DATE	SURVEY LOCATION	WIPE/ SURVEY	DPM	COMMENTS
2-23-94	1	W & S	125	.03					
"	2	W & S	125	.03					
"	3	S		.03					
"	4	S		.03					
"	5	W	125						
"	6	W	125						
"	7	S		.03					
"	8	S		.03					
"	9	W	125						
"	10	W	125						
"	11	W	125						
"	12	W & S	125	.03					
"	13	S		.03					
"	14	S		.03					
"	15	S		.03					
"	16	S		.03					
"	17	S		.03					
"	18	S		.03					
"	19	S		.03					
"	20	W & S	125	.03					
"	21	S		.03					
"	22	S		.03					
"	23	S		.03					
"	24	S		.03					
"	25	W & S	125	.03					

SEP 18 1996

Joseph Stevens
St. Louis Metropolitan
Police Department
1200 Clark Street
St. Louis, MO 63103

Dear Mr. Stevens:

We have reviewed the termination request dated August 27, 1996, for your NRC License No. 24-23418-01 and find that we will need additional information as follows:

1. When a licensee terminates licensed activities, we require that certain records be transferred to the NRC to ensure their long-term availability. Please transfer the following records, as were applicable to your program, that pertain to:
 - a. the decommissioning of your facility;
 - b. radiation doses to the public; and
 - c. waste disposal by release to sewers, incineration, radioactive material spills, and on-site burials.

Copies of these records should be transferred to the USNRC Region III, 801 Warrenville Road, Lisle, Illinois, 60532-4351.

No license terminations will be authorized unless all records considered important to the safe and effective decommissioning of the facility contained in 10 CFR 30.35(g), and all records concerning public dose and waste disposal have been transferred to the NRC.

A copy of 10 CFR Part 30 is enclosed for your use.

2. Regarding the above request for decommissioning records, please note that:
 - a. we are not requesting personnel dosimetry records for employed radiation workers, we are only concerned with doses to members of the public.
 - b. if any spills of radioactive materials occurred under the license you are requesting termination for, those records should be forwarded to us.

301797

- c. if any radioactive materials were released to unrestricted areas via sewer disposals or other effluent pathways, records of these releases should be forwarded to us also.

If any of the requested records are not applicable for your program, please so state specifically for each item.

- 3. With respect to item 1.a. above, we have reviewed your laboratory survey report dated August 23, 1996, and we need the following additional information to continue our review:

- a. It is unclear what units your background measurement is in- please clarify. Note that a background measurement for wipe tests in "counts per minute" is not acceptable.
- b. Please specify the actual numerical results for each survey measurement, in appropriate units, and distinguish between the wipe test results and the direct dose rate survey results.

Wipe test results should be in units of "disintegrations per minute" and the dose rate survey results should be in units of "milliroentgen per hour."

- c. Please specify the action limits for each type of measurement.
 - d. Please state the date on which the survey instrument used for the surveys was calibrated.
 - e. An efficiency of ".65" is listed on the survey report sheet. Does this efficiency refer to phosphorus-32 or was it determined using the sealed source used to calibrate the survey instrument?
 - f. Please confirm that each wipe test taken covered 100 square centimeters of area.
 - g. Please indicate the date on which licensed activities ceased.
- 4. If you have any questions concerning these matters please contact Colleen C. Casey at (630) 829-9841.

We will continue our review of your application upon receipt of this information. Please reply in duplicate, within 30 days, and refer to Control Number 301797.

J. Stevens

-3-

Upon failure to file an answer within the specified time, we will consider that you have abandoned your request and will void this action. This is without prejudice to resubmission of the application.

If you have any questions or require clarification on any of the information stated above, you may contact us at (630) 829-9887.

Sincerely,

Original Signed By
Colleen C. Casey
Nuclear Materials Licensing Branch

License No. 24-23418-01
Docket No. 030-31239

Enclosure: 10 CFR Part 30

DOCUMENT NAME: M:\03031239.DF6

To receive a copy of this document, indicate in the box: "C" = Copy without enclosures "E" = Copy with enclosures "N" = No copy

OFFICE	DNMS/RIII								
NAME	CCASEY:jaw								
DATE	09/17/96								

OFFICIAL RECORD COPY