



# KASPER ASSOCIATES, Inc.

Engineers, Surveyors, Planners  
765 Fairfield Avenue • P.O. Box 1963 • Bridgeport, CT 06601  
Tel. (203) 579-1902

March 15, 1984

Nuclear Regulatory Commission - Region I  
631 Park Avenue  
King of Prussia, Pennsylvania 19406

Attention: Material Licensing

Re: License Amendment  
License No. 06-19549-01

Gentlemen:

As a result of a recent license inspection, conducted by the NRC Region I office, it has come to our attention that our license should be amended in several respects.

License Condition 16 requires that the licensed material be possessed and used in accordance with statements contained in our application dated September 24, 1980. The following revised information is provided so that we can remain in compliance with Condition 16:

Item 6 - Change to read

- a) Arthur Gruhn
- b) Wayne Blair
- c) Derrick Schull

Construction Manager  
Chief Inspector  
Inspector

Item 7 - Change to read

Arthur W. Gruhn

Item 13b - Storage Facilities - Change to indicate

Location 1 - 87 Washington Avenue, Bridgeport, CT. 06604  
Location 2 - 9 Moscariello Place, Norwalk, CT. 06853  
Sketches of locations are enclosed

Item 15 - Paragraph 9

Change Emergency Number for Radiation Safety Officer to read

Arthur W. Gruhn 203 579-1902 (Office)  
203 453-4237 (Home)

B507170513  
REG1 LIC30  
06-19549-01

B50620

PDR

1110

02230

Affiliates:

J&D Kasper & Associates (203) 579-1902  
Kasper-Ryan Associates (203) 748-2623

"OFFICIAL RECORD COPY"

An Equal Opportunity Employer

MAR 22 1984

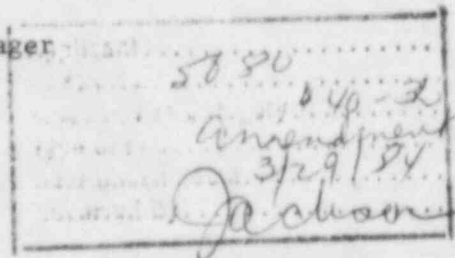
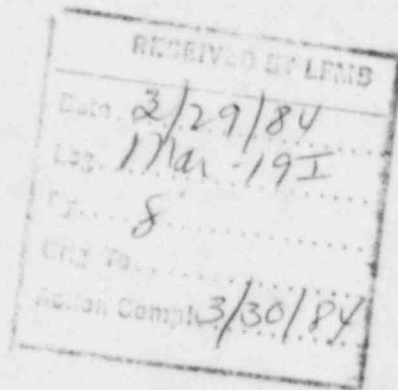



KASPER ASSOCIATES, INC.

Nuclear Regulatory Commission - Region 1  
March 15, 1984  
Page 2

In addition to the locations listed under Item 13b, we will be establishing a third field office in Newington, CT. within the next few months. When the office is established, we will have a requirement for use and storage of a moisture density gauge at that location. Please advise whether it will be necessary to make a further amendment to our license at that time to show the exact location for storage.

We are enclosing, herewith, a check in the amount of \$40.00 to cover the fee for the necessary license amendments. If any further information is required, please contact our office.

Very truly yours,

KASPER ASSOCIATES, INC.

Arthur W. Gruhn, P.E.  
Construction Manager

AWG:dmo



**KASPER ASSOCIATES, Inc.**

Engineers, Surveyors, Planners

765 Fairfield Avenue • P. O. Box 1963 • Bridgeport, Ct 06604  
Tel (203) 579-1902

Project NUCLEAR GAUGE STORAGE LOCATION

Sheet 1 of 1

Computed By A. Gruba Checked By \_\_\_\_\_

Date 3/16/84

Field Book Ref. \_\_\_\_\_ Other Refs. \_\_\_\_\_

Revisions \_\_\_\_\_

STORAGE LOCATION: 87 WASHINGTON AVE BRIDGEPORT, CT.

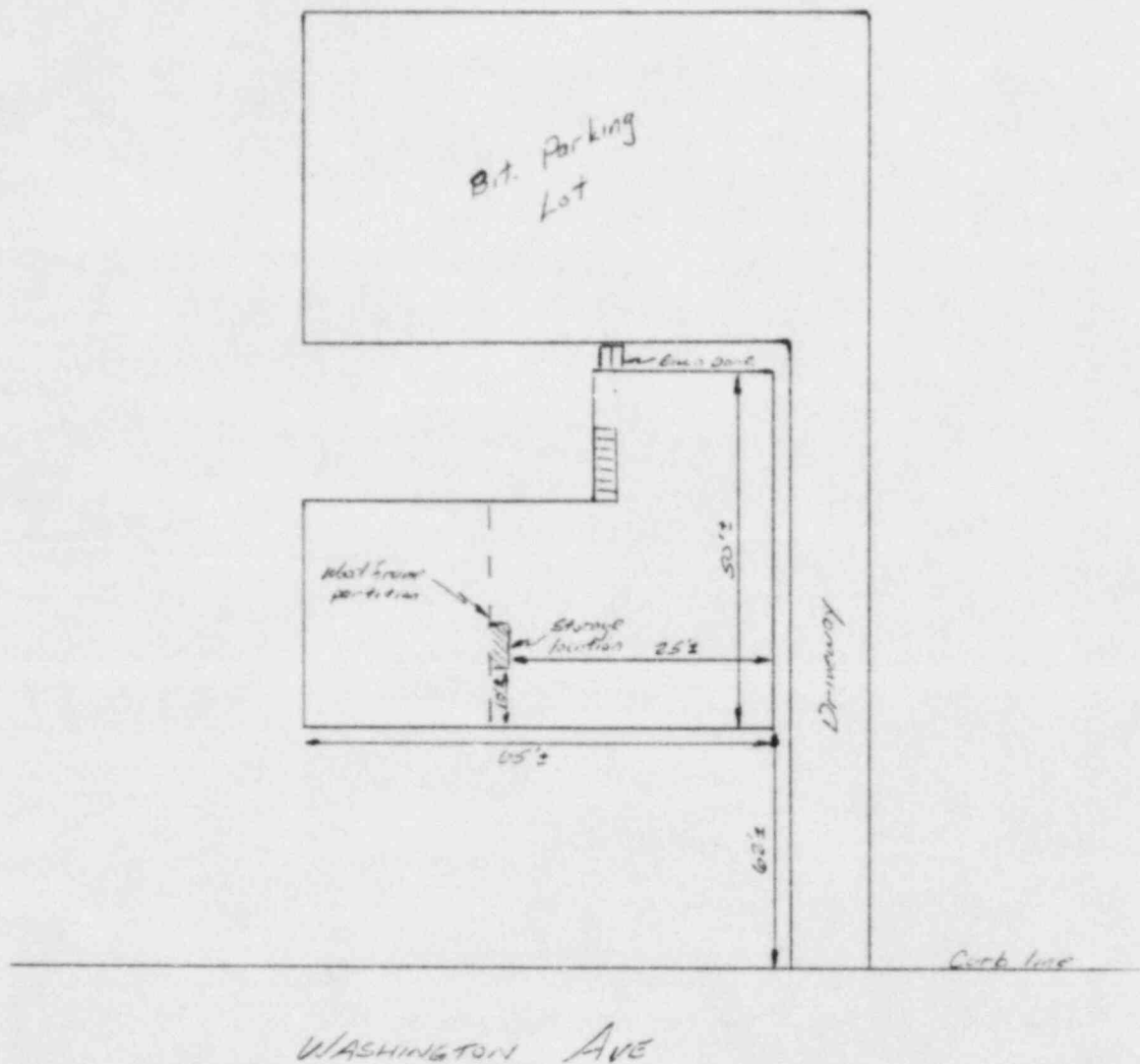

STORAGE LOCATION IS IN BASEMENT OF 87 WASHINGTON AVENUE. GAUGE TO BE SECURED IN WOOD STORAGE CABINET AND CHAINED TO STEEL SUPPORTING COLUMN.

BUILDING IS PROTECTED BY INTRUSION ALARM AFTER WORKING HOURS.



**KASPER ASSOCIATES, Inc.**

Engineers, Surveyors, Planners

765 Fairfield Avenue • P. O. Box 1963 • Bridgeport, Ct. 06604  
Tel. (203) 579-1902

Project NUCLEAR GAUGE STORAGE LOCATION  
Computed By A. Givho Checked By \_\_\_\_\_  
Field Br & Ref. \_\_\_\_\_ Other Refs. \_\_\_\_\_

Sheet 1 of 1  
Date 3/16/84  
Revisions \_\_\_\_\_

STORAGE LOCATION: 9 MOSCARIELLO PLACE NORWALK CT

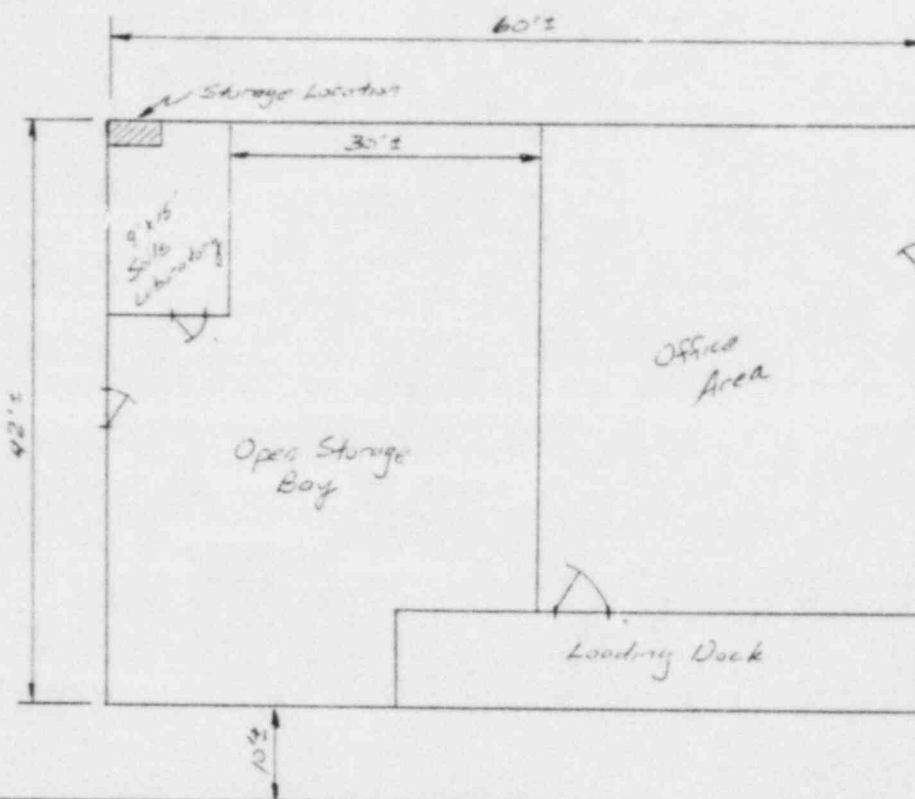

*Carbine*

*Reconstructed Moscarillo Place*

GAUGE TO BE STORED IN STORAGE CABINET IN SOILS LABORATORY. GAUGE WILL BE SECURED TO STRUCTURE WITH FLOOR BOLTS AND LOCKED CHAIN WHEN NOT IN USE.

BUILDING IS ONE STORY CONCRETE BLOCK STRUCTURE. WINDOWS ARE COVERED WITH PLYWOOD AND/OR PROTECTIVE SCREENING.