

MATERIALS LICENSE

Pursuant to the Atomic Energy Act of 1954, as amended, the Energy Reorganization Act of 1974 (Public Law 93-438), and Title 10, Code of Federal Regulations, Chapter I, Parts 30, 31, 32, 33, 34, 35, 36, 39, 40, and 70, and in reliance on statements and representations heretofore made by the licensee, a license is hereby issued authorizing the licensee to receive, acquire, possess, and transfer byproduct, source, and special nuclear material designated below; to use such material for the purpose(s) and at the place(s) designated below; to deliver or transfer such material to persons authorized to receive it in accordance with the regulations of the applicable Part(s). This license shall be deemed to contain the conditions specified in Section 183 of the Atomic Energy Act of 1954, as amended, and is subject to all applicable rules, regulations, and orders of the Nuclear Regulatory Commission now or hereafter in effect and to any conditions specified below.

OFFICIAL RECORD COPY

Licensee		
1. Central Pennsylvania Medical Imaging Institute, LLC		3. License Number 37-30329-01
2. 30 E. Shady Lane Enola, Pennsylvania 17025		4. Expiration Date October 31, 2001
		5. Docket or Reference No. 030-34211
6. Byproduct, Source, and/or Special Nuclear Material	7. Chemical and/or Physical Form	8. Maximum Amount that Licensee May Possess at Any One Time Under This License
A. Any byproduct material identified in 10 CFR 35.100	A. Any radiopharmaceutical identified in 10 CFR 35.100	A. As needed
B. Any byproduct material identified in 10 CFR 35.200	B. Any radiopharmaceutical identified in 10 CFR 35.200 except generators and gas	B. As needed
9. Authorized use		
A. Any uptake, dilution and excretion procedure approved in 10 CFR 35.100.		
B. Any imaging and localization procedure approved in 10 CFR 35.200.		

CONDITIONS

10. Licensed material may be used only at the licensee's facilities located at 30 E. Shady Lane, Enola, Pennsylvania.
11. A. The licensee may not possess and use materials authorized in Items 6, 7, and 8, until: (1) the licensee has constructed the facilities and obtained the equipment described in the application and supporting documentation; and (2) the U.S. Nuclear Regulatory Commission, Region I, ATTN: Chief, Nuclear Materials Safety Branch, 475 Allendale Road, King of Prussia, Pennsylvania 19406 has been notified in writing that activities authorized by the license will be initiated.
- B. In accordance with the requirements set forth in 10 CFR 30.36(b), 40.42(b), and 70.38(b), the licensee shall promptly notify the Nuclear Regulatory Commission, in writing, of a decision not to complete the facility, acquire equipment, or possess and use authorized material.
12. The Radiation Safety Officer for this license is Henry K. Smith, D.O.

9610210161 961009
PDR ADOCK 03034211
C PDR

ML 10

MATERIALS LICENSE
SUPPLEMENTARY SHEET

License Number

37-30329-01

Docket or Reference Number

030-34211

13. Licensed material listed in Item 6 above is only authorized for use by, or under the supervision of, the following individuals for the materials and uses indicated:

<u>Authorized Users</u>	<u>Material and Use</u>
Henry K. Smith, D.O.	35.100; 35.200
George Popkey, M.D.	35.100; 35.200

14. In addition to the possession limits in Item 8, the licensee shall further restrict the possession of licensed material to quantities below the minimum limit specified in 10 CFR 30.35(d), 40.36(b), and 70.25(d) for establishing financial assurance for decommissioning.
15. The licensee is authorized to transport licensed material in accordance with the provisions of 10 CFR Part 71, "Packaging and Transportation of Radioactive Material."
16. Except as specifically provided otherwise in this license, the licensee shall conduct its program in accordance with the statements, representations, and procedures contained in the documents, including any enclosures, listed below, except for minor changes in the medical use radiation safety procedures as provided in 10 CFR 35.31. The U.S. Nuclear Regulatory Commission's regulations shall govern unless the statements, representations, and procedures in the licensee's application and correspondence are more restrictive than the regulations.

A. Application dated July 19, 1996

For the U.S. Nuclear Regulatory Commission

Original Signed By:

Michelle Beardsley

By

Division of Nuclear Materials Safety
Region I
King of Prussia, Pennsylvania 19406

Date

OCT - 9 1996

OCT - 9 1996

License No. 37-30329-01
Docket No. 030-34211
Control No. 123509

Henry K. Smith, D.O.
Central Pennsylvania Medical Imaging
Institute, LLC
30 E. Shady Lane
Enola, PA 17025

Dear Dr. Smith:

Please review the enclosed document carefully and be sure that you understand all conditions. If there are any errors or questions, please notify the U.S. Nuclear Regulatory Commission, Region I Office, Licensing Assistance Team, (610) 337-5093 or 5239, so that we can provide appropriate corrections and answers.

Please be advised that your license expires at the end of the day, in the month, and year stated in the license. Until your license is terminated, you must conduct your program involving byproduct materials in accordance with the conditions of your NRC license, representations made in your license application, and NRC regulations. In particular, note that you must:

1. Operate in accordance with NRC regulations 10 CFR Part 19, "Notices, Instructions and Reports to Workers; Inspections," 10 CFR Part 20, "Standards for Protection Against Radiation," 10 CFR Part 35, "Medical Use of Byproduct Material," and other applicable regulations.
2. Not possess and use materials authorized in Items 6, 7, and 8, on the license until:
 - a. you have constructed the facilities and obtained the equipment described in the license application and supporting documentation; and
 - b. you have notified the U.S. Nuclear Regulatory Commission, Region I, ATTN: Chief, Nuclear Materials Safety Branch, 475 Allendale Road, King of Prussia, Pennsylvania 19406 in writing, that activities authorized by the license will be initiated.
3. Notify NRC, in accordance with 10 CFR 35.14, no later than 30 days after:
 - a. the date that you permit any individual to work as an Authorized User or an Authorized Nuclear Pharmacist pursuant to 10 CFR 35.13(b)(1) through (4), and provide to the Commission a copy of the board certification, the Commission or Agreement State license, or the Permit issued by a licensee of broad scope identifying the individual;

OFFICIAL RECORD COPY

ML 10

- b. an Authorized User, Authorized Nuclear Pharmacist, Radiation Safety Officer, Teletherapy Physicist, or Medical Physicist permanently discontinues performance of duties under the license or has a name change; or
 - c. when the mailing address on the license changes (no fee is required if the location of byproduct material remains the same).
- 4. In accordance with 10 CFR 30.36(b) and/or license condition, notify NRC, promptly, in writing, and request termination of the license:
 - a. when you decide to terminate all activities involving materials authorized under the license; or
 - b. if you decide not to complete the facility, acquire equipment, or possess and use authorized material.
- 5. In accordance with 10 CFR 35.13, request and obtain a license amendment before you:
 - a. receive or use byproduct material for a clinical procedure permitted under Part 35 but not permitted by your license issued pursuant to this Part;
 - b. permit an individual, except as specified in 10 CFR 35.14(b)(1) through (4), to work as an Authorized User or Authorized Nuclear Pharmacist under the license;
 - c. change Radiation Safety Officer, Teletherapy Physicist or Medical Physicist;
 - d. order byproduct material in excess of the amount, or radionuclide, or form different than authorized on the license; or
 - e. add or change the areas of use, or address or addresses of use identified in the license application or on the license.
- 6. Receive written approval from the NRC prior to any change in ownership of your organization, in accordance with 10 CFR 30.34(b).
- 7. Submit a complete renewal application with proper fee or termination request at least 30 days before the expiration date of your license. You will receive a reminder notice approximately 90 days before the expiration date. Possession of byproduct material after your license expires is a violation of NRC regulations. A license will not normally be renewed, except on a case-by-case basis, in instances where licensed material has never been possessed or used.

H. Smith, D.O.
Central PA Medical Imaging Inst., LLC -3-

In addition, please note that NRC Form 313 requires the applicant, by his/her signature, to verify that the applicant understands that all statements contained in the application are true and correct to the best of the applicant's knowledge. The signatory for the application should be the licensee or a certifying official of the licensee rather than the Radiation Safety Officer or a consultant.

You will be periodically inspected by the NRC. Failure to conduct your program in accordance with NRC regulations, license conditions, and representations made in your license application and supplemental correspondence with NRC will result in enforcement action against you. This could include issuance of a notice of violation, or imposition of a civil penalty, or an order suspending, modifying or revoking your license as specified in the "General Statement of Policy and Procedure for NRC Enforcement Actions," (Enforcement Policy), NUREG 1600.

Since serious consequences to employees and the public can result from failure to comply with NRC requirements, prompt and vigorous enforcement actions will be taken when dealing with licensees who do not achieve the necessary meticulous attention to detail and the high standard of compliance which NRC expects of its licensees.

Thank you for your cooperation.

Sincerely,

Original Signed By:
Michelle Beardsley

Michelle R. Beardsley
Division of Nuclear Materials Safety

License No. 37-30329-01
Docket No. 030-34211
Control No. 123509

Enclosures:

1. License No. 37-30329-01
2. 10 CFR Parts 2, 19, 20, 30, 31, 35, and 170

DOCUMENT NAME: R:\WPS\MLTR\L3730329.01

To receive a copy of this document, indicate in the box: "C" = Copy w/o attach/encl "E" = Copy w/ attach/encl "N" = No copy

OFFICE	DNMS/RI	N	DNMS/RI				
NAME	Beardsley MB						
DATE	10/08/96	10/	/96	10/	/96	10/	/96

OFFICIAL RECORD COPY

030-34211

Control # 123509

American Osteopathic Board of Radiology



certifies that

Henry K. Smith, II, D.O.

having met the standards and passed the required examinations

is Recertified in

Diagnostic Radiology

and is hereby awarded this certificate for the period from

1992 - 2002



American Osteopathic Association
Executive Director
Robert A. ...

Certificate No. R-402

American Osteopathic Board of Radiology
Secretary
Gregory D. ...

Michael W. Williams, D.O. F.A.O.R.
Secretary

123509

OCT - 8 1996

OFFICIAL RECORD COPY

ML 10

FAX REC'D

MS16

J-1

030-34211

Central Pennsylvania Medical Imaging Institute
Gadani Medical Center
30 E. Shady Lane
Enola, PA 17025

September 26, 1996

U.S. Nuclear Regulatory Commission
Region I
475 Allendale Road
King of Prussia, PA 19406

ATTN: Ms. Michelle Beardsley

Re: Central Pennsylvania Medical Imaging Institute
Control Number: 123509

Dear Ms. Beardsley:

This correspondence is in response to your questions concerning our recent license application. With regard to the use of I-131, it will not be utilized at our facility. In the event we wish to use I-131 in the future, we will amend our license to include submission of a Quality Management Program at that time.

Please ensure that all future correspondence is directed to the attention of Dr. Henry K. Smith, as Mr. Fran Owen is no longer at our facility.

Sincerely,



Diana L. Stockdale, MS for
Henry K. Smith, D.O.

OFFICIAL RECORD COPY

ML 10

123509

FAX REC'D SEP 27 1996

U. S. Nuclear Regulatory Commission		Date:8-22-96
Telephone or Verbal Conversation Record		Time:10:00 a.m.
<input type="checkbox"/> Incoming Call	<input checked="" type="checkbox"/> Outgoing Call	<input type="checkbox"/> Visit
Person Calling: Michelle Beardsley	Office: USNRC Region I	Phone #: (215) 337-6942
Person Called: Francis Owens	Office:	Phone #:
Conversation		
Subject: License application-Central PA Medical Imaging Inst. Docket No.030-34211 Control No. 123509		
Summary: I explained to Mr. Owens that they will need to submit a Quality Management Program if they will be using NaI-125/131 > 30uCi otherwise, that can give a statement of negative declaration for their use.		
Referred to:		
Action Requested: QMP submittal		
Action Taken:		

OFFICIAL RECORD COPY

ML 10

(10-94)

10 CFR 30, 32, 33

34, 35, 36, 39 and 40

APPLICATION FOR MATERIAL LICENSE

ESTIMATED BURDEN PER RESPONSE TO COMPLY WITH THIS INFORMATION COLLECTION REQUEST: 9 HOURS. SUBMITTAL OF THE APPLICATION IS NECESSARY TO DETERMINE THAT THE APPLICANT IS QUALIFIED AND THAT ADEQUATE PROCEDURES EXIST TO PROTECT THE PUBLIC HEALTH AND SAFETY. FORWARD COMMENTS REGARDING BURDEN ESTIMATE TO THE INFORMATION AND RECORDS MANAGEMENT BRANCH (T-6 F33), U.S. NUCLEAR REGULATORY COMMISSION, WASHINGTON, DC 20555-0001, AND TO THE PAPERWORK REDUCTION PROJECT (3150-0120), OFFICE OF MANAGEMENT AND BUDGET, WASHINGTON, DC 20503.

INSTRUCTIONS: SEE THE APPROPRIATE LICENSE APPLICATION GUIDE FOR DETAILED INSTRUCTIONS FOR COMPLETING APPLICATION. SEND TWO COPIES OF THE ENTIRE COMPLETED APPLICATION TO THE NRC OFFICE SPECIFIED BELOW.

APPLICATION FOR DISTRIBUTION OF EXEMPT PRODUCTS FILE APPLICATIONS WITH:

DIVISION OF INDUSTRIAL AND MEDICAL NUCLEAR SAFETY
OFFICE OF NUCLEAR MATERIALS SAFETY AND SAFEGUARDS
U.S. NUCLEAR REGULATORY COMMISSION
WASHINGTON, DC 20555-0001

ALL OTHER PERSONS FILE APPLICATIONS AS FOLLOWS:

IF YOU ARE LOCATED IN:

CONNECTICUT, DELAWARE, DISTRICT OF COLUMBIA, MAINE, MARYLAND,
MASSACHUSETTS, NEW HAMPSHIRE, NEW JERSEY, NEW YORK, PENNSYLVANIA,
RHODE ISLAND, OR VERMONT, SEND APPLICATIONS TO:

LICENSING ASSISTANT SECTION
NUCLEAR MATERIALS SAFETY BRANCH
U.S. NUCLEAR REGULATORY COMMISSION, REGION I
475 ALLENDALE ROAD
KING OF PRUSSIA, PA 19406-1415

ALABAMA, FLORIDA, GEORGIA, KENTUCKY, MISSISSIPPI, NORTH CAROLINA, PUERTO
RICO, SOUTH CAROLINA, TENNESSEE, VIRGINIA, VIRGIN ISLANDS, OR WEST VIRGINIA,
SEND APPLICATIONS TO:

NUCLEAR MATERIALS LICENSING SECTION
U.S. NUCLEAR REGULATORY COMMISSION, REGION II
101 MARIETTA STREET, NW, SUITE 2900
ATLANTA, GA 30323-0199

IF YOU ARE LOCATED IN:

ILLINOIS, INDIANA, IOWA, MICHIGAN, MINNESOTA, MISSOURI, OHIO, OR WISCONSIN,
SEND APPLICATIONS TO:

MATERIALS LICENSING SECTION
U.S. NUCLEAR REGULATORY COMMISSION, REGION III
801 WARRENVILLE RD.
Lisle, IL 60532-4351

ALASKA, ARIZONA, ARKANSAS, CALIFORNIA, COLORADO, HAWAII, IDAHO, KANSAS,
LOUISIANA, MONTANA, NEBRASKA, NEVADA, NEW MEXICO, NORTH DAKOTA,
OKLAHOMA, OREGON, PACIFIC TRUST TERRITORIES, SOUTH DAKOTA, TEXAS, UTAH,
WASHINGTON, OR WYOMING, SEND APPLICATIONS TO:

NUCLEAR MATERIALS LICENSING SECTION
U.S. NUCLEAR REGULATORY COMMISSION, REGION IV
811 RYAN PLAZA DRIVE, SUITE 400
ARLINGTON, TX 79011-8064

LL 30329
030-34211
02120

PERSONS LOCATED IN AGREEMENT STATES SEND APPLICATIONS TO THE U.S. NUCLEAR REGULATORY COMMISSION ONLY IF THEY WISH TO POSSESS AND USE LICENSED MATERIAL IN STATES SUBJECT TO U.S. NUCLEAR REGULATORY COMMISSION JURISDICTIONS.

1. THIS IS AN APPLICATION FOR (Check appropriate item)



A. NEW LICENSE



B. AMENDMENT TO LICENSE NUMBER _____



C. RENEWAL OF LICENSE NUMBER _____

2. NAME AND MAILING ADDRESS OF APPLICANT (Include Zip code)

Central Pennsylvania Medical
Imaging Institute, LLC
(see Item 3 for address)

3. ADDRESS(ES) WHERE LICENSED MATERIAL WILL BE USED OR POSSESSED

30 E. Shady Lane
Enola, PA 17025

Central Pennsylvania Medical
Imaging Institute, LLC

4. NAME OF PERSON TO BE CONTACTED ABOUT THIS APPLICATION

Fran Owens

TELEPHONE NUMBER

717-732-4554

SUBMIT ITEMS 5 THROUGH 11 ON 8-1/2 X 11" PAPER. THE TYPE AND SCOPE OF INFORMATION TO BE PROVIDED IS DESCRIBED IN THE LICENSE APPLICATION GUIDE.

5. RADIOACTIVE MATERIAL

a. Element and mass number; b. chemical and/or physical form; and c. maximum amount
which will be possessed at any one time.

6. PURPOSE(S) FOR WHICH LICENSED MATERIAL WILL BE USED

7. INDIVIDUAL(S) RESPONSIBLE FOR RADIATION SAFETY PROGRAM AND THEIR TRAINING EXPERIENCE

8. TRAINING FOR INDIVIDUALS WORKING IN OR FREQUENTING RESTRICTED AREAS

9. FACILITIES AND EQUIPMENT

10. RADIATION SAFETY PROGRAM

11. WASTE MANAGEMENT

12. LICENSEE FEES (See 10 CFR 170 and Section 170.31)

FEE CATEGORY

7C

AMOUNT

ENCLOSED \$ 1400.00

13. CERTIFICATION. (Must be completed by applicant) THE APPLICANT UNDERSTANDS THAT ALL STATEMENTS AND REPRESENTATIONS MADE IN THIS APPLICATION ARE BINDING UPON THE APPLICANT.

THE APPLICANT AND ANY OFFICIAL EXECUTING THIS CERTIFICATION ON BEHALF OF THE APPLICANT, NAMED IN ITEM 2, CERTIFY THAT THIS APPLICATION IS PREPARED IN CONFORMITY WITH TITLE 10, CODE OF FEDERAL REGULATIONS, PARTS 30, 32, 33, 34, 35, 36, 39 AND 40, AND THAT ALL INFORMATION CONTAINED HEREIN IS TRUE AND CORRECT TO THE BEST OF THEIR KNOWLEDGE AND BELIEF.

WARNING: 18 U.S.C. SECTION 1001 ACT OF JUNE 25, 1948 62 STAT. 749 MAKES IT A CRIMINAL OFFENSE TO MAKE A WILLFULLY FALSE STATEMENT OR REPRESENTATION TO ANY DEPARTMENT OR AGENCY OF THE UNITED STATES AS TO ANY MATTER WITHIN ITS JURISDICTION.

CERTIFYING OFFICER -- TYPED/PRINTED NAME AND TITLE

FRANCIS OWENS, MANAGING MEMBER

SIGNATURE

Francis Owens, Managing Member

DATE

JUL 19, 1996

FOR NRC USE ONLY

TYPE OF FEE	FEE LOG	FEE CATEGORY	AMOUNT RECEIVED	CHECK NUMBER	COMMENTS
			\$		

APPROVED BY

OFFICIAL RECORD COPY

DATE

ML 10

123509

JUL 29 1996

Central Pennsylvania Medical Imaging Institute, LLC
Items 5 and 6

ITEM 5 - RADIOACTIVE MATERIAL
ITEM 6 - PURPOSE(S) FOR WHICH LICENSED MATERIAL WILL BE USED

BYPRODUCT MATERIAL

AMOUNT

PURPOSE

5.a. Material in 35.100
5.b. Material in 35.200

As Needed
As Needed

6.a. Medical Use
6.b. Medical Use

Central Pennsylvania Medical Imaging Institute, LLC
Item 7

INDIVIDUALS RESPONSIBLE FOR RADIATION SAFETY PROGRAMS -
THEIR TRAINING AND EXPERIENCE

ATTACHMENT 7.1.1

Authorized Users for Medical Use

Name:
Training: Previously authorized on Materials License for Community General
Osteopathic Hospital, Harrisburg and Physician's Diagnostic Center, York, PA

Use: ALL

Name: Henry K. Smith, D.O.
Training: Previously authorized on Materials License for Community General
Osteopathic Hospital, Harrisburg and Physician's Diagnostic Center, York, PA

Use: ALL

NAME GEORGE POPKEY M.D.
TRAINING Previously Authorized on Materials License for Graduate
Health System, City Line Ave Campus Philadelphia, PA
USE ALL

Central Pennsylvania Medical Imaging Institute, LLC
Item 7

INDIVIDUALS RESPONSIBLE FOR RADIATION SAFETY PROGRAMS -
THEIR TRAINING AND EXPERIENCE

ATTACHMENT 7.2

Authorized Users for Nonmedical Use

There are presently no authorized users for nonmedical use of byproduct materials.

Central Pennsylvania Medical Imaging Institute, LLC
Item 7

INDIVIDUALS RESPONSIBLE FOR RADIATION SAFETY PROGRAMS -
THEIR TRAINING AND EXPERIENCE

ATTACHMENT 7.3

Radiation Safety Officer

Name: Henry K. Smith, D.O.
Training: See Attachment 7.1.1

Central Pennsylvania Medical Imaging Institute, LLC
Item 8

TRAINING FOR INDIVIDUALS WORKING IN OR FREQUENTING
RESTRICTED AREAS

We will establish and implement the model training program that was published in Appendix A to Regulatory Guide 10.8, Revision 2, and have appended a table ATTACHMENT 8.1 that identifies the groups of workers who will receive training and the method and frequency of training.

Central Pennsylvania Medical Imaging Institute, LLC
Item 8

TRAINING FOR INDIVIDUALS WORKING IN OR FREQUENTING
RESTRICTED AREAS

ATTACHMENT 8.1

Workers to Receive Training

Personnel in the following categories will receive the indicated training based on their need to work with, or in the vicinity of, radioactive materials. All appropriate employees will be oriented before beginning work in restricted areas. Records will be maintained of all personnel training. All employees specified below will be trained during annual refresher courses.

Type of Personnel	Method of training	Frequency
Nuclear Medicine Technologists	Lectures/Discussions	Yearly
Housekeeping	Handouts	Yearly

Central Pennsylvania Medical Imaging Institute, LLC
Item 9

FACILITIES AND EQUIPMENT

ATTACHMENT 9.1

Annotated Drawing

Floor Plan Attached

Shielding Available:

A lead fort and L-block are present in the hot lab area for preparation and storage of radioactive materials.

Syringe shields, leaded pigs, leaded waste containers, leaded sharp container, remote tongs, etc. are available for use.

Equipment: (the following or comparable equipment will be available)

Gamma Camera
GE Starcam 2000

Well
Model 220 Portable Rate Meter with model 187-243 Well Counter

Survey Instruments
Lucium Model 14C (0.01 - 2000 mR/hr) 1 available
Function as radiation detection and radiation measurement survey instruments

Dose Calibrator
Capintec CRC-7 or comparable unit

Central Pennsylvania Medical Imaging Institute, LLC
Item 9

FACILITIES AND EQUIPMENT

ATTACHMENT 9.1.1

Annotated Drawing

The Nuclear Medicine facility is currently under construction. The attached diagrams describe our current understanding of how the department will be organized. The actual rooms will remain the same, however, the layout of each room may vary, depending on equipment needs. We will forward the final floorplan following completion of the department and arrival of the equipment.

Address: Gadani Medical Center
 30 E. Shady Lane
 Enola, PA 17025

Tentative Floorplan
Ground Floor

Gadani Medical Center
30 E. Shady Lane
Enola, PA 17025

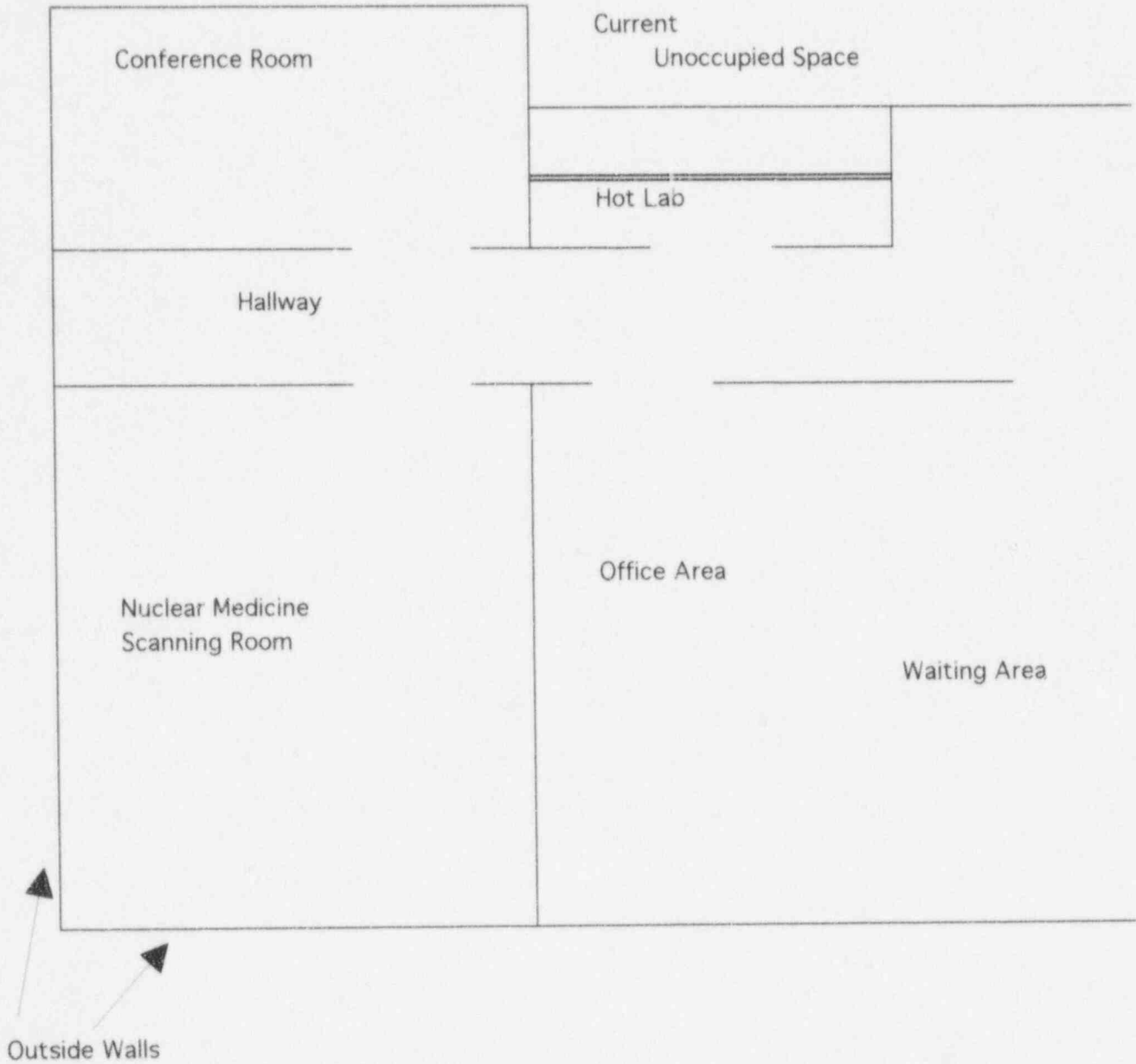

Central Pennsylvania Medical Imaging Institute, LLC
Item 9

FACILITIES AND EQUIPMENT

ATTACHMENT 9.2

Survey Instrument Calibration

All survey instruments will be calibrated on a yearly basis and following servicing by an outside contractor. We will ensure that the contractor has established and implemented the model procedure for calibrating survey instruments that was published in Appendix B to Regulatory Guide 10.8, Revision 2.

During the time period that survey instruments are off-site for calibration, back-up instrumentation will be available or no work with radioactive materials will be performed.

A dedicated check source will be attached to each survey instrument for daily spot-checks of the equipment. Baselines will be established at the time of calibration.

Calibrations will be performed by the following calibration company or a comparable licensed vendor:

RMC Calibration Services
2107 N. Harrison Street
Wilmington, DE 19809
(302) 798-6850

NRC License #: 07-30114-01
Expires: 1/31/99

Central Pennsylvania Medical Imaging Institute, LLC
Item 9

FACILITIES AND EQUIPMENT

ATTACHMENT 9.3

Dose Calibrator Calibration

We will establish and implement the model procedure for calibrating our dose calibrator that was published in Appendix C to Regulatory Guide 10.8, Revision 2.

Central Pennsylvania Medical Imaging Institute, LLC
Item 9

FACILITIES AND EQUIPMENT

ATTACHMENT 9.4

Personnel Monitoring Program

We will establish and implement the model personnel external exposure monitoring program that was published in Appendix D to Regulatory Guide 10.8, Revision 2.

Central Pennsylvania Medical Imaging Institute, LLC
Item 9

FACILITIES AND EQUIPMENT

ATTACHMENT 9.5

Imaging Equipment

This section is NA to our radiation program

Central Pennsylvania Medical Imaging Institute, LLC
Item 9

FACILITIES AND EQUIPMENT

ATTACHMENT 9.6

Other Equipment and Facilities

This section is NA to our radiation program

Central Pennsylvania Medical Imaging Institute, LLC
Item 10

RADIATION SAFETY PROGRAM

ATTACHMENT 10.1

Radiation Safety Committee/Radiation Safety Officer

We will issue the model Radiation Safety Officer Delegation of authority that was published in Appendix F to Regulatory Guide 10.8, Revision 2.

As we are not a medical institution licensee, we will not establish a Radiation Safety Committee. The Nuclear Medicine technologists work in close association with the Radiation Safety Officer and facility management.

Central Pennsylvania Medical Imaging Institute, LLC
Item 10

RADIATION SAFETY PROGRAM

ATTACHMENT 10.2

ALARA Program

We will establish and implement the model ALARA program that was published in Appendix G to Regulatory Guide 10.8, Revision 2.

Central Pennsylvania Medical Imaging Institute, LLC
Item 10

RADIATION SAFETY PROGRAM

ATTACHMENT 10.3

Leak Test

We will establish and implement the model procedure for leak-testing sealed sources that was published in Appendix H to Regulatory Guide 10.8, Revision 2.

Central Pennsylvania Medical Imaging Institute, LLC
Item 10

RADIATION SAFETY PROGRAM

ATTACHMENT 10.4

Safe Use of Radiopharmaceuticals

We will establish and implement the model safety rules published in Appendix I to Regulatory Guide 10.8, Revision 2.

Central Pennsylvania Medical Imaging Institute, LLC
Item 10

RADIATION SAFETY PROGRAM

ATTACHMENT 10.5

Spill Procedures

We will establish and implement the model spill procedures published in Appendix J to Regulatory Guide 10.8, Revision 2.

Central Pennsylvania Medical Imaging Institute, LLC
Item 10

RADIATION SAFETY PROGRAM

ATTACHMENT 10.6

Ordering and Receiving Radioactive Materials

We will establish and implement the model guidance for ordering and receiving radioactive material that was published in Appendix K to Regulatory Guide 10.8, Revision 2.

Radioactive materials received off-hours will be placed in the hot lab area and the area secured. The technologist will assume delivery of the package at the start of the work day.

Central Pennsylvania Medical Imaging Institute, LLC
Item 10

RADIATION SAFETY PROGRAM

ATTACHMENT 10.7

Opening Packages Containing Radioactive Materials

We will establish and implement the model procedure for opening packages that was published in Appendix L to Regulatory Guide 10.8, Revision 2.

In accordance with 10 CFR Part 20.1906 all incoming packages will be monitored for external radioactive contamination and radiation levels as soon as practicable after receipt of the package, but no later than 3 hours after the package is received, if it is received during normal working hours, or not later than 3 hours from the beginning of the next working day if it is received after working hours.

Central Pennsylvania Medical Imaging Institute, LLC
Item 10

RADIATION SAFETY PROGRAM

ATTACHMENT 10.8

Unit Dosage Records of Byproduct Material Use

We will establish and implement the model procedure for a unit dosage record system that was published in Appendix M.1 to Regulatory Guide 10.8, Revision 2.

Central Pennsylvania Medical Imaging Institute, LLC
Item 10

RADIATION SAFETY PROGRAM

ATTACHMENT 10.9

Multidose Vial Records of Byproduct Material Use

We will establish and implement the model procedure for a multidose vial record system that was published in Appendix M.2 to Regulatory Guide 10.8, Revision 2.

Central Pennsylvania Medical Imaging Institute, LLC
Item 10

RADIATION SAFETY PROGRAM

ATTACHMENT 10.10

Measuring and Recording Molybdenum Concentration

We do not use a technetium generator to prepare radiopharmaceuticals, as all material is obtained from a distributor. For this reason, it is not necessary for us to test for molybdenum concentrations

Central Pennsylvania Medical Imaging Institute, LLC
Item 10

RADIATION SAFETY PROGRAM

ATTACHMENT 10.11

Implant Source Use Records

This section is NA to our radiation program.

Central Pennsylvania Medical Imaging Institute, LLC
Item 10

RADIATION SAFETY PROGRAM

ATTACHMENT 10.12

Area Survey Procedures

We will establish and implement the model procedure for area surveys that was published in Appendix N to Regulatory Guide 10.8, Revision 2.

We have established the following trigger levels:

Survey Levels:

Unrestricted (hallways, scanning rooms, etc.):	0.5 mR/hr
Restricted (Hot Lab area)	5.0 mR/hr

Contamination Levels:

Unrestricted (hallways, scanning rooms, etc.)	2000 dpm
Restricted (Hot Lab area)	20000 dpm

Central Pennsylvania Medical Imaging Institute, LLC
Item 10

RADIATION SAFETY PROGRAM

ATTACHMENT 10.13

Procedures for Monitoring, Calculating, and Controlling Air Concentrations

We will not be using Xenon-133 at our facility.

Central Pennsylvania Medical Imaging Institute, LLC
Item 10

RADIATION SAFETY PROGRAM

ATTACHMENT 10.14

Radiopharmaceutical Therapy

This section is NA to our radiation program

Attachment 10.14

Central Pennsylvania Medical Imaging Institute, LLC
Item 10

RADIATION SAFETY PROGRAM

ATTACHMENT 10.15

Implant Therapy

This section is NA to our radiation program

Attachment 10.15

Central Pennsylvania Medical Imaging Institute, LLC
Item 11

RADIATION SAFETY PROGRAM

ATTACHMENT 11

Waste Disposal

We will establish and implement the general guidance and model procedures for waste disposal that were published in Appendix R to Regulatory Guide 10.8, Revision 2.

(FOR LFMS USE)
INFORMATION FROM LTS

[illegible]A. REGION II

- ### 3. COMMENTS

SIGNED M. A. Perkins
DATE 7/31/86

B. LICENSE FEE MANAGEMENT BRANCH (CHECK WHEN MILESTONE 03 IS ENTERED / /)

1. FEE CATEGORY AND AMOUNT: 7c \$1400
2. CORRECT FEE PAID. APPLICATION MAY BE PROCESSED FOR:
AMENDMENT -----
RENEWAL -----
LICENSE -----

3. OTHER -----

SIGNED _____
DATE _____

Aug 6
EDI
1209
\$1,400
7C
APP
BB

1996 AUG - 2 AM 10: 51