

DOUGLAS JARMAN

June 21, 1985

Bruce S. Mallett, Ph. D.
Materials Licensing Section
U.S. Nuclear Regulatory Commission
799 Roosevelt Road
Glen Ellyn, Illinois 60137

Dear Dr. Mallett:

I have enclosed the close-out results for Douglas County Jarman Memorial Hospital. Our Cesium 137 source will be transferred to Nuclear Diagnostics, INC., License Number 12-24416-01.

If you have any questions, please feel free to contact my office at (217) 253-3361.

Sincerely,

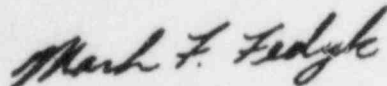

Mark F. Fedyk
Administrator

Enclosures

cc - Radiology Department

U.S. N.R.C.
LIC. FEE MGMT. BRANCH

'85 JUL -1 A9:13

RECEIVED

8507260329 850712
REG3 LIC30
12-24316-01 PDR

RECEIVED BY LFMB	
DATE	7/1/85
TO	Reg. 3
ACTION COMPL.	OK

RECEIVED

JUN 24 1985

REGION III

term
as all day
FEE EXEMPT

DOUGLAS COUNTY JARMAN MEMORIAL HOSPITAL

704 North Main Street • Tuscola, Illinois 61953 • 217/253-3361

JUN 24 1985
CONTROL NO. 7 923 0



NUCLEAR DIAGNOSTICS, INC.

SPECIALISTS IN NUCLEAR MEDICINE PROCEDURES

29W281 CALUMET
WARRENVILLE, ILLINOIS 60555
(312) 393-2889

June 18, 1985

Mark F. Fedyk, Administrator
Jarman Memorial Hospital
704 North Main Street
Tuscola, Illinois 61953

Dear Mr. Fedyk:

Enclosed are the results from your close-out survey. These results, with a letter from your office, should be directed to:

Bruce S. Mallett, Ph.D.
Materials Licensing Section
U.S. Nuclear Regulatory Commission
799 Roosevelt Road
Glen Ellyn, Illinois 60137

Inform Doctor Mallett that these are your close-out results. Also inform him that your Cesium 137 source will be transferred to Nuclear Diagnostics, Inc. License Number 12-24416-01.

For your information, these sources are very hard to sell. However, we feel that we can sell your source for you.

I personally am sorry for these inconveniences. I do feel that this will benefit all of us.

If you have any questions, please feel free to contact me.

Sincerely,

Charles G. Burchett

CGB:cjb
Enc.

CONTROL NO. 7 923 0



RADIATION PROTECTION CONSULTANTS, LTD.

Serving Radiology, Nuclear Medicine, Therapy and Industrial Facilities Since 1968
710 EAST OGDEN AVENUE, SUITE 106
NAPERVILLE, ILLINOIS 60540
PHONE: (312) 369-6488

CLOSEOUT SURVEY REPORT

Performed For: *JARMAN MEM. HOSP.*

Date Performed: *6-11-85*

Instruments Used: *survey meter 700 + Wall Counter Searle Model 8725*

Data: * See attached diagram for area location in reference

Survey Location
Rm. No. *Area

Results - mR/hr
Background
1 .04 - .03 = .01
2 .08 - .03 = .05
3 .04 - .03 = .01
4 .02 - .03 = 0
5 .03 - .03 = 0
6 .03 - .03 = 0
7 .02 - .03 = 0
8 .03 - .03 = 0
9 .03 - .03 = 0
10 .03 - .03 = 0
11 .03 - .03 = 0

Wipes
Results - CPM
Background
1 26 - 25 = 1
2 28 - 25 = 3
3 24 - 25 = 0
4 23 - 25 = 0
5 26 - 25 = 1
6 28 - 25 = 3
7 24 - 25 = 0
8 26 - 25 = 1
9 27 - 25 = 2
10 24 - 25 = 0
11 25 - 25 = 0

Results:

☒ Results show no evidence of contamination
☐ Results show evidence of contamination; see comments
☐ See comments

Comments:

Performed by:

Ronald D. Edwards

Ronald D. Edwards,
Health Physicist

CONTROL NO. 79230

Jarman Mem. Hospital

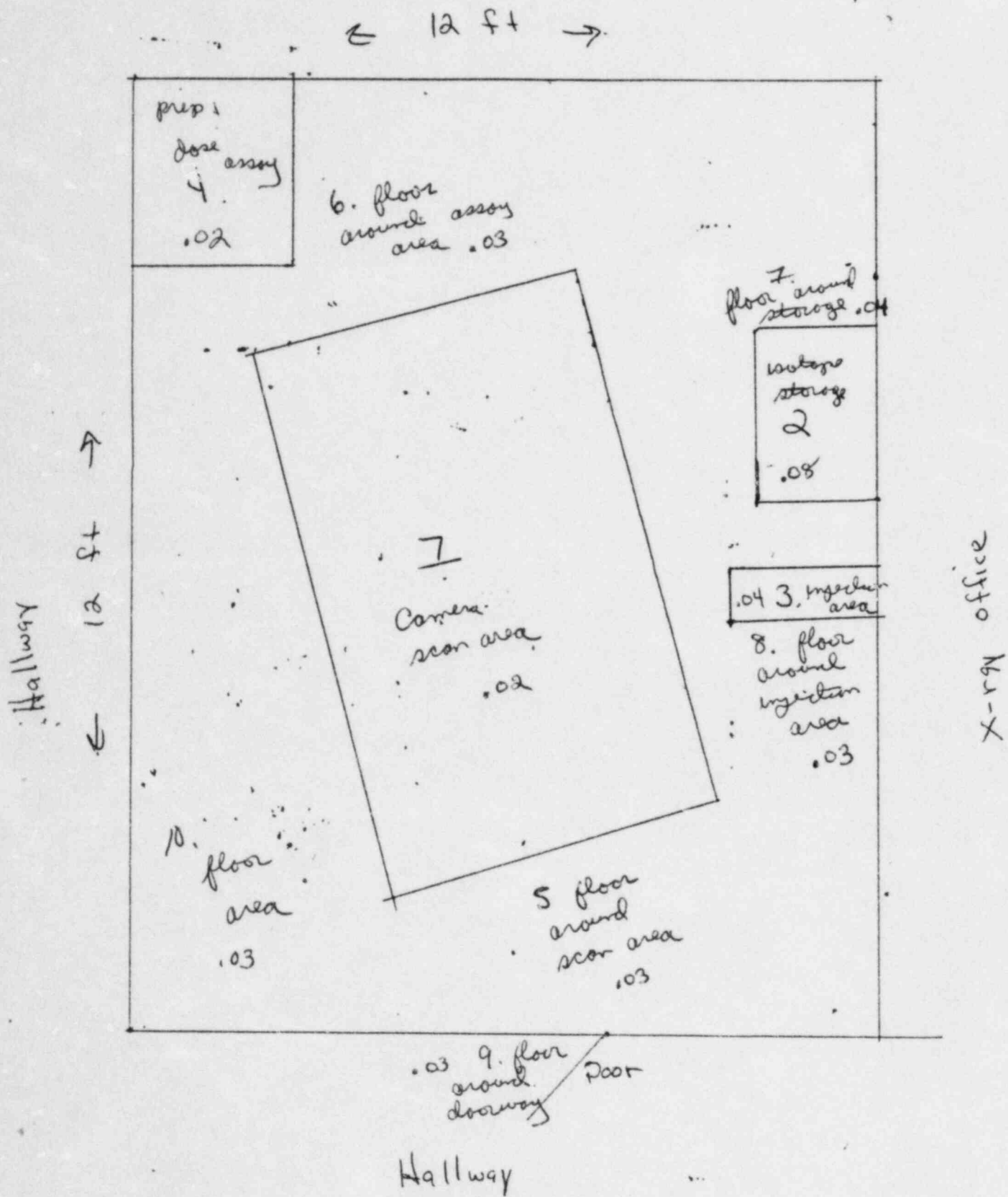

11. out of room.
Bkg .03 mn/hr

CONTROL NO. 79230

readings in mn/hr