

APPLICATION FOR MATERIAL LICENSE

INSTRUCTIONS: SEE THE APPROPRIATE LICENSE APPLICATION GUIDE FOR DETAILED INSTRUCTIONS FOR COMPLETING APPLICATION. SEND TWO COPIES OF THE ENTIRE COMPLETED APPLICATION TO THE NRC OFFICE SPECIFIED BELOW.

FEDERAL AGENCIES FILE APPLICATIONS WITH:

U.S. NUCLEAR REGULATORY COMMISSION
DIVISION OF FUEL CYCLE AND MATERIAL SAFETY, NMSS
WASHINGTON, DC 20555

ALL OTHER PERSONS FILE APPLICATIONS AS FOLLOWS, IF YOU ARE LOCATED IN:

CONNECTICUT, DELAWARE, DISTRICT OF COLUMBIA, MAINE, MARYLAND, MASSACHUSETTS, NEW JERSEY, NEW YORK, PENNSYLVANIA, RHODE ISLAND, OR VERMONT, SEND APPLICATIONS TO:

U.S. NUCLEAR REGULATORY COMMISSION, REGION I
NUCLEAR MATERIAL SECTION B
631 PARK AVENUE
KING OF PRUSSIA, PA 19406

ALABAMA, FLORIDA, GEORGIA, KENTUCKY, MISSISSIPPI, NORTH CAROLINA, PUERTO RICO, SOUTH CAROLINA, TENNESSEE, VIRGINIA, VIRGIN ISLANDS, OR WEST VIRGINIA, SEND APPLICATIONS TO:

U.S. NUCLEAR REGULATORY COMMISSION, REGION II
MATERIAL RADIATION PROTECTION SECTION
101 MARIETTA STREET, SUITE 2900
ATLANTA, GA 30323

IF YOU ARE LOCATED IN:

ILLINOIS, INDIANA, IOWA, MICHIGAN, MINNESOTA, MISSOURI, OHIO, OR WISCONSIN, SEND APPLICATIONS TO:

U.S. NUCLEAR REGULATORY COMMISSION, REGION III
MATERIALS LICENSING SECTION
799 ROOSEVELT ROAD
GLEN ELLYN, IL 60137

ARKANSAS, COLORADO, IDAHO, KANSAS, LOUISIANA, MONTANA, NEBRASKA, NEW MEXICO, NORTH DAKOTA, OKLAHOMA, SOUTH DAKOTA, TEXAS, UTAH, OR WYOMING, SEND APPLICATIONS TO:

U.S. NUCLEAR REGULATORY COMMISSION, REGION IV
MATERIAL RADIATION PROTECTION SECTION
611 RYAN PLAZA DRIVE, SUITE 1000
ARLINGTON, TX 76011

ALASKA, ARIZONA, CALIFORNIA, HAWAII, NEVADA, OREGON, WASHINGTON, AND U.S. TERRITORIES AND POSSESSIONS IN THE PACIFIC, SEND APPLICATIONS TO:

U.S. NUCLEAR REGULATORY COMMISSION, REGION V
MATERIAL RADIATION PROTECTION SECTION
1450 MARIA LANE, SUITE 210
WALNUT CREEK, CA 94596

PERSONS LOCATED IN AGREEMENT STATES SEND APPLICATIONS TO THE U.S. NUCLEAR REGULATORY COMMISSION ONLY IF THEY WISH TO POSSESS AND USE LICENSED MATERIAL IN STATES SUBJECT TO U.S. NUCLEAR REGULATORY COMMISSION JURISDICTION.

1. THIS IS AN APPLICATION FOR (Check appropriate item)

- ☒ A. NEW LICENSE
☐ B. AMENDMENT TO LICENSE NUMBER _____
☐ C. RENEWAL OF LICENSE NUMBER _____

2. NAME AND MAILING ADDRESS OF APPLICANT (Include Zip Code)

GUPTA ASSOCIATES, INC.
2715 West Peterson Avenue
Chicago, IL 60659

3. ADDRESS(ES) WHERE LICENSED MATERIAL WILL BE USED OR POSSESSED.

At address listed in Item #4 and at temporary jobsites throughout the U.S. where the U.S. NRC maintains jurisdiction over byproduct materials.

4. NAME OF PERSON TO BE CONTACTED ABOUT THIS APPLICATION

Sham L. Gupta, P.E. 2715 W. Peterson Ave. Chicago, IL 60659

TELEPHONE NUMBER

(312) 334-6800

SUBMIT ITEMS 5 THROUGH 11 ON 8 1/2 x 11" PAPER. THE TYPE AND SCOPE OF INFORMATION TO BE PROVIDED IS DESCRIBED IN THE LICENSE APPLICATION GUIDE.

5. RADIOACTIVE MATERIAL See Attached Exhibit 'A'

a. Element and mass number, b. chemical and/or physical form, and c. maximum amount which will be possessed at any one time.

6. PURPOSE(S) FOR WHICH LICENSED MATERIAL WILL BE USED. See Attached Exhibit 'A'

7. INDIVIDUAL(S) RESPONSIBLE FOR RADIATION SAFETY PROGRAM AND THEIR TRAINING AND EXPERIENCE Sham L. Gupta, P.E.

8. TRAINING FOR INDIVIDUALS WORKING IN OR FREQUENTING RESTRICTED AREAS. Sham L. Gupta, P.E.

9. FACILITIES AND EQUIPMENT. See Attached Exhibit 'B'

10. RADIATION SAFETY PROGRAM. See Attached Exhibit 'C'

11. WASTE MANAGEMENT. See Attached Exhibit 'A'

12. LICENSEE FEES (See 10 CFR 170 and Section 170.311)

AMOUNT ENCLOSED \$230.00
FEE CATEGORY 3p

13. CERTIFICATION. (Must be completed by applicant) THE APPLICANT UNDERSTANDS THAT ALL STATEMENTS AND REPRESENTATIONS MADE IN THIS APPLICATION ARE BINDING UPON THE APPLICANT.

THE APPLICANT AND ANY OFFICIAL EXECUTING THIS CERTIFICATION ON BEHALF OF THE APPLICANT, NAMED IN ITEM 2, CERTIFY THAT THIS APPLICATION IS PREPARED IN CONFORMITY WITH TITLE 10, CODE OF FEDERAL REGULATIONS, PARTS 30, 32, 33, 34, 35, AND 40 AND THAT ALL INFORMATION CONTAINED HEREIN IS TRUE AND CORRECT TO THE BEST OF THEIR KNOWLEDGE AND BELIEF.

WARNING: 18 U.S.C. SECTION 1001 ACT OF JUNE 25, 1948, 62 STAT. 749 MAKES IT A CRIMINAL OFFENSE TO MAKE A WILLFULLY FALSE STATEMENT OR REPRESENTATION TO ANY DEPARTMENT OR AGENCY OF THE UNITED STATES AS TO ANY MATTER WITHIN ITS JURISDICTION.

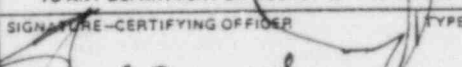
SIGNATURE—CERTIFYING OFFICER  TYPED/PRINTED NAME SHAM L. GUPTA TITLE President DATE 6/20/85

13. ANNUAL RECEIPTS		14. VOLUNTARY ECONOMIC DATA	
<\$250K	\$1M-3.5M	a. NUMBER OF EMPLOYEES (Total for entire facility excluding outside contractors)	d. WOULD YOU BE WILLING TO FURNISH COST INFORMATION (Dollar and/or staff hours) ON THE ECONOMIC IMPACT OF CURRENT NRC REGULATIONS OR ANY FUTURE PROPOSED NRC REGULATIONS THAT MAY AFFECT YOU? (NRC regulations permit it to protect confidential commercial or financial—proprietary—information furnished to the agency in confidence)
\$250K-500K	\$3.5M-7M		
\$500K-750K	\$7M-10M	c. NUMBER OF BEDS	
\$750K-1M	>\$10M		
		YES <input checked="" type="checkbox"/> NO <input type="checkbox"/>	

FOR NRC USE ONLY

TYPE OF FEE	FEE LOG	FEE CATEGORY	COMMENTS	APPROVED BY
APPL	June 25	3P		Cop
AMOUNT RECEIVED	CHECK NUMBER			DATE
\$230	4803			6/28/85
JUN 24 1985				CONTROL NO. 79217
REGION III				

EXHIBIT 'A'

GUPTA ASSOCIATES, INC.
2715 West Peterson Avenue
Chicago, IL 60659
(312) 334-6800

ITEMS 5 - 11

ITEM 5

CS-137	Sealed Source	Troxler Drawing #A-102122	Not to exceed 10 mCi per source
AM 241:Be	Sealed Source	Troxler Drawing #1-102451	Not to exceed 50 mCi per source

ITEM 6

For use in a Troxler Model 3400 Series Surface Moisture Density Gauges to measure properties of construction materials.

ITEM 7

Sham L. Gupta, P.E.

ITEM 8

Sham L. Gupta, P.E.

ITEM 9

See attached Exhibit 'B'

ITEM 10

See attached Exhibit 'C'

ITEM 11

The gauge will be returned to the manufacturer for elimination of waste.

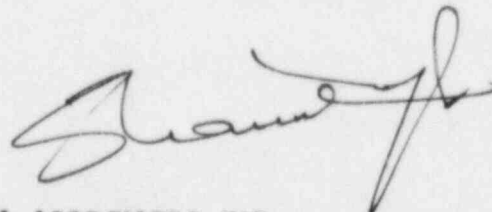

GUPTA ASSOCIATES, INC.
2715 W. PETERSON AVE.
CHICAGO, ILL. 60659

GUPTA ASSOCIATES INC.
2715 ~~155 E Ohio Street W.~~ Peterson Ave
CHICAGO, ILLINOIS 60639
(312) 644-3304
334 6900

JOB: NUCLEAR LICENSE
SHEET NO. _____ OF _____
CALCULATED BY: _____ DATE: _____
CHECKED BY: _____ DATE: _____

EXHIBIT 'B'
SCALE

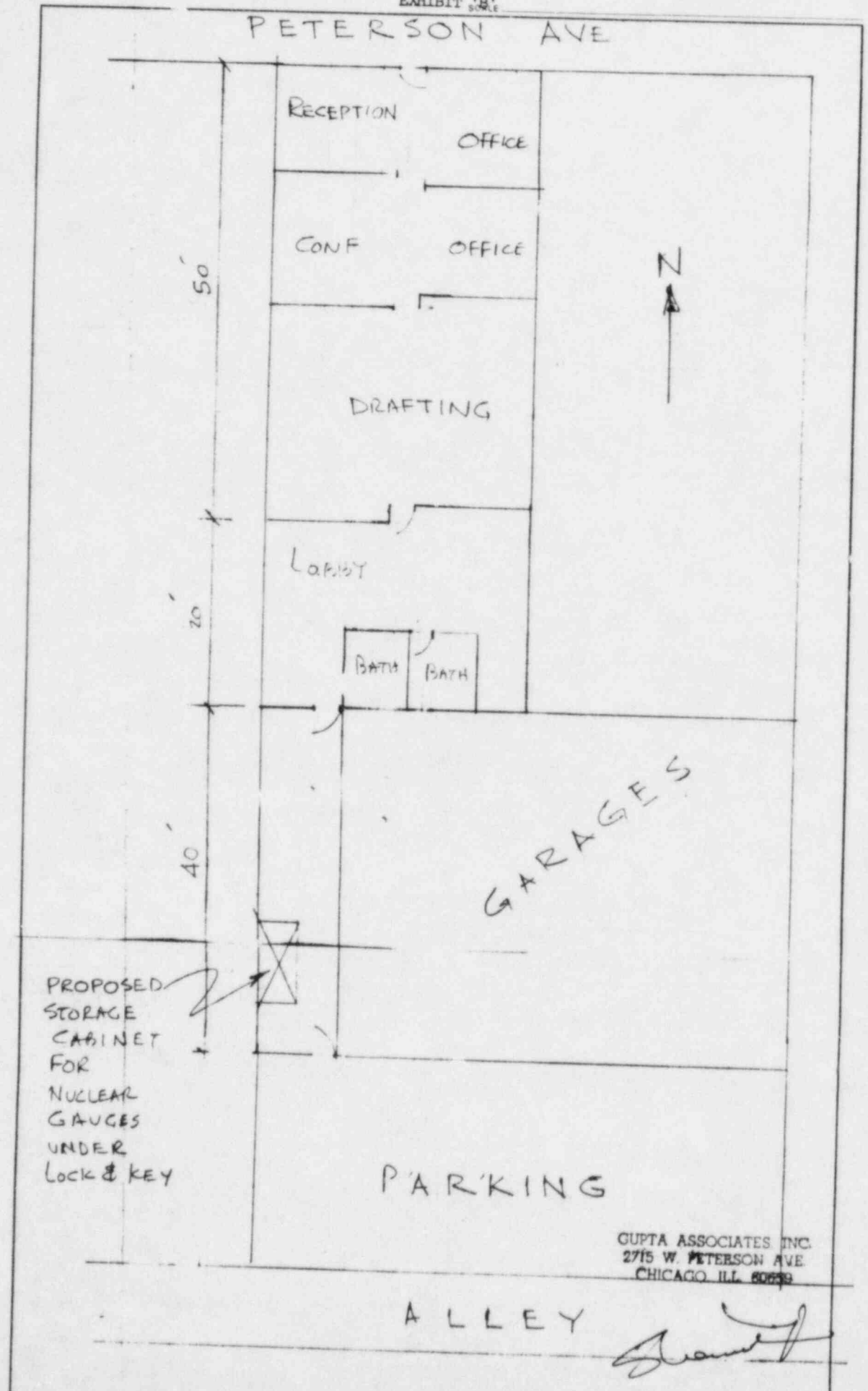

EXHIBIT 'C'

RADIATION SAFETY PROGRAM

Gupta Associates, Inc.
2715 W. Peterson Avenue
Chicago, Illinois 60659
(312)334-6800

RADIATION SAFETY OFFICER

Sham L. Gupta has been designated as the Radiation Safety Officer for this company and has assumed the following duties and responsibilities:

1. He will ensure that all the terms and conditions of the license are being met and that the information contained in the license is up-to-date at all times.
2. He will ensure that all equipment has been leak tested as required (at least once every six months) and that all leak tests are performed in the manner prescribed by the equipment manufacturer.
3. All individuals using this equipment shall do so only after being authorized by Sham L. Gupta and shall wear their personnel monitoring equipment when using the equipment.
4. He shall maintain all records as required by the license and the regulations. These records shall include personnel exposure records, leak test records and training certificates for all authorized users.
5. He shall ensure that the equipment is properly secured against unauthorized removal at all times when not in use.
6. He shall ensure as a point of contact and give assistance in case of any emergency such as equipment damaged in the field or theft and shall notify the proper authorities in case of emergency.
7. He shall serve that all authorized users have read and understand the radiation safety operating and emergency procedures.

OPERATING PROCEDURES

Transportation of Equipment

1. All possible means shall be provided to ensure that the equipment is fully secured in the transporting vehicle and the equipment is away from the passenger compartment. When transporting in an enclosed vehicle (car or van), the vehicle shall be locked. When transporting in an open bed vehicle, the gauge shall be securely fastened and locked to the truck bed.

GUPTA ASSOCIATES, INC. *447*
2715 W. PETERSON AVE.
CHICAGO, ILL. 60659

Transportation of Equipment cont'

2. The gauge shall be transported in the TROXLER transportation case. As required by the U.S. Department of Transportation, the gauge shall be transported in a properly labeled carrying case.
3. The operator shall have a properly completed Bill of Lading for each gauge at all time during transport.

Utilization Procedures

1. When the gauge is in the field the authorized user must maintain control over the gauge at all times and the gauge must never be left unattended.
2. When not making measurements, the gauge should be placed in the transportation case and returned to its permanent storage area as soon as possible. The gauge is to be used for its intended purpose only. By doing so, the user will maintain any radiation exposure to as low as reasonably attainable.
3. All authorized users shall wear the personnel monitoring device that has been assigned to them when using the equipment. When not using the equipment, the personnel monitoring device is to be stored in the radiation free area that has been designated in the office.

Maintenance and Leak Test Procedures

1. Periodic maintenance shall include cleaning the gauge. During any maintenance users involved must wear their personnel monitoring devices.
2. During maintenance of equipment, no radioactive source is to be removed from the equipment. The equipment shall be returned to the manufacturer for this type of maintenance.
3. The leak test is to be performed using the TROXLER Model 3880 Leak Test Kit. The leak test shall be performed using the manufacturer's instructions. Again, the personnel monitoring device shall be employed during these procedures. Gauges are to be leak tested at intervals not to exceed six (6) months.

Emergency Procedures

In the event of physical damage to a gauge, the following shall be performed:

1. Immediately cordon off an area around the gauge. An area radius of 15 feet will be sufficient.
2. If a vehicle is involved, it must be stopped until the extent of contamination, if any, can be established.

Emergency Procedures cont'

3. A visual inspection of the gauge is to be made to determine if the source housing and/or shielding has been damaged.
4. At the earliest possible time, when the situation is under control, you must contact SHAM L. GUPTA at (312) 334-6800 or (312) 674-3800. Describe the present conditions and follow the instructions that he gives you.

IN THE EVENT THAT THE GAUGE IS LOST OR STOLEN, IMMEDIATELY NOTIFY SHAM L. GUPTA
AT (312) 334-6800 or (312) 674-3800.

SG

/bf

GUPTA ASSOCIATES, INC.
2715 W. PETERSON AVE.
CHICAGO, ILL. 60659

CONTROL NO. 7 9 2 1 7

TROXLER ELECTRONIC LABORATORIES, INC.

HEREBY CERTIFIES THAT

SHAM L. GUPTA

of

GUPTA ASSOCIATES, INC.

GUPTA ASSOCIATES, INC.
2715 W. PETERSON AVE.
CHICAGO, ILL. 60659

HAS SUCCESSFULLY COMPLETED THE TROXLER ELECTRONIC LABORATORIES, INC.
TRAINING COURSE FOR THE USE OF NUCLEAR TESTING EQUIPMENT.

SUBJECTS INCLUDED IN THIS COURSE WERE AS FOLLOWS:

Radiological Safety

- | | |
|--|---|
| 1. Principles and practices of radiation protection. | 5. Radioactivity measurement standardization and monitoring techniques and instruments. |
| 2. Leak testing procedures. | 6. Accident and incident procedures. |
| 3. Mathematics and calculations basic to the use and measurement of radioactivity. | 7. Procedures for nuclear gauge storage and transportation. |
| 4. Biological effects of radiation. | 8. General safety precautions. |

Gauge Operation

- | | |
|-------------------------|----------------------|
| 1. Instrument theory | 4. Field application |
| 2. Operating procedures | 5. Gauge calibration |
| 3. Maintenance | |

James L. Whittle
INSTRUCTOR

6/8/85

DATE

W.F. TROXLER

PRESIDENT

No 10003