

8001110516

AIR COOLER
E - 27

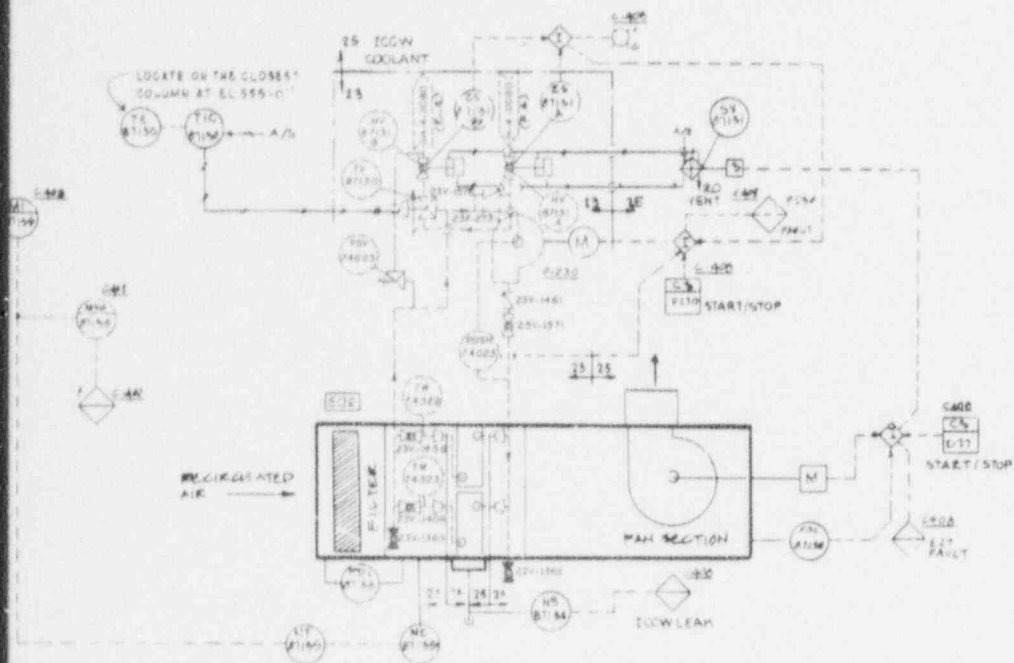

AIR COOLER
E-28

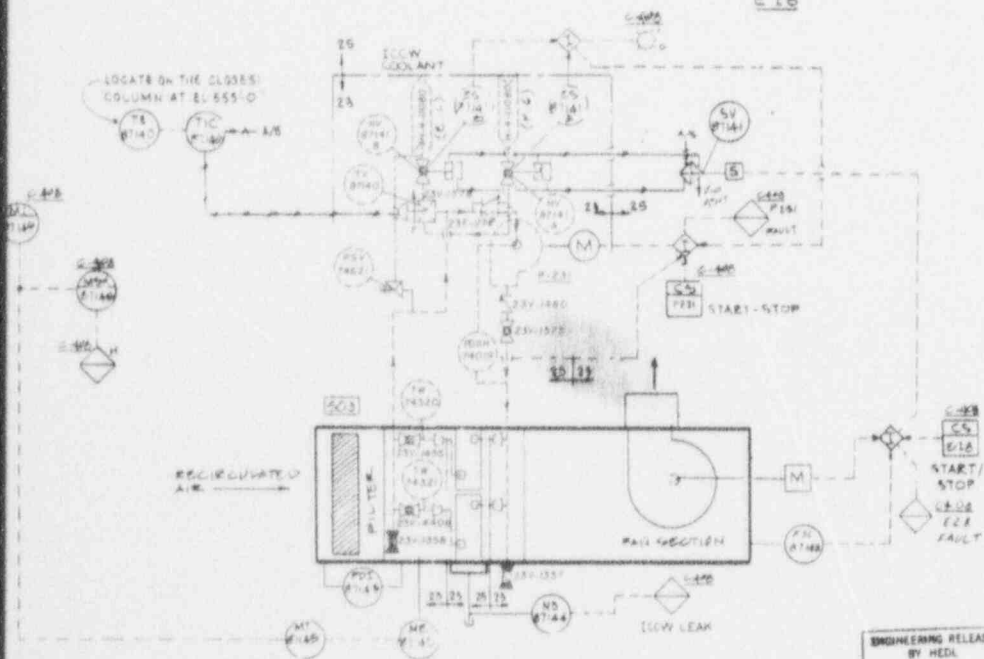

ENGINEERING RELEASE
BY HEDL
REV. 2 DATE 6-1-77
ERO B-2-1-8

THIS DRAWING IS CONTAINED
IN SDC-4-F
ALL CHANGES TO THIS DRAWING
MUST BE PROCESSED USING THE
SDC REVISION PROCESS.

NEXT UNDO ON		DEFENSE FORCE OF INDIA	
DATA NO	REF NO	REASON FOR DO NOT DO	
H.A-11505		H.A. 11505 AIR COOLERS IN-CONTAINMENT PLANT	
DATA NO	REF NO	LOGIC DIAGRAM FOR	
H.A-1234		CENT REGRIC AIR COOLERS	

NOTE 4:

1. SEE DWG H-4-11093 THRU H-4-11096, H-4-11098 & H-4-11099 FOR LEGEND.
2. FOR INSTRUMENT AIR SUPPLY FOR PNEUMATIC INSTRUMENTS SHOWN ON THIS DWG, SEE P&ID H-4-53511.
3. ALL ALARMS SHOWN FOR EACH CONTROL PANEL ARE RETRANSMITTED TO COMMON SINGLE ANNUNCIATOR WINDOW ON PANEL C136. ANY FOLLOWING ALARM SUCCEEDING THE INITIAL ALARM ON THE CONTROL PANEL WILL REFLASH (REACTIVATE) THE PANEL C136 WINDOW.
4. KCV ISOLATION VALVES F.A. ON PNEUMATIC FAILURE, AND P.C. ON ELECTRICAL FAILURE.

[illegible]