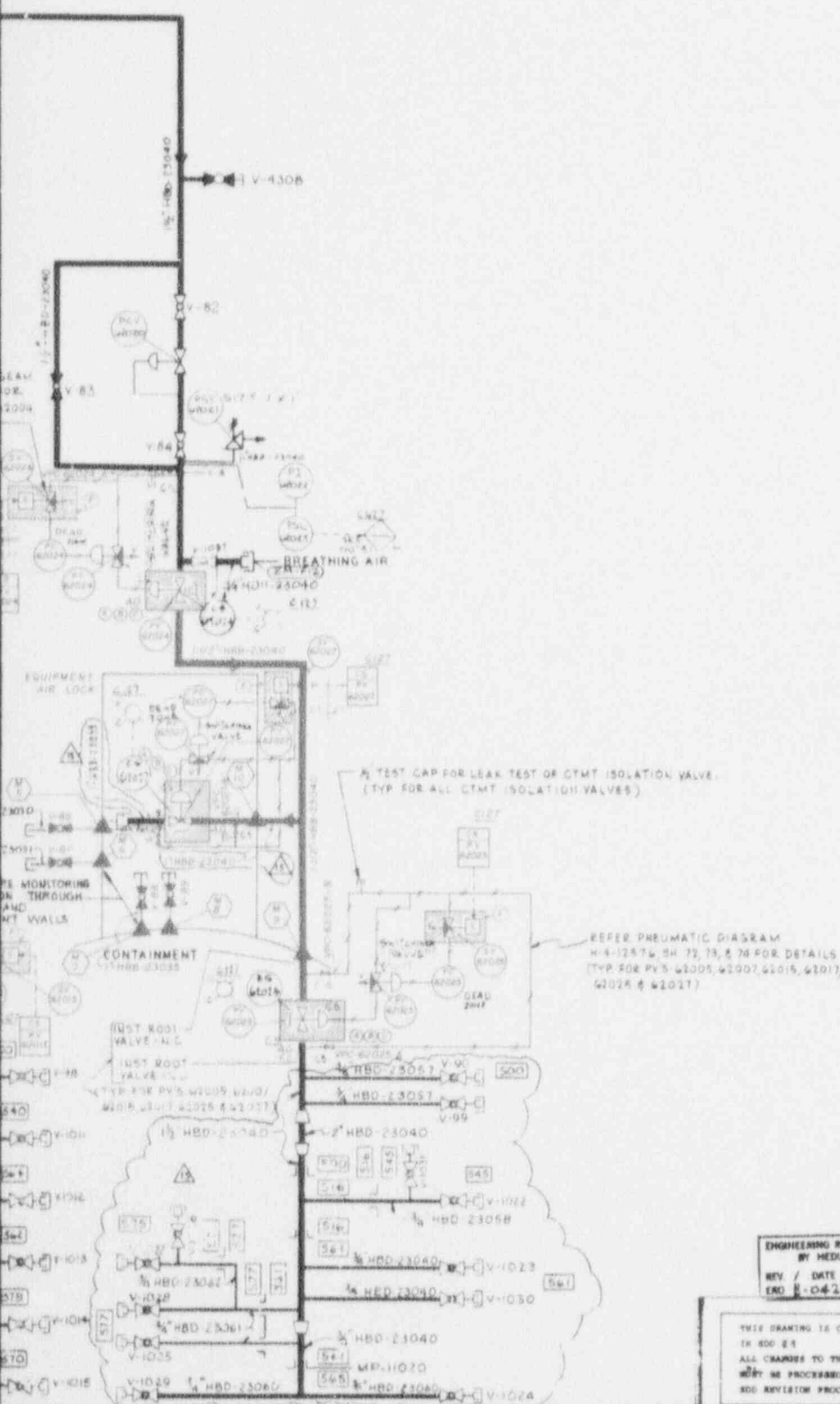

8001110484

5. ALL LINES EXPOSED TO OUTSIDE ATMOSPHERE
SHALL BE HEAT TRACED

REF ID: A66087		
REPLY USED ON		
REFERENCE DRAWINGS		
DRAW. NO.	SHEET NO.	DESCRIPTION TITLE OR SHEET NO.
H-4-11079		F & D DISTURBANT AIR - SERVICE DRING
H-4-11175		FLOW DIAGRAM BESTING AIR SOURCE DRING

1. ALARMS ANNOUNCED ON LOCAL CONTROL PANEL, SET BY AND TRANSMITTED TO A SINGLE ANNUNCIATOR WINDOW ON PANEL C136 IN THE MAIN CONTROL ROOM. THE LOCAL ALARMS ARE CAPABLE OF REPEATING THE ANNUNCIATOR WINDOW ON PANEL C136 WHEN THE C136 WINDOW IS IN AN ACKNOWLEDGED ALARM STATE.
2. FOR TROUBLE AND USAGE, SEE LEADING SHEETS N-4-11003, 11004, 11005, 11006, 11009 AND 11010.
3. ALL VALVE NUMBERS SHALL BE PRECEDED BY THE NUMBER 23.
4. THE CONTAINMENT ISOLATION VALVES ARE DESIGNED TO CLOSE WHEN LOW PROCESS PRESSURE IS SENSED. WHEN LOW PROCESS PRESSURE / BREATHING AIR IS SENSED BY THE DEAD-ZONE PRESSURE CONTROLLER, IT WILL ALLOW PRESSURE ON THE BOTTOM-UP VALVE DIAPHRAGM TO VENT TO ATMOSPHERE (BREATHING AIR / IS NOT TESTED) THROUGH THE PRESSURE CONTROLLER. THIS ALLOWS THE CONTAINMENT ISOLATION VALVE DIAPHRAGM TO TEST THROUGH THE EXITING AIR TO ATMOSPHERE (BREATHING AIR / IS NOT VENTED). SHOULD BREATHING AIR PRESSURE BE RESTORED, THE PRESSURE CONTROLLER WILL REAPPLY AIR TO THE EXITING VALVE DIAPHRAGM ALLOWING BREATHING AIR TO BE APPLIED TO THE CONTAINMENT ISOLATION VALVE DIAPHRAGM. THIS OPENS THE CONTAINMENT ISOLATION VALVE.

[illegible]