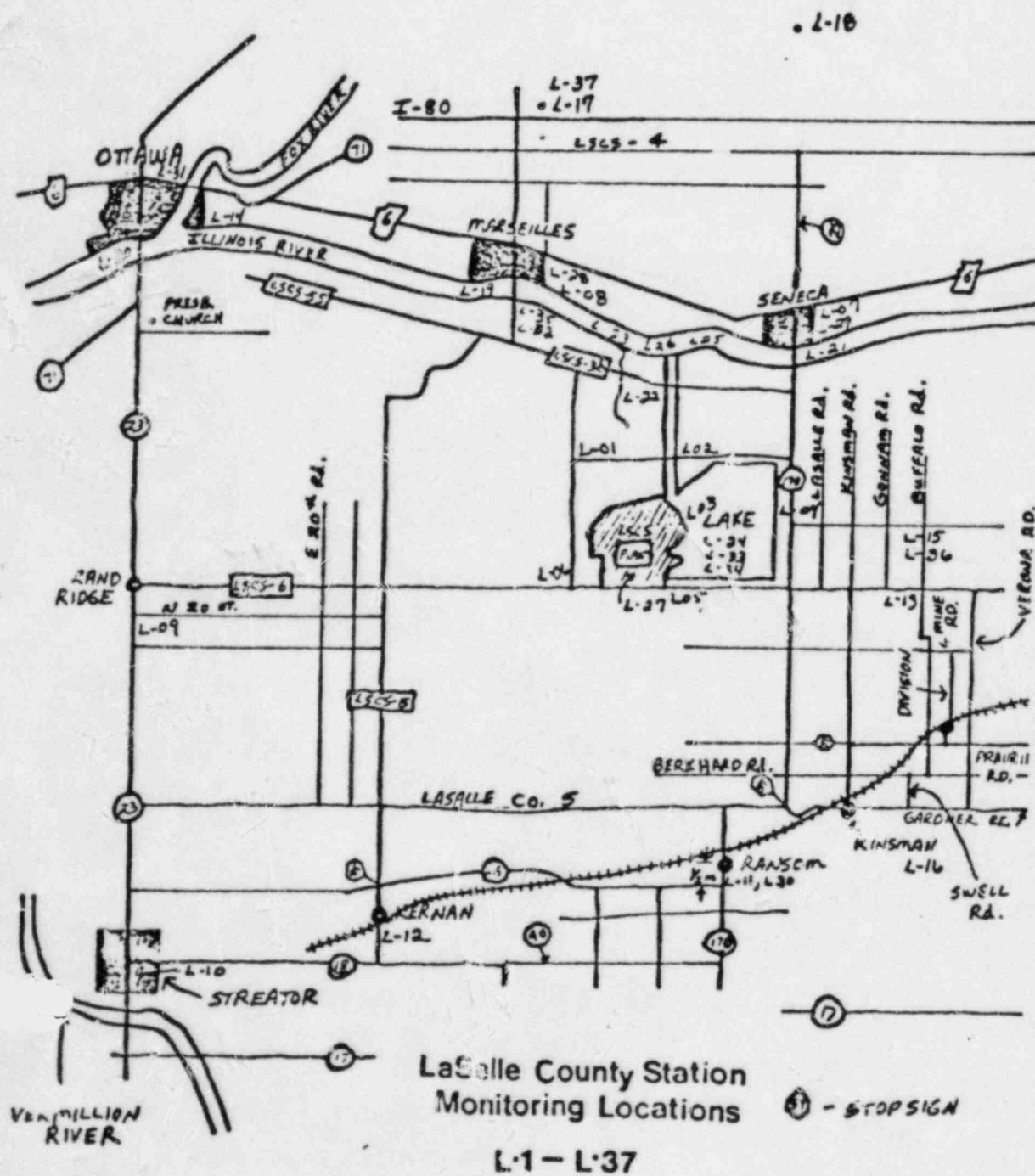

Figure 5.0-1a



LASALLE COUNTY STATION

Figure 5.0-1b

TLD Locations

Inner Ring, 16 Badges

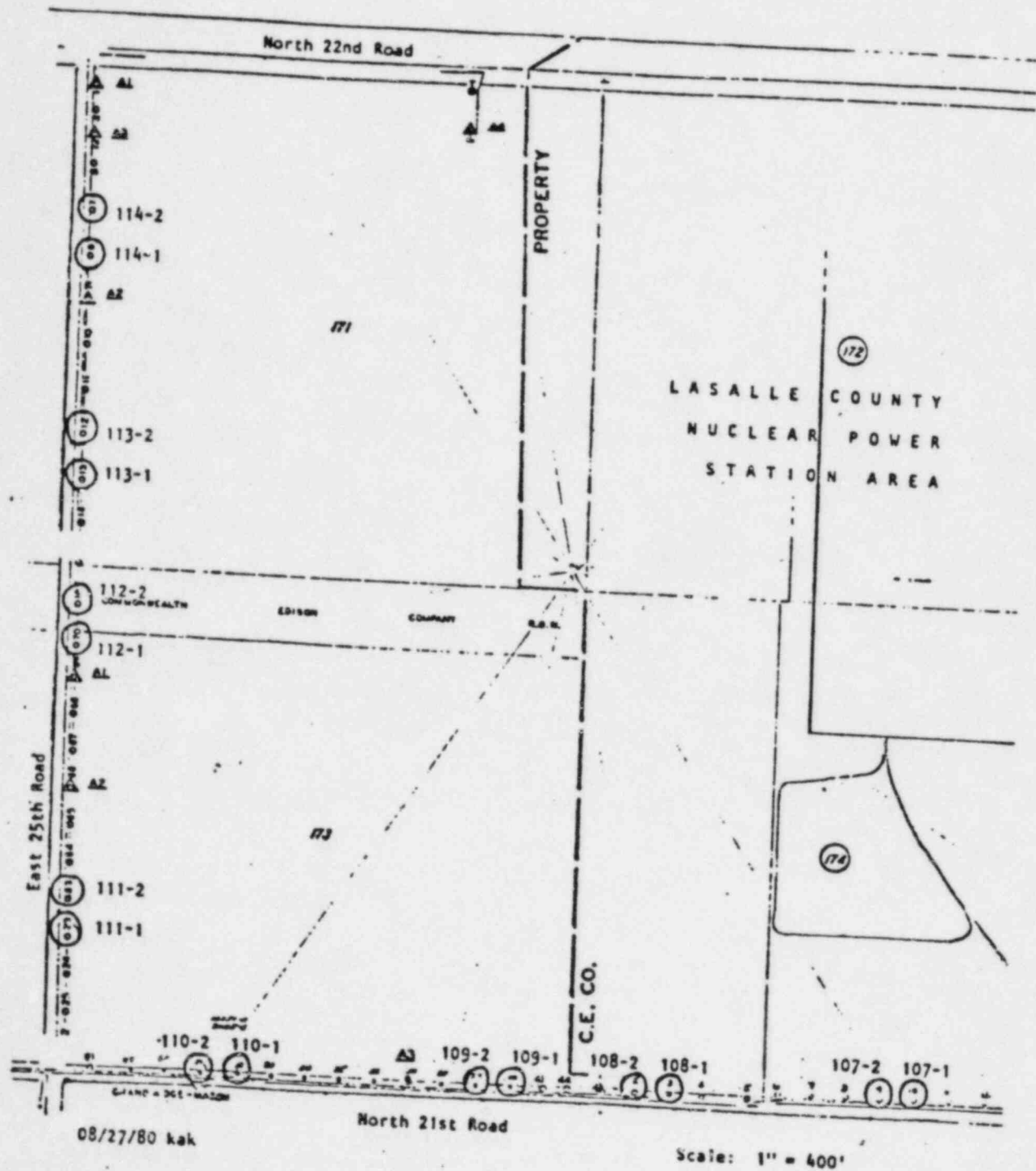

LASALLE COUNTY STATION

Figure 5.0-1c

TLD Locations

Outer Ring, 32 Badges

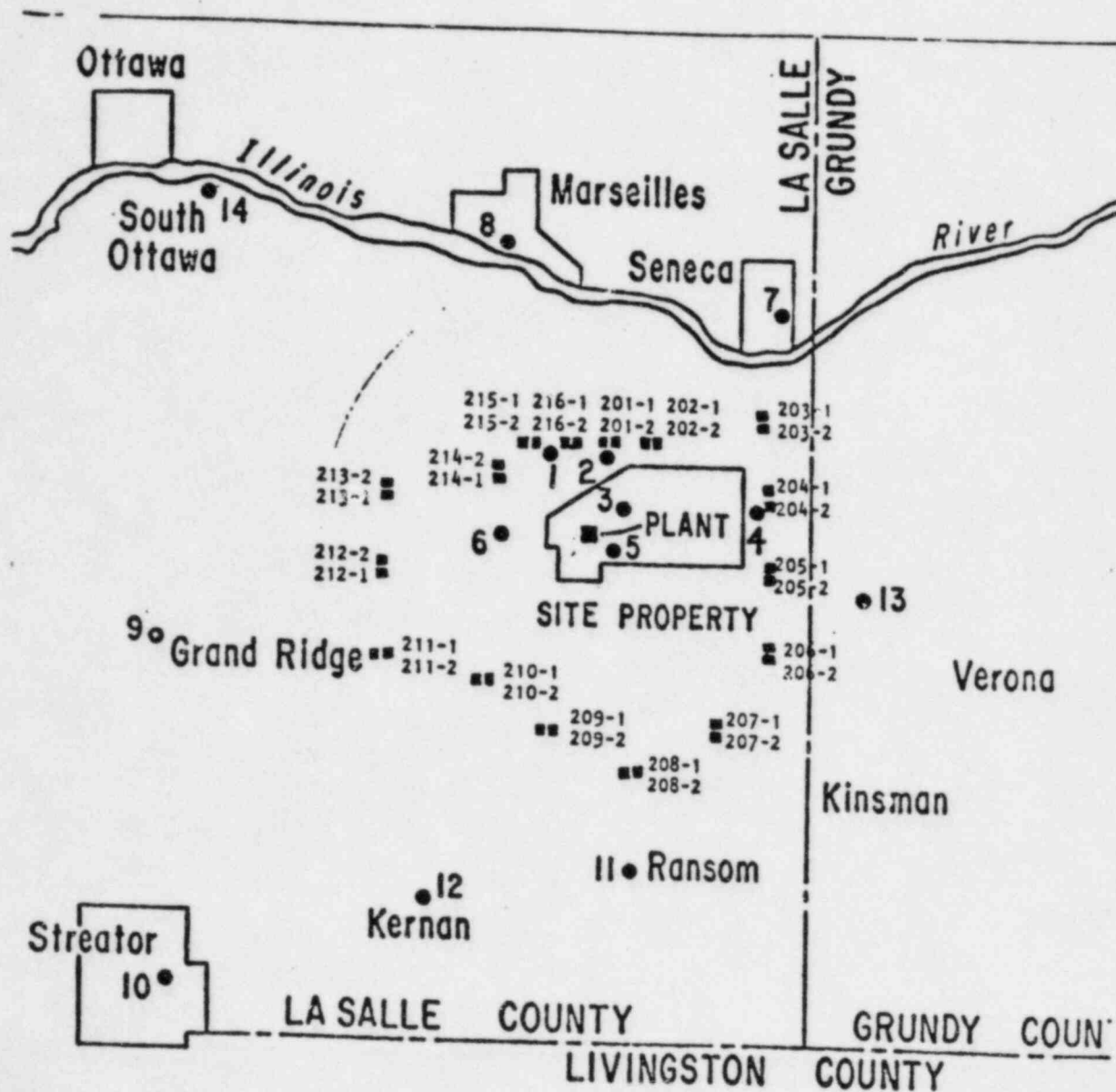

SCALE: 0 1 2 3 4 5 10 MILES

08/27/80 - kek

STANDARD RADIOLOGICAL SAMPLING PROGRAM

LaSalle County Station

1. AIR SAMPLERS

<u>Site Code</u>	<u>Location</u>	<u>Distance (miles)</u>	<u>Direction (°)</u>
L-01	a. Near-site #1	0.5	326
L-02	b. On-site Station #2	0.6	11
L-03	c. On-site Station #3	0.2	56
L-04	d. Near-site #4	1.5	90
L-05	e. On-site Station #5	0.3	145
L-06	f. Near site #6	0.4	270
L-07	g. Seneca	5.2	18
L-08	h. Marseilles	7.0	326
L-09	i. Grand Ridge (C)	10.4	260
L-10	j. Streater (C)	13.5	220
L-11	k. Ransom	6.0	191
L-12	l. Kernan (C)	5.0	214
L-13	m. Route 6 at Gonnam Road	4.3	100
L-14	n. Ottawa (C)	12.0	315

2. TLDs

a. Same as No. 1.

b. Special TLD Samplers

<u>Site Code</u>	<u>Distance (mile)</u>	<u>Direction (°)</u>
107 1,2	0.5	146
108 1,2	0.4	168
109 1,2	0.4	187
110 1,2	0.5	204
111 1,2	0.5	230
112 1,2	0.4	260
113 1,2	0.4	280
114 1,2	0.5	304
201 1,2	2.0	15
202 1,2	2.3	33
203 1,2	4.0	56
204 1,2	3.5	78
205 1,2	3.5	102

STANDARD RADIOLOGICAL SAMPLING PROGRAM

LaSalle County Station

2. TLDs

b. Special TLD Samplers (continued)

<u>Site Code</u>	<u>Distance (mile)</u>	<u>Direction (°)</u>
206 1,2	4.3	123
207 1,2	4.5	146
208 1,2	4.5	170
209 1,2	4.0	192
210 1,2	3.3	216
211 1,2	4.5	240
212 1,2	4.0	261
213 1,2	3.8	283
214 1,2	2.0	303
215 1,2	2.0	330
216 1,2	1.5	350

3. MILK

<u>Site Code</u>	<u>Location</u>	<u>Distance (miles)</u>	<u>Direction (°)</u>
L-15	a. Granby Farm*	7.0	90
L-16	b. Lowery Dairy	7.2	120
L-17	c. Norsen Dairy (C)	9.0	337
L-18	d. Sunnyisle Farm (C)	13.2	15

4. FISH

<u>Site Code</u>	<u>Location</u>	<u>Distance (miles)</u>	<u>Direction (°)</u>
L-35	a. Marseilles Pool of Illinois River	6.5	326
L-24	b. LSCS Cooling Lake	0.3	112

* Granby Farm replaced Johnson Dairy 4-20-84.

STANDARD RADIOLOGICAL SAMPLING PROGRAM

LaSalle County Station

5. SURFACE WATER

<u>Site Code</u>	<u>Location</u>	<u>Distance (miles)</u>	<u>Direction (°)</u>
L-19	a. Illinois River at Marseilles	6.5	326
L-20	b. Illinois River at Ottawa	6.5	304
L-21	c. Illinois River at Seneca (C)	4.0	22
L-22	d. South Kickapoo Creek	4.7	330
L-23	e. Illinois Nitrogen Corp.	5.3	337
L-24	f. LSCS Cooling Lake near Recreation Area	0.3	112

6. COOLING WATER

<u>Site Code</u>	<u>Location</u>	<u>Distance (miles)</u>	<u>Direction (°)</u>
L-25	a. LSCS Intake Pipe/ River (C)	4.8	10
L-26	b. LSCS Discharge Pipe/ River	4.8	11

7. WELL WATER

<u>Site Code</u>	<u>Location</u>	<u>Distance (miles)</u>	<u>Direction (°)</u>
L-27	a. LSCS On-site Well	At Station	180
L-28	b. Marseilles Well	7.0	326
L-29	c. Seneca Well (C)	5.1	18
L-30	d. Ranson Well	6.0	191
L-31	e. Ottawa Well	12.8	304
L-32	f. Illinois State Park	6.5	326

STANDARD RADIOLOGICAL SAMPLING PROGRAM

LaSalle County Station

8. SEDIMENT

<u>Site Code</u>	<u>Location</u>	<u>Distance (miles)</u>	<u>Direction (°)</u>
L-33	a. Just upstream of cooling lake inlet structure (C)	4.7	354
L-34	b. Just downstream of cooling lake discharge structure	4.8	350

(C) - Control (background) locations are indicated. All other locations are indicator.

Table 5.0-2

LaSalle County Radiological Monitoring Program, Sample Collection and Analyses

Sample Media	Location		Collection Frequency	Type of Analysis	Frequency of Analysis	Remarks
	Code	Site				
1. Airborne Particulates	L-1	Nearsite No. 1	Weekly	Gross beta Gamma Isot Sr-89,90	Weekly Quarterly Quarterly	On all samples. On quarterly composites from each location. On quarterly composites from each location.
	L-2	Onsite No. 2				
	L-3	Onsite No. 3				
	L-4	Nearsite No. 4				
	L-5	Onsite No. 5				
	L-6	Nearsite No. 6				
	L-7	Seneca				
	L-8	Marseille				
	L-9	Grand Ridge				
	L-10	Streator				
	L-11	Ransom				
	L-12	Kernan				
	L-13	Route 6 at Gonnam Rd.				
	L-14	Ottawa				
2. Airborne Iodine	Same as 1.		Weekly	I-131	Weekly	On all samples.
3. TLD	Same as 1.		Quarterly	Gamma	Quarterly	Two sets at all AP locations. One set read quarterly. Second set read if required by Edison. At other locations, all sets read quarterly.
	107-14	Inner Ring				
	201-16	Outer Ring				
4. Milk	L-15	Johnson Dairy*	Weekly: Apr to Sep Monthly: Oct to Mar	I-131 Gamma Isot Sr-89,90	Weekly Monthly Monthly	May thru October only. LLD: 0.5 pCi/l
	L-16	Lowery Dairy				
	L-17	Norsen Dairy				
	L-18	Sunnyisle Farm				
5. Surface Water	L-19	Illinois River at	Weekly	Gross beta Gamma Isot Tritium Sr-89,90	Weekly Monthly Quarterly Quarterly	On all samples. On monthly composites from each location. On quarterly composites from each location. On quarterly composites from each location.
		Marseilles				
	L-20	Illinois River at Ottawa				
	L-21	Illinois River at Seneca				
	L-22	South Kickapoo Creek				
	L-23	Illinois River at Intake to Nitrogen Corp.				
6. Cooling Water	L-24	LSCS Cooling Lake near Rec. area	Weekly	Gross beta Gamma Isot Tritium Sr-89,90	Weekly Monthly Monthly Monthly	On all samples. On monthly composites from each location. On monthly composites from each location. On monthly composites from each location.
	L-25	LSCS intake pipe/ river				
	L-26	LSCS discharge pipe/ river				

* Granby Farm replaced Johnson Dairy effective 4-20-84.



Commonwealth Edison

72 West Adams Street, Chicago, Illinois
Address Reply to: Post Office Box 767
Chicago, Illinois 60690

DMB

April 17, 1985

Mr. James G. Keppler
Regional Administrator
Directorate of Inspection and Enforcement
Region III
U.S. Nuclear Regulatory Commission
799 Roosevelt Road
Glen Ellyn, IL 60137

PRIORITY ROUTING

First	Second
✓	
✓	
✓	
✓	
✓	
✓	
✓	
✓	
✓	
✓	

right

FILE

Dockets: No. 50-373

Dear Mr. Keppler:

Enclosed is an errata to Part 3 of the 1983 LaSalle County Station Annual Operating Report, reporting results of environmental radiological and meteorological monitoring.

One copy of this errata is provided for your use and 39 copies are being submitted directly to Mr. D. Eisenhut, Deputy Director of the Office of Nuclear Reactor Regulation.

Sincerely yours,

B. B. Stephenson 4/19/85
B. B. Stephenson
Manager of Production
Nuclear Stations Division

cc: G. J. Diederich
EFG-01-Re-Radc

IE 25
/1

APR 29 1985

BBS/lmk
0322E/91