

50-400 0L

I-E-61

12/17/84

EDDLEMAN 61

CP&L

Carolina Power & Light Company

NOV 08 1984

SERIAL: NLS-84-471

NUCLEAR REGULATORY COMMISSION

Docket No. 50-400-61 + 401 Official Exh. No. 61
 In the matter of Carolina Power
 Staff _____ IDENTIFIED ✓
 Applicant _____ RECEIVED ✓
 Intervenor _____ REJECTED _____
 Cont'g Off: _____ DATE 12-17-84
 Contractor _____ Witness _____
 Other L
 Reporter a. Bloom

Mr. Harold R. Denton, Director
 Office of Nuclear Reactor Regulation
 United States Nuclear Regulatory Commission
 Washington, DC 20555

SHEARON HARRIS NUCLEAR POWER PLANT
 UNIT NO. 1 - DOCKET NO. 50-400
 FIRE PROTECTION DOORS

Dear Mr. Denton:

Carolina Power & Light Company hereby submits additional information concerning fire doors at the Shearon Harris Nuclear Power Plant (SHNPP). The attached information is submitted in response to Safety Evaluation Report (SER) Open Item Number 8 concerning Fire Protection.

If you have any further questions or require additional information, please contact me.

Yours very truly,

S. R. Zimmerman
 for S. R. Zimmerman
 Manager
 Nuclear Licensing Section

JHE/pgp (830JHE)

Attachments

cc: Mr. B. C. Buckley (NRC)
 Mr. G. F. Maxwell (NRC-SHNPP)
 Mr. J. P. O'Reilly (NRC-RII)
 Mr. Travis Payne (KUDZU)
 Mr. Daniel F. Read (CHANGE/ELP)
 Chapel Hill Public Library
 Wake County Public Library

Mr. Wells Eddleman
 Mr. John D. Runkle
 Dr. Richard D. Wilson
 Mr. G. O. Bright (ASLB)
 Dr. J. H. Carpenter (ASLB)
 Mr. J. L. Kelley (ASLB)
 Mr. R. Eberly (NRC-CMEB)

8503280269 841217
 PDR ADDCK 05000400
 G PDR

Shearon Harris Nuclear Power Plant
SER Open Item 8
Fire Protection - Additional Information

Carolina Power & Light Company will provide doors with a 1 1/2 or 3 hour rating having been tested by a nationally recognized testing laboratory except in those areas where design requirements specify the use of special doors. These special doors are listed in the attached table. These doors have specialty functions such as tornado/missile shield required for non-fire protection plant design requirements. As such, these doors have not been documented by the manufacturers as concerns hourly fire rating.

Details of specific door designs are also attached. In conjunction with the designs, the attached table outlines specific door locations and provides plant features and conditions which mitigate the need for tested or listed doors. It is our position that the door details and the attached table combine to justify the doors as adequate to maintain the integrity of the fire barriers in which they are installed and do not have an adverse effect on the ability to safely shutdown the plant in the event of a fire.

DESIGN INFORMATION FOR FIRE DOOR DEVIATION

DOOR NO.	FSAR FIGURE	SSA SK.	INT./EXT. DOOR	FIRE ZONE(S)	AUTOMATIC PROTECTION	COMBUSTIBLE LOADING	SSA EQUIPMENT WITHIN 20 FEET OF DOOR
D1	9.5A-8	668S12	Ext.	1-A-4-COR Yard	I None	141,445 BTU/sq ft No major loading within 50'	None None
D5	9.5A-8 9.5A-35	668S13 None	Ext.	1-A-4-CHLR Turbine Bldg. El. 261	M, T, & I W & T	155,296 BTU/sq ft Steam generator feed pumps 78,478 BTU/sq ft	Chilled Water Pump P-4 (SA) HVAC Chiller WC-2 (SA) Condensate Water Circ. Pump (SA) SB Redundant Sys. more than 20' separation None
D7	9.5A-8 9.5A-35	668S13 None	Ext.	1-A-4-CHLR Turbine Bldg. El. 261	M, T, & I W & T	155,296 BTU/sq ft Steam generator feed pump 78,478 BTU/sq ft	AOV 3CX-W21SA-1 AOV 3AF-F5-SB-1 AOV 3AF-F6-SB-1 AOV 3AF-F4-SB-1 AOV 3CX-W28SB-1 AOV 3AF-F3-SA-1 AH-20 (SA) Local Cooling AH-20 (SB) Local Cooling None
D52	9.5A-8 None	668S15 None	Ext.	D2 fire zone Turbine Bldg. El. 261	None None	None No major loading within 60'	None None
D133	9.5A-15 None	None None	Ext.	5-F-3-CHG Yard	None None	Negligible No major loading within 50'	None None
D232	9.5A-9 9.5A-36	668S17 None	Ext.	1-A-5-HV3 Turbine Bldg. El. 286	None P & T	Negligible Condenser vacuum pump & mezzanine floor 28,097 BTU/sq ft	El. 286 Junction Box B1629-SB (3-hr. protected) El. 261 Same as Door No. D5 None
D250	9.5A-9 9.5A-36	668S17 None	Ext.	1-A-SWGRB Turbine Bldg. El. 286	I P & T	106,792 BTU/sq ft Mezzanine floor 28,097 BTU/sq ft	None None

DOOR NO.	FSAR FIG.	SSA SK	INT./EXT. DOOR	FIRE ZONE(S)	AUTOMATIC PROTECTION	COMBUSTIBLE LOADING	SSA EQUIPMENT WITHIN 20 FEET OF DOOR
D284	9.5A-9	None	EXT.	12-A-5-CHF	P, T & I	82,241 BTU/sq. ft.	None
	9.5A-9	None		Outside	None	None	None
D385	9.5A-11	668S05	EXT.	1-A-4-TA	None	Negligible	None
	9.5A-11	None		Outside	None	None	None
D449	9.5A-10	668S20	EXT.	12-A-6-RT-1	I	Negligible	Main termination Cabs. (SB)
	9.5A-10	None		Outside	None	None	7.5 KVA UPS Rect. IDP-1B Cables to SA MTC's NOTE: Remote shutdown is available from outside the Control Room Complex
D450	9.5A-10	668S20	EXT.	12-A-6-RCC-1	I	Negligible	Air Handler AH-93 (SA)
	9.5A-10	None		Outside	None	None	SV 3CX-W34SA-1
D463	9.5A-10	668S20	EXT.	12-A-6-CR1	I	Negligible	None
	9.5A-36	None		Turbine Bldg.	P & T	28,097 BTU/sq. ft.	None
D473	9.5A-10	668521	EXT.	12-A-6-HV-7	I	19,255 BTU/sq. ft.	AH-15 (1B-SB)
	9.5A-10	None		Outside	None	None	MCC 1836-SB MOV 3C2-B26SB-1 MOV 3C2-B8SB-1 AOV 3CX-W24SB-1 MOV 3C2-B2SB-1 RM-1C2-3504A-SA E-10 (1A-SA) E-10 (1B-SB)
D800 D801 D802	9.5A-27	None	EXT.	5-W-34-DRM	I	13,129 BTU/sq. ft.	None
	9.5A-27	None		Yard	None	None	None
D892	9.5A-15	None	EXT.	5-F-4-BAL	None	Negligible	None
	9.5A-15	None		Outside	None	None	None
D134	9.5A-15	None	EXT.	5-F-3-SC	None	Negligible	None
	9.5A-15	None		Yard	None	None	None

DOOR NO.	FSAR FIG.	SSA SK	INT./EXT. DOOR	FIRE ZONE(S)	AUTOMATIC PROTECTION	COMBUSTIBLE LOADING	SSA EQUIPMENT WITHIN 20 FEET OF DOOR
D3092*	9.5A-14	None	INT.	5-F-2-FPC	M,T	1161 BTU/sq. ft	None
	9.5A-14	None		Hot Machine Shop	None	None	None
D3312*	9.5A-14	None	INT.	5-F-2-DEC	I	Negligible	None
	9.5A-14	None		Contaminated Tool Storage	None	None	None

* NOTE: These doors were previously tagged D092 and D312.

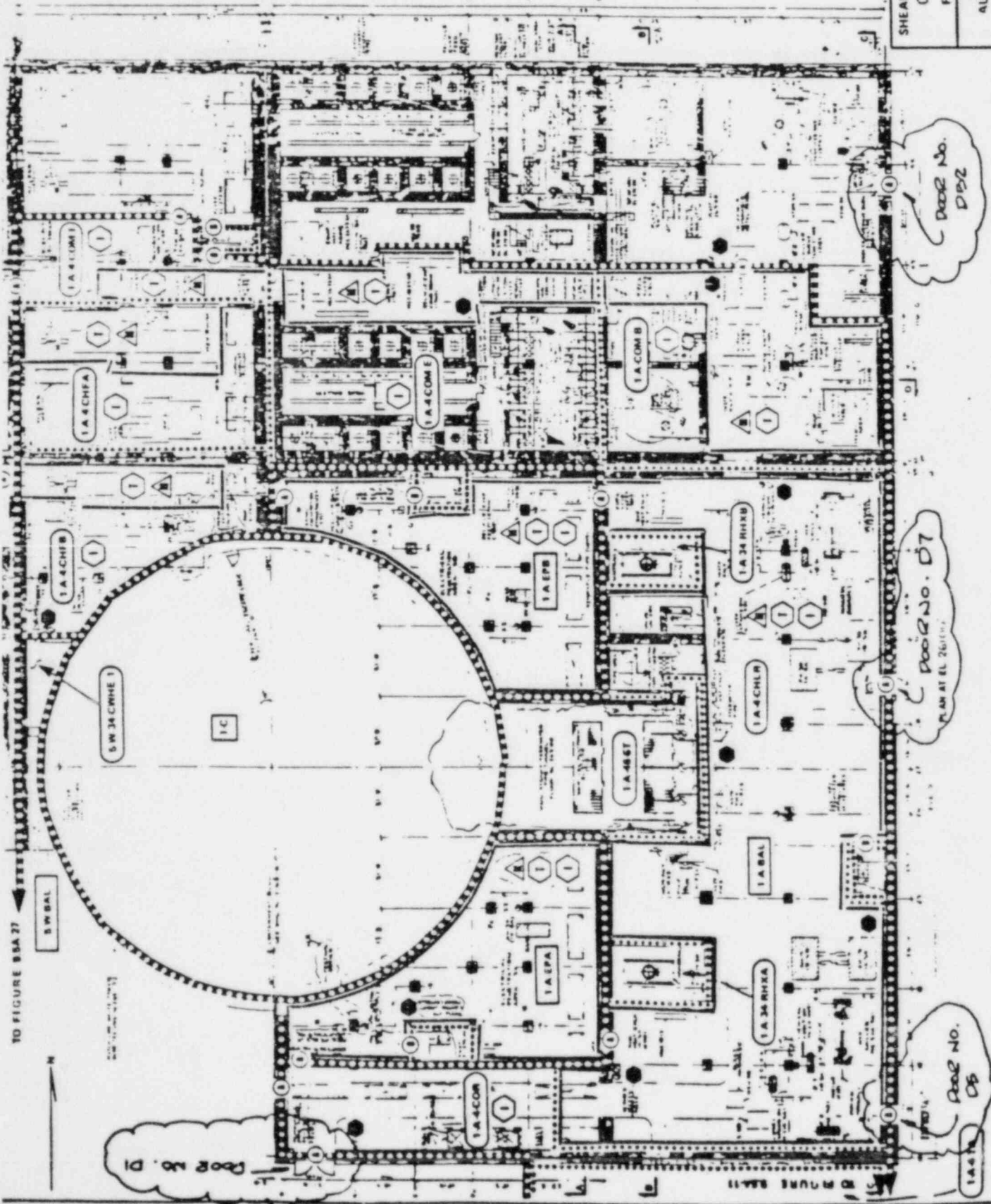

AMENDMENT NO. 15

SHEARON HARRIS NUCLEAR POWER PLANT
 Carolina Power & Light Company
 FINAL SAFETY ANALYSIS REPORT
 FIRE PROTECTION REACTOR
 AUXILIARY BLDG. PLAN EL. 261 00'

FIGURE 35A 8

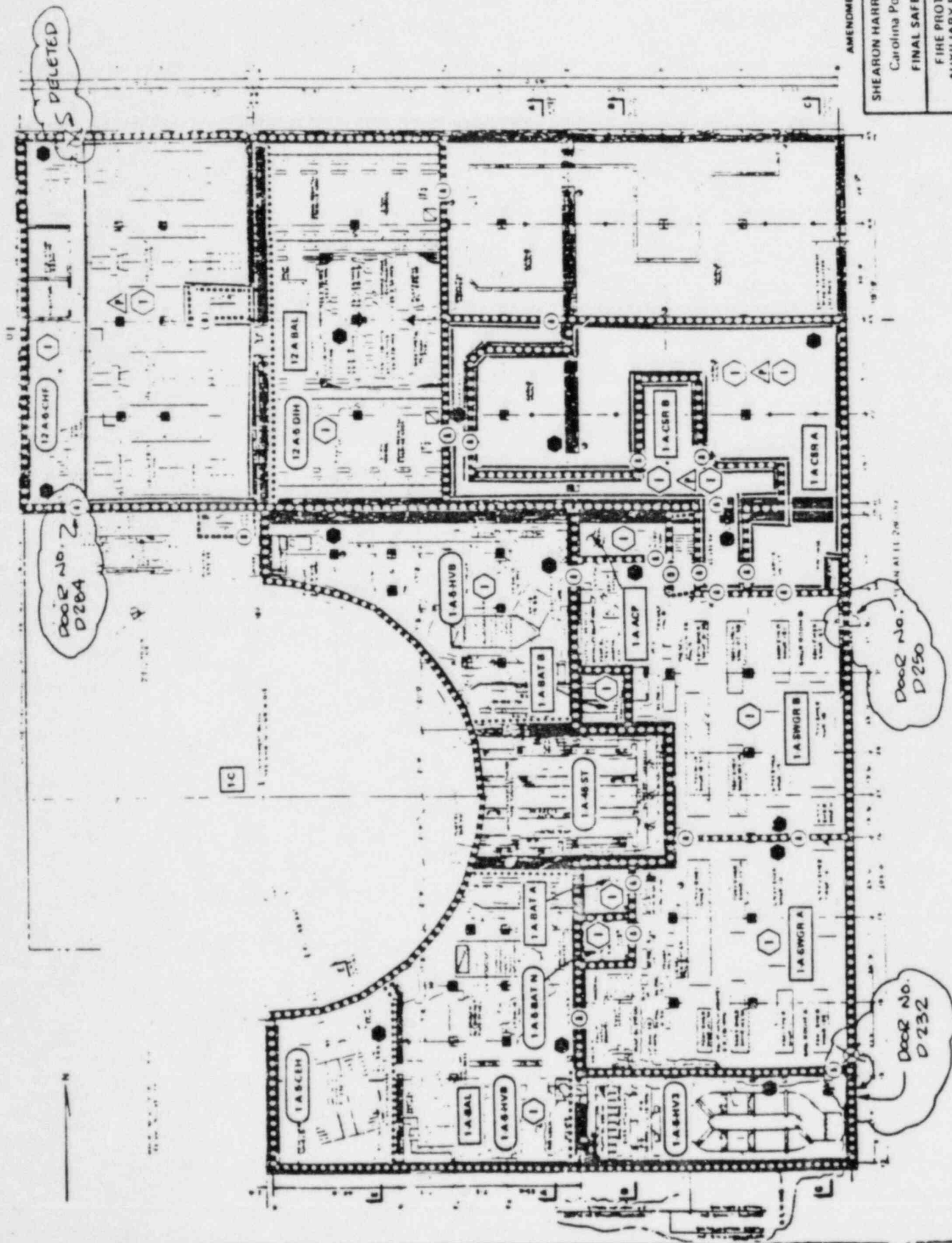

AMENDMENT NO. 15

SHEARON HARRIS NUCLEAR POWER PLANT
 Carolina Power & Light Company
 FINAL SAFETY ANALYSIS REPORT
 FIRE PROTECTION REACTOR
 AUXILIARY BLDG - PLAN EL 288 00

FIGURE 95A 9

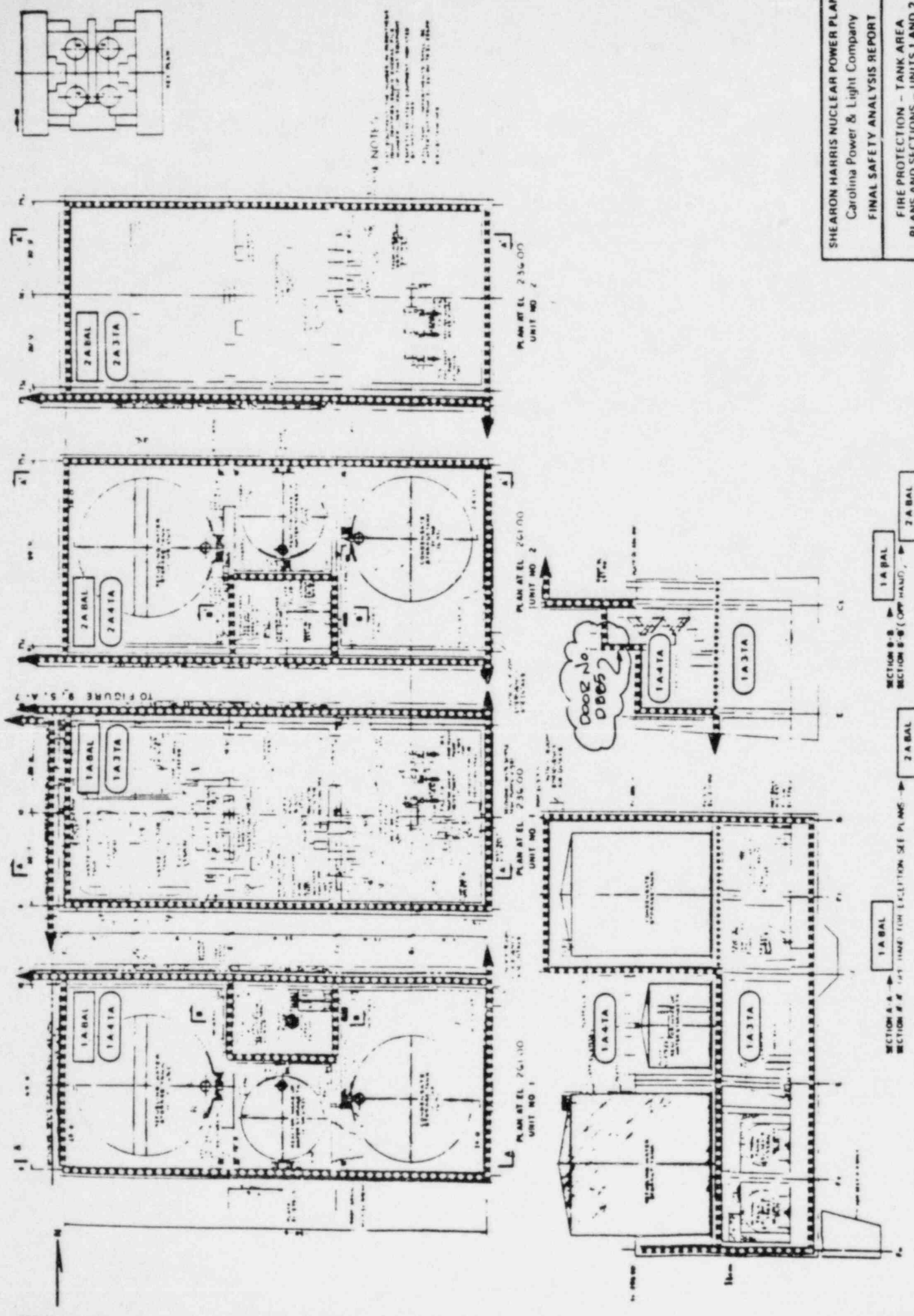

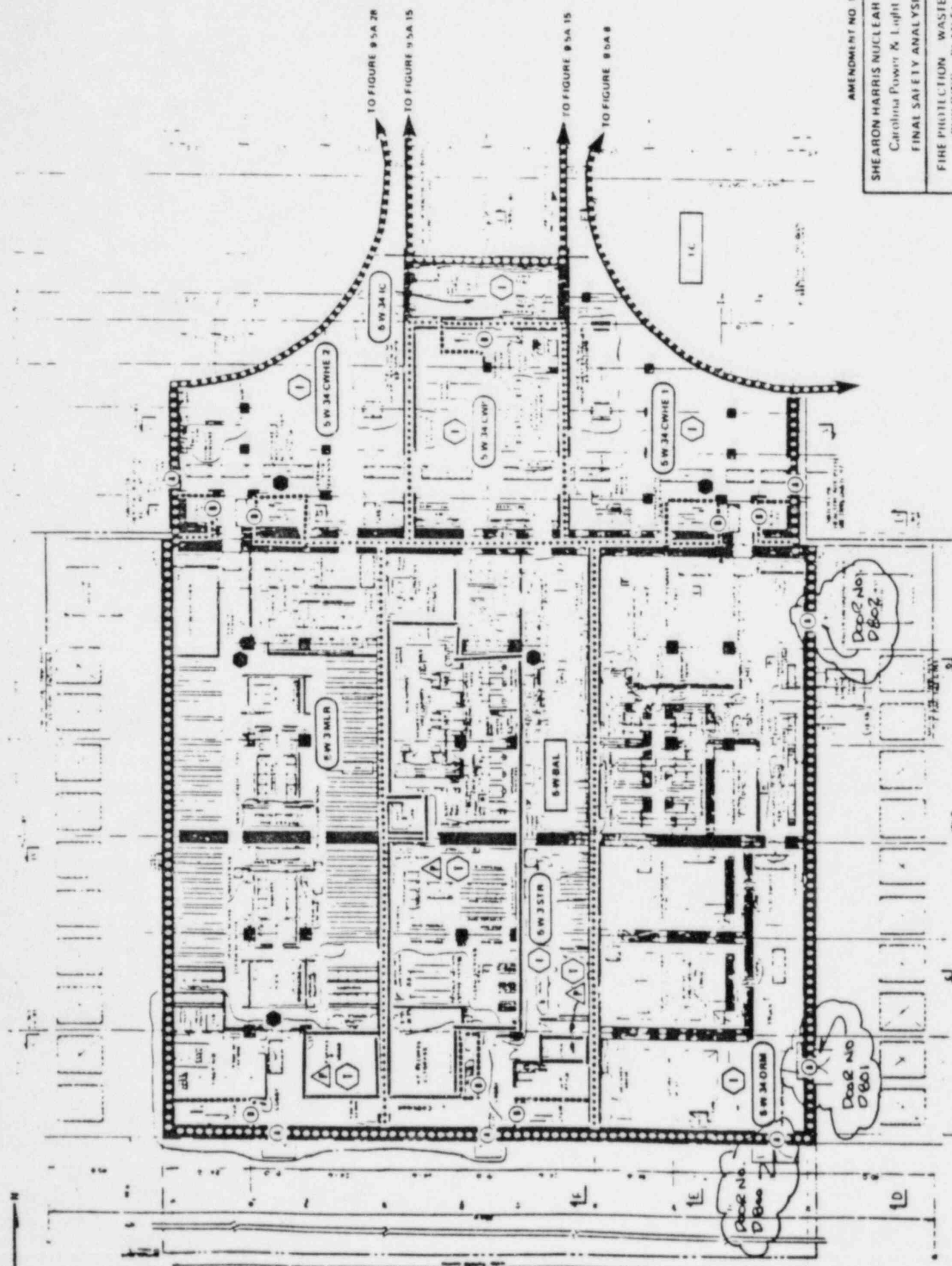

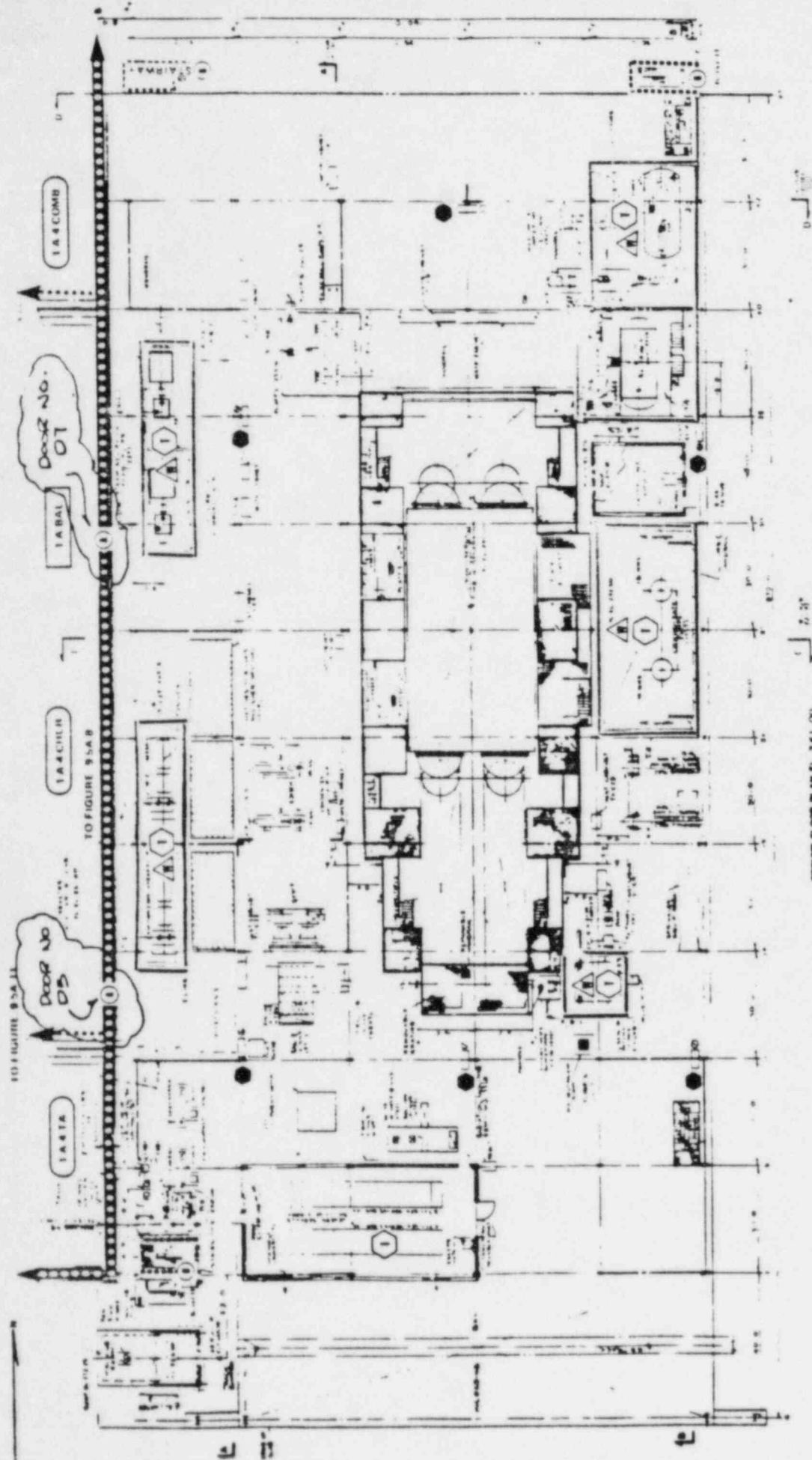

GROUND FLOOR PLAN EL. 2.61 (3)

- NOTES**
- 1. SEE FIGURE 9.5A.1 FOR DETAILS OF DOOR NO. 01.
 - 2. SEE FIGURE 9.5A.2 FOR DETAILS OF DOOR NO. 02.
 - 3. SEE FIGURE 9.5A.3 FOR DETAILS OF DOOR NO. 03.
 - 4. SEE FIGURE 9.5A.4 FOR DETAILS OF DOOR NO. 04.
 - 5. SEE FIGURE 9.5A.5 FOR DETAILS OF DOOR NO. 05.
 - 6. SEE FIGURE 9.5A.6 FOR DETAILS OF DOOR NO. 06.
 - 7. SEE FIGURE 9.5A.7 FOR DETAILS OF DOOR NO. 07.
 - 8. SEE FIGURE 9.5A.8 FOR DETAILS OF DOOR NO. 08.
 - 9. SEE FIGURE 9.5A.9 FOR DETAILS OF DOOR NO. 09.
 - 10. SEE FIGURE 9.5A.10 FOR DETAILS OF DOOR NO. 10.

AMENDMENT NO. 15

SHEARON HARRIS NUCLEAR POWER PLANT
 Carolina Power & Light Company
 FINAL SAFETY ANALYSIS REPORT
 FIRE PROTECTION TURBINE BUILDING
 GROUND FLOOR PLAN

FIGURE 9.5A.35

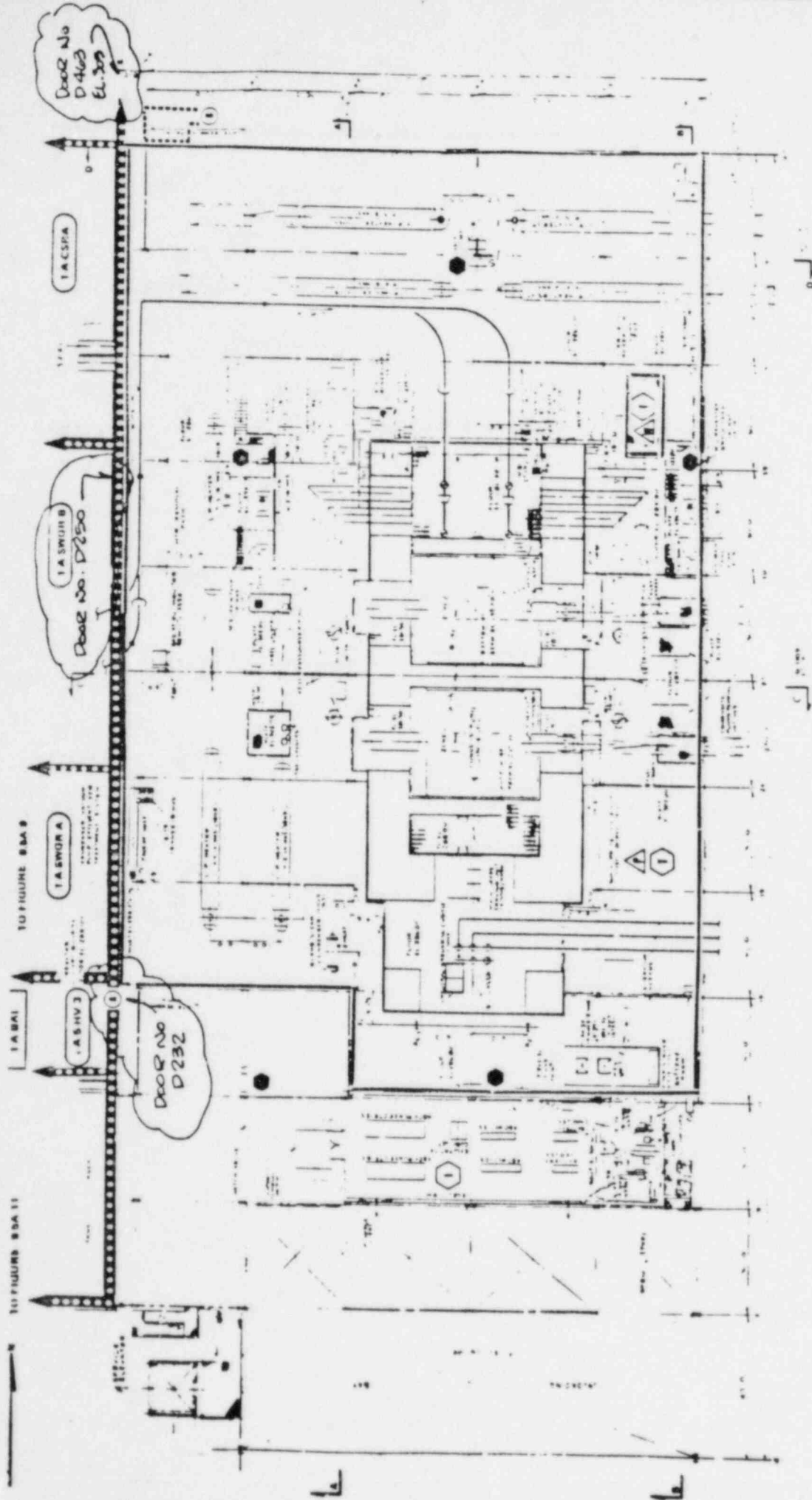

MEZZANINE FLOOR PLAN EL. 294.00

AMENDMENT NO. 15

SHEARON HARRIS NUCLEAR POWER PLANT Carolina Power & Light Company FINAL SAFETY ANALYSIS REPORT
FIRE PROTECTION - TURBINE BUILDING MEZZANINE FLOOR PLAN

FIGURE 9.5A.36