



ENTERGY

Entergy Operations, Inc.

P.O. Box 8

Keene, LA 70066

Tel. 504-739-6774

R. F. Burski

Director

Nuclear Regulation

Washington, D.C.

W3F1-95-0136

A4.05

PR

September 5, 1995

Mr. L.J. Callan
Regional Administrator, Region IV
U.S. Nuclear Regulatory Commission
611 Ryan Plaza Drive, Suite 400
Arlington, TX 76011

Subject: Waterford 3 SES
Docket No. 50-382
License No. NPF-38
Modification to Primary Access Point

Dear Mr. Callan:

Please be informed that Waterford 3 is preparing to implement temporary changes to the Primary Access Point (PAP) to facilitate increased traffic flow during the upcoming refueling outage scheduled to start September 22, 1995, with an anticipated completion date of November 5, 1995. Waterford 3 will continue to implement appropriate steps necessary to ensure access to the plant is maintained in accordance with 10CFR73.55(d) requirements. Waterford is currently planning to make these changes final and shall forward these changes to you in accordance with 10CFR50.54(p).

The attached documentation includes a description of the changes to the PAP which will be in place during our refueling outage. Attached are drawings depicting the present and temporary configuration of the Primary Access Point.

9511070045 950905
PDR ADOCK 05000382
P PDR

4005

Modification to Primary Access Point

W3F1-95-0136

Page 2

September 5, 1995

Should you require additional information concerning this matter, please contact Glenn Zetsch at (505)739-6354.

Very truly yours,

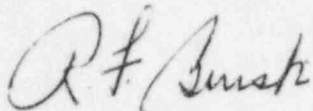

R.F. Burski
Director
Nuclear Safety

RFB/GCS/tjs
Attachments

cc: C.P. Patel, NRC-NRR
R.B. Manili NRC-NRR
N.S. Reynolds
R.B. McGehee
NRC Document Control Desk
NRC Resident Inspectors Office

Description of Temporary Alteration
(include affected equipment and function)

Personnel entering the protected area are processed through the Primary Access Point (PAP) which is located in the Access Control Facility. The Access Control facility conforms to the requirements of 10CFR73.2 as a physical barrier for the protected area. A layout drawing of the existing PAP is included as sketch SK-B-C-0156, indicating the location of personnel and package monitoring areas and points of entrance and exit. Personnel access into the protected area is through turnstiles at the PAP. Waterford 3 has no alternate access point. During refueling outages the traffic through the PAP is almost tripled during shift changes.

This Temporary Alteration will revise the layout of the PAP (See sketch SK-B-C-0157) to help expedite personnel and package monitoring by accomplishing the following:

- 1) Remove all bump turnstile stands.
- 2) Remove all rails except exit rail.
- 3) Swap metal detectors and explosive detectors.
- 4) Add new Hi-Scan 6040-A X-Ray machine between lanes 1 and 2.
- 5) Relocate existing X-Ray machine and mirror between lanes 3 and 4.
- 6) Relocate Sensormatic equipment to front of exit lane.
- 7) Install new security hollow metal door (DQ12) with lockset in South masonry block wall adjacent to gate turnstile 1.

Items that are delivered into the protected area are inspected visually or through the use of portable detection devices or package X-Ray examination devices. The metal detection and explosive detection equipment is designed to detect firearms, explosives and incendiary devices at the PAP. The Sensormatic equipment is designed to alarm locally if a badged personnel does not drop off his badge prior to exiting the PAP. A hands-on search of persons authorized access is conducted when there is cause to suspect that the individual is attempting to introduce firearms, explosives, or incendiary devices into the protected area, or when the metal and/or explosives detection equipment fails. Alarms for the search equipment annunciate locally at the location of the equipment, as well as inside the Final Access Control Security Office (FACSO).

BEFORE

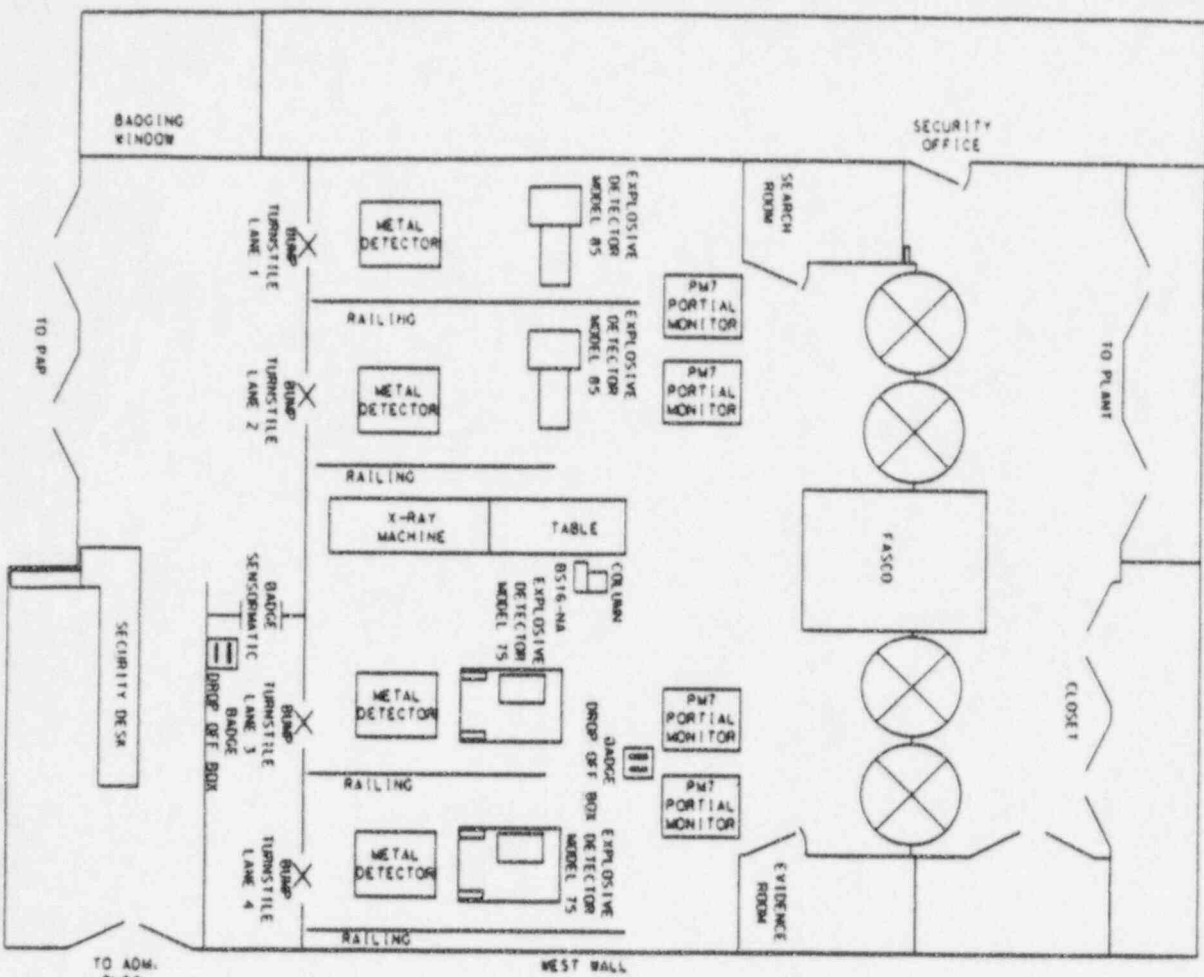

| | | | | | |
|-----|------|----------------------|----|----|----------|
| NEL | DATE | REVISION DESCRIPTION | BY | CH | APPROVED |
|-----|------|----------------------|----|----|----------|

| | | | |
|----------------------|-------------|---|--|
| | | WATERFORD S.E.S. UNIT NO. 3 1165 MW INSTALLATION | |
| PRIMARY ACCESS POINT | | | |
| SCALE: NTS | APPROVED | DATE: 8-1-95 | |
| DEPT. DRAFTING | | | |
| DR. <i>ML</i> | SK-B-C-0156 | | |

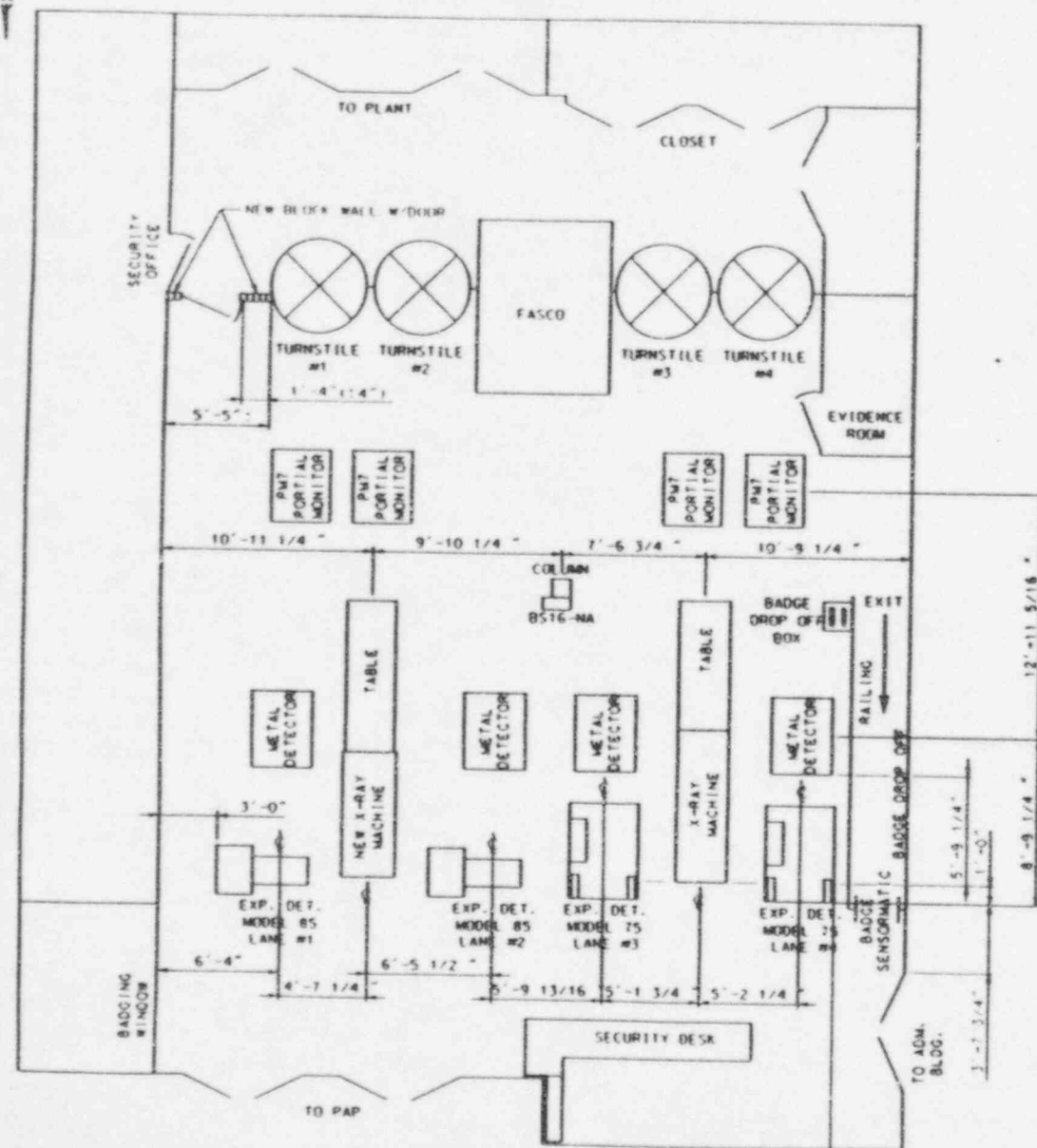

AFTER

- 1) ALL DIMENSIONS HAVE A TOLERANCE OF $\pm 1'-0"$ TOLERANCE.
- 2) SECURITY TO RELOCATE THE BADGE DROP OFF BOX.
- 3) REFER TO TAR 95-010 ENGINEERING INSTRUCTIONS FOR INSTALLATION & RELOCATION OF EQUIPMENT.

| | | | |
|---|------------------------------|---|--------------|
| ENTERGY | | WATERFORD S.E.S. UNIT NO. 3 1165 MW INSTALLATION | |
| RECONFIGURATION OF PRIMARY ACCESS POINT PER TAR 95-010 | | | |
| SCALE: NTS | APPROVED: <i>[Signature]</i> | | DATE: 8-1-95 |
| DEPT. DRAFTING | DR. <i>[Signature]</i> | | SK-B-C-0157 |
| CH. <i>[Signature]</i> | CH. <i>[Signature]</i> | | |

| NOL | DATE | REVISION DESCRIPTION | BY | CH | APPROVED |
|-----|------|----------------------|----|----|----------|
|-----|------|----------------------|----|----|----------|