

**Commonwealth Edison**

Southern Division • Streator District Headquarters
 Frech Street W. of Hwy. 23 • Streator, Illinois
 Telephone 815/672-2101

Address reply to: Post Office Box 518
 Streator, Illinois 61364

DMB

April 16, 1984

Mr. James G. Keppler
 Regional Administrator
 Region III
 U.S. Nuclear Regulatory Commission
 799 Roosevelt Road
 Glen Ellyn, IL 60137

PRINCIPAL STAFF			
EA		DPRP	
D/RA		OE	
A/RA		DRM	orig+2
IS		DRMA	
SAO		SCS	
SJA		ML	
TF		File	WES

Dear Mr. Keppler

Subject: EPP Annual Operating Report
 Appendix B to Facility License No. NPF-11 and No. NPF-18

Attached is the Annual Operating Report for the implementation of the Environmental Protection Plan as required by Section 5.4 of Appendix B to Facility License No. NPF-11 and No. NPF-18. This report is contained in Attachments 1 through 4 as indicated below:

Attachment 1 - Summaries and analyses of the results of the environmental protection activities required by Subsection 4.2.

Attachment 2 - List of EPP noncompliances and corrective actions taken to remedy them.

Attachment 3 - A list of all changes in station design or operation, tests, and experiments made in accordance with Subsection 3.1 which involve a potentially significant unreviewed environmental issue.

Attachment 4 - A list of nonroutine reports submitted in accordance with Subsection 5.4.2.

Section 3.2 of Appendix B requires submittal to the NRC of NPDES noncompliance reports which are required by the State of Illinois. These reports were previously submitted to the NRC at the time submittal was made to the state. Included as Attachment 5 of this Annual Operating Report is a summary of the NPDES noncompliances for 1983.

8404200243 840416
 PDR ADDCK 05000373
 R PDR

APR 18 1984

J. G. Keppler

- 2 -

In accordance with Regulatory Guide 10.1, one copy of this report is provided for your use and 18 copies are being submitted directly to the Document Control Desk, U.S. Nuclear Regulatory Commission, Washington, D.C., 20555.

Sincerely yours,

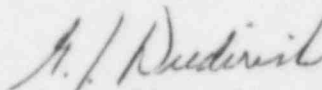
A handwritten signature in cursive script, appearing to read "G. J. Diederich".

G. J. Diederich
Station Superintendent
LaSalle County Station

GJD/FRL/bej

Attach.

xc: C. W. Schroeder, w/attach.
NRC Resident Inspector, w/attach.
Environmental Affairs, w/attach.
Document Control Desk (18 copies)

ATTACHMENT 1

Subject: Vegetative Integrity on Cooling Pond Dike

The vegetative integrity of the cooling pond dike was inspected in accordance with LaSalle County Station procedure LTS-1000-5 on the following dates: March 2, 1983; May 26, 1983; June 29, 1983; July 27, 1983; August 22, 1983; September 29, 1983; October 27, 1983; and November 28, 1983. During these inspections, no problems were noted concerning the vegetative integrity of the cooling pond dike.

Attachment 1 (Continued)

Subject: LaSalle County Station Units 1 and 2
Operational Fog and Ice Observation Report

The following is a summary of the data for 1983 of the operational fog and rime ice observations in the vicinity of the cooling pond including an analysis of the data and comparison to the previous year's experience (1982 partial operation, and 1980 and 1981 baseline). This is in accordance with the Environmental Protection Plan, Appendix B, Section 4.2.2 which is part of the operating license for LaSalle County Station Unit 1 and 2.

Included are: (a) Attachment 1, which includes all reported incidences of fog which restricted visibility to 1/4 miles or less and rime ice observed on station property in 1983; (b) Attachment 2, which consists of copies of the four quarterly summaries of fog and rime ice observations for 1983; and (c) Attachment 3, which includes the annual summaries of observations for the years 1982, 1981 and 1980.

In summary, there were 5 days out of the 249 observation days during 1983 where visibility was restricted to less than 1/4 mile. There were no observations of ice build-up occurring off the station property. There were, however, four cases of on-site rime ice during the year.

Analysis of the five 1983 occurrences of reduced visibility shows that on only one day, February 15, was there an observation of reduced visibility which may have been enhanced by the pond. The report said "general light fog" as a general condition. The February 15 observation was isolated between observation points 4 and 5 in a wind direction indicating possible pond effect. The water temperature of the cooling pond February 15 was 33°F, slightly below the drybulb temperature of 36°F and the dewpoint temperature of 34°F therefore there should have been little contribution of steam fog to the atmosphere from the cooling pond.

All four 1983 rime ice observations were in a localized area near the circulating water discharge. Rime ice was observed on vegetation and on vertical surfaces. None of the occurrences was reported as heavy or persistent. Ice was observed only on the early morning inspections and had disappeared by midday. The first two observations, March 22 and 23, occurred during a period after Unit 1 had been in operation. The water temperature was approximately 40°F and the air temperature was quite cold, reading 15°F. The other two rime ice observations were on December 19 and December 23 during a period of extremely cold weather. The air temperature was well below zero at -17°F and -14°F. Unit 1 had not been operated for sometime so the water temperature was approximately at the freezing point. In all cases of rime ice the vegetation was dormant, there was no physical damage and the ice was not persistent. In view of these factors there is no need for an "Inspection for Environmental Impact of Rime Icing" as specified in Section 4.4.2 (d) of the EPP.

The 1983 data had fewer observations of fog causing reduced visibilities than previous years 1982, 1981, and 1980. As shown below there were 5 observations in 1983, 12 in 1982, 11 in 1981 and 10 in 1980.

<u>Year</u>	<u>Total observations, Visibility Less than 1/4 Mile</u>	<u>Visibility Less Than 1/4 Mile Downwind Only</u>
1983	5	1
1982	12	0
1981	11	1
1980	10	0

It is apparent that there was little or no enhancement of local fog conditions that could be attributed to the heat rejected to the cooling pond. There was the one observation in February, 1983 which was isolated between Points 4 and 5 downwind of the cooling pond. This was only the second time in the 4 years of observations that a visibility reduction under a 1/4 mile occurred downwind of the pond without any similar upwind or cross wind fog observations. The previous occurrence was on August 21, 1981 at points 2 and 3 both of which were downwind of the pond.

All rime ice observations in 1983 and 1982 were localized to the point where the entrance road crosses the cooling water discharge canal. In 1982 there were two observations which occurred during a period of extremely cold weather in January, 1982, which was before fuel loading. There was one observation in 1981 in late December under conditions which combined very cold air temperatures and an area wide light fog which resulted in a natural rime ice formation off site but was apparently not influenced by the cooling pond. The additional incidences of rime ice formation in 1983 indicate that localized, short duration occurrences will be more frequent when the units are operating with low ambient air temperatures.

Fog and Rime Ice Monitoring Program Summary
LaSalle County Generating Station

Incidence of Fog/Rime Ice Formation
 1983

249 Days of Observations

Fog/Rime Ice Observations		Wind Direction	Visibility in Feet (less than 1/4 mile) at Observation Points									Remarks
Date	Time		1	2	3	4	5	6	7	8	9	
2/15	7:30 a	141°				400*						General light fog; low visibility area was about 1 mile east of Point 4.
3/22	7:25 a	234°										Rime ice (1/8") near guardhouse.**
3/23	7:20 a	325°										Rime ice (1/8") near guardhouse.**
4/06	7:00 a	125°	400	400	400	400	400	400	400*	400*	400*	Fog.
6/28	7:15 a	0°				500	400	500	600	600		Heavy fog over pond.
11/17	7:20 a	315°	400*	500	400	300						Heavy fog over pond.
12/05	7:00 a	250°	400	400	200	200	200	200*	200*	400	400	Could not see station lights from Points 2, 3, 4, or 5.
12/19	7:30 a	333°										Rime ice (1/4") on hand-rails and vegetation near circulating water discharge.**
12/23	7:30 a	260°										Rime ice (trace) on guard-rail and plants near circulating water discharge.**

* Denotes Fog Formation Downwind of Cooling Pond

Obs.Pt.	Span	Obs.Pt.	Dir. Span	Obs.Pt.	Dir. Span
1	305°-82°	4	90°-161°	7	197°-339°
2	27°-85°	5	90°-240°	8	278°-351°
3	65°-112°	6	188°-262°	9	286°-67°

**Rime ice on station site only.
 See map on reverse side for location.

(See Map on Reverse Side)

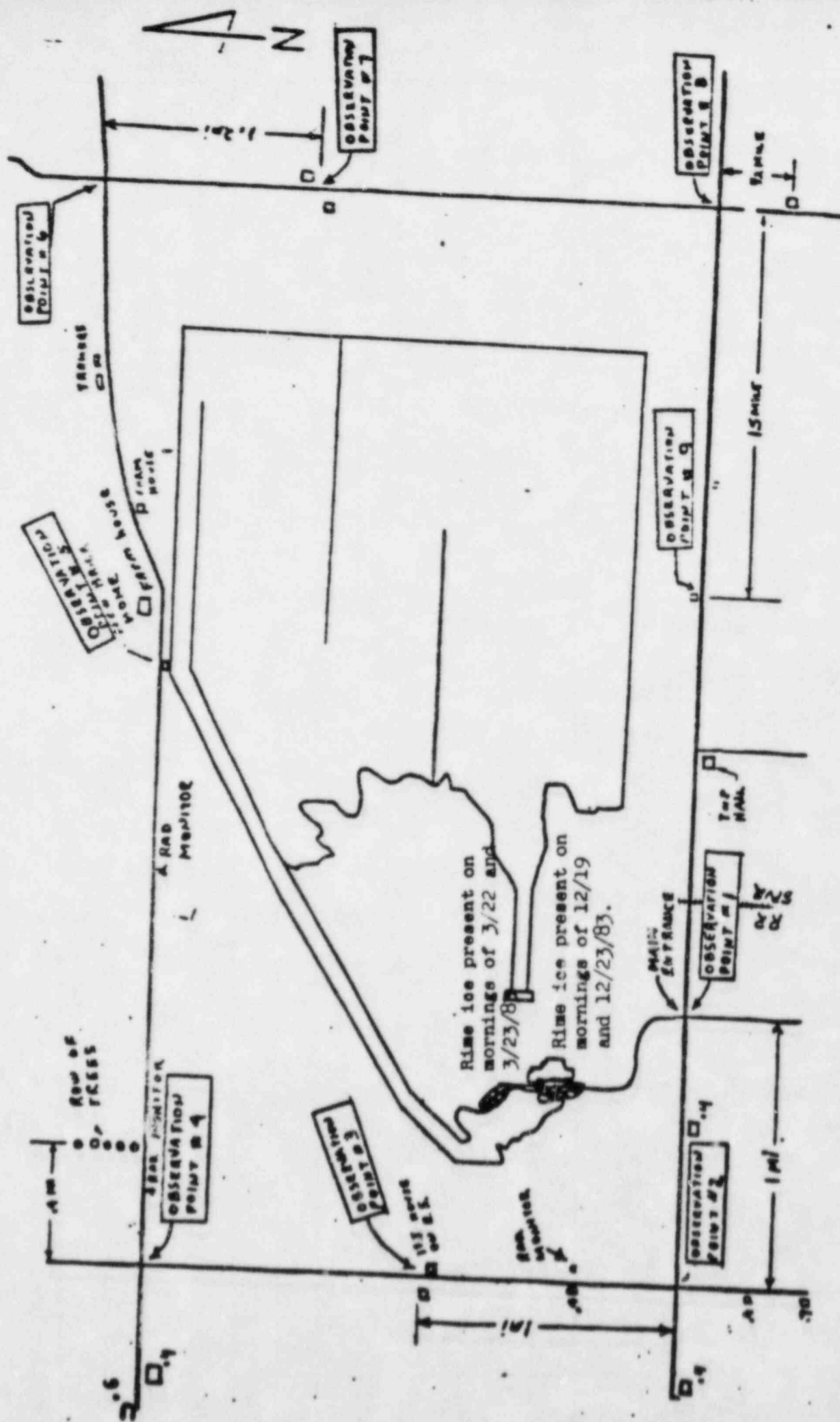

Fog and Rime Ice Monitoring Program Summary
LaSalle County Generating Station

Incidence of Fog/Rime Ice Formation

First Quarter, 198362 Days of Observations

Fog/Rime Ice Observations Date Time	Wind Direction	Visibility in Feet (less than 1/4 mile) at Observation Points									Remarks
		1	2	3	4	5	6	7	8	9	
2-9 7:15a	145°										Heavy fog only over pond
2-15 7:30a	141°				400*						General Light Fog; Low Visibility area was about 1 mile east of Point 4
2-15 4:00p	63°										Light fog
2-16 7:30a	203°										Light fog
2-18 7:30a	184°										Light fog
3-18 7:30a	45°										Light fog
3-22 7:25a	234°										Rime Ice (1/8") near guardhouse.**
3-23 7:20a	325°										Rime Ice (1/8") near guardhouse**

* Denotes Fog Formation Downwind of Cooling Pond

Obs. Pt.	Dir. Span	Obs. Pt.	Dir. Span	Obs. Pt.	Dir. Span
1	305°- 82°	4	90°-161°	7	197°-339°
2	27°- 85°	5	90°-240°	8	278°-351°
3	65°-112°	6	188°-262°	9	286°- 67°

(See Map on Reverse Side)

*Rime ice on Station site only;
See reverse side for location.

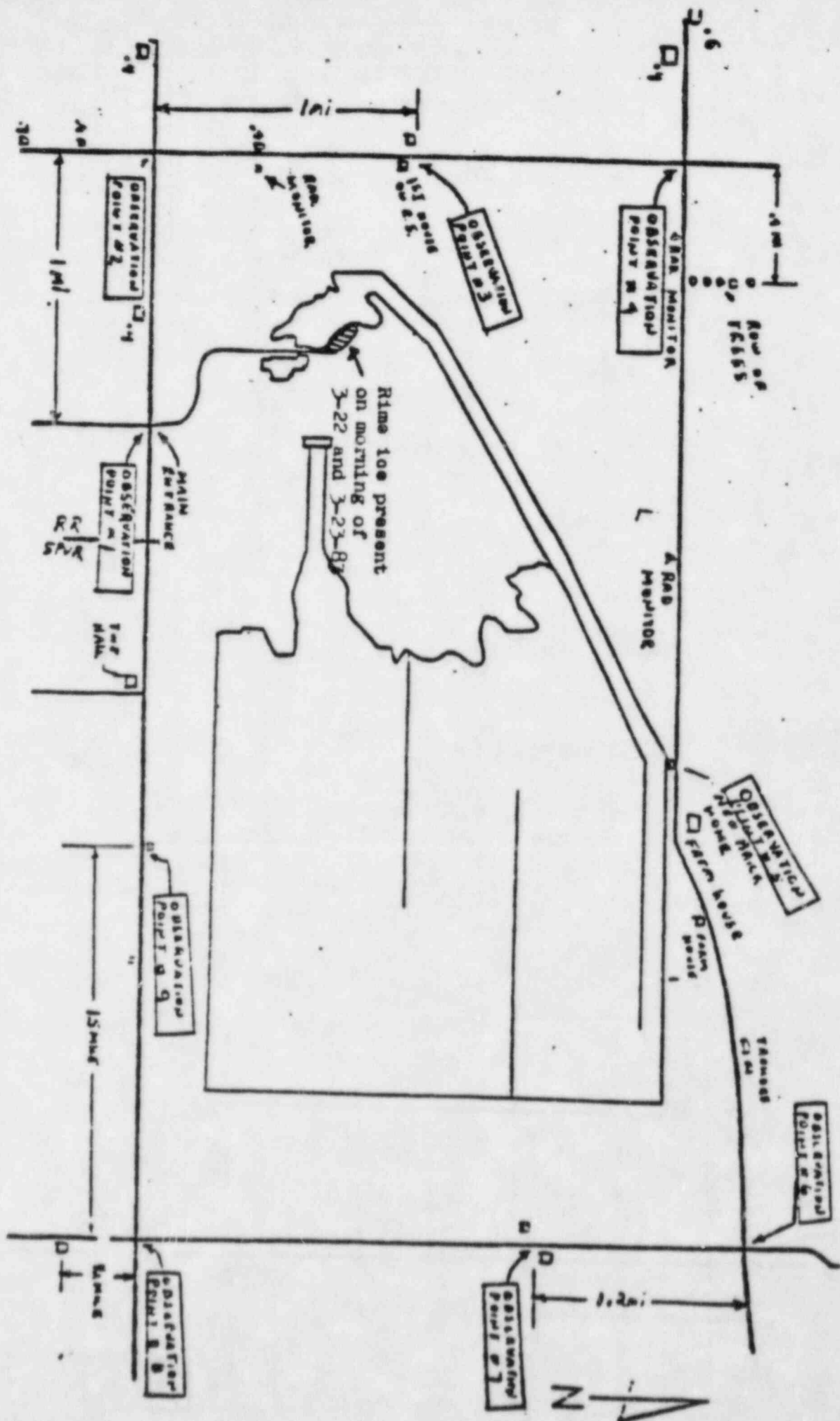

63 Days of Observations

* Denotes Fog Formation Downwind of Cooling Pond

(See Map on Reverse Side)

Incidence of Fog/Rime Ice Formation

Third Quarter, 1983

64 Days of Observations

[illegible]

* Denotes Fog Formation Downwind of Cooling Pond

Obs. Pt.	Dir. Span	Obs. Pt.	Dir. Span	Obs. Pt.	Dir. Span
1	305°-82°	4	90°-161°	7	197°-339°
2	27°-85°	5	90°-240°	8	278°-351°
3	65°-112°	6	188°-262°	9	286°-67°

(See Map on Reverse Side)

Fog and Rime Ice Monitoring Program Summary
LaSalle County Generating Station

Incidence of Fog/Rime Ice Formation

Fourth Quarter, 1983

60 Days of Observations

Fog/Rime Ice Observations		Wind Direction	Visibility in Feet (less than 1/4 mile) at Observation Points									Remarks
Date	Time		1	2	3	4	5	6	7	8	9	
10/05/83	7:15a	300°										Light fog over lake only, formed after 7:00 a.m.
10/14/83	7:30a	234°										Light fog over road at Observation Point #5.
												No visibility restrictions.
11/02/83	7:30a	135°										Light fog, no visibility restrictions.
11/15/83	7:20a	320°										
11/17/83	7:20a	315°	400*	500	400	300						Light fog over pond.
11/23/83	7:30a	27°										Heavy fog over pond.
												Light fog over general area, no visibility restriction.
11/28/83	7:30a	175°										Light fog over general area.
12/05/83	7:00a	250°	400	400	200	200	200	200*	200*	400	400	Could not see station lights from Points 2, 3, 4 or 5.
12/05/83	4:00p	10°										Some light fog, no visibility restrictions.
12/06/83	7:30a	355°										Light fog over general area, no visibility restrictions.

* Denotes Fog Formation Downwind of Cooling Pond

Obs. Pt.	Dir. Span	Obs. Pt.	Dir. Span	Obs. Pt.	Dir. Span
1	305°- 82°	4	90°-161°	7	197°-339°
2	27°- 85°	5	90°-240°	8	278°-351°
3	65°-112°	6	188°-262°	9	286°- 67°

(See Map on Reverse Side)

60 Days of Observations

* Denotes Fog Formation Downwind of Cooling Pond

**See map on reverse side.

(See Map on Reverse Side)

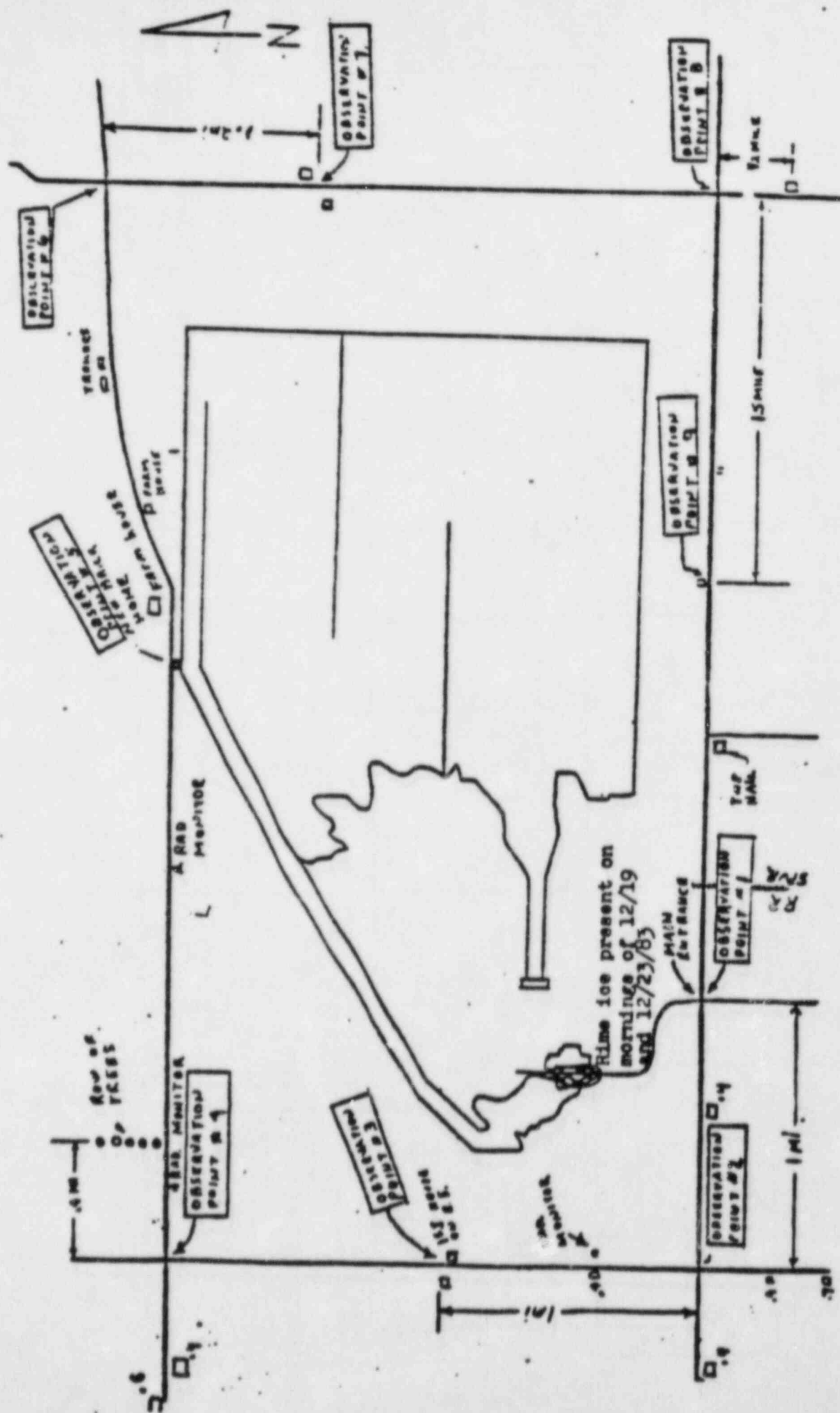

Fog and Rime Ice Monitoring Program Summary
LaSalle County Generating Station

Attachment 3
page 1 of 4

Incidence of Fog/Rime Ice Formation

1982

249 Days of Observations

Fog/Rime Ice Observations		Wind Direction	Visibility in Feet (less than 1/4 mile) at Observation Points									Remarks
Date	Time		1	2	3	4	5	6	7	8	9	
1-14	7:12a	257°										Rime ice (1/16") near guardhouse**
1-26	6:59a	279°										Rime ice (light) along roadway into parking lot**
2-02	7:03a	125°	50	50	75*	50*	50*	50	50	50	50	
2-19	4:10p	261°			1000							
3-12	7:15a	145°				800*	800*	800				
6-29	7:15a	282°	200	200	200	200	400			600*	200*	
8-23	7:25a	18°	500*	500*	200	200	250	250	250	500	500*	
9-01	8:00a	171°				900*	800*	400				Fog rain
9-02	7:30a	279°	300	200	100	150	150	500	300*	200*	200	
9-08	7:30a	90°	900	900	400*	400*	400	400	400	400	900	Light fog-mist
9-09	7:10a	180°	1000					300				
9-27	7:00a	59°	200*	100*	100*	100	100	200	200	200	200*	Heavy fog over general area
10:08	7:00a	20°		Fog density 200-400 feet in all directions								

* Denotes Fog Formation Downwind of Cooling Pond

Obs. Pt.	Dir. Span	Obs. Pt.	Dir. Span	Obs. Pt.	Dir. Span
1	305°- 82°	4	90°-161°	7	197°-339°
2	27°- 85°	5	90°-240°	8	278°-351°
3	65°-112°	6	188°-262°	9	286°- 67°

**Rime ice on station site only:
see page 2 of Attachment 2 for location.

(See Map on Reverse Side)

2

Attachment 3

page 2 of 4

1982

249 Days of Observations

* Denotes Fog Formation Downwind of Cooling Pond

(See Map on Reverse Side)

Fog and Rime Ice Monitoring Program Summary
LaSalle County Generating Station

Incidence of Fog/Rime Ice Formation

248 Days of Observations
During 1981

Fog/Rime Ice Observations	Date	Time	Wind Direction	Visibility in Feet (less than 1/4 mile) at Observation Points									Remarks
				1	2	3	4	5	6	7	8	9	
2-17	7:00p	205°				Fog Density	400-600	feet in all directions					
2-18	7:15a	220°		1200	1200	800	800	600*	800*	1000*	1100	800	Fog over entire area
2-27	7:15a	126°											Ice over all areas
4-30	7:15a	135°		1000	800	1000*					1000	800	Rain, drizzle
8-21	7:12a	72°			1200*	1000*							Fog
9-14	7:05a	280°		200	200	225	250	250	250	250*	250*	250	Fog
10-05	7:05a	90°		600	600	600*	600*	600	600	800	600	600	
10-08	7:08a	10°		350*	350*	350	400	200	150	200	250	300*	
10-15	6:45a	235°		1200	1200	1000	1000	800*	600*	800	1200	1200	Heavy fog over entire area
10-16	6:45a	230°		1200	1200	1200	1200	1000*	800*	1000	1200	1200	Fog over entire area
11-04	7:12a	99°		800	600	500	400*	400*	400	600	600	800	
11-16	7:05a	250°		800	800	800	600	600*	600*	800	800	800	
12-29	7:00a	275°				< 1"	< 1"	< 1"	< 1"	< 1"	< 1"	< 1"	Rime ice at Stations 3-9; Light fog over area

* Denotes Fog Formation Downwind of Cooling Pond

Obs.Pt.	Dir. Span	Obs.Pt.	Dir. Span	Obs.Pt.	Dir. Span
1	305°- 82°	4	90°-161°	7	197°-339°
2	27°- 85°	5	90°-240°	8	278°-351°
3	65°-112°	6	188°-262°	9	286°- 67°

(See Map on Reverse Side)

Fog and Rime Ice Monitoring Program Summary
LaSalle County Generating StationIncidence of Fog/Rime Ice Formation
During 1980

249 Days of Observations

Fog/Rime Ice Observations		Wind Direction	Visibility in Feet (less than 1/4 mile) at Observation Points									Remarks
Date	Time		1	2	3	4	5	6	7	8	9	
1-16	4:00P	171*					200*		1300	1300	1300	Pond frozen
2-20	6:30A	234*		500	500		200*		500	500	500	Pond 90% frozen
2-21	6:30A	90*	500	1000	1000*					1000	1000	Pond 90% frozen
5-19	7:00A	31*	200*	200*	200	200	200	300	300	300	250*	
8-11	7:20A	240*	1400	1400	1400	1000	1000*	1000	700*	800	800	Dense fog 5 mi. east of plant
8-18	7:07A	332*	800*	700	650	800	700	650	720*	750	700	Fog in entire area
8-28	7:06A	**	600	800	800	800	600	600	600	800	800	
9-05	7:15A	71*						1300	700	700	750	
12-01	4:30P	72*					800	800	800	800	800	Raining
12-31	7:00A	315*	1000	1000	1000	1000	1000	1000	1000	1000	1000*	

* Denotes Fog Formation Downwind of Cooling Pond

** Wind direction indicator not working

Obs.Pt.	Dir. Span	Obs.Pt.	Dir. Span	Obs.Pt.	Dir. Span
1	305°- 82°	4	90°-161°	7	197°-339°
2	27°- 85°	5	90°-240°	8	278°-351°
3	65°-112°	6	188°-262°	9	286°- 67°

(See Map on Reverse Side)

ATTACHMENT 2

EPP noncompliances and corrective action taken to remedy them.

NONE

ATTACHMENT 3

Changes in station design or operation, tests and experiments made in accordance with subsection 3.1 which involve a potentially significant unreviewed environmental issue.

NONE

ATTACHMENT 4

Nonroutine reports submitted in accordance with subsection 5.4.2.

NONE

ATTACHMENT 5

Summary of NPDES noncompliances for 1983. These have been previously reported to the NRC at the time the report was submitted to the State of Illinois. These are not EPP noncompliances.

LASALLE COUNTY STATION
NPDES NON-COMPLIANCES
1983

Attachment 5
Page 1 of 6

DVR NUMBER	DATE	NON-COMPLIANCE	CORRECTIVE ACTION
1-1-83-3	3 Jan 83	Regen. Wastes Soln. Disch. Tank Total Sus. Solids and Total Iron	Provide the option for treatment at the Wastewater Treatment Facility. Refer to Note 1, Page 6 of 6.
1-1-83-5	10 Jan 83	Regen. Wastes Soln. Disch. Tank Total Suspended Solids	Provide the option for treatment at the Wastewater Treatment Facility. Refer to Note 1, Page 6 of 6.
1-1-83-10	18 Jan 83	Regen. Wastes Soln. Disch. Tank Total Suspended Solids	Provide the option for treatment at the Wastewater Treatment Facility. Refer to Note 1, Page 6 of 6.
1-1-83-20	26 Jan 83	Regen. Wastes Soln. Disch. Tank Total Sus. Solids and Total Iron	Provide the option for treatment at the Wastewater Treatment Facility. Refer to Note 1, Page 6 of 6.
1-1-83-22	7,8 Feb 83	Sanitary Treatment Plant Effluent Total Suspended Solids	Sludge was pumped out of Polishing Ponds on 15 Feb 83.
1-1-83-30	1 Feb 83	Wastewater Treatment Facility Effluent Total Iron	Repaired Mechanical Problem with Alum Injection Pumps. Clearwell was reprocessed.
1-1-83-31	4 Feb 83	Regen. Wastes Soln. Disch. Tank Total Iron	Provide the option for treatment at the Wastewater Treatment Facility. Refer to Note 1, Page 6 of 6.
1-1-83-32	7 Feb 83	Regen. Wastes Soln. Disch. Tank Total Iron	Provide the option for treatment at the Wastewater Treatment Facility. Refer to Note 1, Page 6 of 6.
1-1-83-42	14 Jan 83	Radwaste Discharge Tanks Oil and Grease	None Taken.
1-1-83-43	21 Feb 83	Regen. Wastes Soln. Disch. Tank Total Suspended Solids	Provide the option for treatment at the Wastewater Treatment Facility. Refer to Note 1, Page 6 of 6.
1-1-83-47	24 Feb 83	Radwaste Discharge Tanks Oil and Grease	Oil was removed from Laundry Drain Collector Tanks.
1-1-83-50	Feb 83	Cooling Pond Blowdown Total Suspended Solids	None taken.

LASALLE COUNTY STATION
NPDES NON-COMPLIANCES
1983

Attachment 5
Page 2 of 6

DVR NUMBER	DATE	NON-COMPLIANCE	CORRECTIVE ACTION
1-1-83-54	28 Feb 83	Radwaste Discharge Tanks Total Iron	Repaired mechanical failure of Radwaste Chemical Waste Concentrator.
1-1-83-55	8 Mar 83	Radwaste Discharge Tanks Total Iron	Repaired mechanical failure of Radwaste Chemical Waste Concentrator.
1-1-83-58	2 Mar 83	Radwaste Discharge Tanks Oil and Grease	Drained and cleaned Radwaste Discharge Tanks.
1-1-83-59	9 Mar 83	Sanitary Treatment Plant Effluent Fecal Coliform	Corrected misfeed of Chlorine Tablets into Chlorinator Pit.
1-1-83-66	11 Mar 83	Regen. Wastes Soln. Disch. Tanks Total Iron	Provide the option for treatment at the Wastewater Treatment Facility. Refer to Note 1, Page 6 of 6.
1-1-83-67	14 Mar 83	Radwaste Discharge Tanks Total Iron	Repaired mechanical failure of Radwaste Chemical Waste Concentrator.
1-1-83-68	14 Mar 83	Regen. Wastes Soln. Disch. Tank Total Iron	Provide the option for treatment at the Wastewater Treatment Facility. Refer to Note 1, Page 6 of 6.
1-1-83-69	15 Mar 83	Radwaste Discharge Tanks Total Iron and Total Suspended Solids	Repaired mechanical failure of Radwaste Chemical Waste Concentrator.
1-1-83-79	21 Mar 83	Wastewater Treatment Facility Effluent pH	Discharge was stopped. Clearwell was reprocessed.
1-1-83-86	16 Mar 83	Radwaste Discharge Tanks Total Iron	Repaired mechanical failure of Radwaste Chemical Waste Concentrator.
1-1-83-88	21 Mar 83	Radwaste Discharge Tanks Total Sus. Solids and Total Iron	Repaired mechanical failure of Radwaste Chemical Waste Concentrator.
1-1-83-89	21 Mar 83	Wastewater Treatment Facility Effluent Total Iron	Repaired mechanical failure of Radwaste Chemical Waste Concentrator.

LASALLE COUNTY STATION
NPDES NON-COMPLIANCES
1983

Attachment 5
Page 3 of 6

DVR NUMBER	DATE	NON-COMPLIANCE	CORRECTIVE ACTION
1-1-83-90	22 Mar 83	Radwaste Discharge Tanks Total Suspended Solids and Total Iron	Repaired mechanical failure of Radwaste Chemical Waste Concentrator.
1-1-83-91	24 Mar 83	Radwaste Discharge Tanks Total Suspended Solids and Total Iron	Repaired mechanical failure of Radwaste Chemical Waste Concentrator
1-1-83-108	25 Mar 83	Radwaste Discharge Tanks Total Suspended Solids and Total Iron	Repaired mechanical failure of Radwaste Chemical Waste Concentrator.
1-1-83-109	26 Mar 83	Radwaste Discharge Tanks Total Suspended Solids and Total Iron	Repaired mechanical failure of Radwaste Chemical Waste Concentrator.
1-1-83-110	27 Mar 83	Radwaste Discharge Tanks Total Suspended Solids and Total Iron	Repaired mechanical failure of Radwaste Chemical Waste Concentrator.
1-1-83-111	27 Mar 83	Radwaste Discharge Tanks Total Iron	Repaired mechanical failure of Radwaste Chemical Waste Concentrator.
1-1-83-112	28 Mar 83	Radwaste Discharge Tanks Total Iron	Repaired mechanical failure of Radwaste Chemical Waste Concentrator.
1-1-83-113	29 Mar 83	Radwaste Discharge Tanks Total Suspended Solids and Total Iron	Repaired mechanical failure of Radwaste Chemical Waste Concentrator
1-1-83-114	28 Mar 83	Wastewater Treatment Facility Effluent Oil and Grease	Oil Absorbant Material was placed in the Effluent Compartment.
1-1-83-115	30 Mar 83	Radwaste Discharge Tanks Total Suspended Solids and Total Iron	Repaired mechanical failure of Radwaste Chemical Waste Concentrator.
1-1-83-116	31 Mar 83	Radwaste Discharge Tanks Total Iron	Repaired mechanical failure of Radwaste Chemical Waste Concentrator
1-1-83-117	31 Mar 83	Radwaste Discharge Tanks Total Suspended Solids and Total Iron	Repaired mechanical failure of Radwaste Chemical Waste Concentrator.

LASALLE COUNTY STATION
NPDES NON-COMPLIANCES
1983

Attachment 5
Page 4 of 6

DVR NUMBER	DATE	NON-COMPLIANCE	CORRECTIVE ACTION
1-1-83-118	Mar 83	Cooling Pond Blowdown Total Suspended Solids	None Taken
1-1-83-119	1 Apr 83	Radwaste Discharge Tanks Total Suspended Solids and Total Iron	Repaired mechanical failure of Radwaste Chemical Waste Concentrator
1-1-83-120	3 Apr 83	Radwaste Discharge Tanks Total Suspended Solids and Total Iron	Repaired Mechanical Failure of Radwaste Chemical Waste Concentrator
1-1-83-121	4 Apr 83	Regen. Wastes Soln. Disch. Tank Total Iron	Tanks Suspected of Violating NPDES Limits will be treated at Wastewater Treatment Facility.
1-1-83-122	11 Apr 83	Wastewater Treatment Facility Effluent pH	Discharge was stopped. Clearwell was reprocessed
1-1-83-125	7 Apr 83	Radwaste Discharge Tanks Total Suspended Solids and Total Iron	Repaired mechanical failure of Radwaste Chemical Waste Concentrator.
1-1-83-126	12 Apr 83	Radwaste Discharge Tanks Total Iron	Repaired mechanical failure of Radwaste Chemical Waste Concentrator.
1-1-83-127	13 Apr 83	Radwaste Discharge Tanks Total Suspended Solids and Total Iron	Repaired mechanical failure of Radwaste Chemical Waste Concentrator.
1-1-83-137	17 Apr 83	Regen. Wastes Soln. Disch. Tank No Sample and Analysis	Shift personnel were instructed on proper set-up of Composite Sampler.
1-1-83-148	14 Apr 83	Radwaste Discharge Tanks Total Suspended Solids and Total Iron	Repaired mechanical failure of Radwaste Chemical Waste Concentrator.
1-1-83-149	20 Apr 83	Radwaste Discharge Tanks Total Suspended Solids and Total Iron	Repaired mechanical failure of Radwaste Chemical Waste Concentrator.
1-1-83-150	21 Apr 83	Radwaste Discharge Tanks Total Suspended Solids and Total Iron	Repaired mechanical failure of Radwaste Chemical Waste Concentrator.

LASALLE COUNTY STATION
NPDES NON-COMPLIANCES
1983

Attachment 5
Page 5 of 6

DVR NUMBER	DATE	NON-COMPLIANCE	CORRECTIVE ACTION
1-1-83-152	21 Apr 83	Radwaste Discharge Tanks Total Iron	Repaired mechanical failure of Radwaste Chemical Waste Concentrator.
1-1-83-153	22 Apr 83	Radwaste Discharge Tanks Total Suspended Solids and Total Iron	Repaired mechanical failure of Radwaste Chemical Waste Concentrator.
1-1-83-154	25 Apr 83	Radwaste Discharge Tanks Total Iron	Repaired mechanical failure of Radwaste Chemical Waste Concentrator.
1-1-83-155	27 Apr 83	Radwaste Discharge Tanks Total Suspended Solids and Total Iron	Repaired mechanical failure of Radwaste Chemical Waste Concentrator.
1-1-83-177	28 Apr 83	Radwaste Discharge Tanks Total Suspended Solids and Total Iron	Repaired mechanical failure of Radwaste Chemical Waste Concentrator.
1-1-83-178	3 May 83	Radwaste Discharge Tanks Total Iron	Repaired mechanical failure of Radwaste Chemical Waste Concentrator.
1-1-83-179	7 May 83	Radwaste Discharge Tanks Total Suspended Solids and Total Iron	Repaired mechanical failure of Radwaste Chemical Waste Concentrator.
1-1-83-185	28 Apr 83	Wastewater Treatment Facility Effluent Total Suspended Solids	Repaired mechanical failure of Alum Injection Skid.
1-1-83-186	Apr 83	Cooling Pond Blowdown Total Suspended Solids.	None Taken.
1-1-83-208	16 May 83	Regen. Wastes Soln. Disch. Tank Total Iron	Tanks potentially in violation of NPDES Permit Limits will be treated at Wastewater Treatment Facility.
1-1-83-231	2 Jun 83	Regen. Wastes Soln. Disch. Tank Total Sus. Solids & Total Iron	Tanks potentially in violation of NPDES permit limits will be treated at Wastewater Treatment Facility.
1-1-83-233	12 Jun 83	Regen. Wastes Soln. Disch. Tank Total Iron	Tanks potentially in violation of NPDES permit limits will be treated at Wastewater Treatment Facility.

LASALLE COUNTY STATION
NPDES NON-COMPLIANCES
1984

Attachment 5
Page 6 of 6

DVR NUMBER	DATE	NON-COMPLIANCE	COPRECTIVE ACTION
1-1-83-232	7 Jun 83	Wastewater Treatment Facility Effluent Total Iron	None Taken.
1-1-83-307	31 Jul 83	Sanitary Treatment Plant Effluent No Fecal Coliform and BOD ₅ Sample or Analyses	NPDES Surveillance Program Compliance was emphasized with personnel.
1-1-83-354	23 Aug 83	Wastewater Treatment Facility Effluent Total Suspended Solids	Use of Equalization Tank Mixer was discontinued.
1-1-83-401	Sep 83	Cooling Pond Blowdown Total Suspended Solids	None Taken. Management to observe sampling and analysis until problem is resolved.
1-1-83-419	16 Oct 83	Wastewater Treatment Facility Effluent Total Suspended Solids	Cleared debris from Alum Injection System Check Valves.
1-1-83-429	24 Oct 83	Wastewater Treatment Facility Effluent pH	Discharge was stopped. Clearwell was pumped to Equalization Tank and neutralized.
1-1-83-435	30 Oct 83	Radwaste Discharge Tanks No Sample and Analysis	Instructed Rad/Chem Technicians to save all samples until results have been evaluated.
1-1-83-436	30 Oct 83	Wastewater Treatment Facility Effluent No Sample and Analysis	Management providing more follow-up of backshift and weekend work performed by Rad Chem Technicians.
1-1-83-459	22 Nov 83	Regen. Wastes Soln. Disch. Tank Total Suspended Solids	No further discharges will occur until a tank is cleaned and the Hydrogen Peroxide System is installed. Refer to Note 2, Page 6 of 6.
			<u>NOTE 1.</u> The option for treatment at the Wastewater Treatment Facility was implemented 21 March 83.
			<u>NOTE 2.</u> The permanent Hydrogen Peroxide Injection System was installed and implemented effective 30 Jan 84.