

ISHAM, LINCOLN & BEALE  
COUNSELORS AT LAW

EDWARD S. ISHAM, 1872-1902  
ROBERT T. LINCOLN, 1872-1889  
WILLIAM G. BEALE, 1885-1923

THREE FIRST NATIONAL PLAZA  
CHICAGO, ILLINOIS 60602  
TELEPHONE 312 558-7500  
TELEX: 2-5288



WASHINGTON OFFICE  
1120 CONNECTICUT AVENUE, N.W.  
SUITE 840  
WASHINGTON, D.C. 20036  
202 833-9730

July 18, 1983

Mr. Michael N. Wilcove  
U. S. Nuclear Regulatory Commission  
Washington, D. C. 20555

Re: Consumers Power Company - Midland Plant Docket Nos.  
Dear Mike: 50-329-OM; 50-330-OM; 50-329-OL; and 50-330-OL.

Enclosed in accordance with our telephone conversation are the July, 1983 crack maps of the Midland containments at the buttress-base slab junctions. Actually they are really more sketches than maps. My understanding is that "H.L." stands for "Hairline" and means that the crack width is less than .005 inches. Only five of the six junctions are included; the sixth area is the Room 110 area which was mapped on Field Engineer's Report Form CC-183 on December 17, 1982. Dr. Shunmugavel visited the site last week and found that the cracks in Room 110 have not changed. Apparently for that reason the Room 110 area was not remapped.

We are filing affidavits today from Dr. Corley and Dr. Shunmugavel in response to Ms. Stamiris' Motion to Reopen the Record. Both Dr. Corley and Dr. Shunmugavel refer to these July crack maps. I decided not to include them in our response since they don't seem to add much. However, we are sending these to you and the other parties for whatever use you want to make of them.

Sincerely,

Philip P. Steptoe

PPS:es

enc.

cc Service List (w/enclosures)

8307260413 830718  
PDR ADOCK 05000329  
G PDR

DS03

Please Resubmit Corrected  
Document in Its Entirety  
Within NA Weeks

AAO-1040

7220

G-321-D

Category NA

AAO-1041

7220

BUTTRESS ACCESS SHAFT  
CRACK MAPPING  
UNIT 1 NORTH & WEST SHAFT  
UNIT 2 NORTH, WEST  
& EAST SHAFTS  
REV. NR

DISTRIBUTION	
JOB 7220	COPY
VENDOR	2
CLIENT	1
FIELD	2
ARCH	F
CIVIL/SOIL	F
ELECT	
P/D	
MECH	
C SYS	
INSP	
STARTUP	
RSE	1
RECORD	1
BECHTEL	

7-14-83

BECHTEL ASSOC. PROFESSIONAL CORP.		JOB NO. 7220-242						
SUPPLIER DOCUMENT STAMP								
1. <input type="checkbox"/> WORK MAY PROCEED. 2. <input type="checkbox"/> WORK MAY PROCEED. SUBMIT FINAL DOCUMENT. 3. <input type="checkbox"/> REVISE AND RESUBMIT. WORK MAY PROCEED SUBJECT TO INCORPORATION OF CHANGES INDICATED. 4. <input type="checkbox"/> REVISE AND RESUBMIT. WORK MAY NOT PROCEED. 5. <input type="checkbox"/> REVIEW NOT REQUIRED. WORK MAY PROCEED. <input checked="" type="checkbox"/> FOR INFORMATION ONLY.								
PERMISSION TO PROCEED DOES NOT CONSTITUTE ACCEPTANCE OR APPROVAL OF DESIGN DETAILS, CALCULATIONS, ANALYSES, TEST METHODS OR MATERIALS DEVELOPED OR SELECTED BY THE SUPPLIER AND DOES NOT RELIEVE SUPPLIER FROM FULL COMPLIANCE WITH CONTRACTUAL OBLIGATIONS.								
REVIEWED	A	C	E	J	M	N	P	Q
	/	/	/	/	/	/	/	/
BY	W. Chapman			Date 7-14-83				
	for B. Chert							

7220-200 REV 9/82

DWG REVISEQ NO. 7220-C-198-2857-1  
STARTUP SYSTEMS OR AREAS  $\leq$  90  
DAYS OF TURNOVER, OR AFTER TURN-  
OVER IF AFFECTED BY CHANGES:

System/  
Area No. Hardware Change  
(Yes or No)

NA

7220-242

7220-C-198-2857-1

TOTAL # OF PAGES - 11

SCALE: ONE  
EQUALS ONE FOOT

# AUXILIARY BUILDING

DATE 7/12/83

ELEVATION 59'6"  
COMPARATOR NO. C1-1  
CALIBRATION DUE DATE N/A

LOCATION Unit #2 East  
SEQUENCE NO. 1  
SURVEYED BY JH

REVIEWED BY  
WJE (LEVEL I  
INSPECTOR)

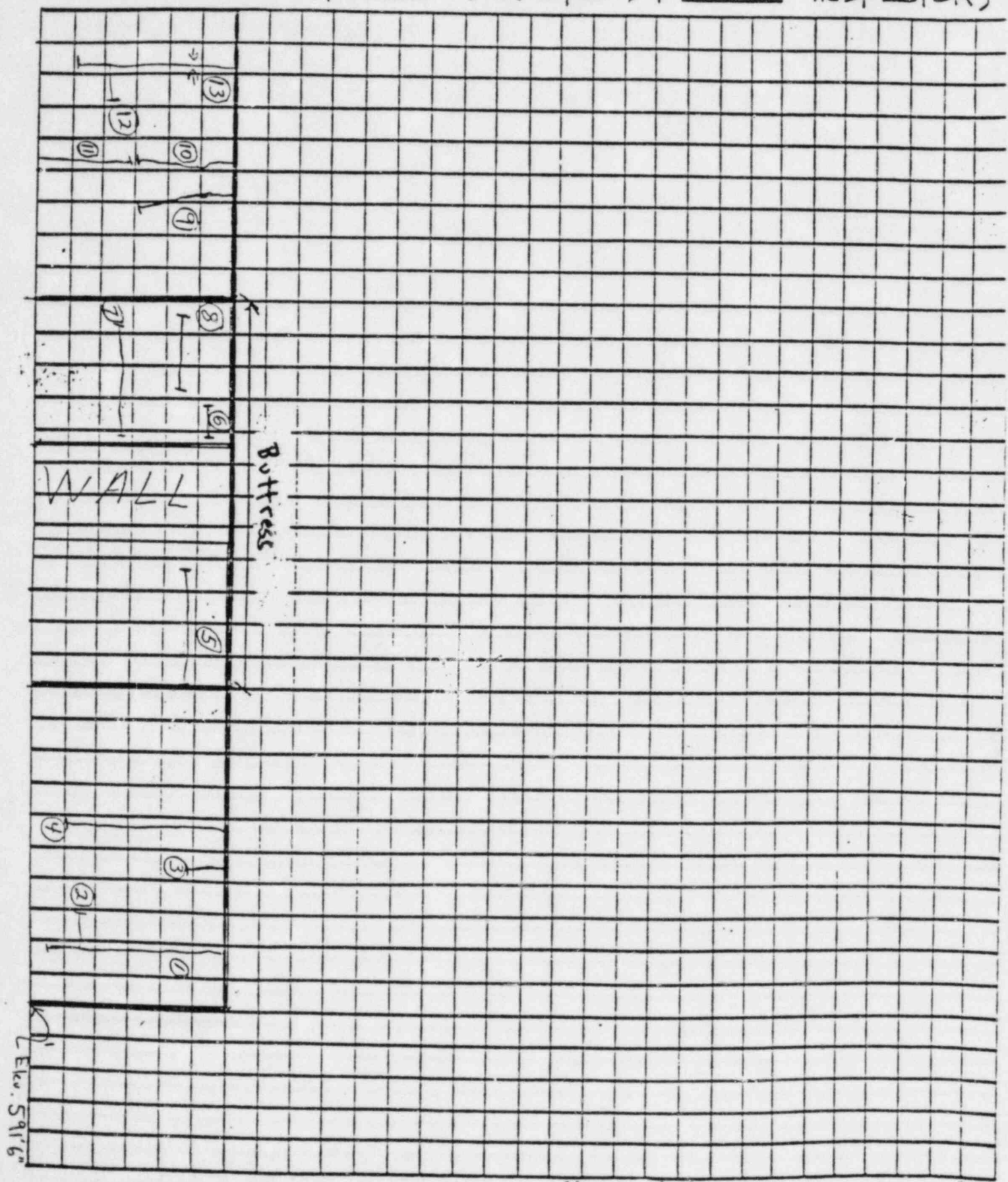

MEASURED CRACK WIDTH SUMMARY

59'6" Unit #2 East

CRACK NO.	DATE									
	C-1-1									
	7/12/83									
1	H.L.									
2	H.L.									
3	H.L.									
4	H.L.									
5	H.L.									
6	H.L.									
7	H.L.									
8	H.L.									
9	H.L.									
10	H.L.									
11	H.L.									
12	H.L.									
13	.005									



SCALE: ONE  
EQUALS ONE FOOT

# AUXILIARY BUILDING

DATE 2/11/92

ELEVATION 591' 6"  
COMPARATOR NO. C1-1  
CALIBRATION DUE DATE N/A

LOCATION Unit = 1 West  
SEQUENCE NO. 1  
SURVEYED BY SK

REVIEWED BY  
WJE (LEVEL:  
INSPECTOR)

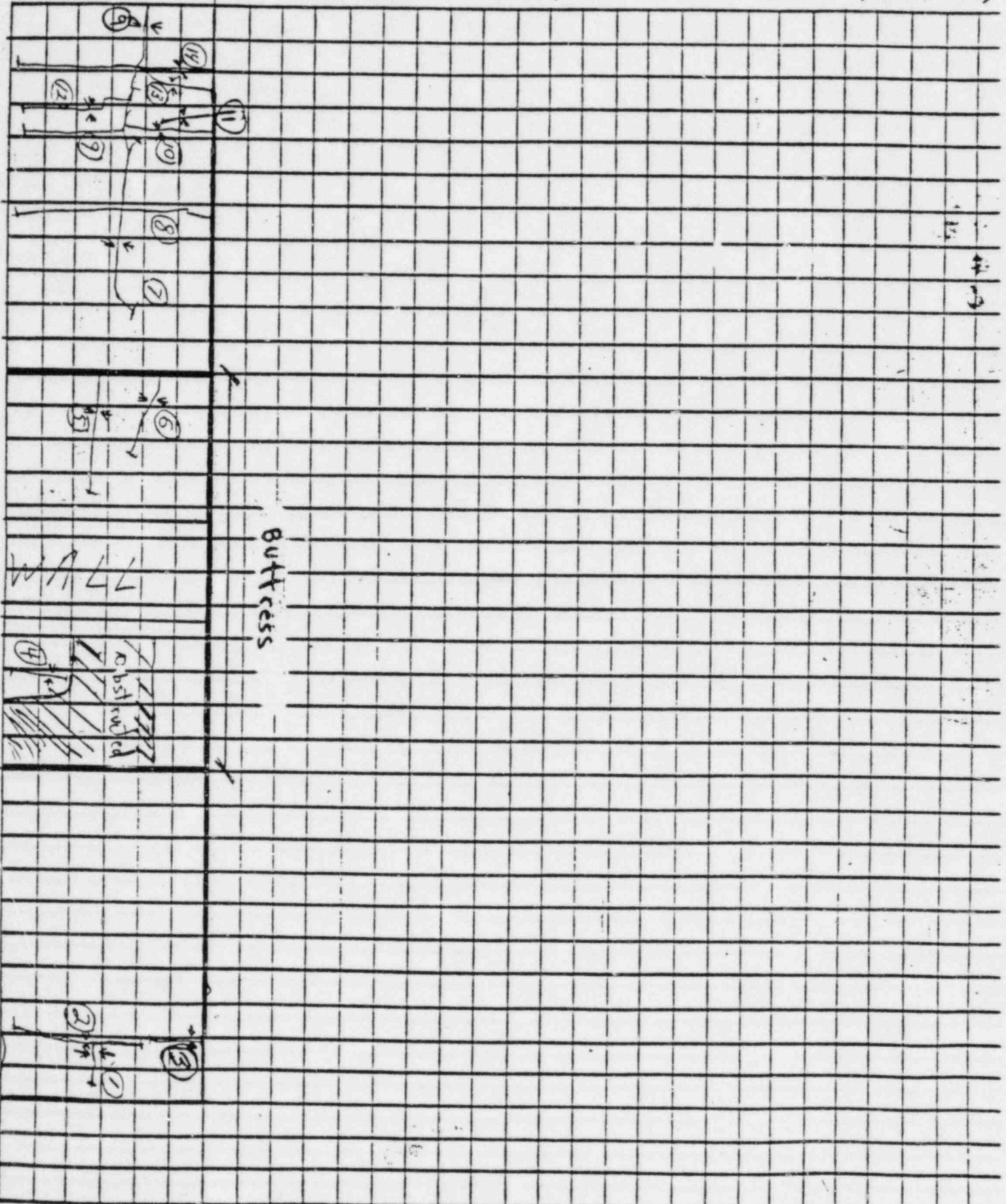

7220-C-198-2857-1

K

TABLE 43T

MEASURED CRACK WIDTH SUMMARY

5916" Unit #1 West

CRACK NO.	DATE										
	LI-1 7/11/83										
1	H.L.										
2	.005										
3	H.L.										
4	H.L.										
5	H.L.										
6	H.L.										
7	H.L.										
8	H.L.										
9	.005										
10	H.L.										
11	.005										
12	H.L.										
13	H.L.										
14	H.L.										

SCALE: ONE

EQUALS ONE FOOT

# AUXILIARY BUILDING

DATE 7-12-83

ELEVATION 591'-6"

COMPARATOR NO. C1-1

CALIBRATION DUE DATE NA

LOCATION UNIT 2 NORTH

SEQUENCE NO. 2

SURVEYED BY G28

REVIEWED BY

WJE (LEVEL INSPECTOR)

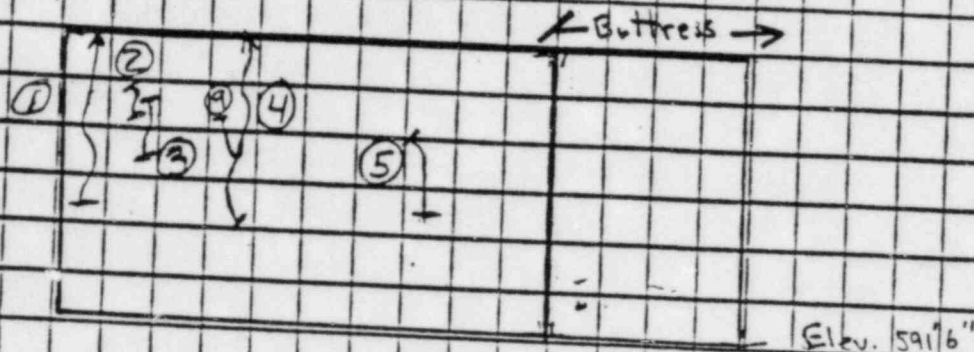

WEST  
SIDE

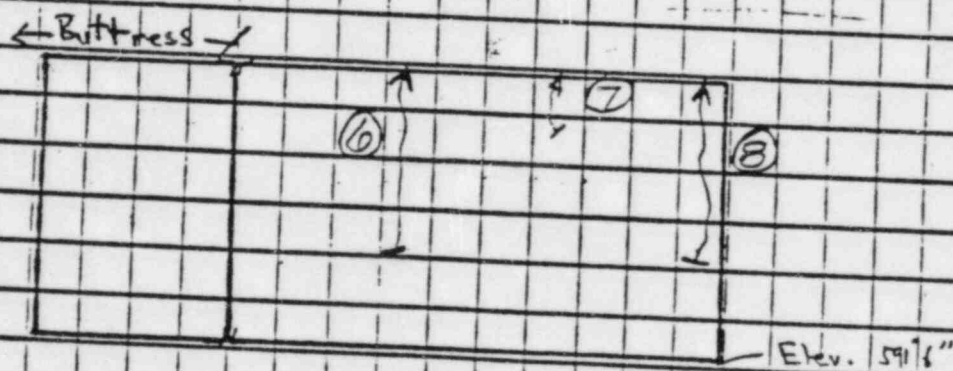

EAST  
SIDE



ALBON 2 UNIT 2 NORTH

[illegible]



SCALE: ONE  EQUALS ONE FOOT

# AUXILIARY BUILDING

DATE 7-12-8-

ELEVATION 591'-6"

COMPARATOR NO. C1-1

CALIBRATION DUE DATE NA

LOCATION UNIT 1 NORTH

SEQUENCE NO. 1

SURVEYED BY CM

REVIEWED BY

WJE (LEVEL I INSPECTOR)

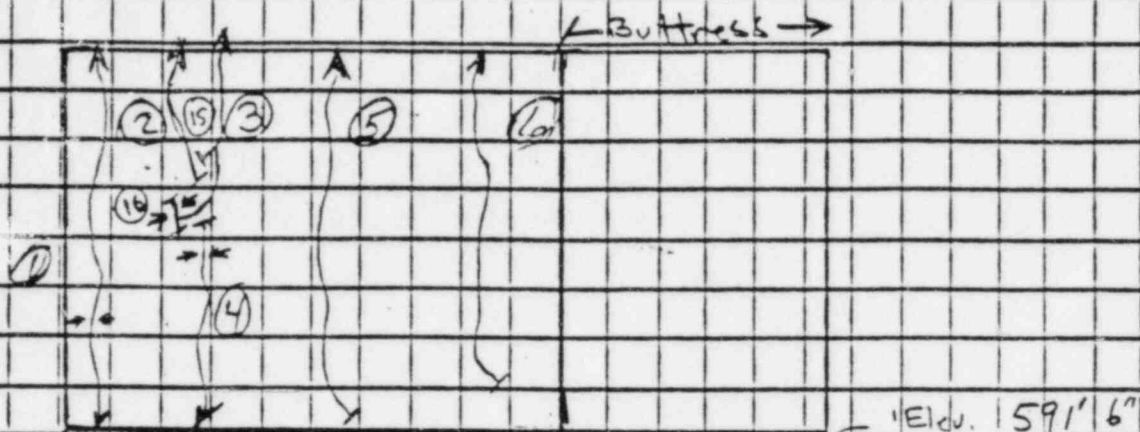

WEST  
SIDE

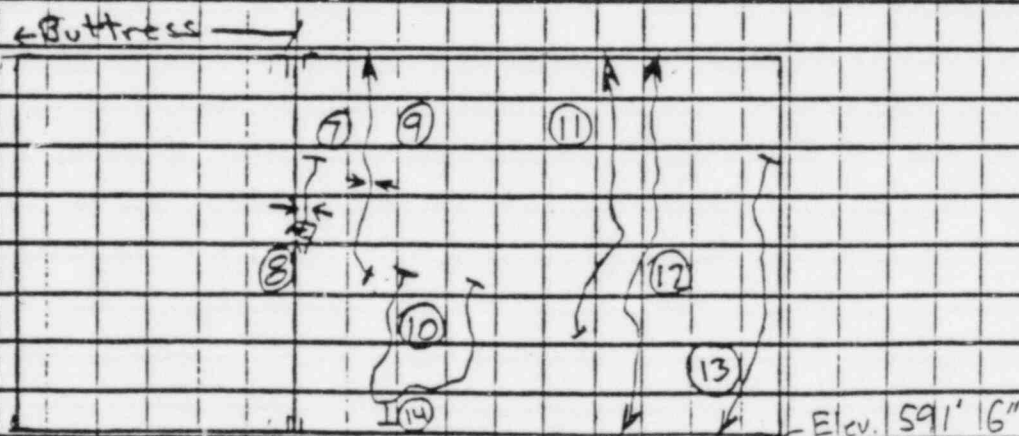

EAST  
SIDE

7220-C-198-2857-1

5

MEASURED CRACK WIDTH SUMMARY

59' 6" UNIT 1 NORTH

CRACK NO.	DATE										
		61-1									
1	7/12/83	015									
2		HL									
3		HL									
4		010									
5		HL									
6		HL									
7		010									
8		010									
9		010									
10		HL									
11		HL									
12		HL									
13		HL									
14		HL									
15		HL									
16		010									

SCALE: ONE   
EQUALS ONE FOOT

# AUXILIARY BUILDING

DATE 7-13-

ELEVATION 591'-6  
COMPARATOR NO. C2-1  
CALIBRATION DUE DATE NA

LOCATION UNIT 2 WEST  
SEQUENCE NO. 1  
SURVEYED BY CRJ

REVIEWED BY M. Brown  
WJE (LEVEL INSPECTOR)

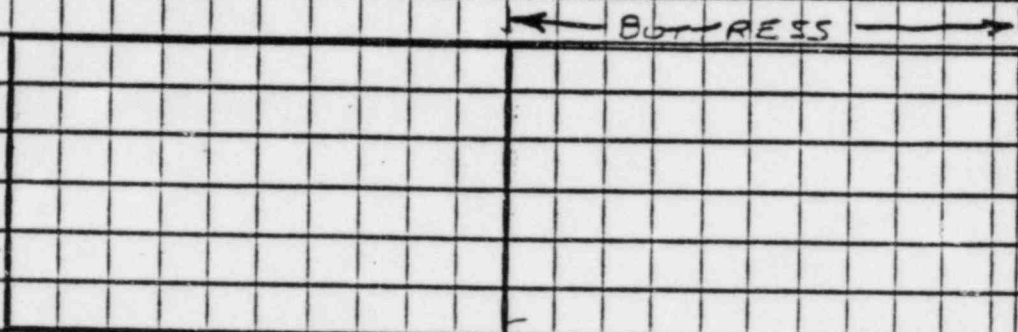

NORTH  
SIDE

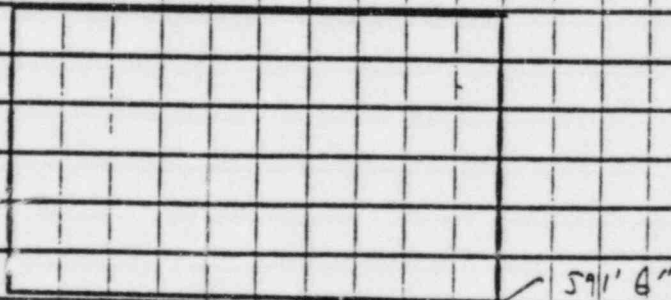

SOUTH  
SIDE

59'6" Unit #2 west

DATE \_\_\_\_\_

CRACK  
NO.

2/13/83

No cracks