

FOR WEEK OF 74-3-4
UNIT NO. 2

ST 7.8.1
Page 1 of 5, Rev 0
RJS:vc

RSF
7-8-74

PHILADELPHIA ELECTRIC COMPANY

PEACH BOTTOM UNITS 2 and 3

SURVEILLANCE TEST

ST 7.8.1 NOISE LEVEL MEASUREMENTS
ENVIRONMENTAL
TECHNICAL SPECIFICATION: 2.3 and 3.3

Test Frequency:

Four times a year until Unit 3 has been in commercial operation for one year.

Test Results:

A. All of the asterisked steps were completed SATISFACTORILY.

PERFORMED BY: Robert D. Crawford
SIGNATURE

1³⁴ 7/25/74
TIME/DATE

R. B. City
SIGNATURE (SHIFT SUPERVISION)

7-25-74
TIME/DATE

B. One or more of the asterisked steps was completed UNSATISFACTORILY.
Refer to Tech Spec 2.3 and 3.3.
Environmental

MRF _____

SIGNATURE

TIME/DATE

SIGNATURE (SHIFT SUPERVISION)

TIME/DATE

IMMEDIATELY NOTIFY PLANT SUPERINTENDENT OR ALTERNATE.

NAME OF PERSON NOTIFIED

TIME/DATE

SIGNATURE OF SHIFT SUPERINTENDENT OR SUPERVISOR

Additional action required if other portions of test did not function properly or other discrepancies were noted during test.

1. MRF submitted: MRF _____
2. Others: _____

SIGNATURE

DATE

REVIEWED BY: *[Signature]*

PLANT STAFF SUPERVISION

7/25/74
DATE

See previous test results; refer to test results to PDC

PURPOSE:

To determine the noise levels at the site boundary.

REFERENCES:

Environment Technical Specifications.

PREREQUISITES:

1. Unit (or Units) operating at full power. 64.9%
2. Three cooling towers in service. ✓
3. North Substation operating normally. ✓

TEST EQUIPMENT REQUIRED:

Sound level meter which meets the requirements of ANSI Standard S 1.4-1971, "Sound Level Meters".

PROCEDURE:

1. At the locations shown on Figures ST 7.8.1-1 and ST 7.8.1-2, measure the sound level. ✓
2. Record the readings on Data Sheet ST 7.8.1-1. ✓
3. The sound levels measured should be equal to or less than the limit shown. ✓
4. Inform Shift Supervision of the results of this test, and fill out the TEST RESULTS Section on the front page of this procedure. ✓

THIS COMPLETES THE NOISE LEVEL MEASUREMENT TEST.

DATA SHEET ST 7.8.1-1
NOISE LEVEL MEASUREMENTS

MARKER	LOCATION	READING	UNIT
A ¹	1800 feet south of "C" Cooling Tower, between discharge structure and "C" Cooling Tower.	45	45 dB(A)
A ²	South of "C" Cooling Tower, near discharge structure.	43	45 dB(A)
B	North-west of North Substation. 500 feet west of #3 start-up transformers.	45	60 dB(A)

LOCATION OF NOISE LEVEL MONUMENTS

FIGURE ST 7.8.1-1
Page 4 of 5, Rev 0

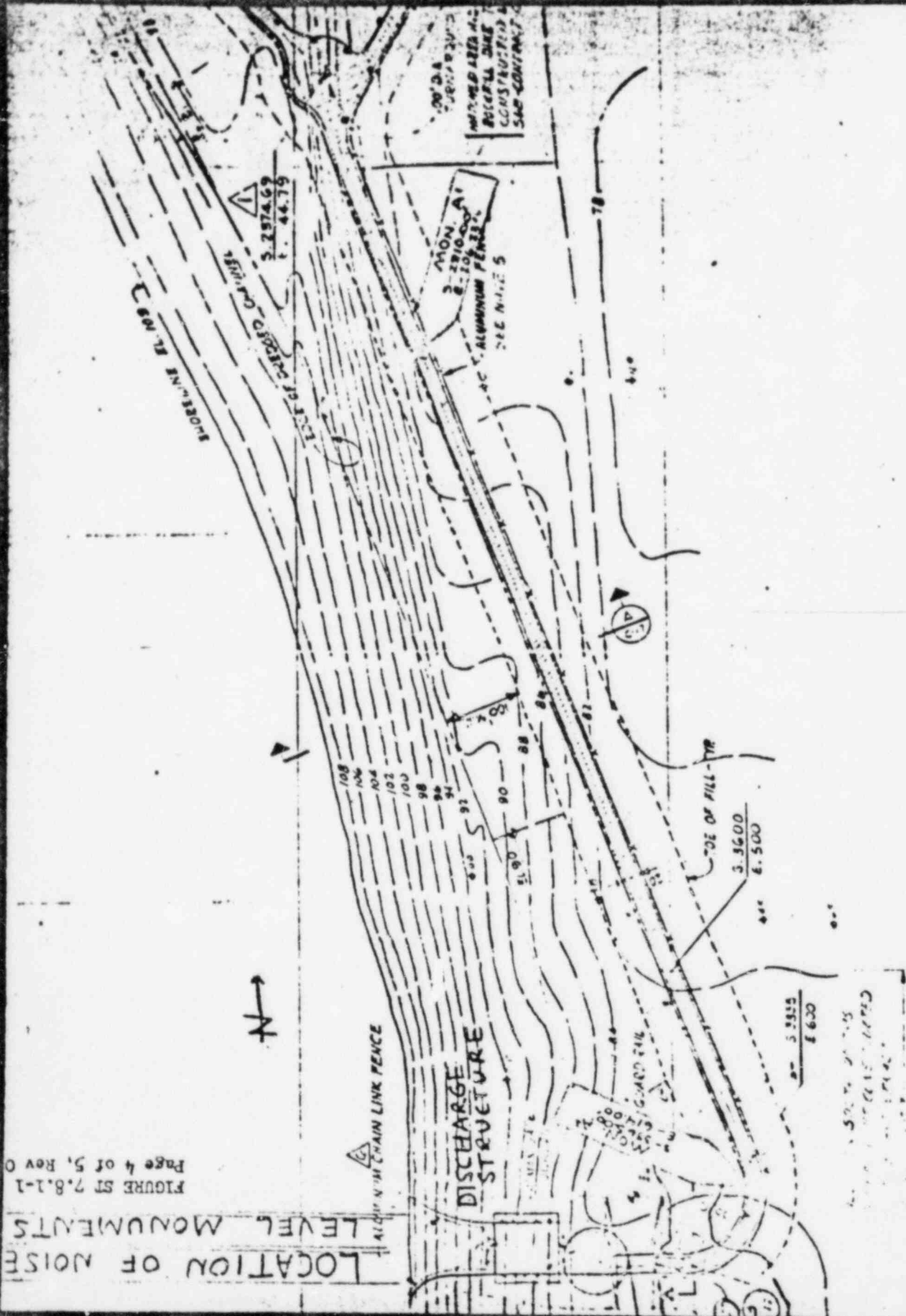

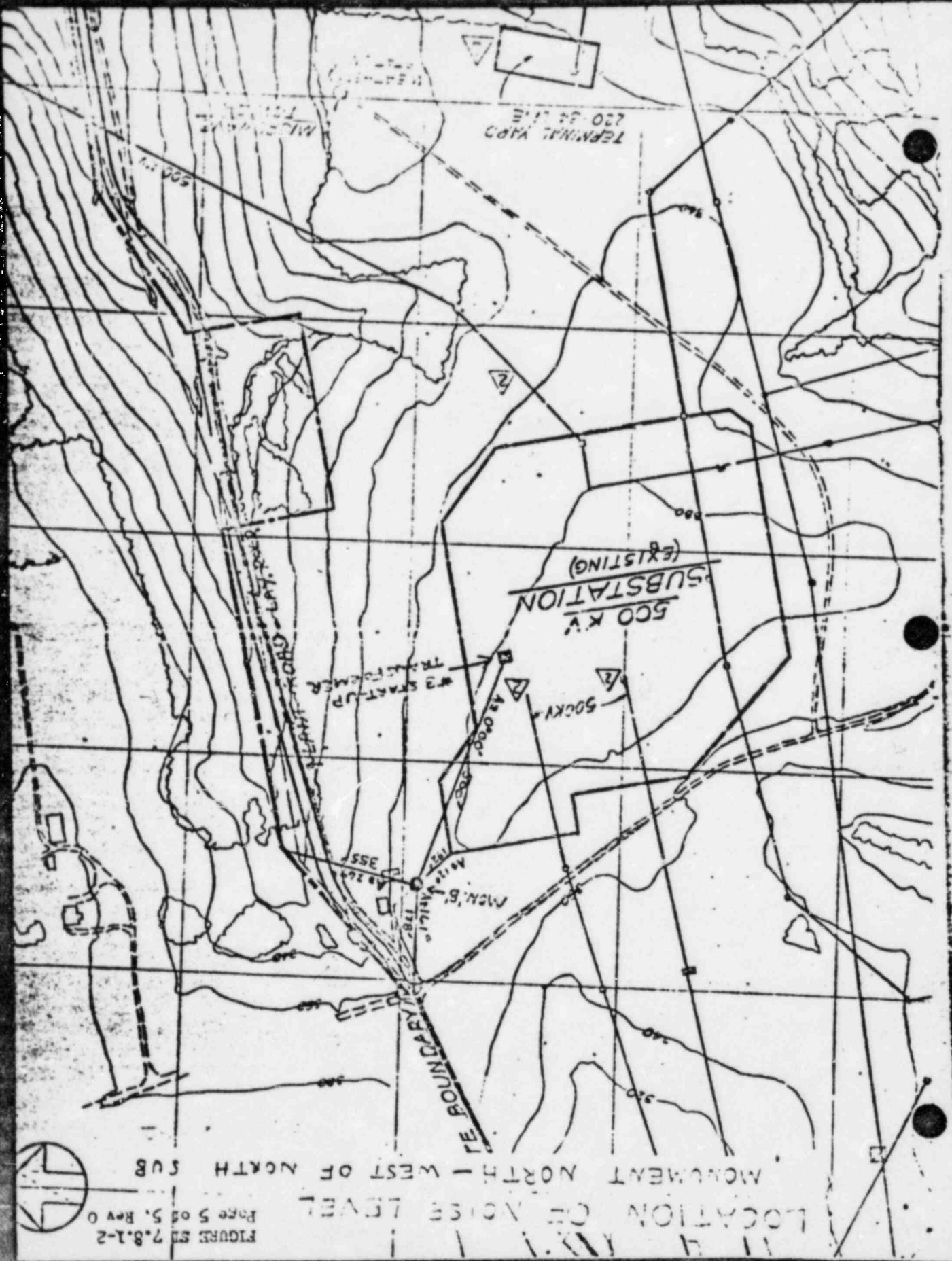

LOCATION OF NOISE LEVEL
 MONUMENT NORTH - WEST OF NORTH SUB
 FIGURE 5.8.1-2
 Page 5 of 5, Rev 0