



50-289
F

METROPOLITAN EDISON COMPANY

POST OFFICE BOX 542 READING, PENNSYLVANIA 19603

TELEPHONE 215 - 929-3601

December 1, 1978
GQL 1919

Director of Nuclear Reactor Regulation
Attn: R. W. Reid, Chief
Operating Reactors Branch No. 4
U. S. Nuclear Regulatory Commission
Washington, D. C. 20555

Dear Sir:

Three Mile Island Nuclear Station, Unit 1 (TMI-1)
Operating License No. DPR-50
Doc'et No. 50-289
Fire Protection Program-Fire Doors

In response to Item 3.1.8 of the Fire Protection Safety Evaluation Report (FPSEER) of September 19, 1978 and Met-Ed's letter of September 29, 1978 (GQL 1585), a documentation search to determine the fire rating of all the TMI-1 Fire Hazards Analysis fire doors, including the doors previously addressed, has been completed. Attached are six copies of applicable Fire Hazards Analysis Drawings marked to show the location of the doors discussed below.

Met-Ed has evaluated the results of the search and proposes the following action for those Fire Hazards Analysis fire doors which do not carry a UL A label or for which sufficient documentation does not exist to verify their fire rating:

Doors and frames C-403 and C-423 are being replaced with bullet-resisting doors as part of the security program. These doors will be of A label construction.

Doors and frames C-131, C-415, C-418 and S-157 will be replaced with assemblies bearing the UL A label.

The frames for doors C-207, C-304, C-307, C-312 and I-101 will be replaced, but the doors and hardware will be reused. The doors are fabricated in accordance with A label requirements. However, the doors are oversized and therefore were not subjected to the standard fire tests required for label attachment.

Met-Ed proposes to leave the following doors in place as is: C-205, C-206, C-303, C-404, C-503, C-202, C-204, D-108, C-306 and C-124.

Doors C-205, C-206, C-303, C-404 and C-503 are listed on the Gilberts Associates, Inc. (GAI) drawings, the manufacturer's shop drawings, and purchase order documentation as UL B label doors and frames. The B label is considered adequate for these locations consistent with Fire Protection Handbook (14th Edition, Section 6, Chapter 8), published by the National Fire Protection Association.

7812030108

SEND CYS
CHARTS OF FULL SIZE
TO PLANT STS
A006
5/16

December 1, 1978
GQL 1919

The doors and frames for C-202, C-204, and D-108 are described on the relevant documentation as UL A label construction. Doors C-202 and C-204 are oversized doors and could not be tested as mentioned above.

Door C-306 is an oversized double door assembly in a three-hour rated metal fire wall. The frame is tack welded to the jamb and head channels and anchored through the door stop into the jamb channels by bolting. In addition, the jamb and head channels are covered by fireproofing materials. It is Met-Ed's opinion that removing the frame, and the resulting damage to the rated metal fire wall, would result in a fire barrier less effective than what presently exists.

Door C-124 is a rolling steel door constructed in accordance with UL A label requirements. It does not carry a label because of its size and because of a wicket installed in the door.

For the fire doors not discussed herein, labels are attached or the documentation is available to verify the rating of the doors. Met-Ed requests your expeditious review and concurrence on the above action so that the necessary modifications may proceed.

Sincerely,



J. G. Herbein

Vice President-Generation

JGH:WSS:tas

Attachment - Six copies

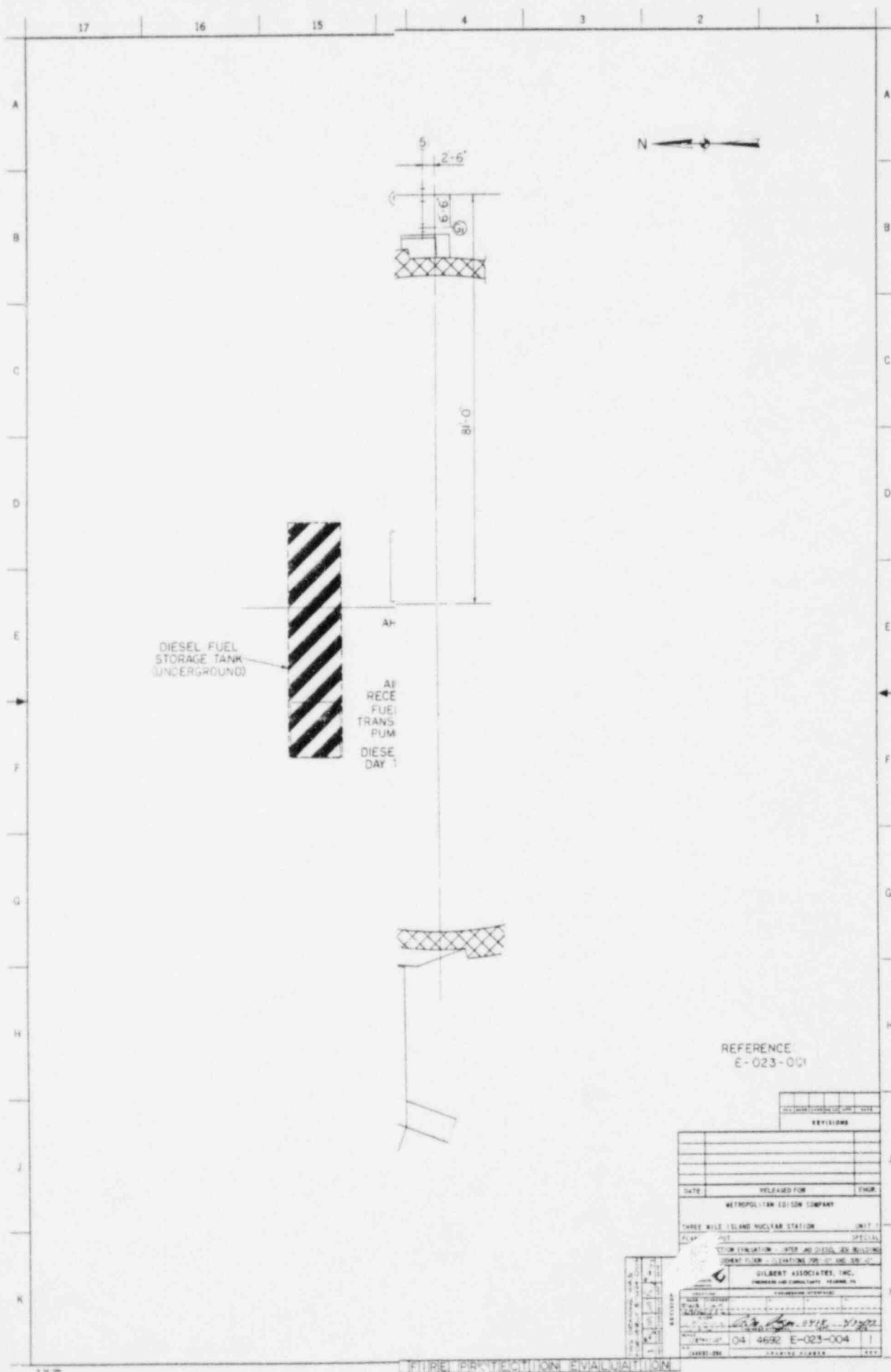

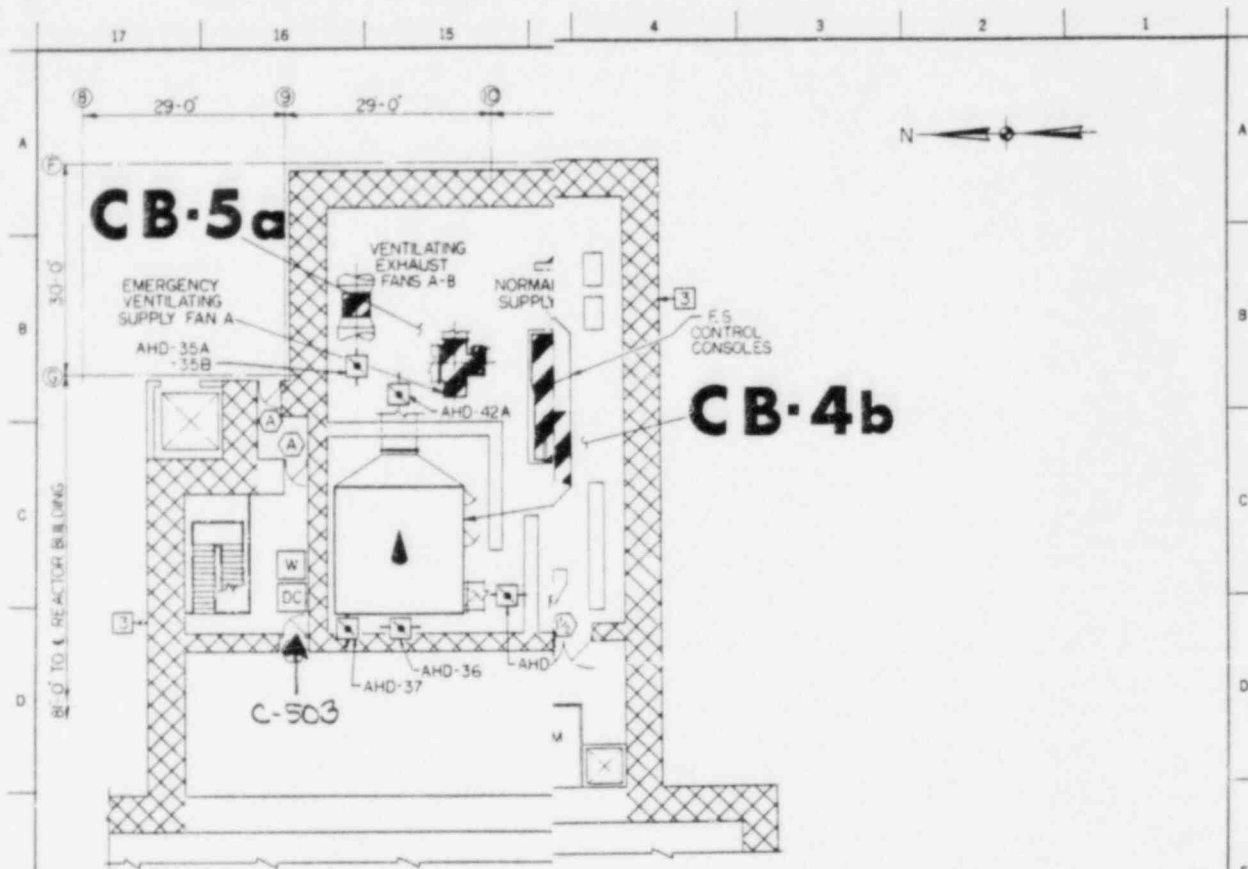

PLAN

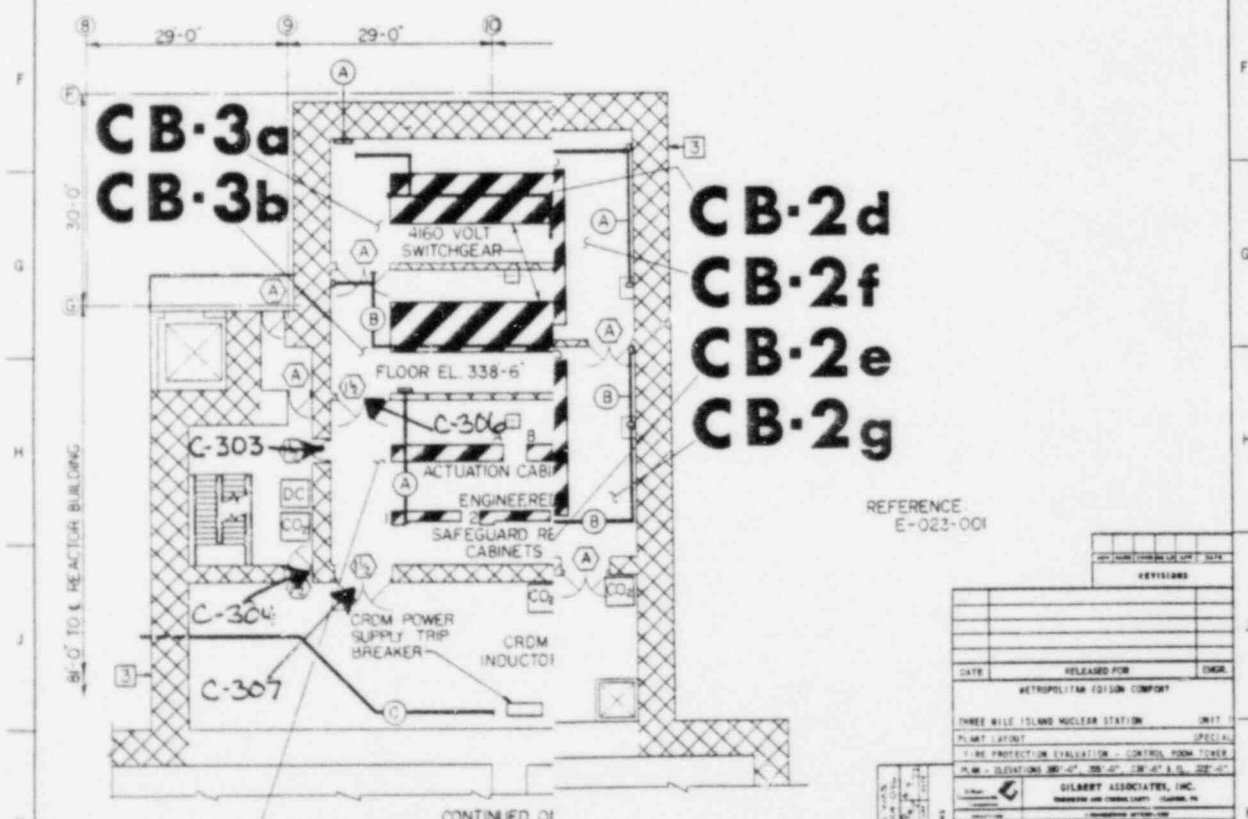

CONTINUED OF

CB-3c

PL

REFERENCE
E-023-001

REVISIONS	
DATE	RELEASED FOR
METROPOLITAN EDISON COMPANY	
THREE ISLAND NUCLEAR STATION UNIT 1	
PLANT LAYOUT SPECIAL	
FIRE PROTECTION EVALUATION - CONTROL ROOM TOWER	
PLM - ELEVATIONS 300'-0" TO 338'-6" 338'-6" TO 350'-0" 350'-0" TO 360'-0"	
GILBERT ASSOCIATES, INC.	
ENGINEERING AND CONSULTING COMPANY	
14000 4th Ave. N. #200	
MINNETONKA, MN 55345	
DATE	BY
04/69	4692 E-023-016
14000 4th Ave. N. #200	MINNETONKA, MN 55345

