



Commonwealth Edison
One First National Plaza, Chicago, Illinois
Address: Reply to: Post Office Box 767
Chicago, Illinois 60690

May 13, 1982

PRINCIPAL STAFF			
D/E		F&IS	
D/D		PAO	
A/D		ELQ	
DR&PI			
DE&TI			
DEP&OS		File	

Mr. James G. Keppler, Regional Administrator
Directorate of Inspection and
Enforcement - Region III
U.S. Nuclear Regulatory Commission
799 Roosevelt Road
Glen Ellyn, IL 60137

Subject: Braidwood Station Units 1 and 2
HVAC Supports
NRC Docket Nos. 50-456 and 50-457

References (a): March 12, 1982, letter from
T. R. Tramm to J. G. Keppler.

(b): April 2, 1982, letter from
T. R. Tramm to J. G. Keppler.

Dear Mr. Keppler:

This is to provide additional information regarding deficiencies in Pullman HVAC duct supports and stiffeners which were reported on February 11 and 18, 1982, and were discussed in references (a) and (b). This report is submitted pursuant to 10 CFR 50.55(e) for Braidwood deficiency 82-01.

Description of Deficiency

HVAC duct supports and stiffeners fabricated by Pullman Construction Industries have been supplied to Braidwood with inadequate weld deposition at corner connections. The enclosed sketch shows the weld details as specified on the Sargent and Lundy design drawings. The fabricator misread the AWS weld symbols and welded only the arrow side instead of all around.

Safety Implications

Structural failures of HVAC duct work could keep safety equipment from being properly cooled and could affect long-term performance of that equipment. Falling ducts could also cause direct damage to safety equipment. Considerable redundancy and safety margins exist at Braidwood, however, and a case-by-case analysis would be required to accurately characterize the specific safety implications of this deficiency.

8205240532 820513
PDR ADOCK 05000456
S PDR

MAY 17 1982

IE 27:10

May 13, 1982

Corrective Action

The adequacy of the existing duct and duct supports is being evaluated on a case-by-case basis. Welds determined to be inadequate will be repaired to restore the design basis margins. The evaluation will be completed by July 15, 1982.

The fabricator has been instructed to perform all future welding in accordance with the design drawings.

Please address questions regarding this matter to this office.

Very truly yours,

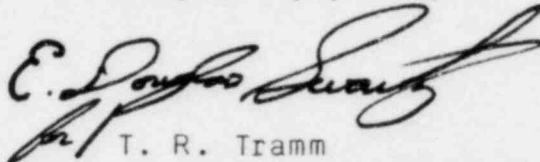
A handwritten signature in dark ink, appearing to read 'T. R. Tramm', is written over the typed name.

T. R. Tramm
Nuclear Licensing Administrator

lm

cc: Director of Inspection & Enforcement

4104N

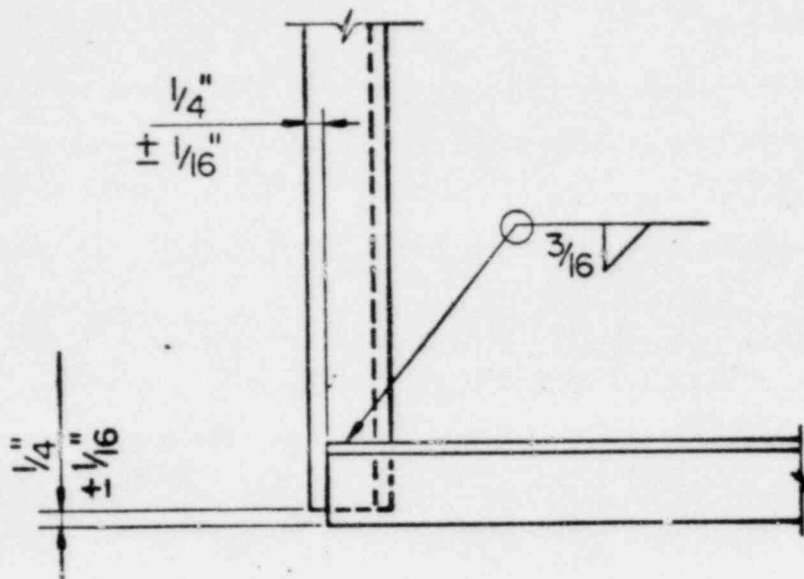

TYPICAL CORNER
HANGER CONNECTION

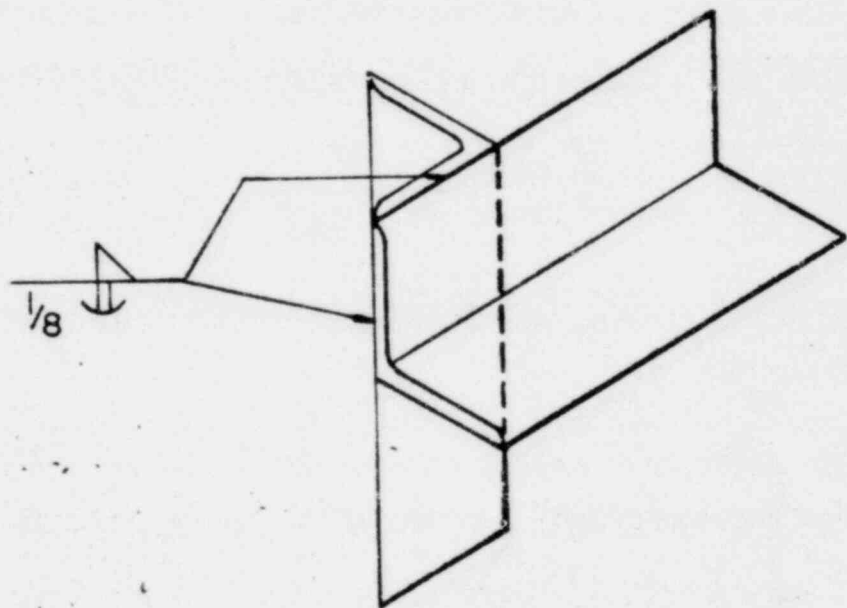

TYPICAL CORNER
STIFFENER CONNECTIONS