



52-001

GE Nuclear Energy

ABWR

Date 5/3/93

Fax No. —

To

1143

Chet Poslusny

This page plus 4 page(s)

From

Jack Fox

Mail Code 782

175 Curtner Avenue
San Jose, CA 95125

Phone

(408) 925-4824

FAX

(408) 925-1193
or (408) 925-1687

Subject

Containment Overpressure
Protection

Message

Call Bernie on my number.

Drawing (in quarters) attached
lead discussion.

Call 1 pm your time on 5/4/93

*2222 o/c
See attached
distribution*

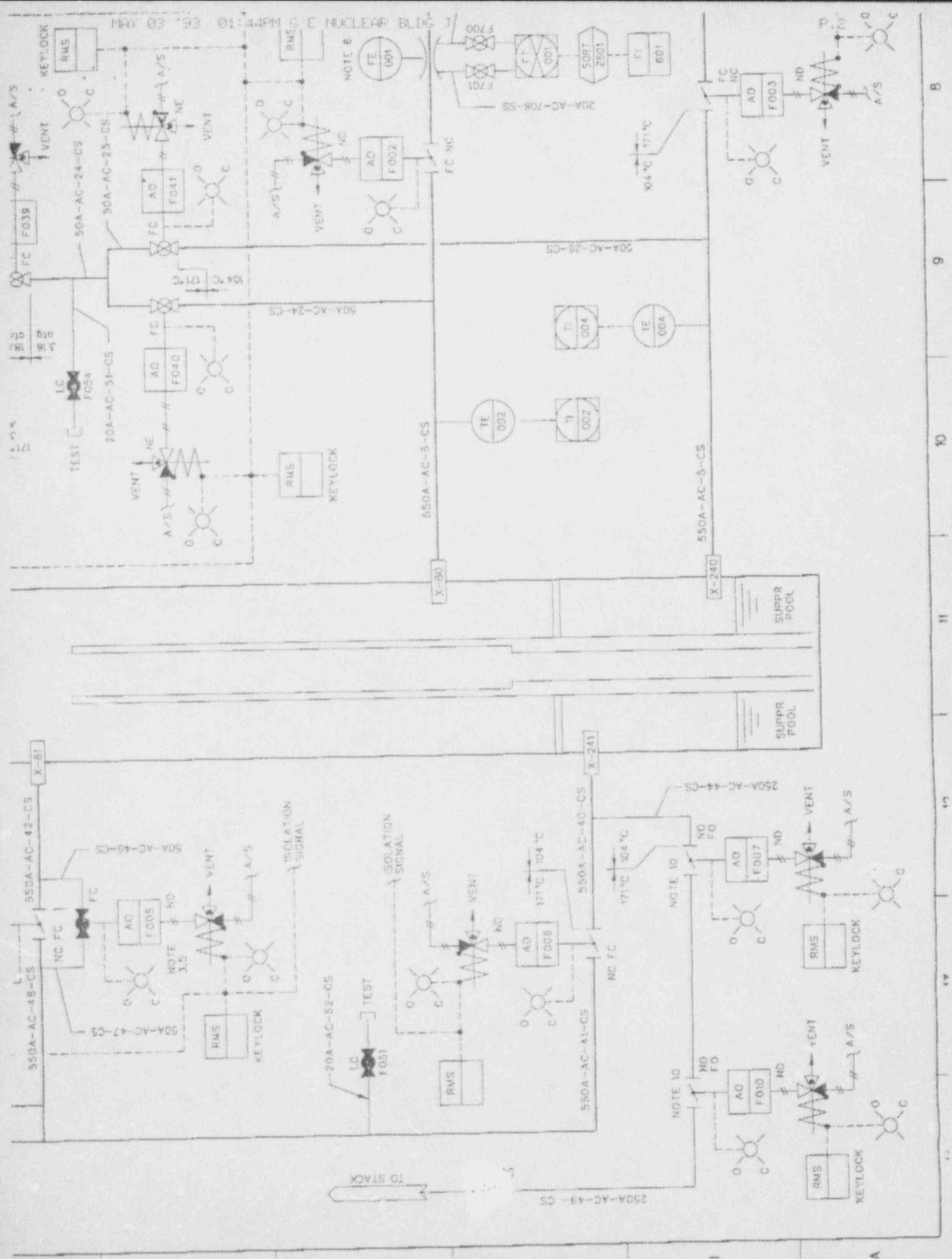

INSTRUMENT PIPING CONNECTED TO SUPPRESSION POOL	3.16 kg/cm ² g	104 °C	SS
TEST TAP			
UPSTREAM OF VALVE	3.16 kg/cm ² g	171 °C	CS
DOWNSTREAM OF VALVE	3.16 kg/cm ² g	55 °C	CS

9. SUPPRESSION POOL WATER TEMPERATURE MONITORING IS PROVIDED BY SPTM SYSTEM, REF 6.
10. THESE VALVES ARE NOT PROVIDED WITH AN ISOLATION SIGNAL CONTROL SWITCHES SHOULD BE LOCKED OPEN.

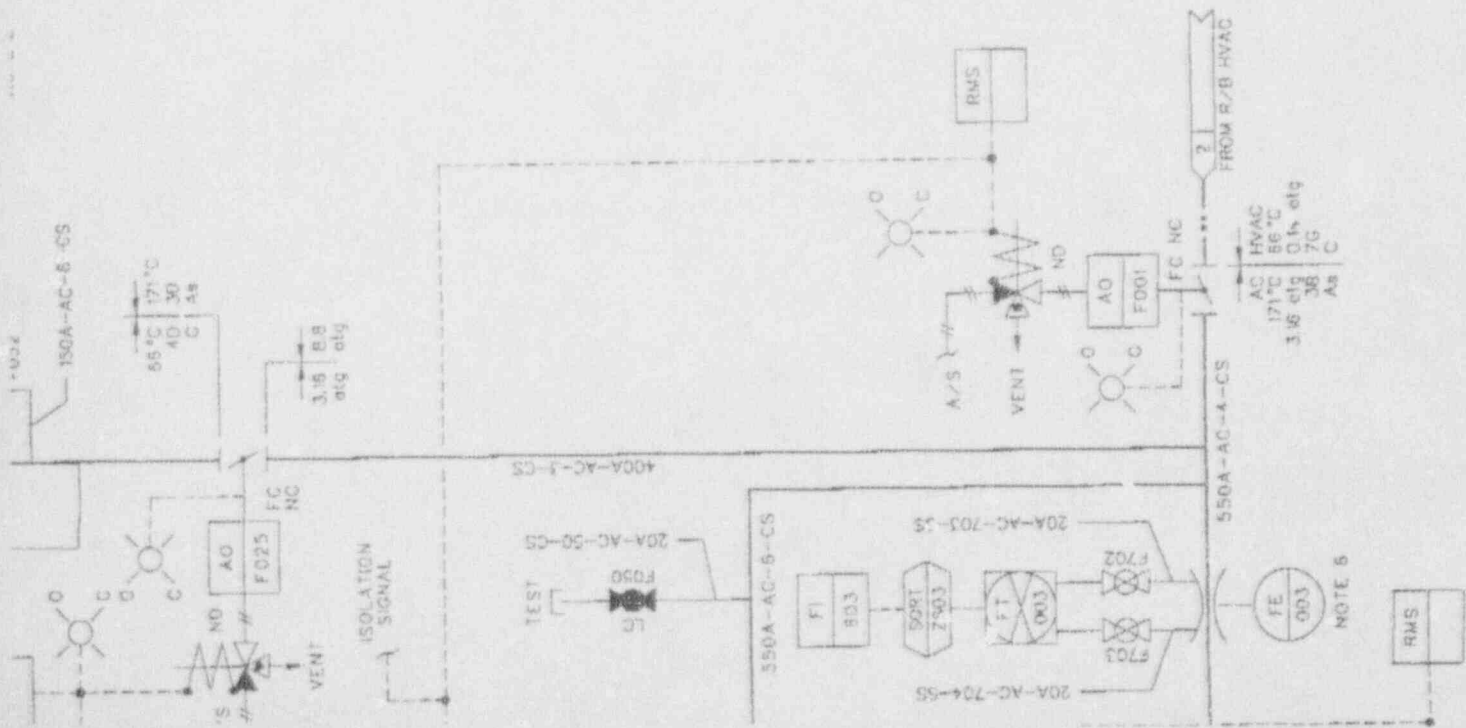

- REFERENCE DOCUMENTS:
1. PIPING AND INSTRUMENT SYMBOLS DIAGRAM A30-3030
 2. HVAC SYSTEM P&ID U41-1010
 3. STANDBY GAS TREATMENT SYSTEM P&ID T22-1010
 4. HIGH PRESS. NITROGEN GAS SUPPLY SYS P&ID P54-1010
 5. NUCLEAR BOILER SYSTEM P&ID B27-1010
 6. SUPPR POOL WATER TEMP MONITORING SYS L.D T53-1010
 7. DRYWELL COOLING SYSTEM T41-1010
 8. REMOTE SHUTDOWN SYSTEM IED C61-1010
 9. HIGH PRESSURE CORE FLOODER SYS P&ID E22-1010
 10. REACTOR CORE ISOLATION COOLING SYS P&ID E51-1010
 11. SUPPRESSION POOL CLEANUP SYSTEM P&ID G51-1010
 12. HOUSE BOILER SYS P&ID P82-1010

MPL NO. T31-1010

EQUIPMENT CLASS CODE		SAFETY RELATED THIS ITEM IS OR CONTAINS A SAFETY RELATED ITEM YES NO		IEEE CLASS IE NUCLEAR SAFETY RELATED YES NO	
SIGNATURES		DATE		TIME	
W.B. TORRES		14		01	
W.B. TORRES		28		1	
R.J. ARMAN		30		1	
G.W. FITZSIMMONS		30		1	
APPROVED		DATE		TIME	
UNLESS OTHERWISE SPECIFIED		31		JAN 1992	
TOLERANCES ON		FRACTIONS		DECIMALS	
2 PLACE DECIMALS		1		2	
3 PLACE DECIMALS		1		2	
APPROVED		DATE		TIME	
31		JAN 1992		1	
107E6043		C		1	
107E6043		C		1	
107E6043		C		1	

< TRANSACTION REPORT >

05-03-1993(MON) 16:41

[RECEIVE]

NO.	DATE	TIME	DESTINATION STATION	PG.	DURATION	MODE	RESULT
12038	5-03	16:38	408 925 1687	5	0° 02' 31"	NORM.E	OK
				5	0° 02' 31"		