



# SONGS MESA



# SONGS RADIOLOGICAL SURVEY



DATE 06 / 02 / 2014

TIME 1210

Page 1 of 1

UNIT	N	SURVEY REASON <input type="checkbox"/> Routine <input type="checkbox"/> Job Coverage <input type="checkbox"/> Pwr Entry ____ % <input type="checkbox"/> Post-Decon <input type="checkbox"/> Shipment/Receipt <input type="checkbox"/> Source/Leak Test <input checked="" type="checkbox"/> Other Confirmatory Surveys	<input type="checkbox"/> Pre-Job
AREA	YD		
ELEV	N/A		
ROOM	G-21		

SURVEY NO.	<u>190602-003</u>
MO NO.	<u>N/A</u>
REP NO.	
EQUIP. ID.	

SMEARS						MASSLINNS	
NO.	$\beta$ - $\gamma$	$\alpha$	NO.	$\beta$ - $\gamma$	$\alpha$	NO.	Gross dpm
1	<1K	N/A	16	<1K	N/A	A	N/A
2			17			B	
3			18			C	
4			19			D	
5			20	<1K		E	
6			21	N/A		F	
7			22				
8			23				
9			24				
10			25				
11							
12							
13							
14							
15	<1K	N/A		N/A	N/A		N/A

SURVEY CLASS	<input type="checkbox"/> Trend Pt.	<input type="checkbox"/> Component
<input type="checkbox"/> Boundary	<input checked="" type="checkbox"/> General Area	<input type="checkbox"/> Individual

SURVEY DESCRIPTION: Mesa Confirmatory Surveys

REMARKS: All accessible floor area scanned using the floor monitors. All survey points consist of direct frisk readings and 100cm<sup>2</sup> smears. No floor drains present in the building.

## Instruments used

Model	FLM3B	FLM3B	2-1	N/A	N/A
Serial No.	01	02	271981		

## TECHNICIAN

Print J. Papson/M. Crumes

Sign *[Signature]*

## APPROVED BY

Print *[Signature]*

Sign *[Signature]*

Approval Date: 6-25-14 Time: 1130

## SURVEY TYPE

☐ Shutdown (S/D)

Reference Number  
SO123-VII-20.9

## Form Number

SCE HP (2/3) 1259-1000  
REV. 3 09/07

MESA- G21 WELDING/RIGGING BUILDING

Floor Monitor BKG.=38 cps  
2-1 BKG.= 80cpm  
Denotes floor area scanned

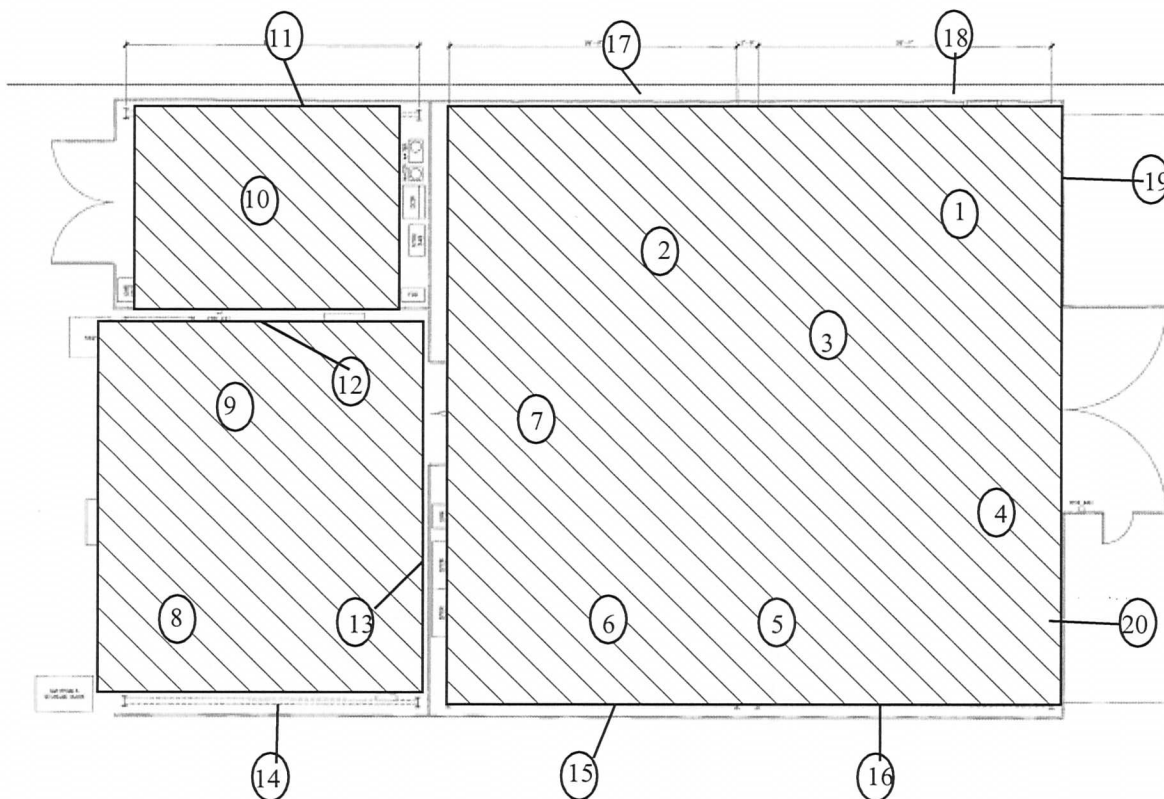

No detectable activity above BKG. during floor scans.

Survey points 1-10 were taken on the floor and 11-20 on the interior walls, no detectable counts above BKG.