

THREE MILE ISLAND NUCLEAR STATION STATION ADMINISTRATIVE PROCEDURE #1028 OPERATOR AT THE CONTROLS

Table of Effective Pages

Page	Date	Revision	Page	Date	Revision	Page	Date	Revision
1.0	05/05/77	0	26.0			51.0		
2.0	05/05/77	0	27.0			52.0		
3.0	05/05/77	0	28.0			53.0		
4.0	05/05/77	0	29.0			54.0		
5.0	05/05/77	0	30.0			55.0		
6.0	05/05/77	0	31.0			56.0		
7.0	05/05/77	0	32.0			57.0		
8.0			33.0			58.0		
9.0			34.0			59.0		
10.0			35.0			60.0		
11.0			36.0			61.0		
12.0			37.0			62.0		
13.0			38.0			63.0		
14.0			39.0			64.0		
15.0			40.0			65.0		
16.0			41.0			66.0		
17.0			42.0			67.0		
18.0			43.0			68.0		
19.0			44.0			69.0		
20.0			45.0			70.0		
21.0			46.0			71.0		
22.0			47.0			72.0		
23.0			48.0			73.0		
24.0			49.0			74.0		
25.0			50.0			75.0		

CHANGE

Unit 1 Staff Recommends Approval

Approval N/A Date _____
Cognizant Dept. Head

Unit 2 Staff Recommends Approval

Approval N/A Date _____
Cognizant Dept. Head

Unit 1 PORC Recommends Approval

J.P. O'Hanlon Date 5-3-77
Chairman of PORC

PORC comments of _____ included
(date)

By _____ Date _____

Unit 2 PORC Recommends Approval

J.L. Stealing Date 5/3/77
Chairman of PORC

PORC comments of _____ included
(date)

By _____ Date _____

Approval J.P. O'Hanlon Date 5-5-77/14/77

Station Superintendent
Unit Superintendent

1122 302

79101 00

TMI-55-A 11-74

P

THREE MILE ISLAND NUCLEAR STATION
STATION ADMINISTRATIVE PROCEDURE #1028
OPERATOR AT THE CONTROLS

Table of Contents

- 1.0 GENERAL
 - 1.1 Purpose
 - 1.2 Scope
 - 1.3 References
- 2.0 RESPONSIBILITIES
 - 2.1 Supervisor of Operations
 - 2.2 Shift Supervisor/Shift Foremen
 - 2.3 Control Room Operator
 - 2.4 Supervisor - Quality Control
- 3.0 REQUIREMENTS
- 4.0 ENCLOSURES
 - 4.1 Enclosure I
 - 4.2 Enclosure II

1122 303

THREE MILE ISLAND NUCLEAR STATION
STATION ADMINISTRATIVE PROCEDURE #1028
Operator at the Controls

1.0 GENERAL

1.1 Purpose

This procedure establishes the requirements to define areas in the Control Room for the "operator at the controls". This procedure is intended to meet the requirements of Reg. Guide 1.114 (Guidance on Being Operator at the Controls of a Nuclear Power Plant).

1.2 Scope

This procedure describes the areas for the Control Room Operator who is at the controls during normal and emergency operation.

1.3 Reference

- a) U.S.N.R.C. Regulatory Guide 1.114.
- b) 10 CFR Part 50.54K

2.0 RESPONSIBILITIES

2.1 The Supervisor of Operations is responsible for overall implementation of this procedure.

2.2 Shift Supervisor/Shift Foreman

The Shift Supervisor/Shift Foreman shall be directly responsible for the Control Room Operator meeting the requirements of this procedure.

2.3 Control Room Operator

The Control Room Operator shall be responsible for adhering to the work area requirements as defined by this procedure.

2.4 Supervisor - Quality Control

The Supervisor - Quality Control shall be responsible for the surveillance and compliance of the subject procedure.

3.0 REQUIREMENTS

3.1 Routine Operations

The operator at the controls should not normally leave the area as defined by Enclosure I where continuous attention can be given to reactor operating conditions.

3.2 Non-Routine Operations

The operator at the controls may briefly enter the area as defined by Enclosure II in order to verify receipt of an annunciator alarm, investigate parameters relating to abnormal or suspected abnormal conditions or initiate corrective action in the event of an emergency affecting the safety of operations.

3.3 The operator at the controls should not under any circumstances leave the areas defined by Enclosure I and II without obtaining a qualified relief operator at the controls. (Refer to Tech. Spec. Section 6.0).

1122 305

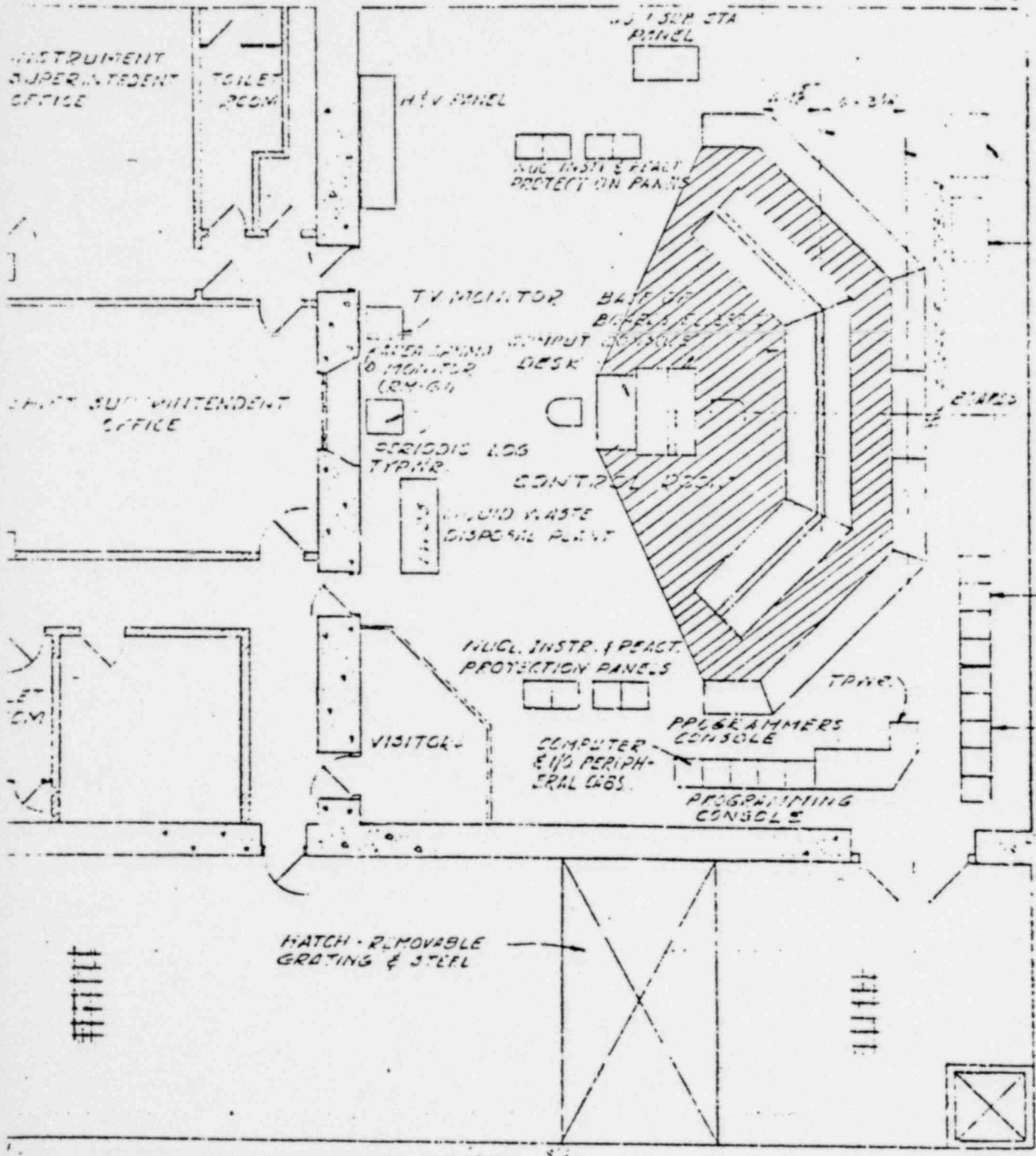

ENCLOSURE I

UNIT I
4.0

POOR ORIGINAL

1028
Revision 0
05/05/77

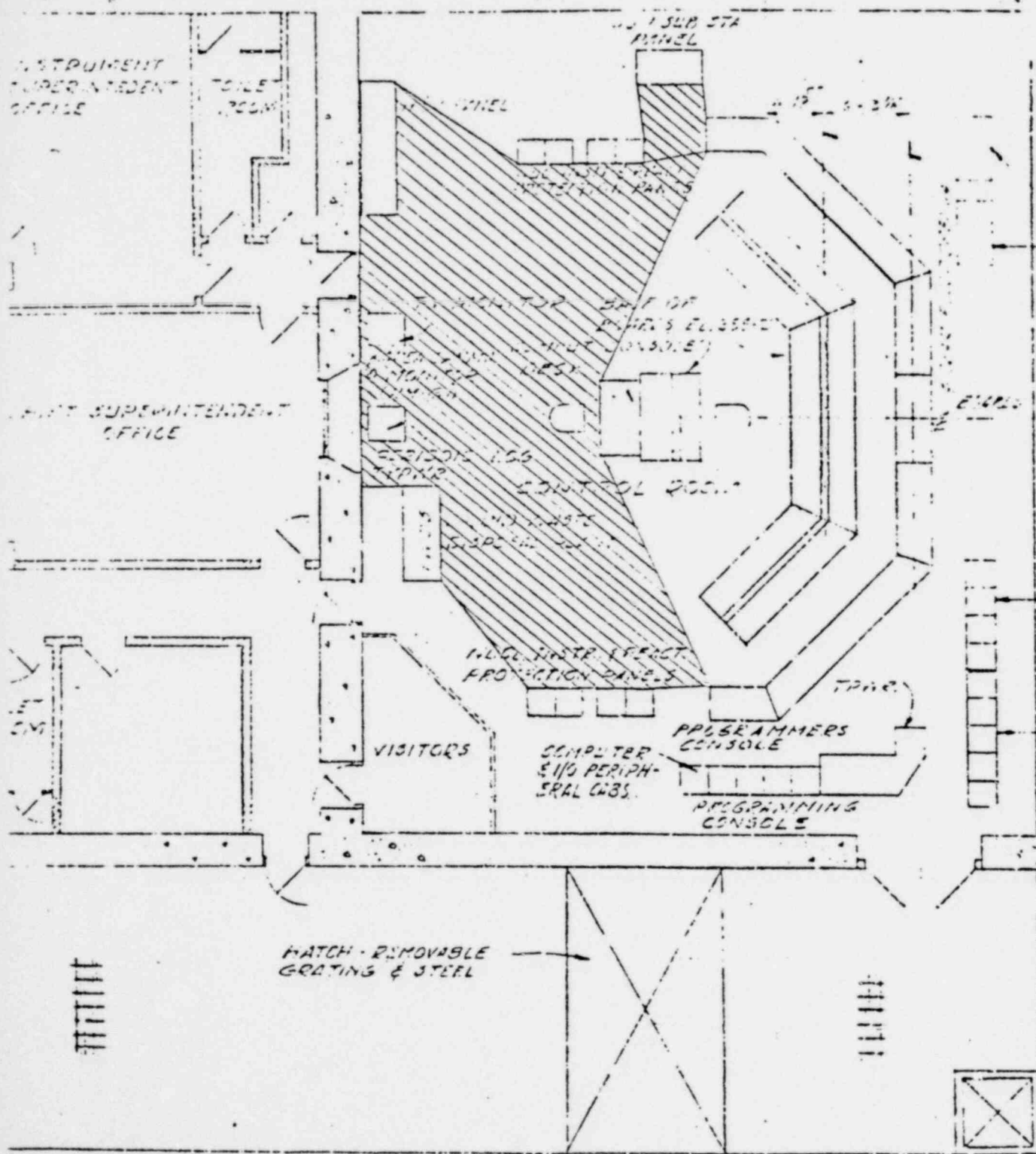

ENCLOSURE II

1122 307

UNIT I
5.0

POOR ORIGINAL



1028
Revision 0
05/05/77

ENCLOSURE II
UNIT II

7-0122 309

POOR ORIGINAL

