



UNITED STATES OF AMERICA
NUCLEAR REGULATORY COMMISSION
ATOMIC SAFETY AND LICENSING BOARD

In the Matter of

CROW BUTTE RESOURCES, INC.

(Marsland Expansion Area)

Docket No. 40-8943-MLA-2

ASLBP No. 13-926-01-MLA-BD01

Hearing Exhibit

Exhibit Number:

Exhibit Title:

PATH: K:\CBR_Projects\CO001396_ThreeCrow\1_ACADE-transmittal\hydro-XS.dwg LAYOUT: UIC SAVED DATE/TIME: 5/5/2010 2:01 PM

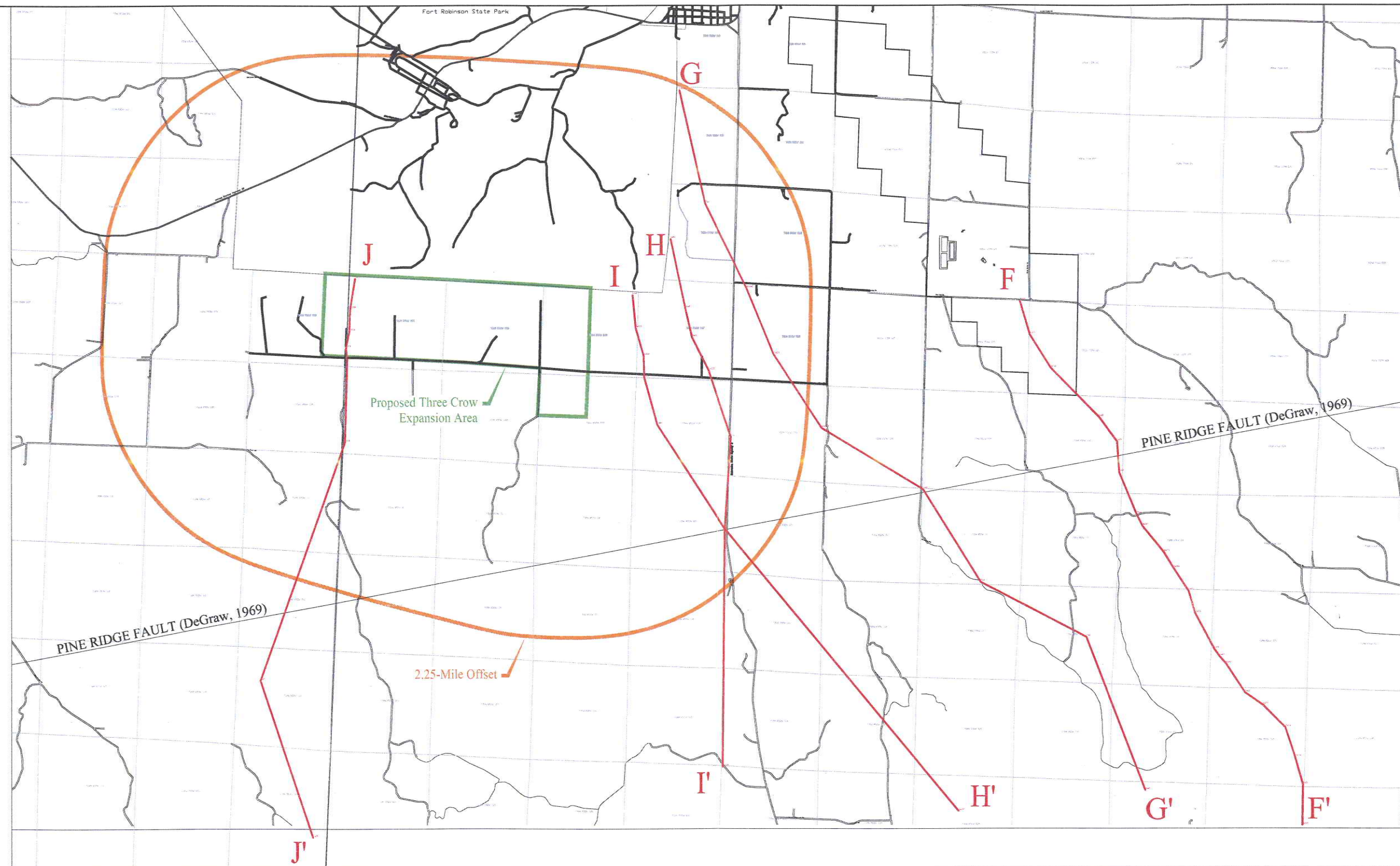

PROJECTION:
NAD 1927, STATE PLANE
NEBRASKA NORTH FIPS 2601



CROW BUTTE
RESOURCES, INC.

**FIGURE 1
REGIONAL CROSS-SECTION
LOCATION MAP**

PROJECT: CO001396

MAPPED BY: JC

CHECKED BY: MS



630 Plaza Drive, Ste. 100
Highlands Ranch, CO 80129
P: 720-344-3500 F: 720-344-3535
www.arcadis-us.com

PATH: K:\CIBR_Projects\CO001396_ThreeCrow\1_ACAD\c-transmittal\hydro-XS.dwg LAYOUT: UIC-1 SAVED DATE/TIME: 5/5/2010 2:01 PM

North **F** **F'** South

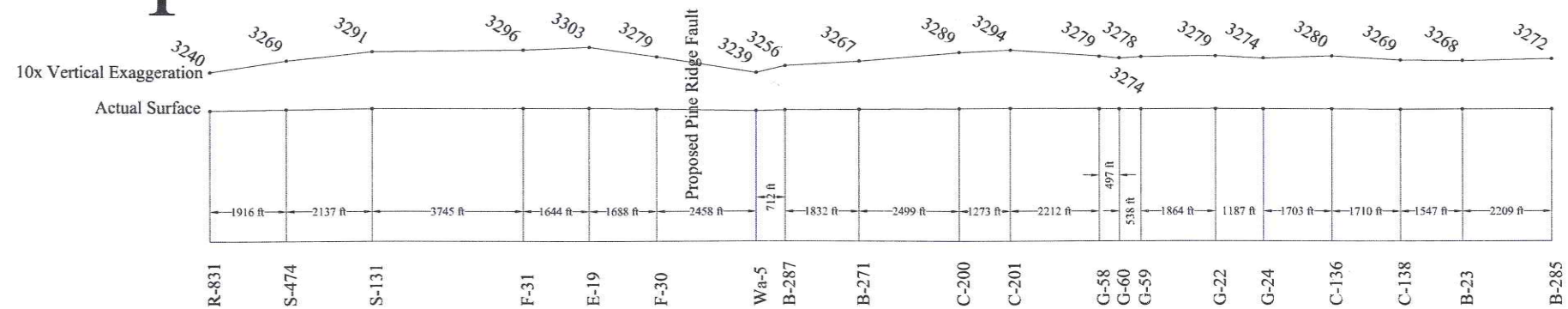

North **G** **G'** South



CROW BUTTE
RESOURCES, INC.

FIGURE 2
THREE CROW STRUCTURAL
CROSS-SECTIONS F-F' AND G-G'
(TOP OF PIERRE SHALE)

PROJECT: CO001396 MAPPED BY: JC CHECKED BY: MS



630 Plaza Drive, Ste. 100
Highlands Ranch, CO 80129
P: 720-344-3500 F: 720-344-3535
www.arcadis-us.com

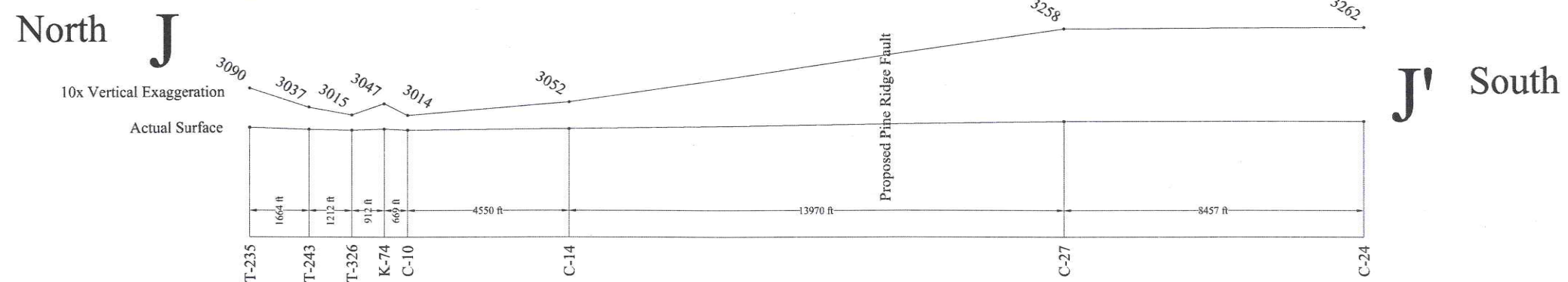
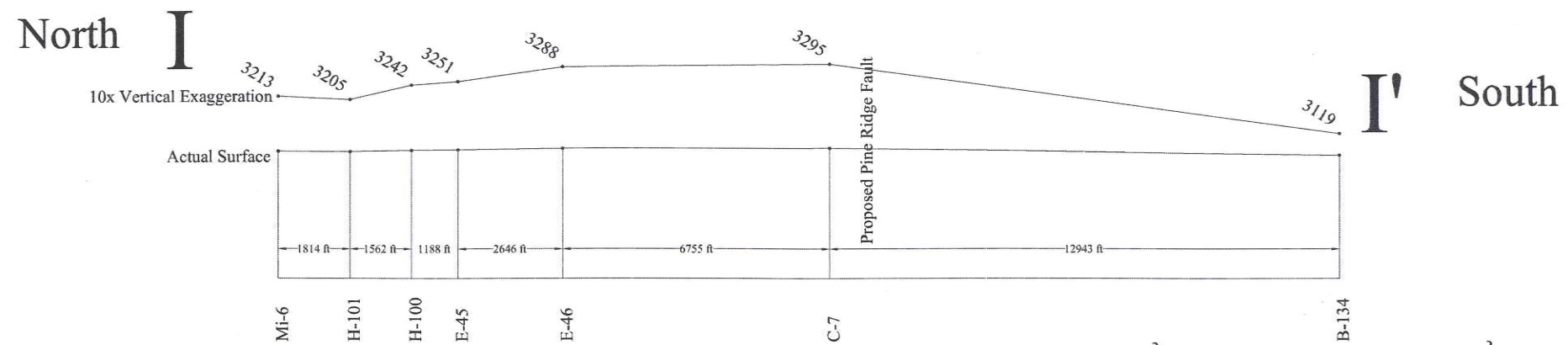
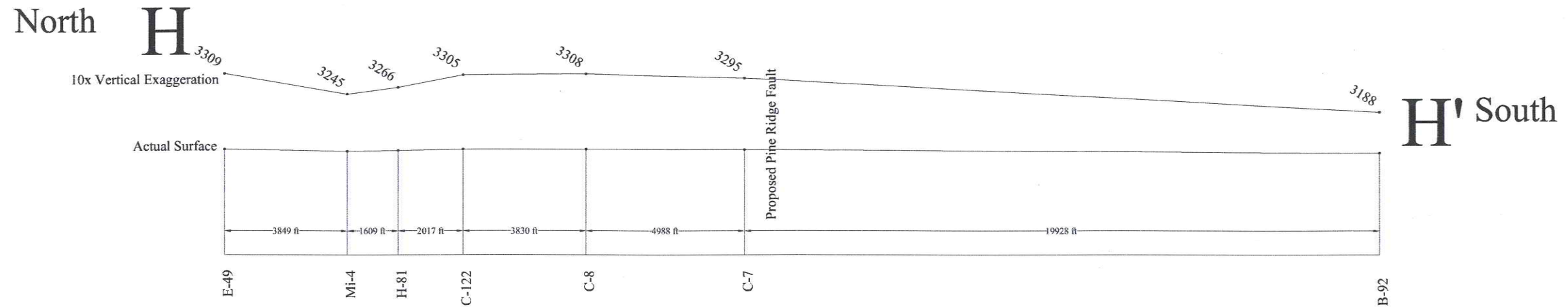

CROW BUTTE
RESOURCES, INC.

FIGURE 3
THREE CROW STRUCTURAL
CROSS-SECTIONS H-H', I-I', AND J-J'
(TOP OF PIERRE SHALE)

PROJECT: CO001396 MAPPED BY: JC CHECKED BY: MS



630 Plaza Drive, Ste. 100
Highlands Ranch, CO 80129
P: 720-344-3500 F: 720-344-3535
www.arcadis-us.com