



U. S. Nuclear Regulatory Commission
Region III
Materials Licensing Section
2443 Warrenville Road, Suite 210
Lisle, Illinois 60532-4352

License Number 24-16275-01

Dear Materials Licensing Section:

We this is written notification to our license to address the following changes:

§ We have closed the restricted space named on our license at 3700 West 10th Street. Included is a close out survey to have this area removed from our RAM license and released for unrestrictive use. All radioactive materials have been removed from the location. An ambient survey was performed with a gm survey meter on 3-27-2018. There were no exposures that exceeded 0.02 mR/hr (BKG). All test smears were negative for removable contamination. Constancy tests were performed on both the G.M. meter and the well counter and both were within 10% of expected values. G.M. surveys were taken on the most sensitive scale.

If you have any question on this request, please contact us at (660) 827-9536.

Sincerely,

Signature

Name

Title

Date

Enclosure

GET WELL. STAY WELL. BOTHWELL.

601 East Fourteenth Street | Sedalia, MO 65301 | PHONE: 660-826-8833 | WEB: www.brhc.org

RECEIVED MAY 01 2018

CLOSEOUT MISSOURI HEART

March 27, 2018

SURVEYS**WIPES****HOTLAB 2C-28**

HOTLAB COUNTER	0.02	67
HOTLAB FLOOR	0.02	67
LEAD CABINET	0.02	67
DOSE PREP	0.02	67
TRASH	0.02	67

STRESS LAB 2C-27

TREADMILL	0.02	6
FLOOR	0.02	6
TRASH	0.02	6

CAMERA ROOM

COUNTER	0.02	69
INJECTION TABLE	0.02	69
FLOOR	0.02	69
TRASH	0.02	69
DISPOSAL	0.02	69
LINEN	0.02	69

BACKGROUND:

0.02 mRh

259 CPM

LUDLUM 14C S/N 277726 CALIBRATED - 3/1/2018

CAPTUS 3000 WELL COUNTER

- A. COUNTER
- B. INJECTION TABLE
- C. FLOOR
- D. TRASH
- E. DISPOSAL
- F. LINEN

G. TREADMILL
H. FLOOR
I. TRASH

- J. LEAD CABINET
- K. COUNTER
- L. DISPOSAL
- M. DOSE PREP
- N. FLOOR
- O. TRASH

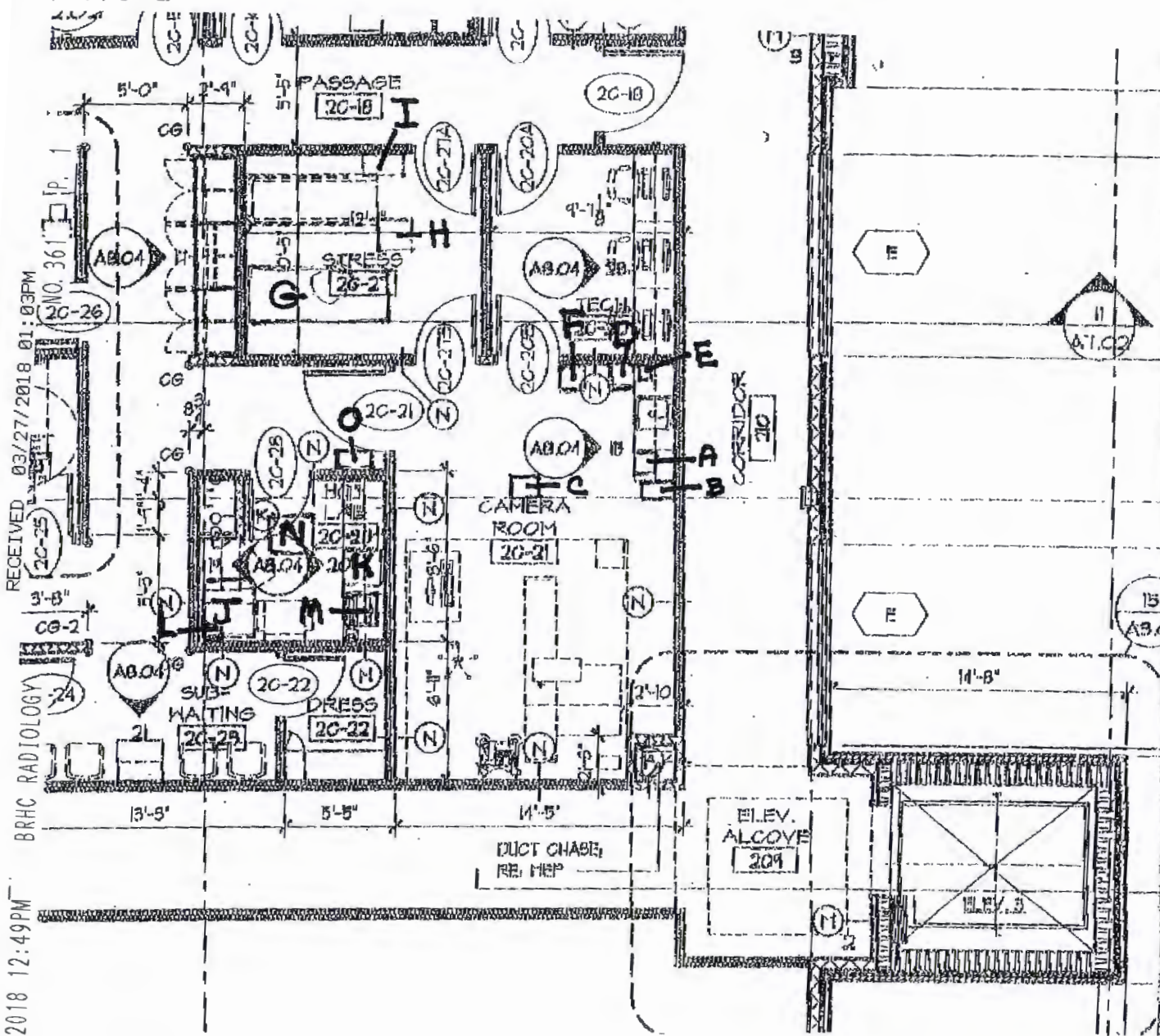

START MOB
"a14111"

As a result, the following is the result of the

BOTHWELL REGIONAL HEALTH CENTER
601 East 14th Street
SEDALIA, MISSOURI 65301

CERTIFIED MAIL



7017 3380 0000 9874 3448

MISSOURI 652

TUE 24 APR 2018 11



RECEIVED MAY 01 2018

US NUCLEAR REGULATORY COMMISSION
REGION III
MATERIALS LICENSING SECTION
2443 WARRENVILLE ROAD, SUITE 210
LISLE, ILLINOIS, 60532-4352

RETURN RECEIPT
REQUESTED

