

BEFORE THE
UNITED STATES NUCLEAR REGULATORY COMMISSION

In the Matter of

PENNSYLVANIA POWER &
LIGHT COMPANY

Docket Nos. 50-387
50-388

AMENDMENT NO. 55

APPLICATION FOR CLASS 103

OPERATING LICENSES FOR THE SUSQUEHANNA
STEAM ELECTRIC STATION

UNITS NO. 1 AND NO. 2

Applicant, Pennsylvania Power & Light Company, hereby files Amendment No. 55 to its Operating License Application dated July 31, 1978.

This amendment contains Revision 7 to the Susquehanna SES Emergency Plan.

PENNSYLVANIA POWER & LIGHT COMPANY
BY:

N. W. Curtis

N. W. Curtis

Vice President - Engineering and
Construction - Nuclear

Sworn to and subscribed before me
this 23rd of November, 1983.

MARtha C. Barto

Notary Public

MARTHA C. BARTO, Notary Public
Allentown, Lehigh County, Pa.
My Commission Expires Jan. 13, 1986

8312280131 831123
PDR-ADDOCK 05000387
PDR

1944

1944

1944

1944

1944

1944

1944

1944

1944

1944

1944

1944

1944

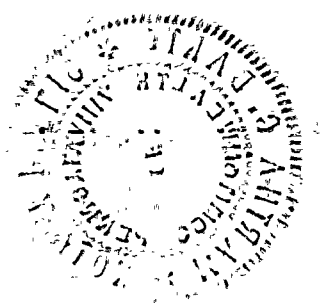

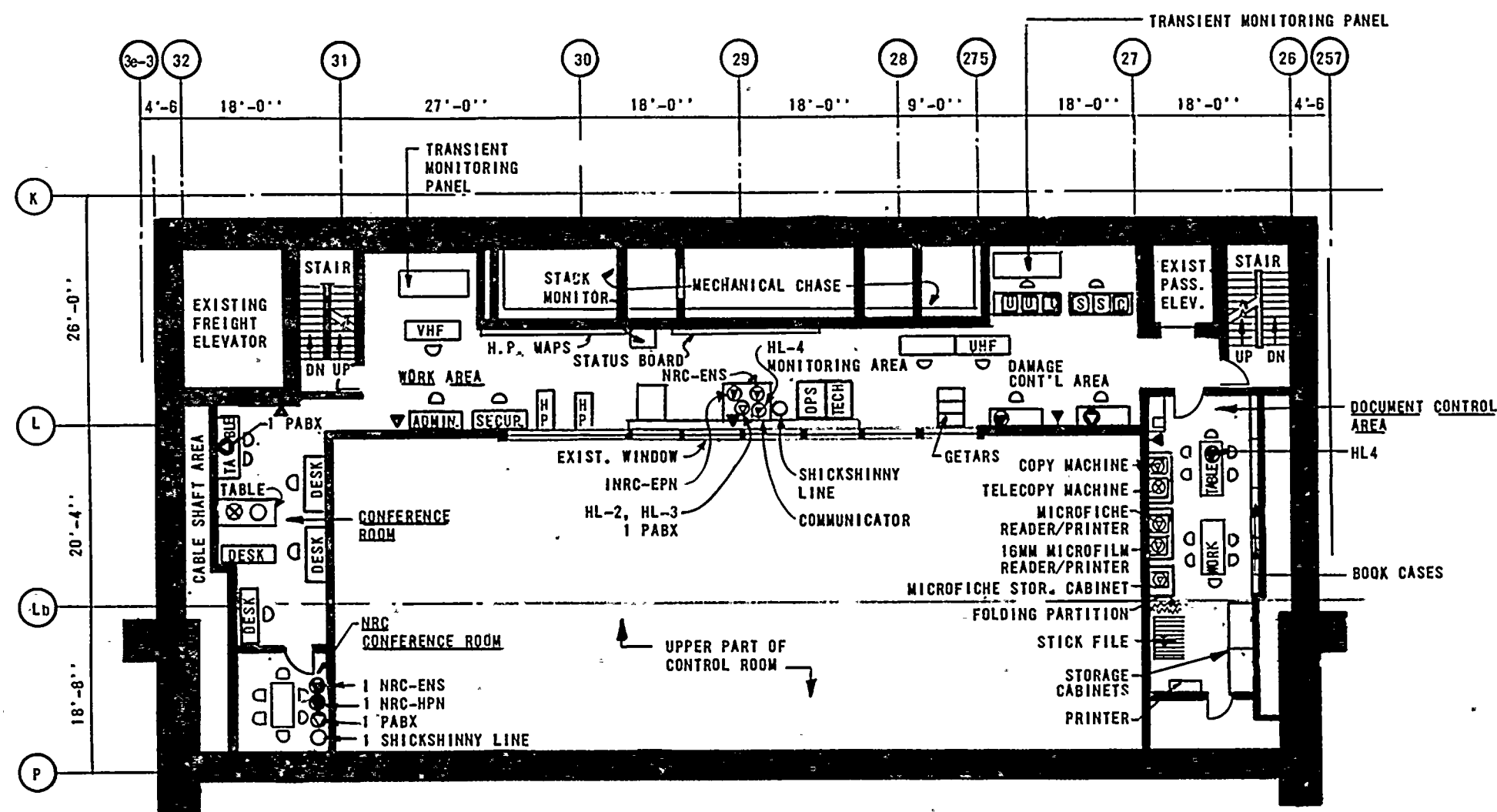

FLOOR PLAN - TECHNICAL SUPPORT CENTER

@ ELEVATION 741'-1" OF CONTROL STRUCTURE (PREVIOUS OBSERVATION GALLERY C-410, MEASURING & TEST EQUIP. CONTROL C-412, CALIBRATION RM. C-414 & COLD INSTRUMENT REPAIR SHOP C-411).

LEGEND

- ⊙ PABX
- HOTLINE
- ▼ P.A.
- ⊞ PCS MONITOR
- ⊗ ALLENTOWN EXTENSION
- ⊙ HOTLINE & PABX (ON SAME UNIT)
- SHICKSHINNY LINE
- ⊞ SPDS MONITOR
- ⊞ VIDEO COPIER

PRC
APERTURE
CARD

Also Available On
Aperture Card

NOTE: NOT ALL FURNITURE OR EQUIPMENT IS DRAWN TO SCALE. SOME P.A. SYSTEM COMPONENTS ARE NOT SHOWN.

FURNITURE LOCATIONS ARE SUBJECT TO CHANGE.

Rev. 7, 11/83

SUSQUEHANNA STEAM ELECTRIC STATION
UNITS 1 AND 2
EMERGENCY PLAN

TECHNICAL SUPPORT CENTER
FLOOR PLAN

Figure 7.3

8312280131-01

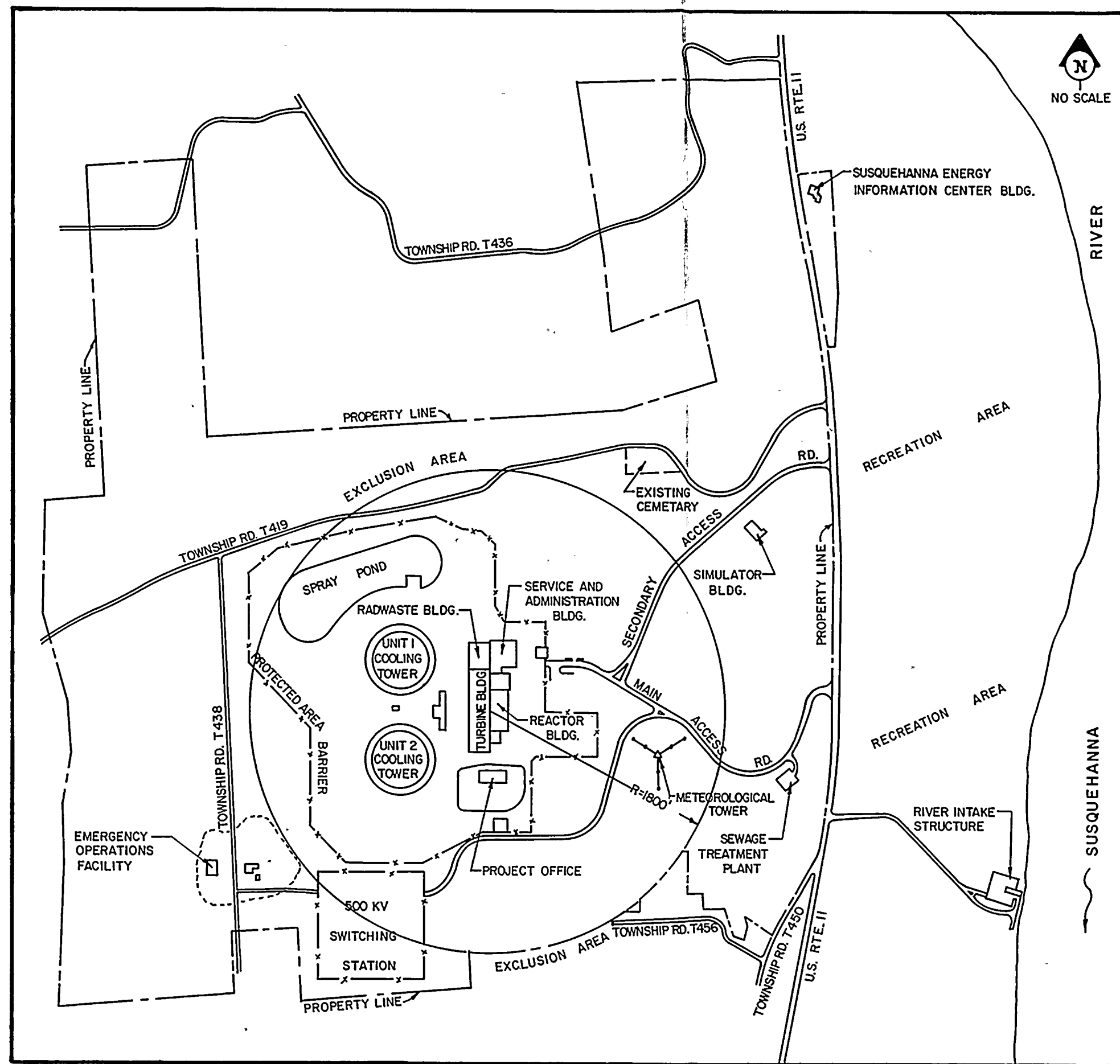

Rev. 6, 10/82

SUSQUEHANNA STEAM ELECTRIC STATION
UNITS 1 AND 2
EMERGENCY PLAN

LOCATION OF THE
EMERGENCY OPERATIONS FACILITY

Figure 7.4

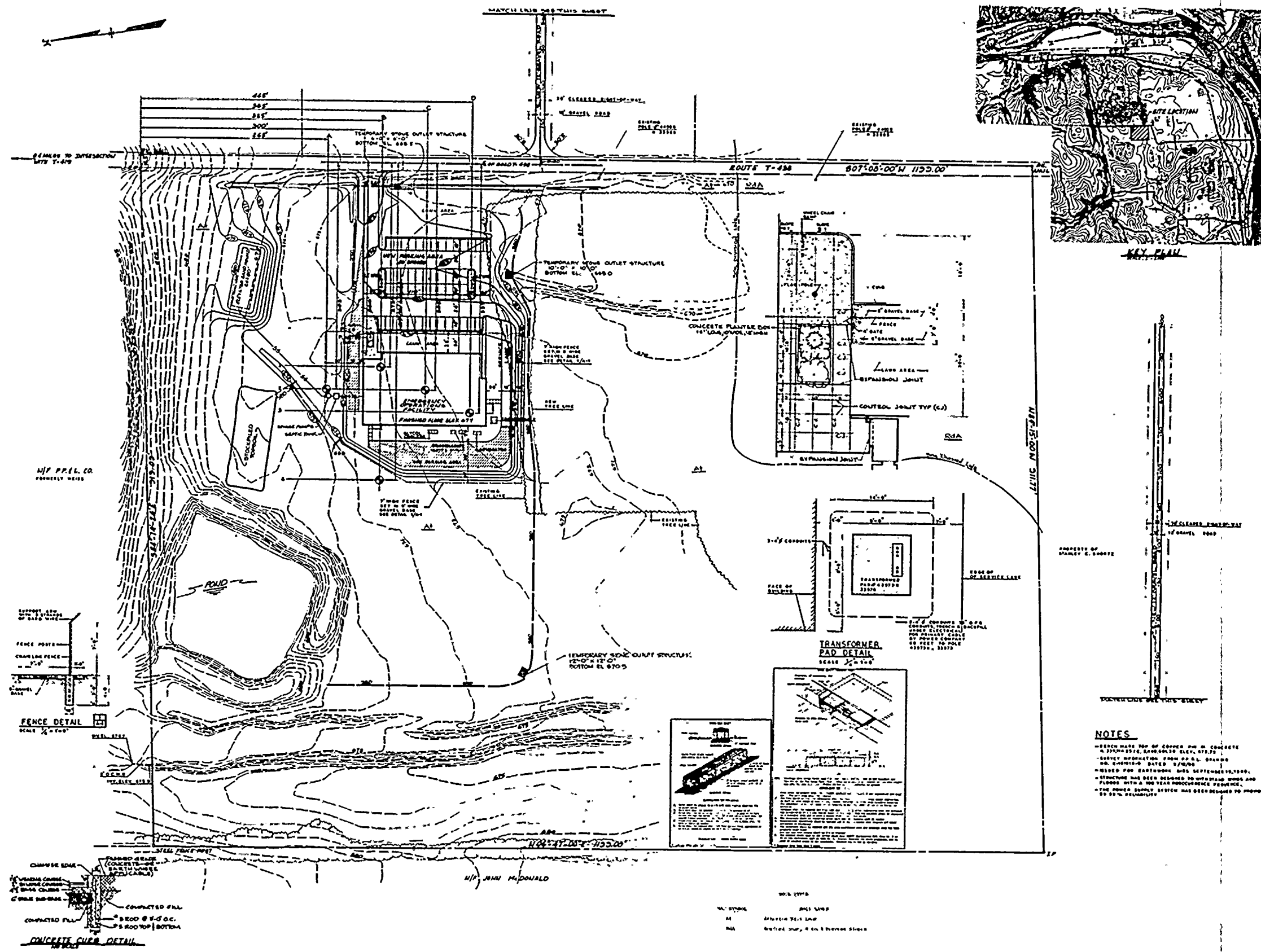

- NOTES**
- RESEARCH MAP OF COPPER PIN IN CONCRETE
 - A DETERMINED, BASED ON ELEV. 071.78
 - SURVEY INFORMATION FROM P.L. BRANDO
 - NO. CHANGES DATED 1/2/80
 - DESIGNED FOR EARTHQUAKE DATA SEPTEMBER 15, 1980.
 - STRUCTURE HAS BEEN DESIGNED TO WITHSTAND WINDS AND
 - FLAMES WITH A TWO YEAR REOCCURRENCE FREQUENCY.
 - THE POWER SUPPLY SYSTEM HAS BEEN DESIGNED TO PROVIDE
 - 50 TO 60% RELIABILITY

Rev. 6, 10/82

**SUSQUEHANNA STEAM ELECTRIC STATION
UNITS 1 AND 2
EMERGENCY PLAN**

**EMERGENCY OPERATIONS FACILITY
SITE PLAN**

Figure 7.5

