

HDP-PR-FSS-701, Final Status Survey Plan Development
APPENDIX P-6
FSS FIELD LOG

Survey Area: LSA-10Description: Burial Pit Open Land AreaSurvey Unit: 05Description: Section 05**FSS Field Log:**

<u>Date/Time</u>	<u>Observation or Comment</u>	<u>Technician</u>
12/18/13 0630	Received our daily safety briefing and FSS briefing.	AS/NJ/JH
12/18/13 0700	Received LSA 10-05 FSS Instruction Briefing. Official start of FSS in LSA 10-05.	
12/18/13 0730	Performed daily instrument source checks for the FSS meters. All FSS meters successfully passed the source check. Assembled GWS backpacks.	
12/18/13 0800	N. Jordan & A. Schooley verified that the isolation and controls were in place and began GWS for FSS in LSA 10-05.	
12/18/13 1130	N. Jordan and A. Schooley completed morning FSS GWS.	
12/18/13 1245	Performed mid-day source check of GWS instruments. All meters being used successfully passed source check.	
12/18/13 1300	N. Jordan & A. Schooley performed download and processing of morning GPS data and documented surveys. See surveys 4726-C-131218 & 4739-C-131218 for more detailed survey information.	
12/18/13 1330	J. Hoffman verified that the isolation and controls were in place and continued GWS FSS in LSA 10-05.	
12/18/13 1500	J. Hoffman completed afternoon GWS and returned to the office to download and process the GPS data and document the survey. See survey 4731-C-131218 for more detailed survey information.	
12/18/13 1630	Post-checks performed on all FSS meters that were used. All meters passed successfully. END AS/NJ/JH	

FSS Field Log __ of __

HDP-PR-FSS-701, Final Status Survey Plan Development
APPENDIX P-6
FSS FIELD LOG

Survey Area: LSA-10Description: Burial Pit Open Land AreaSurvey Unit: 05Description: Section 05**FSS Field Log:**

<u>Date/Time</u>	<u>Observation or Comment</u>	<u>Technician</u>
12/19/13 0630	Received our daily safety briefing and FSS briefing.	JH
12/19/13 0730	Performed daily instrument source checks for FSS L-2221 meter AA. Meter successfully passed the source check. Assembled GWS backpack.	
12/19/13 0800	J. Hoffman verified that the isolation and controls were in place and began GWS for FSS in LSA 10-05.	
12/19/13 1130	J. Hoffman completed a portion of FSS GWS in LSA 10-05. Returned to office to download and process data and perform survey documentation. See survey 4753-C-131219 for more detailed survey information.	
12/19/13 1300	Performed mid-day source check of GWS instrument. Meter AA successfully passed source check.	
12/19/13 1640	Post-checks performed on FSS meter AA. Meter passed successfully. END JH	

FSS Field Log __ of __

HDP-PR-FSS-701, Final Status Survey Plan Development
APPENDIX P-6
FSS FIELD LOG

Survey Area: LSA-10Description: Burial Pit Open Land AreaSurvey Unit: 05Description: Section 05**FSS Field Log:**

<u>Date/Time</u>	<u>Observation or Comment</u>	<u>Technician</u>
12/20/13 0630	NO FSS WORK TO BE PERFORMED IN LSA 10-05 ON THIS DATE END SJ	SJ

FSS Field Log __ of __

HDP-PR-FSS-701, Final Status Survey Plan Development
APPENDIX P-6
FSS FIELD LOG

Survey Area: LSA-10Description: Burial Pit Open Land AreaSurvey Unit: 05Description: Section 05**FSS Field Log:**

<u>Date/Time</u>	<u>Observation or Comment</u>	<u>Technician</u>
12/21/13 0630	NO FSS WORK WAS PERFORMED IN LSA 10-05 BETWEEN 12/21/13 AND 01/6/14 DUE TO SITE CLOSURE FOR THE HOLIDAYS END SJ	SJ

FSS Field Log __ of __

HDP-PR-FSS-701, Final Status Survey Plan Development
APPENDIX P-6
FSS FIELD LOG

Survey Area: LSA-10Description: Burial Pit Open Land AreaSurvey Unit: 05Description: Section 05**FSS Field Log:**

<u>Date/Time</u>	<u>Observation or Comment</u>	<u>Technician</u>
01/06/14 0630	DUE TO WEATHER CONDITIONS, NO FSS WORK WAS PERFORMED IN LSA 10-05 BETWEEN 01/06/14 AND 01/13/14. END SJ	SJ

FSS Field Log __ of __

HDP-PR-FSS-701, Final Status Survey Plan Development
APPENDIX P-6
FSS FIELD LOG

Survey Area: LSA-10Description: Burial Pit Open Land AreaSurvey Unit: 05Description: Section 05**FSS Field Log:**

<u>Date/Time</u>	<u>Observation or Comment</u>	<u>Technician</u>
01/14/14 0630	Received our daily safety briefing and MC&A training.	AS/NJ/JW/JS/SJ
01/14/14 0700	Received our daily FSS briefing and FSS Instructions for LSA 10-05.	
01/14/14 0730	Performed daily instrument source checks for the FSS meters. All FSS meters successfully passed the source check. Assembled GWS backpacks and began assembling soil sampling equipment and supplies.	
01/14/14 0900	N. Jordan and J. Williams verified that the isolation and controls were in place and continued FSS GWS in LSA 10-05. A. Schooley, J. Seals and S. Jenkins began Systematic Soil Sampling efforts in LSA 10-05.	
01/14/14 1300	N. Jordan and J. Williams performed mid-day source check of GWS instruments. Meters successfully passed source check.	
01/14/14 1330	N. Jordan and J. Williams continued FSS GWS in LSA 10-05. A. Schooley, J. Seals and S. Jenkins continued Systematic Soil Sampling efforts in LSA 10-05. Sample ID's L100501BES00, L100502BES00 and L100502BEQ00 were unable to be sampled due to their location currently being under water. The area is currently being pumped and the locations will be revisited as soon as pumping is complete.	
01/14/14 1515	A Schooley, J. Seals and S. Jenkins completed Systematic Soil Sampling of available locations. The following ID's were sampled: L100503BES00, L100504BES00, L100505BES00 L100506BES00, L100507BES00, L100508BES00 See survey 0079-C-140114 for more detailed information.	
01/14/14 1610	N. Jordan and J. Williams completed the GWS of LSA 10-05 for the day and returned to the office to download and process the data. See surveys: 0096-C-140114, 0138-C-140114 & 0139-C-140114 for more detailed information.	
01/14/14 1620	Post-checks performed on all FSS meters that were used. All meters passed successfully. END AS/NJ/JW/JS/SJ	

FSS Field Log __ of __

HDP-PR-FSS-701, Final Status Survey Plan Development
APPENDIX P-6
FSS FIELD LOG

Survey Area: LSA-10Description: Burial Pit Open Land AreaSurvey Unit: 05Description: Section 05**FSS Field Log:**

<u>Date/Time</u>	<u>Observation or Comment</u>	<u>Technician</u>
01/15/14 0630	Received our daily safety briefing and FSS briefing.	AS/NJ/JW/JS/SJ
01/15/14 0730	Performed daily instrument source checks for the FSS meters. All FSS meters successfully passed the source check. Assembled GWS backpacks.	
01/15/14 0915	N. Jordan, J. Williams, J. Seals, A. Schooley and S. Jenkins verified that the isolation and controls were in place and continued GWS FSS in LSA 10-05.	
01/15/14 1100	Completed morning FSS GWS.	
01/15/14 1245	Performed mid-day source check of GWS instruments. All meters being used successfully passed source check.	
01/15/14 1330	N. Jordan, J. Williams, J. Seals, A. Schooley and S. Jenkins verified that the isolation and controls were in place and continued GWS FSS in LSA 10-05.	
01/15/14 1600	Completed FSS GWS on horizontal surfaces within LSA 10-05. See surveys: 0103-C-140115, 0111-C-140115, 0122-C-140115, 0123-C-14015, 0136-C-140115, 0155-C-140115 & 0156-C-140115 for more detailed information.	
01/15/14 1610	Post-checks performed on all FSS meters that were used. All meters passed successfully.	
01/15/14 1620	Performed data download and processing. Performed survey documentation. END AS/NJ/JW/JS/SJ	

FSS Field Log __ of __

HDP-PR-FSS-701, Final Status Survey Plan Development
APPENDIX P-6
FSS FIELD LOG

Survey Area: LSA-10Description: Burial Pit Open Land AreaSurvey Unit: 05Description: Section 05**FSS Field Log:**

<u>Date/Time</u>	<u>Observation or Comment</u>	<u>Technician</u>
01/16/14 0630	Received our daily safety briefing and FSS briefing.	AS/JW/JS/SJ
01/16/14 0715	Performed daily instrument source checks for the FSS meters. All FSS meters Successfully passed the source check. Assembled GWS backpacks.	
01/16/14 0830	A. Schooley and J. Seals verified that the isolation and controls were in place and began systematic soil sampling. S. Jenkins and J. Williams continued GWS in LSA 10-05.	
01/16/14 1000	Completed systematic soil sampling of all horizontal surfaces. See survey 0121-C-140116 for more detailed information.	
01/16/14 1315	Performed mid-day source check of GWS instruments. All meters being used successfully passed source check.	
01/16/14 1400	S. Jenkins and J. Williams verified that the isolation and controls were in place and continued GWS FSS in LSA 10-05. A. Schooley and J. Seals began sidewall systematic soil sampling efforts.	
01/16/14 1610	Completed sidewall systematic soil sampling and FSS GWS for the day in LSA 10-05. See surveys: 0125-C-140116, 0134-C-140116 & 0135-C-140116 for more detailed information.	
01/16/14 1620	Post-checks performed on all FSS meters that were used. All meters passed Successfully.	
01/16/14 1630	Performed data download and processing. Performed GWS and soil sampling survey documentation. END AS/JW/JS/SJ	

FSS Field Log __ of __

HDP-PR-FSS-701, Final Status Survey Plan Development
APPENDIX P-6
FSS FIELD LOG

Survey Area: LSA-10Description: Burial Pit Open Land AreaSurvey Unit: 05Description: Section 05**FSS Field Log:**

<u>Date/Time</u>	<u>Observation or Comment</u>	<u>Technician</u>
01/17/14 0630	Received our daily safety briefing and FSS briefing.	AS/NJ/JW/JS/SJ
01/17/14 0715	Performed daily instrument source checks for the FSS meters. All FSS meters Successfully passed the source check. Assembled GWS backpacks.	
01/17/14 0830	N. Jordan proceeded to LSA 10-10 to conduct GWS of areas that were excavated due to investigate pellet and tire debris that had been previously located during FSS. See surveys: 0141-C-140117 & 0142-C-140117 for more detailed information.	
01/17/14 1010	A. Schooley and J. Seals and S. Jenkins verified that the isolation and controls were in place and began systematic soil sampling in LSA 10-05. J. Williams continued GWS in LSA 10-05.	
01/17/14 1300	Performed mid-day source check of GWS instruments. All meters being used successfully passed source check.	
01/17/14 1315	S. Jenkins, A. Schooley and J. Seals verified that the isolation and controls were in place and continued sidewall systematic soil sampling efforts in LSA 10-05. J. Williams continued GWS of LSA 10-05.	
01/17/14 1530	Completed sidewall systematic soil sampling and FSS GWS of all horizontal surfaces within LSA 10-05. All soil samples labeled and transported to the lab for analysis. See surveys: 0149-C-140117, 0157-C-140117 & 0158-C-140117 for more detailed information.	
01/17/14 1550	Post-checks performed on all FSS meters that were used. All meters passed Successfully.	
01/17/14 1600	Returned to the office to perform data download, processing and documentation of all GWS and soil sampling activities. END AS/NJ/JW/JS/SJ	

FSS Field Log __ of __

HDP-PR-FSS-701, Final Status Survey Plan Development
APPENDIX P-6
FSS FIELD LOG

Survey Area: LSA-10Description: Burial Pit Open Land AreaSurvey Unit: 05Description: Section 05**FSS Field Log:**

<u>Date/Time</u>	<u>Observation or Comment</u>	<u>Technician</u>
01/18/14 0800	N. Jordan, A. Schooley, J. Williams & J. Seals verified that the isolation and controls were in place and began sidewall GWS in LSA 10-05.	AS/NJ/JW/JS
01/18/14 1400	Completed sidewall FSS GWS for the day within LSA 10-05 Post-checks performed on all FSS meters that were used. Meter DD failed post source check. Area will be re-surveyed. All other meters passed successfully.	
01/18/14 1410	Returned to the office to perform data download, processing and documentation of all GWS and soil sampling activities. See surveys: 0176-C-140118, 0179-C-140119 for more detailed information.	
	END AS/NJ/JW/JS	

FSS Field Log __ of __

HDP-PR-FSS-701, Final Status Survey Plan Development
APPENDIX P-6
FSS FIELD LOG

Survey Area: LSA-10Description: Burial Pit Open Land AreaSurvey Unit: 05Description: Section 05**FSS Field Log:**

<u>Date/Time</u>	<u>Observation or Comment</u>	<u>Technician</u>
01/19/14 0630	J. Williams, S. Jenkins & J. Seals verified that the isolation and controls were in place and continued sidewall FSS GWS in LSA 10-05.	SJ/NJ/JW/JS
01/19/14 1200	Completed sidewall FSS GWS within LSA 10-05. Began Biased Soil Sampling activities within LSA 10-05. See Surveys 0173-C-140119, 0179-C-140119, 0180-C-140119 & 0182-C-140119	
01/19/14 1400	Completed Biased Soil Sampling activities. Processed samples and transported to the lab for analysis. The following samples were taken: Sample ID L100525BUB00 L100526BUB00 L100527BUB00 L100528BUB00 See survey 0166-C-140119 for more detailed information.	
01/19/14 1430	Post-checks performed on all FSS meters that were used. All meters passed successfully. END AS/NJ/JW/JS	

FSS Field Log __ of __

HDP-PR-FSS-701, Final Status Survey Plan Development
APPENDIX P-6
FSS FIELD LOG

Survey Area: LSA-10Description: Burial Pit Open Land AreaSurvey Unit: 05Description: Section 05**FSS Field Log:**

<u>Date/Time</u>	<u>Observation or Comment</u>	<u>Technician</u>
01/20/14 0830	N. Jordan verified that the isolation and controls were in place and performed a resurvey of the sidewall in LSA 10-05. This sidewall was originally surveyed with a meter that failed the post source check on 01/18/14.	NJ
01/20/14 1030	Completed resurvey of sidewall. Returned to office to document survey.	
01/20/14 1630	Post-check performed on FSS meter that was used. Meter passed successfully. END NJ	

FSS Field Log __ of __

HDP-PR-FSS-701, Final Status Survey Plan Development
APPENDIX P-6
FSS FIELD LOG

Survey Area:	<u>LSA-10</u>	Description:	<u>Burial Pit Open Land Area</u>
Survey Unit:	<u>06</u>	Description:	<u>Section 06</u>

FSS Field Log:

<u>Date/Time:</u>	<u>Observation or Comment:</u>	<u>Technician</u>
10/28/13 0630	Received our daily FSS and safety briefing.	SJ/NJ/AS/JH
10/28/13 0720	Performed daily instrument source checks for the 2221 meters CC and DD and 2360 meters B and D. All FSS meters successfully passed the source check.	
10/28/13 0830	N. Jordan, J. Hoffman verified that the isolation and controls were in place and continued Pre-FSS/ RASS GWS in LSA 10-06.	
10/28/13 1330	N. Jordan, J. Hoffman completed the Pre-FSS/ RASS GWS in LSA 10-06 for the day and proceeded inside to download, process data and complete the survey documentation. The GWS created the following GPS map files: LSA_1006_102813_DD and LSA_1006_102813_CC. See survey 4055 C 131028 for more detailed information.	
10/28/13 1630	Post-checks performed on all FSS meters that were used. All meters passed successfully. END SJ/NJ/JH/AS	

FSS Field Log __ of __

HDP-PR-FSS-701, Final Status Survey Plan Development
APPENDIX P-6
FSS FIELD LOG

Survey Area: <u>LSA-10</u>	Description: <u>Burial Pit Open Land Area</u>
Survey Unit: <u>06</u>	Description: <u>Section 06</u>

FSS Field Log:

<u>Date/Time:</u>	<u>Observation or Comment:</u>	<u>Technician</u>
11/04/13 0630	Received our daily FSS and safety briefing.	SJ/NJ/AS/JH
11/04/13 0710	Performed daily instrument source checks for the 2221 meters AA, DD and FF And 2360 meters B and D. All FSS meters successfully passed the source check.	
11/04/13 0830	N. Jordan, J. Hoffman and A. Schooley verified that the isolation and controls Were in place and continued Pre-FSS/ RASS GWS in LSA 10-06.	
11/04/13 1500	N. Jordan, J. Hoffman and A. Schooley completed the Pre-FSS/ RASS GWS in LSA 10-06 for the day and proceeded inside to download, process data and complete the survey documentation.	
	<p>The GWS created the following GPS map files: LSA_1006_110413_AA, LSA_1006_110413_DD, LSA_1006_110413_DD_2 and LSA_1006_110413_FF.</p> <p>See the following surveys for more detailed information.</p> <p>4143 C 131104 4189 C 131104 4224 C 131104</p> <p>NOTE: During the GWS, A. Schooley experienced a GPS data-logger failure. Note the manual survey map section, recorded on survey 4143 C 131104. 100% Of this area was walked during the GWS and no anomalous readings were found.</p>	
11/04/13 1620	Post-checks performed on all FSS meters that were used. All meters passed successfully.	
	END SJ/NJ/JH/AS	

FSS Field Log __ of __

HDP-PR-FSS-701, Final Status Survey Plan Development
APPENDIX P-6
FSS FIELD LOG

Survey Area: <u>LSA-10</u>	Description: <u>Burial Pit Open Land Area</u>
Survey Unit: <u>06 & 07</u>	Description: <u>Section 06 & 07</u>

FSS Field Log:

<u>Date/Time:</u>	<u>Observation or Comment:</u>	<u>Technician</u>
11/07/13 0630	Received our daily FSS and safety briefing.	SJ/NJ/AS/JH
11/07/13 0710	Performed daily instrument source checks for the 2221 meters AA, DD and FF and 2360 meters B and D. All FSS meters successfully passed the source check.	
11/07/13 0800	N. Jordan and J. Hoffman assembled backpacks and proceeded to LSA 10-06 to begin GWS.	
11/07/13 0820	A Schooley and S. Jenkins prepared supplies & paperwork and proceeded to LSA 10-07 to begin Pre-FSS/RASS sampling on LSA 10-07. Verified that the isolation and controls were in place before beginning work in the area.	
11/07/13 1300	N. Jordan and J. Hoffman continued the GWS walkovers in LSA 10-06. The following map files were created from the GWS data. LSA_1006_110713_AA, LSA_1006_110713_AA_2, LSA_1006_110713_DD & LSA_1007_110713_DD_2. See surveys 4366C131107 & 4225C131107 for more information.	
11/07/13 1320	After restocking with supplies, A. Schooley and S. Jenkins continued Pre-FSS and RASS sampling in LSA 10-07. The following samples were pulled.	
	Sample ID	
	7121-RA-131107-05-03	
	7121-RA-131107-05-04	
	7121-RA-131107-05-05	
	7121-RA-131107-05-06	
	7121-RA-131107-05-07	
	7121-RA-131107-05-08	
	7121-RA-131107-05-09	
	7121-RA-131107-05-10	
	7121-RA-131107-05-11	
	7121-RA-131107-05-12	
	7121-RA-131107-05-13	
	7121-RA-131107-05-14	
	7121-RA-131107-05-15	
	7121-RA-131107-05-16	

See survey 4226 C 131107 for more detailed information.

FSS Field Log __ of __

HDP-PR-FSS-701, Final Status Survey Plan Development
APPENDIX P-6
FSS FIELD LOG

<u>Date/Time:</u>	<u>Observation or Comment:</u>	<u>Technician</u>
11/07/13 1600	N. Jordan and J. Hoffman completed the GWS for the day and proceeded into the office to download and process the data. A. Schooley and S. Jenkins completed sampling activities for the day and delivered samples to the lab for analysis.	SJ/NJ/AS/JH
11/07/13 1620	Performed post-checks on all FSS 2221 meters. All meters passed successfully. END SJ/NJ/AS/JH	

FSS Field Log __ of __

HDP-PR-FSS-701, Final Status Survey Plan Development
APPENDIX P-6
FSS FIELD LOG

Survey Area:	<u>LSA-10</u>	Description:	<u>Burial Pit Open Land Area</u>
Survey Unit:	<u>06 & 07</u>	Description:	<u>Section 06 & 07</u>

FSS Field Log:

<u>Date/Time:</u>	<u>Observation or Comment:</u>	<u>Technician</u>
11/08/13 0630	Received our daily FSS and safety briefing.	SJ/NJ/AS/JH
11/08/13 0710	Performed daily instrument source checks for the 2221 meters AA, DD and FF and 2360 meters B and D. All FSS meters successfully passed the source check.	
11/08/13 0800	N. Jordan performed statistical analysis on walkover data from 11/07/13.	
11/08/13 0900	J. Hoffman, A. Schooley and S. Jenkins performed walk-down of Iso-Pacific sorter area and assisted with setup and configuration input.	
11/08/13 1300	J. Hoffman and S. Jenkins installed Isolation and Controls around LSA 10-06 including rope, signage and plastic wrapped waddles to control water run-off into the area from other areas. A. Schooley and N. Jordan verified that the isolation and controls were in place and continued Pre-FSS/ RASS sampling in LSA 10-07.	
11/08/13 1600	Completed sampling activities for the day in LSA 10-07. The following samples were pulled. Sample ID 7121-RA-131107-05-01 7121-RA-131107-05-02 See survey 4227 C 131107 for more detailed information.	
11/08/13 1630	Completed installing I&C in LSA 10-06 and completed general housekeeping in the area to prepare it for FSS starting next week. Post-checks performed on all FSS meters that were used. All meters passed successfully. END SJ/NJ/AS/JH	

FSS Field Log __ of __

HDP-PR-FSS-701, Final Status Survey Plan Development
APPENDIX P-6
FSS FIELD LOG

Survey Area: <u>LSA-10 & LSA 12</u>	Description: <u>Burial Pit Open Land Area</u>
Survey Unit: <u>10-06 & 12-05</u>	Description: <u>Section LSA 10-06 & LSA 12-05</u>

FSS Field Log:

<u>Date/Time:</u>	<u>Observation or Comment:</u>	<u>Technician</u>												
11/12/13 0630	Received our daily FSS and safety briefing.	SJ/NJ/AS/JH												
11/12/13 0710	Performed daily instrument source checks for the 2221 meters DD and FF and 2360 meters B and D. All FSS meters successfully passed the source check.													
11/12/13 0730	A. Schooley performed a manual GWS in LSA 12-05 between stockpiles 1 & 4, to verify the surface is clean before placing screened re-use material in the area.													
11/12/13 0745	J. Hoffman provided job coverage for the movement of stockpile 2 material from the old area on the south end of the site to the new area in the north laydown.													
11/12/13 0850	N. Jordan verified that the isolation and controls were in place and continued Pre-FSS / RASS walkovers in LSA 10-06.													
11/12/13 0930	N. Jordan completed the Pre-FSS / RASS GWS of LSA 10-06. Returned to the office to download and perform statistical analysis of data. The GWS created the GPS map file: LSA_1006_111213_DD. See survey 4305 C 131112 for more detailed information.													
11/12/13 1130	A. Schooley completed the manual GWS in LSA 12-05. No anomalous readings were found. See survey 4284 C 131112 for more detailed information.													
11/12/13 1330	A. Schooley proceeded to LSA 12-05 to perform biased soil sampling at 3 locations. Soil samples were taken at the following locations:													
	<table border="0" style="width: 100%;"> <thead> <tr> <th style="text-align: left;">Sample ID</th> <th style="text-align: left;">Easting</th> <th style="text-align: left;">Northing</th> </tr> </thead> <tbody> <tr> <td>7186-SS-131112-15-01</td> <td>827870.64</td> <td>865465.55</td> </tr> <tr> <td>7186-SS-131112-15-02</td> <td>827829.74</td> <td>865474.88</td> </tr> <tr> <td>7186-SS-131112-15-03</td> <td>827828.40</td> <td>865504.61</td> </tr> </tbody> </table>	Sample ID	Easting	Northing	7186-SS-131112-15-01	827870.64	865465.55	7186-SS-131112-15-02	827829.74	865474.88	7186-SS-131112-15-03	827828.40	865504.61	
Sample ID	Easting	Northing												
7186-SS-131112-15-01	827870.64	865465.55												
7186-SS-131112-15-02	827829.74	865474.88												
7186-SS-131112-15-03	827828.40	865504.61												
	See survey 4283 C 131112 for more detailed information.													
11/12/13 1630	J. Hoffman completed job coverage of stockpile soil transport activities. Post checks performed on all FSS meters that were used. All meters passed successfully.													
	END SJ/NJ/JH/AS													

FSS Field Log __ of __

HDP-PR-FSS-701, Final Status Survey Plan Development
APPENDIX P-6
FSS FIELD LOG

Survey Area:	<u>LSA-10</u>	Description:	<u>Burial Pit Open Land Area</u>
Survey Unit:	<u>06</u>	Description:	<u>Section 06</u>

FSS Field Log:

<u>Date/Time:</u>	<u>Observation or Comment:</u>	<u>Technician</u>
11/13/13 0630	Received our daily FSS and safety briefing.	SJ/NJ/AS/JH
11/13/13 0720	Performed daily instrument source checks for the 2221 meters AA, DD and FF and 2360 meters B and D. All FSS meters successfully passed the source check.	
11/13/13 0830	N. Jordan, J. Hoffman, A. Schooley covered setup of the ISO-PACIFIC soil screening machine.	
11/13/13 1300	J. Hoffman covered the ISO-PACIFIC pellet tests for NRC.	
11/13/13 1400	N. Jordan, and A. Schooley verified that the isolation and control measure were in place and continued FSS walkovers in LSA 10-06. The GPS data files LSA_1006_111313_DD & LSA_1006_111313_FF were created. No anomalous Readings were noted during the walkovers. See surveys 4321 C 131113 & 4381 C 131113 for more detailed information.	
11/13/13 1600	Returned to the office to download GWS data and complete survey documentation.	
11/13/13 1630	Post-checks performed on all FSS meters that were used. All meters passed successfully. END SJ/NJ/JH/AS	

FSS Field Log __ of __

HDP-PR-FSS-701, Final Status Survey Plan Development
APPENDIX P-6
FSS FIELD LOG

Survey Area:	<u>LSA-10</u>	Description:	<u>Burial Pit Open Land Area</u>
Survey Unit:	<u>06</u>	Description:	<u>Section 06</u>

FSS Field Log:

<u>Date/Time:</u>	<u>Observation or Comment:</u>	<u>Technician</u>
11/14/13 0630	Received our daily FSS and safety briefing.	SJ/NJ/AS/JH
11/14/13 0720	Performed daily instrument source checks for the 2221 meters AA, DD and FF and 2360 meters B and D. All FSS meters successfully passed the source check.	
11/14/13 0830	N. Jordan, J. Hoffman, verified that the isolation and control measure were in place and continued FSS walkovers in LSA 10-06. During the GWS, GPS data files LSA_1006_111413_AA, LSA_1006_111413_AA_2, LSA_1006_111413_DD & LSA_1006_111413_DD_2 were created. No anomalous readings were noted during the walkovers. See surveys 4367 C 131114 & 4334 C 131114 for more detailed information.	
11/14/13 1610	Returned to the office to download GWS data and complete survey documentation.	
11/14/13 1630	Post-checks performed on all FSS meters that were used. All meters passed successfully. END SJ/NJ/JH/AS	

FSS Field Log __ of __

HDP-PR-FSS-701, Final Status Survey Plan Development
APPENDIX P-6
FSS FIELD LOG

Survey Area: <u>LSA-10</u>	Description: <u>Burial Pit Open Land Area</u>
Survey Unit: <u>06 & 10</u>	Description: <u>Section 06 & 10</u>

FSS Field Log:

<u>Date/Time:</u>	<u>Observation or Comment:</u>	<u>Technician</u>
11/15/13 0630	Received our daily FSS and safety briefing.	SJ/NJ/AS/JH
11/15/13 0710	Performed daily instrument source checks for the 2221 meters AA, DD and FF and 2360 meters B and D. All FSS meters successfully passed the source check.	
11/15/13 0730	A. Schooley and S. Jenkins entered LSA 10-10 to pull Pre-FSS/RASS Biased and systematic samples.	
11/15/13 0815	N. Jordan, J. Hoffman, verified that the isolation and control measure were in place and continued FSS walkovers in LSA 10-06. During the GWS, GPS data files LSA_1006_111513_AA & LSA_1006_111513_DD were created. No anomalous readings were noted during the walkovers. See surveys 4369 C 131115 & 4382 C 131115 for more detailed information.	
11/15/13 1300	N. Jordan and J. Hoffman entered LSA 10-06 to survey the base and sidewalls of the small VOC pit in the northern section of the LSA. During the GWS, the GPS data file LSA_1006_111513_DD_HOLE was created. No anomalous readings were noted during the walkover. See survey 4368 C 131115 for more detailed information.	
11/15/13 1530	Completed soil sampling for the day in LSA 10-10. The following samples were Completed and secured.	

Sample ID

Biased

7214-RA-131114-09-01
 7214-RA-131114-09-03

Systematic

7213-RA-131114-09-04
 7213-RA-131114-09-05

See survey 4341 C 131115 for more detailed information.

FSS Field Log __ of __

HDP-PR-FSS-701, Final Status Survey Plan Development
APPENDIX P-6
FSS FIELD LOG

Survey Area:	<u>LSA-10</u>	Description:	<u>Burial Pit Open Land Area</u>
Survey Unit:	<u>06 & 10</u>	Description:	<u>Section 06 & 10</u>

FSS Field Log:

<u>Date/Time:</u>	<u>Observation or Comment:</u>	<u>Technician</u>
11/15/13 1610	Returned to the office to download GWS data and complete survey documentation.	SJ/NJ/JH/AS
11/15/13 1630	Post-checks performed on all FSS meters that were used. All meters passed successfully.	
	END SJ/NJ/JH/AS	

FSS Field Log __ of __

HDP-PR-FSS-701, Final Status Survey Plan Development
APPENDIX P-6
FSS FIELD LOG

Survey Area: <u>LSA-10</u>	Description: <u>Burial Pit Open Land Area</u>
Survey Unit: <u>06 & 10</u>	Description: <u>Section 06 & 10</u>

FSS Field Log:

<u>Date/Time:</u>	<u>Observation or Comment:</u>	<u>Technician</u>
11/18/13 0630	Received our daily FSS and safety briefing.	SJ/NJ/AS/JH
11/18/13 0700	Performed daily instrument source checks for the 2221 meters AA, DD and FF and 2360 meters B and D. All FSS meters successfully passed the source check.	
11/18/13 0715	A. Schooley and S. Jenkins and N. Jordan entered LSA 10-10 to continue the soil sampling efforts for Pre-FSS/RASS Biased and systematic samples.	
11/18/13 0815	J. Hoffman, verified that the isolation and control measures were in place and continued on the last portion of FSS walkover in LSA 10-06.	
11/18/13 1100	J. Hoffman completed the GWS of LSA 10-06 and returned to the office to perform the data download and survey documentation. During the GWS, GPS data files LSA_1006_111813_AA was created. No anomalous readings were noted during the walkover. See surveys 4370 C 131118 for more detailed information.	
11/18/13 1115	A. Schooley, S. Jenkins and N. Jordan completed soil sampling within LSA 10-10. Transferred all samples to the lab for analysis. The following samples were pulled During today. <div style="text-align: center;"> <p>Sample ID</p> <p>Biased</p> <p>7214-RA-131114-09-02</p> <p>Systematic</p> <p>7213-RA-131114-09-01</p> <p>7213-RA-131114-09-02</p> <p>7213-RA-131114-09-03</p> <p>7213-RA-131114-09-06</p> </div> <p>See survey 4363 C 131118 for more detailed information.</p>	
11/18/13 1300	Received the FSS instruction briefing from M. Bresnahan for LSA 10-07.	

HDP-PR-FSS-701, Final Status Survey Plan Development
APPENDIX P-6
FSS FIELD LOG

Survey Area:	<u>LSA-10</u>	Description:	<u>Burial Pit Open Land Area</u>
Survey Unit:	<u>06 & 10</u>	Description:	<u>Section 06 & 10</u>

FSS Field Log:

<u>Date/Time:</u>	<u>Observation or Comment:</u>	<u>Technician</u>
11/18/13 1400	Performed survey documentation and statistical analysis of GWS data.	SJ/NJ/JH/AS
11/18/13 1630	Post-checks performed on all FSS meters that were used. All meters passed successfully.	
	END SJ/NJ/JH/AS	

FSS Field Log __ of __

HDP-PR-FSS-701, Final Status Survey Plan Development
APPENDIX P-6
FSS FIELD LOG

Survey Area: <u>LSA-10</u>	Description: <u>Burial Pit Open Land Area</u>
Survey Unit: <u>06 & 07</u>	Description: <u>Section 06 & 07</u>

FSS Field Log:

<u>Date/Time:</u>	<u>Observation or Comment:</u>	<u>Technician</u>
11/25/13 0630	Received our daily FSS and safety briefing.	SJ/NJ/AS/JH
11/25/13 0700	Performed daily instrument source checks for the 2221 meters AA, DD and FF and 2360 meters B and D. All FSS meters successfully passed the source check.	
11/25/13 0800	A. Schooley, J. Hoffman and N. Jordan verified that the isolation and control measures were in place and continued FSS walkovers in LSA 10-07.	
11/25/13 1100	A. Schooley, J. Hoffman and N. Jordan completed sections of the GWS of LSA 10-07 and returned to the office to perform mid-day instrument source checks, Download the data and document the surveys. During the GWS, the following GPS data files were created: LSA_1007_112513_AA, LSA_1007_112513_DD and LSA_1007_112513_FF. No anomalous readings were noted during the walkovers. See surveys 4453 C 131125 and 4454 C 131125 for more detailed information.	
11/25/13 1300	Received the FSS instruction briefing from S. Jenkins for Biased Sampling in LSA 10-06.	
11/25/13 1400	J. Hoffman and N. Jordan verified that the isolation and control measures were in place and continued FSS walkovers in LSA 10-07. The walkovers consisted of GPS walkovers of the flat surfaces and manual walkovers of the sidewalls. The GPS walkovers created the following file: LSA_1007_112513_AA_2. See survey 4470 C 131125 for more detailed information.	
11/25/13 1430	A. Schooley proceeded to LSA 10-06 and verified that the isolation and control measures were in place. Sample location flags were placed and sampling equipment was staged and restocked for tomorrow's sampling activities.	
11/25/13 1600	A. Schooley, J. Hoffman and N. Jordan returned to the office to download data And perform survey documentation.	
11/25/13 1640	Post-checks performed on all FSS meters that were used. All meters passed successfully.	
	END SJ/NJ/JH/AS	

FSS Field Log __ of __

HDP-PR-FSS-701, Final Status Survey Plan Development
APPENDIX P-6
FSS FIELD LOG

Survey Area: <u>LSA-10</u>	Description: <u>Burial Pit Open Land Area</u>
Survey Unit: <u>06 & 07</u>	Description: <u>Section LSA 10-06 & 10-07</u>

FSS Field Log:

<u>Date/Time:</u>	<u>Observation or Comment:</u>	<u>Technician</u>
11/26/13 0630	Received daily safety and FSS briefing.	SJ/NJ/JH/AS
11/26/13 0715	Performed daily instrument source checks for FSS meters. All meters successfully passed the source check.	
11/26/13 0820	A. Gayler and M. Dekeyser began manual GWS in the former stockpile 5 & 6 areas.	AG/MD
11/26/13 0930	A. Schooley and S. Jenkins verified that the isolation and controls were in place for LSA 10-06 and 10-07 and began systematic soil sampling in LSA 10-06. J. Hoffman and N. Jordan began FSS GWS in LSA 10-07.	
11/26/13 1100	A. Gayler and M. Dekeyser completed the manual GWS of former stockpile 5 & 6 area. See survey 4476 C 131126 for more detailed information.	AG/MD
11/26/13 1300	J. Hoffman and N. Jordan continued GWS in LSA 10-07. A. Schooley and S. Jenkins continued systematic soil sampling in LSA 10-06.	
11/26/13 1430	A. Schooley and S. Jenkins completed systematic sampling in LSA 10-06. The following samples were completed.	
	Sample ID	
	L100601BES00	
	L100602BES00	
	L100603BES00	
	L100604BES00	
	L100605BRS00	
	L100605BRQ00	
	L100606BES00	
	L100607BES00	
	L100608BES00	
	L100609BES00	
	See survey 4490 C 131126 for more detailed information.	
11/26/13 1510	A. Schooley and S. Jenkins entered LSA 10-07 to begin systematic soil sampling	

FSS Field Log __ of __

HDP-PR-FSS-701, Final Status Survey Plan Development
APPENDIX P-6
FSS FIELD LOG

Survey Area:	<u>LSA-10</u>	Description:	<u>Burial Pit Open Land Area</u>
Survey Unit:	<u>06 & 07</u>	Description:	<u>Section LSA 10-06 & 10-07</u>

FSS Field Log:

<u>Date/Time:</u>	<u>Observation or Comment:</u>	<u>Technician</u>
11/26/13 1600	J. Hoffman and N. Jordan completed GWS in LSA 10-07 for the day. Returned to the office to download data and document surveys. See survey 4540 C 131126 for more detailed information.	SJ/NJ/JH/AS
11/26/13 1615	A. Schooley and S. Jenkins completed systematic sampling for the day in LSA 10-07. The following four samples were pulled: Sample ID L100702BES00 L100705BES00 L100709BRS00 L100710BES00 See survey 4491 C 131126 for more detailed information.	
11/26/13 1640	Performed post checks on FSS meter. All meter passed successfully. END SJ/NJ/JH/AS	

FSS Field Log __ of __

Westinghouse Non-Proprietary Class 3

Pg 2 of 4

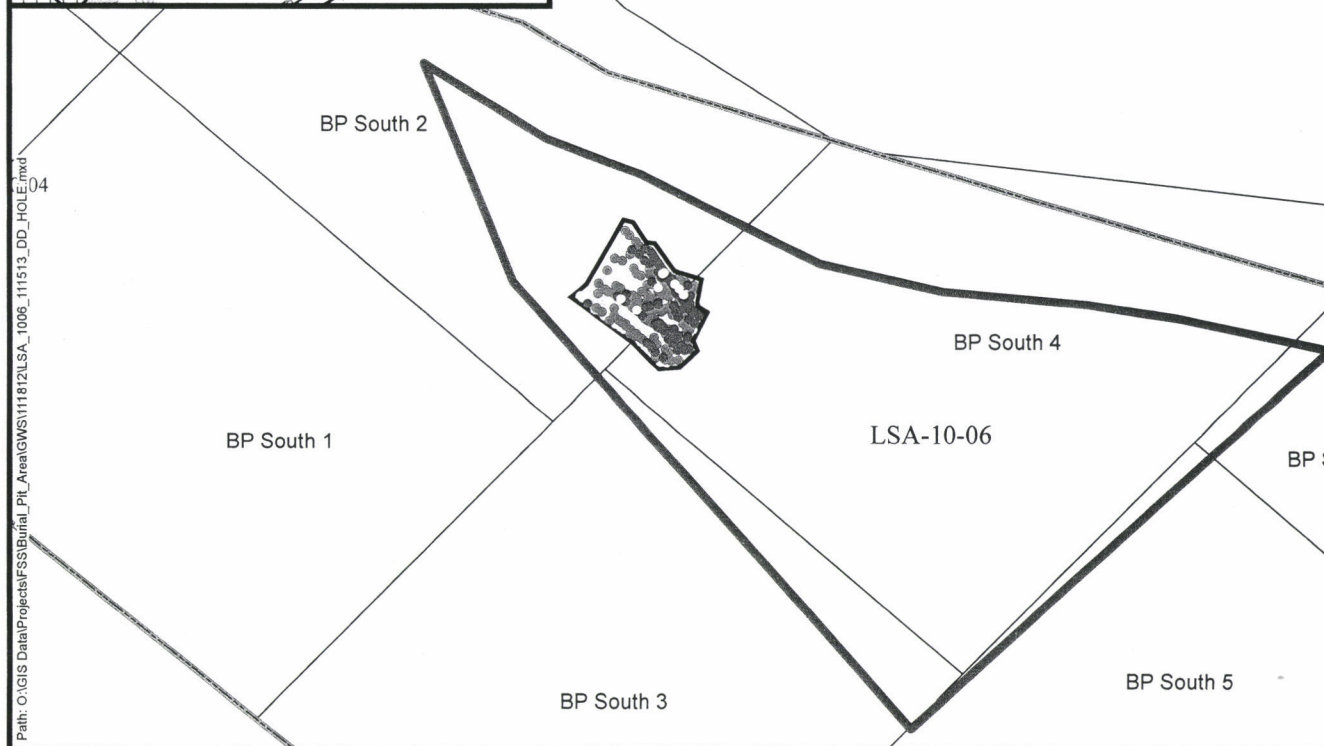
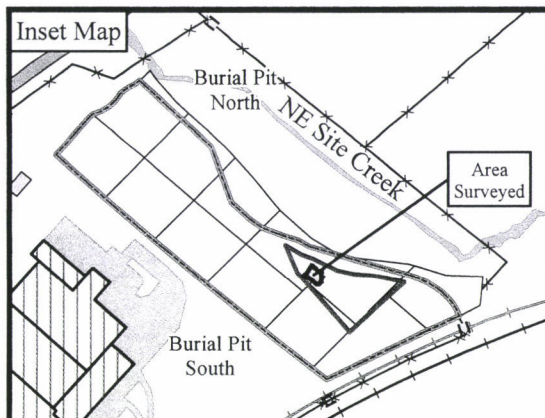

LEGEND:

CPM (Max 9292 gcpm)

<Mean

- 7402 - 8057
- 8058 - 8713
- 8714 - 9369
- >9369

Survey Extent

Excavation SU Boundary

FSS Survey Unit

NCS Controls Boundary

Surface Water



0 20 40 Feet

Probe DD - Hole
LSA-10-06
Burial Pit Area
FFS Gamma Walkover Survey

Requested By:
M. Bresnahan

Document/Reason:
Burial Pit GWS Survey

Hematite Decommissioning Project
Jefferson County
Hematite, MO

Prepared By:
DJH

Rev:
0

Size:
8.5x11

Date:
11-15-13

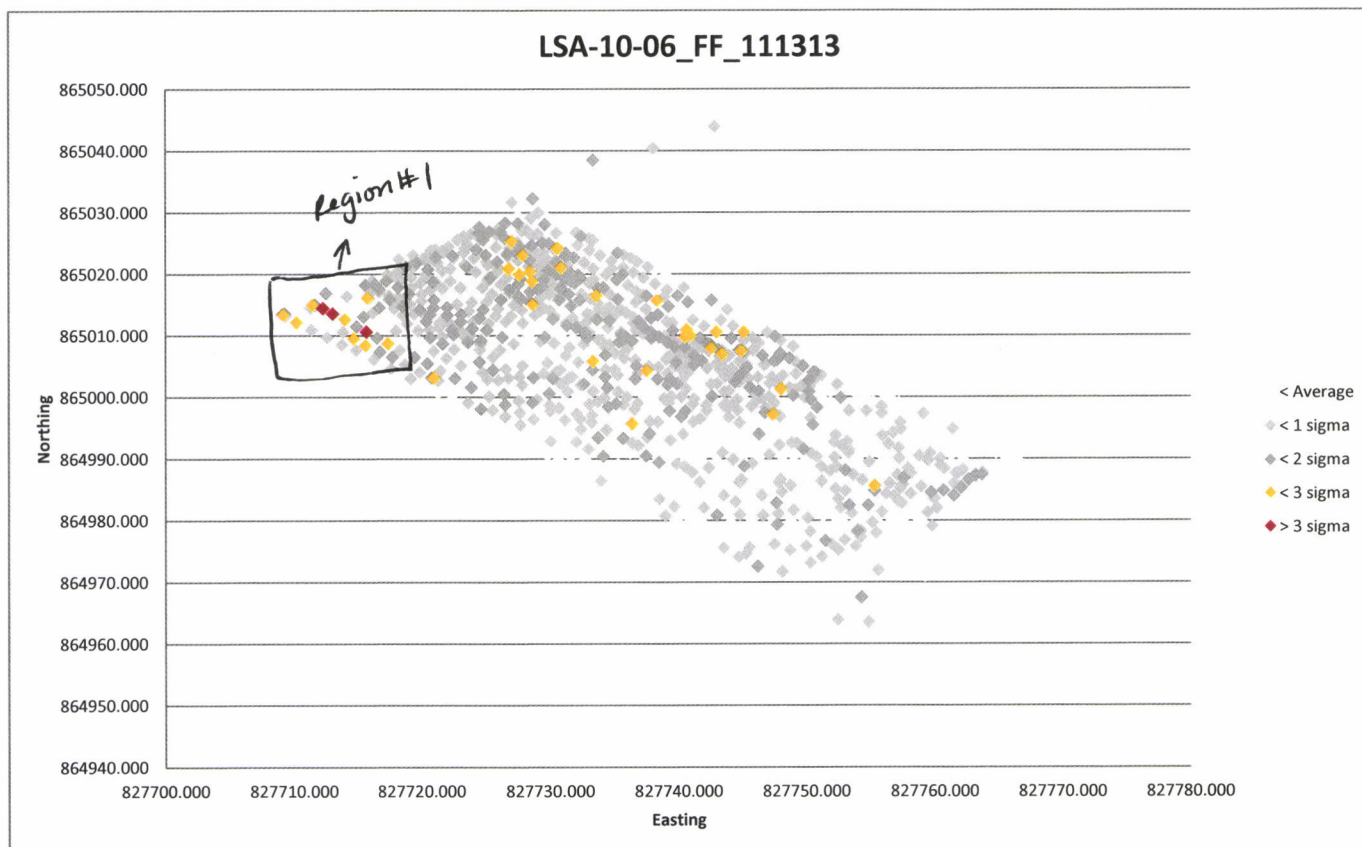

Region #1: Perform a GWS of the general area and look and listen for anomalous readings.

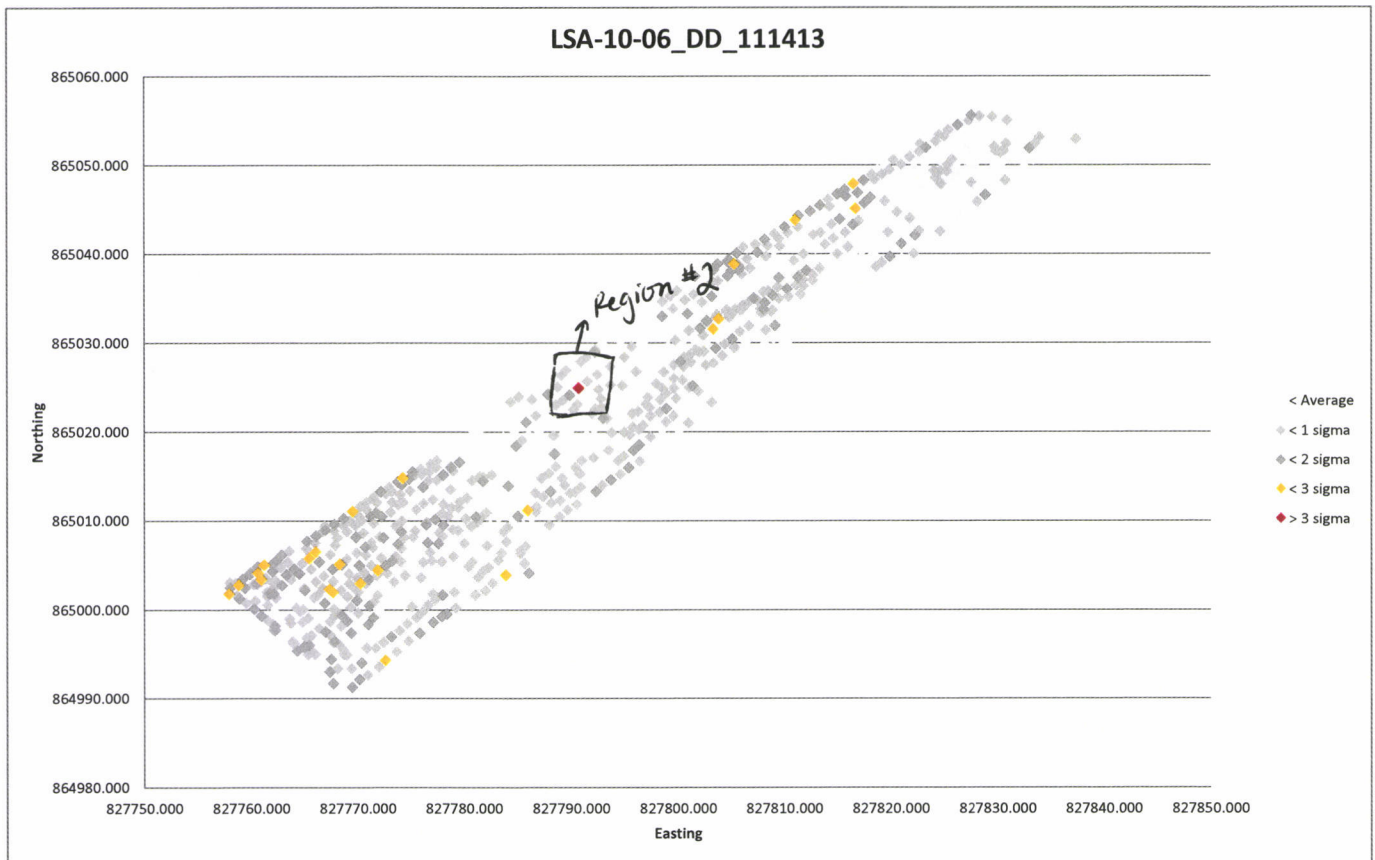

Region #2: Perform a GWS of the general area and look and listen for anomalous readings.

HDP-PR-FSS-701, Final Status Survey Plan Development
APPENDIX P-6
FSS FIELD LOG

Survey Area: <u>LSA-10</u>	Description: <u>Burial Pit Open Land Area</u>
Survey Unit: <u>06 & 07</u>	Description: <u>Section LSA 10-06 & 10-07</u>

FSS Field Log:

<u>Date/Time:</u>	<u>Observation or Comment:</u>	<u>Technician</u>														
12/03/13 0630	Received daily safety and FSS briefing.	SJ/JH/AS/NJ														
12/03/13 0715	Performed daily instrument source checks for FSS meters. All meters successfully passed the source check.															
12/03/13 0810	N. Jordan and J. Hoffman verified that isolation and controls were in place in LSA 10-10 and began performing GWS of the area.															
12/03/13 1300	S. Jenkins and A. Schooley entered LSA 10-06 and 10-07 to perform biased soil sampling activities.															
12/03/13 1600	N. Jordan and J. Hoffman completed FSS GWS for the day in LSA 10-10. Returned to the office to download data and document the surveys. See the following surveys for more detailed information: 4549 C 131203, 4550 C 131203, 4551 C 131203															
12/03/13 1615	S. Jenkins and A. Schooley completed biased soil sampling in LSA 10-06 and LSA 10-07. The following samples were pulled: <table border="0" style="margin-left: 40px;"> <tr> <td style="text-align: left;"><u>10-06 Sample ID</u></td> <td style="text-align: left;"><u>10-07 Sample ID</u></td> </tr> <tr> <td>L100610BUB00</td> <td>L100715BUB00</td> </tr> <tr> <td>L100611BUB00</td> <td>L100701BUI01</td> </tr> <tr> <td>L100612BUB00</td> <td>L100701BUI02</td> </tr> <tr> <td></td> <td>L100701BUI03</td> </tr> <tr> <td></td> <td>L100701BUI04</td> </tr> <tr> <td></td> <td>L100716BUB00</td> </tr> </table> See surveys 4570 C 131203 and 4571 C 131203	<u>10-06 Sample ID</u>	<u>10-07 Sample ID</u>	L100610BUB00	L100715BUB00	L100611BUB00	L100701BUI01	L100612BUB00	L100701BUI02		L100701BUI03		L100701BUI04		L100716BUB00	
<u>10-06 Sample ID</u>	<u>10-07 Sample ID</u>															
L100610BUB00	L100715BUB00															
L100611BUB00	L100701BUI01															
L100612BUB00	L100701BUI02															
	L100701BUI03															
	L100701BUI04															
	L100716BUB00															
12/03/13 1630	Performed post checks on FSS meter. All meters passed successfully. END SJ/JH/AS/NJ															

FSS Field Log __ of __

HDP-PR-FSS-701, Final Status Survey Plan Development
APPENDIX P-6
FSS FIELD LOG

Survey Area: <u>LSA-10</u>	Description: <u>Burial Pit Open Land Area</u>
Survey Unit: <u>06 & 07</u>	Description: <u>Section 06 & 07</u>

FSS Field Log:

<u>Date/Time:</u>	<u>Observation or Comment:</u>	<u>Technician</u>
11/07/13 0630	Received our daily FSS and safety briefing.	SJ/NJ/AS/JH
11/07/13 0710	Performed daily instrument source checks for the 2221 meters AA, DD and FF and 2360 meters B and D. All FSS meters successfully passed the source check.	
11/07/13 0800	N. Jordan and J. Hoffman assembled backpacks and proceeded to LSA 10-06 to begin GWS.	
11/07/13 0820	A Schooley and S. Jenkins prepared supplies & paperwork and proceeded to LSA 10-07 to begin Pre-FSS/RASS sampling on LSA 10-07. Verified that the isolation and controls were in place before beginning work in the area.	
11/07/13 1300	N. Jordan and J. Hoffman continued the GWS walkovers in LSA 10-06. The following map files were created from the GWS data. LSA_1006_110713_AA, LSA_1006_110713_AA_2, LSA_1006_110713_DD & LSA_1007_110713_DD_2. See surveys 4366C131107 & 4225C131107 for more information.	
11/07/13 1320	After restocking with supplies, A. Schooley and S. Jenkins continued Pre-FSS and RASS sampling in LSA 10-07. The following samples were pulled.	
	Sample ID	
	7121-RA-131107-05-03	
	7121-RA-131107-05-04	
	7121-RA-131107-05-05	
	7121-RA-131107-05-06	
	7121-RA-131107-05-07	
	7121-RA-131107-05-08	
	7121-RA-131107-05-09	
	7121-RA-131107-05-10	
	7121-RA-131107-05-11	
	7121-RA-131107-05-12	
	7121-RA-131107-05-13	
	7121-RA-131107-05-14	
	7121-RA-131107-05-15	
	7121-RA-131107-05-16	

See survey 4226 C 131107 for more detailed information.

FSS Field Log __ of __

HDP-PR-FSS-701, Final Status Survey Plan Development
APPENDIX P-6
FSS FIELD LOG

Survey Area:	<u>LSA-10</u>	Description:	<u>Burial Pit Open Land Area</u>
Survey Unit:	<u>06 & 07</u>	Description:	<u>Section 06 & 07</u>

FSS Field Log:

<u>Date/Time:</u>	<u>Observation or Comment:</u>	<u>Technician</u>
11/08/13 0630	Received our daily FSS and safety briefing.	SJ/NJ/AS/JH
11/08/13 0710	Performed daily instrument source checks for the 2221 meters AA, DD and FF and 2360 meters B and D. All FSS meters successfully passed the source check.	
11/08/13 0800	N. Jordan performed statistical analysis on walkover data from 11/07/13.	
11/08/13 0900	J. Hoffman, A. Schooley and S. Jenkins performed walk-down of Iso-Pacific sorter area and assisted with setup and configuration input.	
11/08/13 1300	J. Hoffman and S. Jenkins installed Isolation and Controls around LSA 10-06 including rope, signage and plastic wrapped waddles to control water run-off into the area from other areas. A. Schooley and N. Jordan verified that the isolation and controls were in place and continued Pre-FSS/ RASS sampling in LSA 10-07.	
11/08/13 1600	Completed sampling activities for the day in LSA 10-07. The following samples were pulled. Sample ID 7121-RA-131107-05-01 7121-RA-131107-05-02 See survey 4227 C 131107 for more detailed information.	
11/08/13 1630	Completed installing I&C in LSA 10-06 and completed general housekeeping in the area to prepare it for FSS starting next week. Post-checks performed on all FSS meters that were used. All meters passed successfully. END SJ/NJ/AS/JH	

HDP-PR-FSS-701, Final Status Survey Plan Development
APPENDIX P-6
FSS FIELD LOG

Survey Area:	<u>LSA-10</u>	Description:	<u>Burial Pit Open Land Area</u>
Survey Unit:	<u>07</u>	Description:	<u>Section 07</u>

FSS Field Log:

<u>Date/Time:</u>	<u>Observation or Comment:</u>	<u>Technician</u>
11/11/13 0630	Received our daily FSS and safety briefing.	SJ/NJ/AS/JH
11/11/13 0710	Performed daily instrument source checks for the 2221 meters AA, DD and FF and 2360 meters B and D. All FSS meters successfully passed the source check.	
11/11/13 0830	N. Jordan, J. Hoffman, A. Schooley verified that the isolation and controls were in place and continued Pre-FSS/ RASS sampling in LSA 10-07.	
11/11/13 1000	J. Hoffman was pulled to complete a release survey for a dump truck to be used in the movement of Stockpile 2 soil to the north lay-down area. See survey 4262 C 131111 for more detailed information.	
11/11/13 1300	N. Jordan, J. Hoffman and A. Schooley continued Pre-FSS/ RASS sampling in LSA 10-07.	
11/11/13 1600	Completed sampling activities in LSA 10-07. The following samples were pulled. <div style="text-align: center;">Sample ID 7121-RA-131107-05-17 7121-RA-131107-05-18 7121-RA-131107-05-19 7121-RA-131107-05-20 7121-RA-131107-05-21 7121-RA-131107-05-22 7121-RA-131107-05-23 7121-RA-131107-05-24 7121-RA-131107-05-25 7121-RA-131107-05-26 7121-RA-131107-05-27 7121-RA-131107-05-28</div> See survey 4266 C 131111 for more detailed information.	
11/11/13 1630	Post-checks performed on all FSS meters that were used. All meters passed successfully. END SJ/NJ/JH/AS	

FSS Field Log __ of __

HDP-PR-FSS-701, Final Status Survey Plan Development
APPENDIX P-6
FSS FIELD LOG

Survey Area: <u>LSA-10 & LSA 12</u>	Description: <u>Burial Pit Open Land Area / Stockpile Area</u>
Survey Unit: <u>10-07 & 12-06</u>	Description: <u>Section LSA 10-07 & LSA 12-06</u>

FSS Field Log:

<u>Date/Time:</u>	<u>Observation or Comment:</u>	<u>Technician</u>
11/19/13 0630	Received our daily FSS and safety briefing.	SJ/NJ/AS/JH
11/19/13 0730	Performed daily instrument source checks for the 2221 meters AA, DD and FF and 2360 meters B and D. All FSS meters successfully passed the source check.	
11/19/13 0815	A. Schooley performed a second manual GWS in LSA 12-06 near stockpile 1 to Verify that the surface is clean before placing screened reuse material in the area. The area is expanding as stockpile 1 gets processed through the screener and more area beneath it is exposed and ready for walkover. See survey 4403 C 131119 for more detailed information.	
11/19/13 0830	J. Hoffman and N. Jordan verified that the isolation and controls were in place and conducted FSS walkovers in LSA 10-07.	
11/19/13 1100	J. Hoffman and N. Jordan completed a section of FSS GWS in LSA 10-07. Returned to the office to download the data and perform mid-day source check of the instruments. The GWS created GPS map files: LSA_1007_111913_DD. See survey 4386 C 131119 for more detailed information.	
11/19/13 1130	A. Schooley completed the manual GWS in LSA 12-06. No anomalous readings were found. See survey 4403 C 131119 for more detailed information.	
11/19/13 1300	J. Hoffman proceeded to LSA 10-07 to perform FSS GWS of the area.	
11/19/13 1600	J. Hoffman completed a section of FSS GWS in LSA 10-07. Returned to the office to download the data and document the surveys The GWS created GPS maps: LSA_1007_111913_AA and LSA_1007111913_AA_2. See survey 4407 C 131119 for more detailed information.	
11/19/13 1630	Post checks performed on all FSS meters that were used. All meters passed successfully. END SJ/NJ/JH/AS	

FSS Field Log __ of __

HDP-PR-FSS-701, Final Status Survey Plan Development
APPENDIX P-6
FSS FIELD LOG

Survey Area:	<u>LSA-10 & LSA 12</u>	Description:	<u>Burial Pit Open Land Area / Stockpile Area</u>
Survey Unit:	<u>10-07 & 12-06</u>	Description:	<u>Section LSA 10-07 & LSA 12-06</u>

FSS Field Log:

<u>Date/Time:</u>	<u>Observation or Comment:</u>	<u>Technician</u>
--------------------------	---------------------------------------	--------------------------

11/20/13 0630	Received our daily FSS and safety briefing.	SJ/NJ/AS/JH
---------------	---	-------------

11/20/13 0720	Performed daily instrument source checks for the 2221 meters AA, DD and FF and 2360 meters B and D. All FSS meters successfully passed the source check.	
---------------	--	--

11/20/13 0830	J. Hoffman and N. Jordan verified that the isolation and controls were in place and conducted FSS walkovers in LSA 10-07.	
---------------	---	--

11/20/13 0900	A. Schooley performed biased soil sampling LSA 12-06 near stockpile 1. The soil Sample was then transported to the on-site lab for analysis. The sample information is as follows:	
---------------	--	--

Sample ID	Easting	Northing
7250-SS-131120-14-01	827880.340	865513.070

See survey 4404 C 131120 for more detailed information.

11/20/13 1600	J. Hoffman and N. Jordan completed a section of FSS GWS in LSA 10-07. Returned to the office to download the data and document the surveys. The GWS created GPS map file: LSA_1007_112013_DD.	
---------------	---	--

See survey 4409 C 131120 for more detailed information.

11/20/13 1630	Post checks performed on all FSS meters that were used. All meters passed successfully.	
---------------	---	--

END SJ/NJ/JH/AS

FSS Field Log __ of __

HDP-PR-FSS-701, Final Status Survey Plan Development
APPENDIX P-6
FSS FIELD LOG

Survey Area:	<u>LSA-10</u>	Description:	<u>Burial Pit Open Land Area</u>
Survey Unit:	<u>10-07</u>	Description:	<u>Section LSA 10-07</u>

FSS Field Log:

<u>Date/Time:</u>	<u>Observation or Comment:</u>	<u>Technician</u>
11/22/13 0630	Received our daily FSS and safety briefing.	NJ/AS
11/22/13 0720	Performed daily instrument source checks for the 2221 meters AA, DD and FF and 2360 meters B and D. All FSS meters successfully passed the source check.	
11/22/13 0830	A. Schooley and N. Jordan verified that the isolation and controls were in place and conducted FSS walkovers in LSA 10-07.	
11/22/13 1330	A. Schooley and N. Jordan completed a section of FSS GWS in LSA 10-07. Returned to the office to download the data and document the surveys. The GWS created GPS map files: LSA_1007_112213_DD and LSA_1007_112213_FF. See surveys 4429 C 131122, 4436 C 131122 for more detailed information.	
11/22/13 1630	Post checks performed on all FSS meters that were used. All meters passed successfully. END NJ/AS	

FSS Field Log __ of __

HDP-PR-FSS-701, Final Status Survey Plan Development
APPENDIX P-6
FSS FIELD LOG

Survey Area:	<u>LSA-10</u>	Description:	<u>Burial Pit Open Land Area</u>
Survey Unit:	<u>10-07</u>	Description:	<u>Section LSA 10-07</u>

FSS Field Log:

<u>Date/Time:</u>	<u>Observation or Comment:</u>	<u>Technician</u>
11/24/13 1200	Performed daily instrument source checks for the 2221 meter FF. FSS meter successfully passed the source check.	AS
11/24/13 1230	A. Schooley verified that the isolation and controls were in place and conducted FSS walkovers in LSA 10-07.	
11/24/13 1400	A. Schooley completed a section of FSS GWS in LSA 10-07. Returned to the office to download the data and document the surveys. The GWS created GPS map files: LSA_1007_112213_DD and LSA_1007_112213_FF. See surveys 4429 C 131122, 4436 C 131122 for more detailed information.	
11/24/13 1430	Post checks performed on FSS meter. Meter passed successfully. END AS	

FSS Field Log __ of __

HDP-PR-FSS-701, Final Status Survey Plan Development
APPENDIX P-6
FSS FIELD LOG

Survey Area: <u>LSA-10</u>	Description: <u>Burial Pit Open Land Area</u>
Survey Unit: <u>06 & 07</u>	Description: <u>Section 06 & 07</u>

FSS Field Log:

<u>Date/Time:</u>	<u>Observation or Comment:</u>	<u>Technician</u>
11/25/13 0630	Received our daily FSS and safety briefing.	SJ/NJ/AS/JH
11/25/13 0700	Performed daily instrument source checks for the 2221 meters AA, DD and FF and 2360 meters B and D. All FSS meters successfully passed the source check.	
11/25/13 0800	A. Schooley, J. Hoffman and N. Jordan verified that the isolation and control measures were in place and continued FSS walkovers in LSA 10-07.	
11/25/13 1100	A. Schooley, J. Hoffman and N. Jordan completed sections of the GWS of LSA 10-07 and returned to the office to perform mid-day instrument source checks, Download the data and document the surveys. During the GWS, the following GPS data files were created: LSA_1007_112513_AA, LSA_1007_112513_DD and LSA_1007_112513_FF. No anomalous readings were noted during the walkovers. See surveys 4453 C 131125 and 4454 C 131125 for more detailed information.	
11/25/13 1300	Received the FSS instruction briefing from S. Jenkins for Biased Sampling in LSA 10-06.	
11/25/13 1400	J. Hoffman and N. Jordan verified that the isolation and control measures were in place and continued FSS walkovers in LSA 10-07. The walkovers consisted of GPS walkovers of the flat surfaces and manual walkovers of the sidewalls. The GPS walkovers created the following file: LSA_1007_112513_AA_2. See survey 4470 C 131125 for more detailed information.	
11/25/13 1430	A. Schooley proceeded to LSA 10-06 and verified that the isolation and control measures were in place. Sample location flags were placed and sampling equipment was staged and restocked for tomorrow's sampling activities.	
11/25/13 1600	A. Schooley, J. Hoffman and N. Jordan returned to the office to download data And perform survey documentation.	
11/25/13 1640	Post-checks performed on all FSS meters that were used. All meters passed successfully. END SJ/NJ/JH/AS	

FSS Field Log __ of __

HDP-PR-FSS-701, Final Status Survey Plan Development
APPENDIX P-6
FSS FIELD LOG

Survey Area: <u>LSA-10</u>	Description: <u>Burial Pit Open Land Area</u>
Survey Unit: <u>06 & 07</u>	Description: <u>Section LSA 10-06 & 10-07</u>

FSS Field Log:

<u>Date/Time:</u>	<u>Observation or Comment:</u>	<u>Technician</u>
11/26/13 0630	Received daily safety and FSS briefing.	SJ/NJ/JH/AS
11/26/13 0715	Performed daily instrument source checks for FSS meters. All meters successfully passed the source check.	
11/26/13 0820	A. Gayler and M. Dekeyser began manual GWS in the former stockpile 5 & 6 areas.	AG/MD
11/26/13 0930	A. Schooley and S. Jenkins verified that the isolation and controls were in place for LSA 10-06 and 10-07 and began systematic soil sampling in LSA 10-06. J. Hoffman and N. Jordan began FSS GWS in LSA 10-07.	
11/26/13 1100	A. Gayler and M. Dekeyser completed the manual GWS of former stockpile 5 & 6 area. See survey 4476 C 131126 for more detailed information.	AG/MD
11/26/13 1300	J. Hoffman and N. Jordan continued GWS in LSA 10-07. A. Schooley and S. Jenkins continued systematic soil sampling in LSA 10-06.	
11/26/13 1430	A. Schooley and S. Jenkins completed systematic sampling in LSA 10-06. The following samples were completed.	
	Sample ID	
	L100601BES00	
	L100602BES00	
	L100603BES00	
	L100604BES00	
	L100605BRS00	
	L100605BRQ00	
	L100606BES00	
	L100607BES00	
	L100608BES00	
	L100609BES00	
	See survey 4490 C 131126 for more detailed information.	
11/26/13 1510	A. Schooley and S. Jenkins entered LSA 10-07 to begin systematic soil sampling	

FSS Field Log __ of __

HDP-PR-FSS-701, Final Status Survey Plan Development
APPENDIX P-6
FSS FIELD LOG

Survey Area:	<u>LSA-10</u>	Description:	<u>Burial Pit Open Land Area</u>
Survey Unit:	<u>07</u>	Description:	<u>Section LSA 10-07</u>

FSS Field Log:

<u>Date/Time:</u>	<u>Observation or Comment:</u>	<u>Technician</u>
11/27/13 0630	Received daily safety and FSS briefing.	AS/NJ
11/27/13 0715	Performed daily instrument source checks for FSS meters. All meters successfully passed the source check.	
11/27/13 0915	A. Schooley verified that the isolation and controls were in place for LSA 10-07 and continued systematic soil sampling.	
11/27/13 1545	A. Schooley completed systematic sampling in LSA 10-07. The following samples were completed: Sample ID L100703BSS00 L100704BRS00 L100704BRQ00 L100706BRS00 L100707BES00 L100708BES00 L100712BES00 L100713BRS00 L100714BES00 See survey 4501 C 131127 for more detailed information.	
11/27/13 1640	Performed post checks on FSS meter. All meter passed successfully. END AS/NJ	

FSS Field Log __ of __

HDP-PR-FSS-701, Final Status Survey Plan Development
APPENDIX P-6
FSS FIELD LOG

Survey Area: <u>LSA-10</u>	Description: <u>Burial Pit Open Land Area</u>
Survey Unit: <u>06 & 07</u>	Description: <u>Section LSA 10-06 & 10-07</u>

FSS Field Log:

<u>Date/Time:</u>	<u>Observation or Comment:</u>	<u>Technician</u>														
12/03/13 0630	Received daily safety and FSS briefing.	SJ/JH/AS/NJ														
12/03/13 0715	Performed daily instrument source checks for FSS meters. All meters successfully passed the source check.															
12/03/13 0810	N. Jordan and J. Hoffman verified that isolation and controls were in place in LSA 10-10 and began performing GWS of the area.															
12/03/13 1300	S. Jenkins and A. Schooley entered LSA 10-06 and 10-07 to perform biased soil sampling activities.															
12/03/13 1600	N. Jordan and J. Hoffman completed FSS GWS for the day in LSA 10-10. Returned to the office to download data and document the surveys. See the following surveys for more detailed information: 4549 C 131203, 4550 C 131203, 4551 C 131203															
12/03/13 1615	S. Jenkins and A. Schooley completed biased soil sampling in LSA 10-06 and LSA 10-07. The following samples were pulled: <table border="0" style="margin-left: 40px;"> <tr> <td style="text-align: left;"><u>10-06 Sample ID</u></td> <td style="text-align: left;"><u>10-07 Sample ID</u></td> </tr> <tr> <td>L100610BUB00</td> <td>L100715BUB00</td> </tr> <tr> <td>L100611BUB00</td> <td>L100701BUI01</td> </tr> <tr> <td>L100612BUB00</td> <td>L100701BUI02</td> </tr> <tr> <td></td> <td>L100701BUI03</td> </tr> <tr> <td></td> <td>L100701BUI04</td> </tr> <tr> <td></td> <td>L100716BUB00</td> </tr> </table> See surveys 4570 C 131203 and 4571 C 131203	<u>10-06 Sample ID</u>	<u>10-07 Sample ID</u>	L100610BUB00	L100715BUB00	L100611BUB00	L100701BUI01	L100612BUB00	L100701BUI02		L100701BUI03		L100701BUI04		L100716BUB00	
<u>10-06 Sample ID</u>	<u>10-07 Sample ID</u>															
L100610BUB00	L100715BUB00															
L100611BUB00	L100701BUI01															
L100612BUB00	L100701BUI02															
	L100701BUI03															
	L100701BUI04															
	L100716BUB00															
12/03/13 1630	Performed post checks on FSS meter. All meters passed successfully.															
	END SJ/JH/AS/NJ															

FSS Field Log __ of __

HDP-PR-FSS-701, Final Status Survey Plan Development
APPENDIX P-6
FSS FIELD LOG

Survey Area: LSA-10Description: Burial Pit Open Land AreaSurvey Unit: 06 & 07Description: Section LSA 10-06 & 10-07**FSS Field Log:**

<u>Date/Time:</u>	<u>Observation or Comment:</u>	<u>Technician</u>														
12/03/13 0630	Received daily safety and FSS briefing.	SJ/JH/AS/NJ														
12/03/13 0715	Performed daily instrument source checks for FSS meters. All meters successfully passed the source check.															
12/03/13 0810	N. Jordan and J. Hoffman verified that isolation and controls were in place in LSA 10-10 and began performing GWS of the area.															
12/03/13 1300	S. Jenkins and A. Schooley entered LSA 10-06 and 10-07 to perform biased soil sampling activities.															
12/03/13 1600	N. Jordan and J. Hoffman completed FSS GWS for the day in LSA 10-10. Returned to the office to download data and document the surveys. See the following surveys for more detailed information: 4549 C 131203, 4550 C 131203, 4551 C 131203															
12/03/13 1615	S. Jenkins and A. Schooley completed biased soil sampling in LSA 10-06 and LSA 10-07. The following samples were pulled:															
	<table border="0"> <thead> <tr> <th style="text-align: left;"><u>10-06 Sample ID</u></th> <th style="text-align: left;"><u>10-07 Sample ID</u></th> </tr> </thead> <tbody> <tr> <td>L100610BUB00</td> <td>L100715BUB00</td> </tr> <tr> <td>L100611BUB00</td> <td>L100701BUI01</td> </tr> <tr> <td>L100612BUB00</td> <td>L100701BUI02</td> </tr> <tr> <td></td> <td>L100701BUI03</td> </tr> <tr> <td></td> <td>L100701BUI04</td> </tr> <tr> <td></td> <td>L100716BUB00</td> </tr> </tbody> </table>	<u>10-06 Sample ID</u>	<u>10-07 Sample ID</u>	L100610BUB00	L100715BUB00	L100611BUB00	L100701BUI01	L100612BUB00	L100701BUI02		L100701BUI03		L100701BUI04		L100716BUB00	
<u>10-06 Sample ID</u>	<u>10-07 Sample ID</u>															
L100610BUB00	L100715BUB00															
L100611BUB00	L100701BUI01															
L100612BUB00	L100701BUI02															
	L100701BUI03															
	L100701BUI04															
	L100716BUB00															
	See surveys 4570 C 131203 and 4571 C 131203															
12/03/13 1630	Performed post checks on FSS meter. All meters passed successfully.															
	END SJ/JH/AS/NJ															

FSS Field Log __ of __

Survey Area:	LSA-10	Description:	Burial Pits Open Land Area
Survey Unit:	07	Description:	Section 7

[illegible]



- LEGEND:
- ★ Sample Location
 - FSS Survey Unit
 - BP Excavation Unit
 - NCS Controls Boundary
 - +— RR Spur
 - +— Railroad
 - ××× Fence
 - Gate Location

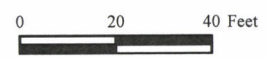
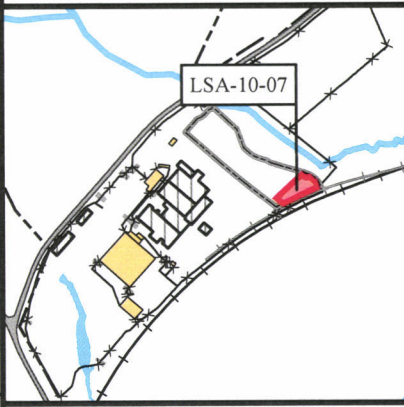

Sample Location
LSA-10-07

Requested By:
M. Bresnahan

Document/Reason:
Final Status Survey

Hematite Decommissioning Project
Jefferson County
Hematite, MO

Prepared By:
DJH

Rev:
0

Size:
8.5x11

Date:
12-03-13



Document Path: O:\GIS Data\Projects\FSS\Burial_Pit\Area\LSA_10_07\LSA_100701BUB00 Location.mxd

FSS Field log 2 of 3

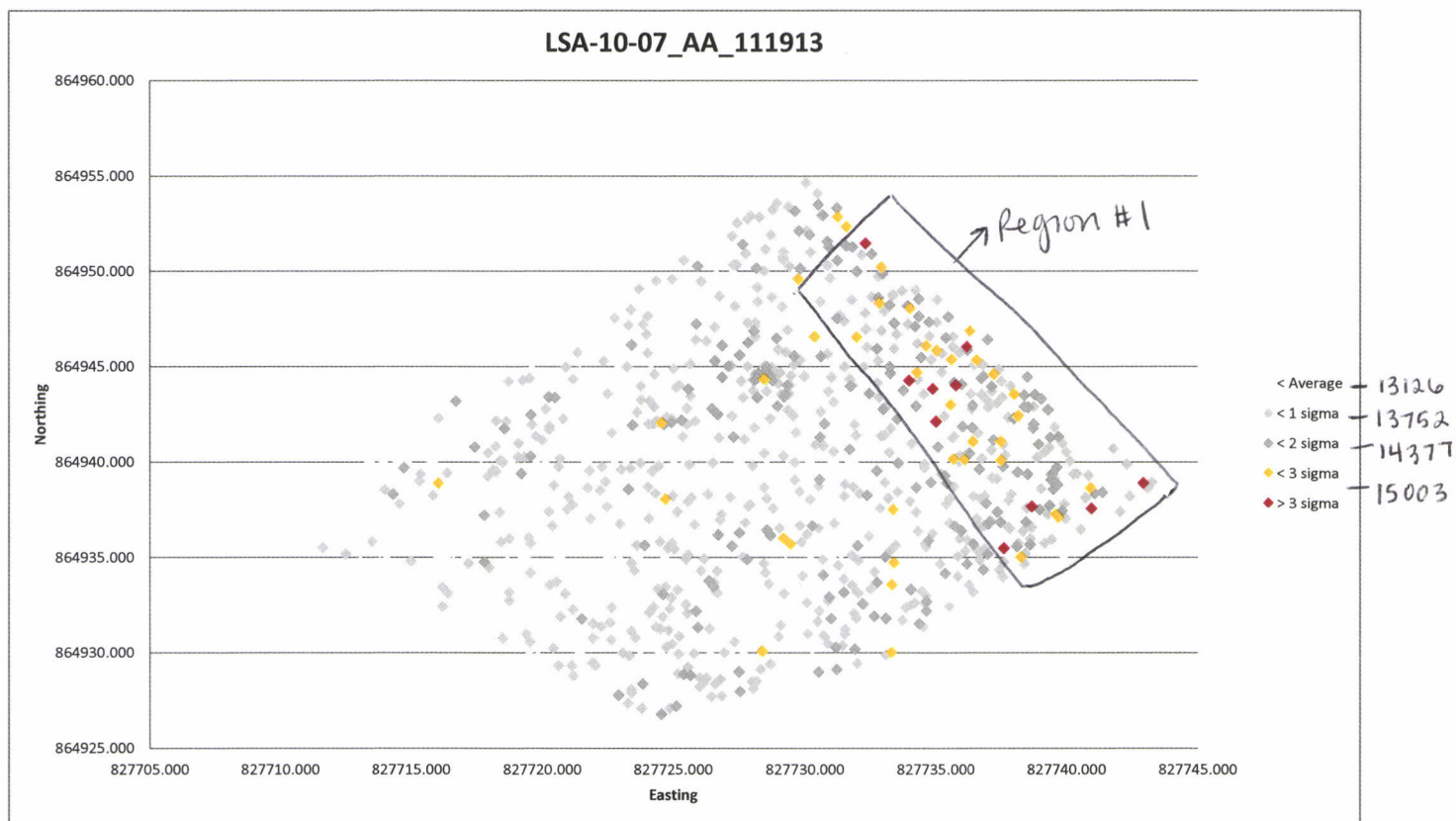

Region #1 : Perform a GWS of the general area and look and listen for anomalous readings.

HDP-PR-FSS-701, Final Status Survey Plan Development
APPENDIX P-6
FSS FIELD LOG

Survey Area: <u>LSA-10</u>	Description: <u>Burial Pits Open Land Area</u>	
Survey Unit: <u>08</u>	Description: <u>NE Corner of LSA 10-02 (Berm)</u>	

FSS Field Log:

<u>Date/Time:</u>	<u>Observation or Comment:</u>	<u>Technician</u>
7/31/13 0715	Performed daily Pre source check of FSS field instruments.	SDJ / JH

Performed GWS of LSA-10-08 (Bladder Dam Area) using handset A and 2221 DD. Six locations were flagged with readings of over 2,000cpm above the general area background of 10,000cpm.

Elevated soil locations were flagged and stored using GPS. All data was downloaded and transferred to FSS Engineering for data analysis.

Elevated Locations are as follows:

<u>ID</u>	<u>Easting</u>	<u>Northing</u>
16,17	827406.090	865383.840
18,19	827408.310	865384.380
20,21	827416.180	865385.920
22,23	827417.230	865390.430
24,25	827418.150	865376.980
26,27	827419.360	865384.030

Rebar debris was identified in the sidewall of the excavated area. The rebar was surveyed and subsequently cut at the sidewall surface. No elevated readings were noted on the rebar or adjacent soils.

Rebar was located at the following coordinates:

<u>ID</u>	<u>Easting</u>	<u>Northing</u>
Rebar	827406.800	654384.210

Post source check was performed and meter DD passed successfully.

LSA boundaries were roped off with green FSS rope and appropriate signage was installed on the ropes.

END SDJ/JH

HDP-PR-FSS-701, Final Status Survey Plan Development
APPENDIX P-6
FSS FIELD LOG

8/1/13 0730

Performed daily Pre source check of FSS field instruments.

Biased soil samples were taken at the six elevated locations noted on the previous days GWS. An additional biased sample location was generated based on the GWS data analysis performed by S. Price. The additional location coordinates are N-865372.03 & E-827456.25. All samples were taken to a depth of 12" at 6" intervals. Collimated and un-collimated readings were taken with a 2"x2" NaI at the surface and at sample depth for all samples.

SDJ / JH

See survey 2943 C 130801 for biased soil sample information, depth and readings.

Ten Systematic Sample locations were created by FSS Engineering and flagged using GPS. Locations were then sampled to the depth specified in the soil sampling instructions.

The Systematic Sample Locations are as follows:

ID	Easting	Northing
L100801BRS00	827409.700	865391.000
L100802BES00	827409.700	865391.000
L100803BES00	827412.800	865379.400
L100804BRS00	827421.300	865387.900
L100805BES00	827421.300	865387.900
L100806BES00	827424.400	865376.300
L100807BRS00	827432.900	865384.800
L100807BRQ00	827432.900	865384.800
L100808BES00	827432.900	865384.800
L100809BES00	827427.500	865364.700
L100810BES00	827436.000	865373.200
L100811BRS00	827444.500	865381.700
L100812BES00	827444.500	865381.700
L100813BES00	827447.600	865370.100
L100814BRS00	827456.100	865378.600
L100815BES00	827456.100	865378.600

Glass was discovered at sample location L100811BRS00 at a depth of 12-14".

See survey 2944 C 130801 for systematic soil sample information, depth and readings.

Post source check was performed and all meters passed successfully.

END SDJ/JH

HPT
SS Field Log 2 of 2

HDP-PR-FSS-701, Final Status Survey Plan Development
APPENDIX P-4
FSS SAMPLE & MEASUREMENT LOCATIONS & COORDINATES

Survey Area: No. LSA 10Description: Burial Pits Open Land AreaSurvey Unit: No. 08Description: NE Corner of LSA 10-02 (Berm)Survey Type: Soil SamplingClassification: 1

Measurement or Sample ID	Surface or CSM	Type	Start Depth (feet)	End Depth (feet)	Easting (X Axis)*	Northing (Y Axis)*
L100801BRS00	Root	S	0	2.5	827409.7	865391.0
L100802BES00	Deep	S	2.5	3	827409.7	865391.0
L100803BES00	Deep	S	0	0.5	827412.8	865379.4
L100804BRS00	Root	S	0	1.5	827421.3	865387.9
L100805BES00	Deep	S	1.5	2	827421.3	865387.9
L100806BES00	Deep	S	0	0.5	827424.4	865376.3
L100807BRS00	Root	S	0	4.5	827432.9	865384.8
L100807BRQ00	Root	Q	0	4.5	827432.9	865384.8
L100808BES00	Deep	S	4.5	5	827432.9	865384.8
L100809BES00	Deep	S	0	0.5	827427.5	865364.7
L100810BES00	Deep	S	0	0.5	827436.0	865373.2
L100811BRS00	Root	S	0	3.5	827444.5	865381.7
L100812BES00	Deep	S	3.5	4	827444.5	865381.7
L100813BES00	Deep	S	0	0.5	827447.6	865370.1
L100814BRS00	Root	S	0	2.5	827456.1	865378.6
L100816BUB00	Uniform	B	0	0.5	827406.1	865383.8
L100817BUB00	Uniform	B	0.5	1.0	827406.1	865383.8
L100818BUB00	Uniform	B	0	0.5	827408.3	865384.4
L100819BUB00	Uniform	B	0.5	1.0	827408.3	865384.4
L100820BUB00	Uniform	B	0	0.5	827416.2	865385.9
L100821BUB00	Uniform	B	0.5	1.0	827416.2	865385.9
L100822BUB00	Uniform	B	0	0.5	827417.2	865390.4
L100823BUB00	Uniform	B	0.5	1.0	827417.2	865390.4
L100824BUB00	Uniform	B	0	0.5	827418.2	865377.0
L100825BUB00	Uniform	B	0.5	1.0	827418.2	865377.0
L100826BUB00	Uniform	B	0	0.5	827419.4	865384.0
L100827BUB00	Uniform	B	0.5	1.0	827419.4	865384.0
L100828BUB00	Uniform	B	0	0.5	827406.8	865384.2

* Distance in feet from southwest corner of the surface.

Surface; Floor = F, Wall = W, Ceiling = C, Roof = R

CSM; Surface, Root, Deep or Uniform

Type; Systematic = S, QC = Q, Biased = B, Investigation = I

HDP-PR-FSS-701, Final Status Survey Plan Development
APPENDIX P-6
FSS FIELD LOG

Survey Area:	<u>LSA-10</u>	Description:	<u>Burial Pits Open Land Area</u>
Survey Unit:	<u>08</u>	Description:	<u>NE Corner of LSA 10-02 (Berm)</u>

FSS Field Log:

<u>Date/Time:</u>	<u>Observation or Comment:</u>	<u>Technician</u>
07-31-2013	Rad Eng. (R. Nevean) observed excavation of legacy berm and determined extent of excavation to be complete (a.m. shift). Contacted criticality engineering to determine the location of boreholes required to release this unit from criticality controls. Boreholes drilled during p.m. (after lunch). Samples and biased scanning performed (pre-R.N. Six locations (or "stations")	N/a Rad. Eng. (R. Nevean)
R.N. (Shift Entry)	identified as biased sample locations. At end of shift, criticality safety issued correspondence formally lifting unit from crit. controls. (via email). Plan is for collection of systematic samples and performance of GWS by FSS crew and NRC.	
END R.N. entry		

Rad Eng. R.N.
FSS Field Log 1 of 3

8-1-13

HDP-PR-FSS-701, Final Status Survey Plan Development
APPENDIX P-6
FSS FIELD LOG

Survey Area: <u>LSA-10</u>	Description: <u>Burial Pits Open Land Area</u>
Survey Unit: <u>08</u>	Description: <u>NE Corner of LSA 10-02 (Berm)</u>

FSS Field Log:

<u>Date/Time:</u>	<u>Observation or Comment:</u>	<u>Technician</u>
08-01-2013/08:00 R.N.	Statistical analysis performed on GWS performed yesterday (7-31-13). S. Price recommended taking additional biases at Easting 827458 ± 5 ft and Northing 865371 ± 5. Rock Nèveau concurred and directed HP Techs to collect this biased. Sample will be surface depth. Attenuated measurement in sample hole will be communicated to Rad Eng. (M. Bresnahan/R. Nèveau) and decision will be made by Rad. Eng. to collect next 6 inches. END R. Nèveau entry	N/A (Rad. Eng. Entry)
08-01-2013/13:45 R.N.	Per entry above, attenuated measurements collected using a collimated probe. No elevated measurements. No additional samples collected beyond surface depth. Per SDJ/JH entry regarding the presence of glass in sample. Crit. Eng. was consulted; no issues from criticality safety. Rad. Eng. (R. Nèveau) examined glass. No elevated counts; glass was not seen ^{at} typical thickness of labware. Glass appeared to be bottle glass typical of soda/drinks. No further action or investigations required. R.N. END R. Nèveau entry	N/A (Rad. Eng.)

Rad Eng.
FSS Field Log 2 of 3

4 R.N.'s
6-8-13

HDP-PR-FSS-701, Final Status Survey Plan Development
APPENDIX P-6
FSS FIELD LOG

Survey Area: <u>LSA-10</u>	Description: <u>Burial Pits Open Land Area</u>
Survey Unit: <u>08</u>	Description: <u>NE Corner of LSA 10-02 (Berm)</u>

FSS Field Log:

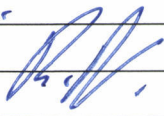
<u>Date/Time:</u>	<u>Observation or Comment:</u>	<u>Technician</u>
08-01-2013/14:30 R.N.	Rad. Engineering / HP Supervision notified of an area located in the eastern "tip" south of the unit, bordering the creek diversion and LSA 11-01. R. Neveau walked the area and moved several small rocks, as best practical. However, there remains berm soil/rock/vegetation that cannot be effectively removed. The total area is very small ($\approx 1\text{-m}^2$) in relation to the total surface area of entire unit ($\approx 110\text{-m}^2$). Focused GWS around the area (as practicable) showed no evidence of elevated measurements. In addition, this small "tip" of this unit will later be excavated, removed, and fall within the footprint of adjacent survey units. Therefore, Rad. Eng notified the HP Techs that there is no need to excavate this small area at this time (since it will be removed later). RSO was notified and concurred via radio. No further action required.	n/y (Rad. Eng.) (Entry)
		

FSS Field Log 3 of 4

Survey Area:	LSA-10	Description:	Burial Pits Open Land Area
Survey Unit:	08	Description:	NE Corner of LSA 10-02 (Berm)

<u>Date/Time:</u>	<u>Observation or Comment:</u>	<u>Technician</u>
08-02-2017:45 R.N.	Upon review of HDP samples results (on-site) for biased samples and systematic samples Rad. Eng. (Rock Neveau) and #PTech removed isolation controls to support placement of clean fill soil delivered by Klineschmidt (per ECC).	Rad Eng. R.N.
END		

0805-13 R.N. Rud Eng. reviewed results of all systematic samples. No further action (shift entry) required for this survey unit.

END: Close out Survey Package

R.N.
08-08-13

FSS Field Log 4 of 3
4

HDP-PR-FSS-701, Final Status Survey Plan Development
APPENDIX P-6
FSS FIELD LOG

Survey Area: LSA 10Description: Burial Pits Open Land AreaSurvey Unit: 09Description: VOC Pit in LSA 10-06**FSS Field Log:**

<u>Date/Time</u>	<u>Observation or Comment</u>	<u>Technician</u>
09/19/13 0630	Received our daily safety briefing covering hazards associated with GWS, surveying and soil sampling.	SJ/AS/NJ
09/19/13 0700	Performed daily instrument source check. All meters successfully passed the source check.	
09/19/13 0930	<p><i>10-09 R.N. 11-12-13 STET LSA 05-D1 R.W.</i></p> Pulled Soil Samples from LSA 05-01 . Samples were sealed with tape, labeled and transported to the lab for on-site analysis. See survey 3530 C 130919 for more information. Conducted GWS of LSA 10-09 VOC Pit area using GPS and 2221 DD. No elevated areas were noted. See survey 3502-C 130919 for more information.	
09/19/13 1300	Entered LSA 10-09 to perform systematic soil sampling. The area is under isolation and control, consisting of green and white rope with signage attached. A total of seven systematic, two biased and one duplicate sample were taken. All samples were sealed with tape and labeled and transported to the on-site lab for analysis. See Survey 3526 C 130919 for more information.	
09/19/13 1520	Performed daily post source check. All instruments passed successfully. END SJ/NJ/AS	

FSS Field Log 1 of 1

HDP-PR-FSS-701, Final Status Survey Plan Development
APPENDIX P-6
FSS FIELD LOG

Survey Area: LSA 10Description: Burial Pits Open Land AreaSurvey Unit: 09Description: VOC Pit in LSA 10-06**FSS Field Log:**

<u>Date/Time</u>	<u>Observation or Comment</u>	<u>Technician</u>
09/23/13 0630	Received our daily safety briefing covering hazards associated with GWS, surveying and soil sampling.	AS/JH
09/23/13 0700	Performed daily instrument source check. All meters Successfully passed the source check. Moved equipment to the barn shack area.	
09/23/13 0800	Staged counting station at location of stockpiles 5 & 6 for vegetation removal. Monitored vegetation removal activities.	
09/23/13 1500	Performed Biased Soil Sampling in LSA 10-09. The area is under isolation and control, consisting of green and white rope with signage attached. A single biased sample was taken. The sample was sealed with tape and labeled and transported to the on-site lab for analysis. See Survey 3547 C 130923 for more information.	
09/23/13 1535	Performed daily post source check. All instruments passed successfully. END AS/JH	

FSS Field Log 1 of 1

HDP-PR-FSS-701, Final Status Survey Plan Development
APPENDIX P-6
FSS FIELD LOG

Survey Area: <u>LSA-10</u>	Description: <u>Burial Pits Open Land Area</u>
Survey Unit: <u>09</u>	Description: <u>VOC Pit in LSA 10-06</u>

FSS Field Log:

<u>Date/Time:</u>	<u>Observation or Comment:</u>	<u>Technician</u>
9/24/13 09:00	Environmental Personnel (R. Andrews) informed Radiological Engineering (M. Bresnahan and R. Neveau) of some plastic sheeting material found during chemical confirmatory sampling of LSA-10-09.	ASB
9/24/13 13:00	Radiological Engineering (M. Bresnahan and R. Neveau) accompanied Environmental Personnel (R. Andrews) to LSA-10-09 to assess the status and confirm the plastic sheeting material that was found during confirmatory sampling. The plastic sheeting was determined to be the bottom of a test pit that was excavated during the Fall 2012 time frame while sampling and surveying for VOC contamination and then backfilled for safety purposes. Environmental Manager (K. Davis) expressed concern regarding the potential for other areas onsite where VOC test pits were excavated and backfill. K. Davis directed R. Andrews to supply a figure with the locations of all test pits that were excavated in LSA-10-09 to determine if the extent of the final excavation was below the bottom elevation of the test pits to verify removal of all backfill material.	AS
9/24/13 14:00	R. Neveau discussed with ECC Personnel (T. Gilbertson) the need to remove the plastic material found in LSA-10-09. R. Neveau dropped the isolation boundary in order for the area where the plastic sheeting was found to be remediated and monitored the entire remediation process.	ASB
9/24/13 15:00	Radiological Engineering (M. Bresnahan and R. Neveau) discussed the plastic material that was found during confirmatory sampling with NRC Inspector (J. Tapp), who also confirmed seeing this material during his confirmatory sampling efforts in LSA-10-09 and discussing it with the Environmental Manager (K. Davis). R. Neveau informed J. Tapp that Environmental and Radiological Engineering were working together to verify that LSA-10-09 was excavated to below the lowest point where backfill material was placed and we would discuss our findings with J. Tapp the following day.	ASB
9/25/13 13:00	A Draft of figure "LSA-10-09 (BP South 4) TEST PITS was supplied by Environmental Personnel (R. Andrews) to Radiological Engineering (M. Bresnahan and R. Neveau). M. Bresnahan and R. Neveau discussed with NRC Inspector (J. Tapp) the location and purpose of the test pits that were excavated in the footprint of LSA-10-09. R. Neveau explained to J. Tapp the figure was a draft our initial assessment was after removal of the plastic sheeting material that was found in the area, we did not believe there would be any other areas necessary to excavate.	ASB
9/26/13 06:00	Environmental Manager (K. Davis) sent an email explaining the excavated surface of LSA-10-09 was not adequately characterized	ASB

HDP-PR-FSS-701, Final Status Survey Plan Development
APPENDIX P-6
FSS FIELD LOG

	since there was evidence of test pits that were excavated and backfilled which had deeper elevations than the current depth of excavation.	AB
9/26/13 08:00	Radiological Engineering (R. Neveau and M. Bresnahan) discussed with J. Tapp.	AB

FSS Field Log 2 of 2

HDP-PR-FSS-701, Final Status Survey Plan Development
APPENDIX P-6
FSS FIELD LOG

Survey Area: LSA 10Description: Burial Pits Open Land AreaSurvey Unit: 09Description: VOC Pit in LSA 10-06**FSS Field Log:**

<u>Date/Time</u>	<u>Observation or Comment</u>	<u>Technician</u>
09/25/13 0630	Received our daily safety briefing covering hazards associated with GWS, surveying and soil sampling.	AS/JH
09/25/13 0700	Performed daily instrument source check. All meters successfully passed the source check. Prepared for GWS walkover of upper area of LSA 10-09.	
09/25/13 0800	Entered LSA 10-09 to conduct GWS using GPS and 221 BB. The area is under isolation and control, consisting of green and white rope with signage attached. Walkover completed and no elevated areas were noted. See survey 3585 C 130925 for more information.	
09/25/13 1045	Performed mid-day source check. 2221 BB passed successfully.	
09/25/13 1300	Completed survey documentation and provided job coverage for barn area work activities.	
09/25/13 1730	Performed post source check on all instruments. All passed successfully. END AS/JH	

FSS Field Log 1 of 1

HDP-PR-FSS-701, Final Status Survey Plan Development
APPENDIX P-6
FSS FIELD LOG

Survey Area: 10Description: Burial Pit Open Land AreaSurvey Unit: 09Description: VOC Pit Area**FSS Field Log:**

<u>Date/Time</u>	<u>Observation or Comment</u>	<u>Technician</u>
10/15/13 0630	Received our daily FSS and safety briefing.	SDJ/JAH/NJJ/ALS
10/15/13 0715	Performed daily instrument source checks for the 2221 meters and 2360 meters. All FSS meters successfully passed the source check.	
10/15/13 0730	Provided job coverage for ECC work in LSA 05-01.	
10/15/13 0900	Conducted a walk down of the LSA 10-09 (VOC Pit) to ensure that the Final Status isolation and control measures were in place and evaluate the area for possible slip trip and fall hazards, due to recent rainfall and muddy conditions. Standing water was observed in the lowest spots within the pit. It was noted that the area was far too muddy to be considered safe to traverse with the added weight of a backpack and the center of gravity shift caused by the backpack. It was also noted that the only entry way into the area was via a soil ramp. This ramp becomes extremely slick and hazardous with rainfall events. Notification was made to Rad. Engineering and arrangements were made with ECC to excavate a stair entryway into the VOC Pit area.	
10/15/13 1300	Continued coverage of the ECC work in LSA 05-01.	
10/15/13 1700	Performed post source check of all FSS meters used. All meters passed post source check successfully. END SDJ/JAH/NJJ/ALS	

FSS Field Log 1 of 1

HDP-PR-FSS-701, Final Status Survey Plan Development
APPENDIX P-6
FSS FIELD LOG

Survey Area: 10Description: Burial Pit Open Land AreaSurvey Unit: 09Description: VOC Pit Area**FSS Field Log:**

<u>Date/Time</u>	<u>Observation or Comment</u>	<u>Technician</u>
10/18/13 0630	Received our daily FSS and safety briefing.	SDJ/JAH/NJJ/ALS
10/18/13 0715	Performed daily instrument source checks for the 2221 meters and 2360 meters. All FSS meters successfully passed the source check.	
10/18/13 0720	Provided job coverage for ECC work in LSA 05-01.	
10/18/13 0830	Proceeded to LSA 10-09 area and ensured that the Final Status isolation and control measures were in place. Conducted a gamma walkover survey and a 100% visual inspection of the horizontal surfaces of LSA 10-09 (VOC Pit). No elevated areas were noted. See Survey 3930 C 131018 for more detailed information.	
10/18/13 1300	Continued coverage of the ECC work in LSA 05-01.	
10/18/13 1330	Finished GWS and returned to office to download and process the data.	
10/18/13 1430	Survey documentation completed for GWS of LSA 10-09. Began statistical analysis of walkover data.	
10/18/13 1630	Completed statistical analysis of walkover data.	
10/18/13 1715	Performed post source check of all FSS meters used. All meters passed post source check successfully. END SDJ/JAH/NJJ/ALS	

FSS Field Log 1 of 1

HDP-PR-FSS-701, Final Status Survey Plan Development
APPENDIX P-6
FSS FIELD LOG

Survey Area: 10Description: Burial Pit Open Land AreaSurvey Unit: 09Description: VOC Pit Area**FSS Field Log:**

<u>Date/Time</u>	<u>Observation or Comment</u>	<u>Technician</u>																																													
10/21/13 0630	Received our daily FSS and safety briefing.	SDJ/JAH/NJJ/ALS																																													
10/21/13 0715	Performed daily instrument source checks for the 2221 meters and 2360 meters. All FSS meters successfully passed the source check.																																														
10/21/13 0730	Provided job coverage for ECC work in LSA 05-01. Prepared equipment for sidewall surveys and systematic soil sampling of LSA 10-09.																																														
10/21/13 0800	Proceeded to LSA 10-09. Ensured that the Final Status isolation and control measures were in place. Began manual sidewall surveys of LSA 10-09. Conducted systematic soil sampling at the following locations. <table><tr><td>ID</td><td>Northing</td><td>Easting</td></tr><tr><td>L100911BSS00</td><td>865051.20</td><td>827750.70</td></tr><tr><td>L100912BRS00</td><td>865051.20</td><td>827750.70</td></tr><tr><td>L100913BRS00</td><td>865032.20</td><td>827755.80</td></tr><tr><td>L100914BES00</td><td>865032.20</td><td>827755.80</td></tr><tr><td>L100915BSS00</td><td>865013.30</td><td>827760.90</td></tr><tr><td>L100916BRS00</td><td>865013.30</td><td>827760.90</td></tr><tr><td>L100917BRS00</td><td>865046.10</td><td>827769.70</td></tr><tr><td>L100918BES00</td><td>865046.10</td><td>827769.70</td></tr><tr><td>L100919BES00</td><td>865027.20</td><td>827774.70</td></tr><tr><td>L100920BSS00</td><td>865060.00</td><td>827783.50</td></tr><tr><td>L100921BRS00</td><td>865060.00</td><td>827783.50</td></tr><tr><td>L100922BRS00</td><td>865041.00</td><td>827788.60</td></tr><tr><td>L100922BRQ00</td><td>865041.00</td><td>827788.60</td></tr><tr><td>L100923BES00</td><td>865041.00</td><td>827788.60</td></tr></table> See survey 3939 C 131021 for more information on the systematic samples.		ID	Northing	Easting	L100911BSS00	865051.20	827750.70	L100912BRS00	865051.20	827750.70	L100913BRS00	865032.20	827755.80	L100914BES00	865032.20	827755.80	L100915BSS00	865013.30	827760.90	L100916BRS00	865013.30	827760.90	L100917BRS00	865046.10	827769.70	L100918BES00	865046.10	827769.70	L100919BES00	865027.20	827774.70	L100920BSS00	865060.00	827783.50	L100921BRS00	865060.00	827783.50	L100922BRS00	865041.00	827788.60	L100922BRQ00	865041.00	827788.60	L100923BES00	865041.00	827788.60
ID	Northing		Easting																																												
L100911BSS00	865051.20		827750.70																																												
L100912BRS00	865051.20		827750.70																																												
L100913BRS00	865032.20		827755.80																																												
L100914BES00	865032.20		827755.80																																												
L100915BSS00	865013.30		827760.90																																												
L100916BRS00	865013.30	827760.90																																													
L100917BRS00	865046.10	827769.70																																													
L100918BES00	865046.10	827769.70																																													
L100919BES00	865027.20	827774.70																																													
L100920BSS00	865060.00	827783.50																																													
L100921BRS00	865060.00	827783.50																																													
L100922BRS00	865041.00	827788.60																																													
L100922BRQ00	865041.00	827788.60																																													
L100923BES00	865041.00	827788.60																																													
10/21/13 1300	Continued sidewall surveys and systematic soil sampling. Finished the sidewall surveys and returned to office to document the surveys. See survey 3965 C 131021 for sidewall survey information.																																														
10/21/13 1615	Performed post source check of all FSS meters used. All meters passed post source check successfully.																																														
	END SDJ/JAH/NJJ/ALS																																														

FSS Field Log __ of __

HDP-PR-FSS-701, Final Status Survey Plan Development
APPENDIX P-6
FSS FIELD LOG

Survey Area: 10Description: Burial Pit Open Land AreaSurvey Unit: 09Description: VOC Pit Area**FSS Field Log:**

<u>Date/Time</u>	<u>Observation or Comment</u>	<u>Technician</u>																								
10/22/13 0630	Received our daily FSS and safety briefing.	SDJ/JAH/NJJ/ALS																								
10/22/13 0720	Performed daily instrument source checks for the 2221 meters and 2360 meters. All FSS meters successfully passed the source check.																									
10/22/13 0730	Provided job coverage for ECC work in LSA 05-01. Prepared equipment for sidewall sampling of LSA 10-09.																									
10/22/13 0900	Proceeded to LSA 10-09. Ensured that the Final Status isolation and control measures were in place. Began the process of sidewall sampling in LSA 10-09 by placing the flags using a measuring tape and GPS unit, per FSS instructions for this area. Systematic soil sampling of the sidewall was done at the following locations. <table><tr><td>ID</td><td>Northing</td><td>Easting</td></tr><tr><td>L100924BSS00</td><td>865012.10</td><td>827769.40</td></tr><tr><td>L100925BRS00</td><td>865021.70</td><td>827790.00</td></tr><tr><td>L100926BRS00</td><td>865037.00</td><td>827801.70</td></tr><tr><td>L100927BES00</td><td>865057.30</td><td>827790.00</td></tr><tr><td>L100928BSS00</td><td>865065.70</td><td>827773.10</td></tr><tr><td>L100929BRS00</td><td>865055.10</td><td>827752.60</td></tr><tr><td>L100930BRS00</td><td>865035.30</td><td>827745.50</td></tr></table> See survey 3956 C 131022 for more information on the systematic samples.		ID	Northing	Easting	L100924BSS00	865012.10	827769.40	L100925BRS00	865021.70	827790.00	L100926BRS00	865037.00	827801.70	L100927BES00	865057.30	827790.00	L100928BSS00	865065.70	827773.10	L100929BRS00	865055.10	827752.60	L100930BRS00	865035.30	827745.50
ID	Northing		Easting																							
L100924BSS00	865012.10		827769.40																							
L100925BRS00	865021.70		827790.00																							
L100926BRS00	865037.00		827801.70																							
L100927BES00	865057.30		827790.00																							
L100928BSS00	865065.70		827773.10																							
L100929BRS00	865055.10	827752.60																								
L100930BRS00	865035.30	827745.50																								
10/22/13 1300	Continued systematic soil sampling of the sidewall locations. Returned to office to document the surveys.																									
10/22/13 1615	Performed post source check of all FSS meters used. All meters passed post source check successfully.																									
	END SDJ/JAH/NJJ/ALS																									

FSS Field Log __ of __

HDP-PR-FSS-701, Final Status Survey Plan Development
APPENDIX P-6
FSS FIELD LOG

Survey Area: 10Description: Burial Pit Open Land AreaSurvey Unit: 09Description: VOC Pit Area**FSS Field Log:****Date/Time****Observation or Comment****Technician**

10/23/13 0630

Received our daily FSS and safety briefing.

SDJ/JAH/NJJ/ALS

10/23/13 0710

Performed daily instrument source checks for the 2221 meters and 2360 meters. All FSS meters successfully passed the source check.

10/23/13 0800

Received the coordinates of the areas of interest within LSA 10-09. Loaded the coordinates into the GPS handset.

10/23/13 0915

Proceeded to LSA 10-09 to investigate areas of interest noted during the GWS survey. Ensured that the Final Status isolation and control measures were in place. The corners of four small areas were flagged using GPS and colored pin flags. The areas were then walked over manually at a maximum speed no greater than one foot per second, with the probe as close to the surface as physically possible. No areas of elevated readings were noted during the walkover survey. See the representation of areas of interest below.

LSA 1009 Investigation Areas

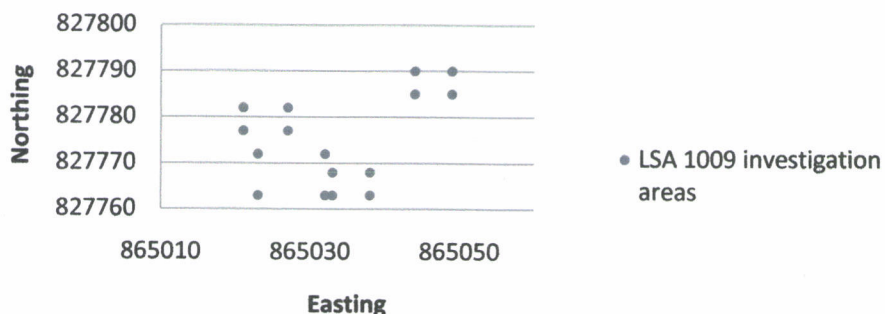

10/23/13 1500

Returned to office to document the surveys. See surveys 3930 C 131018 and 3929 C 131018 for more information.

10/23/13 1635

Performed post source check of all FSS meters used. All meters passed post source check successfully.

END SDJ/JAH/NJJ/ALS

FSS Field Log __ of __

HDP-PR-FSS-701, Final Status Survey Plan Development
APPENDIX P-6
FSS FIELD LOG

Survey Area: 10Description: Burial Pit Open Land AreaSurvey Unit: 09Description: VOC Pit Area**FSS Field Log:****Date/Time****Observation or Comment****Technician**

10/24/13 0630

Received our daily FSS and safety briefing.

SDJ/JAH/NJJ/ALS

10/24/13 0710

Performed daily instrument source checks for the 2221 meters and 2360 meters. All FSS meters successfully passed the source check.

10/24/13 0745

Proceeded to LSA 10-09 to provide job coverage during the backfilling of the LSA. Clean off-site backfill was brought in to fill the excavation. Provided continuous HP monitoring and control of the LSA boundary. Constant visual observation was made on the activities and measures were taken to avoid any possible cross-contamination of the clean area. New Geo-Textile fabric was placed over any areas that may possibly come into contact with equipment or clean soil, to provide a barrier between un-surveyed areas and surveyed areas.

~~10/23/13~~ 1600

10-25-13

Backfill was completed, all geo-textile barriers were removed from the area and general housekeeping was performed. Isolation and control measure were then removed when the area was deemed complete.

~~10/23/13~~ 1635

10-25-13

Returned to the FSS office and performed post source check of all FSS meters used. All meters passed post source check successfully.

END SDJ/JAH/NJJ/ALS

FSS Field Log __ of __

HDP-PR-FSS-701, Final Status Survey Plan Development
APPENDIX P-6
FSS FIELD LOG

Survey Area: <u>LSA-10</u>	Description: <u>Burial Pit Open Land Area</u>
Survey Unit: <u>06 & 10</u>	Description: <u>Section 06 & 10</u>

FSS Field Log:

<u>Date/Time:</u>	<u>Observation or Comment:</u>	<u>Technician</u>
11/15/13 0630	Received our daily FSS and safety briefing.	SJ/NJ/AS/JH
11/15/13 0710	Performed daily instrument source checks for the 2221 meters AA, DD and FF and 2360 meters B and D. All FSS meters successfully passed the source check.	
11/15/13 0730	A. Schooley and S. Jenkins entered LSA 10-10 to pull Pre-FSS/RASS Biased and systematic samples.	
11/15/13 0815	N. Jordan, J. Hoffman, verified that the isolation and control measure were in place and continued FSS walkovers in LSA 10-06. During the GWS, GPS data files LSA_1006_111513_AA & LSA_1006_111513_DD were created. No anomalous readings were noted during the walkovers. See surveys 4369 C 131115 & 4382 C 131115 for more detailed information.	
11/15/13 1300	N. Jordan and J. Hoffman entered LSA 10-06 to survey the base and sidewalls of the small VOC pit in the northern section of the LSA. During the GWS, the GPS data file LSA_1006_111513_DD_HOLE was created. No anomalous readings were noted during the walkover. See survey 4368 C 131115 for more detailed information.	
11/15/13 1530	Completed soil sampling for the day in LSA 10-10. The following samples were Completed and secured.	

Sample ID

Biased

7214-RA-131114-09-01

7214-RA-131114-09-03

Systematic

7213-RA-131114-09-04

7213-RA-131114-09-05

See survey 4341 C 131115 for more detailed information.

FSS Field Log 1 of

HDP-PR-FSS-701, Final Status Survey Plan Development
APPENDIX P-6
FSS FIELD LOG

Survey Area: LSA-10**Description:** Burial Pit Open Land Area**Survey Unit:** 06 & 10**Description:** Section 06 & 10**FSS Field Log:**

<u>Date/Time:</u>	<u>Observation or Comment:</u>	<u>Technician</u>
11/15/13 1610	Returned to the office to download GWS data and complete survey documentation.	SJ/NJ/JH/AS
11/15/13 1630	Post-checks performed on all FSS meters that were used. All meters passed successfully.	
	END SJ/NJ/JH/AS	

FSS Field Log 2 of

HDP-PR-FSS-701, Final Status Survey Plan Development
APPENDIX P-6
FSS FIELD LOG

Survey Area: LSA-10Description: Burial Pit Open Land AreaSurvey Unit: 06 & 10Description: Section 06 & 10**FSS Field Log:**

<u>Date/Time:</u>	<u>Observation or Comment:</u>	<u>Technician</u>
11/18/13 0630	Received our daily FSS and safety briefing.	SJ/NJ/AS/JH
11/18/13 0700	Performed daily instrument source checks for the 2221 meters AA, DD and FF and 2360 meters B and D. All FSS meters successfully passed the source check.	
11/18/13 0715	A. Schooley and S. Jenkins and N. Jordan entered LSA 10-10 to continue the soil sampling efforts for Pre-FSS/RASS Biased and systematic samples.	
11/18/13 0815	J. Hoffman, verified that the isolation and control measures were in place and continued on the last portion of FSS walkover in LSA 10-06.	
11/18/13 1100	J. Hoffman completed the GWS of LSA 10-06 and returned to the office to perform the data download and survey documentation. During the GWS, GPS data files LSA_1006_111813_AA was created. No anomalous readings were noted during the walkover. See surveys 4370 C 131118 for more detailed information.	
11/18/13 1115	A. Schooley, S. Jenkins and N. Jordan completed soil sampling within LSA 10-10. Transferred all samples to the lab for analysis. The following samples were pulled During today. <div style="text-align: center;"> Sample ID Biased 7214-RA-131114-09-02 Systematic 7213-RA-131114-09-01 7213-RA-131114-09-02 7213-RA-131114-09-03 7213-RA-131114-09-06 </div> See survey 4363 C 131118 for more detailed information.	
1/18/13 1300	Received the FSS instruction briefing from M. Bresnahan for LSA 10-07.	

HDP-PR-FSS-701, Final Status Survey Plan Development
APPENDIX P-6
FSS FIELD LOG

Survey Area: LSA-10**Description:** Burial Pit Open Land Area**Survey Unit:** 06 & 10**Description:** Section 06 & 10**FSS Field Log:****Date/Time:****Observation or Comment:****Technician**

11/18/13 1400

Performed survey documentation and statistical analysis of GWS data.

SJ/NJ/JH/AS

11/18/13 1630

Post-checks performed on all FSS meters that were used. All meters passed successfully.

END SJ/NJ/JH/AS

FSS Field Log 4 of

HDP-PR-FSS-701, Final Status Survey Plan Development
APPENDIX P-6
FSS FIELD LOG

Survey Area:	<u>LSA-10</u>	Description:	<u>Burial Pit Open Land Area</u>
Survey Unit:	<u>10</u>	Description:	<u>Section LSA 10-10</u>

FSS Field Log:

<u>Date/Time:</u>	<u>Observation or Comment:</u>	<u>Technician</u>
12/02/13 0630	Received daily safety and FSS briefing.	SJ/JH/AS/NJ
12/02/13 0715	Performed daily instrument source checks for FSS meters. All meters successfully passed the source check.	
12/02/13 0915	S. Jenkins, A. Schooley, J. Hoffman and N. Jordan performed Isolation and Control measures on LSA 10-10. Removed black isolation rope and replaced it with green/white FSS rope and FSS signage. Wrapped waddles in plastic and duct tape and installed them in all areas around the LSA that would otherwise allow surface water from adjacent areas to flow into LSA 10-10.	
12/02/13 1640	Performed post checks on FSS meter. All meters passed successfully.	
	END SJ/JH/AS/NJ	

HDP-PR-FSS-701, Final Status Survey Plan Development
APPENDIX P-6
FSS FIELD LOG

Survey Area: <u>LSA-10</u>	Description: <u>Burial Pit Open Land Area</u>
Survey Unit: <u>10</u>	Description: <u>Section LSA 10-10</u>

FSS Field Log:

<u>Date/Time:</u>	<u>Observation or Comment:</u>	<u>Technician</u>
12/04/13 0630	Received daily safety and FSS briefing.	SJ/JH/AS/NJ
12/04/13 0715	Performed daily instrument source checks for FSS meters. All meters successfully passed the source check.	
12/04/13 0900	S. Jenkins and A. Schooley verified that isolation and controls were in place in LSA 10-10 and began performing systematic soil sampling of the area.	
12/04/13 1300	N. Jordan entered LSA 10-10 to perform FSS GWS.	
12/04/13 1600	S. Jenkins and A. Schooley completed systematic soil sampling in LSA 10-10. The following samples were taken:	
	Sample ID	
	L101001BRS00	
	L101002BES00	
	L101003BRS00	
	L101004BES00	
	L101005BRS00	
	L101006BES00	
	L101007BRS00	
	L101008BES00	
	L101009BSS00	
	L101010BRS00	
	L101011BSS00	
	L101011BSQ00	
	L101012BRS00	
	L101013BSS00	
	L101014BRS00	
	L101015BES00	
	See survey 4572 C 131204 for more detailed information.	
12/04/13 1615	N. Jordan completed FSS GWS in LSA 10-10 for the day. See surveys 4586 C 131204 & 4587 C 131204 for more detailed information.	
12/04/13 1630	Performed post checks on FSS meter. All meters passed successfully.	
	END SJ/JH/AS/NJ	

FSS Field Log __ of __

HDP-PR-FSS-701, Final Status Survey Plan Development
APPENDIX P-6
FSS FIELD LOG

Survey Area:	<u>LSA-10</u>	Description:	<u>Burial Pit Open Land Area</u>
Survey Unit:	<u>10</u>	Description:	<u>Section LSA 10-10</u>

FSS Field Log:

<u>Date/Time:</u>	<u>Observation or Comment:</u>	<u>Technician</u>
12/05/13 0630	Received daily safety and FSS briefing.	SJ/JH/AS/JW/NJ
12/05/13 0715	Performed daily instrument source checks for FSS meters. All meters successfully passed the source check.	
12/05/13 0900	N. Jordan, J. Hoffman, J. Williams and verified that isolation and controls were in place in LSA 10-10 and began performing GPS based FSS GWS of the area.	
12/05/13 1030	A. Schooley entered LSA 10-10 to begin conducting manual FSS GWS of portions of the sidewalls where GPS could not be used.	
12/05/13 1130	A. Schooley completed a manual GWS of a sidewall area and returned to the office to document the survey. See survey 4581 C 131205 for more detailed information.	
12/05/13 1600	N. Jordan, J. Hoffman, J. Williams and A. Schooley completed FSS GWS for the day in LSA 10-10 and returned to the office to document the surveys. See surveys 4576 C 131205, 4577 C 131205 and 4590 C 131205 for more detailed information.	
12/05/13 1635	Performed post checks on FSS meter. All meters passed successfully. END SJ/JH/AS/JW/NJ	

FSS Field Log __ of __

HDP-PR-FSS-701, Final Status Survey Plan Development
APPENDIX P-6
FSS FIELD LOG

Survey Area:	<u>LSA-10</u>	Description:	<u>Burial Pit Open Land Area</u>
Survey Unit:	<u>10</u>	Description:	<u>Section LSA 10-10</u>

FSS Field Log:

<u>Date/Time:</u>	<u>Observation or Comment:</u>	<u>Technician</u>
12/07/13 0630	Received daily safety and FSS briefing.	AS
12/07/13 0725	Performed daily instrument source checks for FSS meters. All meters successfully passed the source check.	
12/07/13 0900	A. Schooley verified that isolation and controls were in place in LSA 10-10 and began performing manual FSS GWS of the area.	
12/07/13 1030	A. Schooley completed manual FSS GWS in LSA 10-10 on portions of the sidewalls where GPS could not be used. See survey 4599 C 131207 for more detailed information.	
12/07/13 1635	Performed post checks on FSS meter. All meters passed successfully. END AS	

FSS Field Log __ of __