

CATEGORY 1

REGULATORY INFORMATION DISTRIBUTION SYSTEM (RIDS)

ACCESSION NBR: 9809150166 DOC. DATE: 98/09/09 NOTARIZED: NO DOCKET #

| | |
|---|----------|
| FACIL: 50-250 Turkey Point Plant, Unit 3, Florida Power and Light C | 05000250 |
| 50-251 Turkey Point Plant, Unit 4, Florida Power and Light C | 05000251 |
| 50-269 Oconee Nuclear Station, Unit 1, Duke Power Co. | 05000269 |
| 50-270 Oconee Nuclear Station, Unit 2, Duke Power Co. | 05000270 |
| 50-272 Salem Nuclear Generating Station, Unit 1, Public Servi | 05000272 |
| 50-311 Salem Nuclear Generating Station, Unit 2, Public Serv | 05000311 |
| 50-331 Duane Arnold Energy Center, Iowa Electric Light & Pow | 05000331 |
| 50-354 Hope Creek Nuclear Station, Unit 1, Public Service El | 05000354 |

AUTH. NAME AUTHOR AFFILIATION A

MALEC, K. J. T

RECIP. NAME RECIPIENT AFFILIATION E

SUBJECT: Part 21 rept re possible machining defect in certain one inch stainless steel Swagelok front ferrules, part number SS-1613-1. Caused by tubing slipping out of fitting at three times working pressure of tubing. Notified affected utils. G

DISTRIBUTION CODE: IE19T COPIES RECEIVED: LTR 1 ENCL 1 SIZE: 4 O

TITLE: Part 21 Rept (50 DKT) R

NOTES: Application for permit renewal filed. 05000354 Y

| RECIPIENT ID CODE/NAME | COPIES LTTR ENCL | RECIPIENT ID CODE/NAME | COPIES LTTR ENCL |
|---------------------------------|---------------------|---------------------------|---------------------|
| PD2-3 PD | 1 1 | PD2-2 PD | 1 1 |
| PD1-2 PD | 1 1 | PD3-3 PD | 1 1 |
| JABBOUR, K | 1 1 | LABARGE, D | 1 1 |
| MILANO, P | 1 1 | LAUFER, R | 1 1 |
| ENNIS, R | 1 1 | | |
| INTERNAL: <u>FILE CENTER-01</u> | 1 1 | NRR/DRPM/PECB | 1 1 |
| NRR/DRPM/PECB/B | 1 1 | PDR WARD, M. | 1 1 |
| RES/DET/EIB | 1 1 | RGN1 | 1 1 |
| RGN2 | 1 1 | RGN3 | 1 1 |
| RGN4 | 1 1 | | |
| EXTERNAL: INPO RECORD CTR | 1 1 | NOAC SILVER, E | 1 1 |
| NRC PDR | 1 1 | NUDOCS FULL TXT | 1 1 |

**THIS DOCUMENT
HAS BEEN SCANNED**

NOTE TO ALL "RIDS" RECIPIENTS:
PLEASE HELP US TO REDUCE WASTE. TO HAVE YOUR NAME OR ORGANIZATION REMOVED FROM DISTRIBUTION LISTS OR REDUCE THE NUMBER OF COPIES RECEIVED BY YOU OR YOUR ORGANIZATION, CONTACT THE DOCUMENT CONTROL DESK (DCD) ON EXTENSION 415-2083

FULL TEXT CONVERSION REQUIRED
TOTAL NUMBER OF COPIES REQUIRED: LTTR 22 ENCL 22

SECRET
NO 6A

Swagelok

SWAGELOK COMPANY
29500 Solon Road, Solon, Ohio 44139-3492 U.S.A.

September 9, 1998

Document Control Desk
Office of Reactor Regulation
Nuclear Regulatory Commission
Washington, DC 20555

Subject: Defects Potentially Reportable Under 10CFR21

We are writing to inform you about a possible machining defect in certain one inch stainless steel Swagelok front ferrules, part number SS-1613-1.

The front ferrule is shipped as a component in a Swagelok tube fitting, or sold separately as a replacement part.

A list containing the part numbers of assembled fittings and nuclear safety related certifications under which these ferrules have been sold is enclosed. All of these customers have already been notified by us about this possible problem. Only front ferrules with the heat codes ILA, JVA and JYL stamped on the part are affected; and only one inch ferrules are involved.

The possible defect is that the 45 degree chamfer on the trailing edge of the ferrule may not be correct. A drawing is enclosed that shows this dimension, along with a drawing that illustrates the front ferrules' position in the Swagelok tube fitting. When these ferrules were machined, an improper set-up allowed a few pieces to be manufactured with an inappropriate dimension. Our inspection of the lots involved shows that about 0.019 per cent of the ferrules manufactured in these lots were affected.

Laboratory testing of these parts with this incorrect dimension had the tubing slip out of the fitting at three times working pressure of the tubing.

Our corrective action includes doubling our sample size on these parts and implementing a long term project to 100 per cent inspect using automation.

If there are any questions, please do not hesitate to contact us.

Sincerely,

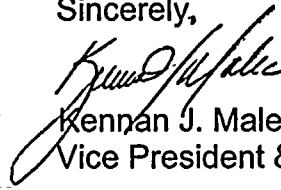
Kennan J. Malec

Vice President & General Manager

142600
9809150166 980909
PDR ADOCK 05000250
S PDR

SWAGELOK COMPANY

SS-1613-1

| Company | Purchase Order | Part Number | QTY | Product ID |
|--------------------------------------|------------------|--------------|-----|------------|
| Florida Power & Light (Turkey Point) | 00032839 | SS-1610-1-16 | 5 | R18G20183 |
| Public Service Electric & Gas | P2 0957644 1850 | SS-1610-1-16 | 10 | R18FJ0055B |
| Mechanical Engineering Workshop | SF/CRX/198/433 | SS-1613-1 | 50 | R17IC0521B |
| IES Utilities (Duane Arnold) | T30228 | SS-1613-1 | 4 | R17IC0521B |
| Duke Power (Oconee) | ON33500007310100 | SS-1610-1-16 | 24 | R17GX0505B |
| Westinghouse Savannah River | AC04139A #8 | SS-1610-1-16 | 1 | R17GX0505 |



TUBE FITTINGS

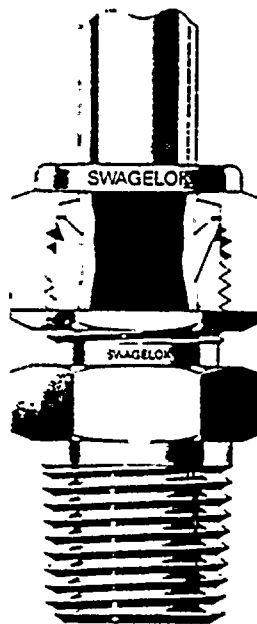

Swagelok
Body

Swagelok
Front
Ferrule

Swagelok
Back
Ferrule

Swagelok
Nut

PART
NO.

1613-1

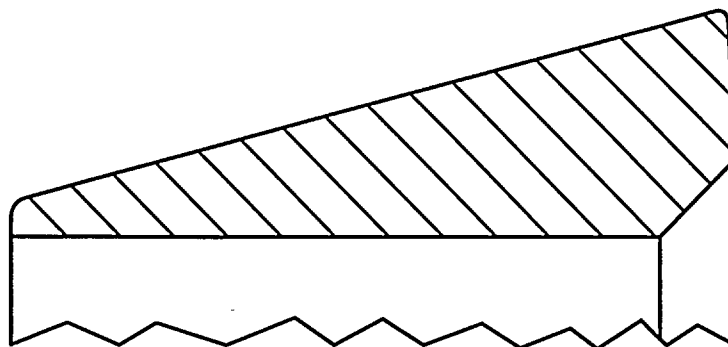

10x SIZE

ACCEPTABLE

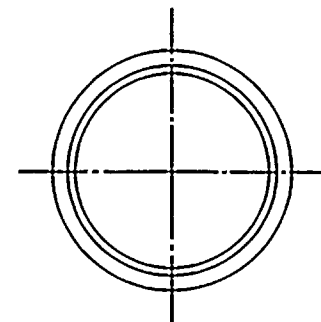

FULL SIZE

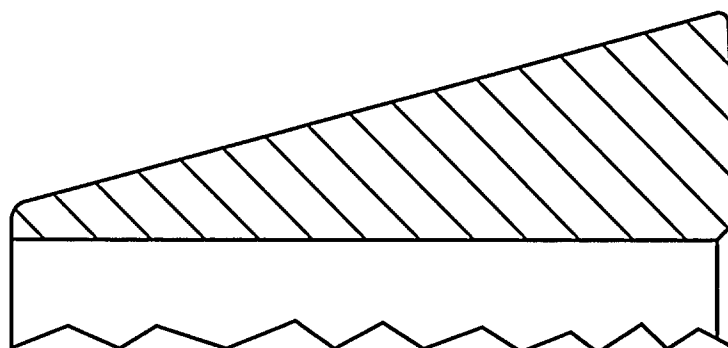

10x SIZE

NOT
ACCEPTABLE

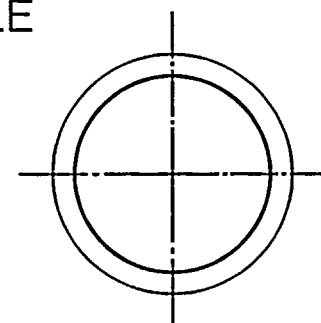

FULL SIZE

CUSTOMER DRAWING

Swagelok
SWAGELOK COMPANY

- DRAWING NOT TO SCALE.
- DIMENSIONS ARE INCHES OVER (MILLIMETERS).
- DRAWING IS SUBJECT TO CHANGE WITHOUT NOTICE.

DRAWN BY

DATE

JN

APPROVED BY

DATE

TITLE

PART
NO.

1613-1

22



50-250
50-251

GENERAL INFORMATION or OTHER

EVENT NUMBER: 34761

LICENSEE: SWAGELOK
CITY: SOLON
COUNTY: CUYAHOGA
LICENSE#:
DOCKET:

REGION: 3
STATE: OH
AGREEMENT: N

NOTIFICATION DATE: 09/11/98
NOTIFICATION TIME: 08:11 [ET]
EVENT DATE: 09/11/98
EVENT TIME: 08:11 [EDT]
LAST UPDATE DATE: 09/11/98

NOTIFICATIONS

JIM GAVULA, REG 3 RDO

JOHN ZEILER, REG 2 FEMA
VERN HODGE, PCEB NRR

NRC NOTIFIED BY: BRUCE FLUSCHE
HQ OPS OFFICER: JOHN MacKINNON

EMERGENCY CLASS: NOT APPLICABLE
10 CFR SECTION:
CDEG 21.21(c) (3) (i) DEFECTS/NONCOMPLIANCE

EVENT TEXT

Swagelok submitted the following Part 21 about a possible machining defect in certain one inch stainless steel Swagelok front ferrules

"We are writing to inform you about a possible machining defect in certain one inch stainless steel Swagelok front ferrules, part number SS-1613-1.

"The front ferrule is shipped as a component in a Swagelok tube fitting, or sold separately as a replacement part.

"A list containing the part numbers of assembled fittings and nuclear safety related certifications under which these ferrules have been sold is enclosed. All of these customers have already been notified by us about this possible problem. Only front ferrules with the heat codes ILA, JVA and JYL stamped on the part are affected; and only one inch ferrules are involved.

"The possible defect is that the 45 degree chamfer on the trailing edge of the ferrule may not be correct. A drawing is enclosed that shows this dimension, along with a drawing that illustrates the front ferrules' position in the Swagelok tube fitting. When these ferrules were machined, an improper set-up allowed a few pieces to be manufactured with an inappropriate dimension. Our inspection of the lots involved shows that about 0.019 per cent of the ferrules manufactured in these lots were affected.

"Laboratory testing of these parts with this incorrect dimension had the tubing slip out of the fitting at three times working pressure of the

(Continued on next page)

tubing.

"Our corrective action includes doubling our sample size on these parts and implementing a long term project to 100 per cent inspect using automation."

Turkey Point, Oconee, and Duane Arnold were contacted by Swagelok of the Part 21 submitted by Swagelok.



Swagelok Company
29500 Solon Road, Solon, OH 44139
Phone: 440-248-4600
Fax: 440-349-5970.

FACSIMILE COVER SHEET

Date: September 11, 1998
To: Document Control Desk/ NRC
From: Bruce Flusche
Total .
Pages: 5
Subject: Potential 10cfr21 notification

Original to follow by certified mail

CONFIDENTIALITY NOTE: This cover sheet and the documents accompanying it contain confidential information that belongs to the sender and is legally privileged. The information is intended only for use by the recipient named above. If you are not the intended recipient, be aware that any disclosure, copying, distribution, or use of its contents is prohibited. If you have received this communication in error, please contact the sender immediately.

