

# Ginna LC 15-1 NRC Written Exam Seating Chart

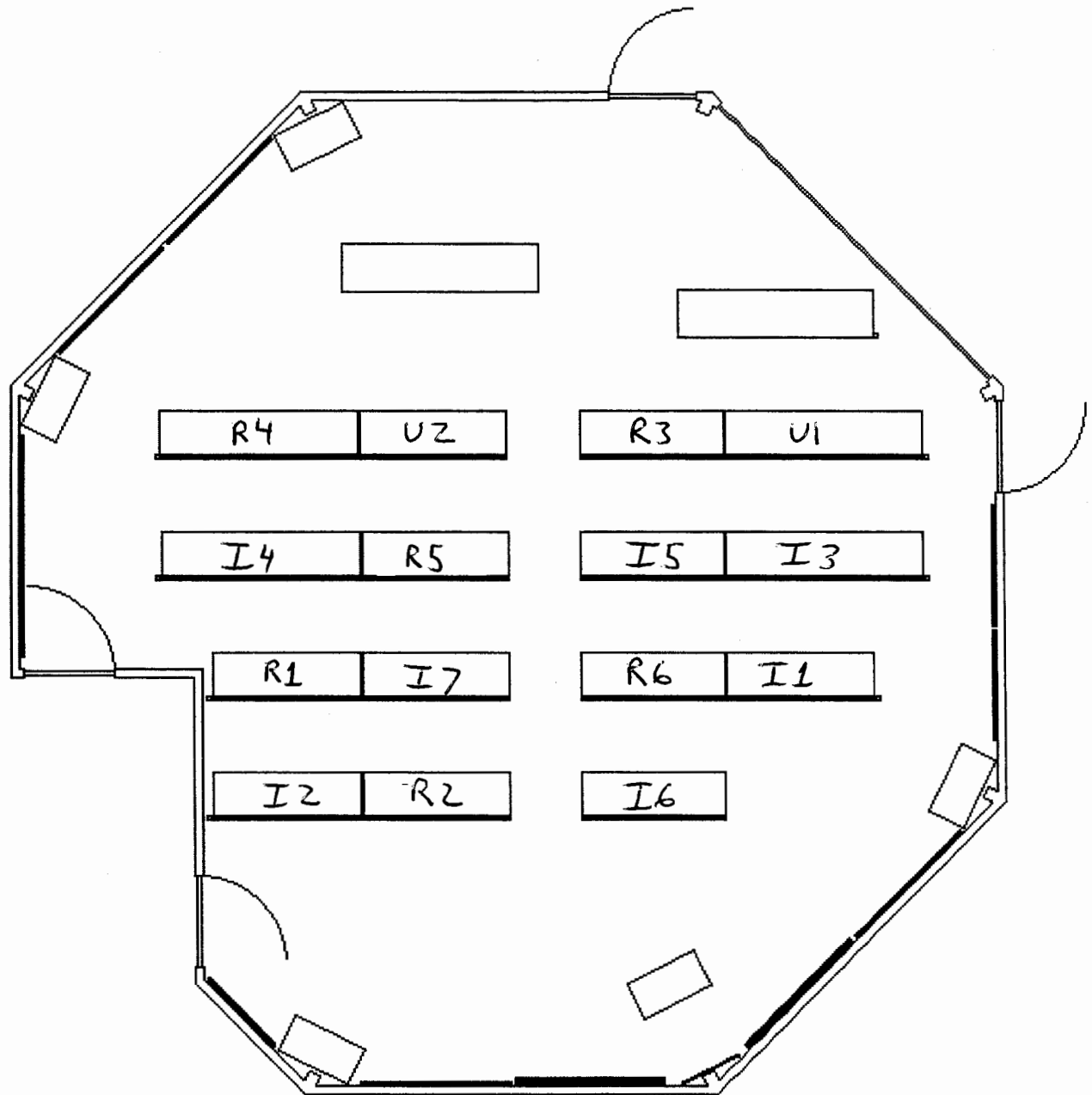

Applicant Name:	I2		
Applicant Level:	RO: <input type="checkbox"/>	SRO: <input checked="" type="checkbox"/>	
RO Question #:	2	SRO Question #:	
Question and Comment: ARE WE TO ASSUME THAT SI DID NOT ACTUATE?  ANSWER QUESTION WITH INFORMATION PROVIDED			
<b>Response:</b>			
Withheld additional guidance. Instructed applicants do the best they can, based on the information provided.			<input checked="" type="checkbox"/>
Did not withhold additional guidance. Provided the following response (enter verbatim).			<input type="checkbox"/>
<b>Changes and Clarifications Made To Examination:</b>			
Identified on white board			<input type="checkbox"/>
Verbally called to applicants attention			<input type="checkbox"/>
NO changes made to key			<input type="checkbox"/>
Pen and ink change made to key, if required			<input type="checkbox"/>
Proctor (Print): DAVID ECKERT			
Proctor (Signature): <i>David Eckert</i>			Date: 3/24/2017

Applicant Name:	U1		
Applicant Level:	RO: <input type="checkbox"/>	SRO: <input checked="" type="checkbox"/>	
RO Question #:	14	SRO Question #:	
Question and Comment: ARE CONTROL RODS IN AUTO OR MANUAL?  THEY ARE IN NORMAL POSITION FOR GIVEN CONDITIONS			
<b>Response:</b>			
Withheld additional guidance. Instructed applicants do the best they can, based on the information provided.			<input checked="" type="checkbox"/>
Did not withhold additional guidance. Provided the following response (enter verbatim).			<input type="checkbox"/>
<b>Changes and Clarifications Made To Examination:</b>			
Identified on white board			<input type="checkbox"/>
Verbally called to applicants attention			<input type="checkbox"/>
NO changes made to key			<input type="checkbox"/>
Pen and ink change made to key, if required			<input type="checkbox"/>
Proctor (Print): DAVID ECKERT			
Proctor (Signature): <i>David Eckert</i>			Date: 3/24/2017

Applicant Name:	I7		
Applicant Level:	RO: <input type="checkbox"/>	SRO: <input checked="" type="checkbox"/>	
RO Question #:	30	SRO Question #:	
Question and Comment: CANNOT ANSWER THE QUESTION WITHOUT BEING GIVEN AFW FLOW RATES.  AFW FLOW IS AS EXPECTED FOR THE GIVEN PLANT CONDITIONS			
<b>Response:</b>			
Withheld additional guidance. Instructed applicants do the best they can, based on the information provided.			<input checked="" type="checkbox"/>
Did not withhold additional guidance. Provided the following response (enter verbatim).			<input type="checkbox"/>
<b>Changes and Clarifications Made To Examination:</b>			
Identified on white board			<input type="checkbox"/>
Verbally called to applicants attention			<input type="checkbox"/>
NO changes made to key			<input type="checkbox"/>
Pen and ink change made to key, if required			<input type="checkbox"/>
Proctor (Print): DAVID ECKERT			
Proctor (Signature): <i>David Eckert</i>			Date: 3/24/2017

Applicant Name:	I2		
Applicant Level:	RO: <input type="checkbox"/>	SRO: <input checked="" type="checkbox"/>	
RO Question #:			SRO Question #: 87
Question and Comment: NO CORRECT ANSWER AS YOU WOULD LOSE AN RCP AND ENTER AP-RCS.2 AND TRANSITION TO E-Φ THEN ES-Φ.1.  ANSWER WHAT YOU FEEL IS THE CORRECT PROCEDURE FLOWPATH BASED ON GIVEN PLANT CONDITIONS.  CALLED CHIEF EXAMINER TO INFORM THAT A CHANGE WILL PROBABLY OCCUR AFTER EXAM REVIEW.			
<b>Response:</b>			
Withheld additional guidance. Instructed applicants do the best they can, based on the information provided.			<input type="checkbox"/>
Did not withhold additional guidance. Provided the following response (enter verbatim).			<input type="checkbox"/>
<b>Changes and Clarifications Made To Examination:</b>			
Identified on white board			<input type="checkbox"/>
Verbally called to applicants attention			<input type="checkbox"/>
NO changes made to key			<input type="checkbox"/>
Pen and ink change made to key, if required			<input type="checkbox"/>
Proctor (Print): DAVID ECKERT			
Proctor (Signature): David Eckert			Date: 3/24/2017

# Exam Item Analysis Report

Exams Graded: 6

Instructor:  
Exam Name:  
Exam Date: Wednesday, March 29, 2017

RU ONLY

Total Possible: 75  
Highest Score: 70 - 93.33%  
Lowest Score: 58 - 77.33%

Class Average: 64.00 - 85.33%  
Class Median: 61.0 - 81.33%  
KR20: 0.679

Correct answers are shown in bold and italics						Blanks	Multiples	Point Biserial	Correct	Percent Incorrect
Q 1	A (1, 16.7%)	<b>B (5, 83.3%)</b>	C (0, 0.0%)	D (0, 0.0%)	E (0, 0.0%)			0.23	5, 83.3%	16.7%
Q 2	A (0, 0.0%)	B (0, 0.0%)	<b>C (6, 100.0%)</b>	D (0, 0.0%)	E (0, 0.0%)			0.00	6, 100.0%	0.0%
Q 3	<b>A (3, 50.0%)</b>	B (0, 0.0%)	C (0, 0.0%)	D (3, 50.0%)	E (0, 0.0%)			-0.48	3, 50.0%	50.0%
Q 4	<b>A (6, 100.0%)</b>	B (0, 0.0%)	C (0, 0.0%)	D (0, 0.0%)	E (0, 0.0%)			0.00	6, 100.0%	0.0%
Q 5	A (0, 0.0%)	B (0, 0.0%)	<b>C (6, 100.0%)</b>	D (0, 0.0%)	E (0, 0.0%)			0.00	6, 100.0%	0.0%
Q 6	A (0, 0.0%)	B (0, 0.0%)	C (0, 0.0%)	<b>D (6, 100.0%)</b>	E (0, 0.0%)			0.00	6, 100.0%	0.0%
Q 7	<b>A (5, 83.3%)</b>	B (0, 0.0%)	C (1, 16.7%)	D (0, 0.0%)	E (0, 0.0%)			0.23	5, 83.3%	16.7%
Q 8	A (2, 33.3%)	B (0, 0.0%)	<b>C (4, 66.7%)</b>	D (0, 0.0%)	E (0, 0.0%)			0.69	4, 66.7%	33.3%
Q 9	A (0, 0.0%)	B (0, 0.0%)	C (0, 0.0%)	<b>D (6, 100.0%)</b>	E (0, 0.0%)			0.00	6, 100.0%	0.0%
Q 10	<b>A (6, 100.0%)</b>	B (0, 0.0%)	C (0, 0.0%)	D (0, 0.0%)	E (0, 0.0%)			0.00	6, 100.0%	0.0%
Q 11	A (0, 0.0%)	<b>B (6, 100.0%)</b>	C (0, 0.0%)	D (0, 0.0%)	E (0, 0.0%)			0.00	6, 100.0%	0.0%
Q 12	A (2, 33.3%)	B (0, 0.0%)	<b>C (4, 66.7%)</b>	D (0, 0.0%)	E (0, 0.0%)			0.06	4, 66.7%	33.3%
Q 13	<b>A (6, 100.0%)</b>	B (0, 0.0%)	C (0, 0.0%)	D (0, 0.0%)	E (0, 0.0%)			0.00	6, 100.0%	0.0%
Q 14	A (0, 0.0%)	B (0, 0.0%)	<b>C (6, 100.0%)</b>	D (0, 0.0%)	E (0, 0.0%)			0.00	6, 100.0%	0.0%
Q 15	A (0, 0.0%)	B (0, 0.0%)	C (0, 0.0%)	<b>D (6, 100.0%)</b>	E (0, 0.0%)			0.00	6, 100.0%	0.0%
Q 16	<b>A (6, 100.0%)</b>	B (0, 0.0%)	C (0, 0.0%)	D (0, 0.0%)	E (0, 0.0%)			0.00	6, 100.0%	0.0%
Q 17	A (1, 16.7%)	B (0, 0.0%)	<b>C (5, 83.3%)</b>	D (0, 0.0%)	E (0, 0.0%)			0.57	5, 83.3%	16.7%
Q 18	A (1, 16.7%)	<b>B (2, 33.3%)</b>	C (3, 50.0%)	D (0, 0.0%)	E (0, 0.0%)			0.79	2, 33.3%	66.7%
Q 19	A (0, 0.0%)	B (0, 0.0%)	C (0, 0.0%)	<b>D (6, 100.0%)</b>	E (0, 0.0%)			0.00	6, 100.0%	0.0%
Q 20	<b>A (6, 100.0%)</b>	B (0, 0.0%)	C (0, 0.0%)	D (0, 0.0%)	E (0, 0.0%)			0.00	6, 100.0%	0.0%
Q 21	A (0, 0.0%)	<b>B (5, 83.3%)</b>	C (0, 0.0%)	D (1, 16.7%)	E (0, 0.0%)			0.23	5, 83.3%	16.7%
Q 22	A (4, 66.7%)	B (0, 0.0%)	<b>C (2, 33.3%)</b>	D (0, 0.0%)	E (0, 0.0%)			-0.27	2, 33.3%	66.7%
Q 23	A (0, 0.0%)	B (0, 0.0%)	C (0, 0.0%)	<b>D (6, 100.0%)</b>	E (0, 0.0%)			0.00	6, 100.0%	0.0%
Q 24	<b>A (6, 100.0%)</b>	B (0, 0.0%)	C (0, 0.0%)	D (0, 0.0%)	E (0, 0.0%)			0.00	6, 100.0%	0.0%
Q 25	A (0, 0.0%)	B (0, 0.0%)	C (0, 0.0%)	<b>D (6, 100.0%)</b>	E (0, 0.0%)			0.00	6, 100.0%	0.0%
Q 26	A (0, 0.0%)	<b>B (6, 100.0%)</b>	C (0, 0.0%)	D (0, 0.0%)	E (0, 0.0%)			0.00	6, 100.0%	0.0%
Q 27	<b>A (6, 100.0%)</b>	B (0, 0.0%)	C (0, 0.0%)	D (0, 0.0%)	E (0, 0.0%)			0.00	6, 100.0%	0.0%

# Exam Item Analysis Report

Exams Graded: 6

Instructor:  
Exam Name:  
Exam Date: Wednesday, March 29, 2017

Total Possible: 75  
Highest Score: 70 - 93.33%  
Lowest Score: 58 - 77.33%

Class Average: 64.00 - 85.33%  
Class Median: 61.0 - 81.33%  
KR20: 0.679

Correct answers are shown in bold and italics						Blanks	Multiples	Point Biserial	Correct	Percent Incorrect
Q 28	A (1, 16.7%)	B (0, 0.0%)	<b>C (5, 83.3%)</b>	D (0, 0.0%)	E (0, 0.0%)			0.23	5, 83.3%	16.7%
Q 29	A (0, 0.0%)	<b>B (5, 83.3%)</b>	C (0, 0.0%)	D (1, 16.7%)	E (0, 0.0%)			0.57	5, 83.3%	16.7%
Q 30	A (1, 16.7%)	B (0, 0.0%)	<b>C (5, 83.3%)</b>	D (0, 0.0%)	E (0, 0.0%)			0.57	5, 83.3%	16.7%
Q 31	A (0, 0.0%)	B (0, 0.0%)	C (0, 0.0%)	<b>D (6, 100.0%)</b>	E (0, 0.0%)			0.00	6, 100.0%	0.0%
Q 32	<b>A (6, 100.0%)</b>	B (0, 0.0%)	C (0, 0.0%)	D (0, 0.0%)	E (0, 0.0%)			0.00	6, 100.0%	0.0%
Q 33	A (0, 0.0%)	B (0, 0.0%)	C (0, 0.0%)	<b>D (6, 100.0%)</b>	E (0, 0.0%)			0.00	6, 100.0%	0.0%
Q 34	A (1, 16.7%)	B (0, 0.0%)	<b>C (5, 83.3%)</b>	D (0, 0.0%)	E (0, 0.0%)			0.57	5, 83.3%	16.7%
Q 35	A (0, 0.0%)	<b>B (6, 100.0%)</b>	C (0, 0.0%)	D (0, 0.0%)	E (0, 0.0%)			0.00	6, 100.0%	0.0%
Q 36	A (0, 0.0%)	B (1, 16.7%)	<b>C (1, 16.7%)</b>	D (4, 66.7%)	E (0, 0.0%)			0.34	1, 16.7%	83.3%
Q 37	A (0, 0.0%)	B (0, 0.0%)	C (0, 0.0%)	<b>D (6, 100.0%)</b>	E (0, 0.0%)			0.00	6, 100.0%	0.0%
Q 38	A (0, 0.0%)	B (0, 0.0%)	<b>C (6, 100.0%)</b>	D (0, 0.0%)	E (0, 0.0%)			0.00	6, 100.0%	0.0%
Q 39	<b>A (6, 100.0%)</b>	B (0, 0.0%)	C (0, 0.0%)	D (0, 0.0%)	E (0, 0.0%)			0.00	6, 100.0%	0.0%
Q 40	A (0, 0.0%)	<b>B (3, 50.0%)</b>	C (1, 16.7%)	D (2, 33.3%)	E (0, 0.0%)			0.92	3, 50.0%	50.0%
Q 41	<b>A (5, 83.3%)</b>	B (1, 16.7%)	C (0, 0.0%)	D (0, 0.0%)	E (0, 0.0%)			0.57	5, 83.3%	16.7%
Q 42	A (1, 16.7%)	<b>B (5, 83.3%)</b>	C (0, 0.0%)	D (0, 0.0%)	E (0, 0.0%)			-0.49	5, 83.3%	16.7%
Q 43	A (0, 0.0%)	B (0, 0.0%)	C (0, 0.0%)	<b>D (6, 100.0%)</b>	E (0, 0.0%)			0.00	6, 100.0%	0.0%
Q 44	A (0, 0.0%)	<b>B (5, 83.3%)</b>	C (1, 16.7%)	D (0, 0.0%)	E (0, 0.0%)			0.23	5, 83.3%	16.7%
Q 45	<b>A (6, 100.0%)</b>	B (0, 0.0%)	C (0, 0.0%)	D (0, 0.0%)	E (0, 0.0%)			0.00	6, 100.0%	0.0%
Q 46	A (0, 0.0%)	B (0, 0.0%)	<b>C (5, 83.3%)</b>	D (1, 16.7%)	E (0, 0.0%)			0.57	5, 83.3%	16.7%
Q 47	A (0, 0.0%)	B (0, 0.0%)	<b>C (4, 66.7%)</b>	D (2, 33.3%)	E (0, 0.0%)			0.69	4, 66.7%	33.3%
Q 48	A (0, 0.0%)	B (0, 0.0%)	C (0, 0.0%)	<b>D (6, 100.0%)</b>	E (0, 0.0%)			0.00	6, 100.0%	0.0%
Q 49	A (0, 0.0%)	<b>B (6, 100.0%)</b>	C (0, 0.0%)	D (0, 0.0%)	E (0, 0.0%)			0.00	6, 100.0%	0.0%
Q 50	A (1, 16.7%)	<b>B (5, 83.3%)</b>	C (0, 0.0%)	D (0, 0.0%)	E (0, 0.0%)			0.57	5, 83.3%	16.7%
Q 51	<b>A (6, 100.0%)</b>	B (0, 0.0%)	C (0, 0.0%)	D (0, 0.0%)	E (0, 0.0%)			0.00	6, 100.0%	0.0%
Q 52	A (3, 50.0%)	<b>B (2, 33.3%)</b>	C (1, 16.7%)	D (0, 0.0%)	E (0, 0.0%)			-0.79	2, 33.3%	66.7%
Q 53	<b>A (2, 33.3%)</b>	B (0, 0.0%)	C (3, 50.0%)	D (1, 16.7%)	E (0, 0.0%)			-0.03	2, 33.3%	66.7%
Q 54	A (1, 16.7%)	B (0, 0.0%)	<b>C (4, 66.7%)</b>	D (1, 16.7%)	E (0, 0.0%)			-0.19	4, 66.7%	33.3%

# Exam Item Analysis Report

Exams Graded: 6

Instructor:  
Exam Name:  
Exam Date: Wednesday, March 29, 2017

Total Possible: 75  
Highest Score: 70 - 93.33%  
Lowest Score: 58 - 77.33%

Class Average: 64.00 - 85.33%  
Class Median: 61.0 - 81.33%  
KR20: 0.679

Correct answers are shown in bold and italics					Blanks	Multiples	Point Biserial	Correct	Percent Incorrect
Q 55	A (2, 33.3%)	B (0, 0.0%)	C (0, 0.0%)	<b><i>D (4, 66.7%)</i></b>	E (0, 0.0%)		-0.03	4, 66.7%	33.3%
Q 56	A (0, 0.0%)	<b><i>B (6, 100.0%)</i></b>	C (0, 0.0%)	D (0, 0.0%)	E (0, 0.0%)		0.00	6, 100.0%	0.0%
Q 57	A (0, 0.0%)	B (0, 0.0%)	C (1, 16.7%)	<b><i>D (5, 83.3%)</i></b>	E (0, 0.0%)		0.23	5, 83.3%	16.7%
Q 58	A (0, 0.0%)	B (0, 0.0%)	<b><i>C (6, 100.0%)</i></b>	D (0, 0.0%)	E (0, 0.0%)		0.00	6, 100.0%	0.0%
Q 59	A (1, 16.7%)	<b><i>B (2, 33.3%)</i></b>	C (0, 0.0%)	D (3, 50.0%)	E (0, 0.0%)		0.14	2, 33.3%	66.7%
Q 60	A (0, 0.0%)	B (0, 0.0%)	C (0, 0.0%)	<b><i>D (6, 100.0%)</i></b>	E (0, 0.0%)		0.00	6, 100.0%	0.0%
Q 61	A (0, 0.0%)	B (0, 0.0%)	<b><i>C (6, 100.0%)</i></b>	D (0, 0.0%)	E (0, 0.0%)		0.00	6, 100.0%	0.0%
Q 62	A (0, 0.0%)	B (0, 0.0%)	C (0, 0.0%)	<b><i>D (6, 100.0%)</i></b>	E (0, 0.0%)		0.00	6, 100.0%	0.0%
Q 63	A (0, 0.0%)	<b><i>B (3, 50.0%)</i></b>	C (1, 16.7%)	D (2, 33.3%)	E (0, 0.0%)		0.28	3, 50.0%	50.0%
Q 64	A (0, 0.0%)	B (0, 0.0%)	C (0, 0.0%)	<b><i>D (6, 100.0%)</i></b>	E (0, 0.0%)		0.00	6, 100.0%	0.0%
Q 65	<b><i>A (6, 100.0%)</i></b>	B (0, 0.0%)	C (0, 0.0%)	D (0, 0.0%)	E (0, 0.0%)		0.00	6, 100.0%	0.0%
Q 66	A (0, 0.0%)	B (1, 16.7%)	C (1, 16.7%)	<b><i>D (4, 66.7%)</i></b>	E (0, 0.0%)		0.23	4, 66.7%	33.3%
Q 67	A (0, 0.0%)	B (0, 0.0%)	<b><i>C (6, 100.0%)</i></b>	D (0, 0.0%)	E (0, 0.0%)		0.00	6, 100.0%	0.0%
Q 68	A (0, 0.0%)	<b><i>B (5, 83.3%)</i></b>	C (0, 0.0%)	D (1, 16.7%)	E (0, 0.0%)		0.23	5, 83.3%	16.7%
Q 69	<b><i>A (6, 100.0%)</i></b>	B (0, 0.0%)	C (0, 0.0%)	D (0, 0.0%)	E (0, 0.0%)		0.00	6, 100.0%	0.0%
Q 70	A (1, 16.7%)	B (0, 0.0%)	C (1, 16.7%)	<b><i>D (4, 66.7%)</i></b>	E (0, 0.0%)		0.41	4, 66.7%	33.3%
Q 71	A (1, 16.7%)	<b><i>B (5, 83.3%)</i></b>	C (0, 0.0%)	D (0, 0.0%)	E (0, 0.0%)		0.23	5, 83.3%	16.7%
Q 72	A (1, 16.7%)	<b><i>B (5, 83.3%)</i></b>	C (0, 0.0%)	D (0, 0.0%)	E (0, 0.0%)		-0.49	5, 83.3%	16.7%
Q 73	A (0, 0.0%)	B (0, 0.0%)	<b><i>C (6, 100.0%)</i></b>	D (0, 0.0%)	E (0, 0.0%)		0.00	6, 100.0%	0.0%
Q 74	<b><i>A (6, 100.0%)</i></b>	B (0, 0.0%)	C (0, 0.0%)	D (0, 0.0%)	E (0, 0.0%)		0.00	6, 100.0%	0.0%
Q 75	A (0, 0.0%)	<b><i>B (5, 83.3%)</i></b>	C (1, 16.7%)	D (0, 0.0%)	E (0, 0.0%)		0.23	5, 83.3%	16.7%



# Exam Item Analysis Report

Exams Graded: 9

Instructor:  
Exam Name:  
Exam Date: Wednesday, March 29, 2017

*SRC ONLY*

Total Possible: 100  
Highest Score: 91 - 91.00%  
Lowest Score: 79 - 79.00%

Class Average: 87.00 - 87.00%  
Class Median: 87.5 - 87.50%  
KR20: 0.580

Correct answers are shown in bold and italics

						Blanks	Multiples	Point Biserial	Correct	Percent Incorrect
Q 1	A (0, 0.0%)	<b>B (9, 100.0%)</b>	C (0, 0.0%)	D (0, 0.0%)	E (0, 0.0%)			0.00	9, 100.0%	0.0%
Q 2	A (1, 11.1%)	B (0, 0.0%)	<b>C (8, 88.9%)</b>	D (0, 0.0%)	E (0, 0.0%)			0.38	8, 88.9%	11.1%
Q 3	<b>A (7, 77.8%)</b>	B (0, 0.0%)	C (0, 0.0%)	D (2, 22.2%)	E (0, 0.0%)			0.84	7, 77.8%	22.2%
Q 4	<b>A (9, 100.0%)</b>	B (0, 0.0%)	C (0, 0.0%)	D (0, 0.0%)	E (0, 0.0%)			0.00	9, 100.0%	0.0%
Q 5	A (0, 0.0%)	B (0, 0.0%)	<b>C (9, 100.0%)</b>	D (0, 0.0%)	E (0, 0.0%)			0.00	9, 100.0%	0.0%
Q 6	A (0, 0.0%)	B (0, 0.0%)	C (0, 0.0%)	<b>D (9, 100.0%)</b>	E (0, 0.0%)			0.00	9, 100.0%	0.0%
Q 7	<b>A (9, 100.0%)</b>	B (0, 0.0%)	C (0, 0.0%)	D (0, 0.0%)	E (0, 0.0%)			0.00	9, 100.0%	0.0%
Q 8	A (4, 44.4%)	B (0, 0.0%)	<b>C (5, 55.6%)</b>	D (0, 0.0%)	E (0, 0.0%)			-0.44	5, 55.6%	44.4%
Q 9	A (0, 0.0%)	B (0, 0.0%)	C (0, 0.0%)	<b>D (9, 100.0%)</b>	E (0, 0.0%)			0.00	9, 100.0%	0.0%
Q 10	<b>A (9, 100.0%)</b>	B (0, 0.0%)	C (0, 0.0%)	D (0, 0.0%)	E (0, 0.0%)			0.00	9, 100.0%	0.0%
Q 11	A (0, 0.0%)	<b>B (9, 100.0%)</b>	C (0, 0.0%)	D (0, 0.0%)	E (0, 0.0%)			0.00	9, 100.0%	0.0%
Q 12	A (2, 22.2%)	B (0, 0.0%)	<b>C (7, 77.8%)</b>	D (0, 0.0%)	E (0, 0.0%)			0.84	7, 77.8%	22.2%
Q 13	<b>A (8, 88.9%)</b>	B (1, 11.1%)	C (0, 0.0%)	D (0, 0.0%)	E (0, 0.0%)			-0.08	8, 88.9%	11.1%
Q 14	A (0, 0.0%)	B (0, 0.0%)	<b>C (9, 100.0%)</b>	D (0, 0.0%)	E (0, 0.0%)			0.00	9, 100.0%	0.0%
Q 15	A (0, 0.0%)	B (0, 0.0%)	C (0, 0.0%)	<b>D (9, 100.0%)</b>	E (0, 0.0%)			0.00	9, 100.0%	0.0%
Q 16	<b>A (9, 100.0%)</b>	B (0, 0.0%)	C (0, 0.0%)	D (0, 0.0%)	E (0, 0.0%)			0.00	9, 100.0%	0.0%
Q 17	A (3, 33.3%)	B (0, 0.0%)	<b>C (6, 66.7%)</b>	D (0, 0.0%)	E (0, 0.0%)			-0.29	6, 66.7%	33.3%
Q 18	A (3, 33.3%)	<b>B (1, 11.1%)</b>	C (5, 55.6%)	D (0, 0.0%)	E (0, 0.0%)			0.01	1, 11.1%	88.9%
Q 19	A (0, 0.0%)	B (0, 0.0%)	C (0, 0.0%)	<b>D (9, 100.0%)</b>	E (0, 0.0%)			0.00	9, 100.0%	0.0%
Q 20	<b>A (8, 88.9%)</b>	B (0, 0.0%)	C (0, 0.0%)	D (1, 11.1%)	E (0, 0.0%)			-0.17	8, 88.9%	11.1%
Q 21	A (0, 0.0%)	<b>B (5, 55.6%)</b>	C (0, 0.0%)	D (4, 44.4%)	E (0, 0.0%)			0.53	5, 55.6%	44.4%
Q 22	A (7, 77.8%)	B (0, 0.0%)	<b>C (2, 22.2%)</b>	D (0, 0.0%)	E (0, 0.0%)			0.17	2, 22.2%	77.8%
Q 23	A (0, 0.0%)	B (0, 0.0%)	C (0, 0.0%)	<b>D (9, 100.0%)</b>	E (0, 0.0%)			0.00	9, 100.0%	0.0%
Q 24	<b>A (9, 100.0%)</b>	B (0, 0.0%)	C (0, 0.0%)	D (0, 0.0%)	E (0, 0.0%)			0.00	9, 100.0%	0.0%
Q 25	A (0, 0.0%)	B (0, 0.0%)	C (0, 0.0%)	<b>D (9, 100.0%)</b>	E (0, 0.0%)			0.00	9, 100.0%	0.0%
Q 26	A (1, 11.1%)	<b>B (8, 88.9%)</b>	C (0, 0.0%)	D (0, 0.0%)	E (0, 0.0%)			0.66	8, 88.9%	11.1%
Q 27	<b>A (9, 100.0%)</b>	B (0, 0.0%)	C (0, 0.0%)	D (0, 0.0%)	E (0, 0.0%)			0.00	9, 100.0%	0.0%

# Exam Item Analysis Report

Exams Graded: 9

Instructor:  
Exam Name:  
Exam Date: Wednesday, March 29, 2017

Total Possible: 100  
Highest Score: 91 - 91.00%  
Lowest Score: 79 - 79.00%

Class Average: 87.00 - 87.00%  
Class Median: 87.5 - 87.50%  
KR20: 0.580

Correct answers are shown in bold and italics						Blanks	Multiples	Point Biserial	Correct	Percent Incorrect
Q 28	A (0, 0.0%)	B (0, 0.0%)	<b>C (9, 100.0%)</b>	D (0, 0.0%)	E (0, 0.0%)			0.00	9, 100.0%	0.0%
Q 29	A (0, 0.0%)	<b>B (9, 100.0%)</b>	C (0, 0.0%)	D (0, 0.0%)	E (0, 0.0%)			0.00	9, 100.0%	0.0%
Q 30	A (0, 0.0%)	B (1, 11.1%)	<b>C (8, 88.9%)</b>	D (0, 0.0%)	E (0, 0.0%)			0.66	8, 88.9%	11.1%
Q 31	A (0, 0.0%)	B (0, 0.0%)	C (0, 0.0%)	<b>D (9, 100.0%)</b>	E (0, 0.0%)			0.00	9, 100.0%	0.0%
Q 32	<b>A (9, 100.0%)</b>	B (0, 0.0%)	C (0, 0.0%)	D (0, 0.0%)	E (0, 0.0%)			0.00	9, 100.0%	0.0%
Q 33	A (0, 0.0%)	B (0, 0.0%)	C (0, 0.0%)	<b>D (9, 100.0%)</b>	E (0, 0.0%)			0.00	9, 100.0%	0.0%
Q 34	A (1, 11.1%)	B (0, 0.0%)	<b>C (8, 88.9%)</b>	D (0, 0.0%)	E (0, 0.0%)			-0.34	8, 88.9%	11.1%
Q 35	A (0, 0.0%)	<b>B (9, 100.0%)</b>	C (0, 0.0%)	D (0, 0.0%)	E (0, 0.0%)			0.00	9, 100.0%	0.0%
Q 36	A (0, 0.0%)	B (0, 0.0%)	<b>C (7, 77.8%)</b>	D (2, 22.2%)	E (0, 0.0%)			0.24	7, 77.8%	22.2%
Q 37	A (0, 0.0%)	B (0, 0.0%)	C (0, 0.0%)	<b>D (9, 100.0%)</b>	E (0, 0.0%)			0.00	9, 100.0%	0.0%
Q 38	A (0, 0.0%)	B (0, 0.0%)	<b>C (8, 88.9%)</b>	D (1, 11.1%)	E (0, 0.0%)			0.66	8, 88.9%	11.1%
Q 39	<b>A (8, 88.9%)</b>	B (0, 0.0%)	C (1, 11.1%)	D (0, 0.0%)	E (0, 0.0%)			-0.08	8, 88.9%	11.1%
Q 40	A (0, 0.0%)	<b>B (7, 77.8%)</b>	C (0, 0.0%)	D (2, 22.2%)	E (0, 0.0%)			0.38	7, 77.8%	22.2%
Q 41	<b>A (9, 100.0%)</b>	B (0, 0.0%)	C (0, 0.0%)	D (0, 0.0%)	E (0, 0.0%)			0.00	9, 100.0%	0.0%
Q 42	A (0, 0.0%)	<b>B (9, 100.0%)</b>	C (0, 0.0%)	D (0, 0.0%)	E (0, 0.0%)			0.00	9, 100.0%	0.0%
Q 43	A (0, 0.0%)	B (0, 0.0%)	C (0, 0.0%)	<b>D (9, 100.0%)</b>	E (0, 0.0%)			0.00	9, 100.0%	0.0%
Q 44	A (3, 33.3%)	<b>B (6, 66.7%)</b>	C (0, 0.0%)	D (0, 0.0%)	E (0, 0.0%)			0.31	6, 66.7%	33.3%
Q 45	<b>A (8, 88.9%)</b>	B (1, 11.1%)	C (0, 0.0%)	D (0, 0.0%)	E (0, 0.0%)			0.66	8, 88.9%	11.1%
Q 46	A (0, 0.0%)	B (1, 11.1%)	<b>C (7, 77.8%)</b>	D (1, 11.1%)	E (0, 0.0%)			0.84	7, 77.8%	22.2%
Q 47	A (0, 0.0%)	B (0, 0.0%)	<b>C (9, 100.0%)</b>	D (0, 0.0%)	E (0, 0.0%)			0.00	9, 100.0%	0.0%
Q 48	A (0, 0.0%)	B (1, 11.1%)	C (0, 0.0%)	<b>D (8, 88.9%)</b>	E (0, 0.0%)			0.10	8, 88.9%	11.1%
Q 49	A (0, 0.0%)	<b>B (9, 100.0%)</b>	C (0, 0.0%)	D (0, 0.0%)	E (0, 0.0%)			0.00	9, 100.0%	0.0%
Q 50	A (0, 0.0%)	<b>B (9, 100.0%)</b>	C (0, 0.0%)	D (0, 0.0%)	E (0, 0.0%)			0.00	9, 100.0%	0.0%
Q 51	<b>A (9, 100.0%)</b>	B (0, 0.0%)	C (0, 0.0%)	D (0, 0.0%)	E (0, 0.0%)			0.00	9, 100.0%	0.0%
Q 52	A (2, 22.2%)	<b>B (7, 77.8%)</b>	C (0, 0.0%)	D (0, 0.0%)	E (0, 0.0%)			0.03	7, 77.8%	22.2%
Q 53	<b>A (3, 33.3%)</b>	B (0, 0.0%)	C (6, 66.7%)	D (0, 0.0%)	E (0, 0.0%)			0.31	3, 33.3%	66.7%
Q 54	A (1, 11.1%)	B (0, 0.0%)	<b>C (7, 77.8%)</b>	D (1, 11.1%)	E (0, 0.0%)			0.24	7, 77.8%	22.2%

# Exam Item Analysis Report

Exams Graded: 9

Instructor:  
Exam Name:  
Exam Date: Wednesday, March 29, 2017

Total Possible: 100  
Highest Score: 91 - 91.00%  
Lowest Score: 79 - 79.00%

Class Average: 87.00 - 87.00%  
Class Median: 87.5 - 87.50%  
KR20: 0.580

Correct answers are shown in bold and italics						Blanks	Multiples	Point Biserial	Correct	Percent Incorrect
Q 55	A (4, 44.4%)	B (0, 0.0%)	C (0, 0.0%)	<b>D (5, 55.6%)</b>	E (0, 0.0%)			-0.23	5, 55.6%	44.4%
Q 56	A (0, 0.0%)	<b>B (9, 100.0%)</b>	C (0, 0.0%)	D (0, 0.0%)	E (0, 0.0%)			0.00	9, 100.0%	0.0%
Q 57	A (0, 0.0%)	B (0, 0.0%)	C (1, 11.1%)	<b>D (8, 88.9%)</b>	E (0, 0.0%)			-0.08	8, 88.9%	11.1%
Q 58	A (0, 0.0%)	B (0, 0.0%)	<b>C (9, 100.0%)</b>	D (0, 0.0%)	E (0, 0.0%)			0.00	9, 100.0%	0.0%
Q 59	A (0, 0.0%)	<b>B (8, 88.9%)</b>	C (0, 0.0%)	D (1, 11.1%)	E (0, 0.0%)			0.66	8, 88.9%	11.1%
Q 60	A (0, 0.0%)	B (0, 0.0%)	C (0, 0.0%)	<b>D (9, 100.0%)</b>	E (0, 0.0%)			0.00	9, 100.0%	0.0%
Q 61	A (0, 0.0%)	B (0, 0.0%)	<b>C (9, 100.0%)</b>	D (0, 0.0%)	E (0, 0.0%)			0.00	9, 100.0%	0.0%
Q 62	A (1, 11.1%)	B (0, 0.0%)	C (0, 0.0%)	<b>D (8, 88.9%)</b>	E (0, 0.0%)			-0.34	8, 88.9%	11.1%
Q 63	A (0, 0.0%)	<b>B (6, 66.7%)</b>	C (2, 22.2%)	D (1, 11.1%)	E (0, 0.0%)			0.00	6, 66.7%	33.3%
Q 64	A (0, 0.0%)	B (0, 0.0%)	C (0, 0.0%)	<b>D (9, 100.0%)</b>	E (0, 0.0%)			0.00	9, 100.0%	0.0%
Q 65	<b>A (9, 100.0%)</b>	B (0, 0.0%)	C (0, 0.0%)	D (0, 0.0%)	E (0, 0.0%)			0.00	9, 100.0%	0.0%
Q 66	A (1, 11.1%)	B (0, 0.0%)	C (0, 0.0%)	<b>D (8, 88.9%)</b>	E (0, 0.0%)			-0.17	8, 88.9%	11.1%
Q 67	A (0, 0.0%)	B (0, 0.0%)	<b>C (9, 100.0%)</b>	D (0, 0.0%)	E (0, 0.0%)			0.00	9, 100.0%	0.0%
Q 68	A (0, 0.0%)	<b>B (7, 77.8%)</b>	C (0, 0.0%)	D (2, 22.2%)	E (0, 0.0%)			-0.23	7, 77.8%	22.2%
Q 69	<b>A (9, 100.0%)</b>	B (0, 0.0%)	C (0, 0.0%)	D (0, 0.0%)	E (0, 0.0%)			0.00	9, 100.0%	0.0%
Q 70	A (0, 0.0%)	B (1, 11.1%)	C (0, 0.0%)	<b>D (8, 88.9%)</b>	E (0, 0.0%)			-0.42	8, 88.9%	11.1%
Q 71	A (0, 0.0%)	<b>B (9, 100.0%)</b>	C (0, 0.0%)	D (0, 0.0%)	E (0, 0.0%)			0.00	9, 100.0%	0.0%
Q 72	A (0, 0.0%)	<b>B (9, 100.0%)</b>	C (0, 0.0%)	D (0, 0.0%)	E (0, 0.0%)			0.00	9, 100.0%	0.0%
Q 73	A (0, 0.0%)	B (0, 0.0%)	<b>C (9, 100.0%)</b>	D (0, 0.0%)	E (0, 0.0%)			0.00	9, 100.0%	0.0%
Q 74	<b>A (9, 100.0%)</b>	B (0, 0.0%)	C (0, 0.0%)	D (0, 0.0%)	E (0, 0.0%)			0.00	9, 100.0%	0.0%
Q 75	A (0, 0.0%)	<b>B (9, 100.0%)</b>	C (0, 0.0%)	D (0, 0.0%)	E (0, 0.0%)			0.00	9, 100.0%	0.0%
Q 76	A (0, 0.0%)	B (0, 0.0%)	<b>C (9, 100.0%)</b>	D (0, 0.0%)	E (0, 0.0%)			0.00	9, 100.0%	0.0%
Q 77	A (0, 0.0%)	<b>B (9, 100.0%)</b>	C (0, 0.0%)	D (0, 0.0%)	E (0, 0.0%)			0.00	9, 100.0%	0.0%
Q 78	<b>A (7, 77.8%)</b>	B (2, 22.2%)	C (0, 0.0%)	D (0, 0.0%)	E (0, 0.0%)			0.17	7, 77.8%	22.2%
Q 79	A (0, 0.0%)	B (0, 0.0%)	C (8, 88.9%)	<b>D (1, 11.1%)</b>	E (0, 0.0%)			0.19	1, 11.1%	88.9%
Q 80	A (0, 0.0%)	B (1, 11.1%)	C (0, 0.0%)	<b>D (8, 88.9%)</b>	E (0, 0.0%)			-0.34	8, 88.9%	11.1%
Q 81	A (0, 0.0%)	B (0, 0.0%)	C (1, 11.1%)	<b>D (8, 88.9%)</b>	E (0, 0.0%)			0.66	8, 88.9%	11.1%

# Exam Item Analysis Report

Exams Graded: 9

Instructor:  
Exam Name:  
Exam Date: Wednesday, March 29, 2017

Total Possible: 100  
Highest Score: 91 - 91.00%  
Lowest Score: 79 - 79.00%

Class Average: 87.00 - 87.00%  
Class Median: 87.5 - 87.50%  
KR20: 0.580

Correct answers are shown in bold and italics					Blanks	Multiples	Point Biserial	Correct	-	Percent Incorrect
Q 82	<b>A (8, 88.9%)</b>	B (1, 11.1%)	C (0, 0.0%)	D (0, 0.0%)	E (0, 0.0%)		0.66	8, 88.9%		11.1%
Q 83	A (0, 0.0%)	B (0, 0.0%)	<b>C (9, 100.0%)</b>	D (0, 0.0%)	E (0, 0.0%)		0.00	9, 100.0%		0.0%
Q 84	A (0, 0.0%)	B (2, 22.2%)	C (2, 22.2%)	<b>D (5, 55.6%)</b>	E (0, 0.0%)		-0.39	5, 55.6%		44.4%
Q 85	<b>A (0, 0.0%)</b>	B (1, 11.1%)	C (8, 88.9%)	D (0, 0.0%)	E (0, 0.0%)		0.00	0, 0.0%		100.0%
Q 86	A (0, 0.0%)	<b>B (9, 100.0%)</b>	C (0, 0.0%)	D (0, 0.0%)	E (0, 0.0%)		0.00	9, 100.0%		0.0%
Q 87	A (4, 44.4%)	B (0, 0.0%)	<b>C (5, 55.6%)</b>	D (0, 0.0%)	E (0, 0.0%)		0.04	5, 55.6%		44.4%
Q 88	A (0, 0.0%)	<b>B (9, 100.0%)</b>	C (0, 0.0%)	D (0, 0.0%)	E (0, 0.0%)		0.00	9, 100.0%		0.0%
Q 89	<b>A (9, 100.0%)</b>	B (0, 0.0%)	C (0, 0.0%)	D (0, 0.0%)	E (0, 0.0%)		0.00	9, 100.0%		0.0%
Q 90	A (0, 0.0%)	<b>B (9, 100.0%)</b>	C (0, 0.0%)	D (0, 0.0%)	E (0, 0.0%)		0.00	9, 100.0%		0.0%
Q 91	<b>A (4, 44.4%)</b>	B (4, 44.4%)	C (1, 11.1%)	D (0, 0.0%)	E (0, 0.0%)		0.53	4, 44.4%		55.6%
Q 92	A (0, 0.0%)	B (0, 0.0%)	C (0, 0.0%)	<b>D (9, 100.0%)</b>	E (0, 0.0%)		0.00	9, 100.0%		0.0%
Q 93	A (0, 0.0%)	B (0, 0.0%)	C (0, 0.0%)	<b>D (9, 100.0%)</b>	E (0, 0.0%)		0.00	9, 100.0%		0.0%
Q 94	A (0, 0.0%)	B (0, 0.0%)	C (1, 11.1%)	<b>D (8, 88.9%)</b>	E (0, 0.0%)		0.10	8, 88.9%		11.1%
Q 95	A (1, 11.1%)	B (0, 0.0%)	<b>C (8, 88.9%)</b>	D (0, 0.0%)	E (0, 0.0%)		-0.17	8, 88.9%		11.1%
Q 96	A (0, 0.0%)	B (3, 33.3%)	C (0, 0.0%)	<b>D (6, 66.7%)</b>	E (0, 0.0%)		-0.50	6, 66.7%		33.3%
Q 97	<b>A (8, 88.9%)</b>	B (1, 11.1%)	C (0, 0.0%)	D (0, 0.0%)	E (0, 0.0%)		0.38	8, 88.9%		11.1%
Q 98	A (0, 0.0%)	B (3, 33.3%)	<b>C (6, 66.7%)</b>	D (0, 0.0%)	E (0, 0.0%)		0.12	6, 66.7%		33.3%
Q 99	A (0, 0.0%)	<b>B (9, 100.0%)</b>	C (0, 0.0%)	D (0, 0.0%)	E (0, 0.0%)		0.00	9, 100.0%		0.0%
Q 100	A (0, 0.0%)	B (0, 0.0%)	<b>C (9, 100.0%)</b>	D (0, 0.0%)	E (0, 0.0%)		0.00	9, 100.0%		0.0%



Joe Pacher  
Site Vice President

R.E. Ginna Nuclear Power Plant  
1503 Lake Rd.  
Ontario, NY 14519

315 791 5200 Office  
585 545 1586 Mobile  
www.exeloncorp.com  
joseph.pacher@exeloncorp.com

January 18, 2017

Mr. David Silk  
U.S. NRC Region 1  
2100 Renaissance Boulevard  
Renaissance Park  
King of Prussia, PA 19406

**R.E. Ginna Nuclear Power Plant**  
Renewed Facility Operating License No. DPR-18  
NRC Docket No. 50-244

Subject: Submittal of Integrated Initial License Examination Materials

Enclosed are the examination materials, which R.E. Ginna is submitting in support of the initial license exam scheduled for the weeks of March 13 and 20, 2017, at Ginna Station.

This submittal includes the Senior Reactor Operator and Reactor Operator Written Examinations, Job Performance Measures, and Integrated Plant Operation Scenario Guides.

These examination materials have been developed in accordance with NUREG-1021, "Operator Licensing Examination Standards for Power Reactors", Revision 10. Please note that reference materials are attached to each individual examination question or item.

Some minor modifications have been made to the Integrated Examination Outline with regards to the operational scenarios in order to improve balance and content. These changes improve examination quality and are in compliance with NUREG-1021, "Operator Licensing Examination Standards for Power Reactors", Revision 10.

Some modifications or adjustments to the examination material may be required due to procedural changes.

In accordance with NUREG-1021, Revision 10, Section ES-201, "Initial Operator Licensing Examination Process", please ensure that these materials are withheld from public disclosure for 2 years after the examinations are complete.

Should you have any questions concerning this letter, please contact Thomas Harding, Manager Site Regulatory Assurance, at (315)791-5219. For questions concerning examination materials, please contact David Eckert, Exam Author, at (315)791-5523.

Respectfully,

A handwritten signature in black ink, appearing to read "JP 3 R", written over the printed name "Joseph E. Pacher".

Joseph E. Pacher

Enclosures: (mail to Dave Silk, Chief Examiner, NRC Region I)

- **DVD containing:**
  - Form ES-401-5, RO/SRO Composite Examination
  - Form ES-C-1, Control Room Systems and Facility Walk-Through Job Performance Measure
  - Form ES-C-1, Administrative Topic Job Performance Measure
  - Form ES-D-1, Scenario Outline, Scenario #1 (N17-1-6)
  - Form ES-D-2, Integrated Plant Operation Scenario Guide, Scenario #1 (N17-1-6)
  - Form ES-D-1, Scenario Outline, Scenario #2 (N17-1-3)
  - Form ES-D-2, Integrated Plant Operation Scenario Guide, Scenario #2 (N17-1-3)
  - Form ES-D-1, Scenario Outline, Scenario #3 (N17-1-5)
  - Form ES-D-2, Integrated Plant Operation Scenario Guide, Scenario #3 (N17-1-5)
  - Form ES-D-1, Scenario Outline, Scenario #4 (N17-1-1)
  - Form ES-D-2, Integrated Plant Operation Scenario Guide, Scenario #4 (N17-1-1)
  - Form ES-D-1, Scenario Outline, Scenario #5 (Spare) (N17-1-4)
  - Form ES-D-2, Integrated Plant Operation Scenario Guide, Scenario #5 (Spare) (N17-1-4)
- 2 Binders containing RO/SRO Written Examination references
- Binder containing Administrative Topic Job Performance Measure references
- Form ES-201-2, Examination Outline Quality Checklist
- Form ES-201-3, Examination Security Agreements (current)
- Form ES-301-1, Administrative Topics Outline for RO
- Form ES-301-2, Control Room/In-Plant Systems Outline for RO
- Form ES-301-1, Administrative Topics Outline for SRO
- Form ES-301-2, Control Room/In-Plant Systems Outline for SRO(I)
- Form ES-301-2, Control Room/In-Plant Systems Outline for SRO(U)
- Form ES-301-3, Operating Test Quality Checklist
- Form ES-301-4, Simulator Scenario Quality Checklist
- Form ES-301-5, Transient and Event Checklist
- Form ES-301-6, Competencies Checklist
- Form ES-401-2, PWR Examination Outline (RO and SRO)
- Form ES-401-3, Generic Knowledge and Abilities Outline (Tier 3)
- Form ES-401-4, Record of Rejected K/As
- Form ES-401-6, Written Examination Quality Checklist

cc: (without enclosures)  
Branch Chief, Operator Licensing, Region 1 – Mr. Donald Jackson  
NRC Senior Resident Inspector – Ginna Station - Mr. Neil Perry

Bcc: (without enclosures)  
Site Vice President  
Manager – Site Regulatory Assurance  
Training Director



**Joe Pacher**  
Site Vice President

R.E. Ginna Nuclear Power Plant  
1503 Lake Rd.  
Ontario, NY 14519

315 791 5200 Office  
585 545 1586 Mobile  
www.exeloncorp.com

joseph.pacher@exeloncorp.com

December 09, 2016

Mr. David Silk  
U.S. NRC Region 1  
2100 Renaissance Boulevard  
Renaissance Park  
King of Prussia, PA 19406

**R.E. Ginna Nuclear Power Plant**  
Renewed Facility Operating License No. DPR-18  
NRC Docket No. 50-244

Subject: Submittal of Initial Operator Licensing Examination Outline

Enclosed are the examination outlines, supporting the initial license exam scheduled during the weeks of March 13 and 20, 2017 at Ginna Station.

This submittal includes all appropriate examination standard forms and outlines in accordance with NUREG-1021, "Operator Licensing Examination Standards for Power Reactors", Revision 10. Also enclosed is the proposed examination schedule for the licensing exam.

In accordance with NUREG-1021, Revision 10, Section ES-201, "Initial Operator Licensing Examination Process", please ensure that these materials are withheld from public disclosure for 2 years after the examinations are complete.

Should you have any questions concerning this letter, please contact Thomas Harding, Manager Site Regulatory Assurance, at (315)791-5219. For questions concerning examination materials, please contact David Eckert, Exam Author, at (315)791-5523.

Respectfully,

A handwritten signature in black ink, appearing to read "Joe Pacher", with a stylized flourish at the end.

Joseph E. Pacher

Enclosures: (mail to Dave Silk, Chief Examiner, NRC Region I)

Form ES-201-2, Examination Outline Quality Checklist  
Form ES-201-3, Examination Security Agreements (currently)  
Form ES-301-1, Administrative Topics Outline for RO  
Form ES-301-2, Control Room/In-Plant Systems Outline for RO  
Form ES-301-1, Administrative Topics Outline for SRO  
Form ES-301-2, Control Room/In-Plant Systems Outline for SRO(I)  
Form ES-301-2, Control Room/In-Plant Systems Outline for SRO(U)  
Form ES-301-5, Transient and Event Checklist  
Form ES-401-2, PWR Examination Outline (RO and SRO)  
Form ES-401-3, Generic Knowledge and Abilities Outline (Tier 3)  
Statement detailing method of Written Examination Outline generation  
Form ES-401-4, Record of Rejected K/As  
Form ES-D-1, Scenario Outline, Scenario #1  
Form ES-D-1, Scenario Outline, Scenario #2  
Form ES-D-1, Scenario Outline, Scenario #3  
Form ES-D-1, Scenario Outline, Scenario #4  
Form ES-D-1, Scenario Outline, Scenario #5 (Spare)  
LC 15-1 CERT Exam Outlines

cc: (without enclosures)  
Branch Chief, Operator Licensing, Region 1 – Mr. Donald Jackson  
NRC Senior Resident Inspector – Ginna Station - Mr. Neil Perry  
NRR Project Manager – Mrs. Brenda Mozafari

Bcc: (without enclosures)  
Site Vice President  
Manager – Site Regulatory Assurance  
Training Director



## 2017 ILT NRC Exam Outline Generation Methodology

The following method was used to generate the INITIAL outline submitted to the NRC for this exam:

- A. NUREG-1122, unsuppressed K/A statements and the list of Rejected K/As from the 2014 ILT NRC Exam were reviewed for possible addition/removal to the Suppressed K/A listing.
- B. The Suppressed K/As sent to the Chief Examiner (Dave Silk) on 05/11/2016 were suppressed in the NKEG software program database.
- C. The Westinghouse NRC KA Exam Generator software program (NKEG), Version 1.1, is loaded on the stand-alone exam development computer. This software application provides a means of accessing Revision 2 versions of NUREG-1122, Knowledge and Abilities Catalog for Nuclear Power Plant Operators. A random exam outline was generated on 08/05/2016 for the RO and SRO sections of the ILT Exam.
- D. The random outline from NKEG was manually inputted into an Excel spreadsheet that verifies ES-401-2 requirements are met. No issues were noted.
- E. On 11/22/2016, discussed with the Chief Examiner (Dave Silk) rejecting K/A 039 2.2.39 due to no Technical Specification Action Statements less than or equal to one hour exist for the Main Steam system. A replacement K/A for System 039 was selected by determining the number of remaining K/As and randomly selecting a numbered chip.
- F. On 12/5/2016, the replacement K/A was manually inputted into an Excel spreadsheet that verifies ES-401-2 requirements are met. No issues were noted.

This was the method I used to generate the random outline used to develop the ILT NRC Exam.

  
Ginna Exam Author / Date