



January 11, 2017

US Nuclear Regulatory Commission, Region III  
2443 Warrenville Road  
Suite 210  
Lisle, IL 60532-4352

Dear Sir or Madam:

Please accept this letter of notification of the closing of the Community Westview Hospital facility at 3630 Guion Road, Indianapolis, IN 46222, **License # 13-18543-01**.

On December 8, 2016 all radioactive sources were removed from the facility and the facility was surveyed. One dose calibrator source was transferred to Community Health Network and the remaining were disposed via Bionomics, Inc. Receipt acknowledgement is attached. All short-lived waste had been decayed in storage and was disposed of after surveys indicated background levels.

Following are the long-lived sources removed from the facility:

Radionuclide	mCi	Type	Assay Date	Mod/Ser#	Final disposition
Cs-137	0.000104	Rod	12/1975	076005-0589	Bionomics, Inc.
Co-57	0.000126	Rod	9/30/2011	BM080511271107	Bionomics, Inc.
Cs-137	0.188	Vial	7/25/1979	NES 356	Bionomics, Inc.
Co-57	5.9	Vial	10/10/2011	BM06057E11278150	Bionomics, Inc.
Cs-137	0.01	Disk	10/13/2014	CS1371014282113	Bionomics, Inc.
Co-57	10.0	Flood	4/27/2016	BM01L1016088304	Bionomics, Inc.
Ba-133	0.287	Vial	9/2/2011	BM06133E11256116	Community Health Network License # 13-18543-01

The facility was surveyed with a GM and the exposure levels in all areas were at background. Wipes were taken and all were below contamination limits. Please see attached map and wipe results.

All dosimetry records have been transferred to Community Health Network at 1500 North Ritter Avenue, Indianapolis, IN 46219. Employees will be notified of final dosimetry readings upon receipt of final dosimetry report.

RECEIVED JAN 18 2017



No radioactive materials remain at this facility and it is requested that this license be terminated.

If you have further questions or concerns, please contact Erin Bell, RSO of Community Health Network, who will be retaining all records from Community Westview Hospital.

Sincerely,

A handwritten signature in black ink that reads "Erin Bell".

Erin Bell, MHP  
Community Health Network  
1500 North Ritter Avenue  
Indianapolis, IN 46219  
(o) 317.355.5528  
(c) 317.313.0406



P.O. Box 817 – Kingston, TN 37763 – (865) 220-8501

January 2, 2017

**Receipt Acknowledgment**

Erin Bell  
Community Westview Hospital  
3630 Guion Road  
Indianapolis, IN 46222

Dear Erin Bell:

As required by 10 CFR Part 20 (Appendix G), this letter is notification that EnergySolutions (formerly Duratek) has received the shipment recently picked up at your facility on **December 8, 2016**.

Attached you will find a copy of your NRC Form 540, the only change from the original is in Item No. 9 "signature" which identifies that EnergySolutions is acknowledging receipt of waste from your facility.

Please keep this with your original, as well as future disposal certifications.

If you have any questions, please feel free to contact me at (865) 220-8501.

Sincerely,

*D. Agana*

Denise Agana  
Shipping/Transportation

Cc: File: 2016-23  
Manifest# 1216CWA





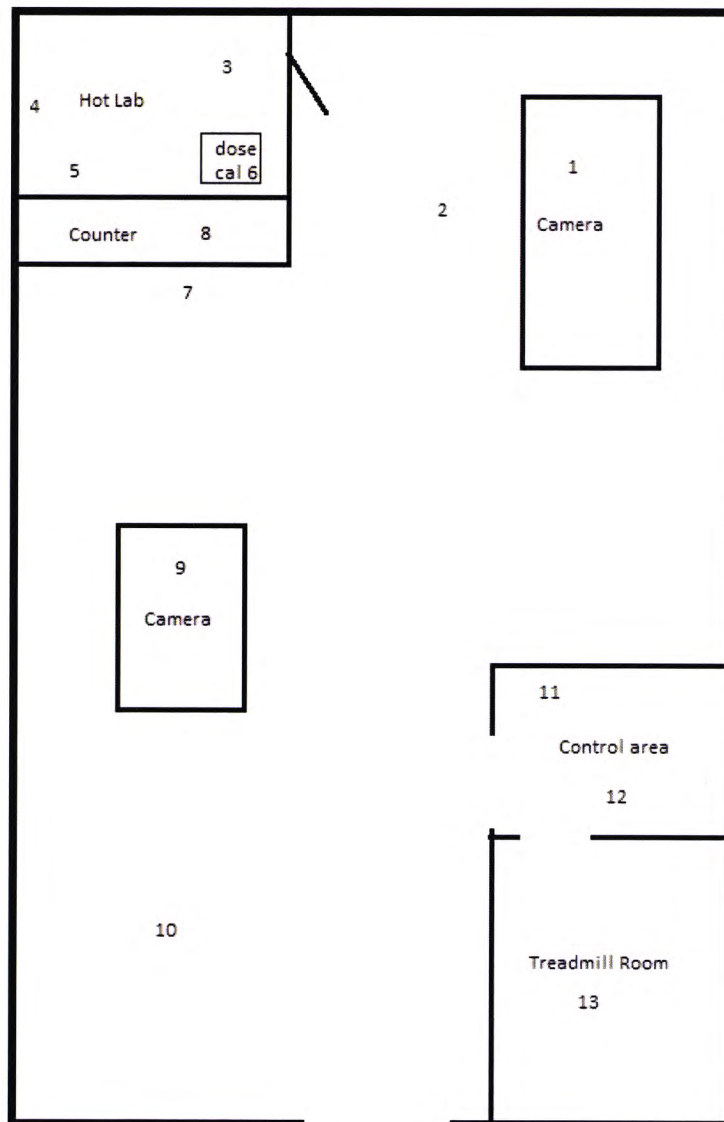



# Community Westview

3630 Guion Rd  
Indianapolis, IN 46222

## Wipe Test Detail Report

Printed on: 12/8/2016 11:04:38 AM

Report Options: Today, For Area: Weekly Wipes

Thursday, December 08, 2016

Area: Weekly Wipes

Type: Restricted (50%)

Location : **1 (Pass)**

Time Stamp : 12/8/2016 10:50 AM

Count Time : 30 (secs)

Performed By : Jodi Hartzler

Detector : Well - 241 (S/N: 241)

Isotope	Background	MDA	Net CPM	Net Activity	Trigger	Status
Wide Window	959 DPM	353 DPM	-6.0	-17 DPM	20,000 DPM	Pass
I-123 (Well)	81 DPM	9 DPM	-12.0	-19 DPM	2,000 DPM	Pass
I-131	141 DPM	19 DPM	-2.0	-7 DPM	2,000 DPM	Pass
Tc-99m	42 DPM	7 DPM	-16.0	-20 DPM	2,000 DPM	Pass

Location : **10 (Pass)**

Time Stamp : 12/8/2016 11:00 AM

Count Time : 30 (secs)

Performed By : Jodi Hartzler

Detector : Well - 241 (S/N: 241)

Isotope	Background	MDA	Net CPM	Net Activity	Trigger	Status
Wide Window	959 DPM	353 DPM	58.0	160 DPM	20,000 DPM	Pass
I-123 (Well)	81 DPM	9 DPM	12.0	19 DPM	2,000 DPM	Pass
I-131	141 DPM	19 DPM	-8.0	-28 DPM	2,000 DPM	Pass
Tc-99m	42 DPM	7 DPM	-4.0	-5 DPM	2,000 DPM	Pass

Location : **11 (Pass)**

Time Stamp : 12/8/2016 11:01 AM

Count Time : 30 (secs)

Performed By : Jodi Hartzler

Detector : Well - 241 (S/N: 241)

Isotope	Background	MDA	Net CPM	Net Activity	Trigger	Status
Wide Window	959 DPM	353 DPM	-24.0	-66 DPM	20,000 DPM	Pass
I-123 (Well)	81 DPM	9 DPM	-14.0	-23 DPM	2,000 DPM	Pass
I-131	141 DPM	19 DPM	-8.0	-28 DPM	2,000 DPM	Pass
Tc-99m	42 DPM	7 DPM	-2.0	-2 DPM	2,000 DPM	Pass

Location : **12 (Pass)**

Time Stamp : 12/8/2016 11:02 AM

Count Time : 30 (secs)

Performed By : Jodi Hartzler

Detector : Well - 241 (S/N: 241)

Isotope	Background	MDA	Net CPM	Net Activity	Trigger	Status
Wide Window	959 DPM	353 DPM	-30.0	-83 DPM	20,000 DPM	Pass
I-123 (Well)	81 DPM	9 DPM	4.0	6 DPM	2,000 DPM	Pass
I-131	141 DPM	19 DPM	-16.0	-57 DPM	2,000 DPM	Pass
Tc-99m	42 DPM	7 DPM	-2.0	-2 DPM	2,000 DPM	Pass

Comments :

Signature :

*E. Bell*

Date Signed :

*12/8/16*

# Community Westview

3630 Guion Rd  
Indianapolis, IN 46222

Location : **13 (Pass)**

Time Stamp : 12/8/2016 11:03 AM

Count Time : 30 (secs)

Performed By : Jodi Hartzler

Detector : Well - 241 (S/N: 241)

Isotope	Background	MDA	Net CPM	Net Activity	Trigger	Status
Wide Window	959 DPM	353 DPM	6.0	17 DPM	20,000 DPM	Pass
I-123 (Well)	81 DPM	9 DPM	-12.0	-19 DPM	2,000 DPM	Pass
I-131	141 DPM	19 DPM	2.0	7 DPM	2,000 DPM	Pass
Tc-99m	42 DPM	7 DPM	2.0	2 DPM	2,000 DPM	Pass

Location : **2 (Pass)**

Time Stamp : 12/8/2016 10:52 AM

Count Time : 30 (secs)

Performed By : Jodi Hartzler

Detector : Well - 241 (S/N: 241)

Isotope	Background	MDA	Net CPM	Net Activity	Trigger	Status
Wide Window	959 DPM	353 DPM	48.0	132 DPM	20,000 DPM	Pass
I-123 (Well)	81 DPM	9 DPM	2.0	3 DPM	2,000 DPM	Pass
I-131	141 DPM	19 DPM	2.0	7 DPM	2,000 DPM	Pass
Tc-99m	42 DPM	7 DPM	-10.0	-12 DPM	2,000 DPM	Pass

Location : **3 (Pass)**

Time Stamp : 12/8/2016 10:53 AM

Count Time : 30 (secs)

Performed By : Jodi Hartzler

Detector : Well - 241 (S/N: 241)

Isotope	Background	MDA	Net CPM	Net Activity	Trigger	Status
Wide Window	959 DPM	353 DPM	62.0	171 DPM	20,000 DPM	Pass
I-123 (Well)	81 DPM	9 DPM	-12.0	-19 DPM	2,000 DPM	Pass
I-131	141 DPM	19 DPM	-6.0	-21 DPM	2,000 DPM	Pass
Tc-99m	42 DPM	7 DPM	-8.0	-10 DPM	2,000 DPM	Pass

Location : **4 (Pass)**

Time Stamp : 12/8/2016 10:54 AM

Count Time : 30 (secs)

Performed By : Jodi Hartzler

Detector : Well - 241 (S/N: 241)

Isotope	Background	MDA	Net CPM	Net Activity	Trigger	Status
Wide Window	959 DPM	353 DPM	82.0	226 DPM	20,000 DPM	Pass
I-123 (Well)	81 DPM	9 DPM	-6.0	-10 DPM	2,000 DPM	Pass
I-131	141 DPM	19 DPM	-2.0	-7 DPM	2,000 DPM	Pass
Tc-99m	42 DPM	7 DPM	-10.0	-12 DPM	2,000 DPM	Pass

Location : **5 (Pass)**

Time Stamp : 12/8/2016 10:55 AM

Count Time : 30 (secs)

Performed By : Jodi Hartzler

Detector : Well - 241 (S/N: 241)

Isotope	Background	MDA	Net CPM	Net Activity	Trigger	Status
Wide Window	959 DPM	353 DPM	-20.0	-55 DPM	20,000 DPM	Pass
I-123 (Well)	81 DPM	9 DPM	-22.0	-35 DPM	2,000 DPM	Pass
I-131	141 DPM	19 DPM	-4.0	-14 DPM	2,000 DPM	Pass
Tc-99m	42 DPM	7 DPM	-24.0	-30 DPM	2,000 DPM	Pass

Comments :

Signature :

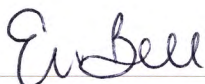

Date Signed :

12/8/16



# Community Westview

3630 Guion Rd  
Indianapolis, IN 46222

Location : **6 (Pass)**

Time Stamp : 12/8/2016 10:56 AM

Count Time : 30 (secs)

Performed By : Jodi Hartzler

Detector : Well - 241 (S/N: 241)

Isotope	Background	MDA	Net CPM	Net Activity	Trigger	Status
Wide Window	959 DPM	353 DPM	28.0	77 DPM	20,000 DPM	Pass
I-123 (Well)	81 DPM	9 DPM	-2.0	-3 DPM	2,000 DPM	Pass
I-131	141 DPM	19 DPM	8.0	28 DPM	2,000 DPM	Pass
Tc-99m	42 DPM	7 DPM	-2.0	-2 DPM	2,000 DPM	Pass

Location : **7 (Pass)**

Time Stamp : 12/8/2016 10:57 AM

Count Time : 30 (secs)

Performed By : Jodi Hartzler

Detector : Well - 241 (S/N: 241)

Isotope	Background	MDA	Net CPM	Net Activity	Trigger	Status
Wide Window	959 DPM	353 DPM	-14.0	-39 DPM	20,000 DPM	Pass
I-123 (Well)	81 DPM	9 DPM	0.0	0 DPM	2,000 DPM	Pass
I-131	141 DPM	19 DPM	-14.0	-50 DPM	2,000 DPM	Pass
Tc-99m	42 DPM	7 DPM	4.0	5 DPM	2,000 DPM	Pass

Location : **8 (Pass)**

Time Stamp : 12/8/2016 10:58 AM

Count Time : 30 (secs)

Performed By : Jodi Hartzler

Detector : Well - 241 (S/N: 241)

Isotope	Background	MDA	Net CPM	Net Activity	Trigger	Status
Wide Window	959 DPM	353 DPM	68.0	187 DPM	20,000 DPM	Pass
I-123 (Well)	81 DPM	9 DPM	0.0	0 DPM	2,000 DPM	Pass
I-131	141 DPM	19 DPM	4.0	14 DPM	2,000 DPM	Pass
Tc-99m	42 DPM	7 DPM	0.0	0 DPM	2,000 DPM	Pass

Location : **9 (Pass)**

Time Stamp : 12/8/2016 10:59 AM

Count Time : 30 (secs)

Performed By : Jodi Hartzler

Detector : Well - 241 (S/N: 241)

Isotope	Background	MDA	Net CPM	Net Activity	Trigger	Status
Wide Window	959 DPM	353 DPM	40.0	110 DPM	20,000 DPM	Pass
I-123 (Well)	81 DPM	9 DPM	0.0	0 DPM	2,000 DPM	Pass
I-131	141 DPM	19 DPM	-4.0	-14 DPM	2,000 DPM	Pass
Tc-99m	42 DPM	7 DPM	-12.0	-15 DPM	2,000 DPM	Pass

Location : **Hot Lab (1-5) (Pass)**

Time Stamp : 12/8/2016 10:44 AM

Count Time : 30 (secs)

Performed By : Jodi Hartzler

Detector : Well - 241 (S/N: 241)

Isotope	Background	MDA	Net CPM	Net Activity	Trigger	Status
Wide Window	959 DPM	353 DPM	10.0	28 DPM	20,000 DPM	Pass
I-123 (Well)	81 DPM	9 DPM	2.0	3 DPM	2,000 DPM	Pass
I-131	141 DPM	19 DPM	-12.0	-42 DPM	2,000 DPM	Pass
Tc-99m	42 DPM	7 DPM	2.0	2 DPM	2,000 DPM	Pass

Comments :

Signature :

*Gi Bell*

Date Signed :

*12/8/16*





GRW BEN 22002  
Community Hospital East  
1500 North Ritter Avenue  
Indianapolis, Indiana 46219-3095

RETURN  
SERVICE  
REQUESTED

neopost<sup>®</sup>  
01/11/2017  
FIRST-CLASS MAIL  
AUTO  
US POSTAGE \$000.64<sup>8</sup>  
ZIP 46219  
041M12250930

US Nuclear Regulatory Commission  
2443 Warrenville Road  
Suite 210  
Lisle, IL 60532-4352

RECEIVED JAN 18 2017