

GENERAL NOTES:

1. AT INTERSECTION OF N-S & E-W BASE LINES,
TEXAS STATE GRID COORDINATE N 230,220;
E 1,911,370 EQUALS PLANT COORDINATE
N 10,000; E 10,000.

COMANCHE PEAK N P P
FINAL SAFETY ANALYSIS REPORT
UNITS 1 AND 2

PLOT PLAN

FIGURE 1.2-1

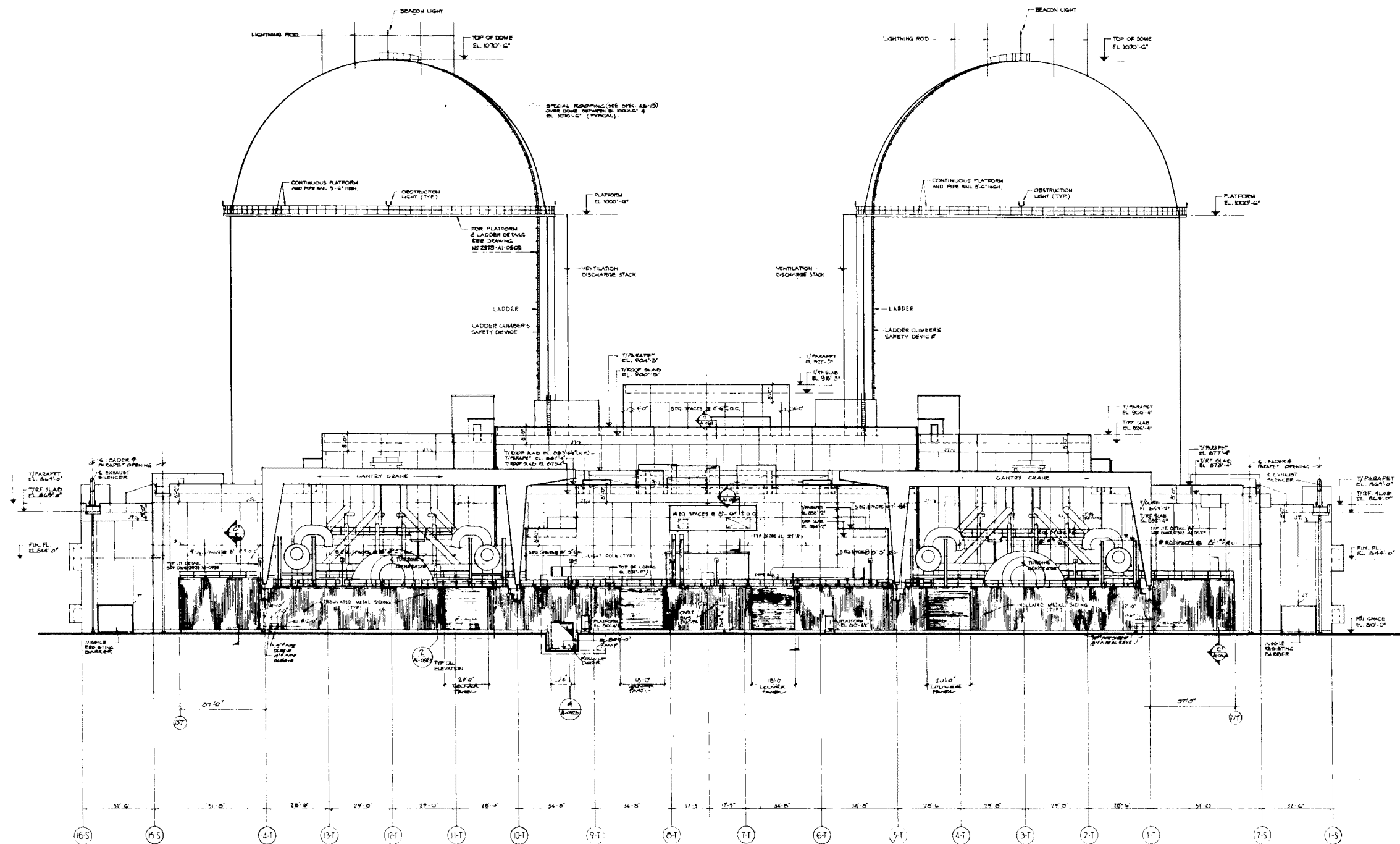

WEST ELEVATION SCALE 1/8"=1'-0"

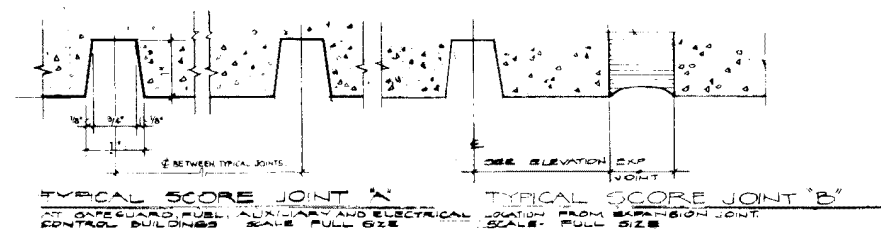

DWG. No 2323-A1-0523
REV. 5

AMENDMENT 10
MARCH 31, 1980

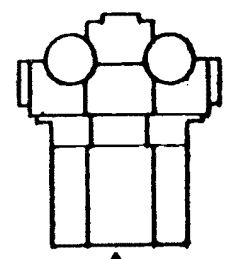

COMANCHE PEAK S.E.S.
FINAL SAFETY ANALYSIS REPORT
UNITS 1 and 2

WEST ELEVATION

FIGURE No. 1-2-2

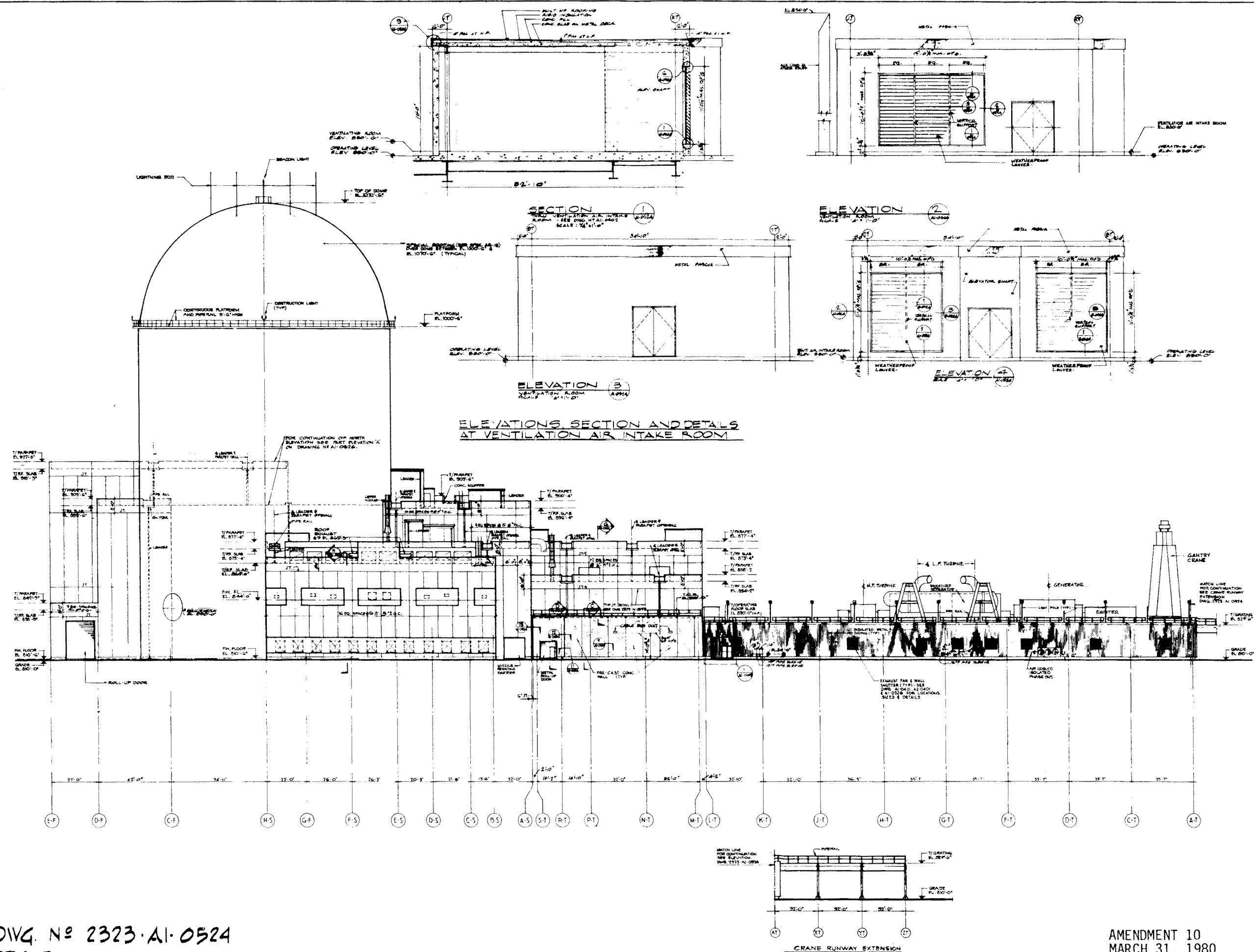

DWG. N° 2323-A1-0524
REV. 5

AMENDMENT 10
MARCH 31, 1980

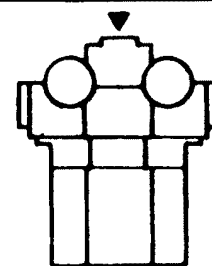

EAST ELEVATION

FIGURE N° 1.2-4

AMENDMENT 10
MARCH 31, 1980

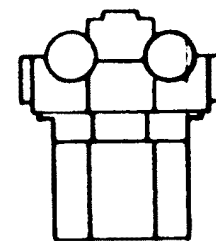
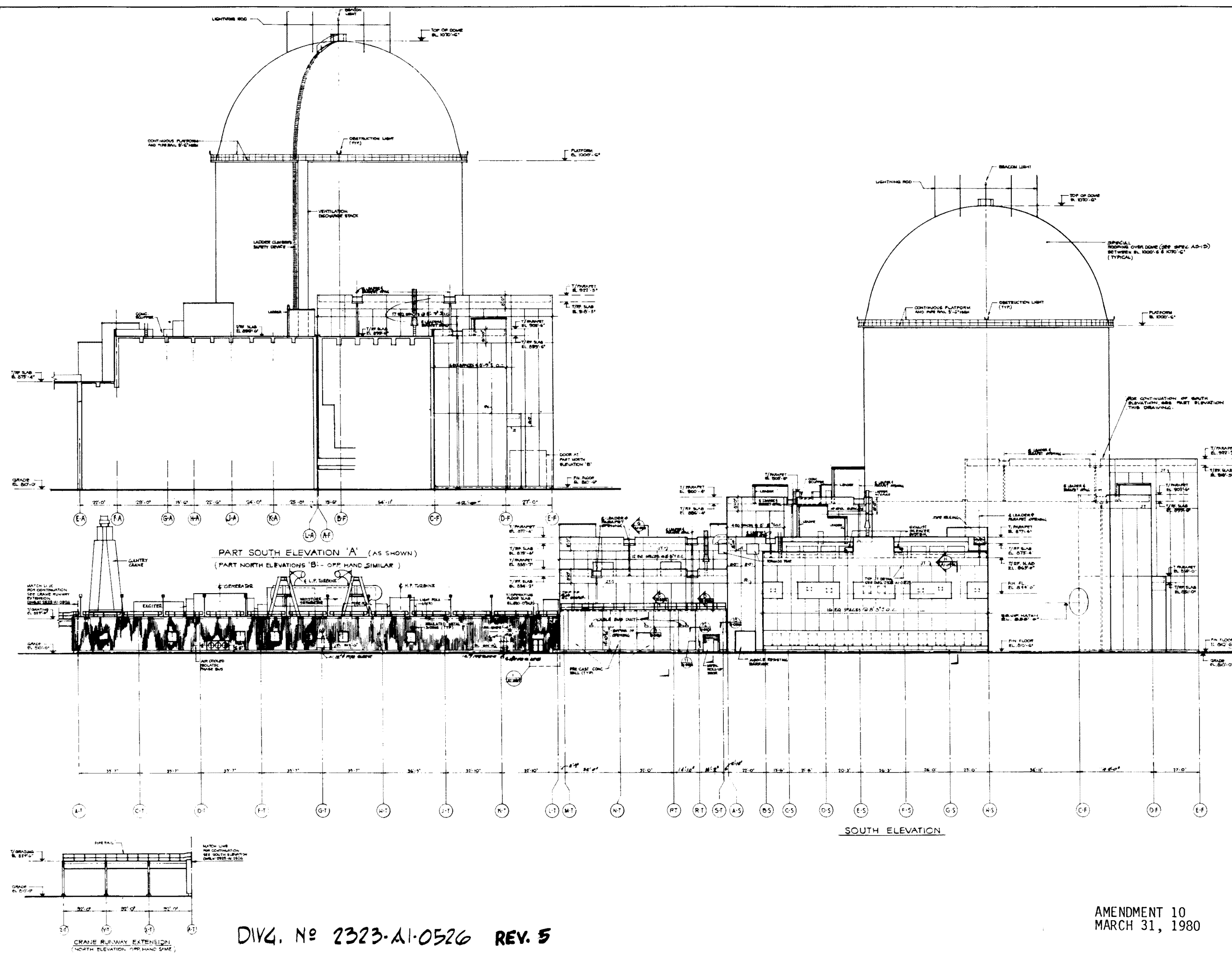

COMANCHE PEAK S.E.S.
FINAL SAFETY ANALYSIS REPORT
UNITS 1 and 2

SOUTH AND PART
ELEVATIONS

FIGURE N° 1.2-5

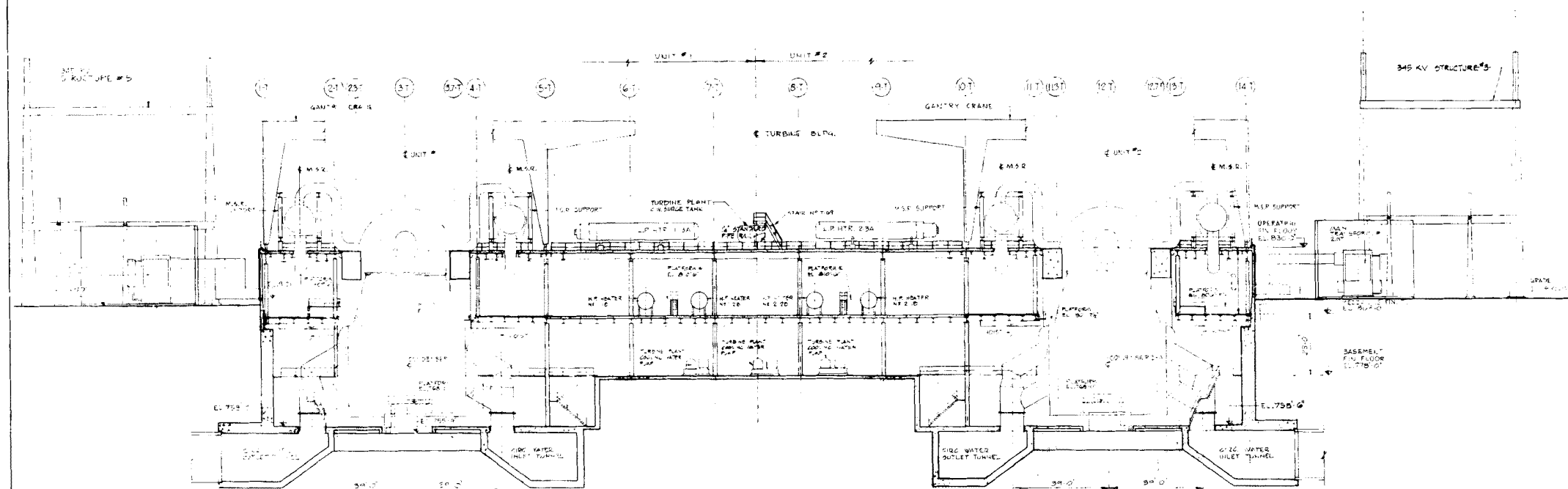

CROSS-SECTION A-A

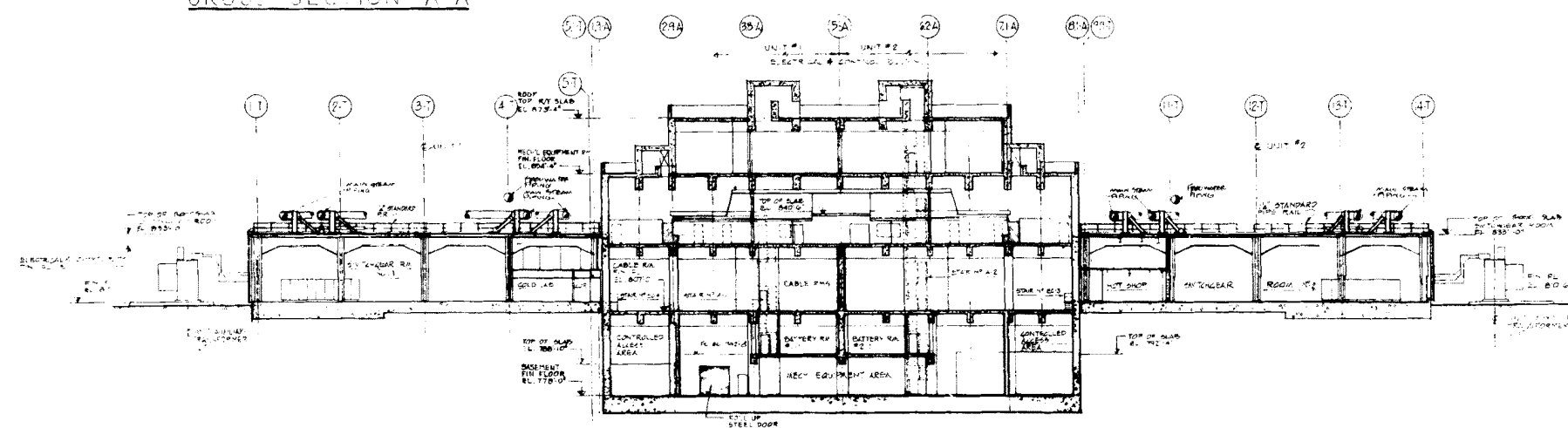

CROSS-SECTION B-B

DWG. NO 2323-A1-0527
REV. NO 6

AMENDMENT 10
MARCH 31, 1980

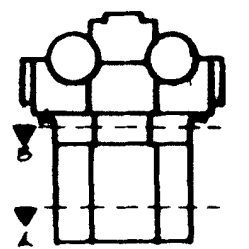

COMANCHE PEAK S.E.S.
FINAL SAFETY ANALYSIS REPORT
UNITS 1 and 2

BUILDING CROSS-SECTION
A-A, B-B

FIGURE NO 12-G

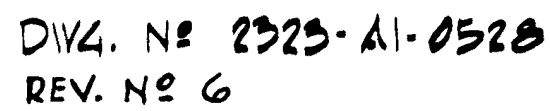

COMANCHE PEAK S.E.S.
FINAL SAFETY ANALYSIS REPORT
UNITS 1 and 2

BUILDING CROSS-SECTION
C-C.

FIGURE N° 1.2 - 7

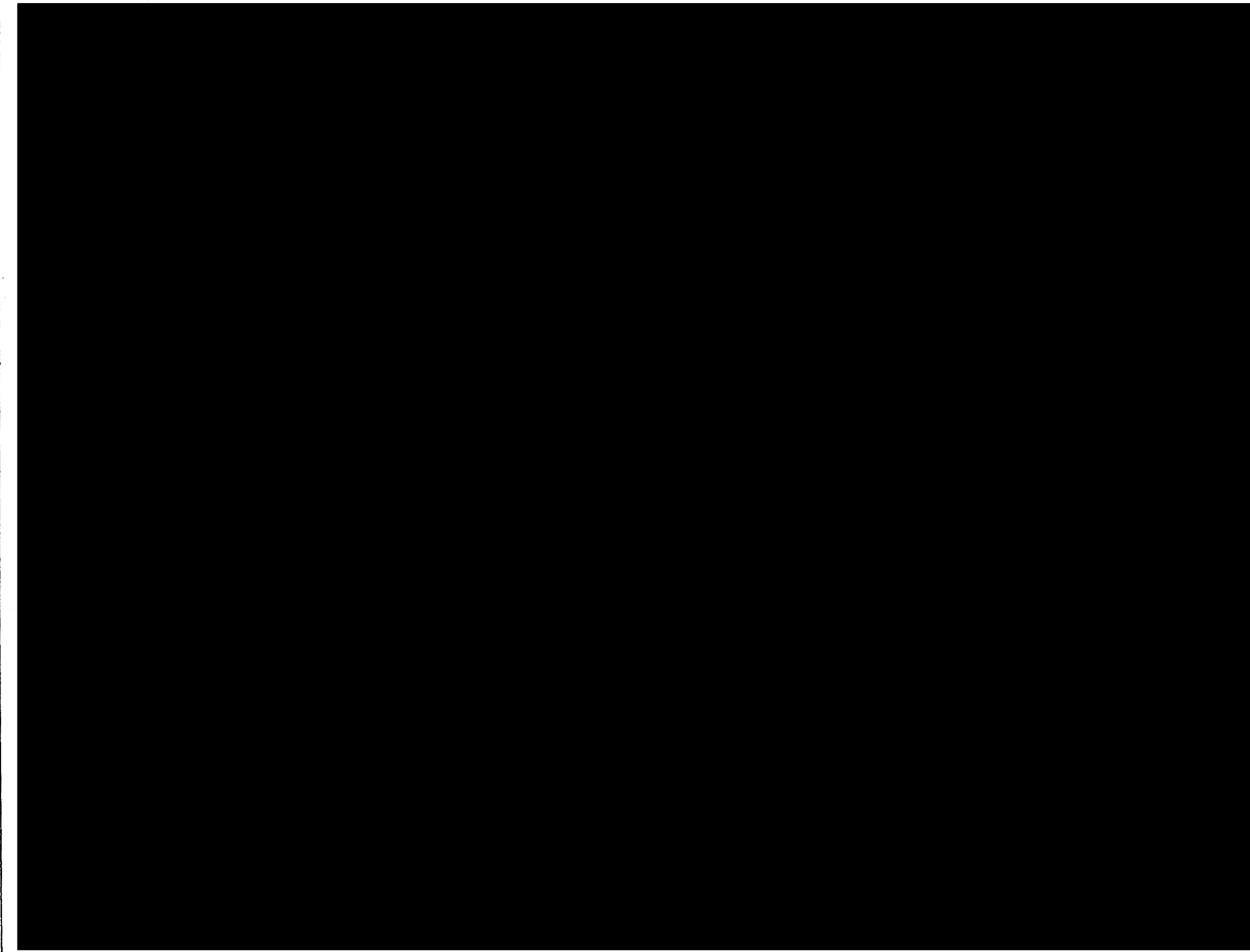

CROSS-SECTION 'D-D'

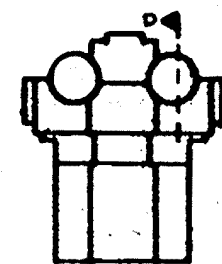

COMANCHE PEAK S.E.S.
FINAL SAFETY ANALYSIS REPORT
UNITS 1 and 2

BUILDING CROSS-SECTION
D-D

FIGURE 1.2-6

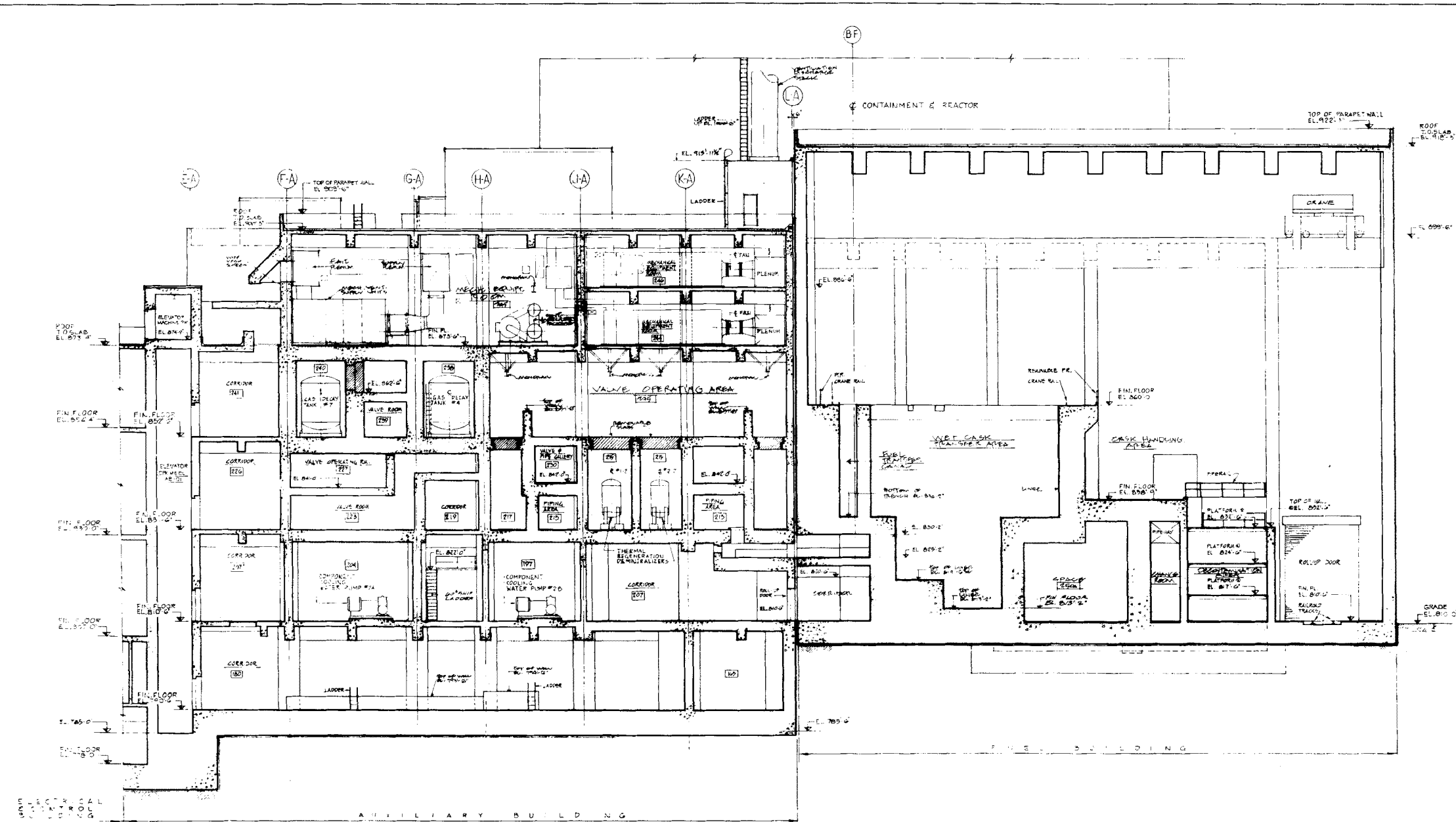

CROSS-SECTION 'E-E'

DWG. No 2323-AI-0530
REV. No 5

AMENDMENT 10
MARCH 31, 1980

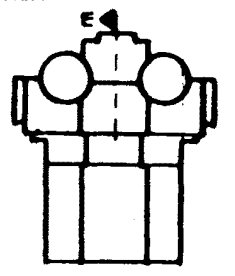

COMANCHE PEAK S.E.S.
FINAL SAFETY ANALYSIS REPORT
UNITS 1 and 2

BUILDING CROSS-SECTION
E-E

FIGURE No 1.2-9

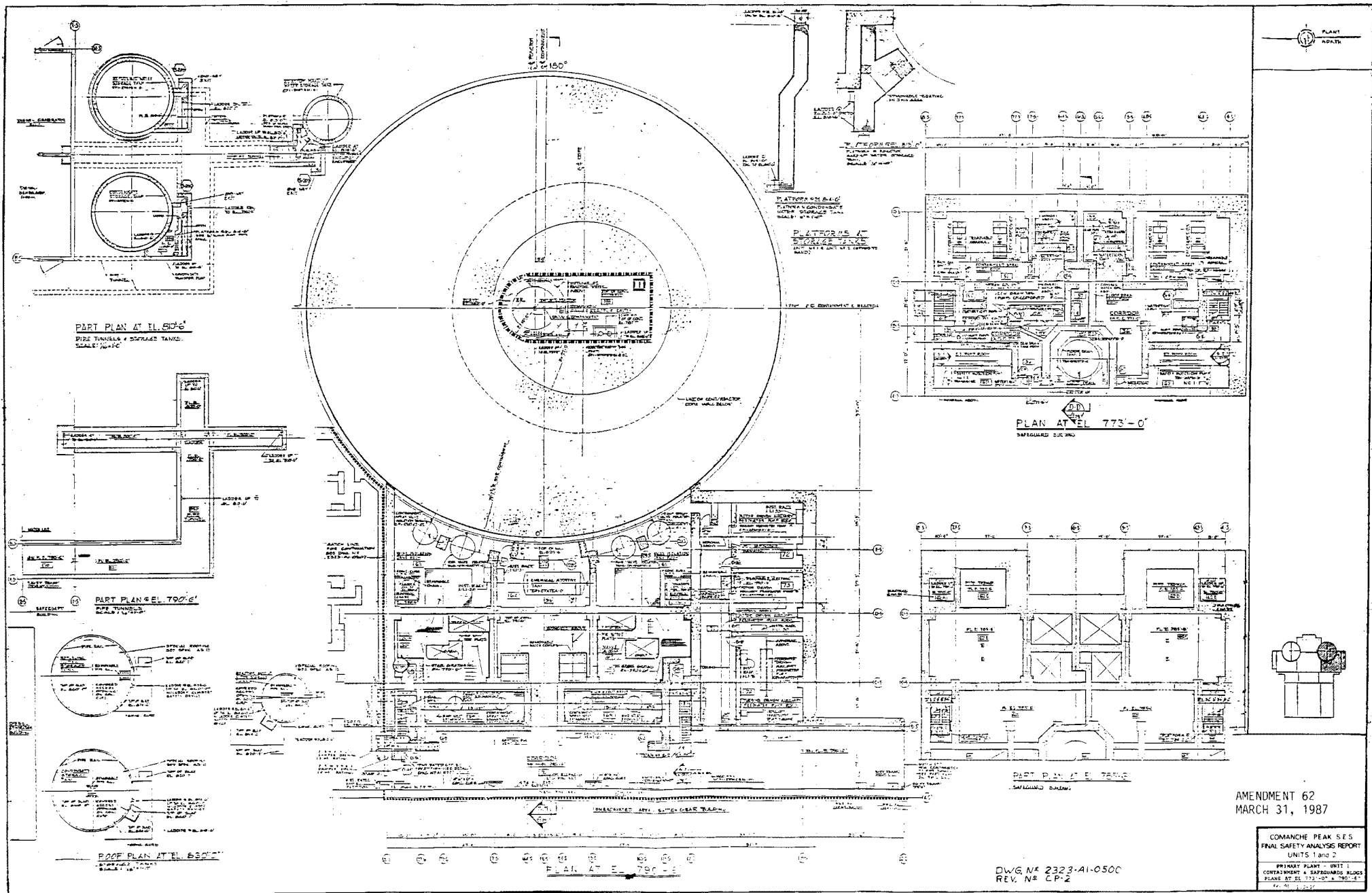

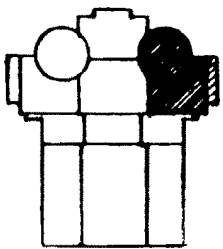
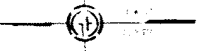

COMANCHE PEAK S.E.S.
FINAL SAFETY ANALYSIS REPORT
UNITS 1 and 2

PRIMARY REACTOR UNIT
CONTAINMENT & SAFEGUARD
BUILDINGS - PLANS AT EL.
60'-0" AND 81'-0" - 6"

FIGURE NO. 1-2-11

REACTOR # 1 REDE CONTAINMENT

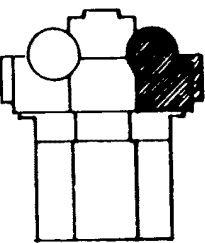

COMANCHE PEAK S.E.S.
FINAL SAFETY ANALYSIS REPORT
UNITS 1 and 2

PRIMARY PLANT - UNIT 1
CONTAINMENT & SAFEGUARD
BUILDINGS - PLANS AT EL.
831'-6" AND 832'-6"

FIGURE NO. 1-2-12

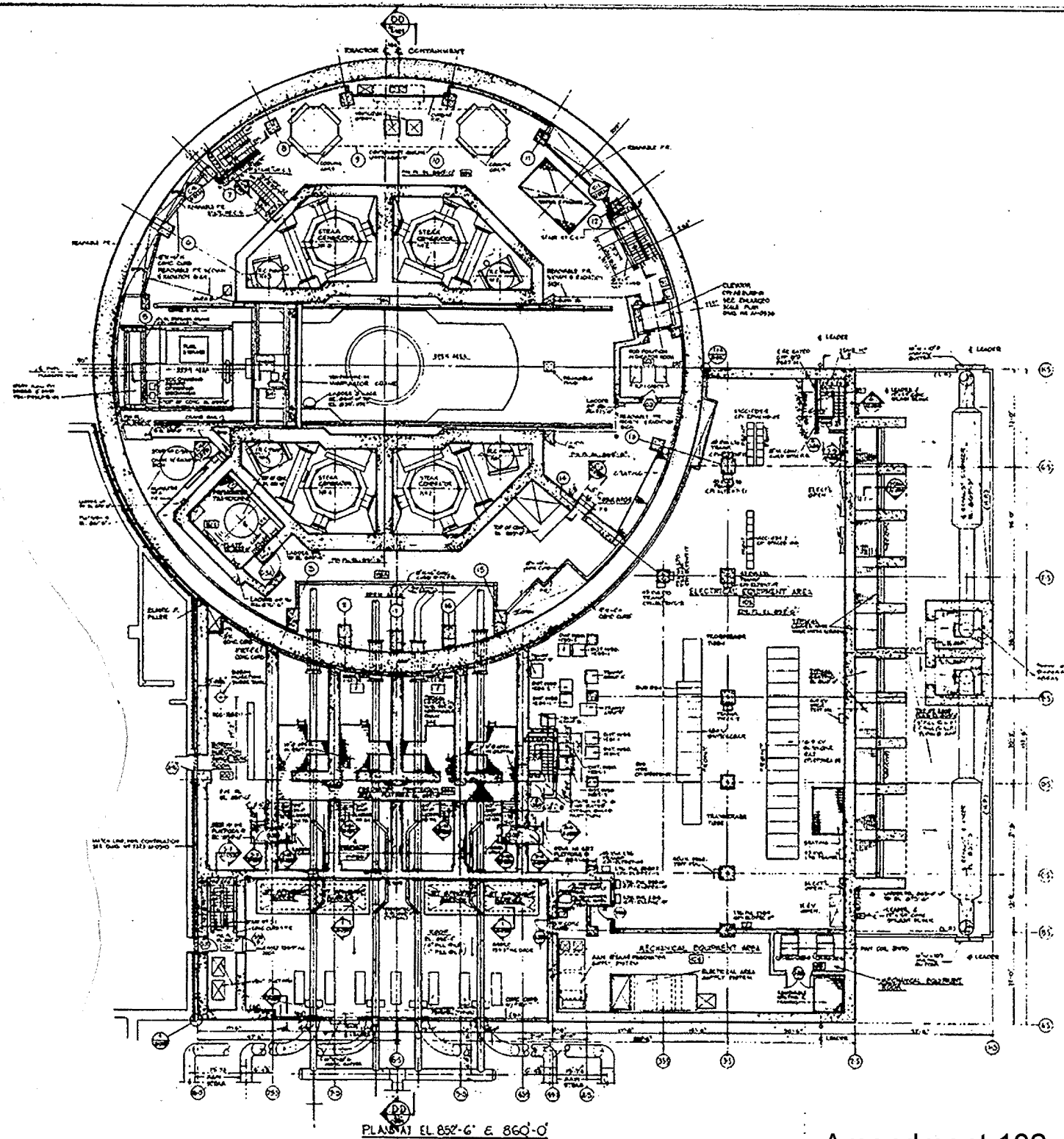

DWG. No 2323-AI-0503 SH. -

Amendment 102

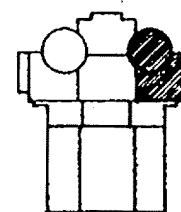

COMANCHE PEAK S.E.S.
FINAL SAFETY ANALYSIS REPORT
UNITS 1 and 2

PRIMARY PLANT - UNIT 1
CONTAINMENT & SAFEGUARD
BUILDINGS - PLANS AT EL
852'-6" AND 860'-0"

FIGURE NO. 1.2.13

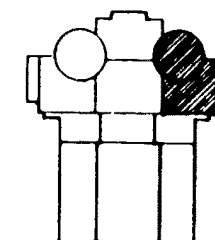
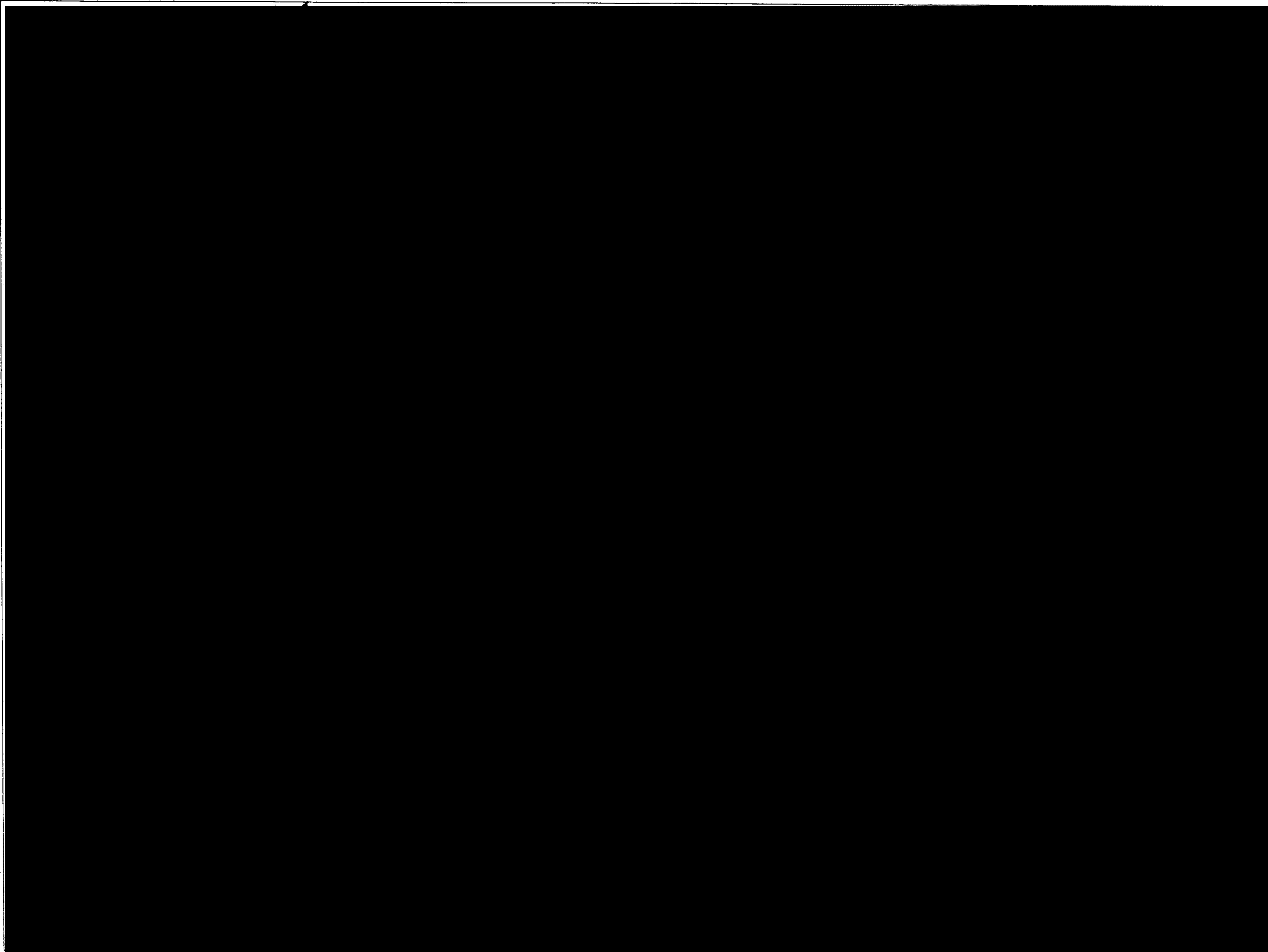

COMANCHE PEAK S.E.S.
FINAL SAFETY ANALYSIS REPORT
UNITS 1 and 2

PRIMARY PLANT - UNIT 1
CONTAINMENT & SAFEGUARD
BUILDINGS - FLOOR PLANS
AT EL. 873'-6"

FIGURE #* 1-2-14

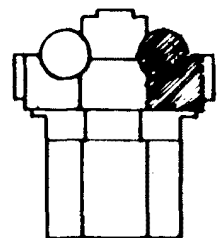
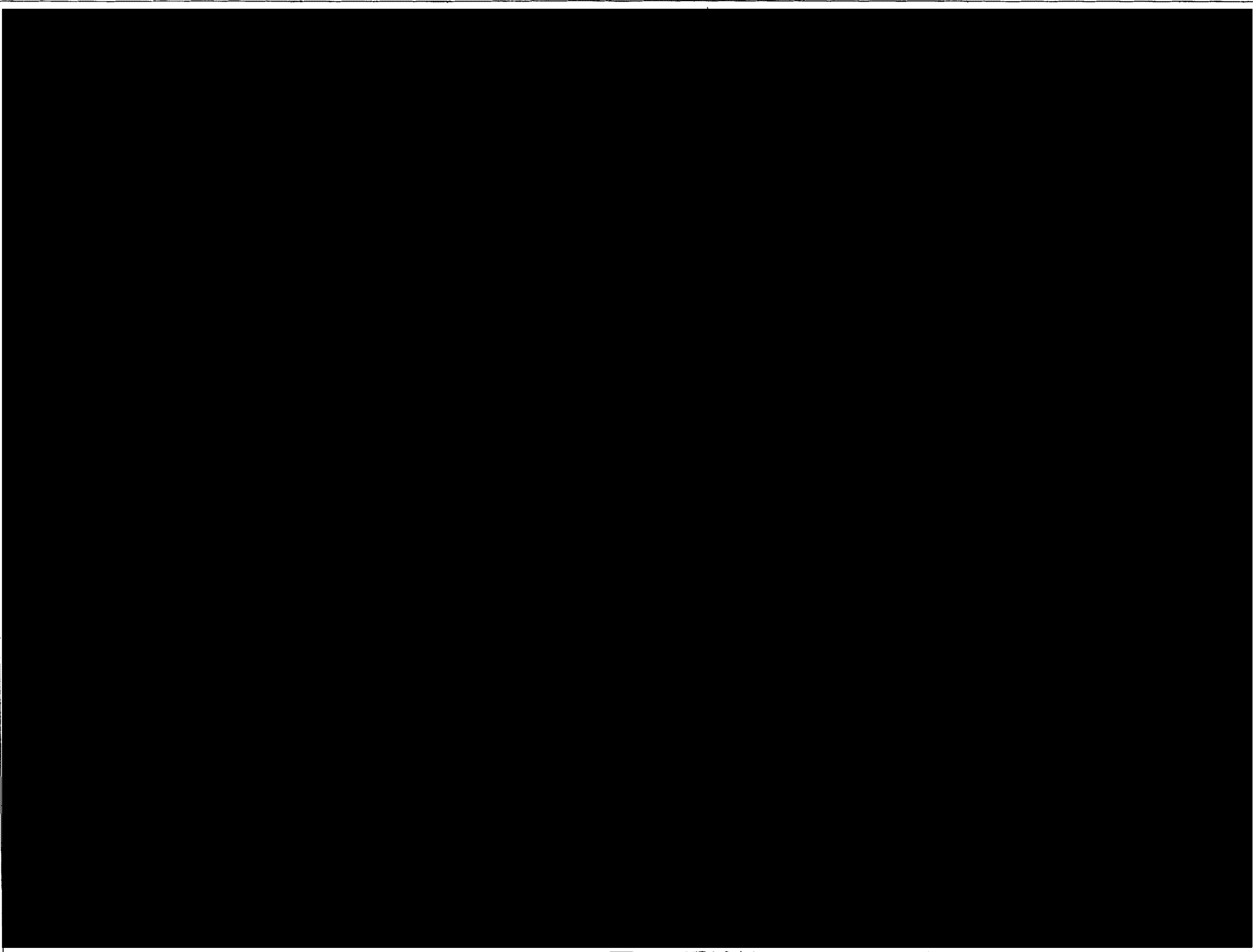

COMANCHE PEAK S.E.S.
FINAL SAFETY ANALYSIS REPORT
UNITS 1 and 2

PRIMARY PLANT UNIT 1
CONTAINMENT BUILDING
PLAN AT EL. 905'-9"

FIGURE N° 1.2.15



- [illegible]

CPDPS & THE SUPERIOR PUMP
SEVERAL BUILDING
STRUCTURES
 41-0004, 42-0004, 42-0007, 42-0018
 42-0019, 42-0021,
P.O.N.G.
 42-0003, 42-0018, 42-0014
VENTILATION
 42-0008
PUMPING
 42-0002, 42-0005
ELECTRIC
 42-0470, 42-0716, 42-0718, 42-0911

CONTAINMENT BUILDING
STRUCTURAL

32-059

PIPING

M2-0508

VENTILATION

44-38861-1000

ELECTRICAL

12-0955

1000

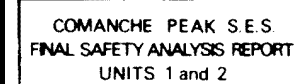

PRIMARY PLANT- UNIT 2
CONTAINMENT & SAFEGUARD BLDGS.
PLANS AT EL. 806'-0" AND 810'-0".

FIGURE N° 1-2-17



- GENERAL NOTES
1. ALL EQUIPMENT LOCATION DIMENSIONS SHOWN ON THIS DRAWING SHALL NOT BE USED FOR INSTALLATION.
 2. FOR DIRECTION OF GRATING, SEE DEPTH OF GRATING, SEE STRUCTURAL DRAWINGS.
 3. FOR ALL PENETRATIONS IN GRATING & FLOOR SLABS, SEE MECH, STRUCT, ELECT. DRAWINGS.
 4. SEE MECH, STRUCT, ELECT. DRAWINGS FOR PENETRATIONS IN GRATING & FLOOR SLABS.
 5. FOR ALL PENETRATIONS IN GRATING & FLOOR SLABS, SEE MECH, STRUCT, ELECT. DRAWINGS.

GUDD HILL REFERENCE DRAWING

CONTAINMENT BUILDING

STRUCTURAL
ME-0012, ME-0013, ME-0017
VENTILATION

ME-0011
PIPING
ME-0017, ME-0017
PLUMBING
ME-0011
INSTRUMENTATION

SAFEGUARD BUILDING

STRUCTURAL
ME-0012, ME-0013, ME-0017
VENTILATION
ME-0011

PIPING
ME-0011
PLUMBING
ME-0012, ME-0013, ME-0017
INSTRUMENTATION
ME-0011
ELECTRICAL
ME-0012, ME-0013

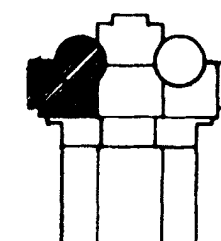

COMANCHE PEAK S.E.S.
FINAL SAFETY ANALYSIS REPORT
UNITS 1 and 2

PRIMARY PLANT - UNIT 2
CONTAINMENT & SAFEGUARD BUILDINGS
PLANS AT EL. 881'6" AND 882'6"

FIGURE NO. 1-2-1B

PARTIAL PLAN AT E. 371'-6"
(COURTNEY BUILDING ONLY)

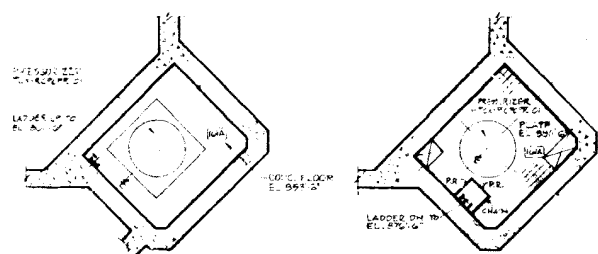

8/3-6

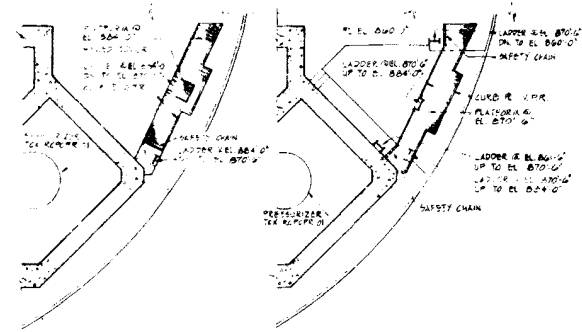
$$\frac{2471.2}{11.836} = 208.7$$

PARTIAL PLAN
D.F. 284-0
SCALE 8"=10'

PARTIAL PLAN
@ EL. 870'-6"
SCALE: 1" = 10'

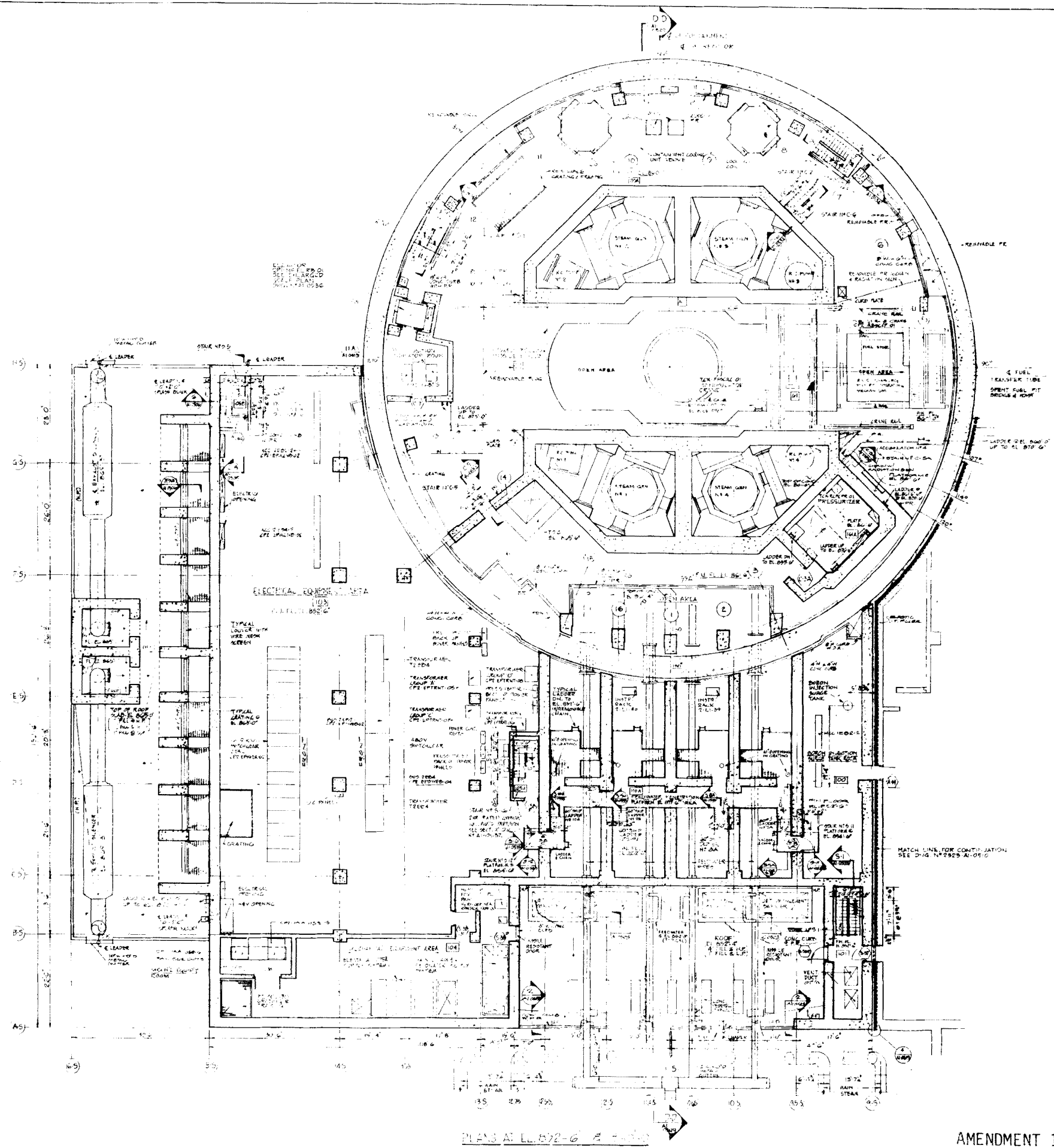

GENERAL NOTES

1. ALL EQUIPMENT LOCATION DIMENSIONS SHOWN ON THIS DRAWING SHALL NOT BE USED FOR INSTALLATION
2. FOR DIRECTION OF GRATING WALK & DEPTH OF GRATING, SEE STRUCTURAL DRAWINGS.
3. FOR ALL PENETRATIONS IN GRATING & FLOOR SLABS, SEE MCHN., STREET, ELEC. DRAWINGS.
4. FOR ROOF DETAILS NOT INDICATED ON THIS DRAWING, SEE ROOF PLAN & DETAIL DRAWING, SPEC. 110500.

CROSS & ALL REFERENCE
DRAWINGS

CONTAINMENT BUILDING
STRUCTURAL
42-0548, 42-0549, 42-0560
VENTILATION
M1-0551
PIPING
42-0507
PLUMBING
M1-0582
MOTIVATION

ELECTRICAL
E1-0505, E1-0531
24HR WARD BUILDING
STRUCTURAL
32-0411, 32-0444
VENTILATION
M1-0634
PIPING
M1-0601
PLUMBING
M2-0606
MOTIVATION
M2-0603
ELECTRICAL
E1-0600-05, E2-0710-02

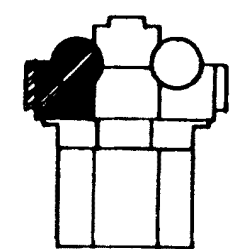

COMANCHE PEAK S.E.S.
FINAL SAFETY ANALYSIS REPORT
UNITS 1 and 2

PRIMARY PLANT - UNIT 2
CONTAINMENT 3 - 6" GLASS
BUILDINGS PLATES 2 - 3
052'-6" AND 500'-0"

FIGURE N° 1-2-19

DIV 4, № 2323-A2-0503
REV. № 3

PLANS AT LL 822-6 A + 104

AMENDMENT 10
MARCH 31, 1980

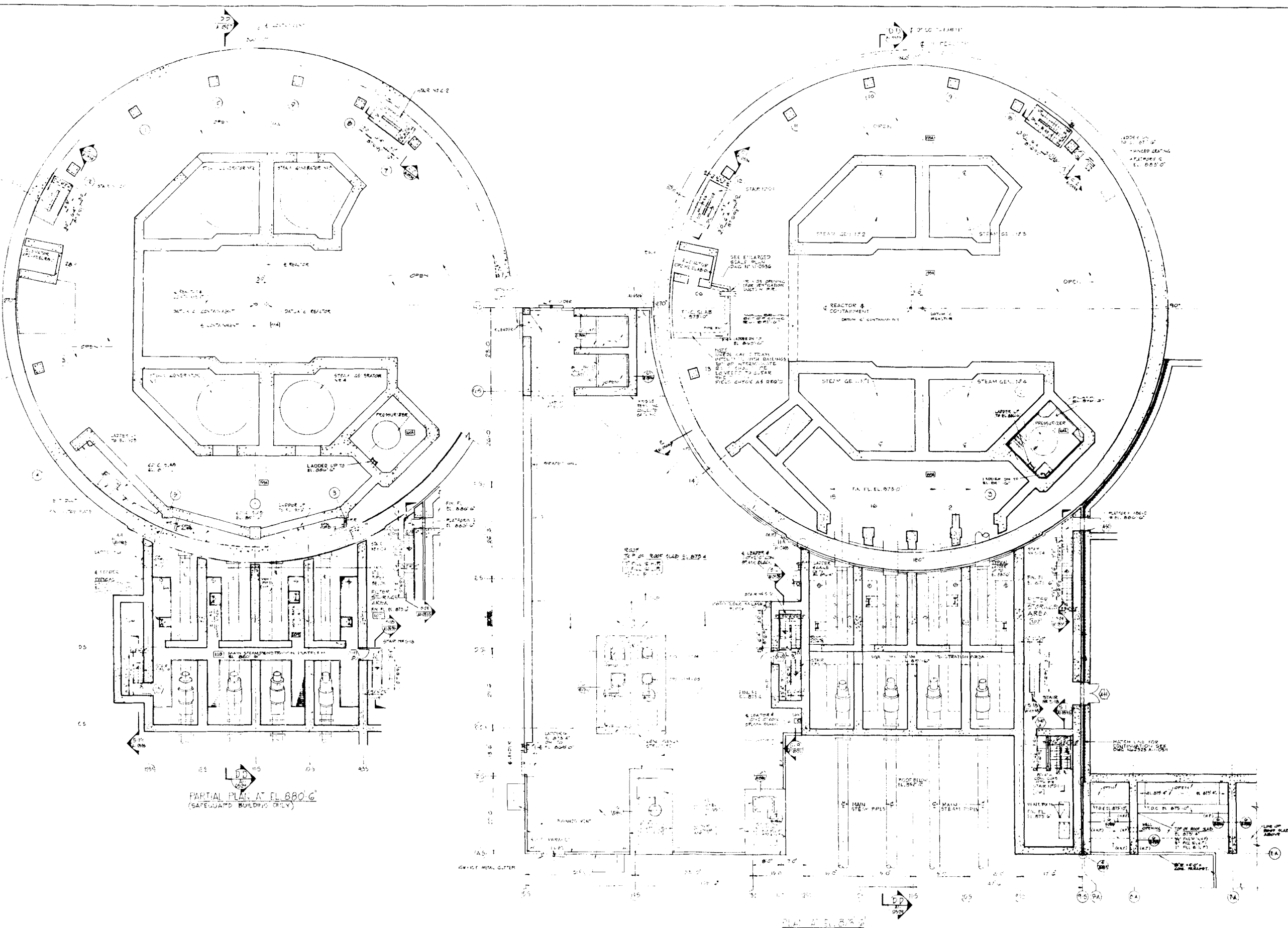

PLANT NORTH

LEGEND
PRECAST CONCRETE LEADER
SEE DWG 17-110552

GENERAL NOTE: 1. ALL EQUIPMENT LOCATION OUTLINES SHOWN ON THIS DRAWING SHALL NOT BE USED FOR INSTALLATION. 2. FOR DIRECTION OF GRATING, SPAN & DEPTH OF GRATING, SEE STRUCTURAL DRAWINGS. 3. FOR ALL PENETRATIONS IN GRATING & FLOOR SLABS, SEE MECH. STRUCT. ELEV. DRAWINGS. 4. SEE DWG 17-110552 FOR DETAILS OF GRATING. 5. SEE DWG 17-110552 FOR DETAILS OF FLOOR SLABS.

COMMANCHE PEAK REFERENCE DRAWINGS

CONTAINMENT BUILDING
STRUCTURAL
S2-0510, S2-0511, S2-0512
VENTILATION
M2-0552
PIPING
M2-0505
PLUMBING
A2-0506
INSTRUMENTATION
ELECTRICAL
E2-0503
SAFEGUARD BUILDING
STRUCTURAL
S2-0514
VENTILATION
M2-0552
PIPING
M2-0505
PLUMBING
A2-0506
INSTRUMENTATION
ELECTRICAL
E2-0503

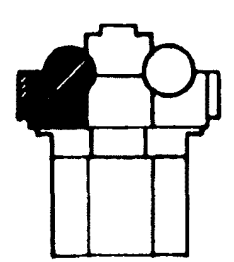

COMMANCHE PEAK S.E.S.
FINAL SAFETY ANALYSIS REPORT
UNITS 1 and 2

PRIMARY PLANT - UNIT 2
CONTAINMENT & SAFEGUARD
BUILDINGS - FLOOR PLANS
AT EL. 875' - 6"

FIGURE NO. 12-20

DWG. NO. 2323-A2-0504
REV. NO. 9

AMENDMENT 10
MARCH 31, 1980

GENERAL NOTES:

1. ALL EQUIPMENT DIMENSIONS SHOWN ON THIS DRAWING SHALL NOT BE USED FOR INSTALLATION.
2. FOR DIRECTION OF BEARING, SPAN & DEPTH OF GRATING, SEE STRUCTURAL DRAWINGS.
3. FOR ALL PENETRATIONS IN GRATING & FLOOR SLABS, SEE MECHANICAL, ELECTRICAL DRAWINGS.
4. FOR EBF INSTALLMENT INDICATED ON THIS DRAWING, SEE EBF PLAN & DETAIL DRAWING, ESDS AT 00007.
5. FOR LOCATION OF LEADERS, SEE DING AT 00008.

REFERENCE

DRAWING
CONTAINMENT
BUILDING

6E-0934, 6E-0935

6E-0934, 6E-0935

6E-0934, 6E-0935

6E-0934, 6E-0935

6E-0934, 6E-0935

6E-0934, 6E-0935

6E-0934, 6E-0935

6E-0934, 6E-0935

6E-0934, 6E-0935

6E-0934, 6E-0935

6E-0934, 6E-0935

6E-0934, 6E-0935

6E-0934, 6E-0935

6E-0934, 6E-0935

6E-0934, 6E-0935

6E-0934, 6E-0935

6E-0934, 6E-0935

6E-0934, 6E-0935

6E-0934, 6E-0935

6E-0934, 6E-0935

6E-0934, 6E-0935

6E-0934, 6E-0935

6E-0934, 6E-0935

6E-0934, 6E-0935

6E-0934, 6E-0935

6E-0934, 6E-0935

6E-0934, 6E-0935

6E-0934, 6E-0935

6E-0934, 6E-0935

6E-0934, 6E-0935

6E-0934, 6E-0935

6E-0934, 6E-0935

6E-0934, 6E-0935

6E-0934, 6E-0935

6E-0934, 6E-0935

6E-0934, 6E-0935

6E-0934, 6E-0935

6E-0934, 6E-0935

6E-0934, 6E-0935

6E-0934, 6E-0935

6E-0934, 6E-0935

6E-0934, 6E-0935

6E-0934, 6E-0935

6E-0934, 6E-0935

6E-0934, 6E-0935

6E-0934, 6E-0935

6E-0934, 6E-0935

6E-0934, 6E-0935

6E-0934, 6E-0935

6E-0934, 6E-0935

6E-0934, 6E-0935

6E-0934, 6E-0935

6E-0934, 6E-0935

6E-0934, 6E-0935

6E-0934, 6E-0935

6E-0934, 6E-0935

6E-0934, 6E-0935

6E-0934, 6E-0935

6E-0934, 6E-0935

6E-0934, 6E-0935

6E-0934, 6E-0935

6E-0934, 6E-0935

6E-0934, 6E-0935

6E-0934, 6E-0935

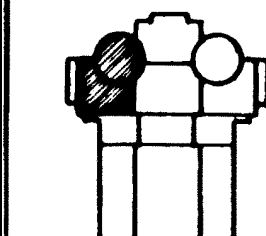

COMANCHE PEAK S.E.S.
FINAL SAFETY ANALYSIS REPORT
UNITS 1 and 2

PRIMARY PLANT - UNIT 2
CONTAINMENT BUILDING
PLAN AT EL. 905' - 9"

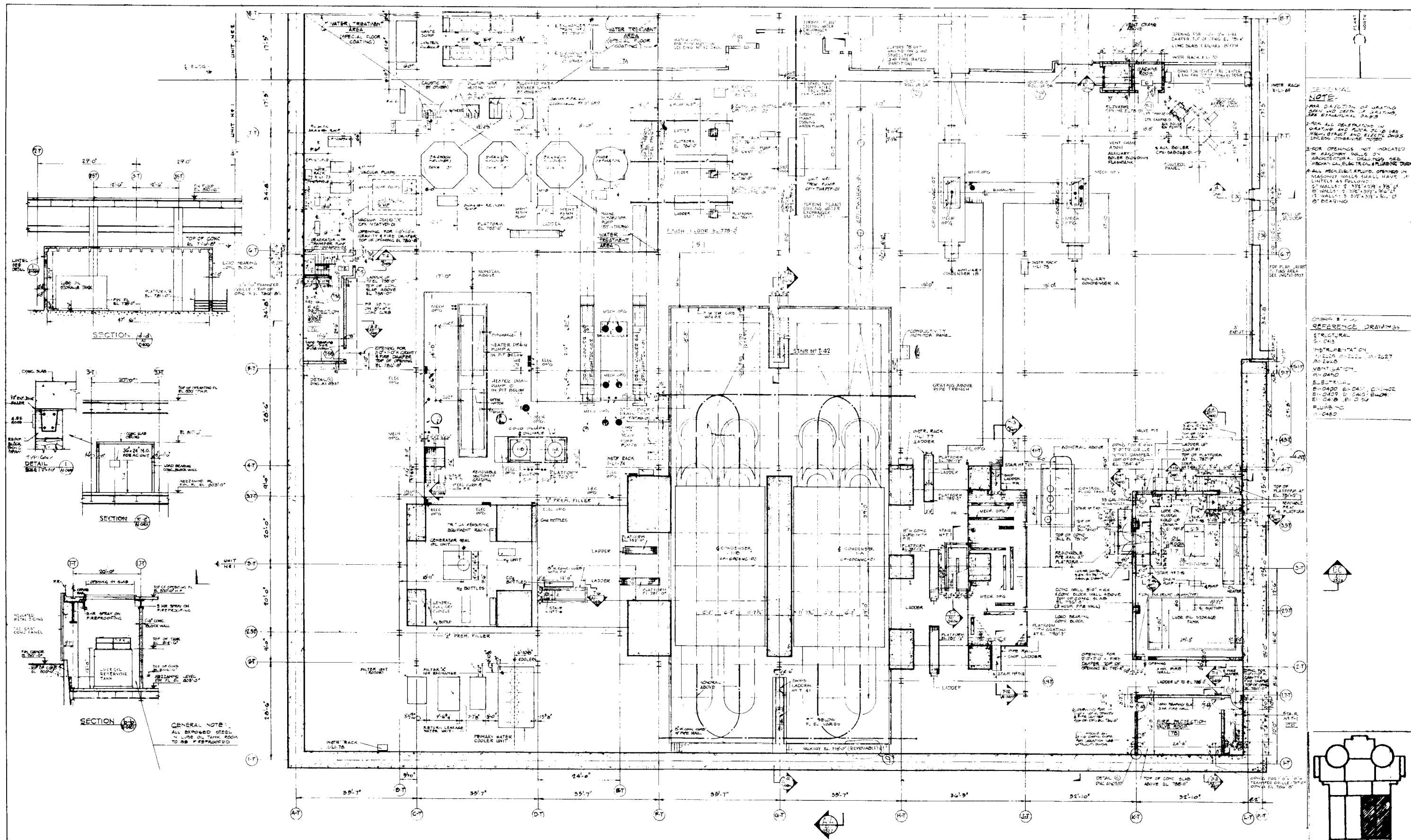

BASEMENT FLOOR PLAN

DIV. NO 2323-AI-0400
REV. NO 9

GENERAL NOTE
ALL DIMENSIONS SHOWN ON THIS DRAWING SHALL NOT BE USED FOR INSTALLATION.

AMENDMENT 10
MARCH 31, 1980

COMANCHE PEAK S.E.S.
FINAL SAFETY ANALYSIS REPORT
UNITS 1 and 2

TURBINE BUILDING UNIT NO. 1
BASEMENT FLOOR PLAN
EL. 778'-0"

FIGURE NO. 12-22

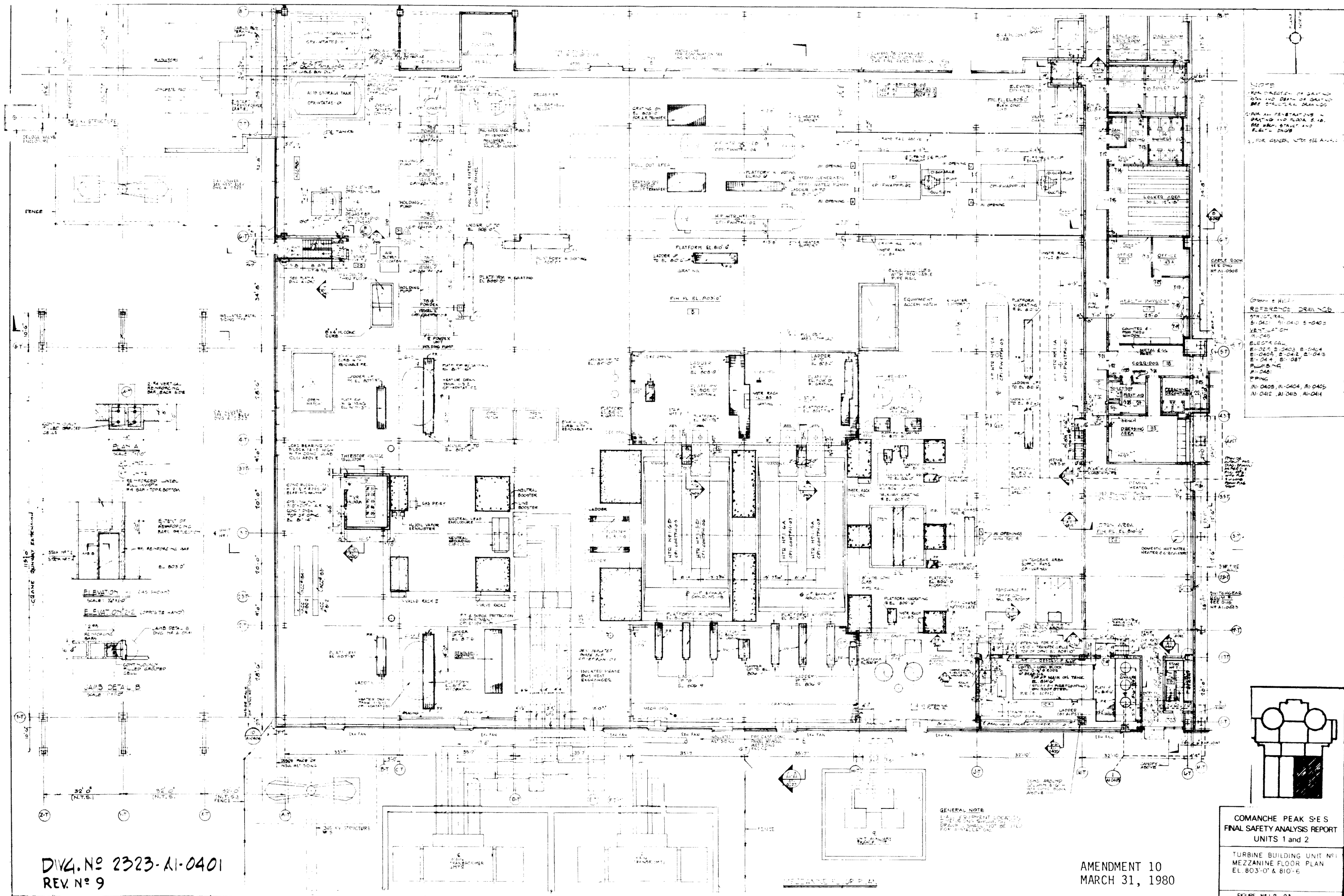

NOTE:
FOR DIRECTION OF DRAINAGE
SEE AND DEPTH OF DRAINAGE
SEE STRUCTURAL DRAWINGS
2. FOR GENERAL NOTES SEE A-1-1

COMP. & HILL
REFERENCE DRAWINGS
STRUCTURAL
B-1042, B-1043, B-1044
ELECTRICAL
E-1042, E-1043, E-1044
MECHANICAL
M-1042, M-1043, M-1044
Piping
P-1042, P-1043, P-1044

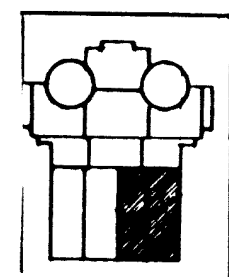

DIV. NO. 2323-A1-0401
REV. NO. 9

AMENDMENT 10
MARCH 31, 1980

COMANCHE PEAK S.E.S.
FINAL SAFETY ANALYSIS REPORT
UNITS 1 and 2
TURBINE BUILDING UNIT NO. 1
MEZZANINE FLOOR PLAN
EL. 803'-0" & 810'-6"
FIGURE N-1.2-25

