

**COLORADO OFFICE**

10758 W. CENTENNIAL RD., STE. 200  
LITTLETON, CO 80127  
TEL: (866) 981-4588  
FAX: (720) 981-5643



**LOST CREEK ISR, LLC**

**WYOMING OFFICE**

5880 ENTERPRISE DR., STE. 200  
CASPER, WY 82609  
TEL: (307) 265-2373  
FAX: (307) 265-2801

April 28, 2016

UIC Program Supervisor  
WDEQ – Water Quality Division  
Herschler Building – 4W  
122 W. 25<sup>th</sup> Street  
Cheyenne, WY 82002

**RE: Quarterly Report for 1st Quarter 2016**  
**UIC Class I Permit 13-409**  
**UIC Class V Permit 15-081**  
**Lost Creek ISR Project, Sweetwater County, WY**

Dear Program Supervisor,

The attached Quarterly Report for the Lost Creek ISR Project has been submitted in accordance with the requirements of Class I Underground Injection Control (UIC) Permit 13-409 Section K. The reporting period for this Quarterly Report is the first calendar quarter of 2016.

A quarterly report is also required as per Class V UIC Permit 15-081 Section 9b. However, the Class V system is not yet in operation and therefore no report will be submitted with the exception of the online report on the agencies GEM website.

If you have any questions regarding this submittal, please contact me at the Casper Office.

Regards,

Michael Gaither  
Manager EHS and Regulatory Affairs  
Ur-Energy USA, Inc.

**Attachments: UIC Class I Quarterly Report**

Cc: Theresa Horne, Ur-Energy, Littleton Office (via e-mail)  
Brian Wood, WDEQ-LQD, Lander (via e-mail)  
John Saxton, NRC Project Manager (via e-mail)

*Lost Creek ISR, LLC is a wholly-owned subsidiary of Ur-Energy Inc.*

TSX: URE

[www.ur-energy.com](http://www.ur-energy.com)

---

**UIC CLASS I QUARTERLY REPORT  
for the  
LOST CREEK ISR PROJECT  
1st Quarter 2016**



**LOST CREEK ISR, LLC  
SWEETWATER COUNTY, WY**

**UIC PERMIT 13-409**

---

**Prepared by Ur-Energy for  
Wyoming Department of Environmental Quality -  
Water Quality Division – Underground Injection Control**

**April 28, 2016**



## Contents

|     |   |   |
|-----|---|---|
| 1.0 | Introduction.....                               | 1 |
| 2.0 | Summary Data .....                              | 2 |
| 3.0 | Analytical Results .....                        | 5 |
| 4.0 | Permit Exceedances.....                         | 5 |
| 5.0 | Alarms, Shut-Downs, and Corrective Actions..... | 6 |
| 6.0 | Summary of Well Tests or Workovers .....        | 6 |

## Tables

|  |
|--|
| Table 1A: Operational Data Summary for DDW-1           |
| Table 1B: Operational Data Summary for DDW-3           |
| Table 1C: Operational Data Summary for DDW-4           |
| Table 2: Cumulative Injection Volumes to Date          |
| Table 3: Analytical Results Summary                    |
| Table 4: Summary of Exceedances                        |
| Table 5: Summary of Automatic Pressure Shutoff Testing |

## Figures

|                          |
|--------------------------|
| Figure 1: Well Locations |
|--------------------------|

## Appendices

|                                       |
|---------------------------------------|
| Appendix 1: Daily Injection Pressures |
| Appendix 2: Lab Report                |



## 1.0 Introduction

The period covered by this report is the first calendar quarter of 2016 from January 1 to March 31, 2016.

Three disposal wells were operational during the reporting period: LC DW No. 1 (“DDW-1”), LC DW No. 3 (“DDW-3”), and LC DW No. 4 (“DDW-4”). Well locations (labeled) are shown below in relation to the Permit to Mine boundary (green line):

**FIGURE 1: Well Locations**

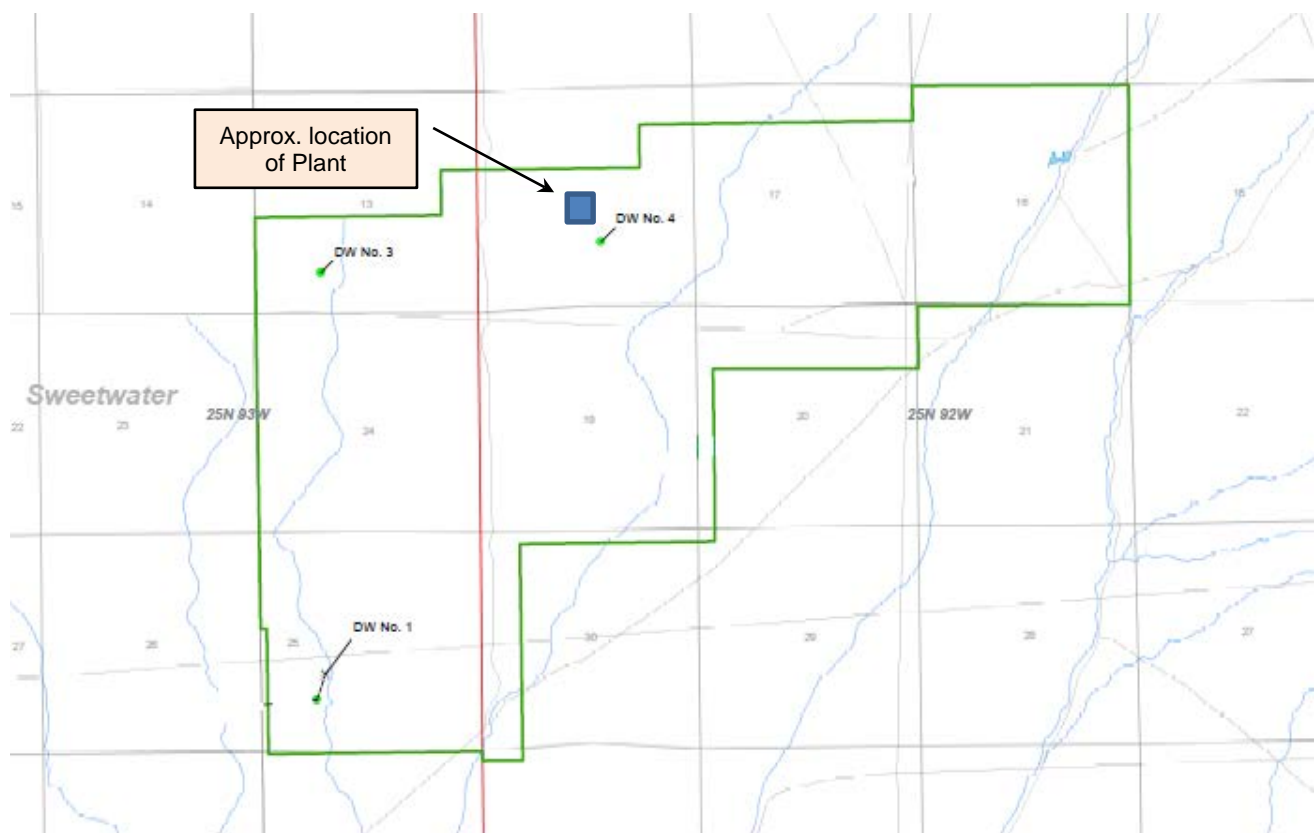

DDW-3 and DDW-4 were operated intermittently during the quarter. DDW-1 was shut in for the duration of the quarter. Operational data was monitored and recorded electronically with redundant data logging.

As per permit requirements, the following elements from Section K(6) of the UIC Permit have been included in this report:

- a.** *Minimum, volume-weighted average, and maximum instantaneous injection rates for each well for each month*



- b. Minimum, average, and maximum daily injection pressures for each well for each month*
- c. Total injection volume in barrels (bbl) for each well for each month, total for the quarter, and cumulative volume of waste injected to date.*
- d. Maximum and minimum annulus pressures for each month with alarm/kill pressure value*
- e. Quarterly analytical results*
- f. Permit exceedances during the quarter*
- g. Any alarms or shutdowns and corrective actions*
- h. Summary of well tests or workovers*

## 2.0 Summary Data

Tables 1A, 1B, 1C, and 2 below provide a data summary for above items **a**, **c**, and **d** above. Data for item **b** above is provided in **Appendix 1** including tables and charts of the daily injection pressure values.

**Table 1A: Operational Data Summary for DDW-1**

| PARAMETER                              | UNITS | LC DW No. 1  |               |            |                     |
|--|-------|--------------|---------------|------------|---------------------|
|  |       | January 2016 | February 2016 | March 2016 | Quarterly Total/Avg |
| Operation Time                         | min   | 0            | 0             | 0          | 0                   |
| % Run Time                             | %     | 0%           | 0%            | 0%         | 0                   |
| Injection Rate Minimum Instantaneous   | gpm   | 0            | 0             | 0          | 0                   |
| Injection Rate Average (TWA)           | gpm   | 0            | 0             | 0          | 0                   |
| Injection Rate Maximum Instantaneous   | gpm   | 0            | 0             | 0          | 0                   |
| Injection Rate Maximum Permit Limit    | gpm   | 50           |               |            | 50                  |
| Injection Pressure Daily Minimum       | psig  | 0            | 0             | 0          | 0                   |
| Injection Pressure Daily Average       | psig  | 0            | 0             | 0          | 0                   |
| Injection Pressure Daily Maximum       | psig  | 0            | 0             | 0          | 0                   |
| Injection Pressure Permit Limit (LSIP) | psig  | 609          |               |            | 609                 |
| Injection Pressure Automatic Kill      | psig  | 600          |               |            | 600                 |
| Injection Volume                       | gal   | 0            | 0             | 0          | 0                   |
| Injection Volume                       | bbl   | 0            | 0             | 0          | 0                   |
| Annulus Pressure Minimum               | psig  | 288          | 291           | 300        | 293                 |
| Annulus Pressure Average               | psig  | 299          | 298           | 304        | 300                 |
| Annulus Pressure Maximum               | psig  | 306          | 307           | 312        | 309                 |
| Annulus Pressure Permit Limit          | psig  | 200-800      |               |            | 200-800             |
| Annulus Pressure Automatic Kill        | psig  | N/A          |               |            | N/A                 |



**Table 1B: Operational Data Summary for DDW-3**

| PARAMETER                              | UNITS | LC DW No. 3  |               |            |                     |
|--|-------|--------------|---------------|------------|---------------------|
|  |       | January 2016 | February 2016 | March 2016 | Quarterly Total/Avg |
| Operation Time                         | min   | 28,469       | 26,167        | 32,649     | 87,286              |
| % Run Time                             | %     | 64%          | 63%           | 73%        | 67%                 |
| Injection Rate Minimum Instantaneous   | gpm   | 0            | 0             | 0          | 0                   |
| Injection Rate Average (TWA)           | gpm   | 13           | 13            | 13         | 13                  |
| Injection Rate Maximum Instantaneous   | gpm   | 18           | 14            | 21         | 17                  |
| Injection Rate Maximum Permit Limit    | gpm   | 50           |               |            | 50                  |
| Injection Pressure Daily Minimum       | psig  | 0            | 724           | 746        | 490                 |
| Injection Pressure Daily Average       | psig  | 768          | 819           | 836        | 808                 |
| Injection Pressure Daily Maximum       | psig  | 910          | 899           | 909        | 906                 |
| Injection Pressure Permit Limit (LSIP) | psig  | 915          |               |            | 915                 |
| Injection Pressure Automatic Kill      | psig  | 910          |               |            | 910                 |
| Injection Volume                       | gal   | 381,762      | 329,748       | 414,868    | 1,126,379           |
| Injection Volume                       | bbl   | 9,090        | 7,851         | 9,878      | 26,819              |
| Annulus Pressure Minimum               | psig  | 293          | 296           | 275        | 288                 |
| Annulus Pressure Average               | psig  | 296          | 297           | 286        | 293                 |
| Annulus Pressure Maximum               | psig  | 300          | 300           | 293        | 298                 |
| Annulus Pressure Permit Limit          | psig  | 200-800      |               |            | 200-800             |
| Annulus Pressure Automatic Kill        | psig  | N/A          |               |            | N/A                 |



**Table 1C: Operational Data Summary for DDW-4**

| PARAMETER                              | UNITS | LC DW No. 4  |               |            |                     |
|--|-------|--------------|---------------|------------|---------------------|
|  |       | January 2016 | February 2016 | March 2016 | Quarterly Total/Avg |
| Operation Time                         | min   | 39,113       | 37,320        | 40,602     | 117,035             |
| % Run Time                             | %     | 88%          | 89%           | 91%        | 89%                 |
| Injection Rate Minimum Instantaneous   | gpm   | 0            | 0             | 0          | 0                   |
| Injection Rate Average (TWA)           | gpm   | 11           | 10            | 11         | 11                  |
| Injection Rate Maximum Instantaneous   | gpm   | 22           | 20            | 12         | 18                  |
| Injection Rate Maximum Permit Limit    | gpm   | 50           |               |            | 50                  |
| Injection Pressure Daily Minimum       | psig  | 604          | 633           | 607        | 615                 |
| Injection Pressure Daily Average       | psig  | 741          | 758           | 738        | 746                 |
| Injection Pressure Daily Maximum       | psig  | 801          | 814           | 807        | 807                 |
| Injection Pressure Permit Limit (LSIP) | psig  | 838          |               |            | 838                 |
| Injection Pressure Automatic Kill      | psig  | 830          |               |            | 830                 |
| Injection Volume                       | gal   | 423,575      | 383,438       | 446,237    | 1,253,251           |
| Injection Volume                       | bbl   | 10,085       | 9,129         | 10,625     | 29,839              |
| Annulus Pressure Minimum               | psig  | 284          | 283           | 283        | 283                 |
| Annulus Pressure Average               | psig  | 295          | 295           | 297        | 296                 |
| Annulus Pressure Maximum               | psig  | 309          | 313           | 311        | 311                 |
| Annulus Pressure Permit Limit          | psig  | 200-800      |               |            | 200-800             |
| Annulus Pressure Automatic Kill        | psig  | N/A          |               |            | N/A                 |

**Table 2: Cumulative Injection Volumes to Date**

| TIME PERIOD                     | UNITS      | LC DW No. 1 | LC DW No. 3 | LC DW No. 4 |
|---------------------------------|------------|-------------|-------------|-------------|
| 2013                            | bbl        | 14,625      | N/A         | 6,471       |
| 2014                            | bbl        | 31,278      | 8,239       | 164,694     |
| 2015                            | bbl        | 14,966      | 130,113     | 105,999     |
| 2016 1 <sup>st</sup> Quarter    | bbl        | 0           | 26,819      | 29,839      |
| <b>CUMULATIVE TOTAL TO DATE</b> | <b>bbl</b> | 60,869      | 165,170     | 307,003     |



### 3.0 Analytical Results

A quarterly grab sample of the injectate was collected from the Plant waste water line upstream of the branch points to each individual well. Sample parameters pH, conductivity, and temperature were measured with a field meter at the sampling site and other applicable parameters were analyzed by Energy Laboratories in Casper, WY. The conductivity reading was off the scale (>19,900 uS/cm) for the field meter so the Energy Lab result was used. Results of the sample analyses are summarized in **Table 3** below and the associated lab report is included as **Appendix 2**.

**Table 3: Analytical Results Summary**

| <b>Sample ID:</b> DW-Injectate |                         |         |       |
|--------------------------------|-------------------------|---------|-------|
| <b>Sample Date:</b> 2/25/2016  |                         |         |       |
| Lab Analyte or Parameter       | Method Used             | Results | Units |
| pH, field                      | SM4500-H <sup>+</sup> B | 6.54    | s.u.  |
| Specific Cond. at 25°C, lab*   | 120.1                   | 50,400  | uS/cm |
| Temperature, field             | SM2550B                 | 15.9    | °C    |
| Specific Gravity               | n/a                     | 1.023   | - -   |
| Total Dissolved Solids         | SM2540C                 | 31,600  | mg/L  |
| Bicarbonate                    | SM2320B                 | 367     | mg/L  |
| Carbonate                      | SM2320B                 | ND(5)   | mg/L  |
| Chloride, total                | 300.0                   | 22,300  | mg/L  |
| Sulfate, total                 | 300.0                   | 1,020   | mg/L  |
| Sulfide (as hydrogen sulfide)  | A4500-S F               | ND(1)   | mg/L  |
| Arsenic, dissolved             | 200.8                   | 0.039   | mg/L  |
| Selenium, dissolved            | 200.8                   | 0.365   | mg/L  |
| Vanadium, dissolved            | 200.8                   | 0.03    | mg/L  |
| Uranium, total                 | 200.7                   | 24.8    | mg/L  |
| Radium-226, total              | E903.0                  | 2,970   | pCi/L |

\*The conductivity was off the scale for the field meter. Lab results used.

The only constituent with a defined Permit limit is pH which must have a value between 2.0 and 12.5. The determined value for pH of 6.54 was within the limit.

### 4.0 Permit Exceedances

There were no exceedances of Permit-defined limits for any of the Class I disposal wells.





**Table 4: Summary of Exceedances**

| Event | Well | Date | Limit Exceeded | Peak Value | Permit Limit | Comment |
|-------|------|------|----------------|------------|--------------|---------|
| ---   | ---  | ---  | ---            | ---        | ---          |         |

## 5.0 Alarms, Shut-Downs, and Corrective Actions

Voluntary shutdowns or other issues occurred during the quarter:

- DDW-1: 1/1 – 3/31/2016. Well shut in for pump repairs. Injection pump was being rebuilt.

Other shutdowns either automatically or manually occur frequently due to pressure increases or due to maintenance activity such as changing inline filters or program changes. Intermittent operation of the injection systems is typical.

Testing of the pressure switches to determine actual automatic shutdown pressures, both digital and analog, occurred in January and March. Results of the testing are summarized on **Table 5**:

**TABLE 5: Summary of Automatic Pressure Shutoff Testing**

| Well  | Pressure Limit (psi) | Test Date | Digital Automatic Pressure Shutoff At (psi) | Digital Shutoff Reset To (psi) | Manual Pressure Switch Shutoff At (psi) | Manual Shutoff Reset To (psi) |
|-------|----------------------|-----------|---|--------------------------------|---|-------------------------------|
| DDW-1 | 609                  | N/A*      | N/A*  | N/A*                           | N/A*                                    | N/A*                          |
| DDW-3 | 915                  | 1/12/2016 | 900   | 900                            | 910                                     | 910                           |
| DDW-3 | 915                  | 3/4/2016  | 900   | 900                            | 910                                     | 910                           |
| DDW-4 | 838                  | 3/4/2016  | 825   | 825                            | 828                                     | 828                           |

\*Well offline

## 6.0 Summary of Well Tests or Workovers

No testing or workovers occurred during the quarter.



## APPENDIX 1

**APPENDIX 1: Daily Injection Pressures**  
**DDW-1 1st Quarter 2016**  
**Lost Creek ISR Project 13-409**

| Date      | Daily Minimum Injection Pressure (psi) | Daily Average Injection Pressure (psi) | Daily Maximum Injection Pressure (psi) | Automatic Shutdown Pressure (psi) | Maximum Injection Pressure Limit (psi) | Comments                  |
|-----------|--|--|--|-----------------------------------|--|---------------------------|
| 1/1/2016  | 0                                      | 0                                      | 0                                      | 600                               | 609                                    | Shut down for pump repair |
| 1/2/2016  | 0                                      | 0                                      | 0                                      | 600                               | 609                                    |                           |
| 1/3/2016  | 0                                      | 0                                      | 0                                      | 600                               | 609                                    |                           |
| 1/4/2016  | 0                                      | 0                                      | 0                                      | 600                               | 609                                    |                           |
| 1/5/2016  | 0                                      | 0                                      | 0                                      | 600                               | 609                                    |                           |
| 1/6/2016  | 0                                      | 0                                      | 0                                      | 600                               | 609                                    |                           |
| 1/7/2016  | 0                                      | 0                                      | 0                                      | 600                               | 609                                    |                           |
| 1/8/2016  | 0                                      | 0                                      | 0                                      | 600                               | 609                                    |                           |
| 1/9/2016  | 0                                      | 0                                      | 0                                      | 600                               | 609                                    |                           |
| 1/10/2016 | 0                                      | 0                                      | 0                                      | 600                               | 609                                    |                           |
| 1/11/2016 | 0                                      | 0                                      | 0                                      | 600                               | 609                                    |                           |
| 1/12/2016 | 0                                      | 0                                      | 0                                      | 600                               | 609                                    |                           |
| 1/13/2016 | 0                                      | 0                                      | 0                                      | 600                               | 609                                    |                           |
| 1/14/2016 | 0                                      | 0                                      | 0                                      | 600                               | 609                                    |                           |
| 1/15/2016 | 0                                      | 0                                      | 0                                      | 600                               | 609                                    |                           |
| 1/16/2016 | 0                                      | 0                                      | 0                                      | 600                               | 609                                    |                           |
| 1/17/2016 | 0                                      | 0                                      | 0                                      | 600                               | 609                                    |                           |
| 1/18/2016 | 0                                      | 0                                      | 0                                      | 600                               | 609                                    |                           |
| 1/19/2016 | 0                                      | 0                                      | 0                                      | 600                               | 609                                    |                           |
| 1/20/2016 | 0                                      | 0                                      | 0                                      | 600                               | 609                                    |                           |
| 1/21/2016 | 0                                      | 0                                      | 0                                      | 600                               | 609                                    |                           |
| 1/22/2016 | 0                                      | 0                                      | 0                                      | 600                               | 609                                    |                           |
| 1/23/2016 | 0                                      | 0                                      | 0                                      | 600                               | 609                                    |                           |
| 1/24/2016 | 0                                      | 0                                      | 0                                      | 600                               | 609                                    |                           |
| 1/25/2016 | 0                                      | 0                                      | 0                                      | 600                               | 609                                    |                           |
| 1/26/2016 | 0                                      | 0                                      | 0                                      | 600                               | 609                                    |                           |
| 1/27/2016 | 0                                      | 0                                      | 0                                      | 600                               | 609                                    |                           |
| 1/28/2016 | 0                                      | 0                                      | 0                                      | 600                               | 609                                    |                           |
| 1/29/2016 | 0                                      | 0                                      | 0                                      | 600                               | 609                                    |                           |
| 1/30/2016 | 0                                      | 0                                      | 0                                      | 600                               | 609                                    |                           |
| 1/31/2016 | 0                                      | 0                                      | 0                                      | 600                               | 609                                    |                           |
| 2/1/2016  | 0                                      | 0                                      | 0                                      | 600                               | 609                                    |                           |
| 2/2/2016  | 0                                      | 0                                      | 0                                      | 600                               | 609                                    |                           |
| 2/3/2016  | 0                                      | 0                                      | 0                                      | 600                               | 609                                    |                           |
| 2/4/2016  | 0                                      | 0                                      | 0                                      | 600                               | 609                                    |                           |
| 2/5/2016  | 0                                      | 0                                      | 0                                      | 600                               | 609                                    |                           |
| 2/6/2016  | 0                                      | 0                                      | 0                                      | 600                               | 609                                    |                           |
| 2/7/2016  | 0                                      | 0                                      | 0                                      | 600                               | 609                                    |                           |
| 2/8/2016  | 0                                      | 0                                      | 0                                      | 600                               | 609                                    |                           |
| 2/9/2016  | 0                                      | 0                                      | 0                                      | 600                               | 609                                    |                           |
| 2/10/2016 | 0                                      | 0                                      | 0                                      | 600                               | 609                                    |                           |
| 2/11/2016 | 0                                      | 0                                      | 0                                      | 600                               | 609                                    |                           |

**APPENDIX 1: Daily Injection Pressures**  
**DDW-1 1st Quarter 2016**  
**Lost Creek ISR Project 13-409**

| Date      | Daily Minimum Injection Pressure (psi) | Daily Average Injection Pressure (psi) | Daily Maximum Injection Pressure (psi) | Automatic Shutdown Pressure (psi) | Maximum Injection Pressure Limit (psi) | Comments |
|-----------|--|--|--|-----------------------------------|--|----------|
| 2/12/2016 | 0                                      | 0                                      | 0                                      | 600                               | 609                                    |          |
| 2/13/2016 | 0                                      | 0                                      | 0                                      | 600                               | 609                                    |          |
| 2/14/2016 | 0                                      | 0                                      | 0                                      | 600                               | 609                                    |          |
| 2/15/2016 | 0                                      | 0                                      | 0                                      | 600                               | 609                                    |          |
| 2/16/2016 | 0                                      | 0                                      | 0                                      | 600                               | 609                                    |          |
| 2/17/2016 | 0                                      | 0                                      | 0                                      | 600                               | 609                                    |          |
| 2/18/2016 | 0                                      | 0                                      | 0                                      | 600                               | 609                                    |          |
| 2/19/2016 | 0                                      | 0                                      | 0                                      | 600                               | 609                                    |          |
| 2/20/2016 | 0                                      | 0                                      | 0                                      | 600                               | 609                                    |          |
| 2/21/2016 | 0                                      | 0                                      | 0                                      | 600                               | 609                                    |          |
| 2/22/2016 | 0                                      | 0                                      | 0                                      | 600                               | 609                                    |          |
| 2/23/2016 | 0                                      | 0                                      | 0                                      | 600                               | 609                                    |          |
| 2/24/2016 | 0                                      | 0                                      | 0                                      | 600                               | 609                                    |          |
| 2/25/2016 | 0                                      | 0                                      | 0                                      | 600                               | 609                                    |          |
| 2/26/2016 | 0                                      | 0                                      | 0                                      | 600                               | 609                                    |          |
| 2/27/2016 | 0                                      | 0                                      | 0                                      | 600                               | 609                                    |          |
| 2/28/2016 | 0                                      | 0                                      | 0                                      | 600                               | 609                                    |          |
| 2/29/2016 | 0                                      | 0                                      | 0                                      | 600                               | 609                                    |          |
| 3/1/2016  | 0                                      | 0                                      | 0                                      | 600                               | 609                                    |          |
| 3/2/2016  | 0                                      | 0                                      | 0                                      | 600                               | 609                                    |          |
| 3/3/2016  | 0                                      | 0                                      | 0                                      | 600                               | 609                                    |          |
| 3/4/2016  | 0                                      | 0                                      | 0                                      | 600                               | 609                                    |          |
| 3/5/2016  | 0                                      | 0                                      | 0                                      | 600                               | 609                                    |          |
| 3/6/2016  | 0                                      | 0                                      | 0                                      | 600                               | 609                                    |          |
| 3/7/2016  | 0                                      | 0                                      | 0                                      | 600                               | 609                                    |          |
| 3/8/2016  | 0                                      | 0                                      | 0                                      | 600                               | 609                                    |          |
| 3/9/2016  | 0                                      | 0                                      | 0                                      | 600                               | 609                                    |          |
| 3/10/2016 | 0                                      | 0                                      | 0                                      | 600                               | 609                                    |          |
| 3/11/2016 | 0                                      | 0                                      | 0                                      | 600                               | 609                                    |          |
| 3/12/2016 | 0                                      | 0                                      | 0                                      | 600                               | 609                                    |          |
| 3/13/2016 | 0                                      | 0                                      | 0                                      | 600                               | 609                                    |          |
| 3/14/2016 | 0                                      | 0                                      | 0                                      | 600                               | 609                                    |          |
| 3/15/2016 | 0                                      | 0                                      | 0                                      | 600                               | 609                                    |          |
| 3/16/2016 | 0                                      | 0                                      | 0                                      | 600                               | 609                                    |          |
| 3/17/2016 | 0                                      | 0                                      | 0                                      | 600                               | 609                                    |          |
| 3/18/2016 | 0                                      | 0                                      | 0                                      | 600                               | 609                                    |          |
| 3/19/2016 | 0                                      | 0                                      | 0                                      | 600                               | 609                                    |          |
| 3/20/2016 | 0                                      | 0                                      | 0                                      | 600                               | 609                                    |          |
| 3/21/2016 | 0                                      | 0                                      | 0                                      | 600                               | 609                                    |          |
| 3/22/2016 | 0                                      | 0                                      | 0                                      | 600                               | 609                                    |          |
| 3/23/2016 | 0                                      | 0                                      | 0                                      | 600                               | 609                                    |          |
| 3/24/2016 | 0                                      | 0                                      | 0                                      | 600                               | 609                                    |          |

**APPENDIX 1: Daily Injection Pressures**  
**DDW-1 1st Quarter 2016**  
**Lost Creek ISR Project 13-409**

| Date      | Daily Minimum Injection Pressure (psi) | Daily Average Injection Pressure (psi) | Daily Maximum Injection Pressure (psi) | Automatic Shutdown Pressure (psi) | Maximum Injection Pressure Limit (psi) | Comments |
|-----------|--|--|--|-----------------------------------|--|----------|
| 3/25/2016 | 0                                      | 0                                      | 0                                      | 600                               | 609                                    |          |
| 3/26/2016 | 0                                      | 0                                      | 0                                      | 600                               | 609                                    |          |
| 3/27/2016 | 0                                      | 0                                      | 0                                      | 600                               | 609                                    |          |
| 3/28/2016 | 0                                      | 0                                      | 0                                      | 600                               | 609                                    |          |
| 3/29/2016 | 0                                      | 0                                      | 0                                      | 600                               | 609                                    |          |
| 3/30/2016 | 0                                      | 0                                      | 0                                      | 600                               | 609                                    |          |
| 3/31/2016 | 0                                      | 0                                      | 0                                      | 600                               | 609                                    |          |

*psi: pounds per square inch*

**APPENDIX 1: Daily Injection Pressures**  
**DDW-1 1st Quarter 2016**  
**Lost Creek ISR Project 13-409**

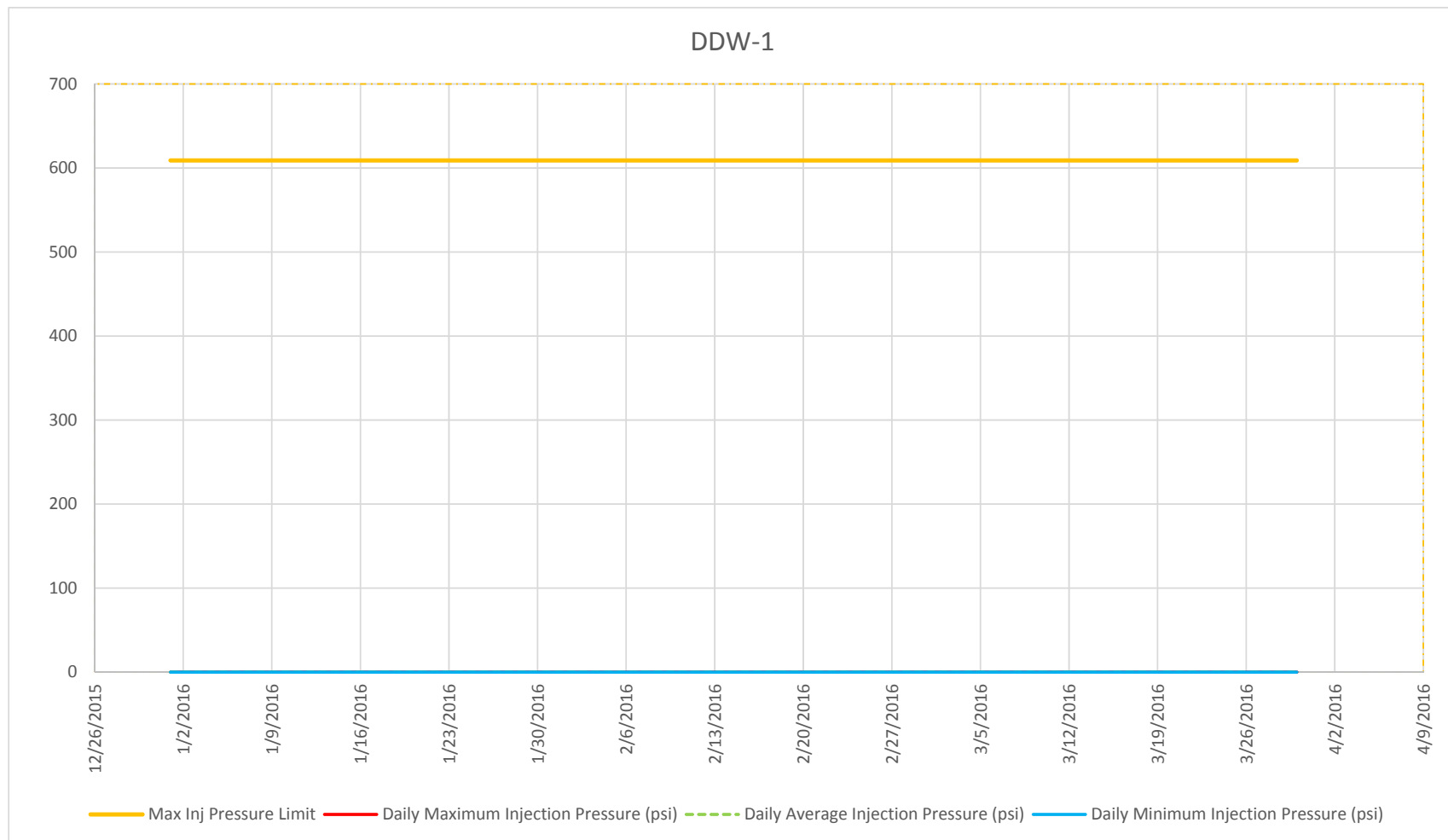

**APPENDIX 1: Daily Injection Pressures**  
**DDW-3 1st Quarter 2016**  
**Lost Creek ISR Project 13-409**

| Date      | Daily Minimum Injection Pressure (psi) | Daily Average Injection Pressure (psi) | Daily Maximum Injection Pressure (psi) | Automatic Shutdown Pressure (psi) | Maximum Injection Pressure Limit (psi) | Comments |
|-----------|--|--|--|-----------------------------------|--|----------|
| 1/1/2016  | 830                                    | 868                                    | 910                                    | 910                               | 915                                    |          |
| 1/2/2016  | 776                                    | 814                                    | 840                                    | 910                               | 915                                    |          |
| 1/3/2016  | 808                                    | 856                                    | 894                                    | 910                               | 915                                    |          |
| 1/4/2016  | 754                                    | 806                                    | 854                                    | 910                               | 915                                    |          |
| 1/5/2016  | 0                                      | 775                                    | 822                                    | 910                               | 915                                    |          |
| 1/6/2016  | 725                                    | 796                                    | 865                                    | 910                               | 915                                    |          |
| 1/7/2016  | 785                                    | 839                                    | 874                                    | 910                               | 915                                    |          |
| 1/8/2016  | 826                                    | 865                                    | 897                                    | 910                               | 915                                    |          |
| 1/9/2016  | 852                                    | 868                                    | 886                                    | 910                               | 915                                    |          |
| 1/10/2016 | 775                                    | 836                                    | 877                                    | 910                               | 915                                    |          |
| 1/11/2016 | 770                                    | 800                                    | 845                                    | 910                               | 915                                    |          |
| 1/12/2016 | 738                                    | 794                                    | 866                                    | 910                               | 915                                    |          |
| 1/13/2016 | 750                                    | 793                                    | 859                                    | 910                               | 915                                    |          |
| 1/14/2016 | 731                                    | 754                                    | 778                                    | 910                               | 915                                    |          |
| 1/15/2016 | 774                                    | 805                                    | 840                                    | 910                               | 915                                    |          |
| 1/16/2016 | 754                                    | 806                                    | 868                                    | 910                               | 915                                    |          |
| 1/17/2016 | 839                                    | 865                                    | 883                                    | 910                               | 915                                    |          |
| 1/18/2016 | 839                                    | 860                                    | 902                                    | 910                               | 915                                    |          |
| 1/19/2016 | 830                                    | 866                                    | 893                                    | 910                               | 915                                    |          |
| 1/20/2016 | 785                                    | 846                                    | 888                                    | 910                               | 915                                    |          |
| 1/21/2016 | 770                                    | 798                                    | 845                                    | 910                               | 915                                    |          |
| 1/22/2016 | 778                                    | 841                                    | 883                                    | 910                               | 915                                    |          |
| 1/23/2016 | 793                                    | 821                                    | 893                                    | 910                               | 915                                    |          |
| 1/24/2016 | 774                                    | 802                                    | 848                                    | 910                               | 915                                    |          |
| 1/25/2016 | 820                                    | 844                                    | 881                                    | 910                               | 915                                    |          |
| 1/26/2016 | 821                                    | 848                                    | 892                                    | 910                               | 915                                    |          |
| 1/27/2016 | 784                                    | 806                                    | 836                                    | 910                               | 915                                    |          |
| 1/28/2016 | 767                                    | 821                                    | 878                                    | 910                               | 915                                    |          |
| 1/29/2016 | 758                                    | 817                                    | 870                                    | 910                               | 915                                    |          |
| 1/30/2016 | 738                                    | 768                                    | 811                                    | 910                               | 915                                    |          |
| 1/31/2016 | 737                                    | 761                                    | 806                                    | 910                               | 915                                    |          |
| 2/1/2016  | 782                                    | 825                                    | 868                                    | 910                               | 915                                    |          |
| 2/2/2016  | 842                                    | 869                                    | 881                                    | 910                               | 915                                    |          |
| 2/3/2016  | 828                                    | 867                                    | 882                                    | 910                               | 915                                    |          |
| 2/4/2016  | 809                                    | 848                                    | 871                                    | 910                               | 915                                    |          |
| 2/5/2016  | 794                                    | 818                                    | 878                                    | 910                               | 915                                    |          |
| 2/6/2016  | 779                                    | 811                                    | 876                                    | 910                               | 915                                    |          |
| 2/7/2016  | 804                                    | 835                                    | 862                                    | 910                               | 915                                    |          |
| 2/8/2016  | 742                                    | 798                                    | 837                                    | 910                               | 915                                    |          |
| 2/9/2016  | 729                                    | 757                                    | 802                                    | 910                               | 915                                    |          |
| 2/10/2016 | 728                                    | 768                                    | 868                                    | 910                               | 915                                    |          |
| 2/11/2016 | 786                                    | 799                                    | 822                                    | 910                               | 915                                    |          |

**APPENDIX 1: Daily Injection Pressures**  
**DDW-3 1st Quarter 2016**  
**Lost Creek ISR Project 13-409**

| Date      | Daily Minimum Injection Pressure (psi) | Daily Average Injection Pressure (psi) | Daily Maximum Injection Pressure (psi) | Automatic Shutdown Pressure (psi) | Maximum Injection Pressure Limit (psi) | Comments |
|-----------|--|--|--|-----------------------------------|--|----------|
| 2/12/2016 | 803                                    | 844                                    | 866                                    | 910                               | 915                                    |          |
| 2/13/2016 | 773                                    | 811                                    | 872                                    | 910                               | 915                                    |          |
| 2/14/2016 | 841                                    | 851                                    | 862                                    | 910                               | 915                                    |          |
| 2/15/2016 | 801                                    | 839                                    | 855                                    | 910                               | 915                                    |          |
| 2/16/2016 | 792                                    | 824                                    | 860                                    | 910                               | 915                                    |          |
| 2/17/2016 | 751                                    | 770                                    | 798                                    | 910                               | 915                                    |          |
| 2/18/2016 | 746                                    | 806                                    | 843                                    | 910                               | 915                                    |          |
| 2/19/2016 | 772                                    | 813                                    | 866                                    | 910                               | 915                                    |          |
| 2/20/2016 | 729                                    | 768                                    | 813                                    | 910                               | 915                                    |          |
| 2/21/2016 | 724                                    | 791                                    | 847                                    | 910                               | 915                                    |          |
| 2/22/2016 | 807                                    | 845                                    | 863                                    | 910                               | 915                                    |          |
| 2/23/2016 | 769                                    | 790                                    | 808                                    | 910                               | 915                                    |          |
| 2/24/2016 | 805                                    | 850                                    | 899                                    | 910                               | 915                                    |          |
| 2/25/2016 | 803                                    | 823                                    | 854                                    | 910                               | 915                                    |          |
| 2/26/2016 | 803                                    | 817                                    | 867                                    | 910                               | 915                                    |          |
| 2/27/2016 | 760                                    | 791                                    | 833                                    | 910                               | 915                                    |          |
| 2/28/2016 | 815                                    | 844                                    | 898                                    | 910                               | 915                                    |          |
| 2/29/2016 | 842                                    | 868                                    | 881                                    | 910                               | 915                                    |          |
| 3/1/2016  | 809                                    | 850                                    | 882                                    | 910                               | 915                                    |          |
| 3/2/2016  | 781                                    | 807                                    | 849                                    | 910                               | 915                                    |          |
| 3/3/2016  | 775                                    | 791                                    | 834                                    | 910                               | 915                                    |          |
| 3/4/2016  | 806                                    | 847                                    | 882                                    | 910                               | 915                                    |          |
| 3/5/2016  | 801                                    | 828                                    | 889                                    | 910                               | 915                                    |          |
| 3/6/2016  | 746                                    | 814                                    | 842                                    | 910                               | 915                                    |          |
| 3/7/2016  | 772                                    | 810                                    | 819                                    | 910                               | 915                                    |          |
| 3/8/2016  | 815                                    | 841                                    | 871                                    | 910                               | 915                                    |          |
| 3/9/2016  | 839                                    | 853                                    | 874                                    | 910                               | 915                                    |          |
| 3/10/2016 | 785                                    | 821                                    | 859                                    | 910                               | 915                                    |          |
| 3/11/2016 | 826                                    | 844                                    | 860                                    | 910                               | 915                                    |          |
| 3/12/2016 | 780                                    | 825                                    | 880                                    | 910                               | 915                                    |          |
| 3/13/2016 | 807                                    | 839                                    | 876                                    | 910                               | 915                                    |          |
| 3/14/2016 | 807                                    | 824                                    | 853                                    | 910                               | 915                                    |          |
| 3/15/2016 | 836                                    | 858                                    | 882                                    | 910                               | 915                                    |          |
| 3/16/2016 | 855                                    | 865                                    | 895                                    | 910                               | 915                                    |          |
| 3/17/2016 | 764                                    | 803                                    | 879                                    | 910                               | 915                                    |          |
| 3/18/2016 | 781                                    | 829                                    | 865                                    | 910                               | 915                                    |          |
| 3/19/2016 | 799                                    | 824                                    | 878                                    | 910                               | 915                                    |          |
| 3/20/2016 | 787                                    | 808                                    | 848                                    | 910                               | 915                                    |          |
| 3/21/2016 | 785                                    | 802                                    | 856                                    | 910                               | 915                                    |          |
| 3/22/2016 | 780                                    | 830                                    | 875                                    | 910                               | 915                                    |          |
| 3/23/2016 | 824                                    | 854                                    | 882                                    | 910                               | 915                                    |          |
| 3/24/2016 | 866                                    | 873                                    | 881                                    | 910                               | 915                                    |          |



**APPENDIX 1: Daily Injection Pressures**  
**DDW-3 1st Quarter 2016**  
**Lost Creek ISR Project 13-409**

| Date      | Daily Minimum Injection Pressure (psi) | Daily Average Injection Pressure (psi) | Daily Maximum Injection Pressure (psi) | Automatic Shutdown Pressure (psi) | Maximum Injection Pressure Limit (psi) | Comments |
|-----------|--|--|--|-----------------------------------|--|----------|
| 3/25/2016 | 812                                    | 856                                    | 909                                    | 910                               | 915                                    |          |
| 3/26/2016 | 797                                    | 818                                    | 862                                    | 910                               | 915                                    |          |
| 3/27/2016 | 830                                    | 838                                    | 850                                    | 910                               | 915                                    |          |
| 3/28/2016 | 818                                    | 848                                    | 891                                    | 910                               | 915                                    |          |
| 3/29/2016 | 836                                    | 874                                    | 896                                    | 910                               | 915                                    |          |
| 3/30/2016 | 818                                    | 871                                    | 887                                    | 910                               | 915                                    |          |
| 3/31/2016 | 795                                    | 816                                    | 851                                    | 910                               | 915                                    |          |

*psi: pounds per square inch*

**APPENDIX 1: Daily Injection Pressures**  
**DDW-3 1st Quarter 2016**  
**Lost Creek ISR Project 13-409**

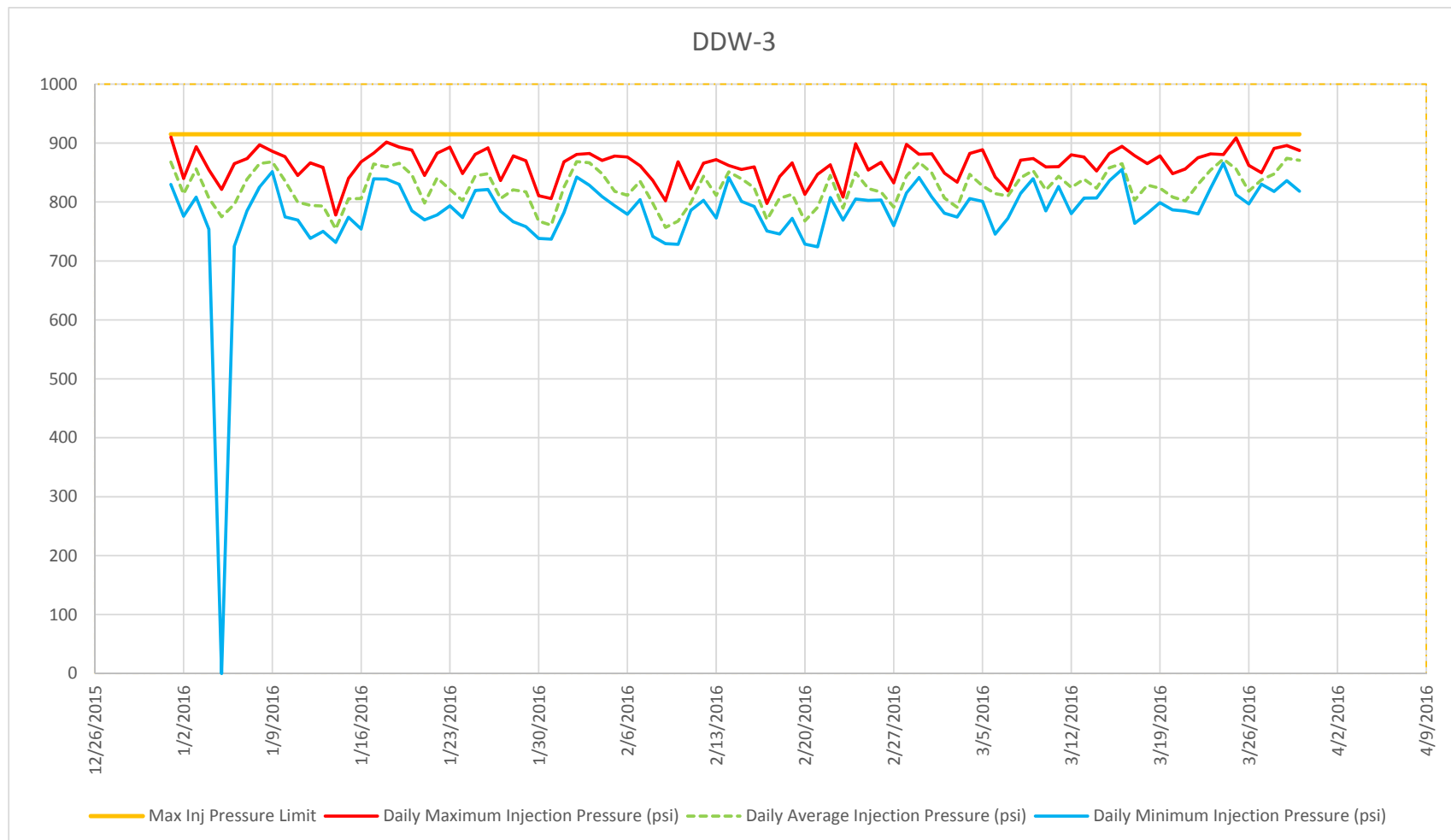

**APPENDIX 1: Daily Injection Pressures**  
**DDW-4 1st Quarter 2016**  
**Lost Creek ISR Project 13-409**

| Date      | Daily Minimum Injection Pressure (psi) | Daily Average Injection Pressure (psi) | Daily Maximum Injection Pressure (psi) | Shutdown Pressure (psi) | Maximum Injection Pressure Limit (psi) | Comments |
|-----------|--|--|--|-------------------------|--|----------|
| 1/1/2016  | 676                                    | 733                                    | 760                                    | 820                     | 838                                    |          |
| 1/2/2016  | 706                                    | 725                                    | 740                                    | 820                     | 838                                    |          |
| 1/3/2016  | 696                                    | 755                                    | 783                                    | 820                     | 838                                    |          |
| 1/4/2016  | 622                                    | 690                                    | 732                                    | 820                     | 838                                    |          |
| 1/5/2016  | 604                                    | 676                                    | 742                                    | 820                     | 838                                    |          |
| 1/6/2016  | 698                                    | 742                                    | 764                                    | 820                     | 838                                    |          |
| 1/7/2016  | 658                                    | 708                                    | 746                                    | 820                     | 838                                    |          |
| 1/8/2016  | 641                                    | 689                                    | 733                                    | 820                     | 838                                    |          |
| 1/9/2016  | 733                                    | 746                                    | 758                                    | 820                     | 838                                    |          |
| 1/10/2016 | 691                                    | 702                                    | 743                                    | 820                     | 838                                    |          |
| 1/11/2016 | 700                                    | 739                                    | 770                                    | 820                     | 838                                    |          |
| 1/12/2016 | 730                                    | 766                                    | 775                                    | 820                     | 838                                    |          |
| 1/13/2016 | 658                                    | 703                                    | 736                                    | 820                     | 838                                    |          |
| 1/14/2016 | 634                                    | 685                                    | 707                                    | 820                     | 838                                    |          |
| 1/15/2016 | 615                                    | 668                                    | 716                                    | 820                     | 838                                    |          |
| 1/16/2016 | 716                                    | 749                                    | 777                                    | 820                     | 838                                    |          |
| 1/17/2016 | 733                                    | 753                                    | 779                                    | 820                     | 838                                    |          |
| 1/18/2016 | 737                                    | 763                                    | 787                                    | 820                     | 838                                    |          |
| 1/19/2016 | 749                                    | 788                                    | 795                                    | 820                     | 838                                    |          |
| 1/20/2016 | 657                                    | 723                                    | 778                                    | 820                     | 838                                    |          |
| 1/21/2016 | 703                                    | 732                                    | 751                                    | 820                     | 838                                    |          |
| 1/22/2016 | 712                                    | 763                                    | 785                                    | 820                     | 838                                    |          |
| 1/23/2016 | 760                                    | 762                                    | 769                                    | 820                     | 838                                    |          |
| 1/24/2016 | 766                                    | 768                                    | 775                                    | 820                     | 838                                    |          |
| 1/25/2016 | 719                                    | 745                                    | 789                                    | 820                     | 838                                    |          |
| 1/26/2016 | 720                                    | 757                                    | 791                                    | 820                     | 838                                    |          |
| 1/27/2016 | 715                                    | 767                                    | 801                                    | 820                     | 838                                    |          |
| 1/28/2016 | 748                                    | 779                                    | 798                                    | 820                     | 838                                    |          |
| 1/29/2016 | 633                                    | 707                                    | 756                                    | 820                     | 838                                    |          |
| 1/30/2016 | 604                                    | 642                                    | 703                                    | 820                     | 838                                    |          |
| 1/31/2016 | 700                                    | 733                                    | 775                                    | 820                     | 838                                    |          |
| 2/1/2016  | 776                                    | 785                                    | 799                                    | 820                     | 838                                    |          |
| 2/2/2016  | 718                                    | 769                                    | 801                                    | 820                     | 838                                    |          |
| 2/3/2016  | 768                                    | 775                                    | 787                                    | 820                     | 838                                    |          |
| 2/4/2016  | 775                                    | 783                                    | 797                                    | 820                     | 838                                    |          |
| 2/5/2016  | 786                                    | 794                                    | 807                                    | 820                     | 838                                    |          |
| 2/6/2016  | 725                                    | 775                                    | 810                                    | 820                     | 838                                    |          |
| 2/7/2016  | 742                                    | 785                                    | 804                                    | 820                     | 838                                    |          |
| 2/8/2016  | 633                                    | 691                                    | 744                                    | 820                     | 838                                    |          |
| 2/9/2016  | 682                                    | 713                                    | 756                                    | 820                     | 838                                    |          |
| 2/10/2016 | 753                                    | 767                                    | 784                                    | 820                     | 838                                    |          |
| 2/11/2016 | 706                                    | 738                                    | 762                                    | 820                     | 838                                    |          |

**APPENDIX 1: Daily Injection Pressures**  
**DDW-4 1st Quarter 2016**  
**Lost Creek ISR Project 13-409**

| Date      | Daily Minimum Injection Pressure (psi) | Daily Average Injection Pressure (psi) | Daily Maximum Injection Pressure (psi) | Shutdown Pressure (psi) | Maximum Injection Pressure Limit (psi) | Comments |
|-----------|--|--|--|-------------------------|--|----------|
| 2/12/2016 | 743                                    | 764                                    | 783                                    | 820                     | 838                                    |          |
| 2/13/2016 | 712                                    | 756                                    | 790                                    | 820                     | 838                                    |          |
| 2/14/2016 | 755                                    | 763                                    | 773                                    | 820                     | 838                                    |          |
| 2/15/2016 | 735                                    | 742                                    | 757                                    | 820                     | 838                                    |          |
| 2/16/2016 | 672                                    | 729                                    | 753                                    | 820                     | 838                                    |          |
| 2/17/2016 | 723                                    | 764                                    | 792                                    | 820                     | 838                                    |          |
| 2/18/2016 | 722                                    | 764                                    | 792                                    | 820                     | 838                                    |          |
| 2/19/2016 | 723                                    | 739                                    | 762                                    | 820                     | 838                                    |          |
| 2/20/2016 | 677                                    | 712                                    | 730                                    | 820                     | 838                                    |          |
| 2/21/2016 | 701                                    | 749                                    | 779                                    | 820                     | 838                                    |          |
| 2/22/2016 | 707                                    | 761                                    | 790                                    | 820                     | 838                                    |          |
| 2/23/2016 | 746                                    | 754                                    | 790                                    | 820                     | 838                                    |          |
| 2/24/2016 | 728                                    | 779                                    | 804                                    | 820                     | 838                                    |          |
| 2/25/2016 | 713                                    | 742                                    | 778                                    | 820                     | 838                                    |          |
| 2/26/2016 | 698                                    | 757                                    | 793                                    | 820                     | 838                                    |          |
| 2/27/2016 | 731                                    | 785                                    | 814                                    | 820                     | 838                                    |          |
| 2/28/2016 | 708                                    | 746                                    | 786                                    | 820                     | 838                                    |          |
| 2/29/2016 | 688                                    | 709                                    | 744                                    | 820                     | 838                                    |          |
| 3/1/2016  | 690                                    | 738                                    | 764                                    | 820                     | 838                                    |          |
| 3/2/2016  | 703                                    | 755                                    | 774                                    | 820                     | 838                                    |          |
| 3/3/2016  | 636                                    | 678                                    | 708                                    | 820                     | 838                                    |          |
| 3/4/2016  | 670                                    | 719                                    | 758                                    | 820                     | 838                                    |          |
| 3/5/2016  | 680                                    | 747                                    | 773                                    | 820                     | 838                                    |          |
| 3/6/2016  | 663                                    | 725                                    | 775                                    | 820                     | 838                                    |          |
| 3/7/2016  | 627                                    | 641                                    | 663                                    | 820                     | 838                                    |          |
| 3/8/2016  | 607                                    | 636                                    | 699                                    | 820                     | 838                                    |          |
| 3/9/2016  | 679                                    | 689                                    | 704                                    | 820                     | 838                                    |          |
| 3/10/2016 | 699                                    | 725                                    | 747                                    | 820                     | 838                                    |          |
| 3/11/2016 | 628                                    | 700                                    | 727                                    | 820                     | 838                                    |          |
| 3/12/2016 | 628                                    | 711                                    | 741                                    | 820                     | 838                                    |          |
| 3/13/2016 | 707                                    | 742                                    | 766                                    | 820                     | 838                                    |          |
| 3/14/2016 | 686                                    | 703                                    | 737                                    | 820                     | 838                                    |          |
| 3/15/2016 | 729                                    | 745                                    | 765                                    | 820                     | 838                                    |          |
| 3/16/2016 | 700                                    | 740                                    | 772                                    | 820                     | 838                                    |          |
| 3/17/2016 | 692                                    | 703                                    | 713                                    | 820                     | 838                                    |          |
| 3/18/2016 | 711                                    | 741                                    | 761                                    | 820                     | 838                                    |          |
| 3/19/2016 | 715                                    | 755                                    | 792                                    | 820                     | 838                                    |          |
| 3/20/2016 | 688                                    | 705                                    | 751                                    | 820                     | 838                                    |          |
| 3/21/2016 | 688                                    | 717                                    | 777                                    | 820                     | 838                                    |          |
| 3/22/2016 | 771                                    | 782                                    | 798                                    | 820                     | 838                                    |          |
| 3/23/2016 | 771                                    | 780                                    | 793                                    | 820                     | 838                                    |          |
| 3/24/2016 | 755                                    | 764                                    | 782                                    | 820                     | 838                                    |          |

**APPENDIX 1: Daily Injection Pressures**  
**DDW-4 1st Quarter 2016**  
**Lost Creek ISR Project 13-409**

| Date      | Daily Minimum Injection Pressure (psi) | Daily Average Injection Pressure (psi) | Daily Maximum Injection Pressure (psi) | Shutdown Pressure (psi) | Maximum Injection Pressure Limit (psi) | Comments |
|-----------|--|--|--|-------------------------|--|----------|
| 3/25/2016 | 754                                    | 785                                    | 790                                    | 820                     | 838                                    |          |
| 3/26/2016 | 746                                    | 767                                    | 784                                    | 820                     | 838                                    |          |
| 3/27/2016 | 669                                    | 719                                    | 753                                    | 820                     | 838                                    |          |
| 3/28/2016 | 735                                    | 767                                    | 792                                    | 820                     | 838                                    |          |
| 3/29/2016 | 787                                    | 800                                    | 807                                    | 820                     | 838                                    |          |
| 3/30/2016 | 763                                    | 781                                    | 802                                    | 820                     | 838                                    |          |
| 3/31/2016 | 722                                    | 769                                    | 790                                    | 820                     | 838                                    |          |

*psi: pounds per square inch*

**APPENDIX 1: Daily Injection Pressures**  
**DDW-4 1st Quarter 2016**  
**Lost Creek ISR Project 13-409**

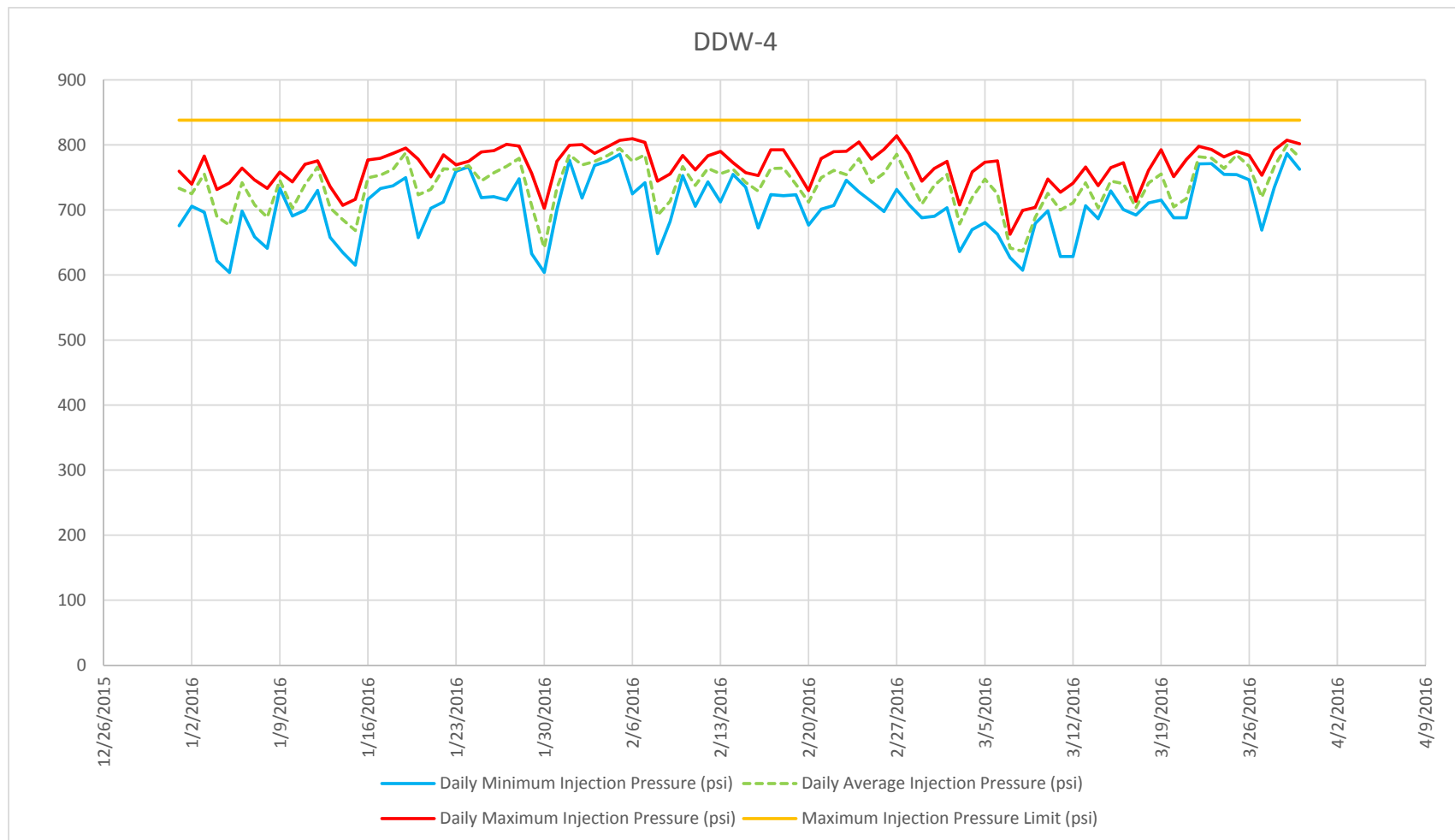



## APPENDIX 2



## ANALYTICAL SUMMARY REPORT

March 11, 2016

UR Energy USA Inc  
10758 W Centennial Rd Ste 200  
Ken Caryl Ranch, CO 80127

Work Order: C16020722

Project Name: Lost Creek Waste Water

Energy Laboratories, Inc. Casper WY received the following 1 sample for UR Energy USA Inc on 2/26/2016 for analysis.

| Lab ID        | Client Sample ID | Collect Date  | Receive Date | Matrix  | Test  |
|---------------|------------------|---------------|--------------|---------|---|
| C16020722-001 | DW - Injectate   | 02/25/16 8:15 | 02/26/16     | Aqueous | Metals by ICP/ICPMS, Total<br>Alkalinity<br>Conductivity<br>Specific Gravity<br>E300.0 Anions<br>pH<br>Metals Preparation by EPA 200.2<br>Radium 226, Total<br>Solids, Total Dissolved<br>Sulfide, Iodine Titrimetric |

The results as reported relate only to the item(s) submitted for testing. The analyses presented in this report were performed at Energy Laboratories, Inc., 2393 Salt Creek Hwy., Casper, WY 82601, unless otherwise noted. Radiochemistry analyses were performed at Energy Laboratories, Inc., 2325 Kerzell Lane, Casper, WY 82601, unless otherwise noted. Any exceptions or problems with the analyses are noted in the Laboratory Analytical Report, the QA/QC Summary Report, or the Case Narrative.

If you have any questions regarding these test results, please call.

Report Approved By:





## LABORATORY ANALYTICAL REPORT

Prepared by Casper, WY Branch

**Client:** UR Energy USA Inc  
**Project:** Lost Creek Waste Water  
**Lab ID:** C16020722-001  
**Client Sample ID:** DW - Injectate

**Report Date:** 03/11/16  
**Collection Date:** 02/25/16 08:15  
**Date Received:** 02/26/16  
**Matrix:** Aqueous

| Analyses                                       | Result | Units    | Qualifiers | RL     | MCL/<br>QCL | Method    | Analysis Date / By     |
|--|--------|----------|------------|--------|-------------|-----------|------------------------|
| <b>MAJOR IONS</b>                              |        |          |            |        |             |           |                        |
| Carbonate as CO <sub>3</sub>                   | ND     | mg/L     |            | 5      |             | A2320 B   | 02/29/16 19:43 / wc    |
| Bicarbonate as HCO <sub>3</sub>                | 367    | mg/L     |            | 5      |             | A2320 B   | 02/29/16 19:43 / wc    |
| Chloride                                       | 22300  | mg/L     | D          | 50     |             | E300.0    | 02/27/16 06:19 / wc    |
| Sulfate  | 1020   | mg/L     | D          | 200    |             | E300.0    | 02/27/16 06:19 / wc    |
| <b>NON-METALS</b>                              |        |          |            |        |             |           |                        |
| Sulfide  | ND     | mg/L     |            | 1      |             | A4500-S F | 02/28/16 17:03 / ljl   |
| Sulfide as Hydrogen Sulfide (H <sub>2</sub> S) | ND     | mg/L     |            | 1      |             | A4500-S F | 02/28/16 17:03 / ljl   |
| <b>PHYSICAL PROPERTIES</b>                     |        |          |            |        |             |           |                        |
| Specific Gravity 60/60F                        | 1.023  | unitless |            |        |             | D1429     | 02/29/16 14:45 / eli-b |
| Conductivity @ 25 C                            | 50400  | umhos/cm | E          | 5      |             | A2510 B   | 02/26/16 14:45 / mag   |
| pH   | 6.72   | s.u.     | H          | 0.01   |             | A4500-H B | 02/26/16 14:45 / mag   |
| Solids, Total Dissolved TDS @ 180 C            | 31600  | mg/L     |            | 500    |             | A2540 C   | 02/26/16 15:27 / mag   |
| <b>METALS - TOTAL</b>                          |        |          |            |        |             |           |                        |
| Arsenic  | 0.039  | mg/L     |            | 0.001  |             | E200.8    | 03/03/16 00:11 / sf    |
| Selenium                                       | 0.365  | mg/L     |            | 0.001  |             | E200.8    | 03/03/16 00:11 / sf    |
| Uranium  | 24.8   | mg/L     |            | 0.0003 |             | E200.8    | 03/03/16 00:11 / sf    |
| Vanadium                                       | 0.03   | mg/L     |            | 0.01   |             | E200.8    | 03/03/16 00:11 / sf    |
| <b>RADIONUCLIDES - TOTAL</b>                   |        |          |            |        |             |           |                        |
| Radium 226                                     | 2970   | pCi/L    |            |        |             | E903.0    | 03/10/16 11:46 / dmf   |
| Radium 226 precision (±)                       | 556    | pCi/L    |            |        |             | E903.0    | 03/10/16 11:46 / dmf   |
| Radium 226 MDC                                 | 0.17   | pCi/L    |            |        |             | E903.0    | 03/10/16 11:46 / dmf   |

**Report Definitions:**  
RL - Analyte reporting limit.  
QCL - Quality control limit.  
MDC - Minimum detectable concentration  
E - Estimated value. Result exceeds the instrument upper quantitation limit.

MCL - Maximum contaminant level.  
ND - Not detected at the reporting limit.  
D - RL increased due to sample matrix.  
H - Analysis performed past recommended holding time.



## QA/QC Summary Report

Prepared by Casper, WY Branch

**Client:** UR Energy USA Inc  
**Project:** Lost Creek Waste Water

**Report Date:** 03/11/16  
**Work Order:** C16020722

| Analyte                                | Count | Result                    | Units | RL  | %REC | Low Limit | High Limit           | RPD | RPDLimit | Qual           |
|--|-------|---------------------------|-------|-----|------|-----------|----------------------|-----|----------|----------------|
| <b>Method: A2320 B</b>                 |       |                           |       |     |      |           |                      |     |          | Batch: R209469 |
| <b>Lab ID: MBLK</b>                    | 3     | Method Blank              |       |     |      |           | Run: MANTECH_160229A |     |          | 02/29/16 16:30 |
| Alkalinity, Total as CaCO <sub>3</sub> |       | ND                        | mg/L  | 1   |      |           |                      |     |          |                |
| Carbonate as CO <sub>3</sub>           |       | ND                        | mg/L  | 1   |      |           |                      |     |          |                |
| Bicarbonate as HCO <sub>3</sub>        |       | 1                         | mg/L  | 1   |      |           |                      |     |          |                |
| <b>Lab ID: LCS_15917</b>               |       |                           |       |     |      |           |                      |     |          | 02/29/16 16:44 |
|  |       | Laboratory Control Sample |       |     |      |           | Run: MANTECH_160229A |     |          |                |
| Alkalinity, Total as CaCO <sub>3</sub> |       | 240                       | mg/L  | 5.0 | 96   | 90        | 110                  |     |          |                |
| <b>Lab ID: C16020692-001BDUP</b>       |       |                           |       |     |      |           |                      |     |          | 02/29/16 16:59 |
|  | 3     | Sample Duplicate          |       |     |      |           | Run: MANTECH_160229A |     |          |                |
| Alkalinity, Total as CaCO <sub>3</sub> |       | 196                       | mg/L  | 5.0 |      |           |                      | 0.7 | 10       |                |
| Carbonate as CO <sub>3</sub>           |       | ND                        | mg/L  | 5.0 |      |           |                      |     | 10       |                |
| Bicarbonate as HCO <sub>3</sub>        |       | 239                       | mg/L  | 5.0 |      |           |                      | 0.7 | 10       |                |
| <b>Lab ID: C16020692-003BMS</b>        |       |                           |       |     |      |           |                      |     |          | 02/29/16 17:15 |
|  |       | Sample Matrix Spike       |       |     |      |           | Run: MANTECH_160229A |     |          |                |
| Alkalinity, Total as CaCO <sub>3</sub> |       | 285                       | mg/L  | 5.2 | 95   | 80        | 120                  |     |          |                |

### Qualifiers:

RL - Analyte reporting limit.

ND - Not detected at the reporting limit.

MDC - Minimum detectable concentration



## QA/QC Summary Report

Prepared by Casper, WY Branch

**Client:** UR Energy USA Inc  
**Project:** Lost Creek Waste Water

**Report Date:** 03/11/16  
**Work Order:** C16020722

| Analyte                          | Count | Result                                       | Units    | RL  | %REC | Low Limit | High Limit | RPD                                | RPDLimit | Qual           |
|----------------------------------|-------|--|----------|-----|------|-----------|------------|------------------------------------|----------|----------------|
| <b>Method:</b> A2510 B           |       |  |          |     |      |           |            | Analytical Run: PHSC_101-C_160226A |          |                |
| <b>Lab ID:</b> CCV - SC 1413     |       | Continuing Calibration Verification Standard |          |     |      |           |            |                                    |          | 02/26/16 14:13 |
| Conductivity @ 25 C              |       | 1420   | umhos/cm | 5.0 | 100  | 90        | 110        |                                    |          |                |
| <b>Method:</b> A2510 B           |       |  |          |     |      |           |            | Batch: R209385                     |          |                |
| <b>Lab ID:</b> SC 100            |       | Initial Calibration Verification Standard    |          |     |      |           |            |                                    |          | 02/26/16 10:48 |
| Conductivity @ 25 C              |       | 100  | umhos/cm | 5.0 | 100  | 90        | 110        |                                    |          |                |
| <b>Lab ID:</b> SC 2ND 1413       |       | Laboratory Control Sample                    |          |     |      |           |            |                                    |          | 02/26/16 11:00 |
| Conductivity @ 25 C              |       | 1410   | umhos/cm | 5.0 | 100  | 90        | 110        |                                    |          |                |
| <b>Lab ID:</b> MBLK              |       | Method Blank                                 |          |     |      |           |            |                                    |          | 02/26/16 12:17 |
| Conductivity @ 25 C              |       | ND   | umhos/cm | 4   |      |           |            |                                    |          |                |
| <b>Lab ID:</b> C16020722-001ADUP |       | Sample Duplicate                             |          |     |      |           |            |                                    |          | 02/26/16 14:49 |
| Conductivity @ 25 C              |       | 50300  | umhos/cm | 5.0 |      |           |            | 0.3                                | 10       |                |

### Qualifiers:

RL - Analyte reporting limit.

ND - Not detected at the reporting limit.

MDC - Minimum detectable concentration



## QA/QC Summary Report

Prepared by Casper, WY Branch

**Client:** UR Energy USA Inc  
**Project:** Lost Creek Waste Water

**Report Date:** 03/11/16  
**Work Order:** C16020722

| Analyte                             | Count | Result       | Units | RL  | %REC | Low Limit | High Limit          | RPD | RPDLimit | Qual              |
|-------------------------------------|-------|--------------|-------|-----|------|-----------|---------------------|-----|----------|-------------------|
| <b>Method: A2540 C</b>              |       |              |       |     |      |           |                     |     |          | Batch: TDS160226C |
| <b>Lab ID: MB-1_160226C</b>         |       | Method Blank |       |     |      |           | Run: BAL-18_160226D |     |          | 02/26/16 15:21    |
| Solids, Total Dissolved TDS @ 180 C |       | ND           | mg/L  | 8   |      |           |                     |     |          |                   |
| <b>Lab ID: LCS-2_160226C</b>        |       |              |       |     |      |           |                     |     |          | 02/26/16 15:22    |
| Solids, Total Dissolved TDS @ 180 C |       | 1110         | mg/L  | 11  | 99   | 90        | 110                 |     |          |                   |
| <b>Lab ID: C16020713-001A DUP</b>   |       |              |       |     |      |           |                     |     |          | 02/26/16 15:23    |
| Solids, Total Dissolved TDS @ 180 C |       | 209          | mg/L  | 9.9 |      |           |                     | 2.9 | 5        |                   |

### Qualifiers:

RL - Analyte reporting limit.

ND - Not detected at the reporting limit.

MDC - Minimum detectable concentration



## QA/QC Summary Report

Prepared by Casper, WY Branch

**Client:** UR Energy USA Inc  
**Project:** Lost Creek Waste Water

**Report Date:** 03/11/16  
**Work Order:** C16020722

| Analyte                          | Count | Result                                       | Units | RL    | %REC | Low Limit               | High Limit | RPD                                | RPDLimit       | Qual           |
|----------------------------------|-------|--|-------|-------|------|-------------------------|------------|------------------------------------|----------------|----------------|
| <b>Method:</b> A4500-H B         |       |  |       |       |      |                         |            | Analytical Run: PHSC_101-C_160226A |                |                |
| <b>Lab ID:</b> pH 6.86           |       | Initial Calibration Verification Standard    |       |       |      |                         |            |                                    |                | 02/26/16 10:45 |
| pH                               |       | 6.90   | s.u.  | 0.010 | 101  | 98                      | 102        |                                    |                |                |
| <b>Lab ID:</b> CCV - pH 7        |       | Continuing Calibration Verification Standard |       |       |      |                         |            |                                    |                | 02/26/16 14:10 |
| pH                               |       | 7.02   | s.u.  | 0.010 | 100  | 98                      | 102        |                                    |                |                |
| <b>Lab ID:</b> pH 6.86           |       | Initial Calibration Verification Standard    |       |       |      |                         |            |                                    |                | 02/26/16 14:39 |
| pH                               |       | 6.90   | s.u.  | 0.010 | 101  | 98                      | 102        |                                    |                |                |
| <b>Method:</b> A4500-H B         |       |  |       |       |      |                         |            | Batch: R209385                     |                |                |
| <b>Lab ID:</b> C16020722-001ADUP |       | Sample Duplicate                             |       |       |      | Run: PHSC_101-C_160226A |            |                                    | 02/26/16 14:49 |                |
| pH                               |       | 6.71   | s.u.  | 0.010 |      |                         |            | 0.1                                | 3              |                |

### Qualifiers:

RL - Analyte reporting limit.

ND - Not detected at the reporting limit.

MDC - Minimum detectable concentration



## QA/QC Summary Report

Prepared by Casper, WY Branch

**Client:** UR Energy USA Inc  
**Project:** Lost Creek Waste Water

**Report Date:** 03/11/16  
**Work Order:** C16020722

| Analyte                           | Count | Result                                    | Units | RL  | %REC | Low Limit | High Limit | RPD                               | RPDLimit | Qual           |
|-----------------------------------|-------|---|-------|-----|------|-----------|------------|-----------------------------------|----------|----------------|
| <b>Method:</b> A4500-S F          |       |   |       |     |      |           |            | Analytical Run: TITRATION_160228A |          |                |
| <b>Lab ID:</b> ICV                | 2     | Initial Calibration Verification Standard |       |     |      |           |            |                                   |          | 02/28/16 15:59 |
| Sulfide                           |       | 120                                       | mg/L  | 1.0 | 97   | 80        | 120        |                                   |          |                |
| Sulfide as Hydrogen Sulfide (H2S) |       | 127                                       | mg/L  | 1.1 |      | 80        | 120        |                                   |          |                |
| <b>Method:</b> A4500-S F          |       |   |       |     |      |           |            | Batch: 160228-SULFIDE-TTR-W       |          |                |
| <b>Lab ID:</b> MBLK7-160228       | 2     | Method Blank                              |       |     |      |           |            |                                   |          | 02/28/16 15:54 |
| Sulfide                           |       | ND  | mg/L  | 0.4 |      |           |            |                                   |          |                |
| Sulfide as Hydrogen Sulfide (H2S) |       | ND  | mg/L  | 0.4 |      |           |            |                                   |          |                |
| <b>Lab ID:</b> C16020722-001BMS   |       | Sample Matrix Spike                       |       |     |      |           |            |                                   |          | 02/28/16 17:07 |
| Sulfide                           |       | 23.4                                      | mg/L  | 1.0 | 95   | 80        | 120        |                                   |          |                |
| <b>Lab ID:</b> C16020722-001BMSD  |       | Sample Matrix Spike Duplicate             |       |     |      |           |            |                                   |          | 02/28/16 17:11 |
| Sulfide                           |       | 23.6                                      | mg/L  | 1.0 | 96   | 80        | 120        | 0.7                               | 20       |                |

### Qualifiers:

RL - Analyte reporting limit.

ND - Not detected at the reporting limit.

MDC - Minimum detectable concentration



## QA/QC Summary Report

Prepared by Casper, WY Branch

**Client:** UR Energy USA Inc  
**Project:** Lost Creek Waste Water

**Report Date:** 03/11/16  
**Work Order:** C16020722

| Analyte                          | Count | Result                                    | Units | RL      | %REC | Low Limit                        | High Limit | RPD | RPDLimit | Qual                                 |
|----------------------------------|-------|---|-------|---------|------|----------------------------------|------------|-----|----------|--------------------------------------|
| <b>Method: E200.8</b>            |       |   |       |         |      | Analytical Run: ICPMS4-C_160302A |            |     |          |                                      |
| <b>Lab ID: ICV</b>               | 4     | Initial Calibration Verification Standard |       |         |      |                                  |            |     |          | 03/02/16 17:40                       |
| Arsenic                          |       | 0.0507                                    | mg/L  | 0.0010  | 101  | 90                               | 110        |     |          |                                      |
| Selenium                         |       | 0.0496                                    | mg/L  | 0.0010  | 99   | 90                               | 110        |     |          |                                      |
| Uranium                          |       | 0.0466                                    | mg/L  | 0.00030 | 93   | 90                               | 110        |     |          |                                      |
| Vanadium                         |       | 0.0491                                    | mg/L  | 0.0010  | 98   | 90                               | 110        |     |          |                                      |
| <b>Method: E200.8</b>            |       |   |       |         |      | Batch: 46921                     |            |     |          |                                      |
| <b>Lab ID: MB-46921</b>          | 4     | Method Blank                              |       |         |      |                                  |            |     |          | Run: ICPMS4-C_160302A 03/02/16 23:55 |
| Arsenic                          |       | 5E-05                                     | mg/L  | 2E-05   |      |                                  |            |     |          |                                      |
| Selenium                         |       | ND  | mg/L  | 2E-05   |      |                                  |            |     |          |                                      |
| Uranium                          |       | ND  | mg/L  | 4E-06   |      |                                  |            |     |          |                                      |
| Vanadium                         |       | 0.0007                                    | mg/L  | 5E-05   |      |                                  |            |     |          |                                      |
| <b>Lab ID: LCS3-46921</b>        | 4     | Laboratory Control Sample                 |       |         |      |                                  |            |     |          | Run: ICPMS4-C_160302A 03/03/16 00:01 |
| Arsenic                          |       | 0.508                                     | mg/L  | 0.0010  | 101  | 85                               | 115        |     |          |                                      |
| Selenium                         |       | 0.498                                     | mg/L  | 0.0010  | 100  | 85                               | 115        |     |          |                                      |
| Uranium                          |       | 0.493                                     | mg/L  | 0.00030 | 99   | 85                               | 115        |     |          |                                      |
| Vanadium                         |       | 0.508                                     | mg/L  | 0.010   | 102  | 85                               | 115        |     |          |                                      |
| <b>Lab ID: C16020743-001BMS3</b> | 4     | Sample Matrix Spike                       |       |         |      |                                  |            |     |          | Run: ICPMS4-C_160302A 03/03/16 00:22 |
| Arsenic                          |       | 0.512                                     | mg/L  | 0.0010  | 102  | 70                               | 130        |     |          |                                      |
| Selenium                         |       | 0.518                                     | mg/L  | 0.0010  | 94   | 70                               | 130        |     |          |                                      |
| Uranium                          |       | 0.619                                     | mg/L  | 0.00030 | 97   | 70                               | 130        |     |          |                                      |
| Vanadium                         |       | 0.521                                     | mg/L  | 0.010   | 104  | 70                               | 130        |     |          |                                      |
| <b>Lab ID: C16020743-001BMSD</b> | 4     | Sample Matrix Spike Duplicate             |       |         |      |                                  |            |     |          | Run: ICPMS4-C_160302A 03/03/16 00:27 |
| Arsenic                          |       | 0.512                                     | mg/L  | 0.0010  | 102  | 70                               | 130        | 0.1 | 20       |                                      |
| Selenium                         |       | 0.528                                     | mg/L  | 0.0010  | 96   | 70                               | 130        | 1.8 | 20       |                                      |
| Uranium                          |       | 0.627                                     | mg/L  | 0.00030 | 99   | 70                               | 130        | 1.3 | 20       |                                      |
| Vanadium                         |       | 0.522                                     | mg/L  | 0.010   | 104  | 70                               | 130        | 0.1 | 20       |                                      |

### Qualifiers:

RL - Analyte reporting limit.

ND - Not detected at the reporting limit.

MDC - Minimum detectable concentration



## QA/QC Summary Report

Prepared by Casper, WY Branch

**Client:** UR Energy USA Inc  
**Project:** Lost Creek Waste Water

**Report Date:** 03/11/16  
**Work Order:** C16020722

| Analyte                          | Count | Result                                       | Units | RL   | %REC | Low Limit | High Limit | RPD | RPDLimit | Qual                              |
|----------------------------------|-------|--|-------|------|------|-----------|------------|-----|----------|-----------------------------------|
| <b>Method: E300.0</b>            |       |  |       |      |      |           |            |     |          | Analytical Run: IC2-C_160226A     |
| <b>Lab ID: ICV</b>               | 2     | Initial Calibration Verification Standard    |       |      |      |           |            |     |          | 02/26/16 13:00                    |
| Chloride                         |       | 10.0   | mg/L  | 1.0  | 100  | 90        | 110        |     |          |                                   |
| Sulfate                          |       | 40.0   | mg/L  | 1.0  | 100  | 90        | 110        |     |          |                                   |
| <b>Lab ID: CCV-160226-4</b>      | 2     | Continuing Calibration Verification Standard |       |      |      |           |            |     |          | 02/27/16 02:54                    |
| Chloride                         |       | 10.6   | mg/L  | 1.0  | 106  | 90        | 110        |     |          |                                   |
| Sulfate                          |       | 41.7   | mg/L  | 1.0  | 104  | 90        | 110        |     |          |                                   |
| <b>Method: E300.0</b>            |       |  |       |      |      |           |            |     |          | Batch: R209415                    |
| <b>Lab ID: ICB</b>               | 2     | Method Blank                                 |       |      |      |           |            |     |          | Run: IC2-C_160226A 02/26/16 13:18 |
| Chloride                         |       | ND   | mg/L  | 0.01 |      |           |            |     |          |                                   |
| Sulfate                          |       | ND   | mg/L  | 0.03 |      |           |            |     |          |                                   |
| <b>Lab ID: LFB-160226-1</b>      | 2     | Laboratory Fortified Blank                   |       |      |      |           |            |     |          | Run: IC2-C_160226A 02/26/16 13:37 |
| Chloride                         |       | 10.6   | mg/L  | 1.0  | 106  | 90        | 110        |     |          |                                   |
| Sulfate                          |       | 42.6   | mg/L  | 1.0  | 106  | 90        | 110        |     |          |                                   |
| <b>Lab ID: C16020713-003AMS</b>  | 2     | Sample Matrix Spike                          |       |      |      |           |            |     |          | Run: IC2-C_160226A 02/27/16 03:50 |
| Chloride                         |       | 10.5   | mg/L  | 1.0  | 102  | 90        | 110        |     |          |                                   |
| Sulfate                          |       | 40.7   | mg/L  | 1.0  | 102  | 90        | 110        |     |          |                                   |
| <b>Lab ID: C16020713-003AMSD</b> | 2     | Sample Matrix Spike Duplicate                |       |      |      |           |            |     |          | Run: IC2-C_160226A 02/27/16 04:08 |
| Chloride                         |       | 10.6   | mg/L  | 1.0  | 103  | 90        | 110        | 0.2 | 20       |                                   |
| Sulfate                          |       | 40.7   | mg/L  | 1.0  | 102  | 90        | 110        | 0.0 | 20       |                                   |
| <b>Lab ID: LFB-160226-2</b>      | 2     | Laboratory Fortified Blank                   |       |      |      |           |            |     |          | Run: IC2-C_160226A 02/27/16 07:52 |
| Chloride                         |       | 10.3   | mg/L  | 1.0  | 103  | 90        | 110        |     |          |                                   |
| Sulfate                          |       | 40.7   | mg/L  | 1.0  | 102  | 90        | 110        |     |          |                                   |
| <b>Lab ID: C16020727-001AMS</b>  | 2     | Sample Matrix Spike                          |       |      |      |           |            |     |          | Run: IC2-C_160226A 02/27/16 08:48 |
| Chloride                         |       | 16.3   | mg/L  | 1.0  | 106  | 90        | 110        |     |          |                                   |
| Sulfate                          |       | 55.4   | mg/L  | 1.0  | 105  | 90        | 110        |     |          |                                   |
| <b>Lab ID: C16020727-001AMSD</b> | 2     | Sample Matrix Spike Duplicate                |       |      |      |           |            |     |          | Run: IC2-C_160226A 02/27/16 09:06 |
| Chloride                         |       | 16.4   | mg/L  | 1.0  | 107  | 90        | 110        | 0.5 | 20       |                                   |
| Sulfate                          |       | 55.8   | mg/L  | 1.0  | 106  | 90        | 110        | 0.7 | 20       |                                   |

### Qualifiers:

RL - Analyte reporting limit.

ND - Not detected at the reporting limit.

MDC - Minimum detectable concentration





Trust our People. Trust our Data.  
www.energylab.com

Billings, MT 800.735.4489 • Casper, WY 888.235.0515  
College Station, TX 888.690.2218 • Gillette, WY 866.686.7175 • Helena, MT 877.472.0711

## QA/QC Summary Report

Prepared by Casper, WY Branch

**Client:** UR Energy USA Inc  
**Project:** Lost Creek Waste Water

**Report Date:** 03/11/16  
**Work Order:** C16020722

| Analyte                          | Count                               | Result | Units | RL                  | %REC | Low Limit | High Limit | RPD | RPDLimit | Qual              |
|----------------------------------|-------------------------------------|--------|-------|---------------------|------|-----------|------------|-----|----------|-------------------|
| <b>Method:</b> E903.0            |                                     |        |       |                     |      |           |            |     |          | Batch: RA226-8022 |
| <b>Lab ID:</b> LCS-RA226-8022    | Laboratory Control Sample           |        |       | Run: G5000W_160303A |      |           |            |     |          | 03/10/16 11:46    |
| Radium 226                       |                                     | 9.7    | pCi/L |                     | 93   | 80        | 120        |     |          |                   |
| <b>Lab ID:</b> LCS-RA226-8022DUP | Laboratory Control Sample Duplicate |        |       | Run: G5000W_160303A |      |           |            |     |          | 03/10/16 11:46    |
| Radium 226                       |                                     | 9.4    | pCi/L |                     | 90   | 80        | 120        | 3.1 | 20       |                   |
| <b>Lab ID:</b> MB-RA226-8022     | 3 Method Blank                      |        |       | Run: G5000W_160303A |      |           |            |     |          | 03/10/16 11:46    |
| Radium 226                       |                                     | 0.2    | pCi/L |                     |      |           |            |     |          |                   |
| Radium 226 precision ( $\pm$ )   |                                     | 0.1    | pCi/L |                     |      |           |            |     |          |                   |
| Radium 226 MDC                   |                                     | 0.2    | pCi/L |                     |      |           |            |     |          |                   |

### Qualifiers:

RL - Analyte reporting limit.

ND - Not detected at the reporting limit.

MDC - Minimum detectable concentration



## Work Order Receipt Checklist

UR Energy USA Inc

C16020722

Login completed by: Ralph Stanley

Date Received: 2/26/2016

Reviewed by: Dave Blaida

Received by: dcq

Reviewed Date: 2/26/2016

Carrier name: Hand Del

|   |   |                             |  |
|---|---|-----------------------------|--|
| Shipping container/cooler in good condition?  | Yes <input checked="" type="checkbox"/> | No <input type="checkbox"/> | Not Present <input type="checkbox"/>               |
| Custody seals intact on all shipping container(s)/cooler(s)?  | Yes <input type="checkbox"/>            | No <input type="checkbox"/> | Not Present <input checked="" type="checkbox"/>    |
| Custody seals intact on all sample bottles?   | Yes <input type="checkbox"/>            | No <input type="checkbox"/> | Not Present <input checked="" type="checkbox"/>    |
| Chain of custody present?   | Yes <input checked="" type="checkbox"/> | No <input type="checkbox"/> |  |
| Chain of custody signed when relinquished and received?   | Yes <input checked="" type="checkbox"/> | No <input type="checkbox"/> |  |
| Chain of custody agrees with sample labels?   | Yes <input checked="" type="checkbox"/> | No <input type="checkbox"/> |  |
| Samples in proper container/bottle?   | Yes <input checked="" type="checkbox"/> | No <input type="checkbox"/> |  |
| Sample containers intact?   | Yes <input checked="" type="checkbox"/> | No <input type="checkbox"/> |  |
| Sufficient sample volume for indicated test?  | Yes <input checked="" type="checkbox"/> | No <input type="checkbox"/> |  |
| All samples received within holding time?<br>(Exclude analyses that are considered field parameters<br>such as pH, DO, Res Cl, Sulfite, Ferrous Iron, etc.) | Yes <input checked="" type="checkbox"/> | No <input type="checkbox"/> |  |
| Temp Blank received in all shipping container(s)/cooler(s)?   | Yes <input type="checkbox"/>            | No <input type="checkbox"/> | Not Applicable <input checked="" type="checkbox"/> |
| Container/Temp Blank temperature:   | 9.6°C On Ice                            |                             |  |
| Water - VOA vials have zero headspace?  | Yes <input type="checkbox"/>            | No <input type="checkbox"/> | Not Applicable <input checked="" type="checkbox"/> |
| Water - pH acceptable upon receipt?   | Yes <input type="checkbox"/>            | No <input type="checkbox"/> | Not Applicable <input checked="" type="checkbox"/> |

---

### Standard Reporting Procedures:

Lab measurement of analytes considered field parameters that require analysis within 15 minutes of sampling such as pH, Dissolved Oxygen and Residual Chlorine, are qualified as being analyzed outside of recommended holding time.

Solid/soil samples are reported on a wet weight basis (as received) unless specifically indicated. If moisture corrected, data units are typically noted as –dry. For agricultural and mining soil parameters/characteristics, all samples are dried and ground prior to sample analysis.

---

### Contact and Corrective Action Comments:

None



# Chain of Custody and Analytical Request Record

Page 1 of 1

PLEASE PRINT (Provide as much information as possible.)

|  |  |                                   |   |
|--|--|-----------------------------------|---|
| Company Name:<br><b>UR - ENERGY</b>          | Project Name, PWS, Permit, Etc.<br><b>LAST CREEK WASTE WATER</b> | Sample Origin<br>State: <b>NY</b> | EPA/State Compliance:<br>Yes <input type="checkbox"/> No <input type="checkbox"/> |
| Report Mail Address (Required):              | Contact Name:<br><b>MIKE GATNER</b>                              | Cell:<br><b>(907) 265-2373</b>    | Sampler: (Please Print)<br><b>ME</b>  |
| <input type="checkbox"/> No Hard Copy Email: | Invoice Contact & Phone:<br><b>MIKE GATNER (907) 265-2373</b>    | Purchase Order:                   | Quote/Bottle Order:   |

|  |  |  |  |                               |
|--|--|--|--|-------------------------------|
| Invoice Address (Required):  | ANALYSIS REQUESTED<br>SEE ATTACHED<br>RA-220<br>AS, SE, V, U (GND)<br>TDS<br>SPECIFIC CONDUCTIVITY<br>HYDROLYZABLE NITROGEN<br>SUPTN<br>CHLORIDE<br>BICARB/CARB<br>PH/CONDUCTIVITY | Standard Turnaround (TAT)<br><b>↑ R U S H</b>  | Contact ELI prior to RUSH sample submittal for charges and scheduling - See instruction Page | Comments:                     |
| <input type="checkbox"/> No Hard Copy Email:   | Number of Containers<br>Sample Type: A W S V B O DW<br>Air Water Soils/Solids<br>Vegetation Bioassay Other<br>DW - Drinking Water  | MATRIX<br><b>W</b>   | Shipped by:<br><b>Handel</b>   | Cooler ID(s):<br><b>350</b>   |
| Special Report/Formats:<br><input type="checkbox"/> DW<br><input type="checkbox"/> POTW/MWTP<br><input type="checkbox"/> State:<br><input type="checkbox"/> Other: | <input type="checkbox"/> EDD/EDT (Electronic Data)<br>Format:<br><input type="checkbox"/> LEVEL IV<br><input type="checkbox"/> NELAC   | Collection Date<br><b>2/25/2016</b>  | Collection Time<br><b>0815</b>   | Receipt Temp<br><b>9.4 °C</b> |
| SAMPLE IDENTIFICATION (Name, Location, Interval, etc.)<br><b>DW - INDIAN</b>   |  | On Ice: <input checked="" type="checkbox"/> Y <input type="checkbox"/> N                   |  |                               |
|  |  | Custody Seal<br>On Bottle <input checked="" type="checkbox"/> Y <input type="checkbox"/> N |  |                               |
|  |  | On Cooler <input type="checkbox"/> Y <input type="checkbox"/> N                            |  |                               |
|  |  | Intact <input type="checkbox"/> Y <input type="checkbox"/> N                               |  |                               |
|  |  | Signature Match <input type="checkbox"/> Y <input type="checkbox"/> N                      |  |                               |
|  |  | LABORATORY USE ONLY<br><b>C1602722</b>   |  |                               |

|                               |   |                                     |   |
|-------------------------------|---|-------------------------------------|---|
| Custody Record MUST be Signed | Reinquisitioned by (print):<br><b>M. GATNER</b> | Date/Time:<br><b>2/25/2016 1620</b> | Signature:<br><i>[Signature]</i>                      |
|                               | Requisitioned by (print):                       | Date/Time:                          | Signature:  |
| Sample Disposal:              | Return to Client:                               | Date/Time:                          | Signature:  |
|                               |   |                                     | Received by Laboratory:<br><b>2/25/16 Mike Gatner</b> |

In certain circumstances, samples submitted to Energy Laboratories, Inc. may be subcontracted to other certified laboratories in order to complete the analysis requested.



Trust our People. Trust our Data.  
www.energylab.com

Billings, MT 800.735.4489 • Casper, WY 888.235.0515  
College Station, TX 888.690.2216 • Gillette, WY 866.686.7175 • Helena, MT 877.472.0711

## BOTTLE ORDER 48226



### SHIPPED TO: UR Energy USA Inc

Contact: Mike Gaither

5880 Enterprise Dr Ste 200

Casper WY 82609-

Phone: (303) 265-2373

Project: Lost Creek Waste Water

Order Created by: Corinne Wagner

Shipped From: Casper, WY

Ship Date: 1/9/2016

VIA: PickUp

| Bottle Size/Type | Bottles Per Samp | Method          | Tests  | Critical Hold Time | Preservative                             | Notes               | Num of Samp |
|------------------|------------------|-----------------|--|--------------------|--|---------------------|-------------|
| 1 Liter Plastic  | 1                | A2540 C         | Solids, Total Dissolved<br>Gravimetric Tests |                    |  | ALK = HCO3 & CO3    | 1           |
|                  |                  | Gravimetri<br>c |  |                    |  |                     |             |
|                  |                  | E300.0          | E300.0 Anions                                |                    |  |                     |             |
|                  |                  | A2320 B         | Alkalinity                                   |                    |  |                     |             |
|                  |                  | A2510 B         | Conductivity                                 |                    |  |                     |             |
|                  |                  | A4500-H B       | pH   | 0.25<br>hrs        |  |                     |             |
| 250 mL Plastic   | 1                | A4500-S F       | Sulfide, Iodine Titrimetric                  |                    | <input checked="" type="checkbox"/> ZnAc | Zero Headspace      | 1           |
|                  |                  | A4500-S F       | Sulfide, Iodine Titrimetric                  |                    | <input checked="" type="checkbox"/> NaOH |                     |             |
| 250 mL Plastic   | 1                | E200.7_8        | Metals by ICP/CPMS, Total                    |                    | <input checked="" type="checkbox"/> HNO3 | Total As, Se, V & U | 1           |
| 2 Liter Plastic  | 2                | E903.0          | Radium 226, Total                            |                    | <input checked="" type="checkbox"/> HNO3 |                     | 1           |

We strongly suggest that the samples are shipped the same day as they are collected.

☒ HNO3 - Nitric Acid ☐ H2SO4 - Sulfuric Acid ☒ NaOH - Sodium Hydroxide  
☒ ZnAc - Zinc Acetate ☒ HCl - Hydrochloric Acid ☐ H3PO4 - Phosphoric Acid  
Acid

Material Safety Data Sheets(MSDS) Available @ EnergyLab.com ->Services -> MSDS Sheets