

# APR1400 Instrumentation & Controls Design (Man-Machine Interface System)

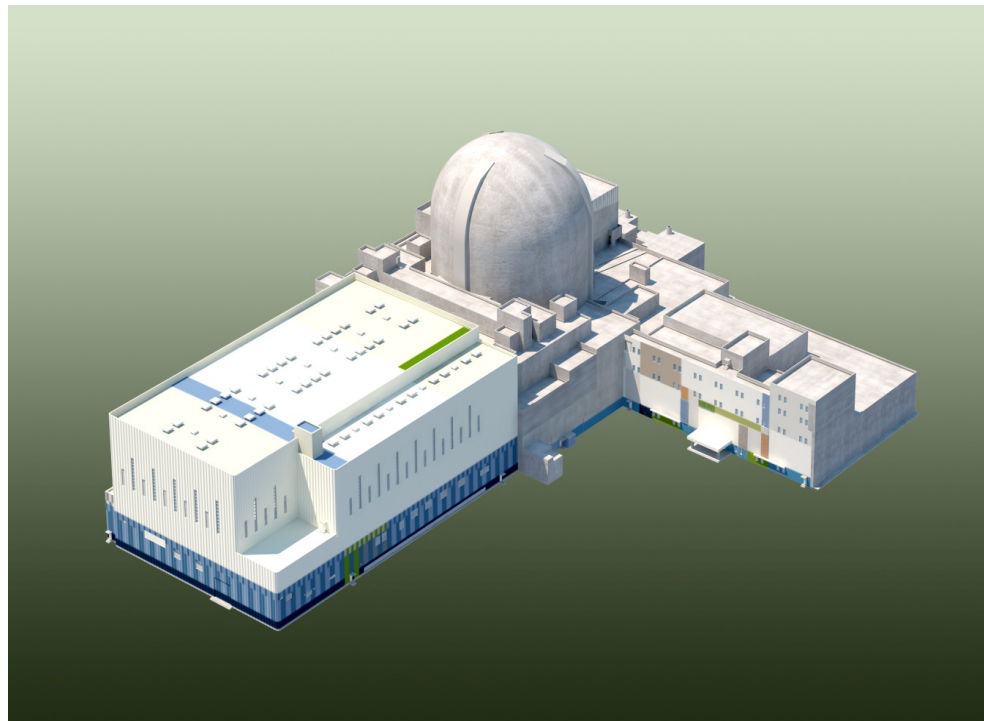

**KEPCO/KHNP**  
**April 20~21 2016**

# Contents

---

- Human-System Interface design process
- APR1400 Basic HSI
  - APR1400 Main Control Room
  - Large Display Panel
  - Safety Console
  - Operator Console
    - System Display
    - Soft Control
    - Alarm Display
    - Computer-Based Procedure Display
- Summary

# Human-System Interface(HSI) design process

- The APR1400 Basic HSI is derived from the Basic HSI of the APR1400 predecessor design, Shin Kori Nuclear power plant units 3 and 4.
- APR1400 Basic HSI is applied to development of APR1400 HSI system and HSI facilities.

TS

# APR1400 Main Control Room (MCR)

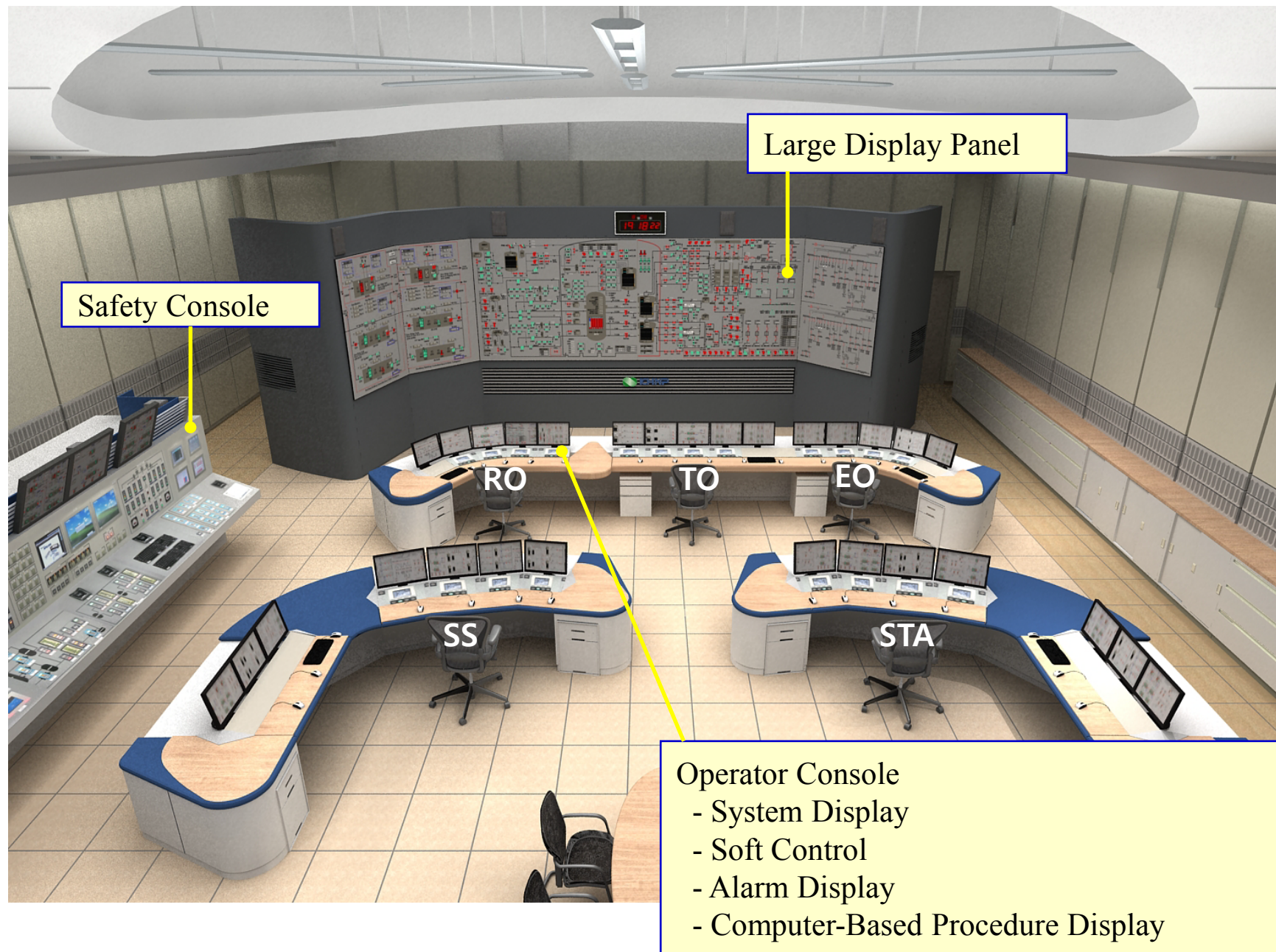

# Large Display Panel (LDP)

---

TS

ACRS Meeting (Apr.20-21, 2016)

# Safety Console



TS

ACRS Meeting (Apr.20-21, 2016)

# Operator Console

TS

ACRS Meeting (Apr.20-21, 2016)

# System Displays

TS

ACRS Meeting (Apr.20-21, 2016)

# Soft Control

---

TS

ACRS Meeting (Apr.20-21, 2016)

# Alarm Displays

TS

ACRS Meeting (Apr.20-21, 2016)

# Computer-Based Procedure Displays

TS

ACRS Meeting (Apr.20-21, 2016)

# Summary

- The HSI design process and major HSI system are introduced.
- The APR1400 Basic HSI is derived from the HSI design of the SKN 3 which is successfully developed and verified.
  - Operating license of SKN 3 was issued on October 2015 and SKN 3 was connected to the grid on January 2016.
- The detail HSI design of SKN 3 can be referred to COL applicant who will develop detail HSI design of APR1400.

