

WLS
COL 2.4-4

LEGEND:

- MW-1216 ● MONITORING WELL
- MW-1209 ● GROUNDWATER SAMPLING LOCATION

GROUNDWATER FLOW DIRECTION →

CONTOUR INTERVAL = 5 FT.
WATER LEVEL ELEVATIONS IN FT. MSL

DATA COLLECTED: 04-18-2006

**WILLIAM STATES LEE III
NUCLEAR STATION UNITS 1 & 2**

Potentiometric Surface Map
April 2006

FIGURE 2.4.12-204
(Sheet 1 of 8)

Rev 1

Datum: GCS North American 1983
Projection: NAD 1983 UTM Zone 17N

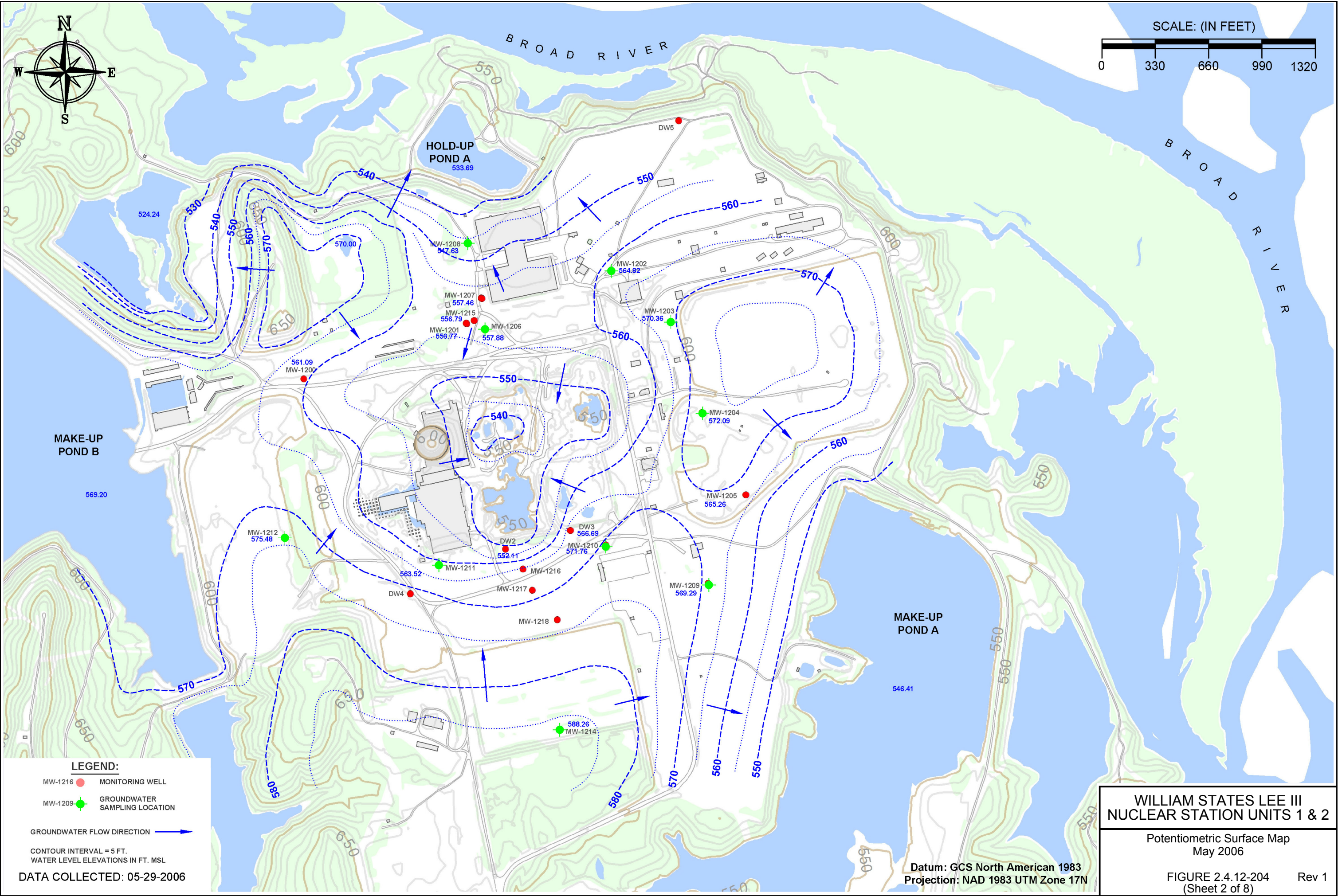

WLS
COL 2.4-4

LEGEND:

MW-1216 ● MONITORING WELL

MW-1209 ● GROUNDWATER
SAMPLING LOCATION

GROUNDWATER FLOW DIRECTION →

CONTOUR INTERVAL = 5 FT.
WATER LEVEL ELEVATIONS IN FT. MSL

DATA COLLECTED: 05-29-2006

**WILLIAM STATES LEE III
NUCLEAR STATION UNITS 1 & 2**

Potentiometric Surface Map
May 2006

FIGURE 2.4.12-204
(Sheet 2 of 8)

Rev 1

Datum: GCS North American 1983
Projection: NAD 1983 UTM Zone 17N

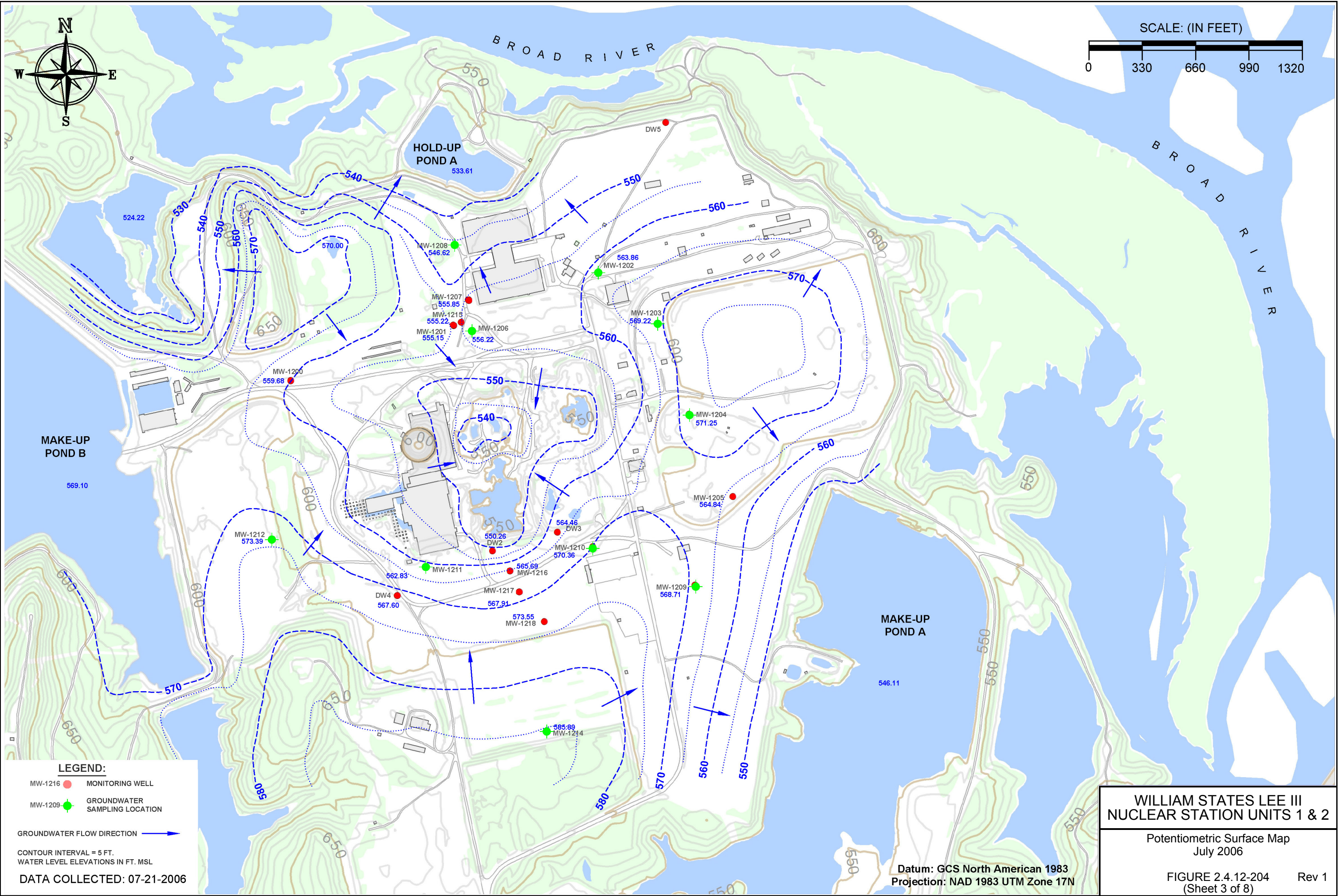

WLS
COL 2.4-4

LEGEND:

MW-1216 ● MONITORING WELL

MW-1209 ● GROUNDWATER
SAMPLING LOCATION

GROUNDWATER FLOW DIRECTION →

CONTOUR INTERVAL = 5 FT.
WATER LEVEL ELEVATIONS IN FT. MSL

DATA COLLECTED: 07-21-2006

**WILLIAM STATES LEE III
NUCLEAR STATION UNITS 1 & 2**

Potentiometric Surface Map
July 2006

FIGURE 2.4.12-204
(Sheet 3 of 8)

Rev 1

Datum: GCS North American 1983
Projection: NAD 1983 UTM Zone 17N

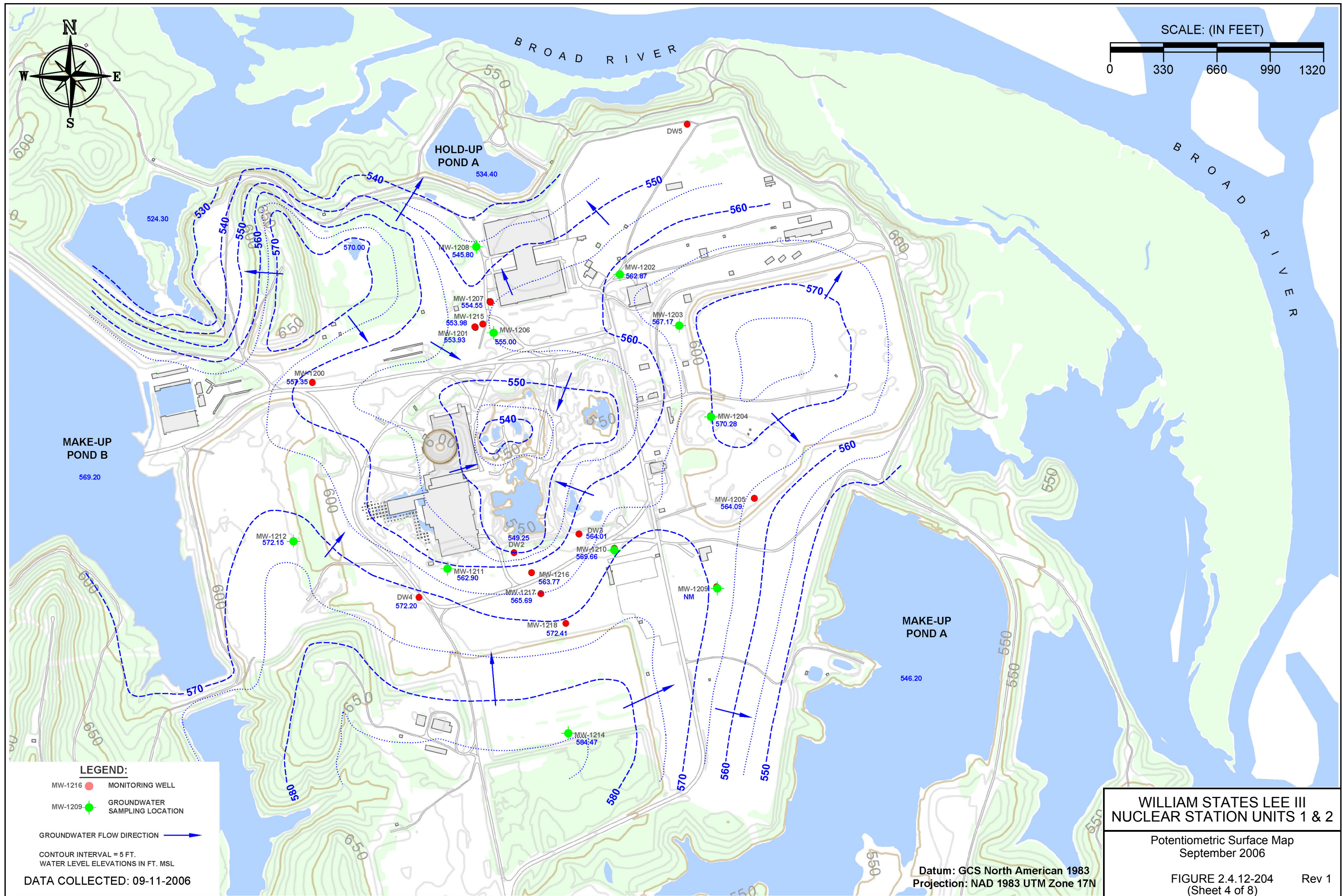

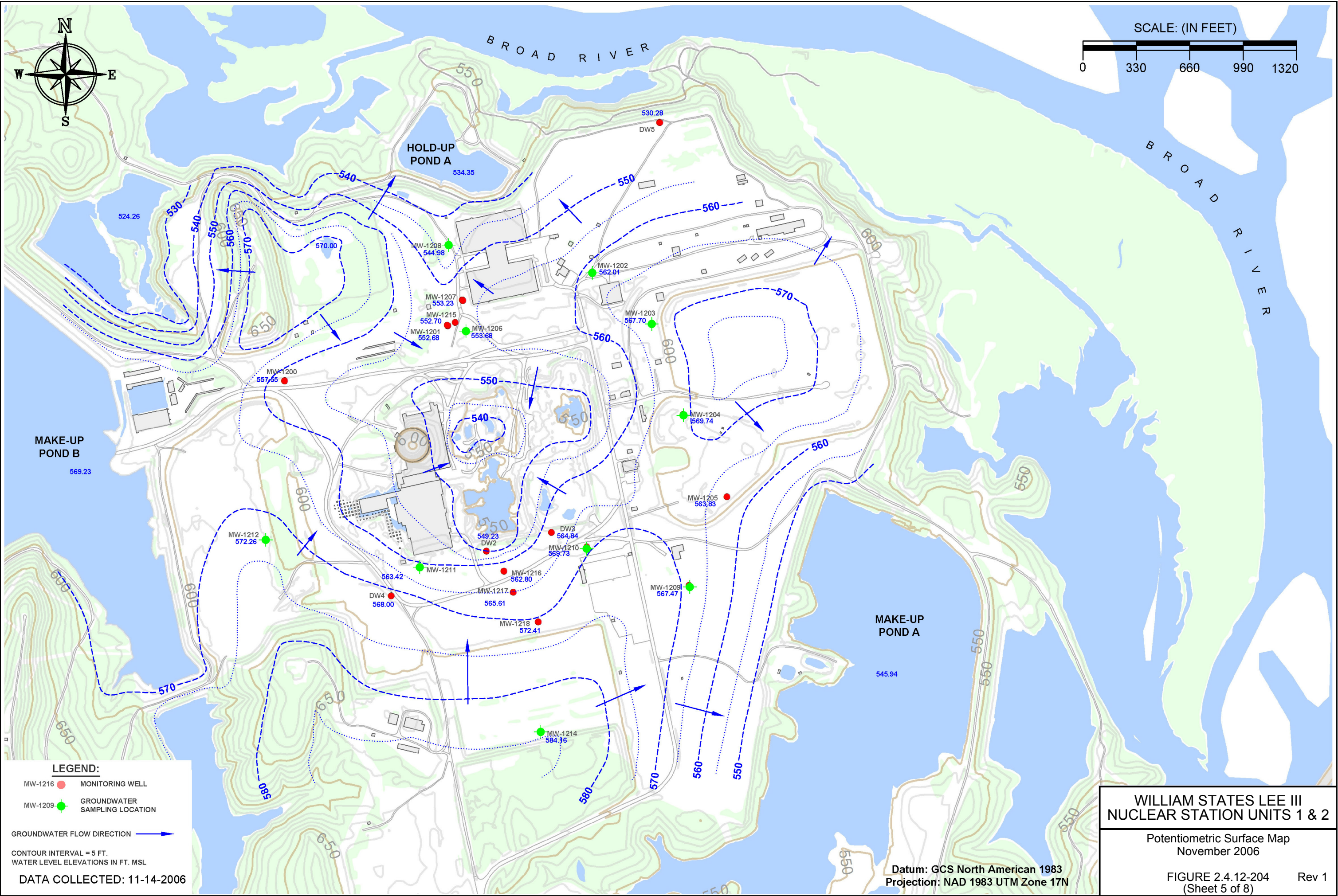

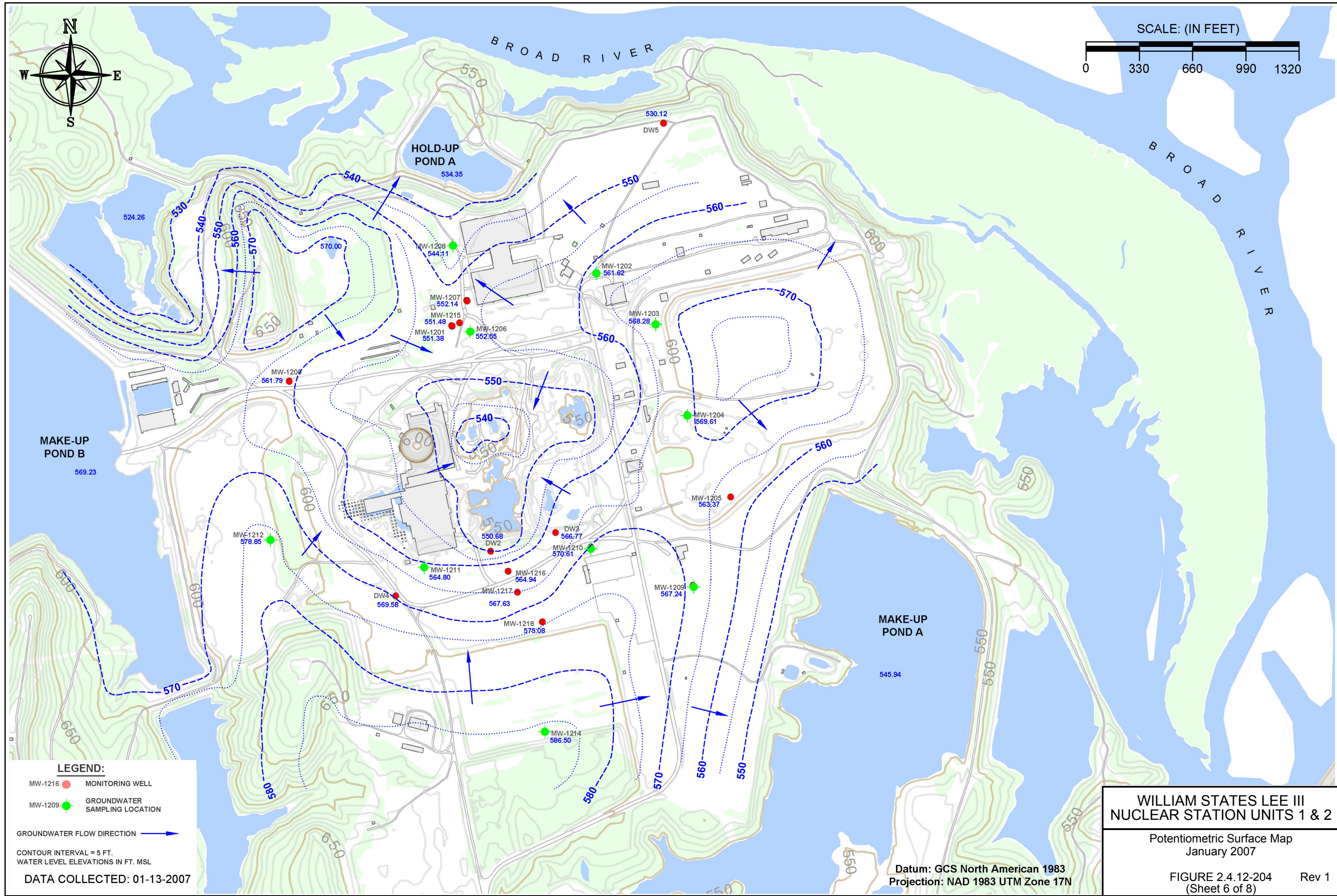

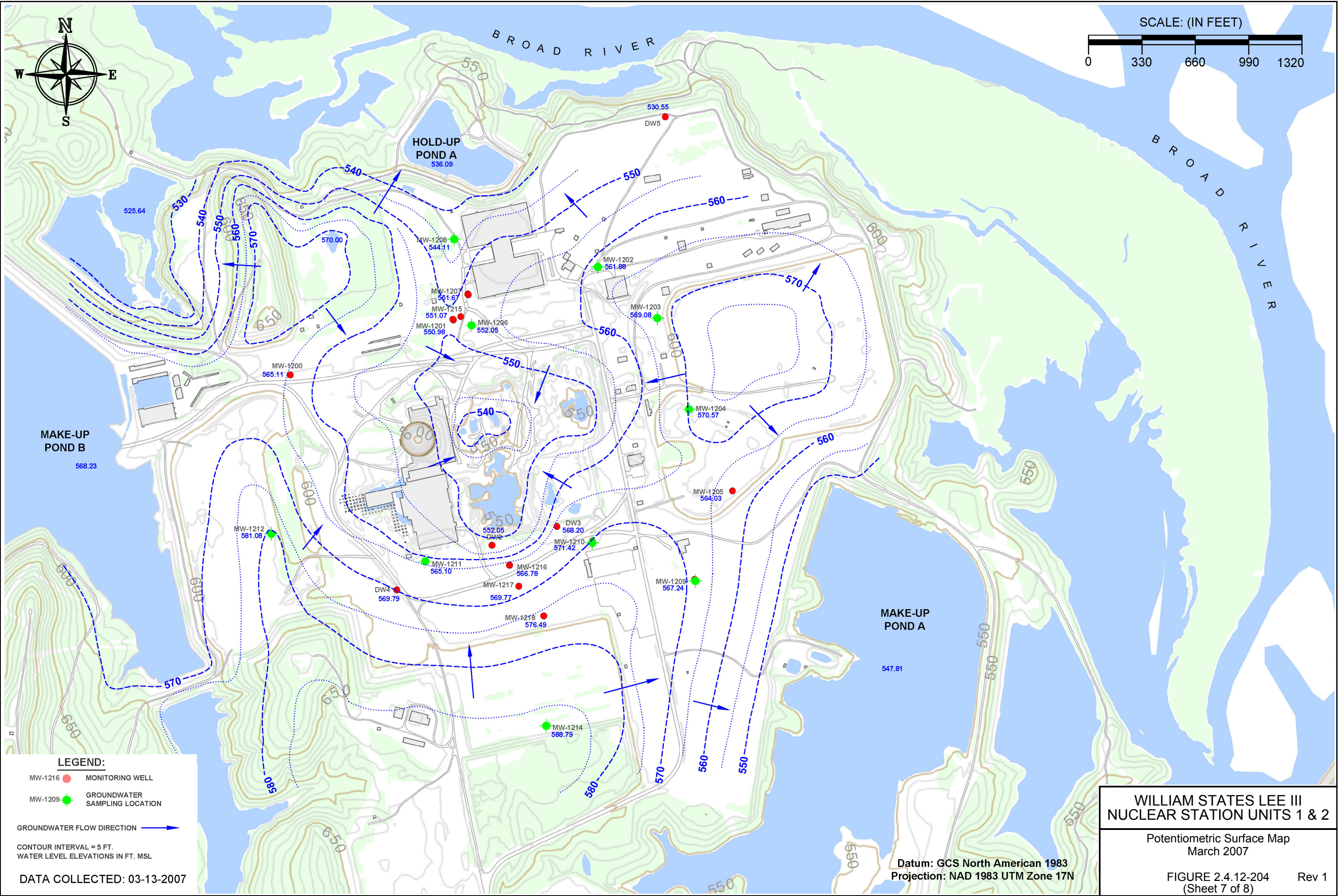

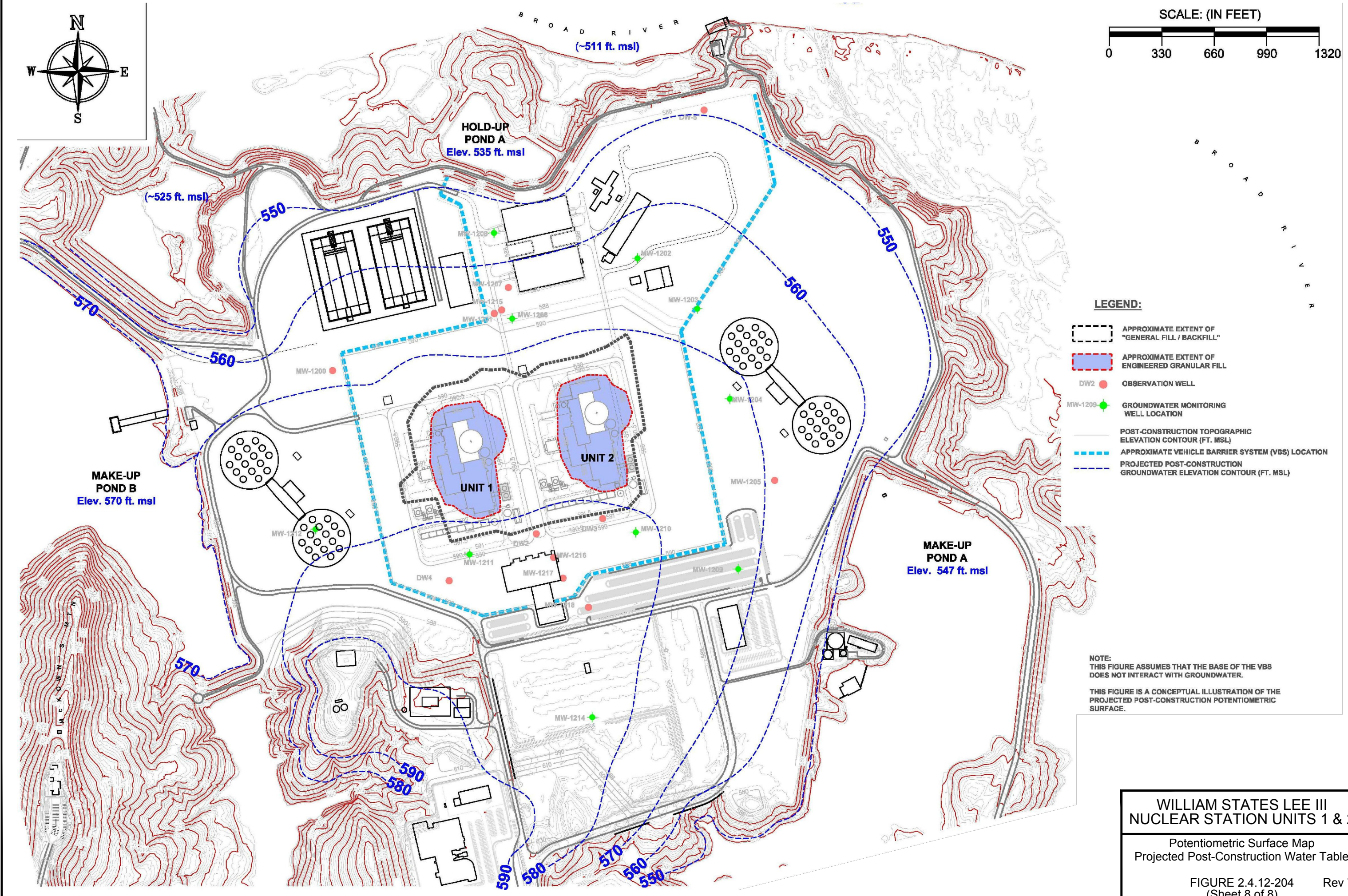
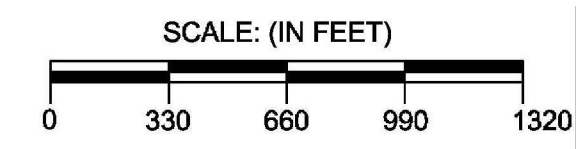
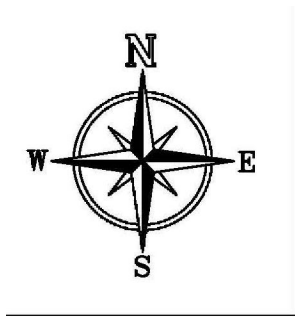

- LEGEND:**
- APPROXIMATE EXTENT OF "GENERAL FILL / BACKFILL"
 - APPROXIMATE EXTENT OF ENGINEERED GRANULAR FILL
 - DW2 OBSERVATION WELL
 - MW-1209 GROUNDWATER MONITORING WELL LOCATION
 - POST-CONSTRUCTION TOPOGRAPHIC ELEVATION CONTOUR (FT. MSL)
 - APPROXIMATE VEHICLE BARRIER SYSTEM (VBS) LOCATION
 - PROJECTED POST-CONSTRUCTION GROUNDWATER ELEVATION CONTOUR (FT. MSL)

NOTE:
THIS FIGURE ASSUMES THAT THE BASE OF THE VBS DOES NOT INTERACT WITH GROUNDWATER.
THIS FIGURE IS A CONCEPTUAL ILLUSTRATION OF THE PROJECTED POST-CONSTRUCTION POTENTIOMETRIC SURFACE.

**WILLIAM STATES LEE III
NUCLEAR STATION UNITS 1 & 2**

Potentiometric Surface Map
Projected Post-Construction Water Table