

March 2nd, 2016

Nuclear Regulatory Commission
Medical Licensing Division, Region III
2443 Warrenville Road
Lisle, IL 60532-4351

Dear Madam/Sir,

Please amend Radioactive Materials License #24-02704-01 (Prime Healthcare Services-Kansas City d.b.a. St. Joseph Medical Center; 1000 Carondelet Drive; Kansas City, MO. 64114) to include the following changes;

- A. On February 29th 2016, the following events occurred at the St. Joseph Medical Center-Nuclear Cardiology Department-Suite 200 Location (930 Carondelet Drive-Suite 200):
1. All Restricted Areas of Use located in this department were decommissioned in accordance with the regulatory requirements. These areas included the Room #104-Imaging Room 1, Room #106-Imaging Room 2, Room #129-Treadmill/Stress Room and Room #136-Hot Lab. The decommissioning test results are enclosed for your review. The results include the following:
 - A. Decommissioning grids,
 - B. MicroR survey test results,
 - C. Wipe test results,
 - D. Suite 200 Floor Plans.
 2. All radioactive sources from St. Joseph Medical Center-Nuclear Cardiology Department-Suite 200 Location (930 Carondelet Drive-Suite 200) were transferred to the Main Nuclear Medicine Department. These sealed sources were placed in a D.O.T. approved container and transported by a Nuclear Medicine Technologist who is approved to handle these radioactive sealed sources. No shipping papers were required for the transfer of these sources since the Nuclear Medicine Department is listed as an Area of Use on the same Radioactive Materials License.

RECEIVED MAR 22 2016

3. All Waste Disposal Containers were monitored to assure each container was at or below Background Levels prior to being disposed of into Bio-Hazard Waste. Containers that were disposed of included Decay-In-Storage and currently In-Use containers. All monitoring results were entered into the Syntrac prior to disposal. There were no waste containers that were transported to Nuclear Medicine.
4. Upon completion of the decommissioning, the following steps were completed;
 - a. The "Caution Radioactive Materials" signs will be removed from this area.
 - b. The Notice to Employees will be removed from this area.
 - c. The Emergency Procedures will be removed from this area.
 - d. The Radiation Safe Handling Procedures will be removed from this area.
5. Upon the review and approval of these decommissioning results by your office, we are requesting that the Restricted Areas of Use be removed from our license and released to the facility for General Public use.
However, the final release of these areas will only occur once we have received written confirmation that the decommissioning results have been accepted and this area has been released from our Radioactive Materials License.

Your attention in this matter is greatly appreciated. Should you have any additional questions, please contact our health physicist, Subby Anzalone, at 402-290-2391 or sebastiano.anzalone@cardinalhealth.com.

Sincerely,

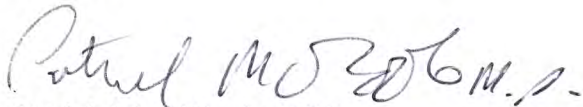

Patrick M. O'Toole, M.D.
Radiation Safety Officer

Prime Healthcare Services, LLC
dba St. Joseph Medical Center
1000 Carondelet Drive - Suite 200
Kansas City, MO 64114
NRC Lic. No.: 24-02704-01

RESTRICTED AREAS FOR SUITE 200

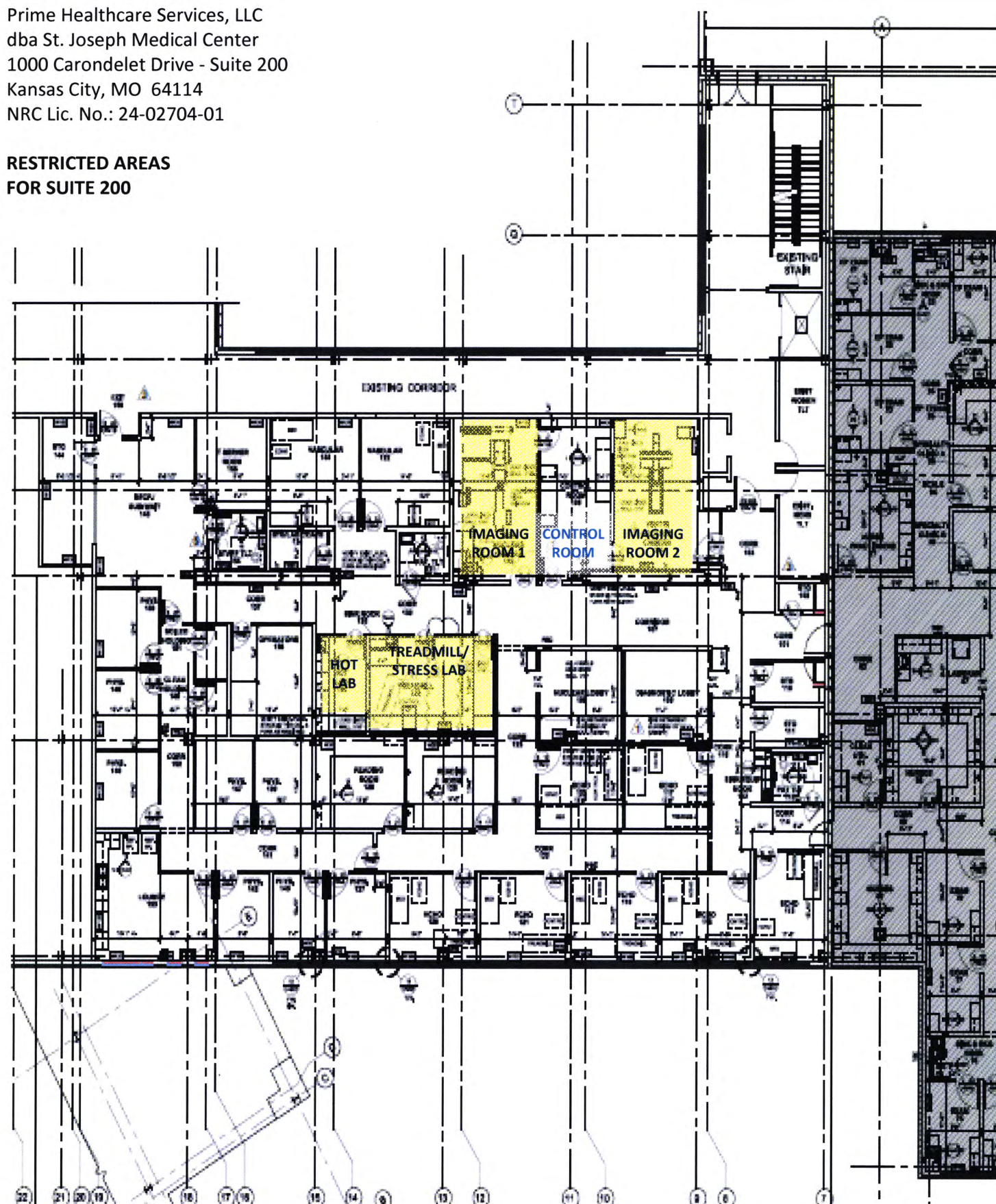

Close-out Area Surveys

Date: February 29, 2016
Licensee: Prime Healthcare Services, LLC dba St. Joseph Medical Center
Instrument Model: Ludlum Model 19 (Micro R Meter) **Serial Number:** 169637 **Calibration date:** June 17, 2015
Location: 1000 Carondelet Drive - Suite 200 - HOT LAB AND TREADMILL / STRESS ROOM

<u>Location</u>	<u>Results</u>
1. Background	10-14 μ R
2. Hot Lab Floor	10-14 μ R
3. Hot Lab Floor	10-14 μ R
4. Hot Lab Floor	10-14 μ R
5. Hot Lab Floor	10-14 μ R
6. Hot Lab Floor	10-14 μ R
7. Hot Lab Floor	10-14 μ R
8. Hot Lab Floor	10-14 μ R
9. Hot Lab Floor	10-14 μ R
10. Hot Lab Counter Top	10-14 μ R
11. Hot Lab Counter Top	10-14 μ R
12. Hot Lab Counter Top	10-14 μ R
13. Hot Lab Counter Top	10-14 μ R
14. Well Counter	10-14 μ R
15. Dose Calibrator	10-14 μ R
16. L-Block	10-14 μ R
17. Waste Container	10-14 μ R
18. Syntrac Computer	10-14 μ R
19. Hot Lab Injection Chair	10-14 μ R
20. Hot Lab Door Handle	10-14 μ R
21. TM Room Floor	10-14 μ R
22. TM Room Floor	10-14 μ R
23. TM Room Floor	10-14 μ R
24. TM Room Floor	10-14 μ R
25. TM Room Floor	10-14 μ R
26. TM Room Floor	10-14 μ R
27. TM Room Floor	10-14 μ R

<u>Location</u>	<u>Results</u>
28. TM Room Floor	10-14 μ R
29. TM Room Floor	10-14 μ R
30. TM Room Floor	10-14 μ R
31. TM Room Floor	10-14 μ R
32. TM Room Floor	10-14 μ R
33. TM Room Floor	10-14 μ R
34. TM Room Floor	10-14 μ R
35. TM Room Floor	10-14 μ R
36. TM Room Floor	10-14 μ R
37. TM Room Floor	10-14 μ R
38. TM Room Floor	10-14 μ R
39. TM Room Floor	10-14 μ R
40. TM Room Floor	10-14 μ R
41. TM Room Floor	10-14 μ R
42. TM Room Floor	10-14 μ R
43. TM Room Floor	10-14 μ R
44. TM Room Floor	10-14 μ R
45. TM Room Counter Top	10-14 μ R
46. TM Room Counter Top	10-14 μ R
47. TM Room Counter Top	10-14 μ R
48. Treadmill	10-14 μ R
49. EKG Computer/Stand	10-14 μ R
50. Stress Chair	10-14 μ R
51. TM Room Door Knob 1	10-14 μ R
52. TM Room Door Knob 2	10-14 μ R

Results: The above area surveys were acquired of the assigned areas with a micro R meter. None of the areas exceeded the room background reading of 10-14 μ R.

Completed by:

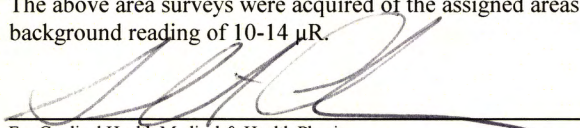
 For Cardinal Health Medical & Health Physics
 Registry #50

Close-out Wipe Tests

Date: February 29, 2016
Licensee: Prime Healthcare Services, LLC dba St. Joseph Medical Center
Instrument: Cobra II Auto Gamma **Serial Number:** 400692
Location: 1000 Carondelet Drive - Suite 200 - HOT LAB AND TREADMILL / STRESS ROOM

Location	Results
1. Background	< 200 dpm / 100 cm ²
2. Hot Lab Floor	< 200 dpm / 100 cm ²
3. Hot Lab Floor	< 200 dpm / 100 cm ²
4. Hot Lab Floor	< 200 dpm / 100 cm ²
5. Hot Lab Floor	< 200 dpm / 100 cm ²
6. Hot Lab Floor	< 200 dpm / 100 cm ²
7. Hot Lab Floor	< 200 dpm / 100 cm ²
8. Hot Lab Floor	< 200 dpm / 100 cm ²
9. Hot Lab Floor	< 200 dpm / 100 cm ²
10. Hot Lab Counter Top	< 200 dpm / 100 cm ²
11. Hot Lab Counter Top	< 200 dpm / 100 cm ²
12. Hot Lab Counter Top	< 200 dpm / 100 cm ²
13. Hot Lab Counter Top	< 200 dpm / 100 cm ²
14. Well Counter	< 200 dpm / 100 cm ²
15. Dose Calibrator	< 200 dpm / 100 cm ²
16. L-Block	< 200 dpm / 100 cm ²
17. Waste Container	< 200 dpm / 100 cm ²
18. Syntrac Computer	< 200 dpm / 100 cm ²
19. Hot Lab Injection Chair	< 200 dpm / 100 cm ²
20. Hot Lab Door Handle	< 200 dpm / 100 cm ²
21. TM Room Floor	< 200 dpm / 100 cm ²
22. TM Room Floor	< 200 dpm / 100 cm ²
23. TM Room Floor	< 200 dpm / 100 cm ²
24. TM Room Floor	< 200 dpm / 100 cm ²
25. TM Room Floor	< 200 dpm / 100 cm ²
26. TM Room Floor	< 200 dpm / 100 cm ²
27. TM Room Floor	< 200 dpm / 100 cm ²

Location	Results
28. TM Room Floor	< 200 dpm / 100 cm ²
29. TM Room Floor	< 200 dpm / 100 cm ²
30. TM Room Floor	< 200 dpm / 100 cm ²
31. TM Room Floor	< 200 dpm / 100 cm ²
32. TM Room Floor	< 200 dpm / 100 cm ²
33. TM Room Floor	< 200 dpm / 100 cm ²
34. TM Room Floor	< 200 dpm / 100 cm ²
35. TM Room Floor	< 200 dpm / 100 cm ²
36. TM Room Floor	< 200 dpm / 100 cm ²
37. TM Room Floor	< 200 dpm / 100 cm ²
38. TM Room Floor	< 200 dpm / 100 cm ²
39. TM Room Floor	< 200 dpm / 100 cm ²
40. TM Room Floor	< 200 dpm / 100 cm ²
41. TM Room Floor	< 200 dpm / 100 cm ²
42. TM Room Floor	< 200 dpm / 100 cm ²
43. TM Room Floor	< 200 dpm / 100 cm ²
44. TM Room Floor	< 200 dpm / 100 cm ²
45. TM Room Counter Top	< 200 dpm / 100 cm ²
46. TM Room Counter Top	< 200 dpm / 100 cm ²
47. TM Room Counter Top	< 200 dpm / 100 cm ²
48. Treadmill	< 200 dpm / 100 cm ²
49. EKG Computer/Stand	< 200 dpm / 100 cm ²
50. Stress Chair	< 200 dpm / 100 cm ²
51. TM Room Door Knob 1	< 200 dpm / 100 cm ²
52. TM Room Door Knob 2	< 200 dpm / 100 cm ²

Remarks: The above close-out wipe tests were acquired of the assigned areas. The sample areas consisted of a contiguous wipe from a 3' x 3' area or approximately 8361 cm². Please see the attached print-out that lists the cpm and dpm.

Completed by:

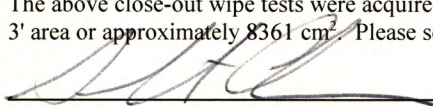
 For Cardinal Health Medical & Health Physics
 Registry #50

Tech ID: SA
 ST. JOSEPH MED CTR-CARDIOLOGY STE 200; KCMO
 Count Time(minutes): 1.00
 Assay Type: CPM
 Background Subtract : IPA Bkg
 Code: 1234
 Outlier: 5.0 FLAG
 Dilution Operator : \$
 %Spillup: 0.00
 %Spilldown: 0.00
 Screening: OFF

	Window A		Window B		Window C	
Nuclide:	Co-57	75 - 165 keV	MAN	562 - 762 keV	MAN	15 - 2000 keV
Bkg:	42.4		33.3		296	
Sigma:	0.00		0.00		0.00	
LCR:	0		0		0	
Half Life(hours):	0.00		0.00			
Multiplier:	2.0000					
%CV Flag Limit:	0.00		0.00			

S#	TIME	A:CPM	B:CPM	C:CPM	CCPM	PAT/ID
1	1.00	0	0	0	0	BACKGROUND
2	1.00	1	0	0	1	HOT LAB-FLOOR
3	1.00	0	2	47	0	HOT LAB-FLOOR
4	1.00	0	0	0	0	HOT LAB-FLOOR
5	1.00	0	9	0	0	HOT LAB-FLOOR
6	1.00	6	10	45	11	HOT LAB-FLOOR
7	1.00	0	5	0	0	HOT LAB-FLOOR
8	1.00	0	0	0	0	HOT LAB-FLOOR
9	1.00	0	0	0	0	HOT LAB-FLOOR
10	1.00	0	6	14	0	HOT LAB-COUNTER
11	1.00	0	0	15	0	HOT LAB-COUNTER
12	1.00	0	5	0	0	HOT LAB-COUNTER
13	1.00	4	0	10	7	HOT LAB-COUNTER
14	1.00	1	12	26	1	WELL COUNTER
15	1.00	6	0	9	11	DOSE CALIBRATOR
16	1.00	2	13	46	3	L-BLOCK
17	1.00	8	3	40	15	WASTE STORAGE CONTAINER
18	1.00	3	0	28	5	SYNTRAC COMPUTER
19	1.00	0	0	7	0	INJ. CHAIR
20	1.00	5	0	23	9	HOT LAB DOOR KNOB
21	1.00	0	2	0	0	TREADMILL RM-FLOOR
22	1.00	3	8	18	5	TREADMILL RM-FLOOR
23	1.00	0	0	4	0	TREADMILL RM-FLOOR
24	1.00	0	2	0	0	TREADMILL RM-FLOOR
25	1.00	0	0	0	0	TREADMILL RM-FLOOR
26	1.00	6	3	11	11	TREADMILL RM-FLOOR
27	1.00	0	0	41	0	TREADMILL RM-FLOOR
28	1.00	5	2	8	9	TREADMILL RM-FLOOR
29	1.00	4	0	0	7	TREADMILL RM-FLOOR
30	1.00	0	0	0	0	TREADMILL RM-FLOOR

S#	TIME	A:CPM	B:CPM	C:CPM	CCPM	PAT/ID
31	1.00	1	0	4	1	TREADMILL RM-FLOOR
32	1.00	2	3	0	3	TREADMILL RM-FLOOR
33	1.00	1	0	11	1	TREADMILL RM-FLOOR
34	1.00	0	2	0	0	TREADMILL RM-FLOOR
35	1.00	2	2	0	3	TREADMILL RM-FLOOR
36	1.00	0	10	0	0	TREADMILL RM-FLOOR
37	1.00	0	0	0	0	TREADMILL RM-FLOOR
38	1.00	0	0	15	0	TREADMILL RM-FLOOR
39	1.00	4	5	41	7	TREADMILL RM-FLOOR
40	1.00	7	0	3	13	TREADMILL RM-FLOOR
41	1.00	0	0	0	0	TREADMILL RM-FLOOR
42	1.00	0	11	0	0	TREADMILL RM-FLOOR
43	1.00	0	0	0	0	TREADMILL RM-FLOOR
44	1.00	9	0	0	17	TREADMILL RM-FLOOR
45	1.00	0	0	0	0	TREADMILL RM-COUNTER
46	1.00	7	12	29	13	TREADMILL RM-COUNTER
47	1.00	0	9	30	0	TREADMILL RM-COUNTER
48	1.00	1	5	1	1	TREADMILL
49	1.00	0	0	0	0	EKG
50	1.00	1	0	11	1	STRESS CHAIR
51	1.00	0	5	6	0	TREADMILL RM-DOOR KNOB 1
52	1.00	0	8	20	0	TREADMILL RM-DOOR KNOB 2

S#	TIME	CPMA	DPM1	MDA at 95% CL:
1	1.00	0		
2	1.00	1	0	2.7 cpm above background.
3	1.00	0	0	
4	1.00	0	0	
5	1.00	0	0	
6	1.00	6	11	
7	1.00	0	0	
8	1.00	0	0	
9	1.00	0	0	
10	1.00	0	0	
11	1.00	0	0	
12	1.00	0	0	

13	1.00	4	7
14	1.00	1	0
15	1.00	6	11
16	1.00	2	0
17	1.00	8	15
18	1.00	3	5
19	1.00	0	0
20	1.00	5	9
21	1.00	0	0
22	1.00	3	5
23	1.00	0	0
24	1.00	0	0
25	1.00	0	0
26	1.00	6	11
27	1.00	0	0
28	1.00	5	9
29	1.00	4	7
30	1.00	0	0
31	1.00	1	0
32	1.00	2	0
33	1.00	1	0
34	1.00	0	0
35	1.00	2	0
36	1.00	0	0
37	1.00	0	0

37	1.00	0	0
38	1.00	0	0
39	1.00	4	7
40	1.00	7	13
41	1.00	0	0
42	1.00	0	0
43	1.00	0	0
44	1.00	9	17
45	1.00	0	0
46	1.00	7	13
47	1.00	0	0
48	1.00	1	0
49	1.00	0	0
50	1.00	1	0
51	1.00	0	0
52	1.00	0	0

Prime Healthcare Services, LLC
dba St. Joseph Medical Center
1000 Carondelet Drive - Suite 200
Kansas City, MO 64114
NRC Lic. No.: 24-02704-01

**DECOMMISSIONING GRID
FOR SUITE 200
HOT LAB AND TREADMILL ROOM**

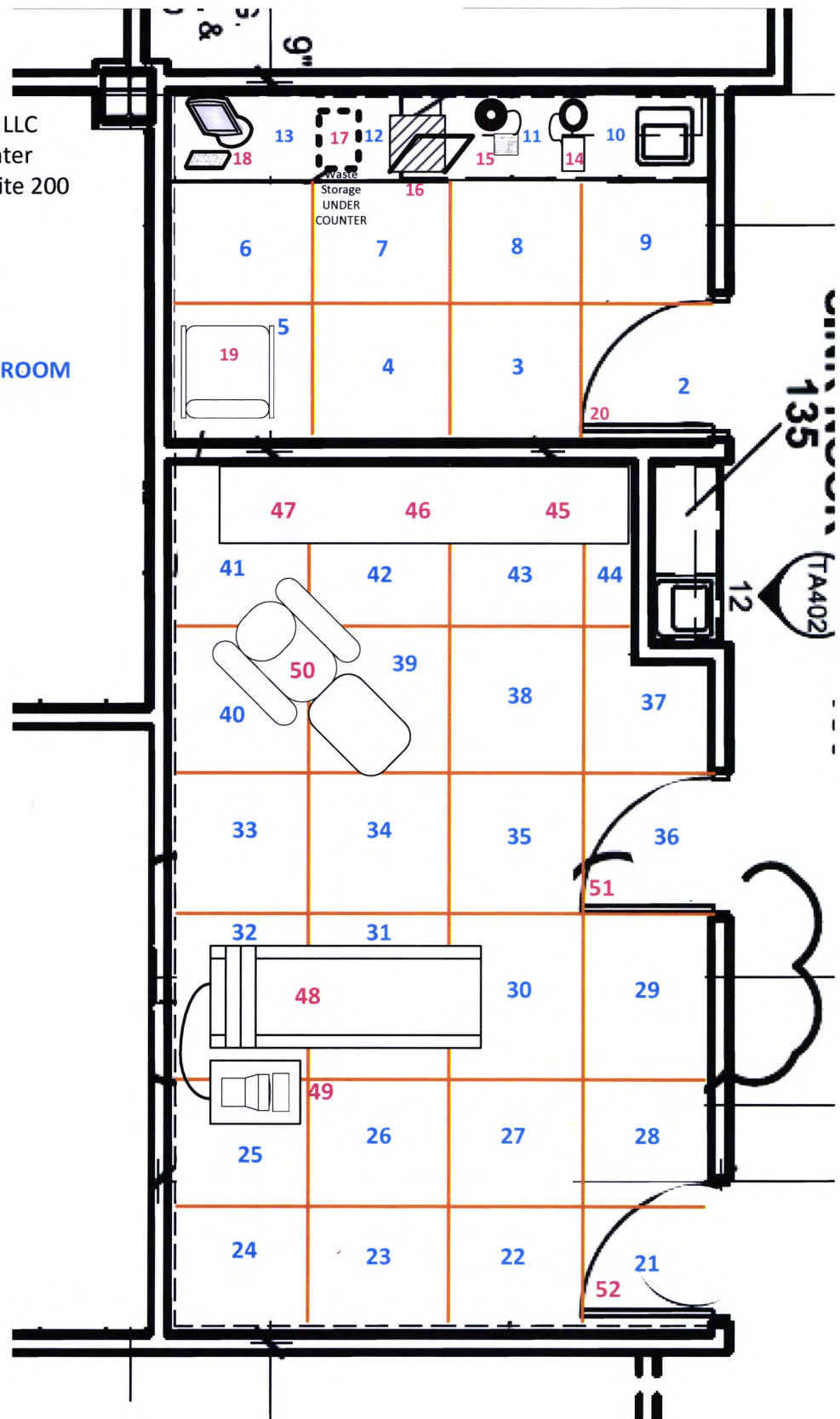

Close-out Area Surveys

Date: February 29, 2016

Licensee: Prime Healthcare Services, LLC dba St. Joseph Medical Center

Instrument Model: Ludlum Model 19 (Micro R Meter) Serial Number: 169637

Calibration date: June 17, 2015

Location: 1000 Carondelet Drive - Suite 200 - IMAGING ROOM 1 AND IMAGING ROOM 2

Location	Results
1. Background	10-14 μ R
2. Imaging Rm 1 Floor/Door Knob	10-14 μ R
3. Imaging Room 1 Floor	10-14 μ R
4. Imaging Room 1 Floor	10-14 μ R
5. Imaging Room 1 Floor	10-14 μ R
6. Imaging Room 1 Floor	10-14 μ R
7. Imaging Room 1 Floor	10-14 μ R
8. Imaging Room 1 Floor	10-14 μ R
9. Imaging Room 1 Floor	10-14 μ R
10. Imaging Room 1 Floor	10-14 μ R
11. Imaging Room 1 Floor	10-14 μ R
12. Imaging Room 1 Floor	10-14 μ R
13. Imaging Room 1 Floor	10-14 μ R
14. Imaging Room 1 Floor	10-14 μ R
15. Imaging Room 1 Floor	10-14 μ R
16. Imaging Room 1 Floor	10-14 μ R
17. Imaging Room 1 Floor	10-14 μ R
18. Imaging Room 1 Floor	10-14 μ R
19. Imaging Room 1 Floor	10-14 μ R
20. Imaging Room 1 Floor	10-14 μ R
21. Imaging Room 1 Floor	10-14 μ R
22. Imaging Room 1 Floor	10-14 μ R
23. Imaging Room 1 Floor	10-14 μ R
24. Imaging Room 1 Floor	10-14 μ R
25. Imaging Room 1 Floor	10-14 μ R
26. Camera 1 Gantry	10-14 μ R
27. Imaging Table 1	10-14 μ R
28. Camera 1 Hand Control	10-14 μ R
29. Acquisition Station/Computer 1	10-14 μ R
30. Imaging Room 2 Floor	10-14 μ R
31. Imaging Room 2 Floor	10-14 μ R
32. Imaging Room 2 Floor	10-14 μ R
33. Imaging Room 2 Floor	10-14 μ R

Location	Results
34. Imaging Room 2 Floor	10-14 μ R
35. Imaging Room 2 Floor	10-14 μ R
36. Imaging Room 2 Floor	10-14 μ R
37. Imaging Room 2 Floor	10-14 μ R
38. Imaging Room 2 Floor	10-14 μ R
39. Imaging Room 2 Floor	10-14 μ R
40. Imaging Room 2 Floor	10-14 μ R
41. Imaging Room 2 Floor	10-14 μ R
42. Imaging Room 2 Floor	10-14 μ R
43. Imaging Room 2 Floor	10-14 μ R
44. Imaging Room 2 Floor	10-14 μ R
45. Imaging Room 2 Floor	10-14 μ R
46. Imaging Room 2 Floor	10-14 μ R
47. Imaging Room 2 Floor	10-14 μ R
48. Imaging Room 2 Floor	10-14 μ R
49. Imaging Room 2 Floor	10-14 μ R
50. Imaging Room 2 Floor	10-14 μ R
51. Imaging Room 2 Floor	10-14 μ R
52. Imaging Room 2 Floor	10-14 μ R
53. Imaging Room 2 Floor	10-14 μ R
54. Imaging Room 2 Floor	10-14 μ R
55. Imaging Room 2 Floor	10-14 μ R
56. Imaging Room 2 Floor	10-14 μ R
57. Imaging Room 2 Floor	10-14 μ R
58. Imaging Room 2 Floor	10-14 μ R
59. Imaging Room 2 Floor	10-14 μ R
60. Camera 2 Gantry	10-14 μ R
61. Imaging Table 2	10-14 μ R
62. Camera 2 Hand Control	10-14 μ R
63. Acquisition Station/Computer 2	10-14 μ R
64. Imag. Rm 2 Door Knob 1	10-14 μ R
65. Imag. Rm 2 Door Knob 2	10-14 μ R

Results: The above area surveys were acquired of the assigned areas with a micro R meter. None of the areas exceeded the room background reading of 10-14 μ R.

Completed by:

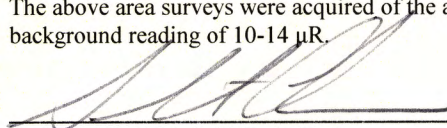
For Cardinal Health Medical & Health Physics
Registry #50

Close-out Wipe Tests

Date: February 29, 2016
Licensee: Prime Healthcare Services, LLC dba St. Joseph Medical Center
Instrument: Cobra II Auto Gamma **Serial Number:** 400692
Location: 1000 Carondelet Drive - Suite 200 - IMAGING ROOM 1 AND IMAGING ROOM 2

Location	Results
1. Background	< 200 dpm / 100 cm ²
2. Imaging Rm 1 Floor/Door Knob	< 200 dpm / 100 cm ²
3. Imaging Room 1 Floor	< 200 dpm / 100 cm ²
4. Imaging Room 1 Floor	< 200 dpm / 100 cm ²
5. Imaging Room 1 Floor	< 200 dpm / 100 cm ²
6. Imaging Room 1 Floor	< 200 dpm / 100 cm ²
7. Imaging Room 1 Floor	< 200 dpm / 100 cm ²
8. Imaging Room 1 Floor	< 200 dpm / 100 cm ²
9. Imaging Room 1 Floor	< 200 dpm / 100 cm ²
10. Imaging Room 1 Floor	< 200 dpm / 100 cm ²
11. Imaging Room 1 Floor	< 200 dpm / 100 cm ²
12. Imaging Room 1 Floor	< 200 dpm / 100 cm ²
13. Imaging Room 1 Floor	< 200 dpm / 100 cm ²
14. Imaging Room 1 Floor	< 200 dpm / 100 cm ²
15. Imaging Room 1 Floor	< 200 dpm / 100 cm ²
16. Imaging Room 1 Floor	< 200 dpm / 100 cm ²
17. Imaging Room 1 Floor	< 200 dpm / 100 cm ²
18. Imaging Room 1 Floor	< 200 dpm / 100 cm ²
19. Imaging Room 1 Floor	< 200 dpm / 100 cm ²
20. Imaging Room 1 Floor	< 200 dpm / 100 cm ²
21. Imaging Room 1 Floor	< 200 dpm / 100 cm ²
22. Imaging Room 1 Floor	< 200 dpm / 100 cm ²
23. Imaging Room 1 Floor	< 200 dpm / 100 cm ²
24. Imaging Room 1 Floor	< 200 dpm / 100 cm ²
25. Imaging Room 1 Floor	< 200 dpm / 100 cm ²
26. Camera 1 Gantry	< 200 dpm / 100 cm ²
27. Imaging Table 1	< 200 dpm / 100 cm ²
28. Camera 1 Hand Control	< 200 dpm / 100 cm ²
29. Acquisition Station/Computer 1	< 200 dpm / 100 cm ²
30. Imaging Room 2 Floor	< 200 dpm / 100 cm ²
31. Imaging Room 2 Floor	< 200 dpm / 100 cm ²
32. Imaging Room 2 Floor	< 200 dpm / 100 cm ²
33. Imaging Room 2 Floor	< 200 dpm / 100 cm ²

Location	Results
34. Imaging Room 2 Floor	< 200 dpm / 100 cm ²
35. Imaging Room 2 Floor	< 200 dpm / 100 cm ²
36. Imaging Room 2 Floor	< 200 dpm / 100 cm ²
37. Imaging Room 2 Floor	< 200 dpm / 100 cm ²
38. Imaging Room 2 Floor	< 200 dpm / 100 cm ²
39. Imaging Room 2 Floor	< 200 dpm / 100 cm ²
40. Imaging Room 2 Floor	< 200 dpm / 100 cm ²
41. Imaging Room 2 Floor	< 200 dpm / 100 cm ²
42. Imaging Room 2 Floor	< 200 dpm / 100 cm ²
43. Imaging Room 2 Floor	< 200 dpm / 100 cm ²
44. Imaging Room 2 Floor	< 200 dpm / 100 cm ²
45. Imaging Room 2 Floor	< 200 dpm / 100 cm ²
46. Imaging Room 2 Floor	< 200 dpm / 100 cm ²
47. Imaging Room 2 Floor	< 200 dpm / 100 cm ²
48. Imaging Room 2 Floor	< 200 dpm / 100 cm ²
49. Imaging Room 2 Floor	< 200 dpm / 100 cm ²
50. Imaging Room 2 Floor	< 200 dpm / 100 cm ²
51. Imaging Room 2 Floor	< 200 dpm / 100 cm ²
52. Imaging Room 2 Floor	< 200 dpm / 100 cm ²
53. Imaging Room 2 Floor	< 200 dpm / 100 cm ²
54. Imaging Room 2 Floor	< 200 dpm / 100 cm ²
55. Imaging Room 2 Floor	< 200 dpm / 100 cm ²
56. Imaging Room 2 Floor	< 200 dpm / 100 cm ²
57. Imaging Room 2 Floor	< 200 dpm / 100 cm ²
58. Imaging Room 2 Floor	< 200 dpm / 100 cm ²
59. Imaging Room 2 Floor	< 200 dpm / 100 cm ²
60. Camera 2 Gantry	< 200 dpm / 100 cm ²
61. Imaging Table 2	< 200 dpm / 100 cm ²
62. Camera 2 Hand Control	< 200 dpm / 100 cm ²
63. Acquisition Station/Computer 2	< 200 dpm / 100 cm ²
64. Imag. Rm 2 Door Knob 1	< 200 dpm / 100 cm ²
65. Imag. Rm 2 Door Knob 2	< 200 dpm / 100 cm ²

Remarks: The above close-out wipe tests were acquired of the assigned areas. The sample areas consisted of a contiguous wipe from a 3' x 3' area or approximately 8361 cm². Please see the attached print-out that lists the cpm and dpm.

Completed by:

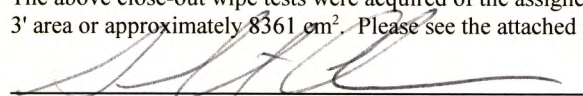
For Cardinal Health Medical & Health Physics
Registry #50

29 Feb 2016 16:02

Cardinal Medical & Health Physics

Page #1

Protocol #: 8

DECOMMISSIONING LEAK

User :

Tech ID: SA
 ST. JOSEPH MED CTR-CARDIOLOGY STE 200; KCMO
 Count Time(minutes): 1.00
 Assay Type: CPM
 Background Subtract : IPA Bkg
 Code: 1234
 Outlier: 5.0 FLAG
 Dilution Operator : #
 %Spillup: 0.00
 %Spilldown: 0.00
 Screening: OFF

	Window A	Window B	Window C
Nuclide:	Co-57 75 - 165 keV	MAN 562 - 762 keV	MAN 15 - 2000 keV
Bkg:	42.4	33.3	296
Sigma:	0.00	0.00	0.00
LCR:	0	0	0
Half Life(hours):	0.00	0.00	
Multiplier:	2.0000		
%CV Flag Limit:	0.00	0.00	

S#	TIME	A:CPM	B:CPM	C:CPM	CCPM	PAT/ID
1	1.00	0	8	5	0	BACKGROUND
2	1.00	6	0	11	11	CAMERA RM 1-FLOOR
3	1.00	1	1	12	1	CAMERA RM 1-FLOOR
4	1.00	3	3	14	5	CAMERA RM 1-FLOOR
5	1.00	3	0	0	5	CAMERA RM 1-FLOOR
6	1.00	0	0	0	0	CAMERA RM 1-FLOOR
7	1.00	0	8	9	0	CAMERA RM 1-FLOOR
8	1.00	0	0	8	0	CAMERA RM 1-FLOOR
9	1.00	0	0	0	0	CAMERA RM 1-FLOOR
10	1.00	0	0	15	0	CAMERA RM 1-FLOOR
11	1.00	3	4	1	5	CAMERA RM 1-FLOOR
12	1.00	0	12	23	0	CAMERA RM 1-FLOOR
13	1.00	0	0	0	0	CAMERA RM 1-FLOOR
14	1.00	0	0	11	0	CAMERA RM 1-FLOOR
15	1.00	0	0	5	0	CAMERA RM 1-FLOOR
16	1.00	0	3	0	0	CAMERA RM 1-FLOOR
17	1.00	4	0	6	7	CAMERA RM 1-FLOOR
18	1.00	0	0	0	0	CAMERA RM 1-FLOOR
19	1.00	0	4	37	0	CAMERA RM 1-FLOOR
20	1.00	0	0	20	0	CAMERA RM 1-FLOOR
21	1.00	0	1	0	0	CAMERA RM 1-FLOOR
22	1.00	0	0	16	0	CAMERA RM 1-FLOOR
23	1.00	7	5	5	13	CAMERA RM 1-FLOOR
24	1.00	0	0	7	0	CAMERA RM 1-FLOOR
25	1.00	3	7	5	5	CAMERA RM 1-FLOOR
26	1.00	0	4	0	0	CAMERA RM 1-GANTRY
27	1.00	2	9	28	3	CAMERA RM 1-IMG TABLE
28	1.00	0	0	7	0	CAMERA RM 1-HANDSET
29	1.00	7	8	19	13	CAMERA RM 1-ACQ STATION
30	1.00	5	0	0	9	CAMERA RM 2-FLOOR

S#	TIME	A:CPM	B:CPM	C:CPM	CCPM	PAT/ID
31	1.00	6	0	0	11	CAMERA RM 2-FLOOR
32	1.00	4	0	3	7	CAMERA RM 2-FLOOR
33	1.00	0	0	0	0	CAMERA RM 2-FLOOR
34	1.00	1	0	12	1	CAMERA RM 2-FLOOR
35	1.00	3	7	10	5	CAMERA RM 2-FLOOR
36	1.00	9	2	26	17	CAMERA RM 2-FLOOR
37	1.00	0	3	15	0	CAMERA RM 2-FLOOR
38	1.00	2	11	0	3	CAMERA RM 2-FLOOR
39	1.00	3	0	0	5	CAMERA RM 2-FLOOR
40	1.00	8	1	18	15	CAMERA RM 2-FLOOR
41	1.00	0	4	11	0	CAMERA RM 2-FLOOR
42	1.00	5	0	0	9	CAMERA RM 2-FLOOR
43	1.00	0	0	12	0	CAMERA RM 2-FLOOR
44	1.00	0	0	0	0	CAMERA RM 2-FLOOR
45	1.00	0	3	0	0	CAMERA RM 2-FLOOR
46	1.00	0	7	28	0	CAMERA RM 2-FLOOR
47	1.00	1	6	18	1	CAMERA RM 2-FLOOR
48	1.00	7	0	14	13	CAMERA RM 2-FLOOR
49	1.00	0	0	0	0	CAMERA RM 2-FLOOR
50	1.00	1	5	0	1	CAMERA RM 2-FLOOR
51	1.00	0	4	0	0	CAMERA RM 2-FLOOR
52	1.00	8	0	8	15	CAMERA RM 2-FLOOR
53	1.00	7	11	23	13	CAMERA RM 2-FLOOR
54	1.00	0	11	0	0	CAMERA RM 2-FLOOR
55	1.00	1	7	8	1	CAMERA RM 2-FLOOR
56	1.00	15	3	22	29	CAMERA RM 2-FLOOR
57	1.00	0	10	0	0	CAMERA RM 2-FLOOR
58	1.00	0	3	0	0	CAMERA RM 2-FLOOR
59	1.00	0	0	12	0	CAMERA RM 2-FLOOR
60	1.00	0	0	0	0	CAMERA RM 2-GANTRY
61	1.00	0	2	12	0	CAMERA RM 2-IMG TABLE
62	1.00	0	10	2	0	CAMERA RM 2-HANDSET
63	1.00	5	1	0	9	CAMERA RM 2-ACQ STATION
64	1.00	0	4	21	0	CAMERA RM 2-DOOR KNOB 1
65	1.00	2	0	0	3	CAMERA RM 2-DOOR KNOB 2

S#	TIME	CPMA	DPM1	MDA at 95% CL:
1	1.00	0		
2	1.00	6	11	2.7 cpm above background.
3	1.00	1	0	
4	1.00	3	5	
5	1.00	3	5	
6	1.00	0	0	
7	1.00	0	0	
8	1.00	0	0	
9	1.00	0	0	
10	1.00	0	0	
11	1.00	3	5	
12	1.00	0	0	
13	1.00	0	0	
14	1.00	0	0	
15	1.00	0	0	
16	1.00	0	0	
17	1.00	4	7	
18	1.00	0	0	
19	1.00	0	0	
20	1.00	0	0	
21	1.00	0	0	
22	1.00	0	0	
23	1.00	7	13	
24	1.00	0	0	

25	1.00	3	5
26	1.00	0	0
27	1.00	2	0
28	1.00	0	0
29	1.00	7	13
30	1.00	5	9
31	1.00	6	11
32	1.00	4	7
33	1.00	0	0
34	1.00	1	0
35	1.00	3	5
36	1.00	9	17
37	1.00	0	0
38	1.00	2	0
39	1.00	3	5
40	1.00	8	15
41	1.00	0	0
42	1.00	5	9
43	1.00	0	0
44	1.00	0	0
45	1.00	0	0
46	1.00	0	0
47	1.00	1	0
48	1.00	7	13
49	1.00	0	0
50	1.00	1	0
51	1.00	0	0
52	1.00	8	15
53	1.00	7	13
54	1.00	0	0
55	1.00	1	0
56	1.00	15	29
57	1.00	0	0
58	1.00	0	0
59	1.00	0	0

60	1.00	0	0
61	1.00	0	0
62	1.00	0	0
63	1.00	5	9
64	1.00	0	0
65	1.00	2	0

**DECOMMISSIONING GRID
FOR SUITE 200
IMAGING ROOMS 1 AND 2**

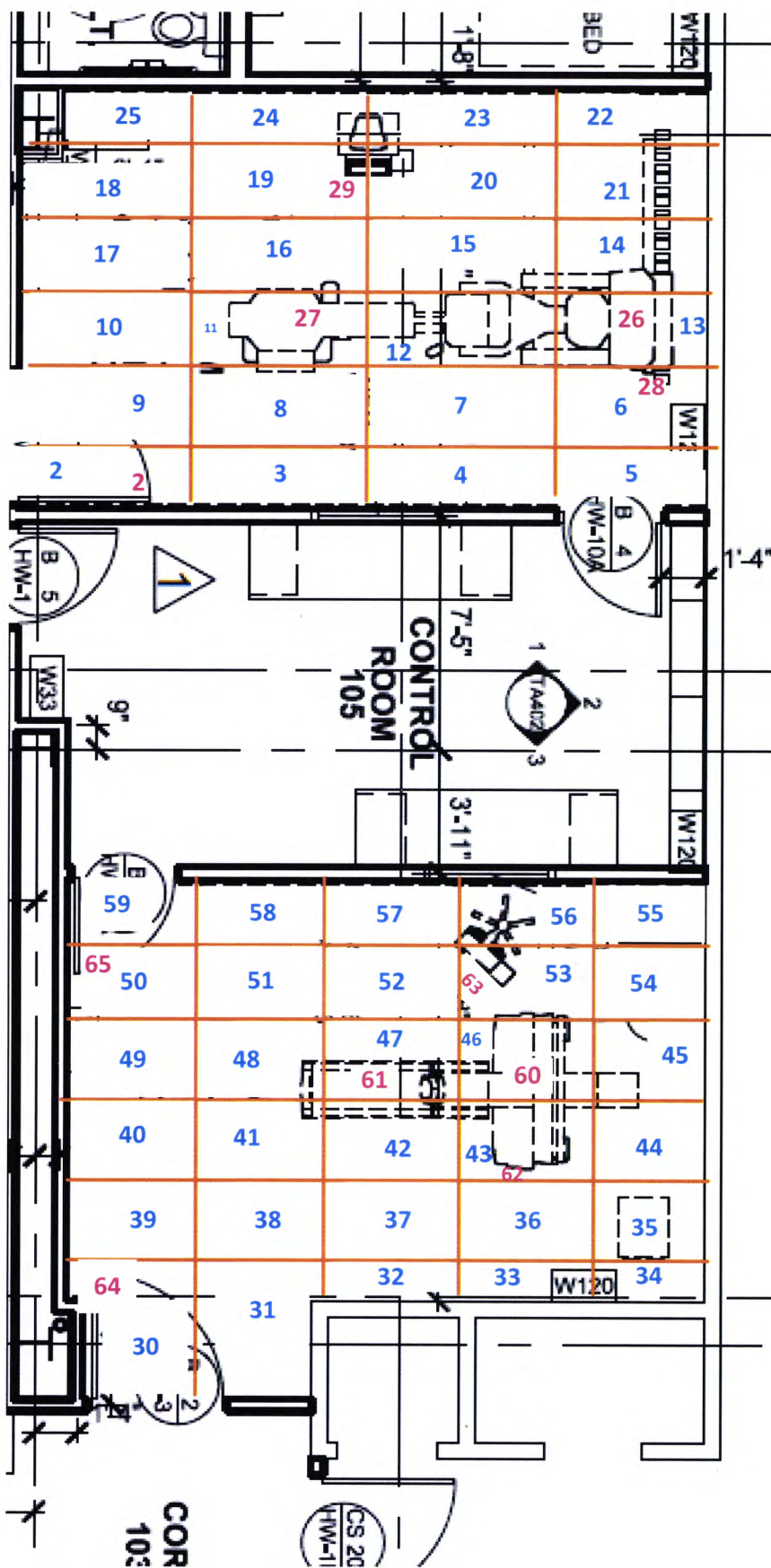

1000 Canalelet Dr.
KCMO 64114



Nuclear Regulatory Commission
Medical Licensing Division, Region III
2443 Warrenville Rd.
Lisle, IL 60532-4351

RECEIVED MAR 22 2016

