



May 26, 2015

U. S. Nuclear Regulatory Commission
Materials Licensing Section
2443 Warrenville Road, Suite 210
Lisle, IL 60532-4352

Dear Sir or Madam:

Perry County Memorial Hospital would like to amend its Byproduct Materials License, Number 13-26526-01, to remove the #1 Hospital Road, Tell City, Indiana 47586 Address of Use. Enclosed is a close-out survey of the Address of Use.

If there are any questions concerning this amendment request, please contact our nuclear medicine physicist, Patrick Byrne, DABR, CHP, DABSNM, at 1-877-321-2207x343.

Sincerely,

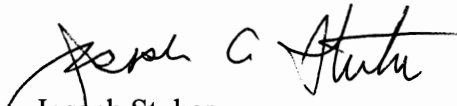
Joseph Stuber
President and CEO

8885 State Road 237 | Tell City, Indiana | 47586
812-547-7011 | www.pchospital.org

This institution is an equal opportunity provider and employer.

RECEIVED JUN 02 2015

Close-out survey of #1 Hospital Road, Tell City, Indiana 47586 Address of Use

Performed by: Patrick J. Byrne, DABR, CHP, DABSNM
Medical Physics Consultants, Inc.

Radioactive materials usage at this address of use was limited to materials licensed under 10 CFR 35.100 and 35.200. The area was licensed for a short period of time for 35.300 materials several years ago and use was limited to a few iodine-131 dosages. Sealed radioactive sources were possessed and used for equipment quality control.

Wipe tests for removable radioactive contamination were taken on 5/20/15 and analyzed in a Ludlum Model 243 (S/N: 145366) Shielded Well Scintillator coupled to a Ludlum Model 2200 (S/N: 138705) Scaler Ratemeter. A window of 50 to 400 keV was used to analyze the wipes. The efficiency of this system for cobalt-57 is 1.07 dpm/cpm. The results of the wipe samples are enclosed.

The radiation levels survey was performed on 5/20/15 by Patrick Byrne, using a Ludlum Model 14C Geiger-Muller survey meter (S/N: 110511) with an end window probe. The meter was calibrated on 04/22/15. The range used for the radiation level survey was 0.0 to 0.2 mR/hr.

Visual Inspection

The area was visually inspected to ensure that all radioactive waste had been removed. No radioactive material was located in the area.

Radiation Level Survey

No area demonstrated radiation levels in excess of the background reading of 0.02 mR/hr.

Sealed Sources

All sealed sources have been moved to the Nuclear Medicine Department area of use, located at 8885 State Road 237, Tell City, Indiana 47586. No sealed source had ever been found to be leaking and a copy of the most recent leak test results is enclosed.

Removable Contamination Survey Results

Wipe samples were counted in a Ludlum Model 243 Shielded Well Scintillator (S/N: 145366) coupled to a Ludlum Model 2200 Scaler Ratemeter (S/N: 138705). The efficiency of this system for cobalt-57 is 1.09 dpm/cpm.

Background: 284 counts per minute

Wipe Number	Gross counts per minute	Net counts per minute	Disintegrations per minute
1	264	0	0
2	278	0	0
3	292	8	8.72
4	298	14	15.26
5	290	6	6.54
6	291	7	7.63
7	274	0	0
8	301	17	18.53
9	311	27	29.43
10	278	0	0
11	297	13	14.17
12	275	0	0
13	287	3	3.27
14	307	23	25.07
15	308	24	26.16
16	300	16	17.44
17	291	6	6.54
18	313	29	31.61

*Please refer to the attached survey map for wipe locations.

Maximum removable contamination occurred in area 18. Gross count rate = 313 cpm/100cm². Net count rate (gross minus background) = 313 – 284 = 29 cpm/100cm². Net removable disintegrations per minute = 29 cpm/100cm² x 1.09 dpm/cpm = 31.61 dpm/100cm².

Conclusion

As of 5/20/15, all radioactive materials have been removed from the area of use and no removable contamination is present.



Sealed Source Leak Test

Licensee: Perry County Memorial Hospital

Date: 05/20/15

Performed by: Patrick Byrne

Nuclide	Type	Calibration Activity	Calibration Date	Location	M/N	S/N
Cs-137	Vial	213 uCi	10/28/93	Hot Lab	NES-356	S356026030
Current Activity: 129.4 uCi						
Ba-133	Vial	278 uCi	02/14/00	Hot Lab	NES-358	S358027012
Current Activity: 101.7 uCi						
Co-57	Flood	15 mCi	03/16/13	Hot Lab	Benchmark	BM011513045204
Current Activity: 1.963 mCi						

Comment: The sources listed above were leak tested using a dry wipe technique and were found to have less than 0.005 uCi removable activity. The following Minimum Detectable Activities are based upon a background at the indicated value. Background was at or below these levels when the above tests were completed.

Well Counter: Ludlum 2200 Scaler

Nuclide	MDA	Background
Cs-137	2.1×10^{-4} uCi	45 cpm
Ba-133	6.0×10^{-5} uCi	264 cpm
Co-57	4.0×10^{-5} uCi	307 cpm

RADIATION SAFETY OFFICER: _____

Perry County Memorial Hospital #1 Hospital Rd. Tell City, In. 47586

Circled numbers correspond to wipe sample locations and the respectively results are enclosed.

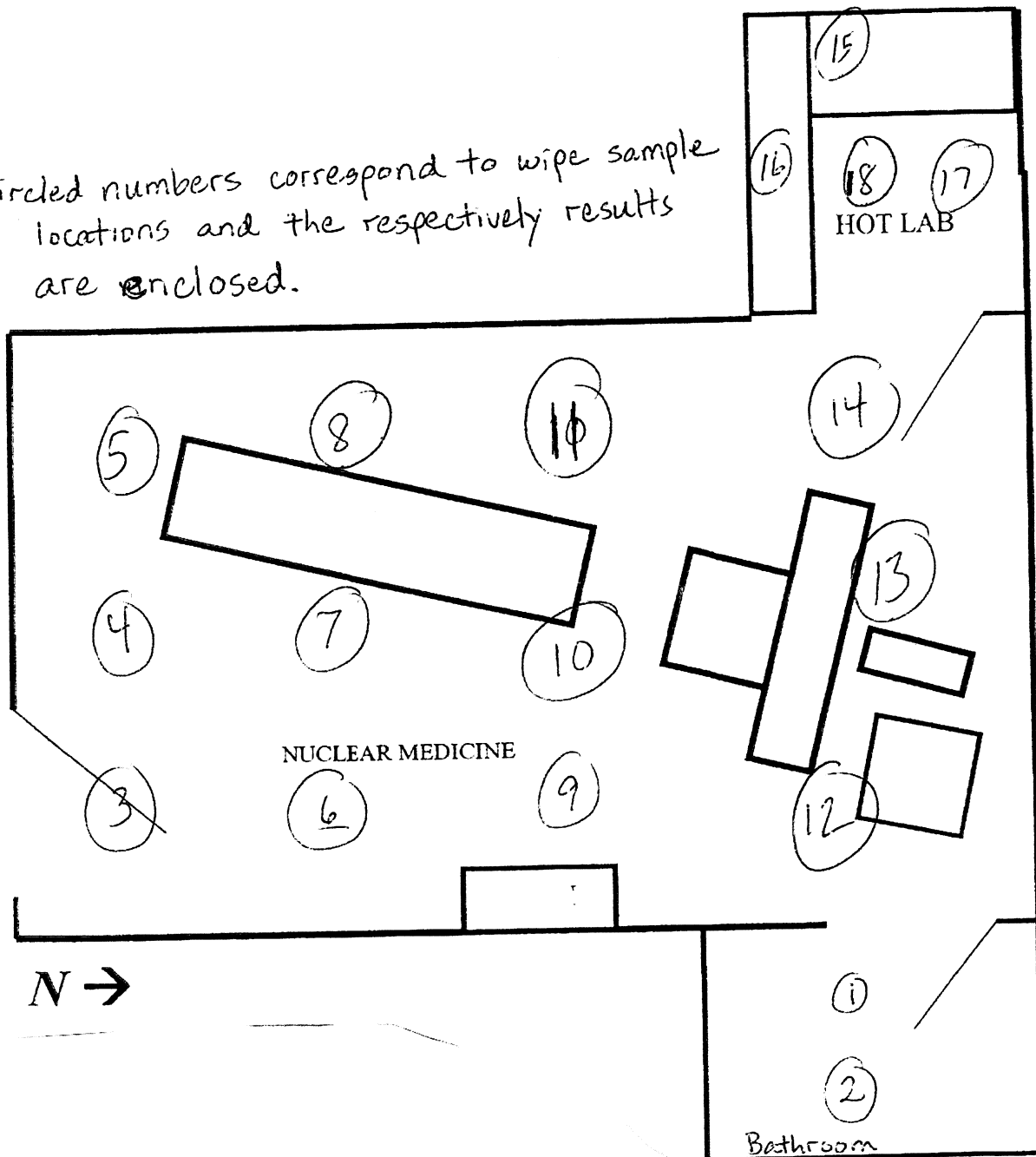

Nancy Hobby, RCR
PCMH Perry County
Memorial
Hospital
#1 Hospital Road
Tell City, Indiana 47586

EVANSVILLE
IN 476
29 MAY '15
PM 2 L



UNITED STATES POSTAGE
PITNEY BOWES
02 1P \$ 000.690
0000808535 MAY 28 2015
MAILED FROM ZIP CODE 47586

US Nuclear Regulatory Commission
Materials Licensing Section
2443 Warnerville Road, Suite 210
Lisle, IL 60532-4352

RECEIVED JUN 02 2015

60532435260

