

**JANX**  
**8550 E. Michigan Avenue (49269-9785)**  
**P.O. Box 190, Parma, MI**  
**49269-0190, USA**  
**Phone: 517 531 8210**  
**Fax: 517 531 3911**

March, 25<sup>th</sup> 2015

Attention:  
Radioactive Material License Division  
U.S. Nuclear Regulatory Commission, Region III  
Materials Licensing Branch  
2443 Warrenville Rd.  
Suite 210  
Lisle, IL 60532-4352

Re: License No. 21-16560-01 Amendment Request:

Radioactive Material License Division

Dear Radioactive Material License Division, U.S. Nuclear Regulatory Commission, Region III

JANX would like to submit the following amendment request to our NRC Radioactive Material license No. 21-16560-01:

- Please remove the following addresses from section 10 Item "A":
  1. 10625 Liberty Ave. St. Louis, MO 63132
- Please remove the following addresses from section 10 Item "B":
  1. 1974 Youngs Rd. Gladwin, MI 48624
  2. 344 Osage Dr. Wixom, MI 48393
  3. 128 South Oak St. Clarksburg, WV 26301
  4. 5712 East Dallas Dr. Terre Haute, IN 47802
  5. 344 North Jackson, Casper, WY 82601
- All addresses from section 10 Item "B" listed above do not need a swab examination. The radioactive material located at these addresses was stored in a darkroom vehicle. The vehicle that was used to store the radioactive material has been removed from the location and put into place at the newly requested locations or has returned to the corporate office in Parma Michigan.



- Please add the following addresses to section 10 Item "A":

1. 22 Sanders Dr. O'Fallon, MO 63366

- Please add the following addresses to section 10 Item "B":

1. 304 South Holmes St. Lansing, MI 48658
2. 322 North Main St. Standish, MI 48658
3. 317 Columbine Dr. Casper, WY 82601
4. 5091 East Woodsmall Dr. Terre Haute, IN 47802

**NOTE:** See attached decommissioning report for the 10625 Liberty Ave. St. Louis, MO 63132 address. All other addresses which we are removing from the NRC License had the radioactive Material stored in an approved JANX vehicle. No decommissioning report is needed. The vehicles are now located at the new addresses that we have requested as new radioactive material storage field stations in this amendment.

**NOTE:** LLEA's for the addresses we would like to add to the NRC License have been put into place. LLEA's that we would like to remove from our NRC License have been terminated.

I will be the point of contact for this amendment request. Thank you for your assistance with this matter. Please do not hesitate to contact me should you have any questions.

William Reeve, telephone (517) 531-8210 extension 1019, e-mail [bill.reeve@applusrtd.com](mailto:bill.reeve@applusrtd.com).

Sincerely,

A handwritten signature in black ink that reads "William D. Reeve". The signature is fluid and cursive, with the first name "William" and last name "Reeve" being the most prominent parts.

William D. Reeve, CRSO and T & R Official

JANX Integrity Group.

10627 LIBERTY AVENUE • ST. LOUIS, MO. 63132 • (314) 427-0221

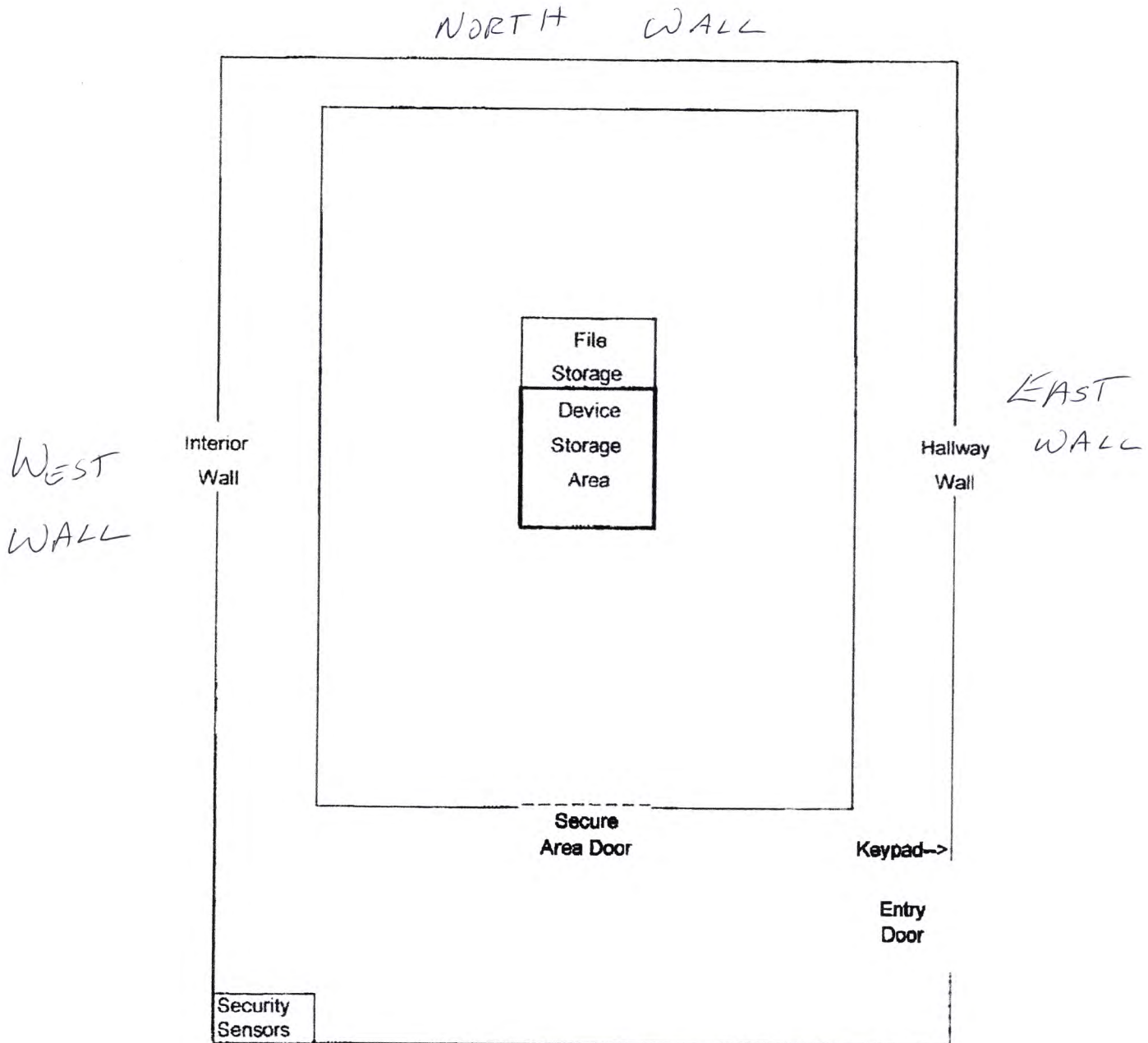

OFFICIAL USE ONLY - SECURITY RELATED INFORMATION

NOT FOR PUBLIC DISCLOSURE

SOUTH WALL

JANX Integrity Group  
10625 / 10627 Liberty Ave. St. Louis MO. 63132

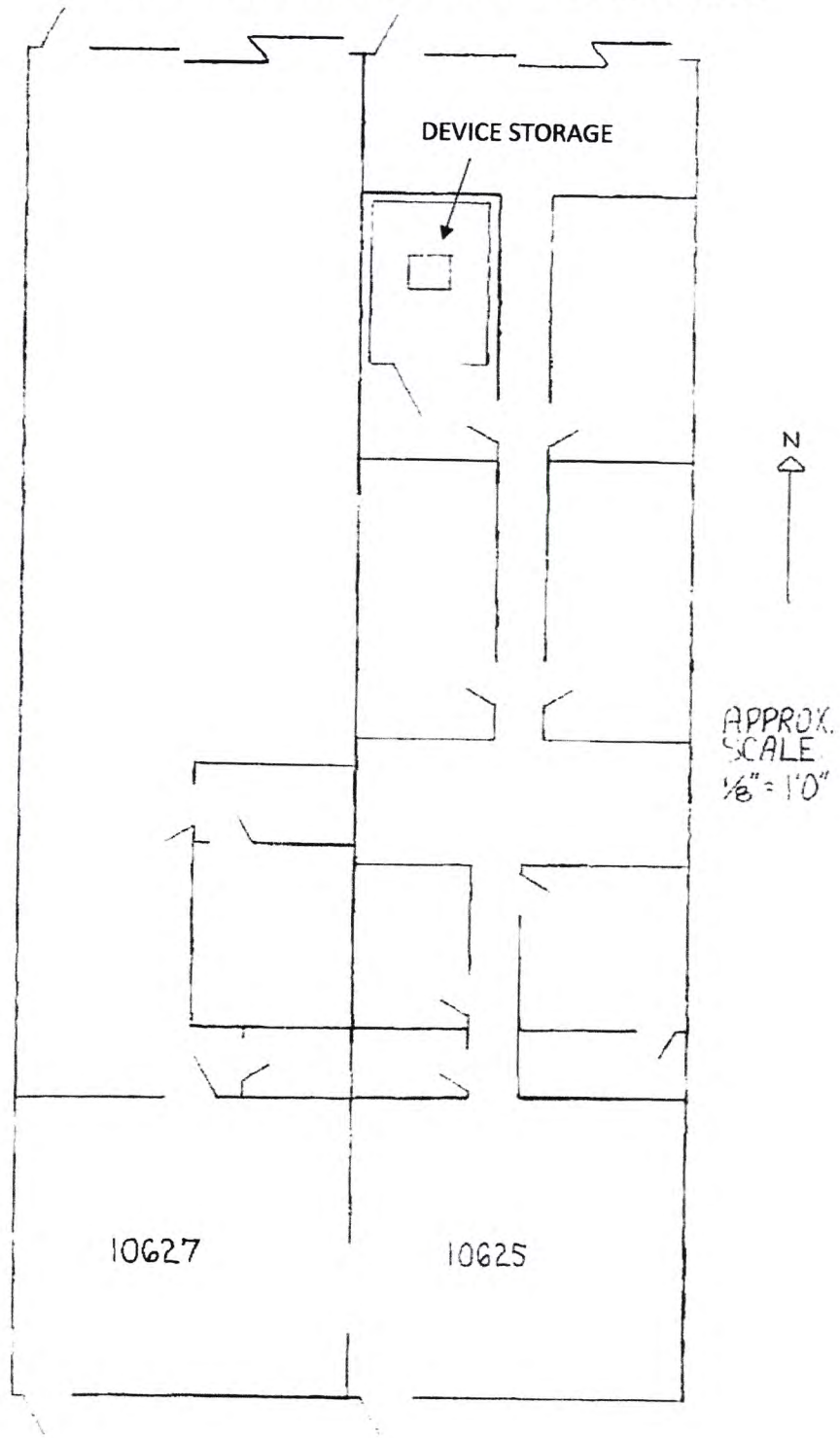



8550 East Michigan Ave  
Parma, Michigan 49269  
(517) 531-8210 Facility  
(517) 416-0682 Mobile

Company Name: JANX

Location: St. Louis MO

Inspection Date: 3/10/2015

Technician: William D. Rowe

Field Sketch of: Storage Facility for radioactive material Located at 10625 Liberty Ave. St. Louis, MO

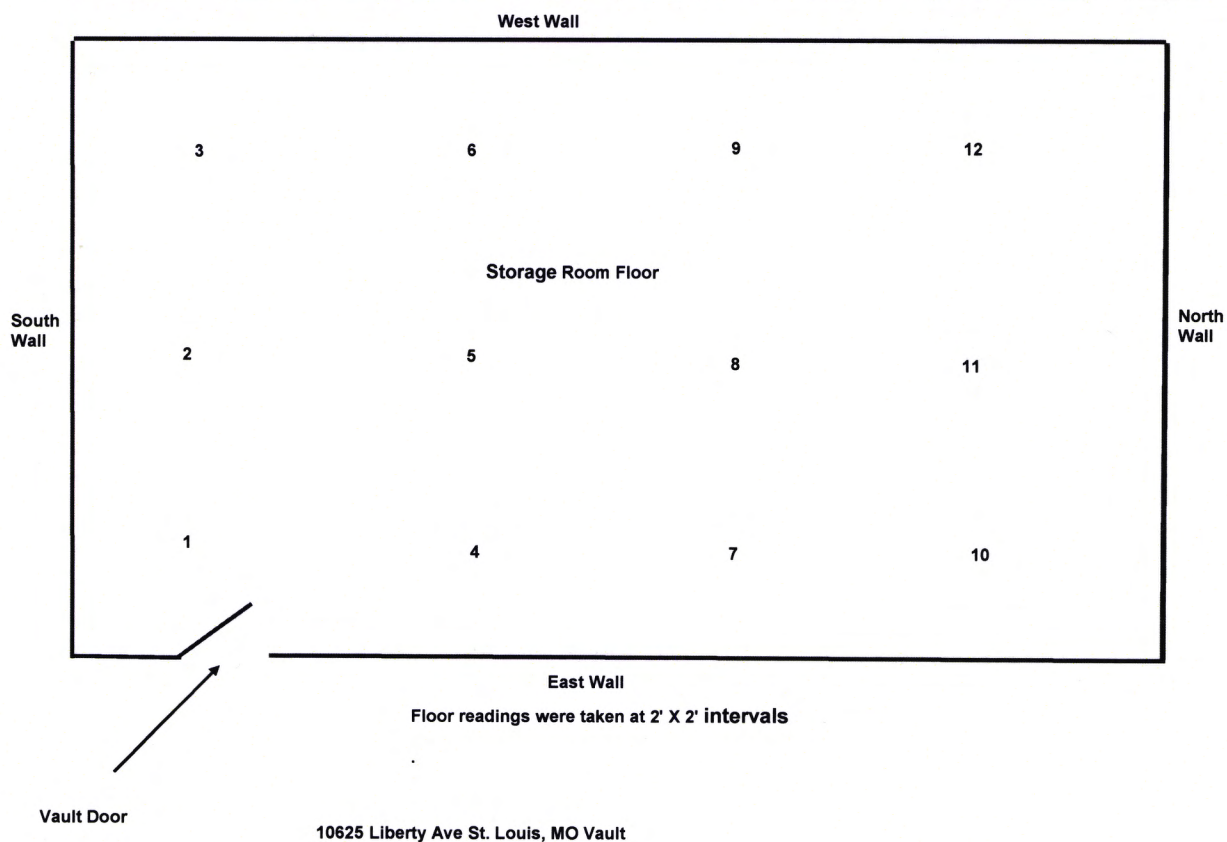



8550 East Michigan Ave  
Parma, Michigan 49269  
(517) 531-8210 Facility  
(517) 416-0682 Mobile

Company Name: JANX

Location: St. Louis MO

Inspection Date: 3/10/2015

Technician: William D. Reese

Field Sketch of: Storage Facility for radioactive material Located at 10625 Liberty Ave. St. Louis, MO

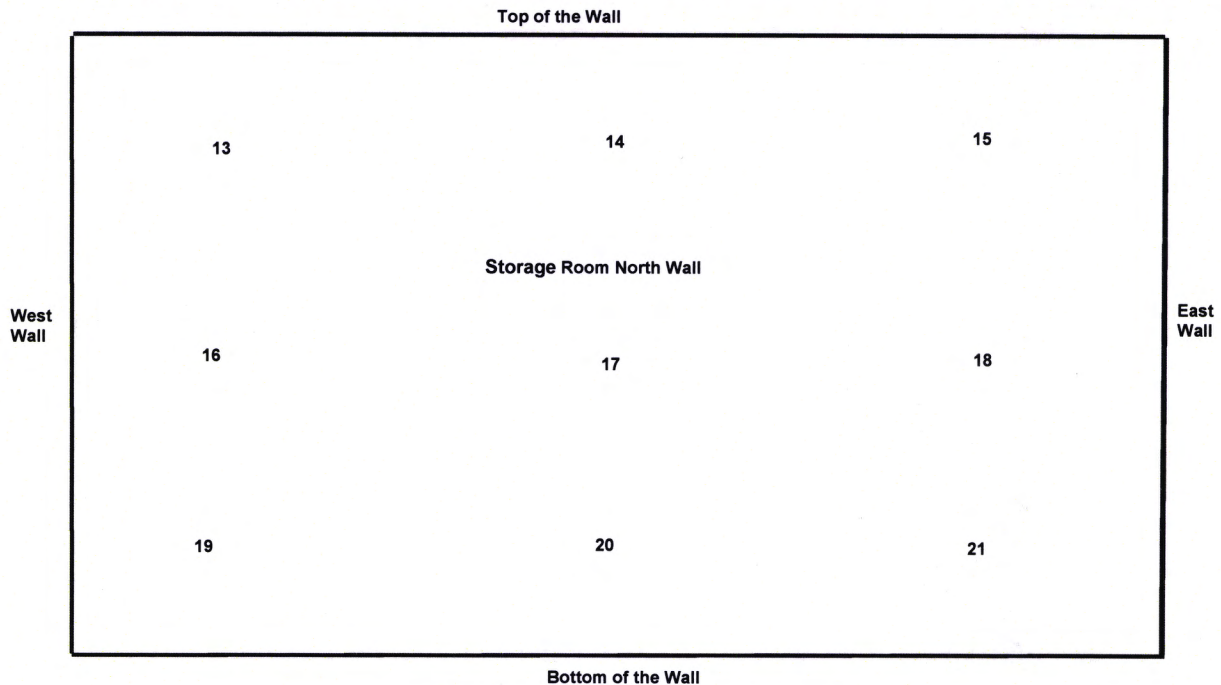

North Wall Readings were taken at 2' X 2' intervals

10625 Liberty Ave St. Louis, MO Vault





8550 East Michigan Ave  
Parma, Michigan 49269  
(517) 531-8210 Facility  
(517) 416-0682 Mobile

Company Name: JANX

Location: St. Louis MO

Inspection Date: 3/10/2015

Technician: William D. Rowe

Field Sketch of: Storage Facility for radioactive material Located at 10625 Liberty Ave. St. Louis, MO

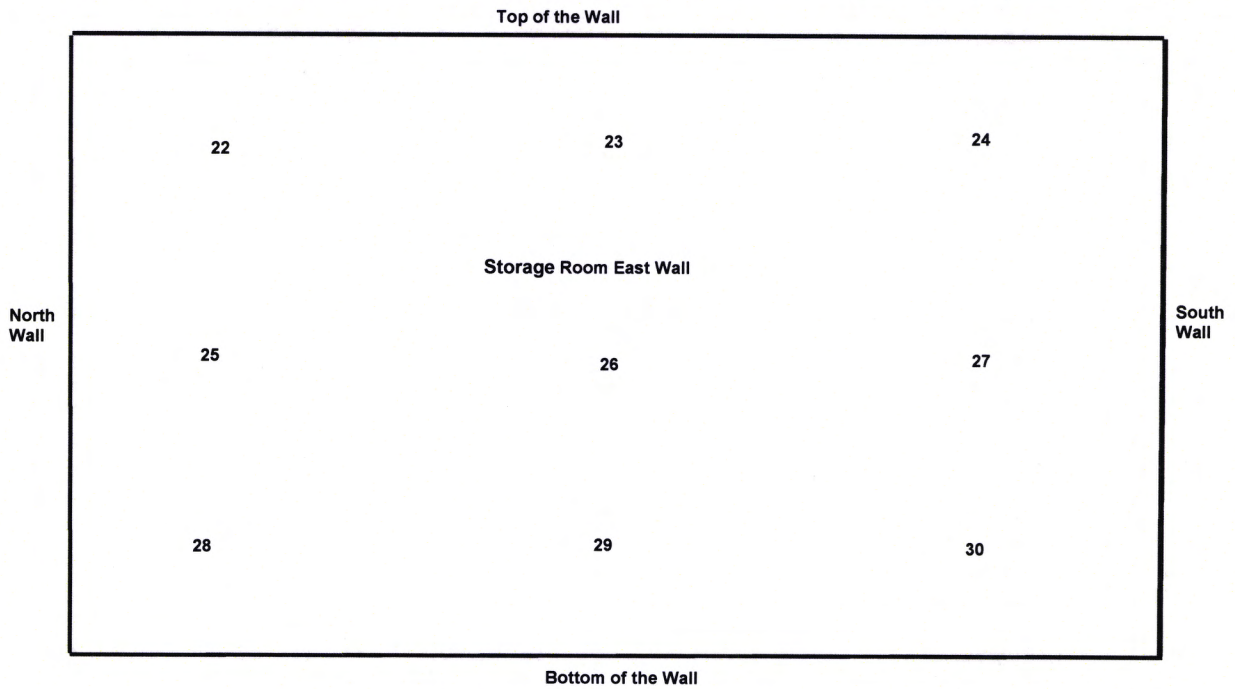

East Wall Readings were taken at 4' X 4' intervals

10625 Liberty Ave St. Louis, MO Vault



8550 East Michigan Ave  
Parma, Michigan 49269  
(517) 531-8210 Facility  
(517) 416-0682 Mobile

Company Name: JANX

Location: St. Louis MO

Inspection Date: 3/10/2015

Technician: William D. Rowe

Field Sketch of: Storage Facility for radioactive material Located at 10625 Liberty Ave. St. Louis, MO

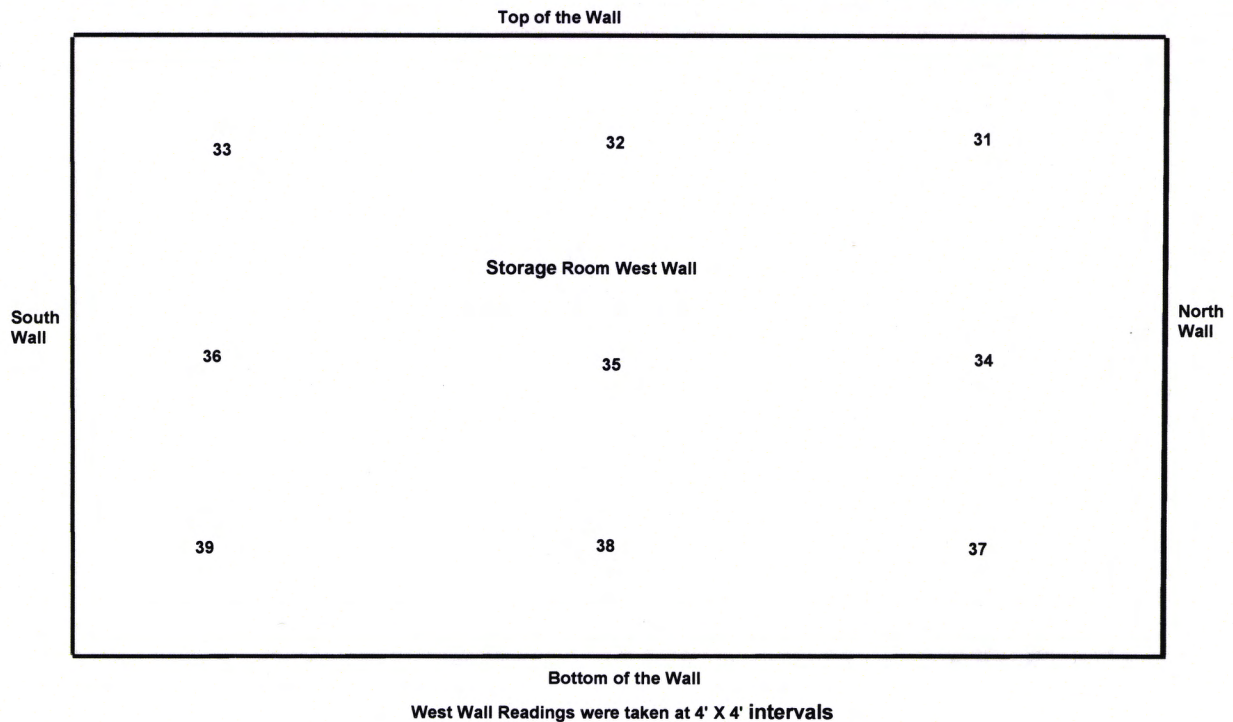

10625 Liberty Ave St. Louis, MO Vault





8550 East Michigan Ave  
Parma, Michigan 49269  
(517) 531-8210 Facility  
(517) 416-0682 Mobile

Company Name: JANX

Location: St. Louis MO

Inspection Date: 3/10/2015

Technician: William D. Reese

Field Sketch of: Storage Facility for radioactive material Located at 10625 Liberty Ave. St. Louis, MO

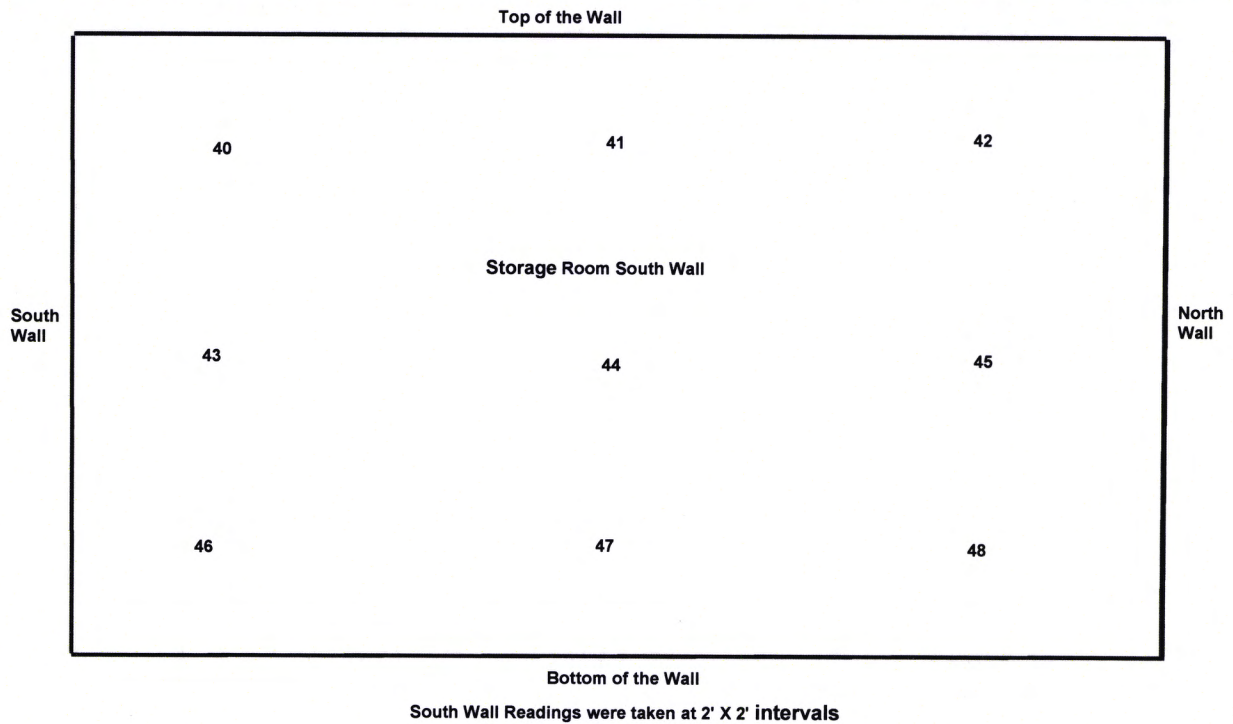

10625 Liberty Ave St. Louis, MO Vault

SUNTRAC SERVICES, INC.  
1818 EAST MAIN STREET  
LEAGUE CITY, TEXAS 77573  
PHONE ( 281 ) 338-2133

AREA WIPE TEST REPORT FORM

Company Name: **Janx**

Smear Taken Date: **March 10, 2015 by: William Reeve**

This report certifies that wipe test smears are from **Janx** Located at **10625 Liberty Avenue St. Louis, MO.** and they have been assayed at our facility for removable contamination with a Ludlum 2929 S/N: 86481. Calibration certificate attached.

Smear Location	Alpha DPM	Beta/Gamma DPM
#1	BDL	BDL
#2	BDL	BDL
#3	BDL	17
#4	BDL	BDL
#5	BDL	BDL
#6	BDL	BDL
#7	BDL	BDL
#8	BDL	34
#9	BDL	BDL
#10	BDL	46
#11	BDL	BDL
#12	BDL	6
#13	BDL	BDL
#14	BDL	17
#15	BDL	BDL
#16	BDL	BDL
#17	BDL	6
#18	BDL	BDL
#19	BDL	29
#20	BDL	46
#21	BDL	BDL
#22	BDL	BDL
#23	BDL	BDL
#24	BDL	63
#25	BDL	BDL
#26	BDL	BDL
#27	BDL	BDL
#28	BDL	23
#29	BDL	23
#30	BDL	BDL
#31	BDL	BDL
#32	BDL	BDL
#33	BDL	BDL
#34	BDL	BDL
#35	BDL	BDL
#36	BDL	BDL
#37	BDL	BDL
#38	BDL	23
#39	BDL	34
#40	BDL	BDL

#41	BDL	BDL
#42	BDL	BDL
#43	BDL	86
#44	BDL	11
#45	BDL	BDL
#46	BDL	6
#47	BDL	29
#48	BDL	74

BDL = Below Detectable Limits

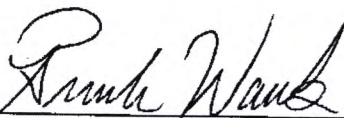
CERTIFIED BY:  DATE: 3-23-15  
**Brenda Wasek** **March 23, 2015**

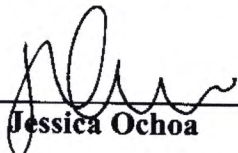
QC'D BY:  DATE: 3-24-15  
**Jessica Ochoa** **March 24, 2015**





# SUNTRAC Services, Inc.

## CERTIFICATE OF CALIBRATION

1818 East Main Street  
League City, TX 77573  
Phone: (281) 338-2133  
Fax: (281) 338-2136  
www.suntrac.com

**Customer: 147**

Suntrac - IN HOUSE METERS  
1818 East Main Street  
League City, TX 77573

Instrument Serviced:		Manufacturer	Model Number	Serial Number		
		Ludlum	2929 (L)	86481		
Detector:		Ludlum	43-10-1	PR108772		
Meter Range Multiplier	Distance Calculated (inches)	Filter	Calculated Calibration Point	Instrument Meter Reading	Unit	Correction Factor
Alpha Channel	Pulser	N	40	40	C.P.M.	1.0
Alpha Channel	Pulser	N	400	398	C.P.M.	
Alpha Channel	Pulser	N	4000	4010	C.P.M.	
Alpha Channel	Pulser	N	40000	40065	C.P.M.	
Alpha Channel	Pulser	N	400000	402563	C.P.M.	
Beta/Gamma Ct	Pulser	N	40	40	C.P.M.	1.0
Beta/Gamma Ct	Pulser	N	400	398	C.P.M.	
Beta/Gamma Ct	Pulser	N	4000	4017	C.P.M.	
Beta/Gamma Ct	Pulser	N	40000	40267	C.P.M.	
Beta/Gamma Ct	Pulser	N	400000	401575	C.P.M.	
Minutes	Pulser	N	0.1	.1	Min	1.0
Minutes	Pulser	N	1	1	Min	
Minutes	Pulser	N	10	10	Min	

Calibrated in accordance with Texas Radioactive Materials License Number L03062, and requirements of ANSI/NCSS Z540-1-1994; ANSI-N323A-1997; and 10 CFR 34.25 & 35.61. NIST Traceable #111926/T111433.

Temperature: 79°F Humidity: 35% Altitude: 30inHG Geotropism: ☒

Calibration Source S/N: A280 Source Activity: 58.40 mCi Cs137: 20.10 mR/hr. @100cm; <+/-5%

Pulser Utilized: Yes Pulser Information: Ludlum Model 500 S/N 50802

Battery Check: N/A

OP Volts: 700

Detector Position: Parallel

Check Source: No

Isotope:

Isotope S/N:

Min At Contact:

Technician Comments: This instrument is calibrated electronically in C. P. M.

*Benito Herrera*

12/15/14

6 months

6/15/15

Calibrated By Benito Herrera

Cal. Date

Calibration Interval Cal. Due Date

This certificate may not be reproduced except in full, without written permission from Suntrac Services, Inc.



**SUNTRAC Services, Inc.**  
**CERTIFICATE OF CALIBRATION**

1818 East Main Street  
League City, TX 77573  
Phone: (281) 338-2133  
Fax: (281) 338-2136  
www.suntrac.com

**Customer: 147**

Suntrac - IN HOUSE METERS  
1818 East Main Street  
League City, TX 77573

		Manufacturer	Model Number	Serial Number		
Instrument Serviced:		Ludlum	2929 (L)	86481		
Detector:		Ludlum	43-10-1	PR108772		
Meter Range	Distance	Filter	Calculated	Instrument	Unit	Correction
Multiplier	Calculated		Calibration	Meter		Factor
	(inches)		Point	Reading		
HV	Pulser	N	500	500	Volts	1.0
HV	Pulser	N	2000	2000	Volts	

Calibrated in accordance with Texas Radioactive Materials License Number L03062, and requirements of ANSI/NCSL Z540-1-1994; ANSI-N323A-1997; and 10 CFR 34.25 & 35.61. NIST Traceable #111926/T111433.

Temperature: 79°F Humidity: 35% Altitude: 30inHG Geotropism: ☒  
Calibration Source S/N: A280 Source Activity: 58.40 mCi Cs137: 20.10 mR/hr.@100cm;<+/-5%  
Pulser Utilized: Yes Pulser Information: Ludlum Model 500 S/N 50802

Battery Check: N/A OP Volts: 700 Detector Position: Parallel  
Check Source: No Isotope: Isotope S/N: Volts At Contact:

Technician Comments: This instrument is calibrated electronically in C. P. M.

*Benito Herrera*

Calibrated By Benito Herrera 12/15/14  
Cal. Date

6 months 6/15/15  
Calibration Interval Cal. Due Date

This certificate may not be reproduced except in full, without written permission from Suntrac Services, Inc.



100% Recycled fiber  
80% Post-Consumer

## Extremely Urgent

This envelope is for use with the following services:

UPS Next Day Air®  
UPS Worldwide Express™  
UPS 2nd Day Air®

Visit [ups.com](http://ups.com)® or call 1-800-PICK-UPS® (1-800-742-5877) to schedule a pickup or find a drop off location near you.

### Domestic Shipments

- To qualify for the Letter rate, UPS Express Envelopes may only contain correspondence, urgent documents, and/or electronic media, and must weigh 8 oz. or less. UPS Express Envelopes containing items other than those listed or weighing more than 8 oz. will be billed by weight.

### International Shipments

- The UPS Express Envelope may be used only for documents of no commercial value. Certain countries consider electronic media as documents. Visit [ups.com/importexport](http://ups.com/importexport) to verify if your shipment is classified as a document.

- To qualify for the Letter rate, the UPS Express Envelope must weigh 8 oz. or less. UPS Express Envelopes weighing more than 8 oz. will be billed by weight.

**Note:** Express Envelopes are not recommended for shipments of electronic containing sensitive personal information or breakable items. Do not send or cash equivalent.

JOHN NEWLAND  
(517) 531-8210  
JAN X-RAY SERVICES, INC.  
8550 E MICHIGAN AVE  
PARMA MI 49269-0785

LTR 1 OF 1

SHIP TO:  
NRC MATERIALS LIC. BRANCH, REG III  
SUITE 210  
2443 WARRENVILLE RD  
LISLE IL 60532-4352

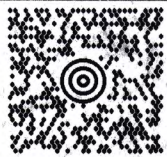

IL 603 9-03



UPS NEXT DAY AIR

TRACKING #: 1Z 434 95X 01 5984 2608

1

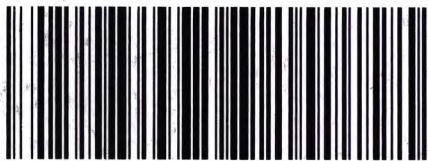

BILLING: P/P

RECEIVED MAR 26 2005

HS 17.0.31

LP2844 60.0R 01/2015

SEE NOTICE ON REVERSE regarding UPS terms, and notice of limitation of liability. Where allowed by law, shipper authorizes UPS to act as forwarding agent for export control and customs purposes. If exported from the U.S., shipper certifies that the commodities, technology or software were exported from the U.S. in accordance with the Export Administration Regulations. Diversion contrary to law is prohibited. B00 R 1114

Apply shipping documents on this side.

Do not use this envelope for:

UPS Ground  
UPS Standard  
UPS 3 Day Select®  
UPS Worldwide Expedited®

Serving you for more than 100 years  
United Parcel Service.



International Shipping Notice — Carriage hereunder may be subject to the rules relating to liability and other terms and/or conditions established by the Convention for the Unification of Certain Rules Relating to International Carriage by Air (the "Warsaw Convention") and/or the Convention on the Contract for the International Carriage of Goods by Road (the "CMR Convention"). These commodities, technology or software were exported from the U.S. in accordance with the Export Administration Regulations. Diversion contrary to U.S. law prohibited.

010195101 4/14 PAC United Parcel Service