

United States Nuclear Regulatory Commission Official Hearing Exhibit																									
In the Matter of: POWERTECH USA, INC. (Dewey-Burdock In Situ Uranium Recovery Facility)																									
	<table><tr><td><b>ASLBP #:</b></td><td>10-898-02-MLA-BD01</td><td><b>Identified:</b></td><td>8/19/2014</td></tr><tr><td><b>Docket #:</b></td><td>04009075</td><td><b>Withdrawn:</b></td><td></td></tr><tr><td><b>Exhibit #:</b></td><td>APP-040-H-00-BD01</td><td><b>Stricken:</b></td><td></td></tr><tr><td><b>Admitted:</b></td><td>8/19/2014</td><td></td><td></td></tr><tr><td><b>Rejected:</b></td><td></td><td></td><td></td></tr><tr><td><b>Other:</b></td><td></td><td></td><td></td></tr></table>	<b>ASLBP #:</b>	10-898-02-MLA-BD01	<b>Identified:</b>	8/19/2014	<b>Docket #:</b>	04009075	<b>Withdrawn:</b>		<b>Exhibit #:</b>	APP-040-H-00-BD01	<b>Stricken:</b>		<b>Admitted:</b>	8/19/2014			<b>Rejected:</b>				<b>Other:</b>			
<b>ASLBP #:</b>	10-898-02-MLA-BD01	<b>Identified:</b>	8/19/2014																						
<b>Docket #:</b>	04009075	<b>Withdrawn:</b>																							
<b>Exhibit #:</b>	APP-040-H-00-BD01	<b>Stricken:</b>																							
<b>Admitted:</b>	8/19/2014																								
<b>Rejected:</b>																									
<b>Other:</b>																									

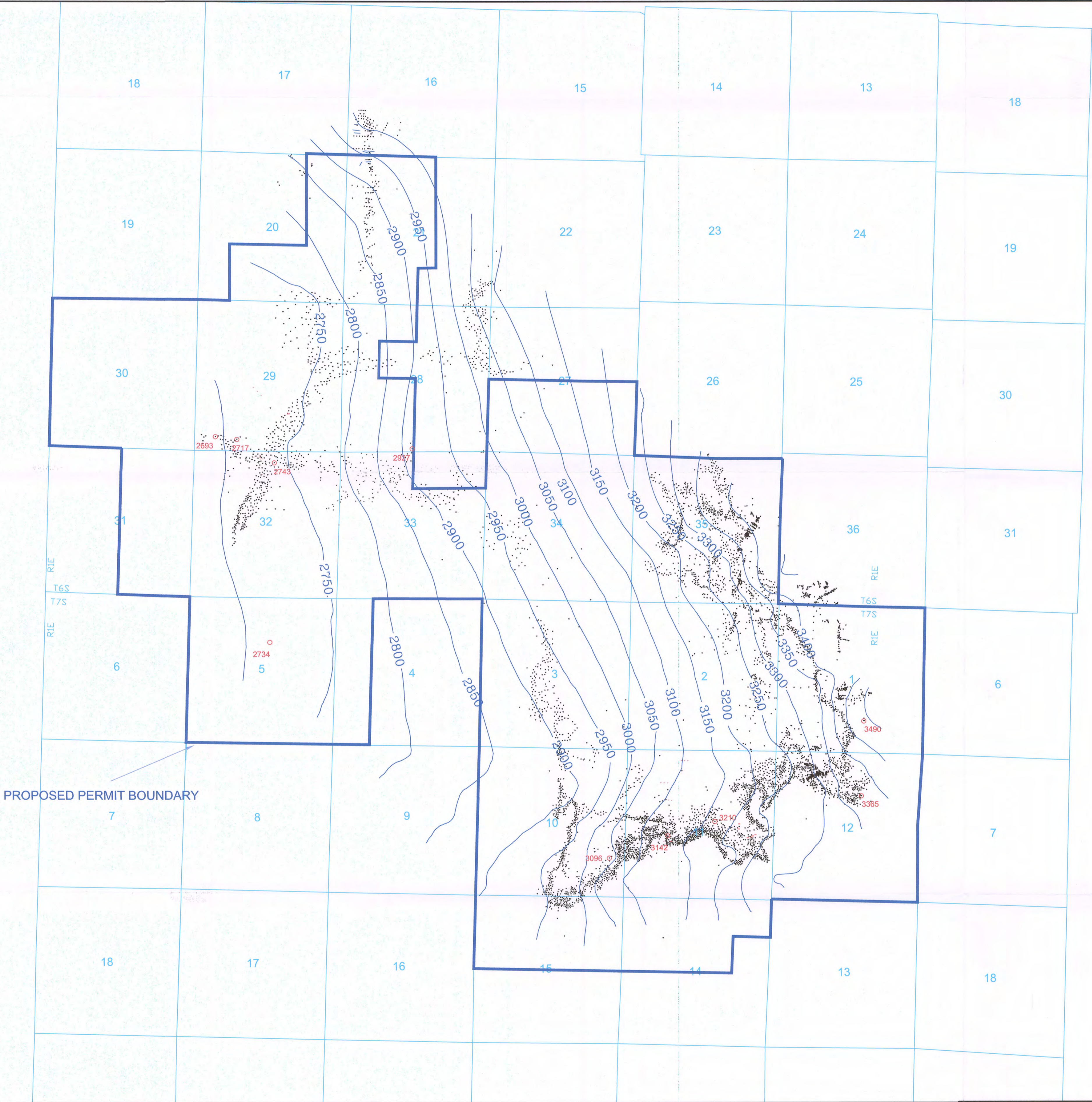

This map is based on very few holes.  
Most holes were not drilled this deep.

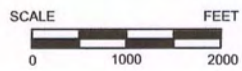

CONSULTANT	REVISIONS				PROJECT	Dewey-Burdock Project	
	#	DRAWN	CHECKED	APPROVED			DATE
REF						COORDS	State Plane- NAD27
CHECK SCALES		14-Nov-2008	11-Nov-2008				
If this bar does not measure 1 inch this map is not at its original scale.		RC	CHECKED				
SCALE		as noted	FILENAME c:\powertech\south dakota\dewey burdock\adloc\2008\trunk db & topo\contour\structure map - top of the unkpa 11-14-08.dwg				
Arch D		24" x 36"	1 OF 1				

**PLATE 3.3-4**  
**Structure Map**  
**Top of the Unkpapa**