

R 76 W

R 75 W

T
44
N

T
44
N

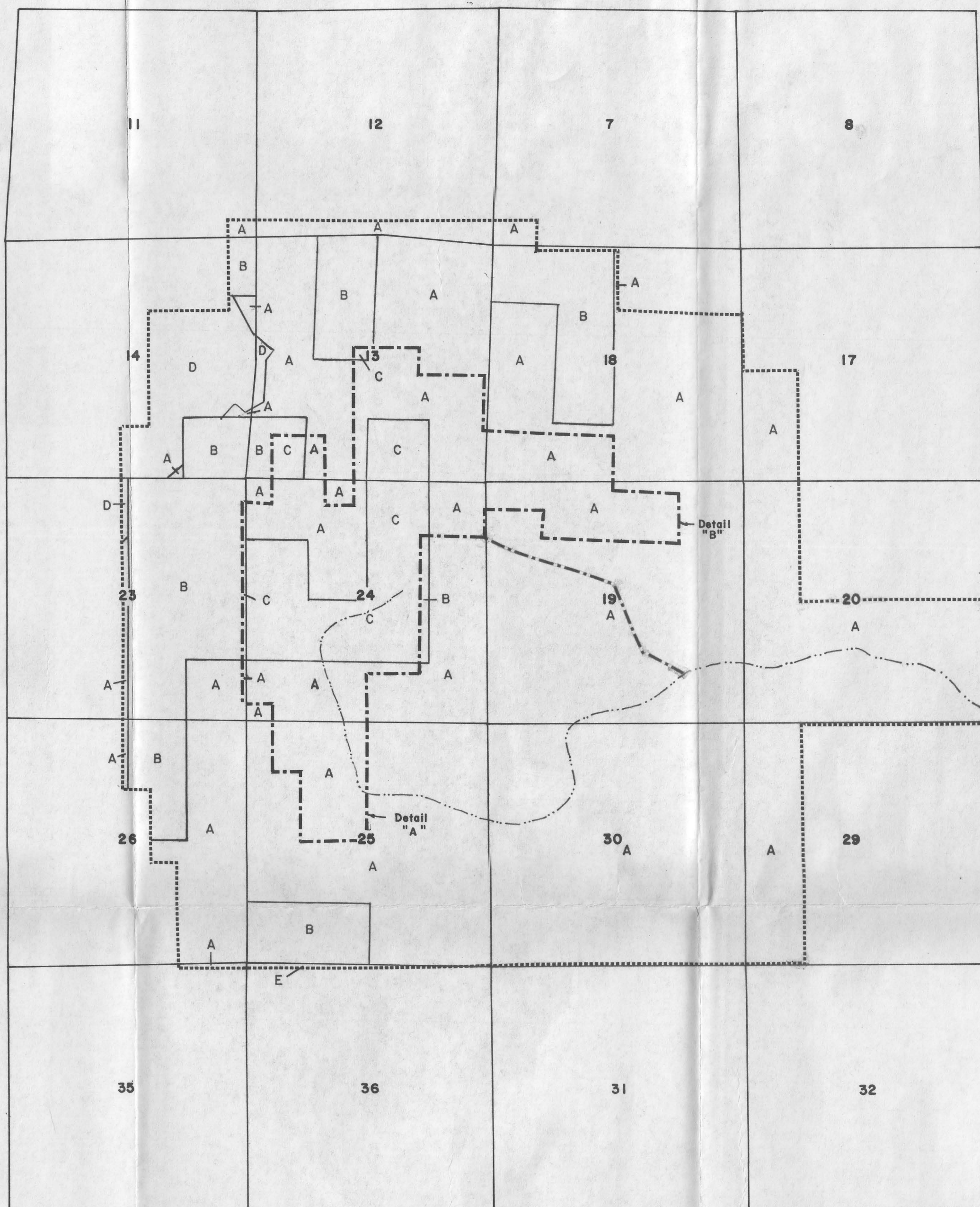

23, 24
25 26

24, 19
25 30

26+ 25

Detail "A"
Not to Scale

18
19

Detail "B"
Not to Scale

LEGEND

- A: T Chair Land Company
- B: United States of America
- C: Pathfinder Mines Corporation
- D: John O. Christensen
- E: State of Wyoming

Access Road
Permit Area
One-half Mile Perimeter
Area

PATHFINDER MINES CORPORATION			
NORTH BUTTE ISL PROJECT			
P.O. BOX 730 MILLS, WYOMING 82644			
SURFACE OWNERSHIP			
Reference: Appendix A & B			
Geol:	Scale: 1"=2000'	Revised: 1-1-92	Fig. 2.1
Drawn By: P.A.H.	Report:	Revised:	
Date: 7-14-88	Dwg:	Revised:	

Note: Access Road Right of Way included within Permit Area