

Model Description of Spent Fuel Storage Rack

Spent fuel storage rack is composed of modules with the different number of cell. Spent fuel storage rack is installed without constraint at bottom of storage pool. Storage pool is separated into two areas of Region I and Region II. Region I consists of four 8 cell x 8 cell rack modules and two 6 cell x 8 cell modules. Region II consists of nineteen 8 cell x 8 cell rack modules and four 8 cell x 7 cell rack modules. Even if modules have the same number of cells, total weights of them vary due to the different number of outside/inside cover plates and poison plates. Therefore, among the modules of the same number of cells, the one with the highest weight was adopted for analysis.

	<u>Number of cell</u>	<u>Identification number of module</u>
Region I	8 x 8	A1-1, A1-2, A1-3 & A1-4
	6 x 8	A2-1 & A2-2
Region II	8 x 8	B1, B2-1, B2-2, B2-3, B3, B4, B5-1, B5-2, B5-3, B5-4, B5-5 B5-6, B6-1, B6-2, B6-3, B7, B8, B9 & B10
	8 x 7	C1, C2, C3 & C4

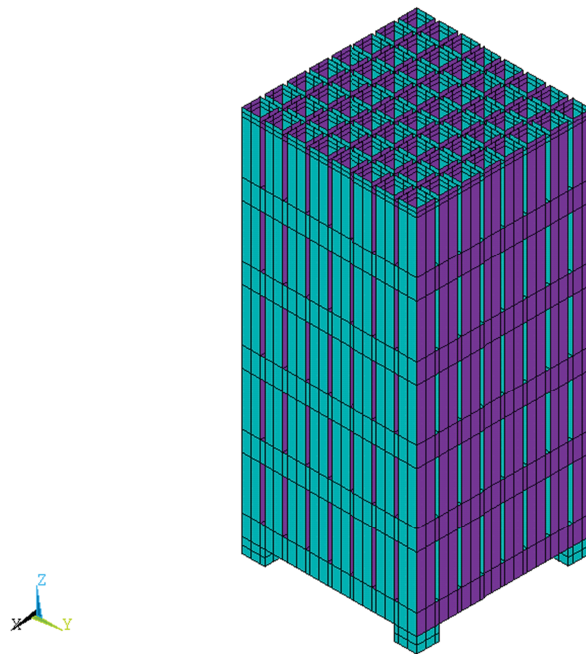

Figure B.2 Full Model of Region I 8x 8 Modules for SF SR

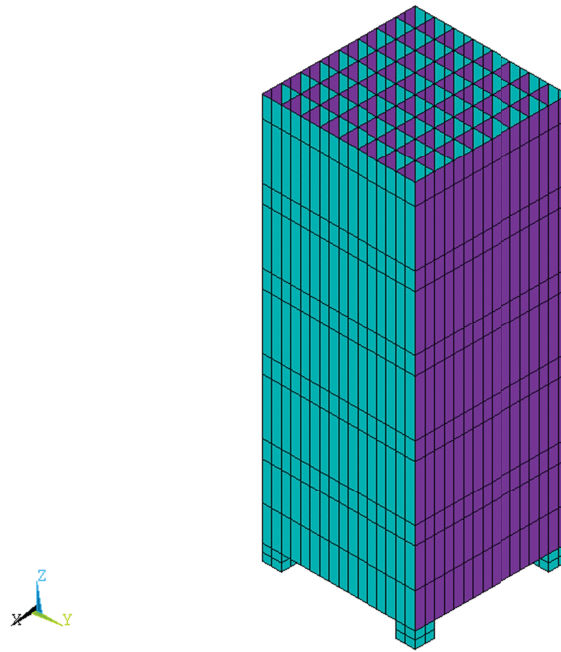

Figure B.3 Full Model of Region II 8 x 8 Modules for SFSR